

HONDA VFR800F ABS V-TEC from 2002 to 2013 (high pipes).

Parts list for MCS 4440/1 kit

For bikes with type 1 (un-sealed) speedometer sender connectors.

&

Parts list for MCS 4440/2 kit

For bikes with type 2 (sealed) speedometer sender connectors.

Item	Qty	Part Number	Description
1	1	MCSU 400C	Computer
2	2		Form mounting tape
		<u>MCS 4442</u>	<u>Vacuum actuator assembly</u>
3	1	MCS 574	Vacuum actuator
4	1	MCS 574D SP	Solenoid housing dust cover
5	1	MCS 4442A	Actuator bracket
	3		6g x 1/2" self tap screw
	1		6g x 3/8" pan head self tap screws
6	1	MCS 574F	Rubber grommet
7	1	MCS 574E SP	Diaphragm housing dust cover
8	1		M6 x 25 plated bolt
9	2		6mm plated flat washers
10	1		M6 Nyloc nut
11	1	MCS 032	Vacuum stop valve
12	1	MCS 031	Vacuum 'T' piece
13			4mm Vacuum hose
14	1	MCS 4441	Wiring loom (type 1 un-sealed speed sender connectors)
OR	1	MCS 4443	Wiring loom (type 2 sealed speed sender connectors)
a			Computer plug (26 pin)
b			Fuse holder (3 amp fuse)
c			Tach sensor wire (yellow wire)
d			Speed sensor connectors (co-axial wire)
e			Actuator plug (4 pin)
f			Power & brake sensor wires (orange and grey wires)
g			Ground connector (black wire)
h			Neutral sensor wire (blue wire)
i			Control switch plug (6 pin)
		<u>MCS 4094</u>	<u>Control switch assembly</u>
15	1	MCS 820	Control switch
16	1	MCS 830A	Switch bracket
	4		4 gauge x 1/2" pan head self tap screw
	1		100mm cable tie
		<u>MCS 4445</u>	<u>Cable Interface Unit (CIU) assembly</u>
18	1	MCS 4445A	CIU housing
19	1	MCS 003F	Actuator spool
20	1	MCS 4446	Dual spool
21	1	MCS 003H	Bush
22	1	MCS 003K	End Cap
23	1		M5 x 50 countersunk metal thread screw (pivot bolt)
24	1		M5 Nyloc nut
25	1		5mm plated flat washer

26	1		M4 x 10 pan head screw (actuator cable retainer)
27	1	MCS 4445B	CIU mount bracket
28	1		M6 x 30 bolt
29	1		6mm flat washer
30	1	MCS 300	Carburettor cable
	10		100mm cable ties
	10		150mm cable ties
	10cm	HST6	6mm heat shrink tube (for tach sensor connection)

Information, Set up and Operation Manual
 Operation and User Manual
 Installation Manual
 Trouble shooting guide

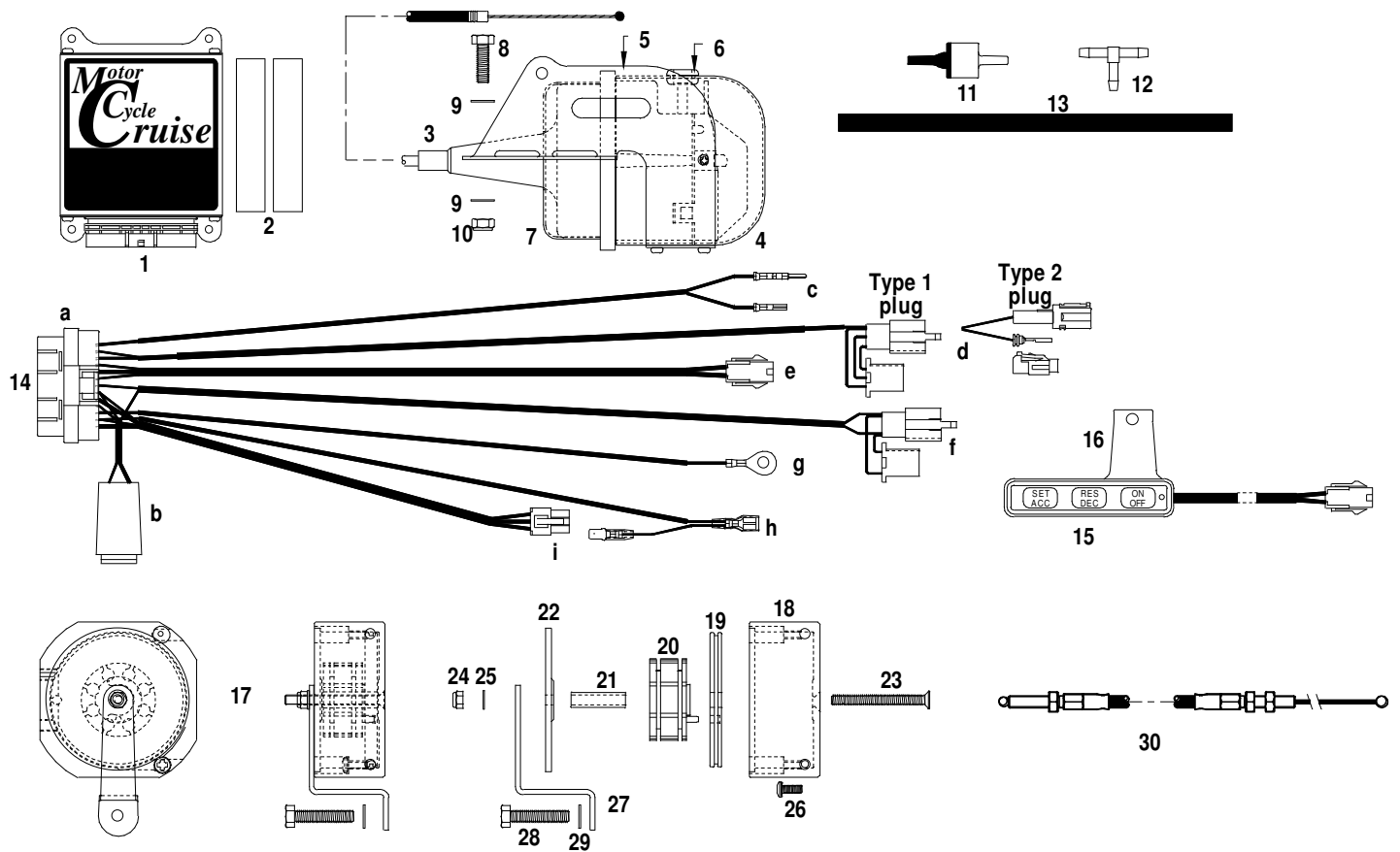

Dual spool hole marking

