

HONDA VFR800F V-TEC 2002 to 2013 (high pipes). Not for bikes with ABS brakes.

Parts list for MCS 4090A/1 kit

For bikes with type 1 (non-sealed) speedometer sender connectors.

&

Parts list for MCS 4090A/2 kit

For bikes with type 2 (sealed) speedometer sender connectors.

<u>Item</u>	<u>Qty</u>	<u>Part Number</u>	<u>Description</u>
1	1	MCSU 400C	Computer
2	1	MCS 001	Foam mounting block
	1		90mm x 40mm rubber pad with double sided tape
		<u>MCS 4092</u>	<u>Vacuum actuator assembly</u>
3	1	MCS 574	Vacuum actuator
4	1	MCS 4092A	Actuator bracket
	3		6g x 3/8" pan head self tap screws
5	2	W500	M6 x 16 bolt & flat washer
6	2		6mm flat washers
7	2		M6 Nyloc nut
8	1	MCS 032	Vacuum stop valve
9	1	MCS 031	Vacuum 'T' piece
10			4mm Vacuum hose
11	1	MCS 4091	Wiring loom (type 1 un-sealed speed sender connectors)
<u>OR</u>	1	MCS 4093	Wiring loom (type 2 sealed speed sender connectors)
a			Computer plug (26 pin)
b			Fuse holder (3 amp fuse)
c			Tach sensor wire (yellow wire)
d			Speed sensor connectors (co-axial wire)
e			Actuator plug (4 pin)
f			Power & brake sensor wires (orange and grey wires)
g			Ground connector (black wire)
h			Neutral sensor wire (blue wire)
i			Control switch plug (6 pin)
		<u>MCS 4094</u>	<u>Control switch assembly</u>
12	1	MCS 820	Control switch
13	1	MCS 830A	Switch bracket
	4		4 gauge x 1/2" pan head self tap screw
	1		100mm cable tie
14		<u>MCS 4098</u>	<u>Cable Interface Unit (CIU) assembly</u>
15	1	MCS 4098A	CIU housing
16	1	MCS 003F	Actuator spool
17	1	MCS 4096	Dual spool
18	1	MCS 003K	End Cap
19	1	MCS 003H	Bush
20	1		M5 x 45 plated bolt (pivot bolt)
21	1		M5 Nyloc nut
22	2		5mm plated flat washer
23	1		M4 x 10 pan head screw (actuator cable retainer)
24	1	MCS 4095B	CIU mount bracket
25	1		M6 x 20 bolt

26	1		6mm flat washer
27	1	MCS 300	Carburettor cable
	10		100mm cable ties
	10		150mm cable ties
	10cm	HST6	6mm heat shrink tube (tach sensor connection)

Information, Set up and Operation Manual
 Operation and User Manual
 Installation Manual
 Trouble shooting guide

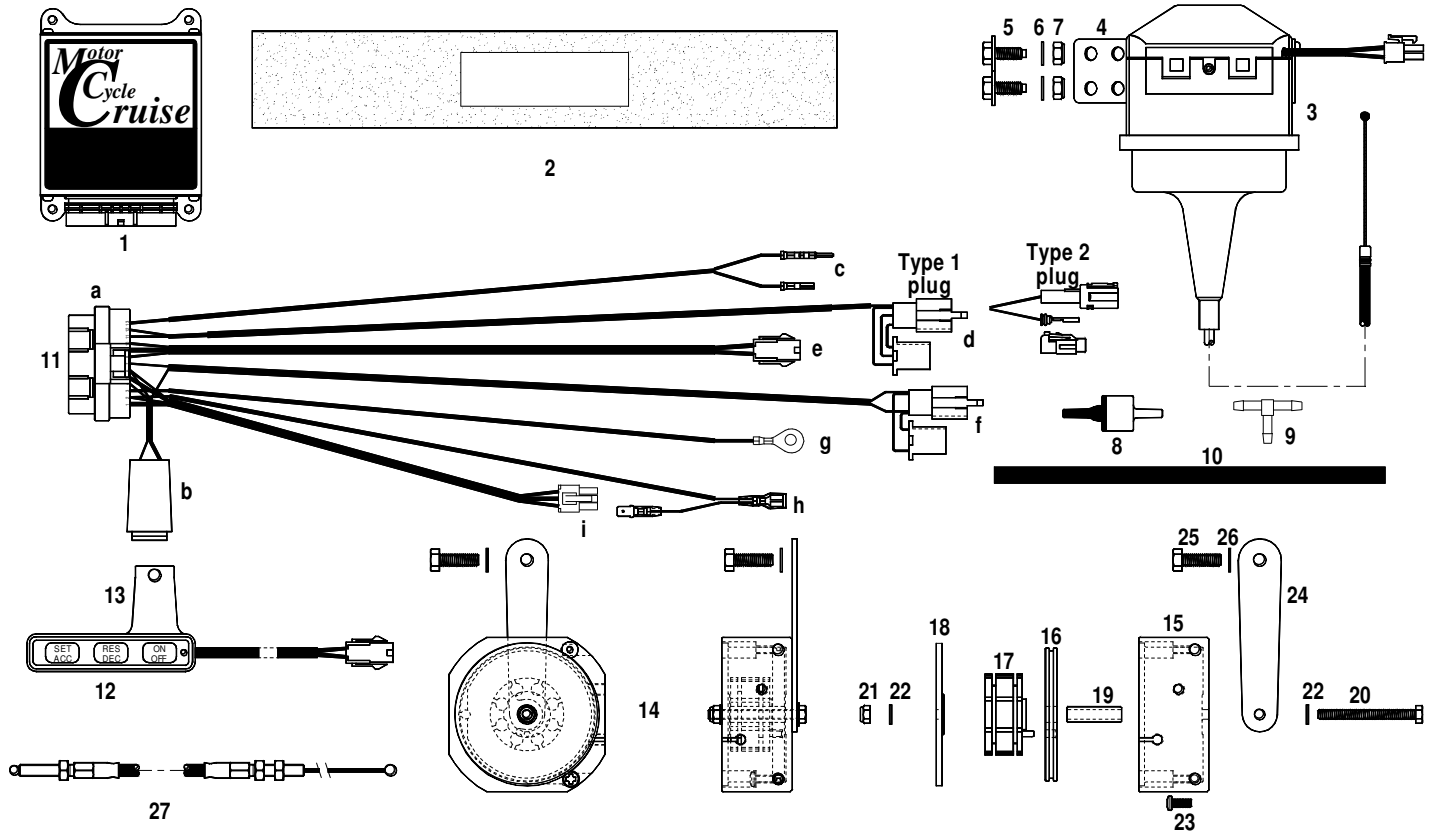

Dual spool hole marking

