

H²O H₂O

Replacement Water Filter

USER MANUAL



When to change your Water Filters?

For best results, it is recommended to change the filters every 2650 litres or every 3 months, whichever comes first.

INSTRUCTIONS

1



Remove the ceramic discs from the bottom of the filter cartridges.

2

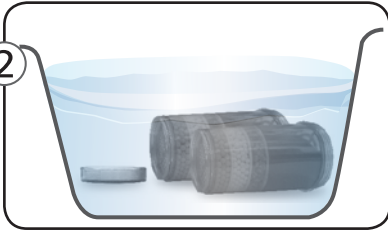

Soak both filter cartridges and the ceramic discs completely in water for 15 - 20 minutes. DO NOT wash with soap.

**Make sure the container used is clean and free of odour.*

3



Lift up the filter cartridge and shake lightly to remove carbon fines. Re-immerses filter cartridge and repeat a few cycles.

4



Hold each filter cartridge under running tap water for approximately 30 seconds.

Re-attach the ceramic discs to the cartridges.

5



Turn filter cartridges back to the bottom of the inner container. Make sure the large o-rings are properly positioned around the top of the cartridges.

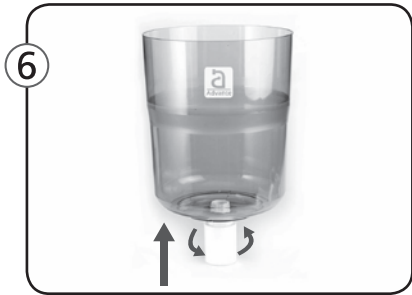

Rinse the Float Valve with water. Attach it to the underside of the outer container.

Refer to **Attaching the Float Valve on the next page.*



Place outer container with Float Valve onto the top of the dispenser system.



Place the inner container back into the outer container. Fill in water and flush out the first one or two rounds of filtered water.

Refill and press for water to flow through the **HOT** water tap before switching the power supply.

USEFUL TIPS & PRECAUTIONS

1. Never use HOT water to clean the filter cartridges, or filling in for filtration.
2. When the water filtering speed is slow, check the ceramic disc which is enclosed in the inner container.
 - a) **Air Lock**
With water in the inner container, unscrew the Ceramic Disc Cover and gently lift the ceramic disc, air bubbles will be released and water flow will improve. Screw back the Ceramic Disc Cover.
 - b) **Ceramic disc and filter cartridges are dirty**
Replace a new set of filter cartridges and ceramic disc.
3. If leaking occurs, it could be due to the Float Valve dirty or loose fitting after maintenance. Drain out all the water in the container, lift up the container and unscrew the Float Valve for cleaning. Attach the Float Valve back to the base of the water container. *Refer to **Attaching The Float Valve** below.
4. Keep The Water Filtration System away from direct sunlight.
5. It is recommended to wash the water containers, the filter cartridges and the dispenser every month, including draining off water within the dispenser.
6. Make sure water flows through the HOT Water Tap before turning on the power supply.
7. Do not use water that is microbiologically unsafe or of unknown quality without adequate disinfection before or after the system.



ATTACHING THE FLOAT VALVE

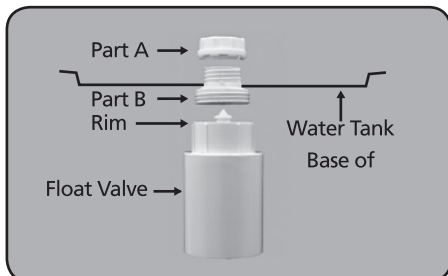

Part A and B must be tightened together.

While attaching the Float Valve, stop turning when the Rim touches the Base of the Water Tank.