

1. Crawlair housing
2. Crawlair cover
3. Filter tray
4. Left lock arm
5. Right lock arm
6. Lock hook
7. Compressed air set
8. Fan set
9. Electrical set
10. Fan inlet ZWR3
11. Lock
12. Filter cartridge
13. Metal mesh filter
14. Swivel caster 125
15. Fixed wheel 125

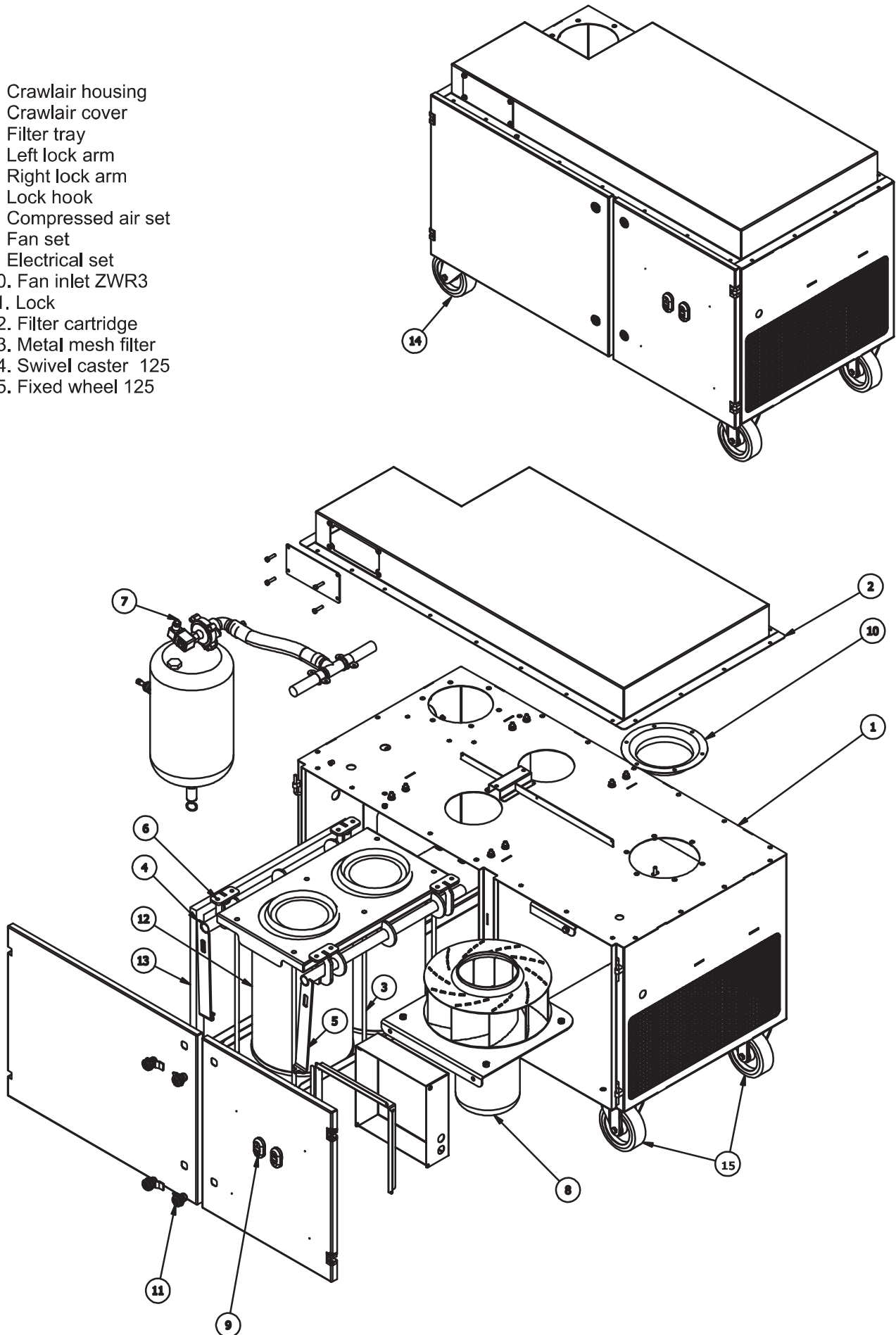

Technical data and dimension

B-2

- Air volume [m³/h] - 1000
- Noise rating [db(A)] - 73
- Power supply [V]/[Hz] - 3x400/50
- Motor power[kW] - 1,1
- Current rating [A] - 2,5
- Motor rpm [1/min] - 2800
- Compressed air tank capacity [l] - 10
- Compressed air supply [bar] - 5 - 5,5
- Compressed air connection - G1/2 - Ø10
- Drawer for waste [l] - 10
- Sparktrap - metal mesh - 1 pc - P01-81-0002
- Polyester filter cartridges - 2 pc - P01-80-0005
- Weight without arm [kg] - 110

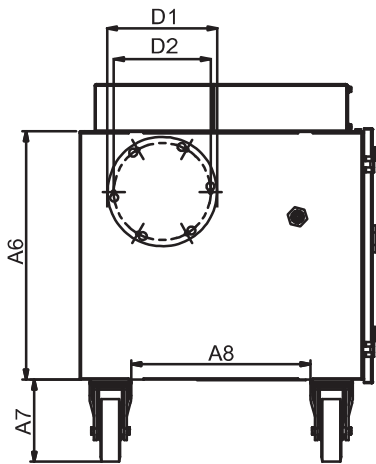

A1 =	1140
A2 =	763
A3 =	606
A4 =	941
A5 =	592
A6 =	503
A7 =	165
A8 =	362
B1 =	239
B2 =	240
B3 =	185
D1 =	220
D2 =	195

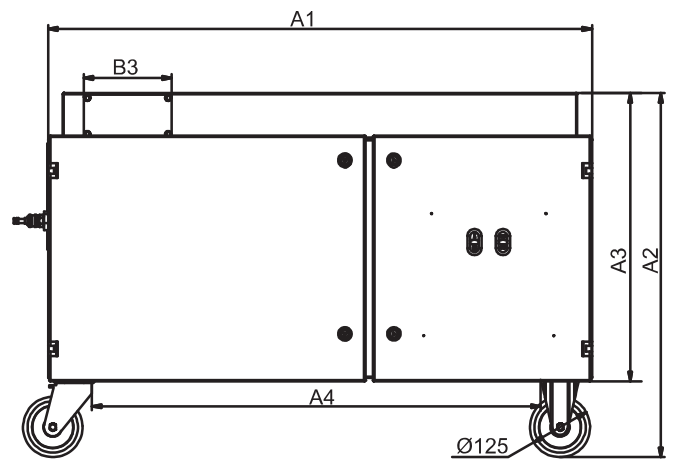
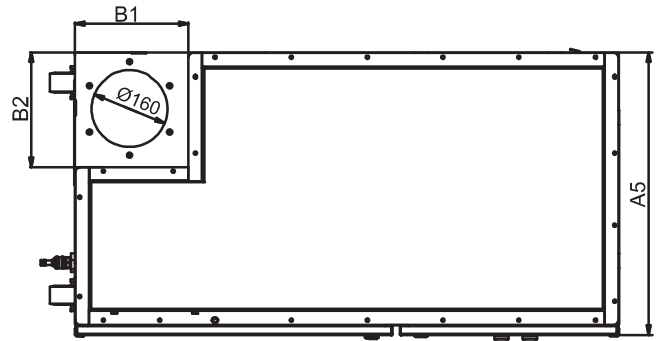

All dimensions in millimeters.

Installation

C-1

Before starting the unit:

- Mount self-supporting arm or connect to inlet ducting.
- Install cartridges and connect compressed air supply:
 - more: C1 - Compressed air cleaning system;
 - more: C2 - Motor control.
- Plug the unit to the power supply.
- Check status of all connections.
- Start with the main switch, located on the fan door.



Mounting the arm with bolts M6/25 and spring washers:

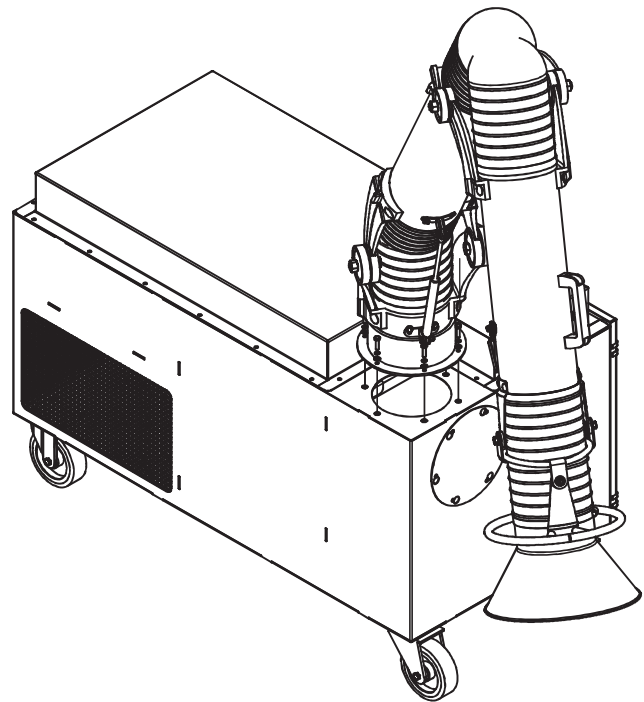
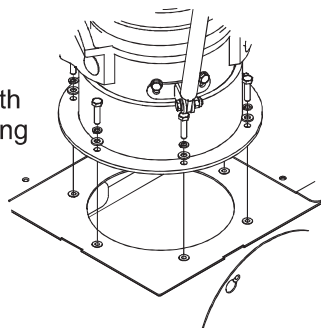



Cartridge filter module maintenance

Pulling out filter module:

- Unlock the filter lock handles and release them downwards.
- Pull the filter module out.

Cartridge filters replacement:

- Place cartridge module gasket downwards.
- Unscrew bottom plate and replace cartridges with new ones.
- Mount the bottom plate back.
- Check center of filter gaskets to holes of module top plate.

Mounting filter module:

- Slide the filters module into the unit.
- Pull filter lock handles up and lock them together.
- Check if the handles are well together inside the unit.
- You can push handles in if they are visibly out.



WARNING! Stop the filter unit and disconnect it from power supply before filter change operation.

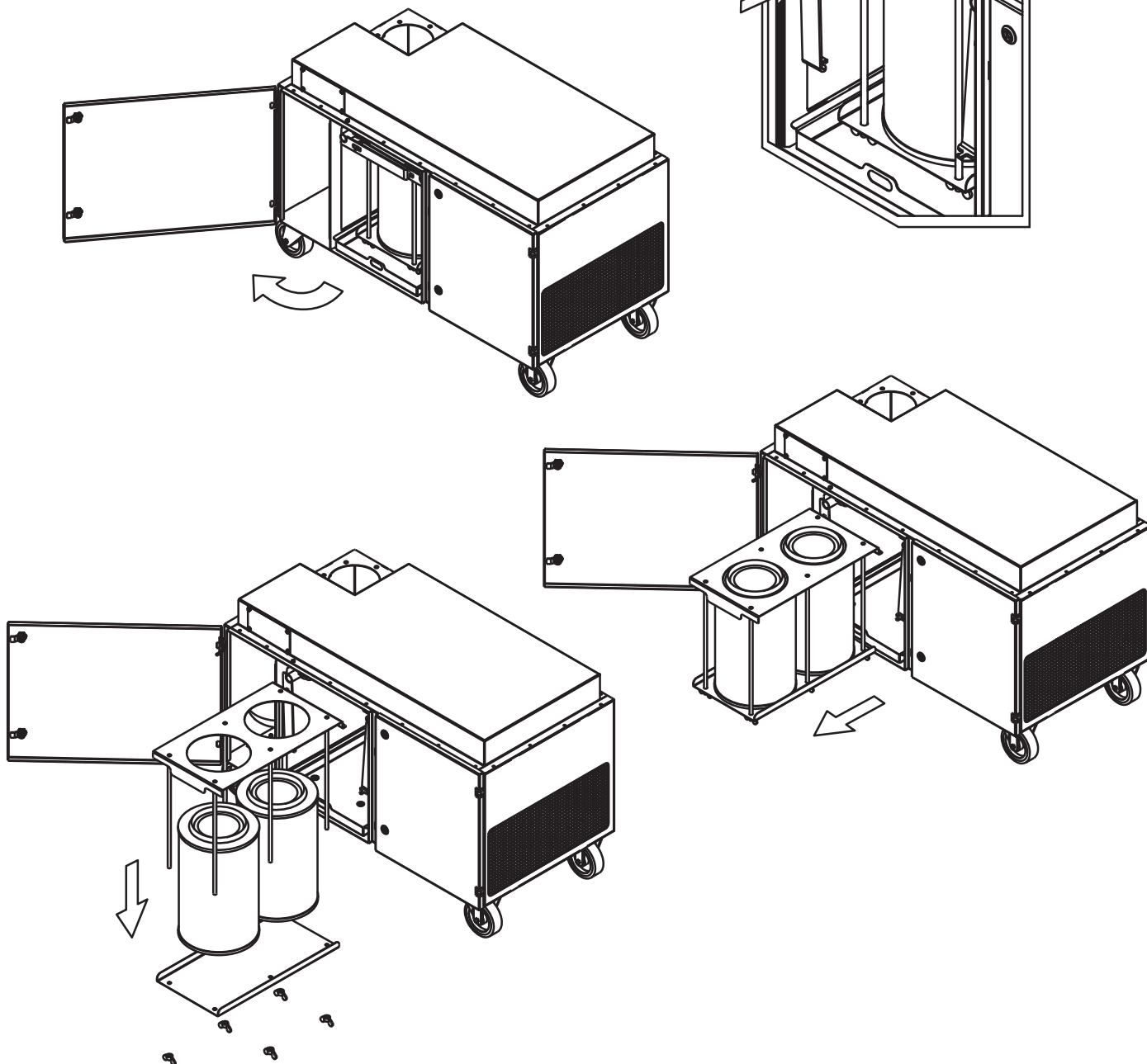

Compressed air cleaning system

D-1

- Manual cartridge cleaning is activated with compressed air release button (see the drawing). A pulse of compressed air cleans the cartridges blowing off dust cake built up between cartridge pleats.
- Before next compressed air release wait about 5 seconds or until the tank is filled back with compressed air.
- Cartridges cleaning is recommended to be performed every time at startup and shutdown and during the work (not less than every 4 hours).
- Each time when the airflow is significantly low compressed air cleaning is advised.
- For timer control operation detail read C-4 compressed air cleaning timer.

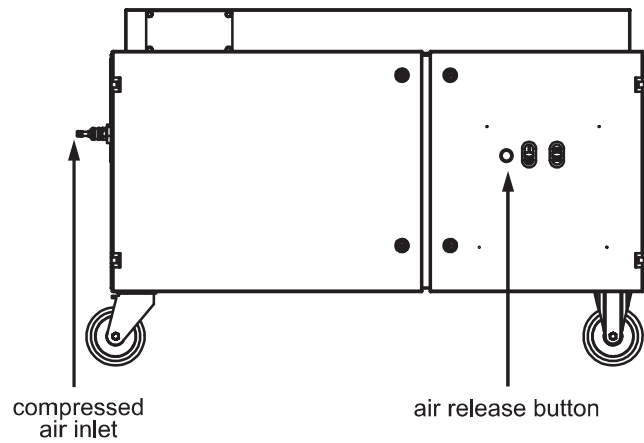

Motor control / basic setup

D-2

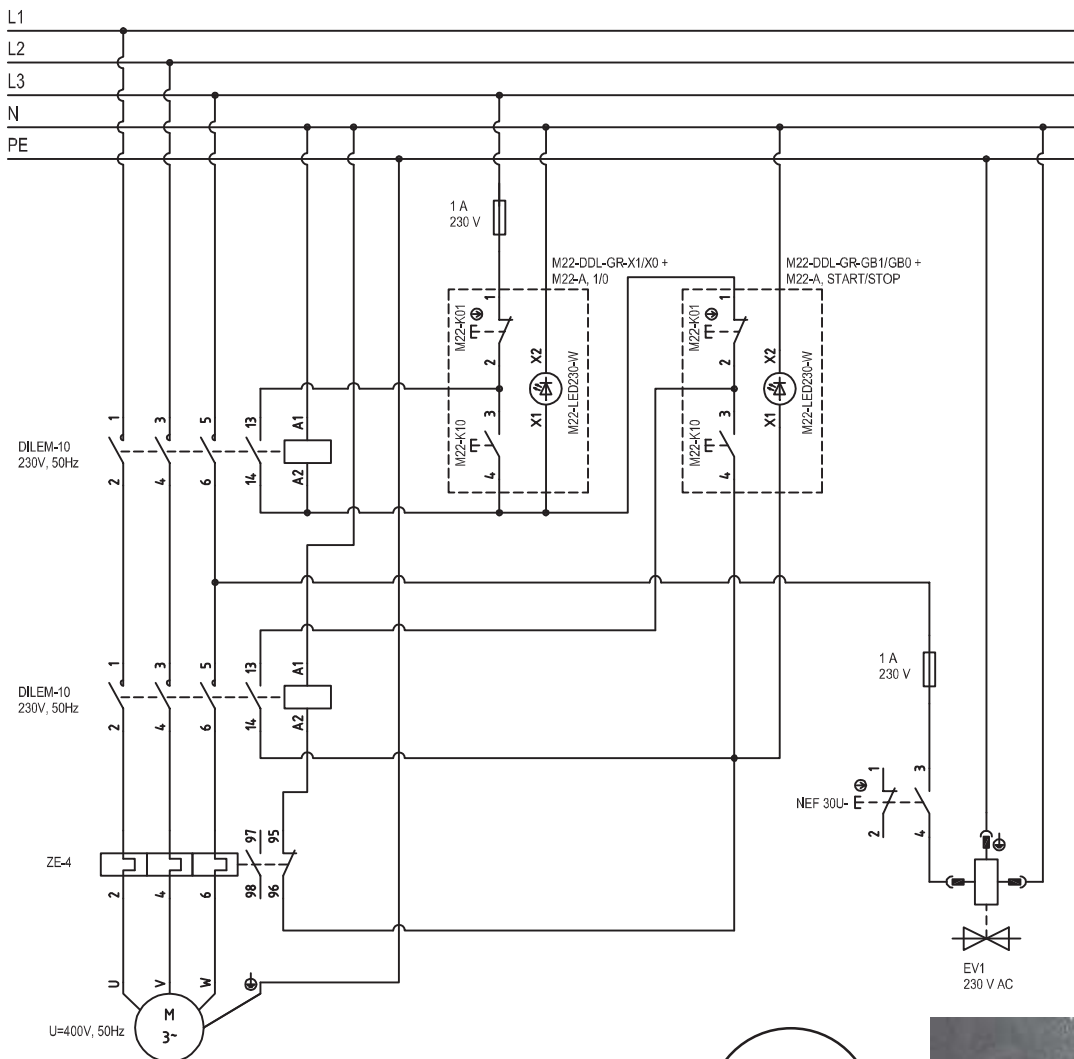

Lp	P [kW]	U [V]	f [Hz]	ZE	I _N [A]	1,1 x I _N [A]
1	1,1	400	50	ZE-4	2,5	2,8

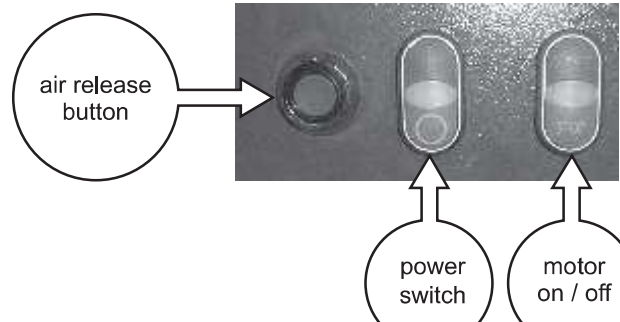

Timer is mounted on compressed air cleaning cutout.

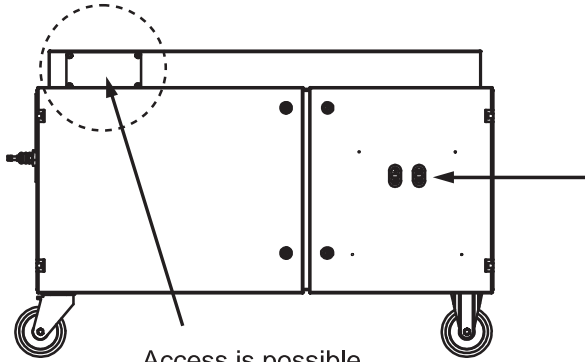

Access is possible through inspection door.

compressed air timer switch

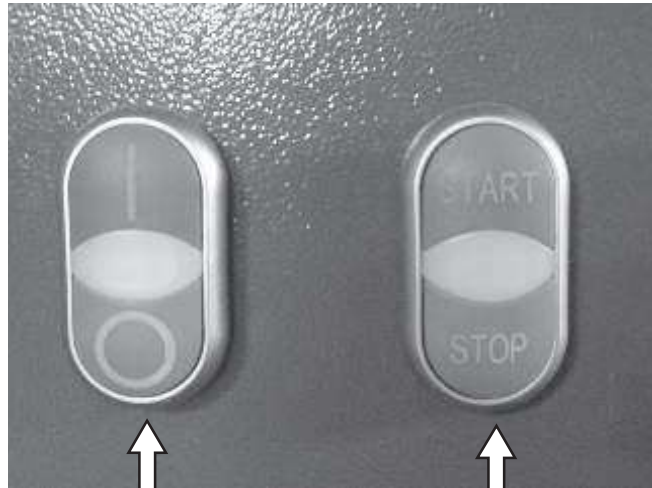

power switch

motor on/off

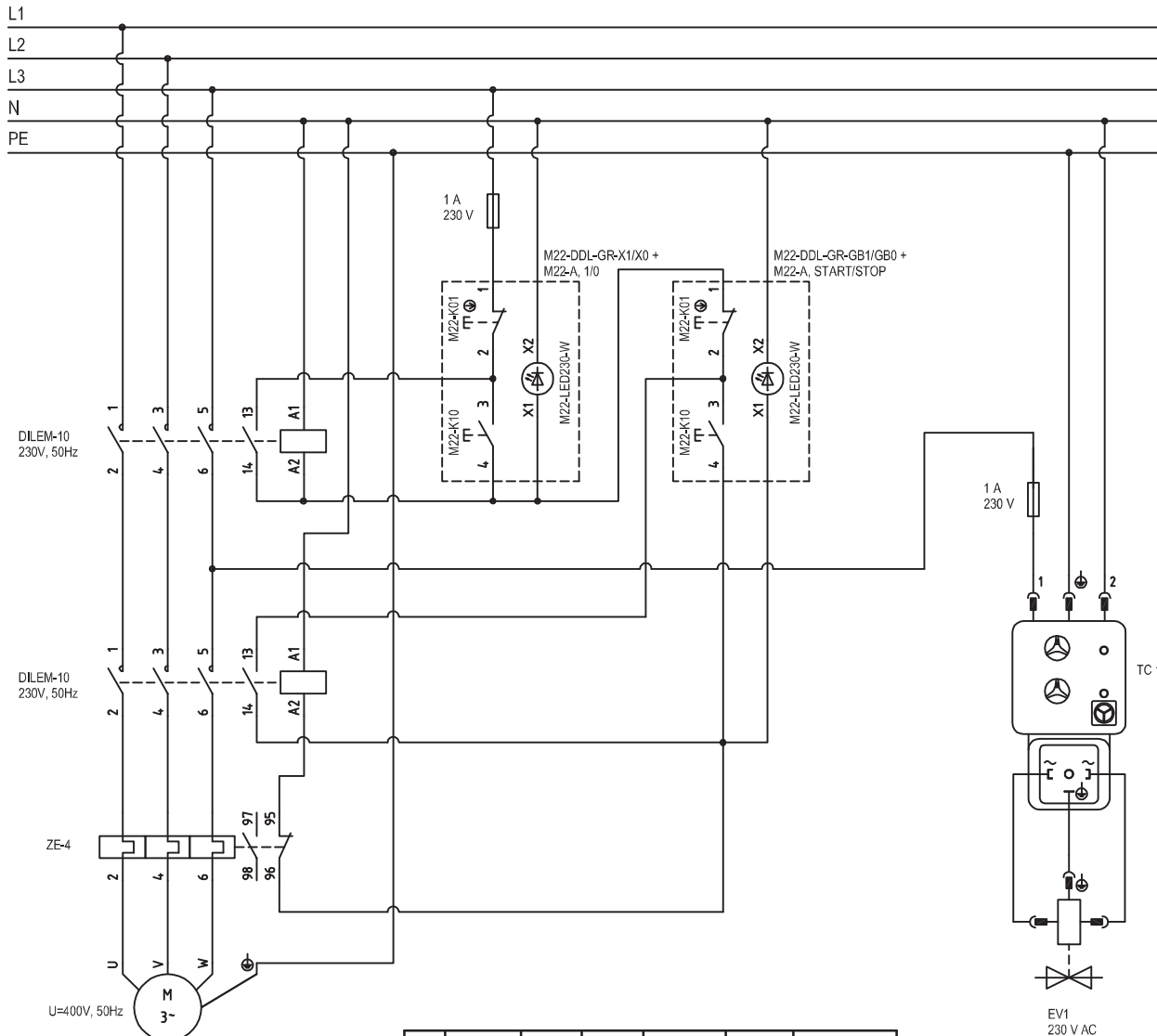

Lp	P [kW]	U [V]	f [Hz]	ZE	I _N [A]	1,1 x I _N [A]
1	1,1	400	50	ZE-4	2,5	2,8

CICLIC GENERATOR TC01

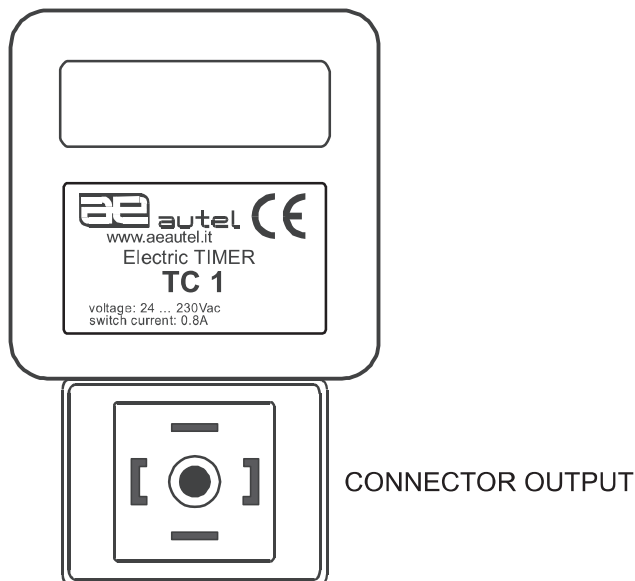
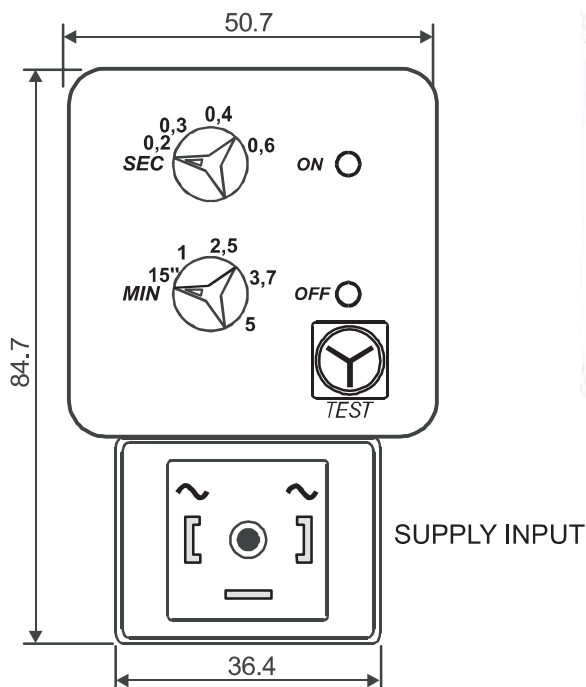
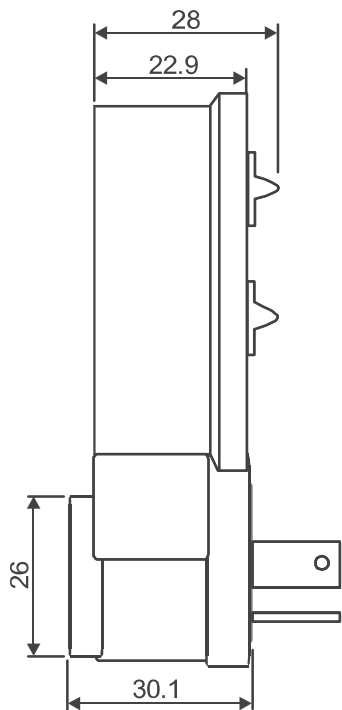

Technical Specifications

- Power supply - 24Vac ... 230Vac – 50/60Hz (on demand also 24 ... 230 Vac/dc)
- Max. power - 0,8A
- Absorbed power - 2mA (at rest)
- OPERATION time - 0-1 sec / 0-20 sec (+/-3%)
- PAUSE time- 0-5 min / 0-40 min (+/-3%)
- Case - plastic self-extinguishable material (UL94V0)
- Protection level - IP65
- Connections - DIN43650 B connector
- Preservation - 1 fuse = 1A quick acting

DAILY	MONTHLY	YEARLY
<ul style="list-style-type: none"> • overall control for any leakage, including the state of door • seal and flexible suction pipes or suction arm • pulse cleaning of filter cartridge • check waste drawer 	<ul style="list-style-type: none"> • inspection of compressed air and pneumatic components • visual inspection for signs corrosion • electrical system control and wire insulation 	<ul style="list-style-type: none"> • recommended replacement of carbon filter and cartridges • inspection for corrosion or any type of mechanical perforation of the filter box • check electrical wiring condition

Troubleshooting

SYMPTOMS	POSSIBLE REASONS	SOLUTION
Low air volume.	Wrong direction of motor rotation.	Change direction on the motor by changing the phases on power supply.
	Filter cartridge is clogged.	Connect compressed air to the filter, perform the cleaning cycle several times. If this proves ineffective remove the cartridge, wash it with clean water and detergent
Dust coming out of the filter outlet.	Wrong sealed or mechanically damaged filter cartridge.	Properly tighten the filter gasket. Replace the filter cartridge for a new one.
Can not start the device.	No power supply.	Check the connection of the device. Check the power supply.