









USER AND MAINTENANCE MANUAL



General information.....	A-1
Product application.....	A-2
Equipment arrival.....	A-3
Construction.....	B-1
Technical data.....	B-2
Dimensions.....	B-3
Installation.....	C-1
Filter change.....	C-2
Compressed air cleaning system.....	D-1
Motor control.....	D-2
Motor control with compressed air cleaning timer.....	D-3
Compressed air cleaning timer.....	D-4
Use and maintenance.....	E-1
Troubleshooting.....	E-2

	Important information		3D preview available in electronic form		Installation, tools, Subparts, accessories		Keep away from source of high temperature
	warnings, notes		use respiratory protective equipment		protect from noise or eye damage		switch off before proceeding

## General Information

A-1

This instruction manual contains SF-2000 portable cartridge filter unit use and maintenance information. SF-2000 user should become acquainted with contents of this publication to learn about unit construction, principles of operation and means of its safe use. Manufacturer is not responsible for any consequences arising from the use of the unit against its intended purpose. Manufacturer reserves the right to make changes to improve performance and operational qualities of the product in the future without prior notice.



- Store in dry and airy rooms
- Place in a position ready for operation
- Protect against possibility of shifting during transport

## Product Application

A-2

filtering unit can be used without restriction in the technical areas intended for permanent human habitation. is designed for extraction and purification of air from the dry dust (with particular emphasis on the processes of welding, grinding, polishing, pouring, dispensing, grinding, cutting metals and plastics).



- Manufacturer does not recommend use of the unit in the process of:
- Cleaning the air from dust containing asbestos, cadmium, beryllium
  - Cleaning the air from wet dust
  - Cleaning the air polluted with explosive or chemically active gases



Due to the extremely harmful to the health fine dust, located inside the filter and on filter cartridges, all work associated with the filter exchange should be done using respiratory protective equipment.

## Equipment Arrival

A-3

Upon arrival the user needs to thoroughly inspect the equipment and make sure there was no damage caused by shipping carrier. If there is damage, the user needs to immediately contact their dealer.

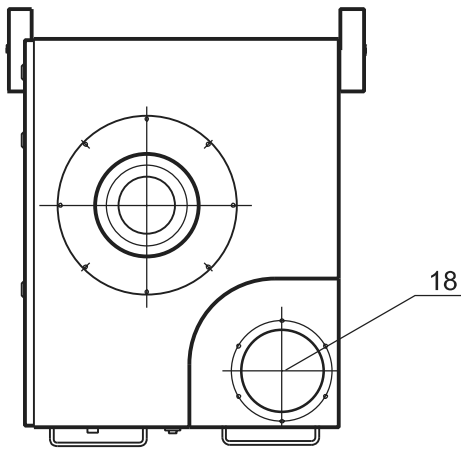
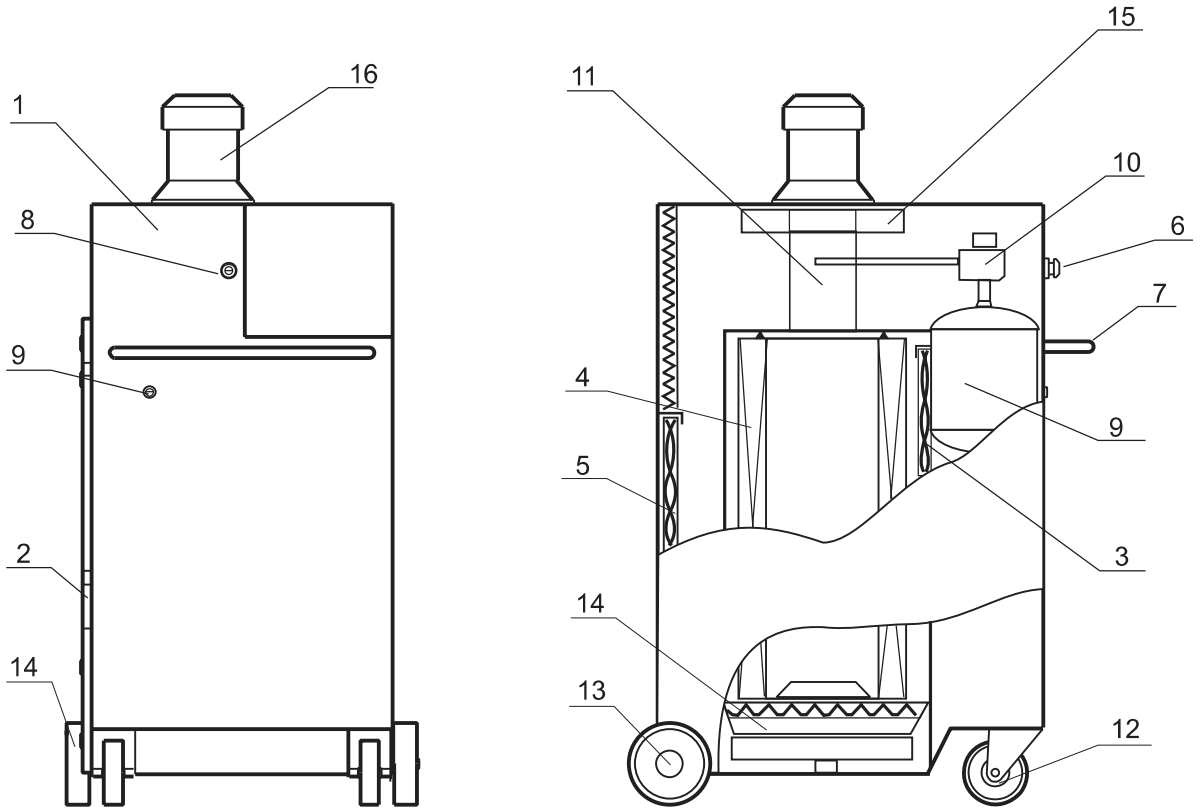

1. Housing
2. Door
3. Preliminary, metal filter
4. Main Filtering Cartridge
5. Outlet Carbon Filter
6. Button – Compressed air cleaning manual release
7. Grab Handle
8. Compressed Air Connection (G1/2)
9. Compressed Air Tank
10. Pneumatic Valve
11. Clean Air Outlets
12. Swivel Caster Wheel with Brake
13. Wheels
14. Waste Drawer
15. Impeller
16. Motor
17. Noise Reducing Foam
18. Mounting Arm Connection

- Airflow with arm 1630P [m<sup>3</sup>/h] - 1150
- Noise level at 1m [db(A)] - 75
- H (for 1630p) [m] - 3,95
- R (for 1630p) [m] - 2,8
- Power supply (voltage) [V]/[Hz] - 3x400/50
- Motor power [kW] - 1,1
- Current rating [A] - 2,5
- Fan rotation speed [1/min] - 2800
- Compressed Air tank [l] - 10
- Air pressure [bar] - 5 - 5,5
- Compressed air connection - G1/2
- Drawer for waste [l] - 10
- Preliminary - metal mesh - 1pc
- Cartridge - 1pC
- At outlet - carbon - 1pc
- Weight without arm [kg] - 125
- Weight with arm [kg] - 145

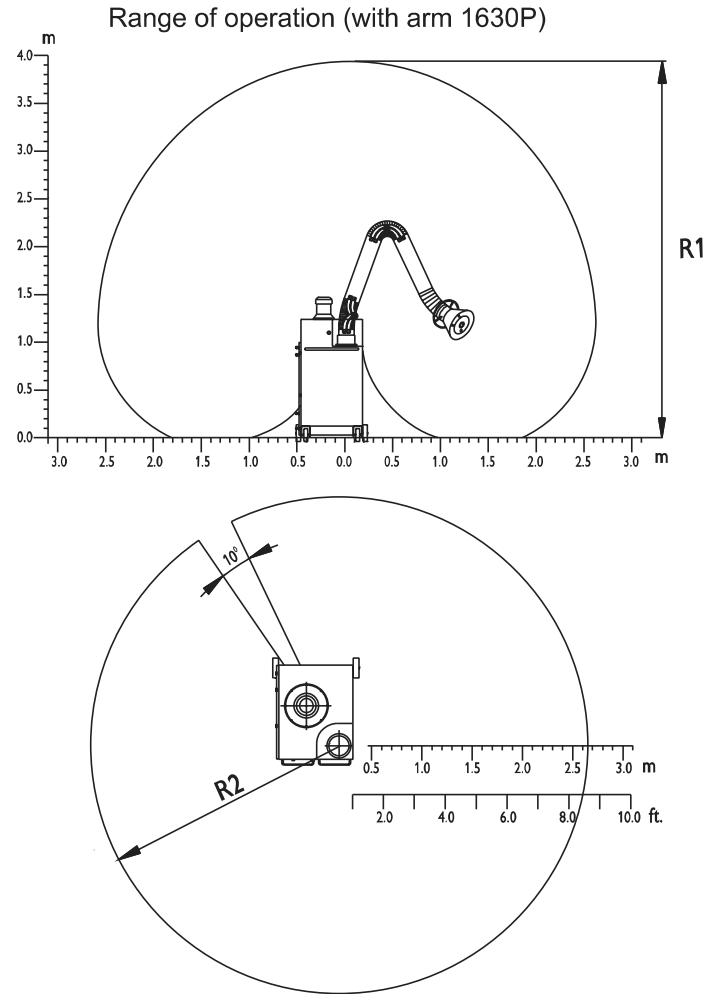

## Dimensions

B3

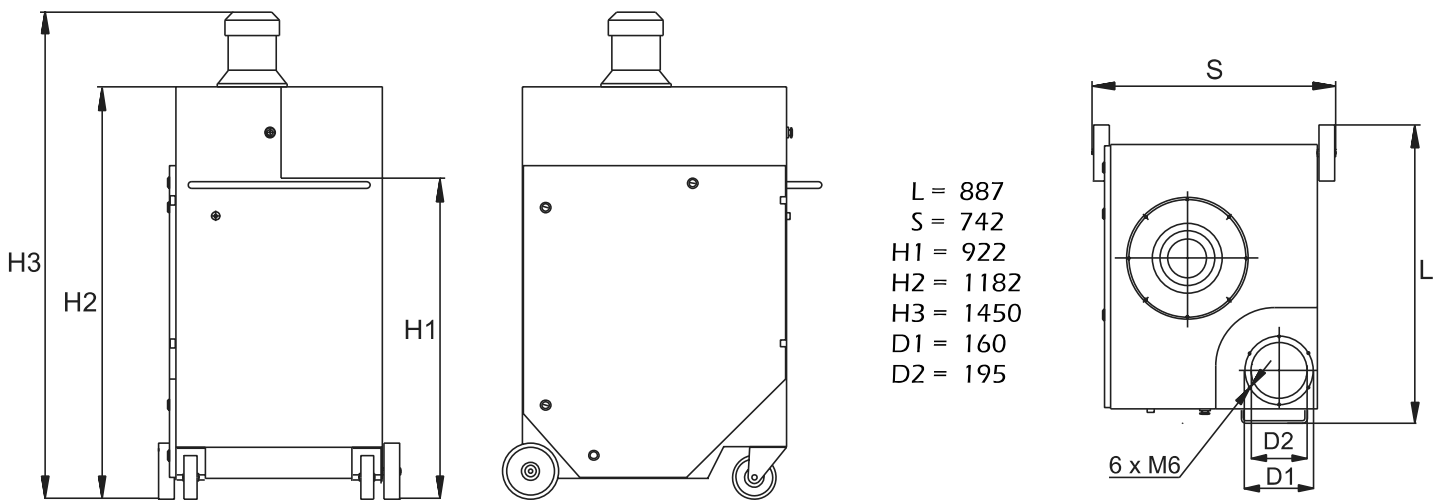

Before starting the unit:

- Mount self-supporting arm on the housing
- Connect compressed air supply – read more: C1 – Compressed air cleaning system
- Plug the unit to power supply using the cable ended with the plug
- Check all connections status
- Start filter unit with main switch – read more: C2 – Motor control
- Check the rotation direction of the fan (see an arrow on the motor housing)
- Units equipped with timer control compressed air cleaning – read more: C3 and C4

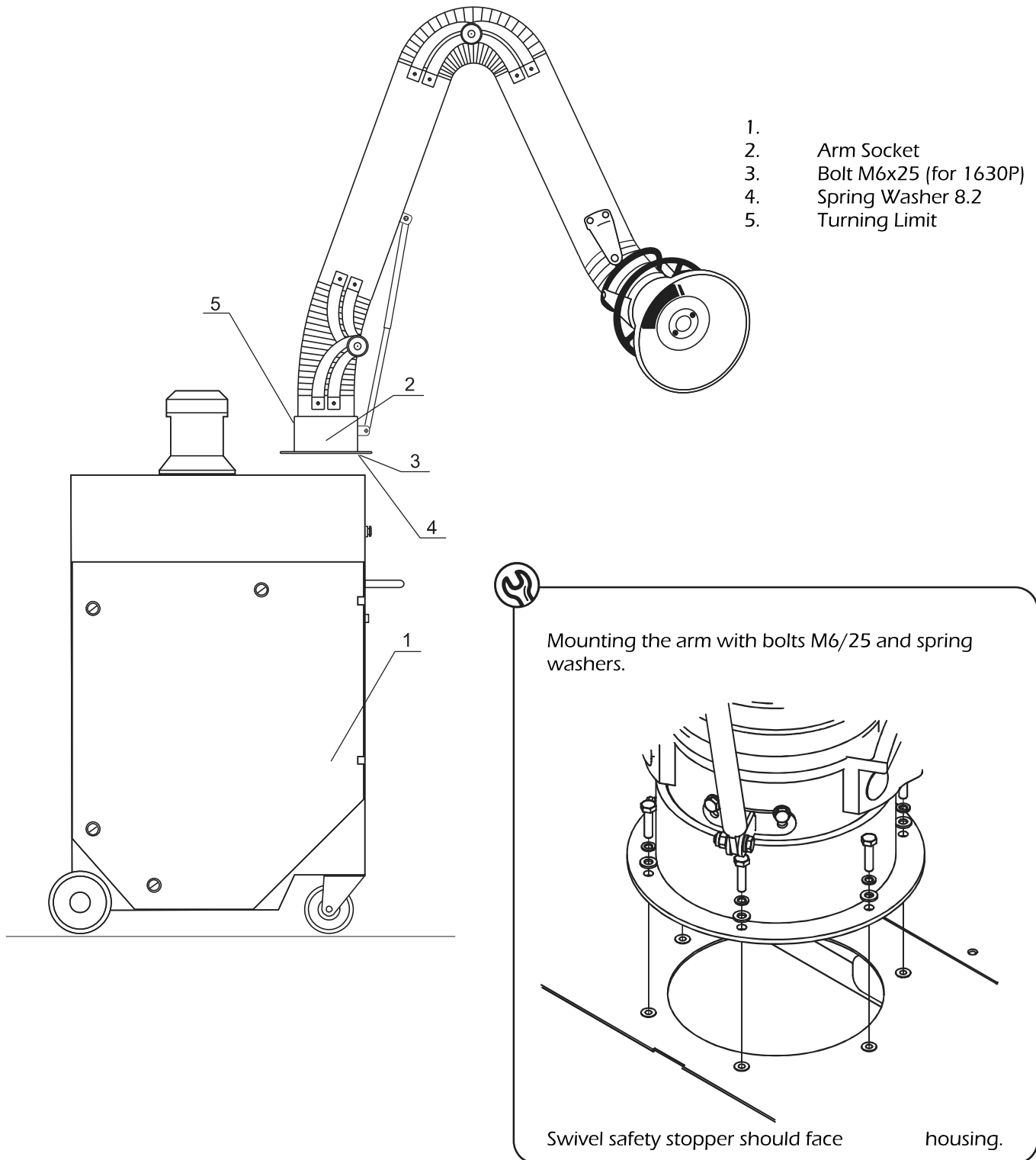



WARNING! Stop the filter unit and disconnect it from power supply before filter change operation.

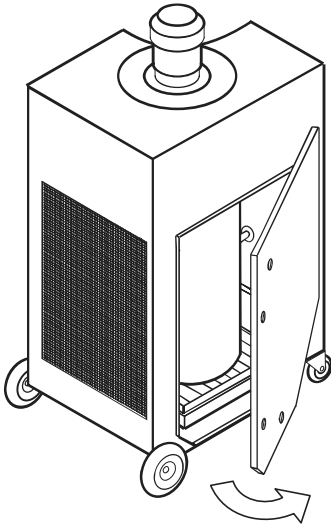

Open the door

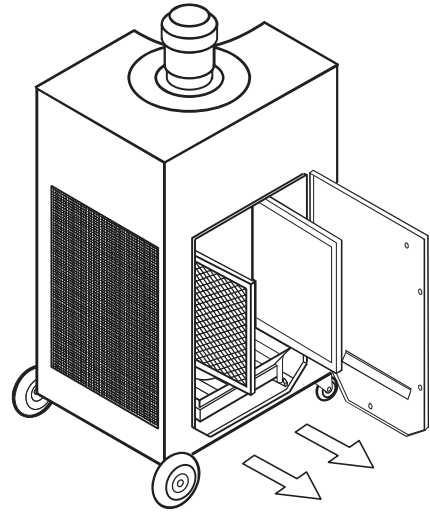

Change preliminary and outlet filter

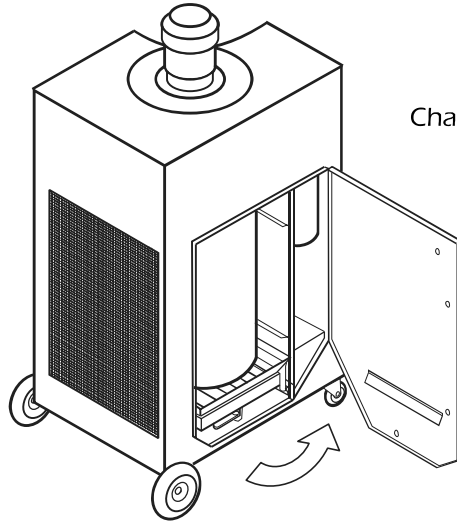

Pull the handle under the dust drawer

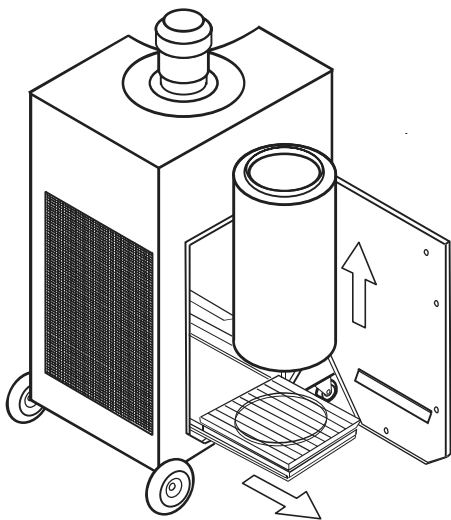

Slide out the drawer and change cartridge

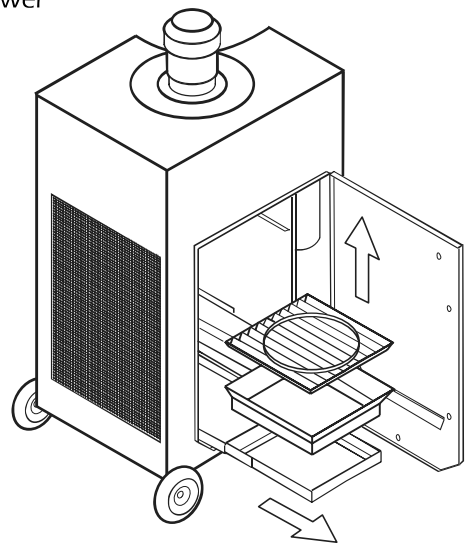

Take out the drawer to empty

- Manual cartridge cleaning is activated with compressed air release button (see the drawing). A pulse of compressed air cleans the cartridge blowing off dust cake built up between cartridge pleats
- Before next compressed air release wait about 5 seconds or until the tank is filled back with compressed air
- Cartridge cleaning is recommended to be performed every time at startup and shutdown and during the work (not less than once every 4 hours).
- Each time when the airflow is significantly low compressed air cleaning is advised

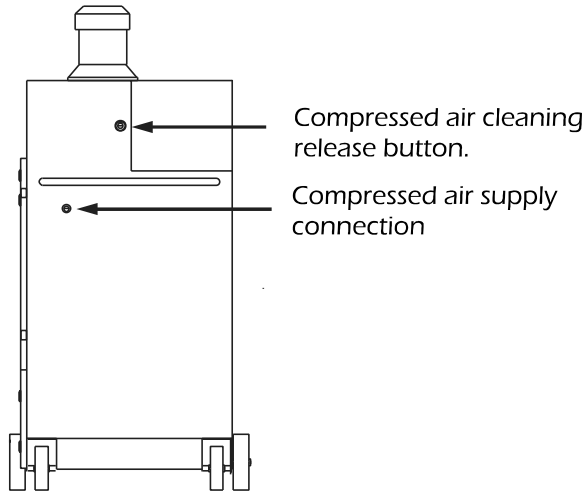
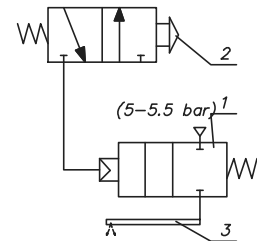
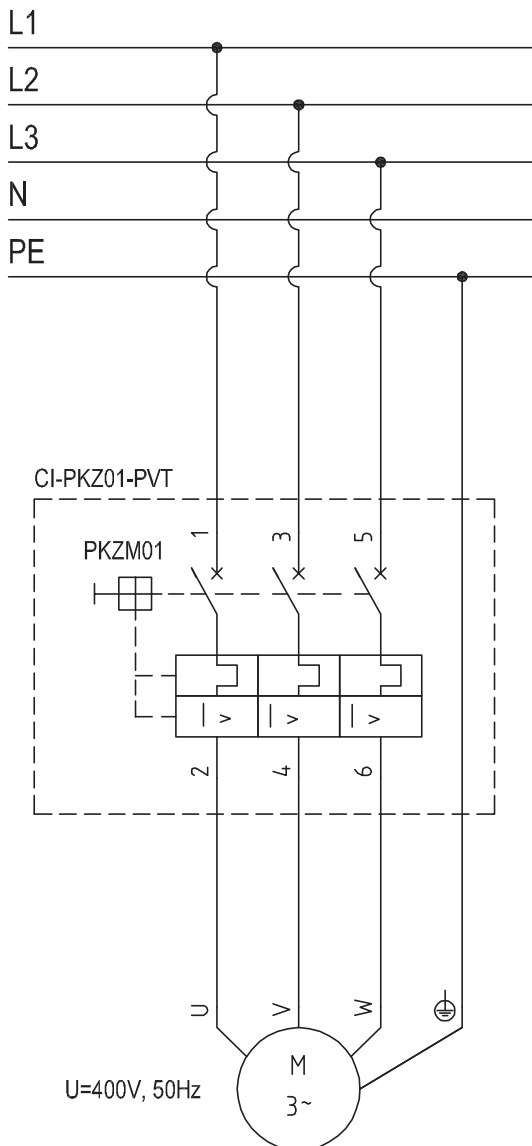

Diagram of pneumatic cleaning system:

1. Pulse valve
2. Push Button
3. Pulse pipe



### Motor Control / Basic Setup



P [kW]	U [V]	f [Hz]	PKZM01	I <sub>N</sub> [A]	1,1 x I <sub>N</sub> [A]
1,1	400	50	PKZM01-4	2,5	2,8

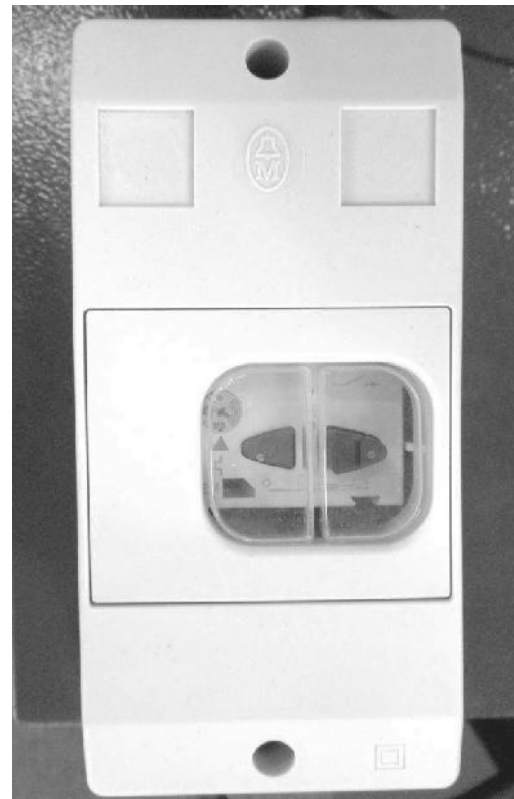

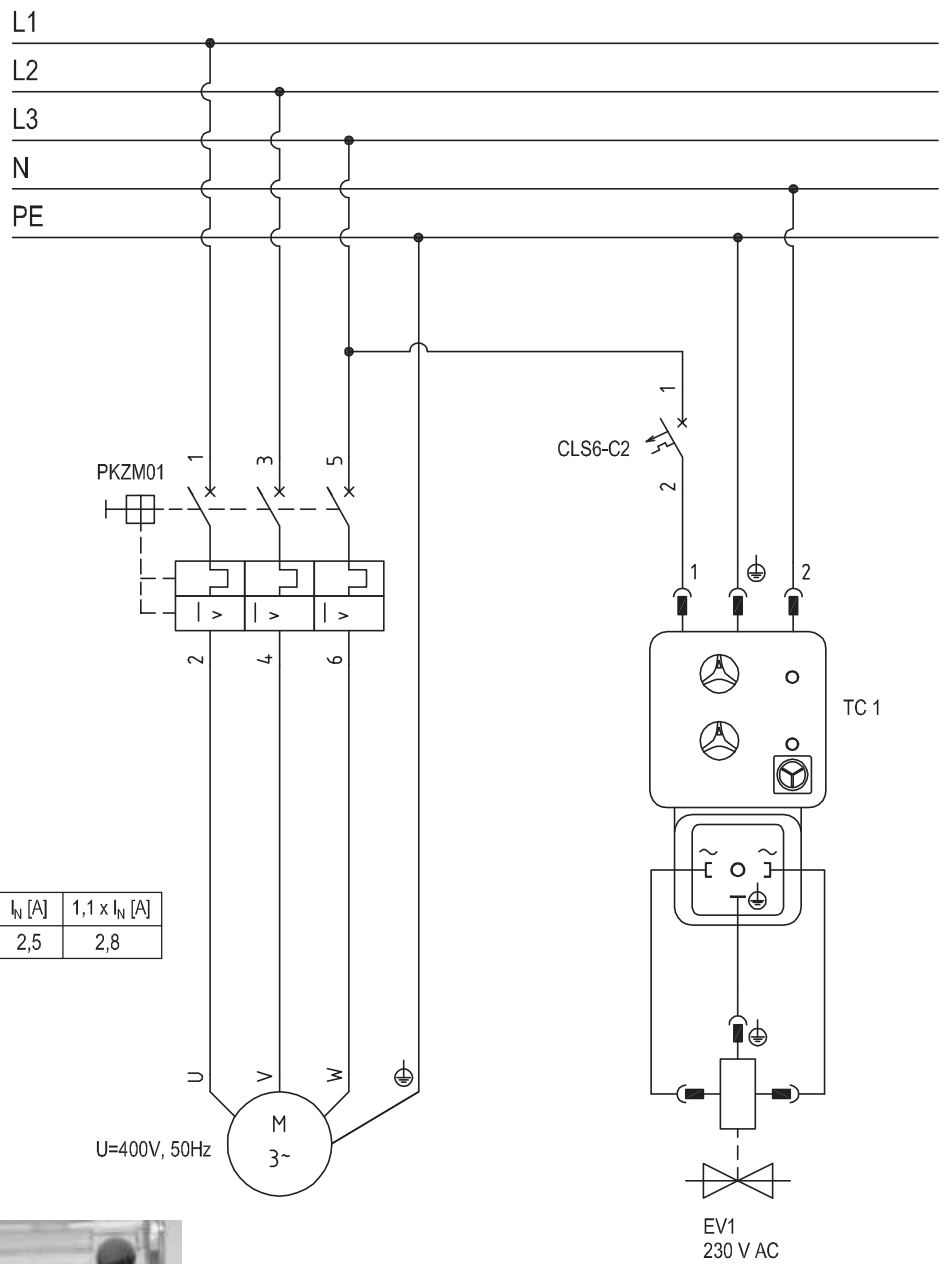

Lp	P [kW]	U [V]	f [Hz]	PKZM01	I <sub>N</sub> [A]	1,1 x I <sub>N</sub> [A]
1	1,1	400	50	PKZM01-4	2,5	2,8

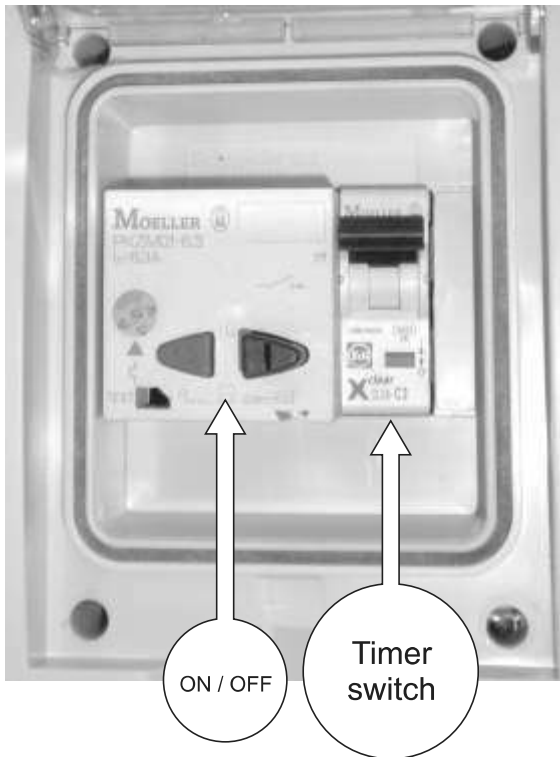

- Compressed air cleaning timer is installed on the pneumatic valve
- Access through the inspection door

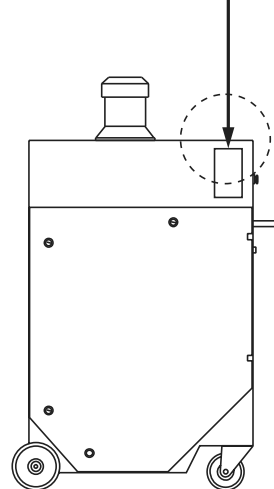



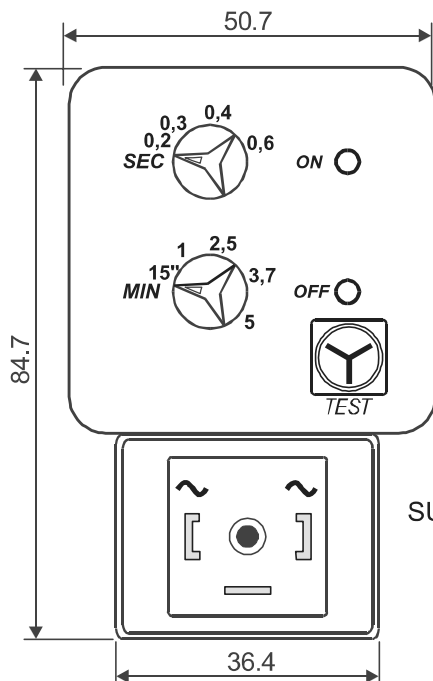
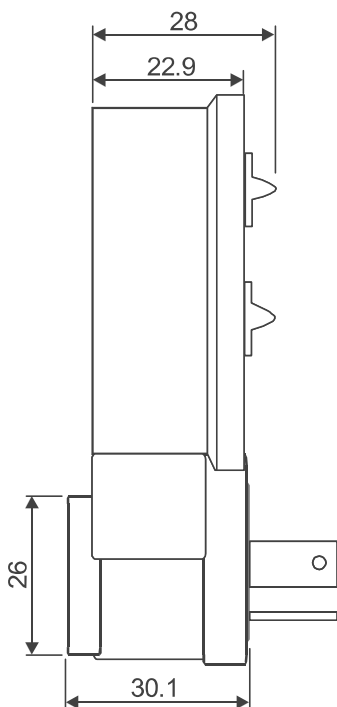

## CICLIC GENERATOR TC01

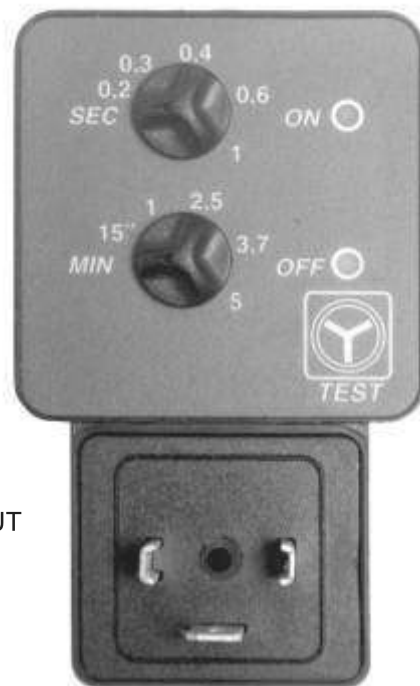

SUPPLY INPUT

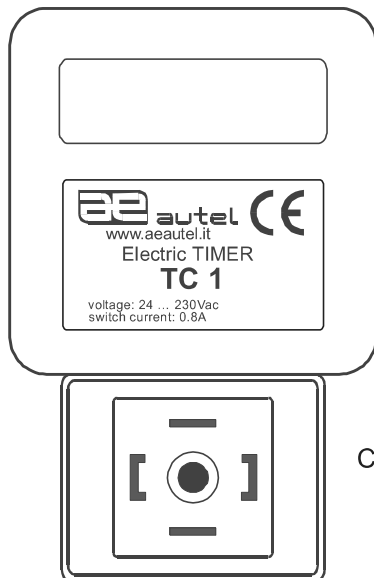

CONNECTOR OUTPUT



### Technical Specifications

- Power supply – 24Vac... 230Vac – 50/60Hz (on demand also 24 ... 230Vac/dc)
- Max. power – 0.8A
- Absorbed power – 2mA (at rest)
- OPERATION time – 0-1 sec / 0-20 sec (+/- 3%)
- PAUSE time – 0-5 min / 0-40 min (+/- 3%)
- Case – Plastic self-extinguishable material (UL94V0)
- Protection level – IP65
- Connections – DIN43650 B connector
- Preservation – 1 fuse = 1 A quick acting

DAILY	MONTHLY	YEARLY
<ul style="list-style-type: none"> <li>• Overall control for any leakage, including the state of door chamber seal and flexible suction pipes or suction arm</li> <li>• Pulse cleaning of dirty filter</li> <li>• Cleaning of waste drawer</li> </ul>	<ul style="list-style-type: none"> <li>• Inspection of the tank of compressed air and pneumatic components</li> <li>• Visual inspection in terms of corrosion</li> <li>• Electrical system control and wire insulation</li> </ul>	<ul style="list-style-type: none"> <li>• Recommended replacement carbon filter and cartridge(s)</li> <li>• Visual inspection in terms of corrosion</li> <li>• Check the ground connection and wire condition</li> </ul>

## Troubleshooting

SYMPTOMS	POSSIBLE REASONS	SOLUTION
Low air volume	Wrong direction of motor rotation	Changes direction on the motor by changing the phases on power supply
	Filter cartridge is clogged	Connect compressed air to the filter, perform the cleaning cycle several times. If this proves ineffective remove the cartridge, wash it with clean water and detergent.
	Compressed air with wrong parameters has being used. Cartridges blocked by moisture or oil	Take cartridge out. Clean and dry. If it doesn't help change to a new one.
Dust coming out of the filter	Wrong sealed or mechanically damaged filter cartridge	Properly tighten the filter gasket. Replace filter cartridge for a new one.
Can not start the device	No power supply	Check the connection of the device, check the power supply.



