



verotti

—Bathroom Culture—

Eternity Intelligent Toilet Suite
Apply to ET.100, ET.200U, ET.ST



ET.100



ET.200U

Add. Building M, 61-65 Roberts Road
Greenacre NSW 2190 Australia Tel:
1300 837 688

Fax: 1300 837 888

Email: info@verotti.com

Website: www.verotti.com

Thank you for choosing Verotti

- Please read the instructions and related illustration carefully before installation and use.
- All products demonstrated in the illustrations are for reference purposes only and actual product may differ from illustrations.
- The company reserves the right to alter, modify or change any product without prior notice.

Please contact us if you have any questions regarding the manual.

Contents

Product Features

Washing	Rear wash	●
	Lady wash	●
	Oscillation massage	●
	Water pressure adjustment	●
	Water temperature adjustment	●
	Nozzle position adjustment	●
Cleaning	Nozzle self-cleaning	●
	Detachable nozzle	●
	Anti-bacterial nozzle	●
	Seat cover quick release	●
	Water inlet filtration	●
Comfort	Soft close seat cover	●
	LED, Night light	●
	Instant water heating	●
	Rotary knob control	●
	Remote control	●
	Descaling	●
Cert.	WMK AS.1172.2	●
	IPX4	●
	CE	●
	RoHS	●

Before use

Chapter 1 Safety Precautions	2
Description of Symbols	2
Safety precautions	2
Cautions in use	7
Chapter 2 Product Overview	8
ET.ST bottom inlet	8
Remote control button overview	10

Instructions

Chapter 3 Operation Instructions	12
Initialization operation instructions	12
Rotary knob operation instructions	16
Side button instructions	17
Remote control operation instructions	18



Cleaning and Maintenance

Chapter 4 Cleaning and Maintenance	24
Seat cover cleaning	24
Nozzle cleaning	24
Remote control cleaning	25
Deodorant box cleaning	25
Descaling	26
Product maintenance	27
Chapter 5 Troubleshooting	28
Chapter 6 Technical Data	32



Chapter 1 Safety Precautions

To ensure that you can enjoy the intelligent toilet, please read the “Safety Precautions” carefully and comply with it. Please keep the user manual properly. If the product needs to be transferred to others, please be sure to attach this manual. The cautions listed below are important to safety and must be adhere.

Description of symbols

 Warning	Indicates that if you ignore this icon while operating, it may cause serious injury or death.
 Caution	Indicates that if you ignore this icon while operating, it may cause personal injury or property loss.

The following symbols are important safety cautions when using the product:

Symbol	Identification
	Mandatory content that must be executed
	Prohibited

Safety Precautions

Warning

Make sure the power cord is not damaged. If it is damaged, it must be replaced by the manufacturer, agent or professional so as to avoid danger. The power cord cannot be jammed or squeezed. Keep the power cord away from hot surfaces and sharp edges. Do not use the device while it is not working properly. Immediately disconnect off the power supply, close the inlet angle valve, stop the water supply.

contact the customer service hotline to avoid product failure and damage caused by improper use.

Persons with disabilities and those with limited experience or common sense (including children) are required to use this product under the supervision of a responsible person.

This product must be connected to the cold water supply (inlet water temperature is approximately 4~35 °C), otherwise the machine scald or malfunction.

When an abnormality or malfunction occurs, immediately turn off the power, close the inlet angle valve, and stop using it.

Abnormal, fault conditions such as:

- Product crack or damage
- Product smoke emitting
- Abnormal sound and burning smell
- Product abnormal heating
- Water seepage from pipes and product

Continue to use the product regardless of the fault, which may lead to electric shock, fire, injury or indoor seepage.

Do not grab the cover or the seat to pick up the product.

Do not open the cover or seat when there are items on it.

Otherwise the product may be damaged, resulting in injury.

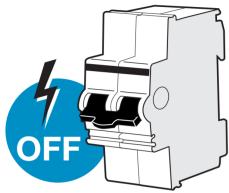

Turn the Power off

Ensure power is off prior to any cleaning or maintenance. Failure to do so may cause electric shock.



Connect the ground wire

Check the power socket whether grounded or not. This product must be well grounded. Can only be connected to the dedicated 220V-240V, 50/60Hz, 10A with ground fault circuit breaker or ground leakage protector circuit.



Mandatory

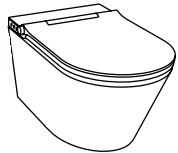

If the power cord is damaged, it needs to be replaced. To avoid danger, please observe the following: Please contact the retail store where you purchased this product or the nearby customer service center. It must be replaced only by the manufacturer, its service department or an authorized professional.



Prohibit water soaking

Do not spray water or detergent on the toilet seat unit and power plug. It may cause product damage, fire, or electric shock.



Prohibited

Do not use the following items to clean the product: gasoline, banana water, benzene, paint thinner, decontamination powder and nylon brush. It may damage the inlet pipe or product.

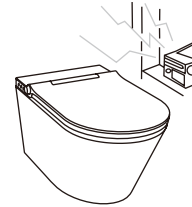

Prohibited

Keep away from the product when using the radio.







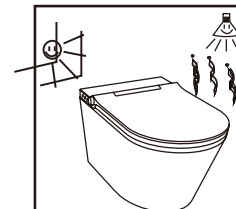

Prohibited



Do not install the product in a room where frost may develop. Indoor temperature shall not be less than 4 °C. In order to prevent product freezing or damage.

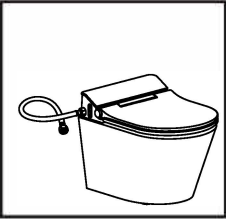

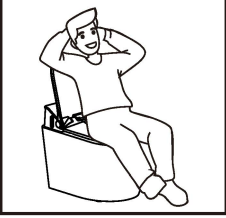
Prohibited

Do not expose the product directly to water, strong light or sunlight. It may cause fading.

 Caution	
	 <p>Do not bend or twist the inlet hose.</p> <ul style="list-style-type: none"> ● It may cause water leakage.
	 <p>Do not use the following items to clean the product: Gasoline, banana water, benzene, paint thinner, cleanser and nylon brush.</p> <ul style="list-style-type: none"> ● It may damage the inlet pipe or product.
	 <p>Keep away from the product when using the radio.</p> <ul style="list-style-type: none"> ● It may cause interference.
	 <p>Do not lean on the seat cover.</p> <ul style="list-style-type: none"> ● It may damage the seat cover and cause personal injury.
	 <p>Do not use a DC or AC power supply that is not 220V-240V.</p> <ul style="list-style-type: none"> ● It may cause product failure.

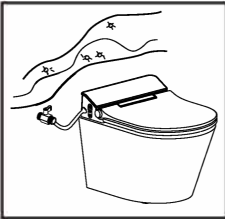
 Caution	
	 <p>Do not connect any wastewater, mixed water, industrial water, sea water or other untreated or semi-treated water.</p> <ul style="list-style-type: none"> ● It May cause skin infection or malfunction.

Cautions in use

The cold water shall be connected from the main water supply pipe. Please use the new hose assembly supplied with this product, the old hose assembly cannot be reused.

The water pressure of this product is: 0.05Mpa - 0.75Mpa
Make sure the electrical junction box is securely fixed on to the wall before installation.

If the toilet is moved from a lower temperature to a higher temperature, condensation moisture may occur. Please turn off the device for a few hours before use.

Do not intentionally soil, spray or block the cleaning nozzle.

Repair work must be performed by relevant professionals.
Do not use accessories that are not recommended by this manual.
The battery type for this product is button battery with specification CR2032.

If the battery acid leaks, do not touch the skin, eyes and mucous membranes.

If you accidentally come into contact with the acid, flush the affected area with plenty of water and seek medical attention immediately. Keep the battery out of reach of children. If swallowed, it can be life threatening. If the battery has been swallowed, get medical attention immediately.

Chapter 2 Product Overview

ET.ST bottom inlet

Bottom view

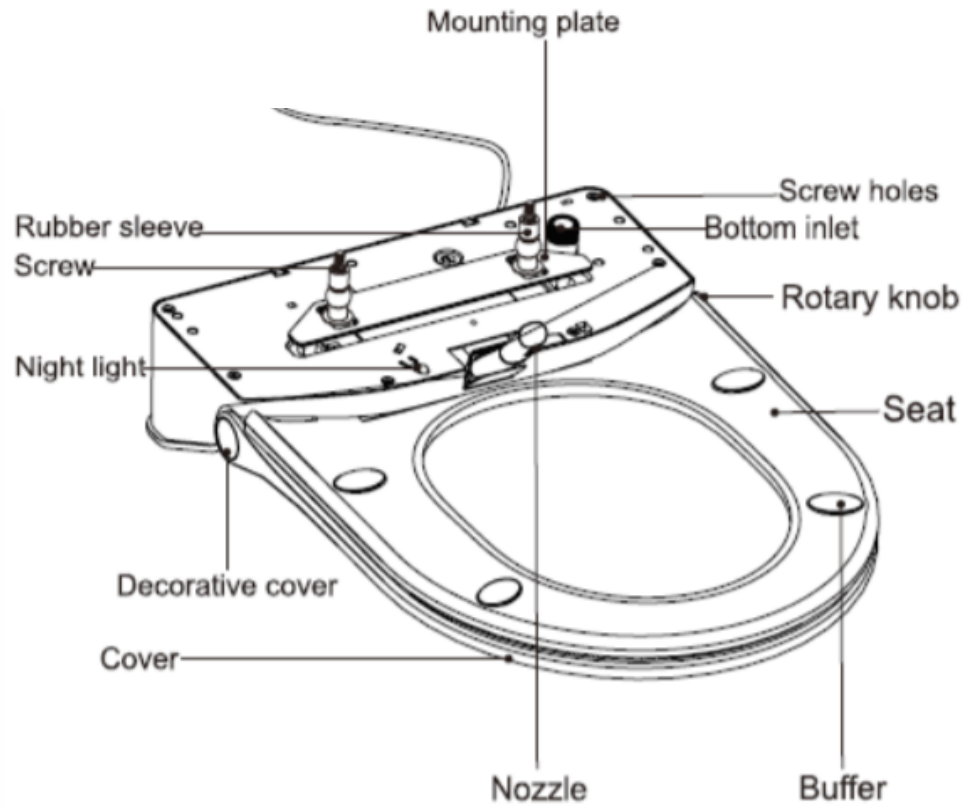

Front view

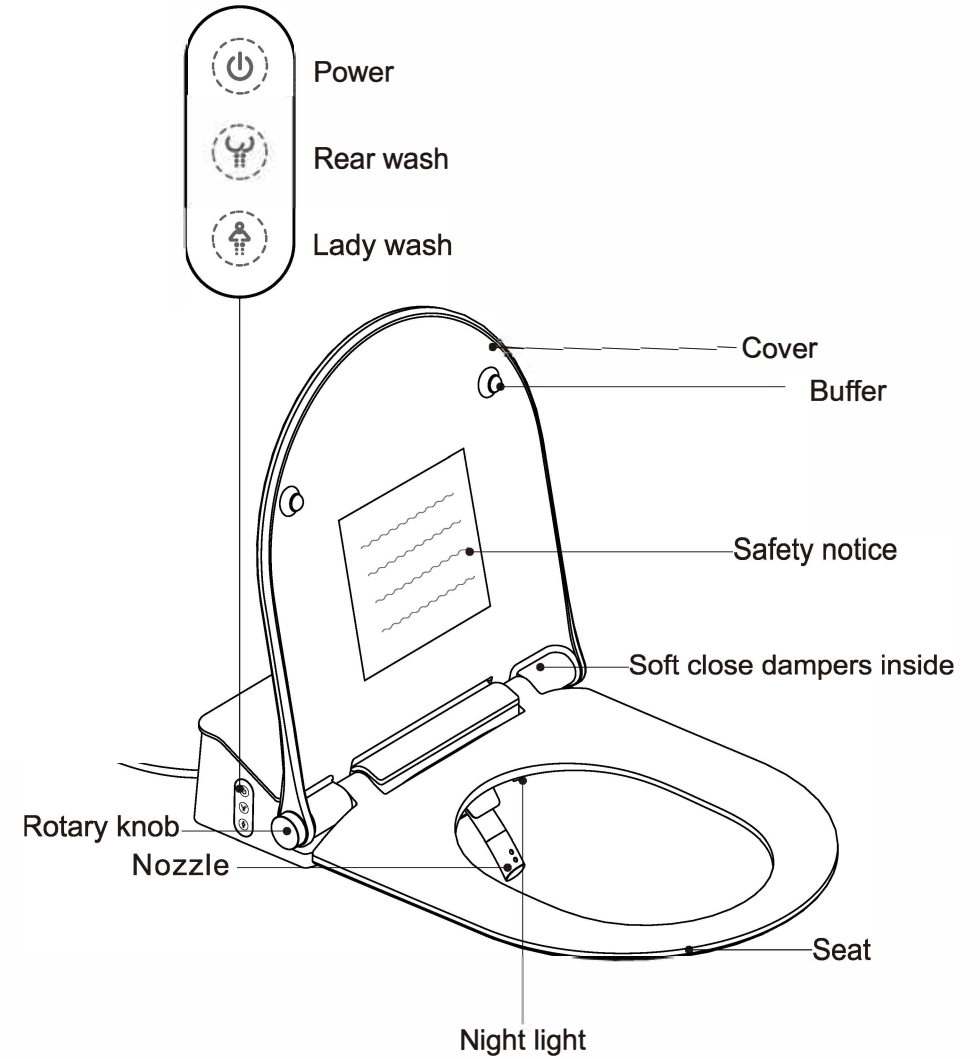

Remote control button overview

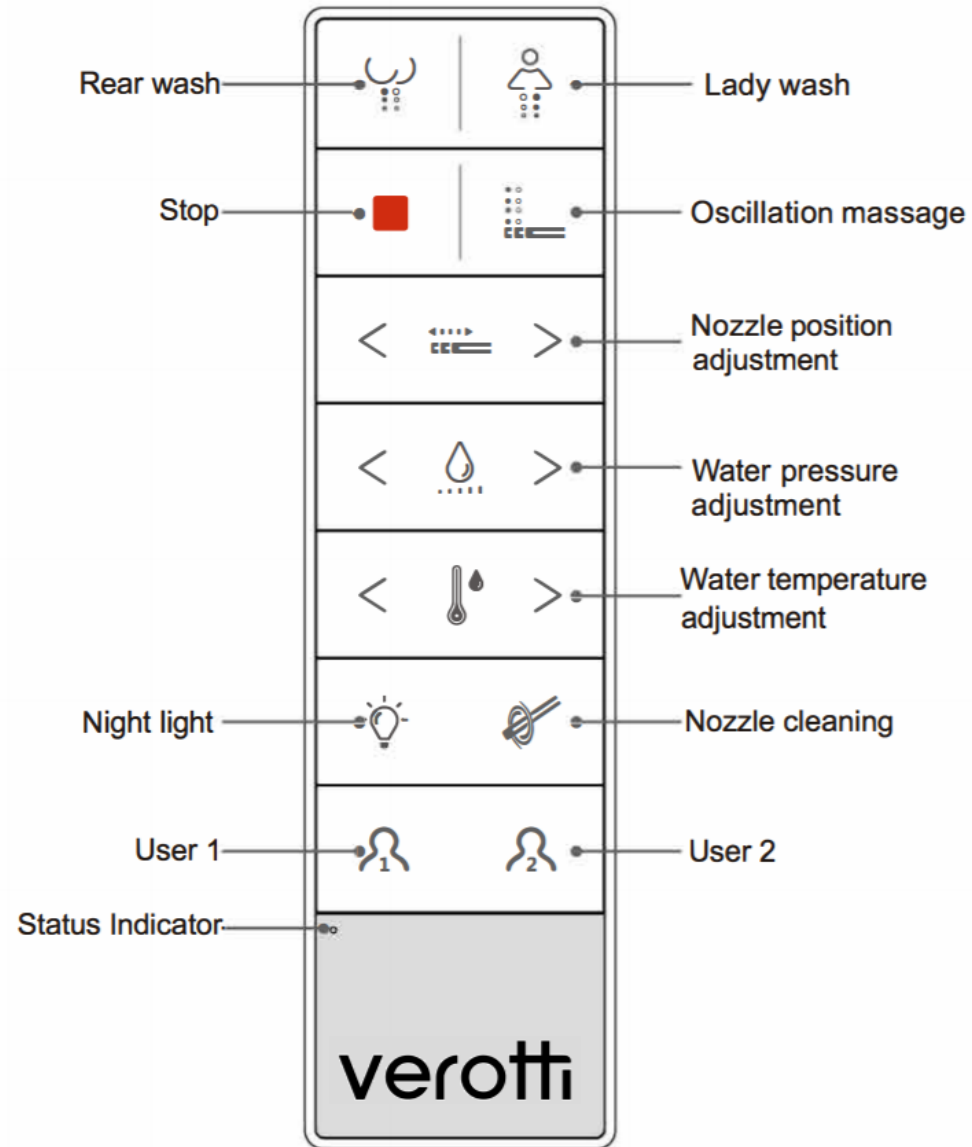

(See pages 18-23 for details of each button function)

Chapter 3 Operation Instructions

Initialization operation

1. Install the remote control battery

1 Take down the remote from the bracket

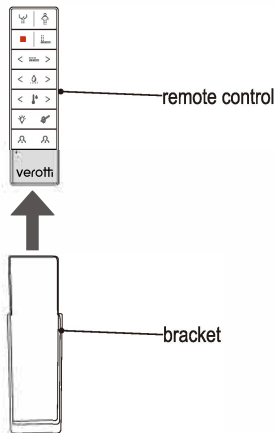

2 At the arrow position on the back of the remote control, pull it up forcefully and open the front battery cover as below

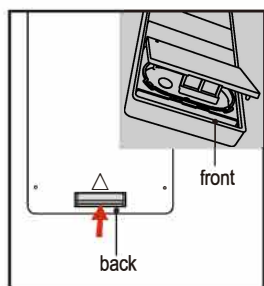

3 Install two CR2032 button batteries, note that the battery is printed with + CR 2032 3V on the positive side of the battery

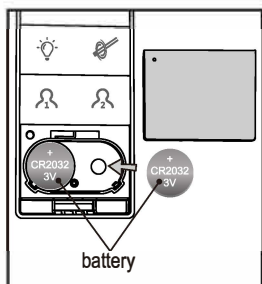

● After the battery is properly installed, the remote control indicator will lighten 2 seconds.

4 Buckle the battery cover and finish the installation

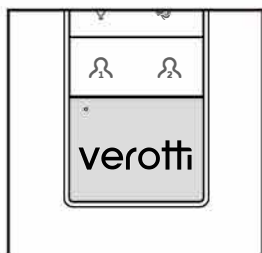

● About dry battery
Be sure to use alkaline batteries.
To prevent the battery from rupturing or leaking, please adhere the "Cautions in Use". (page 9)

2. Match code

1 Press the "Stop" button until the remote control status light flashes (make sure the toilet power switched off before matching).

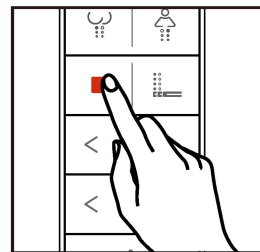

2 Turn on the power of the Machine, the light is on, it will start "Initiali-zation" for 15 seconds. After one beep sound and the light off, the code was matched.

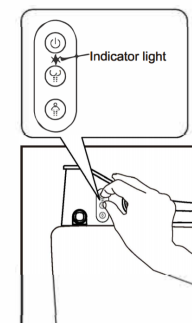

If the code matching is unsuccessful, the indicator will automatically off after 30 seconds. Try again as described above. If it is still unsuccessful, please consult professional staff.

3. Install the rotary knob battery

1 Pull the rotary knob as shown.

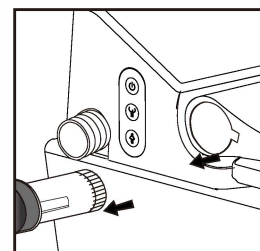

2 Open the battery cover and insert the battery into he battery hole. Note that the battery positive pole printed with CR 2032 3V facing up, as shown.

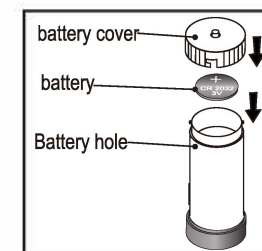

3 Put the rotary knob aligned with the positioning slot, as shown.

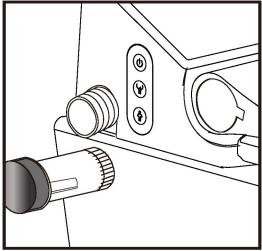

4 Complete the installation.

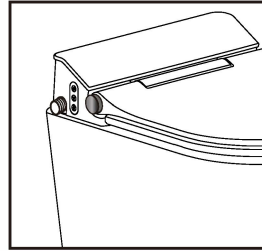

4. Turn on the main power

1 Turn on the main power of the power distribution box and confirm that it is powered on.

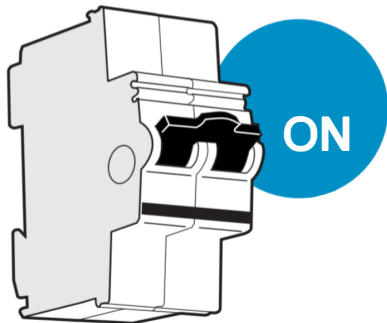

2 Confirm the power light on the toilet side button is on.

● If not, press it

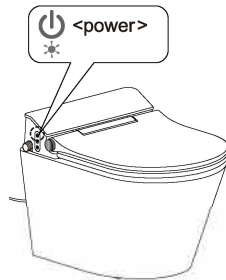

5. Turn on the inlet angle valve and confirm that the tap water is connected

1 Completely turn on the inlet angle valve

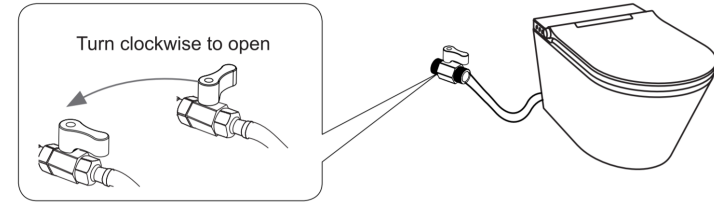

6. After normal charged, it is automatically in the power-on state

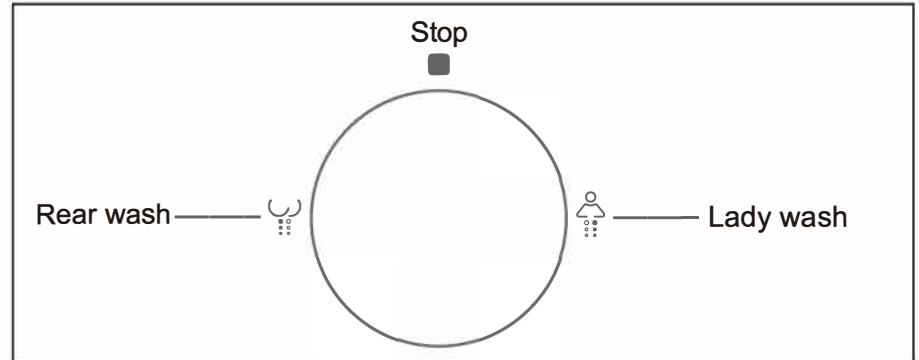

7. Rotary knob re-code matching

If the knob remote control does not work properly after use, you can re-code matching, the specific method is as following:

1 Press the "Power" and "Rear wash" button at the one time. When you release it, you hear a long "beep" from the machine, and the machine is ready for code matching (if there is no beep, it may be due to different pressing, you can try again.)

2 Press and hold the "Rotary knob" until you hear a long beep, which means that the code is successfully matched. If it is unsuccessful, try again according to the above steps; if it is still unsuccessful, please consult the after-sales serves.

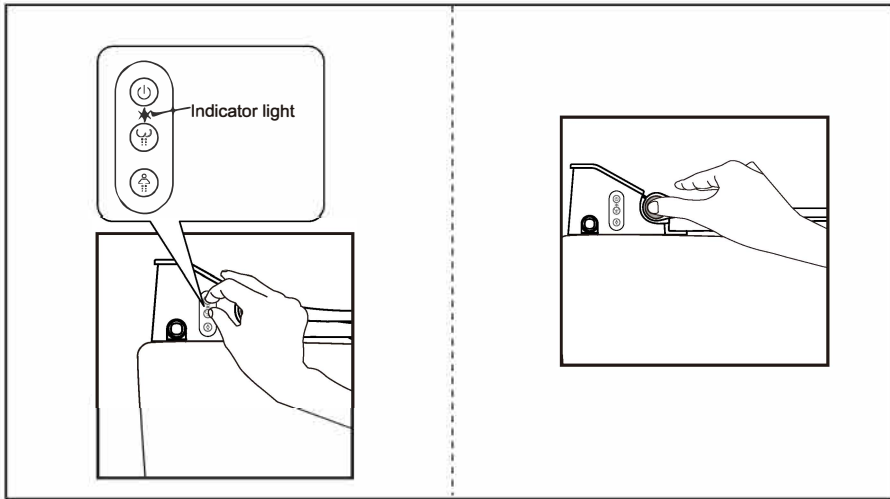

Rotary knob operation instruction

<p>Rear wash</p>	<p>Lady wash</p>
<p>Water pressure Stop</p>	<p>Water pressure Stop</p>
<p>1. Under the condition of seat induction, after rotate backward the rotary knob, beeping shortly, nozzle stretched, and the [Rear wash] function is activated</p> <p>2. Under the washing condition, rotate forward and backward the rotary knob to adjust the water pressure. Rotate forward, the water pressure rises and vice versa.</p>	<p>1. Under the condition of seat induction, after rotate backward the rotary knob, beeping shortly, nozzle stretched, and the [Lady wash] function is activated.</p> <p>2. Under the washing condition, rotate forward and backward the rotary knob to adjust the water pressure. Rotate forward, the water pressure rises and vice versa.</p>

A beep sound means a grade, with total of 5 grades; two beeps sound means highest grade or lowest grade.

3. Fixed washing cycle is 3 minutes, and stopped automatically, or press and hold rotary knob to stop.

A beep sound means a grade, with total of 5 grades; two beeps sound means highest grade or lowest grade.

3. Fixed washing cycle is 3 minutes, and stopped automatically, or press and hold rotary knob to stop.

Side button instructions

<p>Power</p>	<p>Press the power button to turn on / off.</p>
<p>Rear wash</p>	<p>Press the "Rear wash" button, the Rear wash is activated, the nozzle is extended, and the function is activated. Press the "Rear wash" button again or press the stop button on the remote control to stop, or it will stop automatically after 3 minutes.</p>
<p>Lady wash</p>	<p>Press the "Lady wash" button, the Lady wash is activated, the nozzle is extended, and the function is activated. Press the "Lady wash" button again or press the stop button on the remote control to stop, or it will stop automatically after 3 minutes.</p>

Remote control operation instructions

The toilet is operated with a rotary knob and a remote control. Press the corresponding button on the remote control to activate the related function. The remote indicator will light up briefly.

Stop

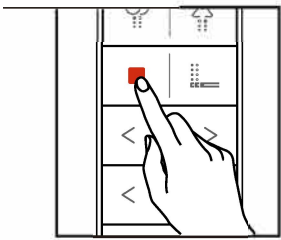

In any case, "Stop" is the button with the highest priority, can stop the current function after pressing.

When more than 2 button presses, the first button press is valid.

Rear wash

Press the "Rear wash", the indicator light turns on, the system buzzer beeps and the rear wash function starts.

1 The indicator light is on, "Rear wash" is activated, and the nozzle is slowly extended.

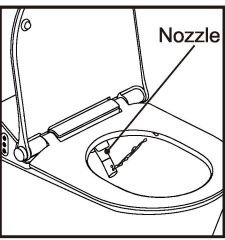

2 Press ">" in the nozzle position adjustment to move the nozzle forward; Press "<" to move the nozzle backward.

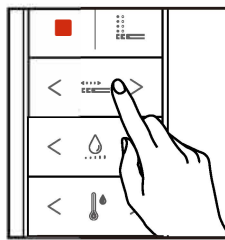

3 Press ">" in the water pressure adjustment to increase the water intensity; press "<" to decrease the water.

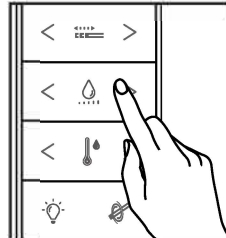

4 Press the "Stop" button to stop the "Rear wash" or wait for 3 minute to stop automatically.

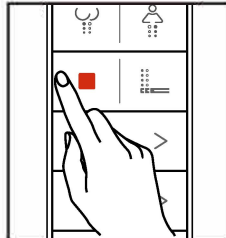

Lady wash

Press the "Lady wash" button, the indicator light turns on, the system buzzer beeps and the lady wash function starts.

1 The indicator light is on, "Lady wash" is activated, and the nozzle is slowly extended.

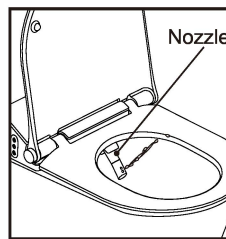

2 Press ">" in the nozzle position adjustment to move the nozzle forward; Press "<" to move the nozzle backward.

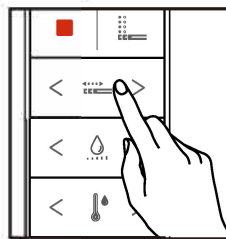

3 Press “>” in the water pressure adjustment to increase the water intensity; press “<” to decrease the water.

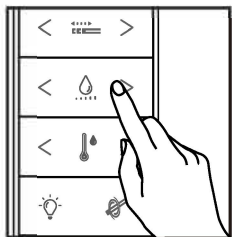

4 Press the “Stop” button to stop the “Lady wash” or wait for 3 minutes to stop automatically.

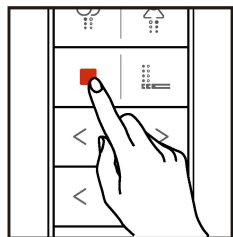

Oscillation massage Press “Oscillation massage”, the nozzle will move back and forth when using the cleaning function.

Condition: Rear wash or Lady wash function have been activated.

1 “Oscillation massage” is activated and the nozzle moves back and forth.

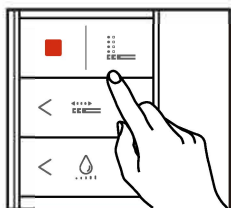

2 Press “Oscillation massage” again to stop and switch back to Rear wash/Lady wash, or wait for 3 minutes to stop automatically.

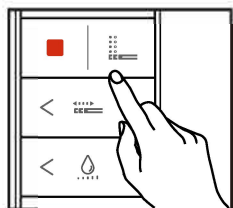

Nozzle position adjustment

There are 5 grades of the “Nozzle position adjustment”. The default setting is grade 3.

Condition: Rear wash or Lady wash function have been activated.

1 Press the left arrow “<” to retract the nozzle backward.

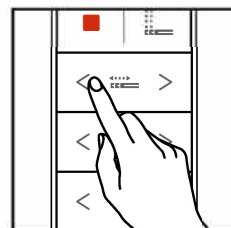

2 Press the right button “>”, the nozzle extends forward.

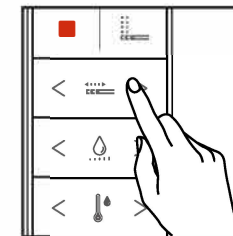

Water pressure adjustment

There are 5 grades of “Water pressure adjustment”. The default setting is grade 3.

Condition: Rear wash or Lady wash function have been activated.

1 Press the left button “<” to downshift and the water intensity will decrease.

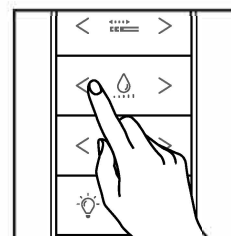

2 Press the right arrow “>” to up-shift, and the water intensity will increase.

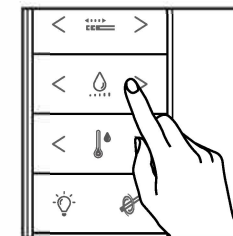

Water temperature adjustment

There are 5 grades of “Water temperature adjustment”. The default setting is grade 3

- 1** Press button “<”, the temperature will fall

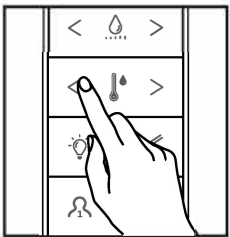

- 2** Press arrow “>”, the temperature will rise

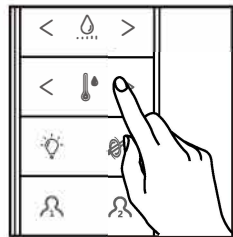

 **Night light** Turn on/off Night light
The default is turn on

- 1** Press the “” button, the indicator light is on and the night light is on.

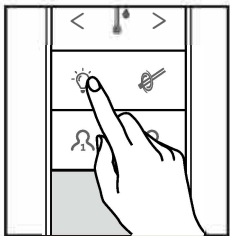

- 2** Press the night light again to turn it off.

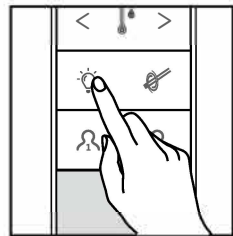

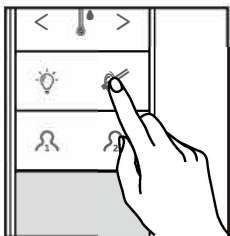

 **Nozzle self clean** Turn on/off Nozzle self-clean

- 1** Press the “” button, the indicator light is on and the nozzle cleaning is on.

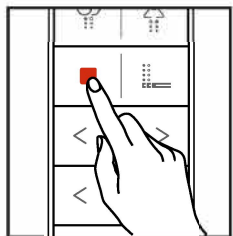

- 2** Press the stop button to stop.



 **User 1** User setting storage
Turn on/off “User Preset 1”

Parameters such as nozzle position, water pressure adjustment, water temperature adjustment, night light, and nozzle self-cleaning can be stored and recalled.

- 1** Long press for more than 5 seconds to save the current user setting as “User Preset 1”.

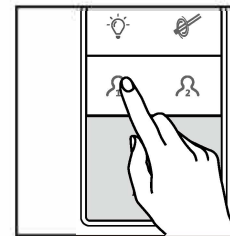

- 2** Short press this key to activate the user parameter “User Preset 1”.

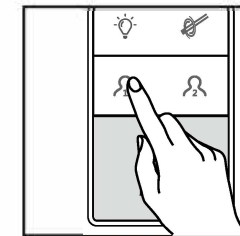

 **User 2** User setting storage
Turn on/off “User Preset 2”

Parameters such as nozzle position, water pressure adjustment, water temperature adjustment, night light, and nozzle self-cleaning can be stored and recalled.

- 1** Long press for more than 5 seconds to save the current user setting as “User Preset 2”.

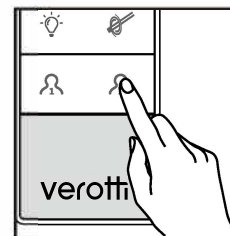

- 2** Short press this key to activate the user parameter “User Preset 2”.

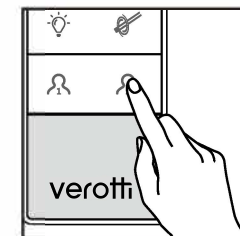

Chapter 4 Cleaning and Maintenance

Seat cover cleaning

Clean the toilet body regularly, or immediately clean after getting dirty. If cleaning is not performed frequently, the dirt may become noticeable, resulting in stubborn dirt.

Always turn off the power before cleaning the surface of the product.

Do not allow water or detergent to enter the product or the power plug, as this may cause short circuit, electric shock, or fire.

Notice color fading, yellowing or paint peeling off due to improper cleaning.

Do not use abrasive cleaners or cleaners with chlorine or acids.

Only use special detergent and device in this field.

Follow the detergent manufacturer's instructions.

Forbid to mix detergents.

Wipe with a soft cloth soaked in water and wrung out.

A neutral soap solution is the ideal daily cleaner.

Nozzle and sprayer clean

The retracted nozzle is automatically cleaned by the toilet before and after using the cleaning function.

Manually cleaning nozzles and sprayer

Clean the sprayer of the nozzles regularly or as soon as dirt is found.

1 Press and hold the "Stop" button to ensure the toilet is in standby mode.

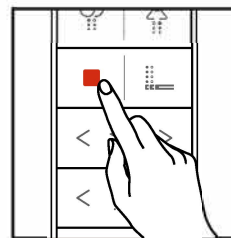

2 Press the "Nozzle self clean" button.

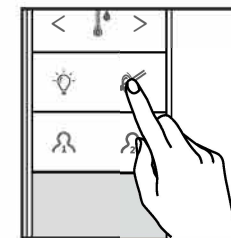

3 Nozzle extends without spraying water; remove the nozzle and clean the nozzle with a cloth, sponge or brush and neutral detergent.

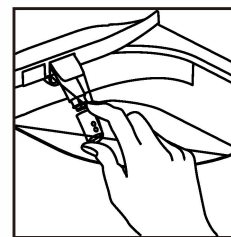

4 Press the "Stop" button to stop cleaning and the nozzle will retract.

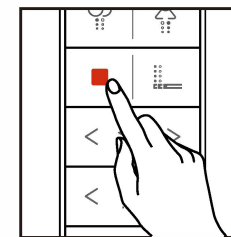

Filter cleaning

When the user feels that the water pressure is less than as usual during use, the filter valve can be disassembled and the filter can be cleaned with a brush. The product must be completely separated from the water supply hose during cleaning.

Remote control cleaning

Clean the remote control and bracket with a soft, damp cloth.

Descaling

Descaling instruction

When the machine needs to be descaled, the reminder are as follows:

1. The night light flashes. 2. The sound prompts three times ,once every 10 seconds.

Remark: The system will not remind when it is not in use.

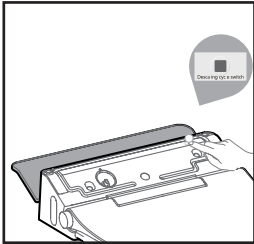

- Press the descaling key, tank start to drain.
- During drainage the nozzle self-clean, accompanied by drops...beeping noise.
- If Incorrect operation to open the drainage, machine will power off and re-start.

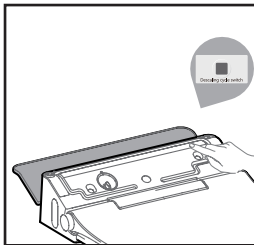

Press the descaling key, start descaling cycle.

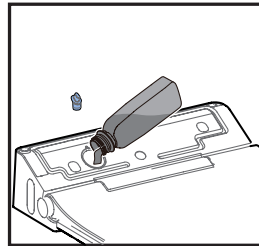

- Add the descaling liquid after the water tank is drained and the nozzle self-clean off. (recommended coffee machine descaling liquid).
- Add the maximum descaling capacity: $V_{max} \leq 100ml$.

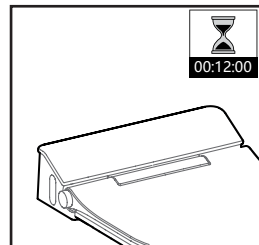

After 12 minutes, the descaling is completed and all function can be used normally.

Remote control cleaning

Clean the remote control and bracket with a soft, damp cloth.

Waste disposal

Electronic equipment may contain hazardous or dangerous substances. Do not discard it as unsorted household waste. Please send it to the designated collection spot. In this way, you can contribute to resource conservation and environmental protection. Contact your retailer or local authorities for more information.

Used batteries must be disposed of properly. Therefore, battery recycling bins with corresponding labels are available in stores and community collection stations where batteries are sold.

To avoid possible suffocation or danger, do not let children play with plastic bags and product packaging. Please keep such packaging materials in a safe place or discard them in an environmentally friendly manner. If possible, keep the packaging materials until the end of the warranty period.

Product maintenance

In the following cases, please close the inlet valve and remove the hose to drain the water.

- Water may freeze in cold areas.
- When not used for a long time.

It may cause skin infection due to deterioration of residual water.

1 Turn the power off.

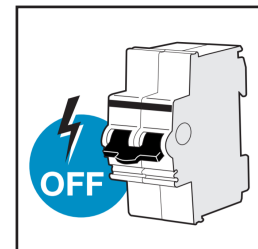

2 Close the valve and stop supplying water to the system.

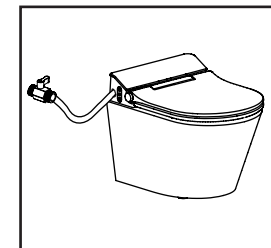

Chapter 5 Troubleshooting

Recommendation: Initial basic operation in case of failure

Turn off the main power of the product, and then turn it on again after at least 3 hours.

If your device still does not work properly after following the instructions described below, please contact your company's customer service center or your dealer.

Problem	Potential cause	Solution
Basic function		
Function does not work at all	Power failure	Please wait for power restoration of electricity
	Plug loose or out of touch	Please plug in to ensure the power is restored
	The leakage protection button of the power cord is not turned on	Please press the leakage switch of the power cord
	In standby mode	Switch to power mode
Water leakage	Malfunction	Close the water supply Disconnect the power Call Customer Service Hotline
Remote control		
During operation, the indicator light of remote control keeps flashing	Low battery indication	Change the battery

Problem	Potential cause	Solution
The remote does not work	No battery inserted	Load the battery
	Run out of power	Replacement battery
	Wrong load of positive and negative	Load the battery correctly
	Defective remote control	Call Customer Service Hotline

 Warning	<p>Do not disassemble, repair or modify the product by yourself. It may cause electric shock, fire or malfunction.</p>
--	--

Problem	Potential cause	Solution
Rear Wash/Lady Wash		
It takes slightly long to switch between rear wash and lady wash	When switching between rear wash and lady wash, the spray wand needs to be retracted and self-cleaning before extend again.	Normal
Cleaning nozzle does not extend	Water inlet hose bent	Exclude water hose bending Call Customer Service Hotline

Problem	Potential cause	Solution
The cleaning water does not spray out	Water supply was cut off	Please wait for water supply to be restored
	Inlet angle valve is not open or is blocked by dirt	Open or clean the inlet angle valve
	Water inlet hose bend	Exclude bending water hose Call Customer Service Hotline
	Nozzle blocked	Clean nozzle
Abnormal water spray	Abnormal operation malfunction	Power on again after unplugging for one minute Call Customer Service Hotline
Water spray intensity is too weak	Water spray intensity has been set to "1st" grade	Adjust the water spray intensity to 2nd, 3rd, 4th or 5th grade
	Nozzle blocked	Clean nozzle
	Inlet water filter blocked	Cleaning the decompression valve filter
	Inlet hose deformation	Call Customer Service Hotline
The water temperature is not high enough	Water temperature has been set to "Off" or "1st" grade	Set the water temperature to 2nd, 3rd, 4th or 5th grade
Water temperature is too high	Water temperature has been set to "5th" grade	Set the water temperature to 1st, 2nd, 3rd or 4th grade

Problem	Potential cause	Solution
Nozzle suddenly stop spraying	The function stops automatically after 3 minutes	Normal
Retracted nozzle drips water	The nozzle is automatically cleaned before and after the cleaning function	Normal

In the following cases, be sure to contact the service center.

- After replugging the power, the indicator light on the seat cover is still blinking. (Please unplug)
- After replugging the power, the indicator light on the seat cover is still off.
- When emitting smoke or occurring abnormal sound. (Please unplug the power)

Chapter 6 Technical Data

Model	ET.ST INTELLIGENT SEAT	
Water inlet	G 1/2	
Applicable voltage	AC220-240V, 50 / 60HZ 1300W	
Power	2m	
Power cord length	70 - 500kpa	
Applicable water pressure range	4 ~ 35 °C	
Applicable water temperature	4 ~ 40 °C	
Applicable ambient temperature	IPX4	
Waterproof level	350 ~ 650ml / min	
Flushing device	Flush flow	31 ~ 39 °C
	Flush water temperature	3 minutes
	Flush cycle	Instant
	Warm water heating method	1400W
	Max heating power	Temperature fuse, level switch,
	Safety devices	thermostat Anti-siphon valve, air cutoff Leakage Protection
	Anti-backflow device	4.6kg
Other safety devices	510*362*95mm	
Product net weight		
Size		

The final explanation right of this instruction belongs to VEROTTI PTY LTD.

Specifications are subject to change without notice.

Service Card			
Product model			
Factory number		Purchase date	
Dealer		Telephone	
City	Province	Country	Dealer's stamp
<p>Maintenance regulations</p> <p>1. In accordance with the instructions and cautions in use, if a failure occurs after normal use, maintenance will be performed free of charge during the warranty period.</p> <p>2. Please contact the company's customer service center or the seller for repairs due to failures during the warranty period, and show the maintenance service card.</p> <p>3. Although it is under warranty, the following conditions will be charged for maintenance.</p> <ul style="list-style-type: none"> • Failures due to carelessness or negligence in use, and failures due to improper repair or modification. • Failures or damages due to moving installation location. • Failures and damages caused by fire, earthquake, flood, lightning, and other natural disasters, pollution, or abnormal voltage. • Failures and damages caused by the use of unspecified power sources (voltage, frequency). • Used for purposes other than general domestic use, malfunctions or damage. • This service card cannot be provided. • When the seller, the installation date, and the seal of the dealer are not filled in this service card or the contents are modified without authorization. <p>4. This service card is no longer issued, please keep it properly.</p>			

About service

Customer rights

Customers have the right to get maintenance free of charge if a failure occurs within one year from the date of purchase.

However, if the customer's failure or natural disaster occurs, maintenance will be charged even during the warranty period.

First copy: saved by the customer

Crop line



Service Card

Product number	
Serial number	
Customer name	
Contact number	
Detailed address	
Seller	
Contact number	
Purchase date	

Second copy: sent back to company headquarter

Maintenance Records

Maintenance date	Maintenance project	Maintenance party	Signature of maintenance staff

Crop line

