

THE · DAIRY

CLICKIT

SMARTPHONE
HOLDER & STAND



INSTRUCTIONS

Please attach CLICKIT about 3~3.5cm from the bottom of your smartphone

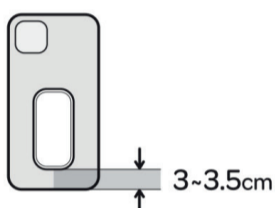

FOR GLASS-BACKED PHONE USERS

If your device does not have a case, please place this film on the back of your phone to ensure good adhesion of your **CLICKIT**. The film is repositionable 2-3 times.

FEATURES



Comfortable phone use, with secure grip between fingers.



Large and stable stand area for trouble free selfies.



Use vertically for web surfing or horizontally for watching videos.

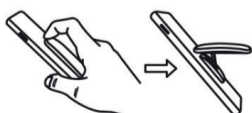

One touch setup for easy grip and folding.



Reusable adhesive:
- Rinse adhesive pad with clean water and allow to air dry.