



TOPLIFT PRO™ FORD BRONCO® 2-DOOR

ASSEMBLY MANUAL & HOW-TO GUIDE



Parts



T-Connectors (x6)

Bolt Pack

Accessory Pack



Top Platform
Assembly Legs

Horizontal Tube
(3 Hole)

Gear Bracket



8 Inch Aluminum
Insert (Long)

4 Inch Aluminum
Insert (Short)

Height Adjustable
Insert (5 Hole)



Parts



Left & Right Y-Frame
+ Support Cross Bar



Green Handle Brake
Release + Yoke



S-Frame



Caster w/ Brake (x2)



Caster w/out
Brake (x2)



Pawl



Top Platform



Left & Right
Base Frame



Parts



Left & Right Base Frame, Top Platform Legs, Horizontal Tube, 8in Insert, 4in Insert, Left & Right Y-Frame + Support Crossbar.



S-Frame & Top Platform.

① M8X16 BOLTS WITH LOCK NUTS(16)



② M10X50 BOLTS WITH LOCK NUTS(9)



③ M10X90 BOLTS WITH LOCK NUTS(8)



④ M10X55 BOLT WITH LOCK NUTS(1)

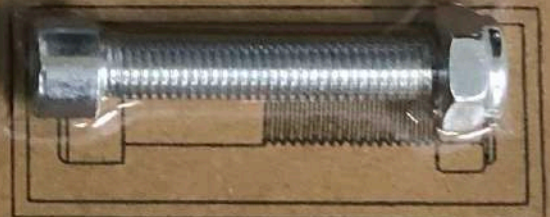

⑥ M10X90 ADJUSTABLE BOLTS WITH NUTS(2)



⑤ $\Phi 6$ CLEVIS PIN (1) & SPLIT PIN(1) & $\Phi 3$ WRENCH (1)





Parts



M10 Nut

M8 Nut



M10x95 | M10x90 (x7) | M10x55 | M10x50 (x9) | M8x16 (x16)



Nylon Washer (x8)

Cotter & Clevis Pin

3mm Allen Key

SPRING

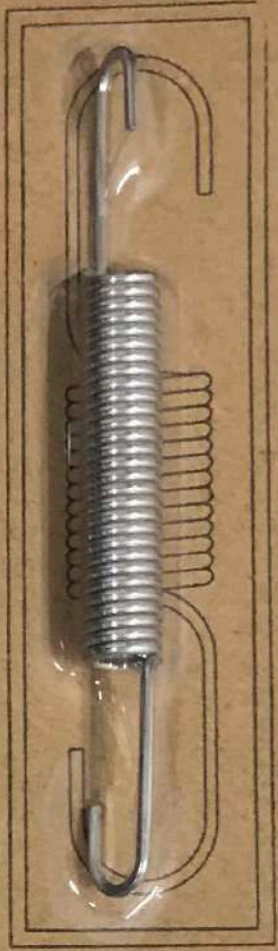

⑩ M6X16 BOLTS (4) & WASHERS (8) & M6 LOCK NUTS (4)



⑫ SNAP PINS (2)

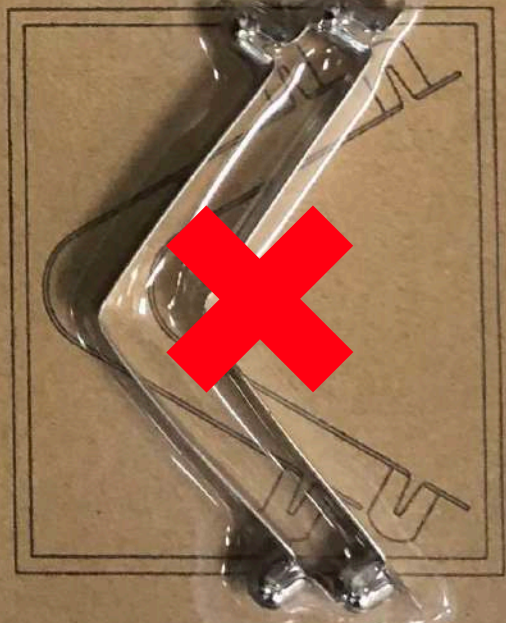

⑪ D-RING PINS (4)



⑬ RUBBER PAD (2)





Parts



End Caps (x16)



D-Locking Pins (x4)



Spring

Note: You will receive Snap Pins but will not need them as they are omitted from this specific Lift.



Tools you need



Steps

1.) Install all 6 T-Connectors as shown in the Fig. below using the 5mm Allen key, all lower assembly pieces will have a dimple/ marker on both sides of the base that indicate where the T-Connectors sit. Tighten them loosely on the middle of the dimples on both left and right base pieces, and Y-Frames. (**Do Not Tighten T-Connectors All The Way, Just Snug**). *See Figures Below*

- a. (It is important that you install all T-Connectors prior to construction).
- b. (All T-Connectors must sit halfway on the dimple/ marker to ensure your base and Y-Frames are lined up correctly).
- c. (When tightening the T-Connectors, make sure you do not over tighten them as they will snap from excessive force).



The red dot in the fig. indicates where to find the dimple on the base piece. (There are two dimples per base piece, one at the front and one at the rear; There is also one dimple per Y-Frame).



Once you have located all your dimples you can start adding the T-connectors to the pieces mentioned above. Remember to put the T-connectors halfway on the dimples for stability. (**Do this for both L & R Base Frame and L & R Y-Frame**) *See fig. above to see how the T-connectors should look*

Steps

- 2.) Once you have attached all the T-connectors to the L & R Base and Y-Frame, you can then connect the Y-Frame with the T-connector on it to the Base Frame. You simply insert the Y-Frame into the T-connector closest to the Front of the Base Frame and then sit the rear end of the Y-Frame into the rear T-connector.

*See Figures Below

Make sure you add this on before assembling the pieces.



For easy fitment install the front of the of the Y-Frame to the **Front** of the T-connector, followed by the rear of the Y-Frame into the **Rear** T-connector.



After you have finished attaching the Y-Frame to the Base pieces, it should look like this.

Steps

- 3.) The next step is to grab the two 8in Aluminum Insert (Long) and four M10x50 Bolts/Nuts. Install the 8in Inserts(x2) into the Left or right half of the base with two M10x50 Bolt/Nut (Use the 17mm wrench & 8mm Allen Key). After installing the 8in Inserts in one half of the base, you will then take the other half, slide it on, and then tighten it together with the other two M10x50 Bolts/Nuts.

See Figures Below

1



2



3



4



*Note: After you finish this step you can tighten all the T-connectors that touch the base. **Do Not Fully Tighten T-Connectors on Y-Frame Yet.***

Steps

- 4.) Take your Support Cross Bar and insert it into either one of the Y-Frame T-Connectors. After that you will just rotate the Support Bar into the other T-connector and tighten them with the 5mm Allen Key. **DO NOT TIGHTEN UNTIL TOP S-FRAME IS INSTALLED.**

1



2



3



*Note: When you complete this section of assembly you can now check all your T-Connectors and tighten them all the way.

When tightening T-connectors please remember to not over tighten as they will crack and break from excessive force.*



Steps

5.) Grab your 4 Casters (BRAKE TO THE FRONT OR BACK, YOUR PREFERENCE), 6mm Allen Key, 13mm Wrench, and your 16 M8x16 Bolts/Nuts. Take your completed Base Frame and lean it onto its back for easier Installation, line up the holes on the Casters to the holes on the Base Frame and insert the M8x16 Bolts into the now lined up holes in the Casters.



2



Steps

- 6.) With the Base completed and the Casters on, you will grab the Height Adjustable Inserts and D-Locking Pins. Take the insert and with the side that has two holes and insert it into the top of the Y-Frame (Make sure you line up the hole in the Y-Frame to Second Highest Hole in the Insert). Take the D-Locking Pin and insert it into the now lined up hole and lock it into place. With your Height Adjustable Inserts now in place, grab the S-Frame and slide it on to the Inserts, Install D-Locking Pins through frame on lowest hole. **TIGHTEN THE CROSS BAR T-CONNECTORS AT THIS TIME** (Top D-Locking Pin is not required for Stock Option TLPs).



Note: If it is hard to add the S-Frame, loosen the T-Connectors then add the S-Frame, then re-tighten the T-Connectors once it is on.

Steps

- 7.) With the S-Frame now on, you will grab the **Gear Bracket, Green Handle, Nylon Washers, and M10x55, M10x90, M10x95 Bolt/Nuts (Use the 18mm Wrench & 8mm Allen Key)**. The Gear Bracket will go on the side of the S-Frame that has the 3 holes, take the Gear Bracket and line it up to the middle hole on that side. Take your **M10x55 Bolt** and put it through the now lined up hole and tighten it. With the Green Handle line the hole on the handle with the lower holes on the S-Frame, take your **M10x95** and insert it into the lined up hole on the Bracket side. With your **M10x90** insert it onto the opposite side. **(MAKE SURE TO PUT NYLON WASHER IN BETWEEN ALL MOVING TUBES TO DECREASE FRICTION)**.

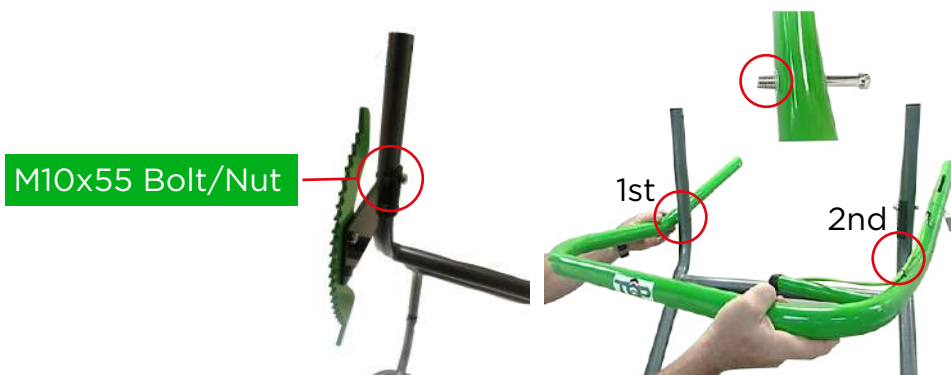

Note: All areas where there are moving tubes touching other tubes, must have a Nylon Washer Sandwiche**d** between them. (When tightening make sure that the nylon washers are barely crimped.)

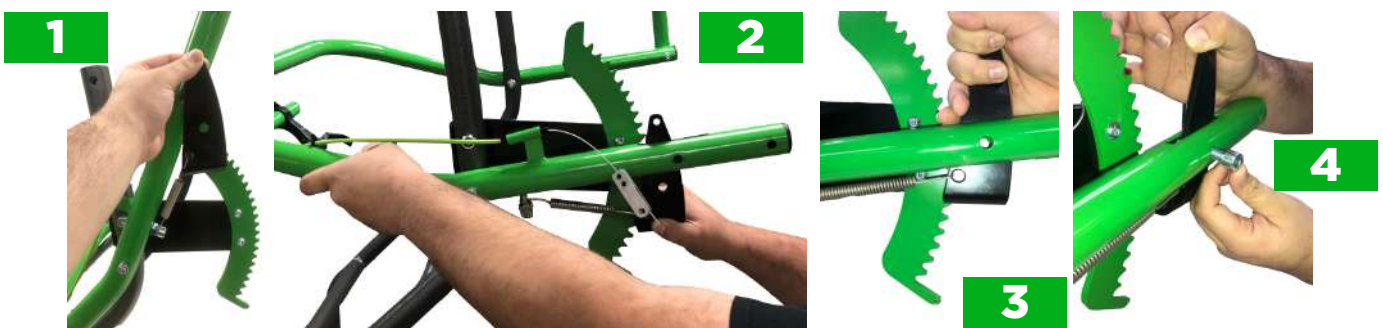

With the Green Handle and the Gear Bracket now attached to the S-Frame, you can now grab your Spring and Pawl. Hook the Spring onto the bolt that is underneath the Green Handle on the Gear Bracket side, and then with the other side of the Spring, hook it onto the bottom left hole of the Pawl. With the Spring now hooked to the handle and the Pawl, rest the the Pawl onto the Gear as pictured and rotate Handle down over the Pawl through the slotted hole in the handle. Adjust Pawl in the slotted hole and install an **M10x50 Bolt/ Nut** through it.

Steps

- 8.) Grab your two **Top Platform Assembly Legs**, **M10x90 Bolt/Nuts**, and some more **Nylon Washers**. Take your Platform Assembly Legs and on the side that has one hole put the **M10x90** bolt through it with a washer on the end. Take the Platform Assembly Leg with the bolt and washer through it and put the rest of the bolt through the hole at the end of the Green Handle and tighten. (**REMEMBER TO ONLY CRIMP THE NYLON WASHER A LITTLE, DO NOT OVER TIGHTEN**).
-



Grab your two **Horizontal Tube (3 Hole)**, **M10x90 Bolt/Nuts**, and some Nylon Washers. On the left side of the 3 Hole Tube Insert the M10x90 bolt and put a washer on the end of it once you have done so. Attach the 3 Hole tube with the bolt in it and washer on it, to the top hole on the S-Frame and tighten it gently. Now that you have attached the **3 Hole Tube** you can now grab another **M10x90** bolt and put it through the **right hole** of the 3 Hole Tube, put a washer on the end of the bolt and insert the bolt/washer combo into the second lowest hole on the **Top Platform Assembly Legs** and tighten it gently. (**All 8 washers should now be in between all the moving tubes**).



Steps

- 9.) With the upper assembly now constructed you can grab your **4 Inch Aluminum Insert (Short)**, **M10x50 Bolt/Nuts**, and **Top Platform**. Take your Short Aluminum Insert and put it into the top of the Top Platform Assembly Legs; now with the hole lined up to both the Short Insert and the Assembly legs, insert the **M10x50** bolt into the hole and tighten it. After you have put the insert on you can now take the Top Platform and put it on top of the short insert, line the holes up, insert the other **M10x50** and tighten.
-



How It Should Look

Steps

10.) With the TopLift Pro now fully constructed, we will move onto the Cable Adjustment. Take your Yoke that is attached to the Green Handle, and with the Cotter/ Clevis pin connect the hole at the top of the Pawl to the lined up hole in the Yoke. Now that the Yoke is connected to the Pawl, take your **Adjuster Screw** (Black Screw Built into Green Handle) and drive it **INTO** the green sleeve its housed in; by doing this it decreases the amount of SLACK in the cable. Now that the Adjuster Screw is all the way in, untighten (**DO NOT REMOVE**) the two Set Screws in the Yoke with the 3mm Allen Key. Pull the end of the cable that is going through the yoke until all the wire is straight and tight; while holding the cable and keeping it tight, you can now re-tighten the Set Screws so they can hold that point of the cable. With the Yoke connected to the Pawl, the cable pulled through, and set screws holding the correct point on the cable; you can now take that Adjuster Screw mentioned before and back it out until you have the maximum amount of tension possible. Once you have do this step your lift is now complete, try out the handle before using the mechanism and see if it clears all the teeth on the gears. If it does not, then continue to back out that Adjuster Screw until it does so.

Drive Adjuster Screw into green sleeve



Insert the **Clevis** Pin into the hole, and on the opposite side take your **Cotter** Pin and insert it into the hole on the other side of the clevis pin and bend it to lock.

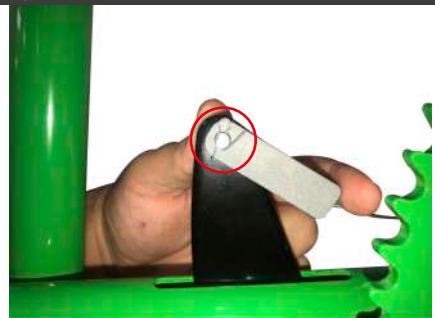

Loosen the two **Set Screws** and pull the cable to decrease slack.



While still pulling the cable, re-tighten the Set Screws to get it to hold the cable in place.



Back out the Adjuster Screw **accordingly** to increase the tension in the cable.

Steps

- 11.) After you have removed your Hardtop and rolled it away from your Bronco®, you can now adjust your **Leveling Feet**. With one hand lift up on the front of your Hardtop, with your other hand push in the **Silver Leveling Button** under the internal arm and slide it forward accordingly to make your Hardtop level.

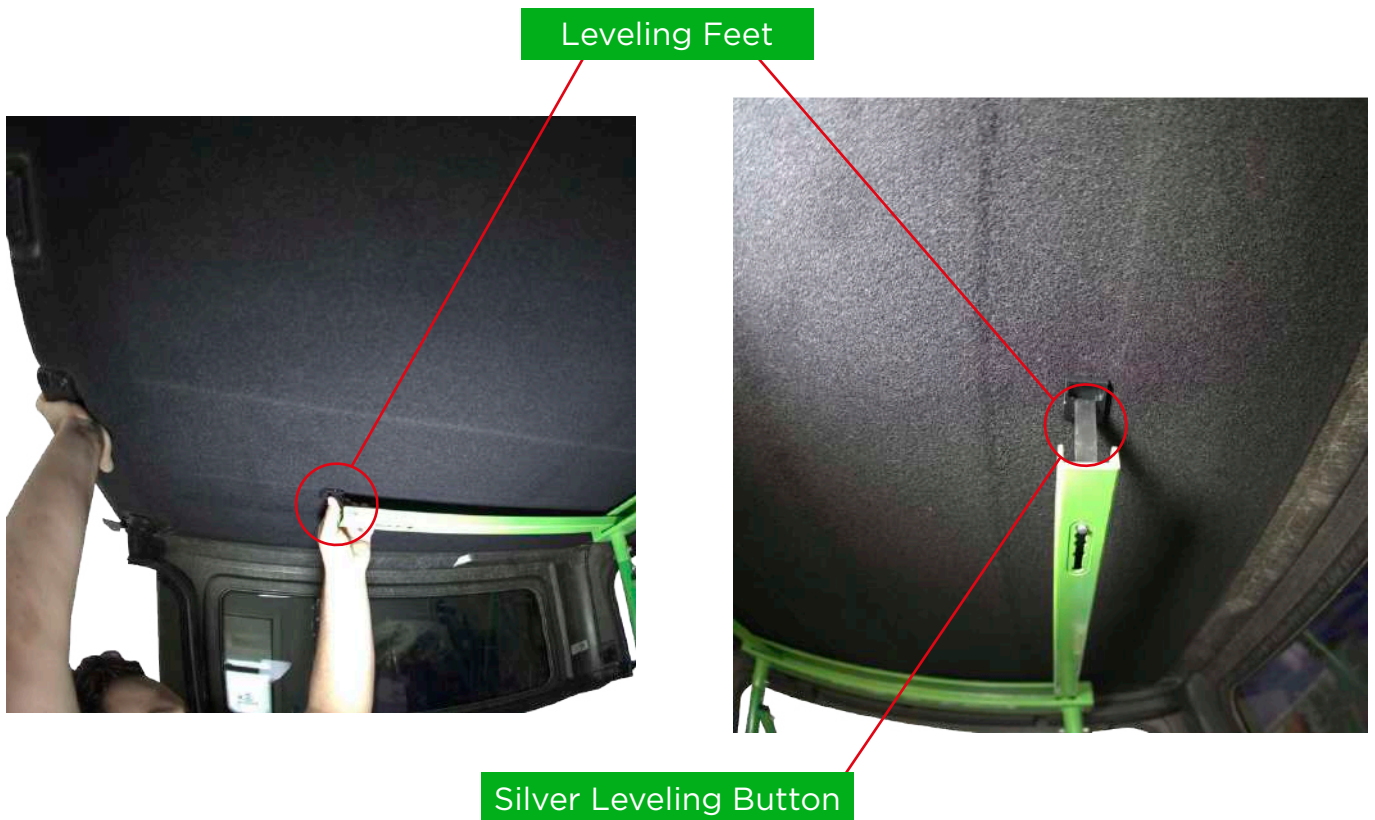

Ford Bronco[®] (2-Door) Hardtop Removal Tool

Your unit will look like this, don't be alarmed. The 6 degree angle is to help with ease of lift and to also help with the 2 Door Broncos' extra guide pins.





HOW-TO GUIDE

FORD BRONCO® 2-DOOR



Step 1

Disconnect Power & Washer Fluid In rear left side of cargo area.



Step 2

Remove 8 Bolts (Torx T-50), 4 on each side in rear area of vehicle.





Step 3

Unlatch Freedom Panels from front, removing drivers side followed by passenger side.





Step 4

Remove T-50 Bolt that is over the driver and passenger side that holds onto the front of the Hardtop.





Step 5

Roll your TopLift Pro™ into position in the cargo area. Line up the Square-Bar resting platform at the rear under the Hardtop.





Step 6

Raise platform until level with roofline or until touching Hardtop.

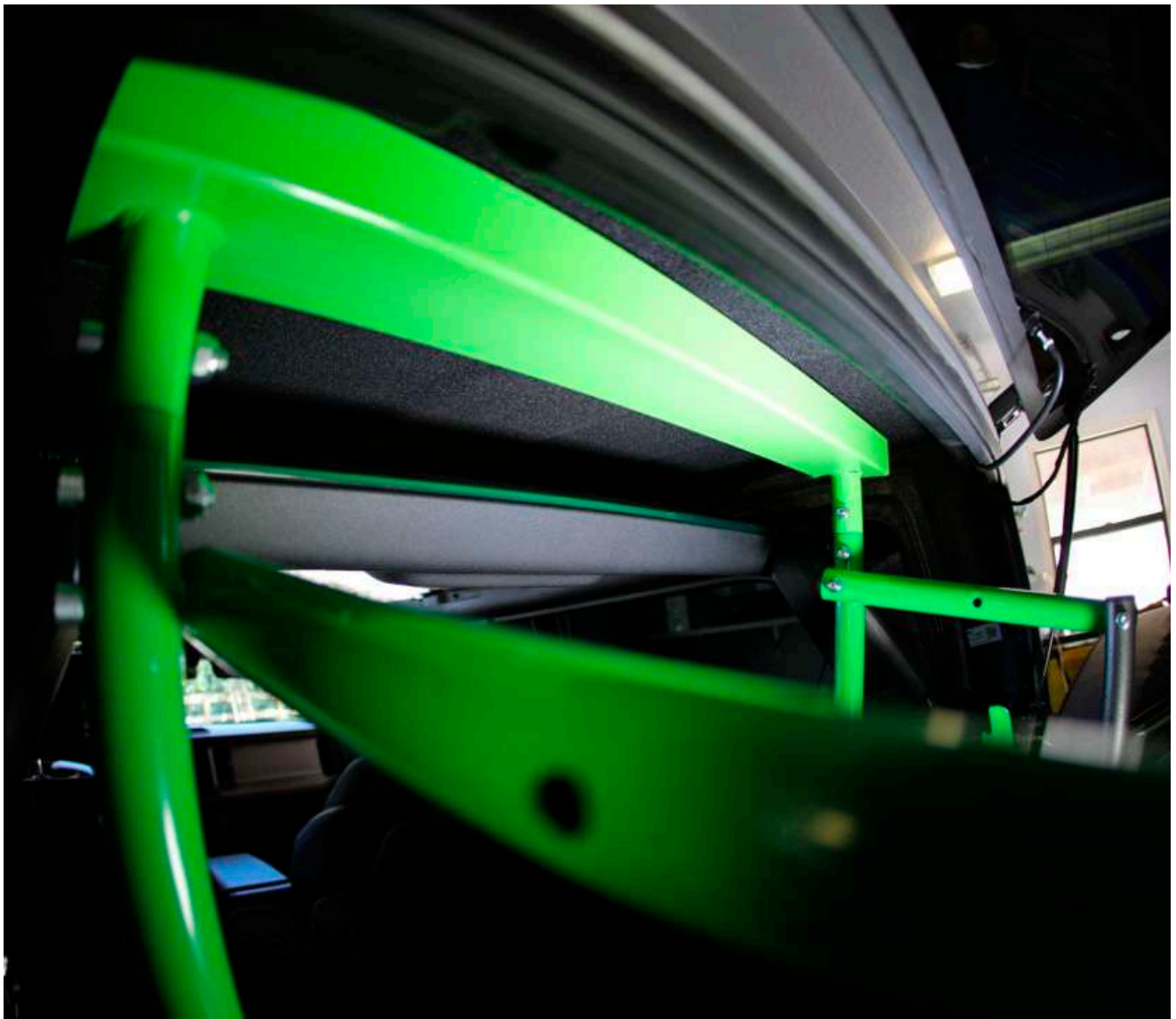

Step 7

Take two pieces of foam (3in.), or a cut pool noodle about 12in each works great. Raise each side of the front of the Hardtop where the two T50 Bolts are and put the foam underneath each side of the front Hardtop.

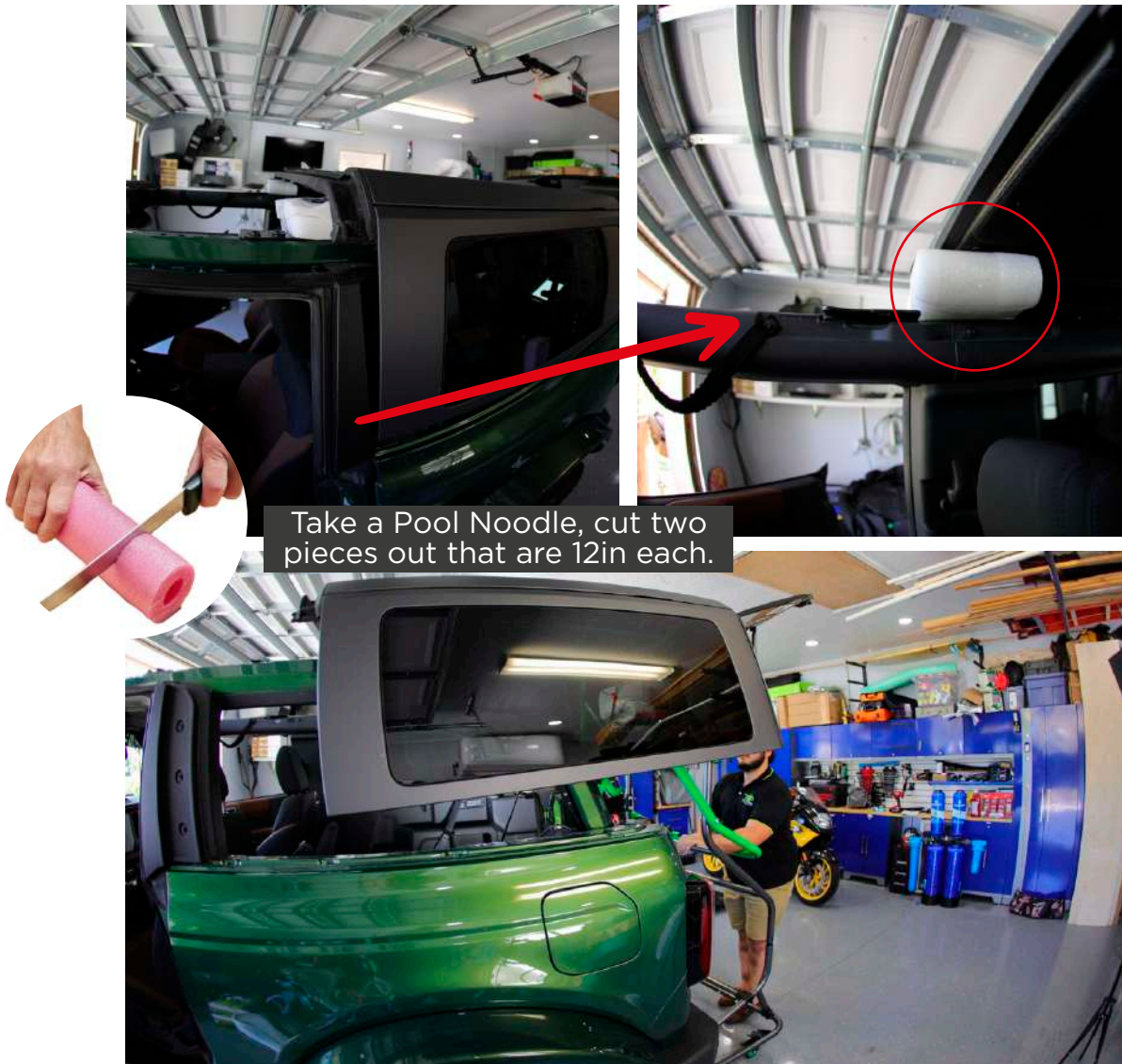

Note: The reason for the foam is because Ford® installed long positioning pins to guide the install of your Hardtop and this will help unnecessary binding of those pins as they are well fabricated into the hardtop.



Step 8

Flip out each side of the internal arms until they are fully extended. SEE FOAM PIECES AS THEY ALSO HELP WITH SPACING BETWEEN ROLL BAR.





Step 9

Raise your Hardtop using the TopLift Pro™. Raise high enough to clear any obstruction.

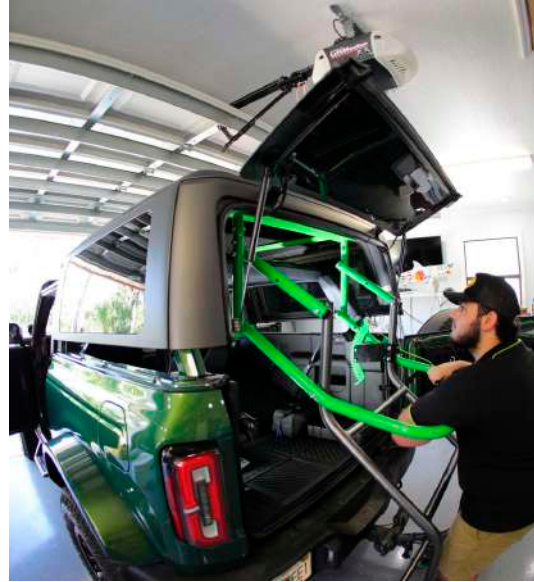



Step 10

Use the **leveling feet** on the end of each Internal arm to level your Hardtop out.





TOPLIFT PRO™ 2 DOOR BRONCO HARDTOP REMOVAL TOOL

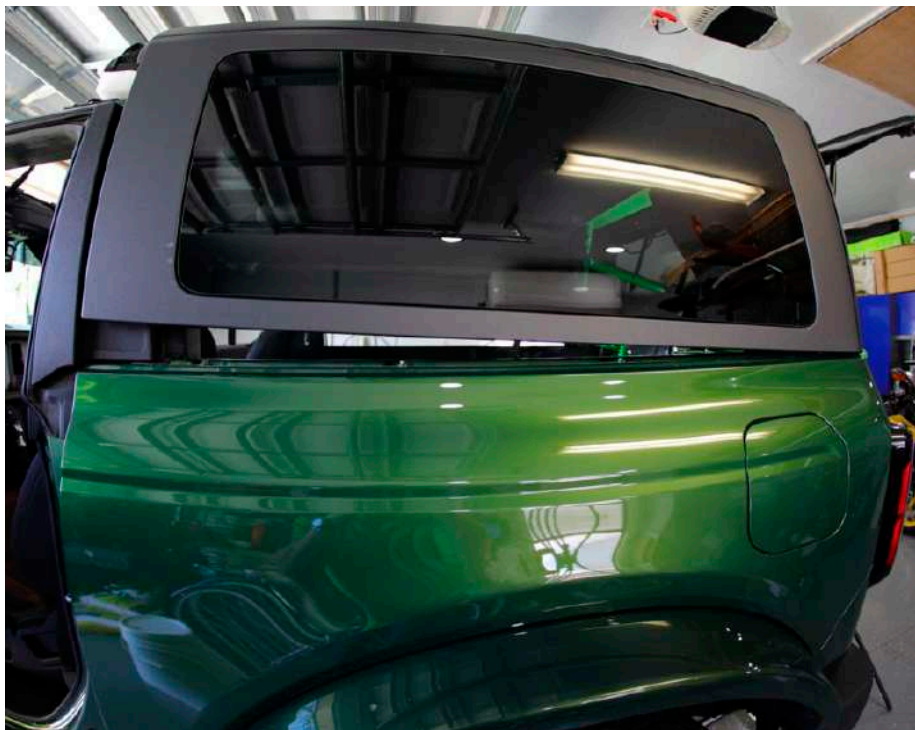



Extra

If you received any of these items, they are omitted from the 2 Door Bronco Lift.*

