



Installation Guide

Tempered Glass Screen Protector

Welcome | Thank you for choosing AT&T electronics

Low-cost, Lifetime Replacements:

At AT&T electronics, we stand behind the quality of our screen protectors for a lifetime. We design our products to protect your devices from normal wear and tear, which means that over time, they may need to be replaced to continue to provide the same level of protection. As part of the Customer Loyalty Program, you only have to pay shipping and handling to receive a brand new replacement for your product.

Any replacement or warranty service, and all questions about this product, should be directed to: Concept 101 LLC, 1-888-920-8680.

Installation guide

1. Gently clean the screen of your device with the included alcohol prep pad to remove any oil and dust and wipe the screen with the micro fiber cloth.

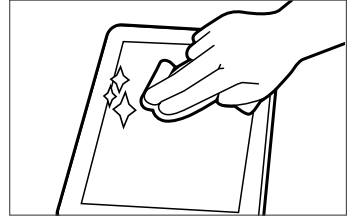

2. Pull sticker #1 to remove the film from the contact side of the glass. Do not touch the contact side once the film is removed.

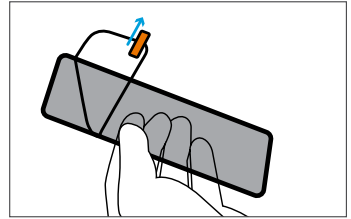

3. Align the screen protector to the sides of your device, contact side down. Gently lift immediately if it does not align perfectly; adjust until you are satisfied.

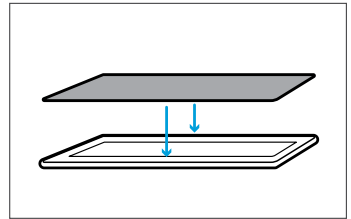

4. Once in place, press firmly on the screen protector to secure the position.

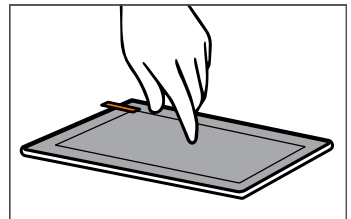

5. Use sticker #2 to remove the film from the outside of the screen protector.

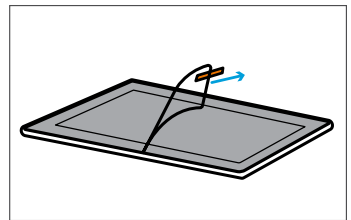



www.att.com/electronics

© 2017 Concept 101 LLC. All Rights Reserved. AT&T and the AT&T logo are trademarks of AT&T Intellectual Property licensed to Concept 101 LLC, New York, New York 10018. D Issue 3.1 AT&T 9/2017.