



# Essential SmartBright G2 LED Downlight DN029B

## DN029B G2 LED20/CCT PSR-E D200 CAU

The Philips SmartBright G2 LED downlight provides a professional and flexible solution for a wide variety of applications. Offering three selectable colour temperatures plus integrated dimming capability, the G2 downlight makes it really easy to create the perfect ambience for your unique environment. This affordable and quick to install fitting delivers high energy savings without compromising on light quality.

### Product data

General Information		Controls and Dimming	
Lamp colour code	3000/4000/6500	Dimmable	Yes
Light source replaceable	No	Mechanical and Housing	
Luminaire light beam spread	100°	Housing material	Metal-Plastic
Connection	Plug-in connector 2-pole	Reflector material	Polycarbonate
Protection class IEC	Safety class II (II)	Optic material	Polycarbonate
Operating and Electrical		Fixation material	Stainless steel
Input Voltage	220 to 240 V V	Optical cover/lens finish	Frosted
Input frequency	50 or 60 Hz	Overall length	225 mm
Power factor (min.)	0.8	Overall width	225 mm
		Overall height	63 mm
		Overall diameter	225 mm
		Colour	White

**Distributed By:**  
Reduction Revolution Pty Ltd  
[www.reductionrevolution.com.au/LED](http://www.reductionrevolution.com.au/LED)

# Essential SmartBright G2 LED Downlight DN029B

## Approval and Application

Ingress protection code	IP40/IP54 front
Mech. impact protection code	IK03 [ 0.3 J]

## Initial Performance (IEC Compliant)

Initial luminous flux (system flux)	2000 lm
Initial LED luminaire efficacy	111.00 lm/W
Lamp colour temperature	3000 4000 6500 K
Colour Rendering Index	80
Initial chromaticity	(3000K@. 0.4400, 0.40304000K@0.37600.36566500K@0.31300.3370) 6
Initial input power	18 W
Power consumption tolerance	+/-10%

## Over Time Performance (IEC Compliant)

Median useful life	30000 h
L70B50	

## Application Conditions

Ambient temperature range	-20 to +40 °C
---------------------------	---------------

## Product Data

Full product code	871951425189200
Order product name	DN029B G2 LED20/CCT PSR-E D200 CAU
EAN/UPC – product	8719514251892
Order code	929002531719
Local order code	DN029BL20CCT200
SAP numerator – quantity per pack	1
Numerator – packs per outer box	6
SAP material	929002531719
SAP net weight (piece)	0.585 kg



## Dimensional drawing

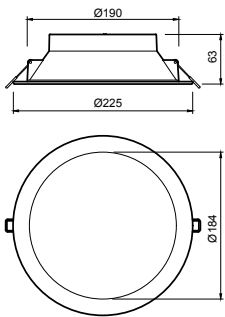

DN029B G2 LED20 3CCT 24W D200 DIM AU

**Distributed By:**  
Reduction Revolution Pty Ltd  
[www.reductionrevolution.com.au/LED](http://www.reductionrevolution.com.au/LED)

# Essential SmartBright G2 LED Downlight DN029B

## Photometric data

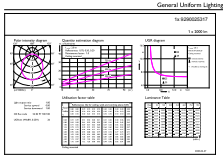

## Downlight DN029B G2 LED20 PSR D200

## Lifetime

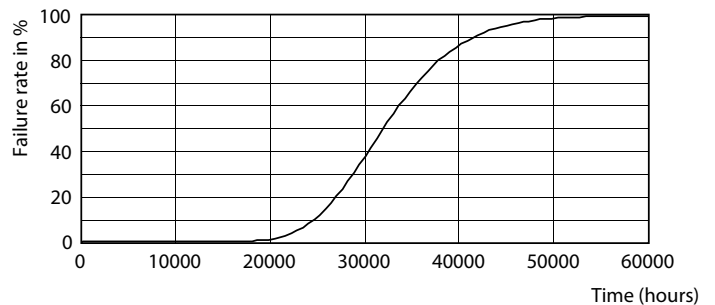
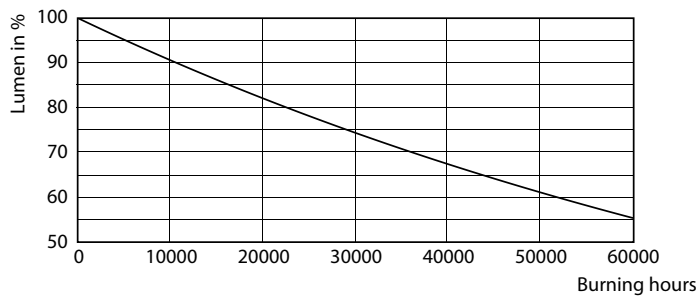

## B50L70 30K LMP

## B50L70 30K LED

