

BELIZE BICYCLE

TRI-RIDER R-2 Recumbent Trike Assembly Guide

Revision 2020-01-09



PREPARATION

1. Read this assembly manual **BEFORE** commencing assembly.
2. Carefully remove all the components and packaged hardware from the shipping box.
3. Check the contents of the box and confirm that you have received a complete package. The contents should include:

Contents:

- (1) A main frame assembly with fork, crankset, and drivetrain, pre-installed
- (2) One 20" left rear wheel assembly
- (3) One 20" right rear wheel assembly
- (4) One 20" front wheel assembly
- (5) Two 20" rear fenders
- (6) One 20" front fender
- (7) Rear seat support cage and mesh
- (8) Main seat platform
- (9) Handlebar with Shimano 3x6 twist shifters pre-installed.
- (10) Hardware and accessories
- (11) Small box containing hardware and accessories

BELIZE BICYCLE

TRI-RIDER R-2 Recumbent Trike Assembly Guide

Revision 2020-01-09

Small box contents

NO	ITEM	QTY	INSTALLATION
1	Gooseneck extension and stem	1 ea	Install in greased fork steering tube
2	Brake levers, Promax, V-brake	1 pair	Install on handlebars
3	V-brake cable, front, 27.5"	1	Install between brake lever and V-brake
4	Shimano 6-speed twist shifter	1	Install on right hand handlebar
5	Grips	1 pair	Install on handlebar
6	Mirrors, handlebar clamp	1 pair	Install on handlebar
7	Front reflector, white	1	Install on reflector mount
8	Front reflector mount, handlebar	1	Install on stem below handlebar
9	Bell, steel, black	1	Install on handlebar
10	Rear fender reflectors	2	Install on rear fenders
11	Pedals	1 pair	Install on crank arms
12	Axle caps	2	Install on rear axle to complete wheel installation
13	Seat post, chrome, 28.6mm	1	Install in greased seat tube
14	Wheel spoke reflector, white	1	Install on front wheel opposite valve
15	Chain, single speed, with installation link	1	Install between front and rear frame sections on main drive cogs
16	Hex head bolts, M10 (6) M10 washer (12) M10 nuts, plain (6)	1 set	Install to connect front and rear frame sections
17	Brake noodle, 90 degrees (1) Brake cable bellows, rubber (1) Cable clips, black, plastic (2) Cable crimp (3) M6 x 35mm hex head bolt (1) M6 Nylock nut (1)	1 set	Install brake noodle and rubber cable bellows at front V-brake Install front fender using M6 x 35mm hex head bolt, washer and nylock nut
18	Seat cage	2	Install at one of five attachment points on frame using oversized seat Quick Release provided
19	Mesh seat cover	1	Install over seat cage, adjust tension with belts straps Top end has pockets to slide over upper tube ends
20	Seat cage adjustable support rods	2 sections	Install upper sections to upper attachment point on seat cage Attach lower sections to one of two mounting points on rear frame Adjust assembly length to vary seating angle and lock in place with clips provided.

BELIZE BICYCLE

TRI-RIDER R-2 Recumbent Trike Assembly Guide

Revision 2020-01-09

ASSEMBLY

1. Open the plastic bag containing mounting hardware. Group all similar nuts and bolts in preparation for assembly.
2. Prop the front frame assembly vertically and align the rear frame section perpendicular to it. Install two bolts / washer/ nut assemblies in the inside bottom hole on the main frame and slide the rear assembly forward inside the rear frame dropouts. After aligning the two bolts already in place with the slots on the rear frame section, add the second set of anchoring bolts to the dropouts (Head inside / locknut outside). Finally add the third sets of hardware on the riser struts on each side.
3. Install the drive chain between the two frame sections with the joining link installed as shown in the photograph and pull the two frame sections in opposite directions to tension the chain.



BELIZE BICYCLE

TRI-RIDER R-2 Recumbent Trike Assembly Guide

Revision 2020-01-09

4. Tighten all six bolts that hold the two frame sections together making sure that the rear is perpendicular to the front. The nuts will face to the outside and will be tightened from the outside. Confirm that the chain is still properly tensioned.

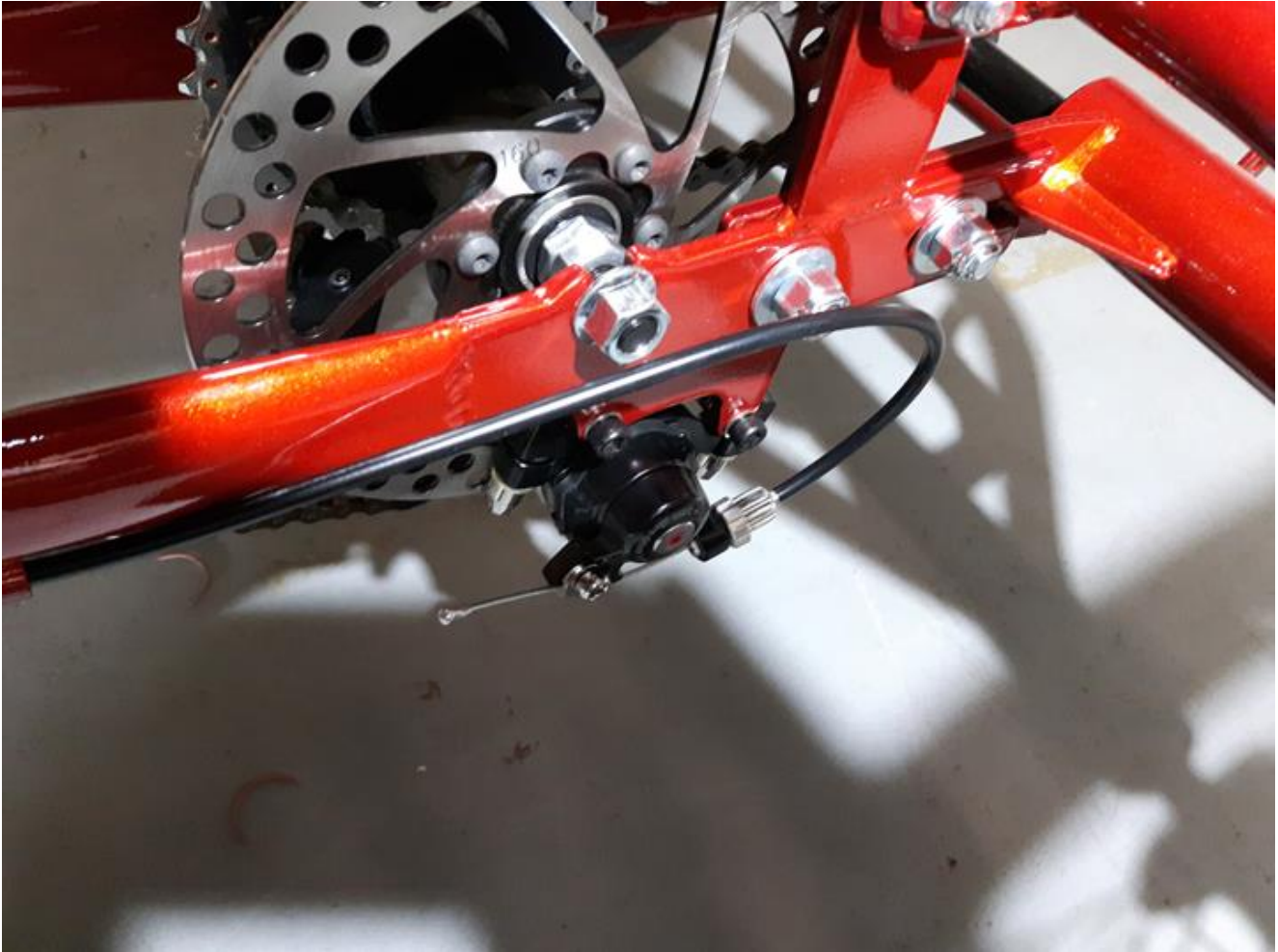

5. Unwrap and separate the wheels and fenders. Use caution when unpacking.
6. Install the drive side rear wheel (right hand side RHS). The right wheel and left-hand wheel are identical and interchangeable. Use the tread direction to orient the wheel during installation. The drive wheel will interface with three prongs on the axle. This axle nut should be fully tightened (40Nm).
7. Install the non-drive side wheel (left hand side LHS). **DO NOT OVERTIGHTEN!!** Be sure that the left axle nut is loose enough that the inside spacer is just barely free to spin

BELIZE BICYCLE

TRI-RIDER R-2 Recumbent Trike Assembly Guide

Revision 2020-01-09

by hand. Overtightening will side-load the bearings and cause premature wear and bearing failure. A clicking noise from the left wheel bearing while driving is a symptom of overtightening.

8. Install the front wheel assembly making sure that the tabs on the safety washers fit into the holes on the fork and that the rim is centered in the fork arch before tightening the axle nuts.
9. Install the front fender on the fork using the long bolt and nut assembly supplied in the hardware package and the pre-installed fender stay mounting screws.
10. Install the gooseneck and handlebar assembly. Brake levers, shifter and grips are pre-installed on the handlebar. Normally the stem is reversed in a recumbent installation to bring the handlebar closer to the rider. Experiment to find a comfortable height and reach for the rider before fully tightening.
11. Complete the rear disc brake cable installation by passing the cable through the rear cable adjustment assembly and finally under the anchoring nut. Adjust cable tension so that parking brake is fully engaged when brake lever is parallel to the handlebar.
12. Complete the front brake adjustment. Proper adjustment will just permit the removal of the cable by unlatching the brake noodle. Brake pads are properly aligned when square to the rim and have 1mm vertical clearance to the tire on each side.
13. Complete the shifter cable installation by passing it through the rear derailleur adjustment assembly and finally under the derailleur cable anchoring nut. First put the shifter in 6th gear and the rear derailleur on the smallest cog. This will remove all preload from the cable.
14. Mount the rear fenders using the bolts supplied.
15. Lightly grease inside the seat tube and install the seat and seat post assembly. The seat position can be adjusted slightly by sliding the seat backwards or forwards on the seat rails.
 - A smaller rider can be better accommodated by reversing the gooseneck than by advancing the seat to an extreme forward position. A larger rider can be better accommodated by installing a gooseneck with a longer stem than by installing the seat in its extreme backwards position.
16. Install the pedals (L on the left side with a counter clockwise thread, R on the right with a regular clockwise thread).
17. Install the chain guard using the pre-installed mounting screws.

BELIZE BICYCLE

TRI-RIDER R-2 Recumbent Trike Assembly Guide

Revision 2020-01-09

18. Install the white reflector on the front steering stem. Install wheel reflectors on all three wheels (red on the rear wheels, orange or white on the front wheel).
19. Install cable crimps after adjusting and trimming cables.
20. Install the seat cage to the main frame using the oversized quick release provide. Pick one of the five attachment points. The location can be easily changed later to adjust to the rider size. The five different frame positions change the reach to the pedals and allow the R2 to adjust to different rider sizes.
21. Install the rear seat cage support rods using the hardware supplied. The length and anchor positions change the angle of the seat for comfort and personal preference.
22. Install the mesh seat cover over the seat cage starting at the top. Slip the top of each seat cage tube inside the pocket found at the top corners of the mesh cover. Work downwards tensioning the mesh with the belts that clip behind the seat cage. Adjust the final position and seat angle to suit the rider. This is also the best time to make final adjustments to the handlebar height and angle.
23. Inflate the tires. The recommended tire pressure is marked on the tire sidewall. Make final adjustments to the handlebar angle and the seat height.

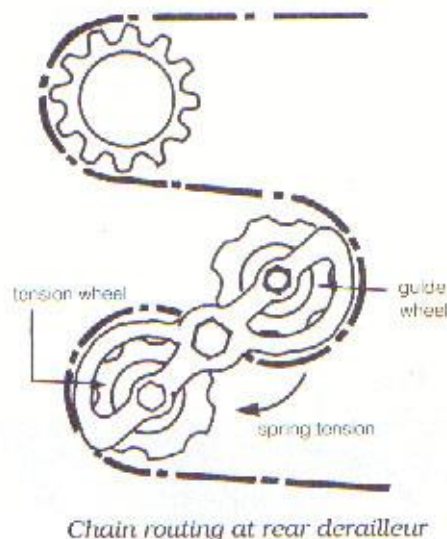

Drivetrain routing through rear derailleur

Stroke adjustment and cable securing

1. Top adjustment

Turn the top adjustment screw to adjust so that the guide pulley is below the outer line of the smallest sprocket when looking from the rear.

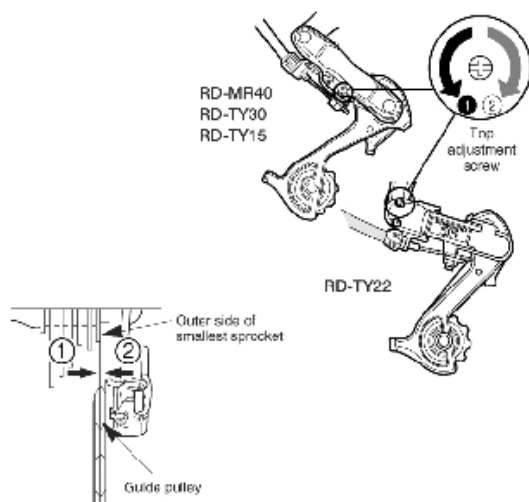

2. Connection and securing of cable

Connect the cable to the rear derailleur and, after taking up the initial slack in the cable, reattach to the rear derailleur as shown in the illustration.

Secure the cable by pulling it with pliers with a force of 5-10 kg.

Tightening torque:
5 - 7 Nm (44 - 60 in. lbs.)

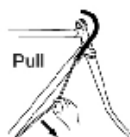

Note: Be sure that the cable is securely in the groove.

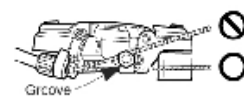

3. Low adjustment

Turn the low adjustment screw so that the guide pulley moves to a position directly below the largest sprocket.

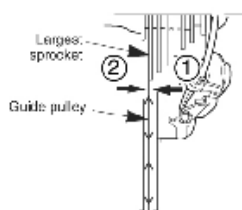

SIS Adjustment

1. Operate the shifting lever to move the chain from the top gear to the 2nd gear.

* If the chain will not move to the 2nd gear, turn the outer casing adjustment barrel to increase the tension---① (counter clockwise)

* If the chain moves past the 2nd gear, decrease the tension---② (clockwise)

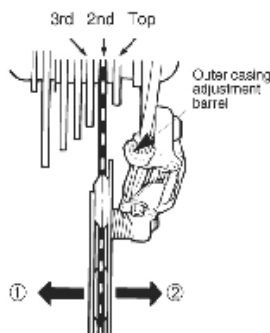

2. Next with the chain on the 2nd gear, increase the inner cable tension ① while turning the crank arm forward. Stop turning the outer casing adjustment barrel just before the chain makes noise against the 3rd gear.

This completes the adjustment.

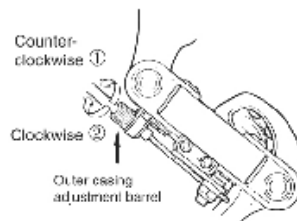

For the best SIS performance, periodically lubricate all power-transmission parts.

BELIZE BICYCLE

TRI-RIDER R-2 Recumbent Trike Assembly Guide

Revision 2020-01-09

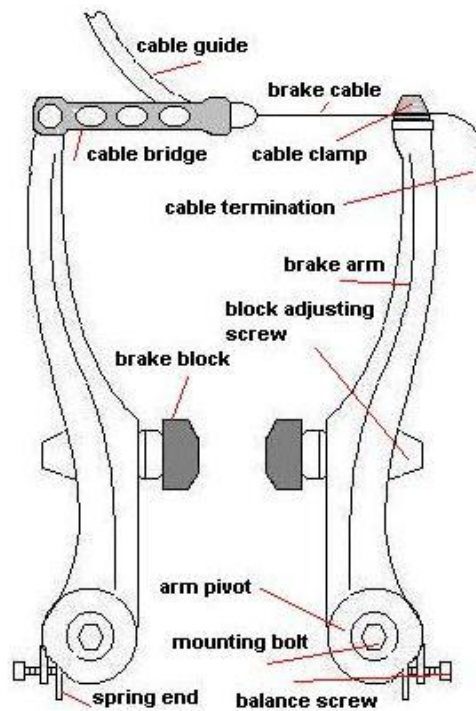

V-Brake Assembly

Note: For your own safety it is recommended that you bring the assembled tricycle to a competent bicycle mechanic for an inspection before using it.