

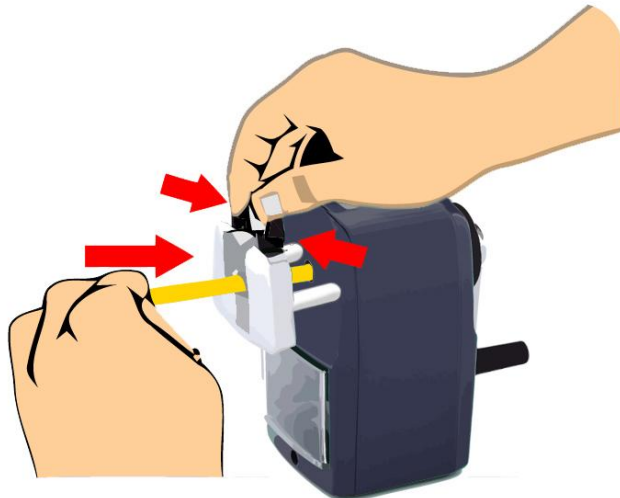

1. Pull the silver face forward until it locks in place.



2. Pinch the 2 black knobs together and insert your pencil completely into the sharpener. When you release the knobs they will hold the pencil securely in place.



3. Place one hand on top of the sharpener to hold it secure. Do not hold onto the pencil while sharpening. Turn the handle clockwise to sharpen. The face will pull the pencil in automatically. The handle will spin freely once the pencil is fully sharpened.

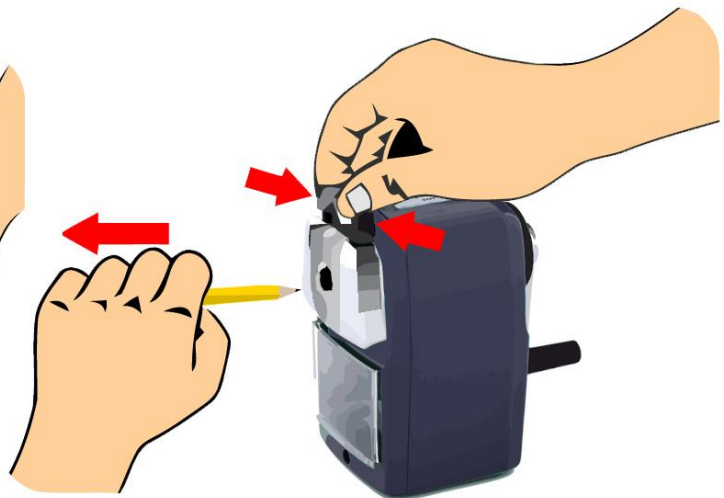

4. Pinch the 2 black knobs to release the pencil once sharpened.

A perfect sharpen every time!

For tips on how to use and repair your sharpener please visit
www.classroomfriendlysupplies.com/pages/help-portal



1. Pull the silver face forward until it locks in place.

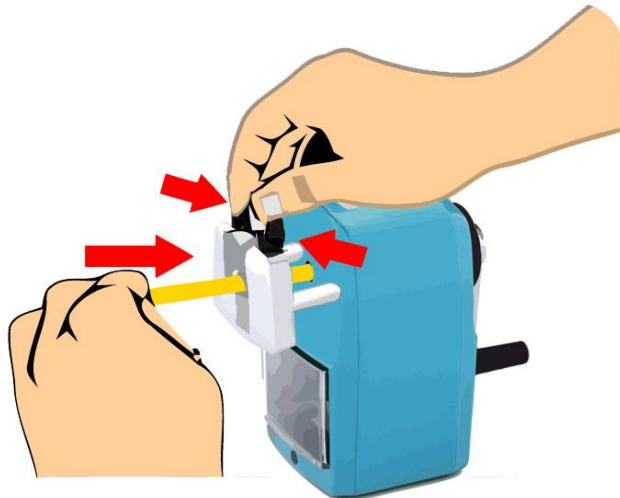

2. Pinch the 2 black knobs together and insert your pencil completely into the sharpener. When you release the knobs they will hold the pencil securely in place.

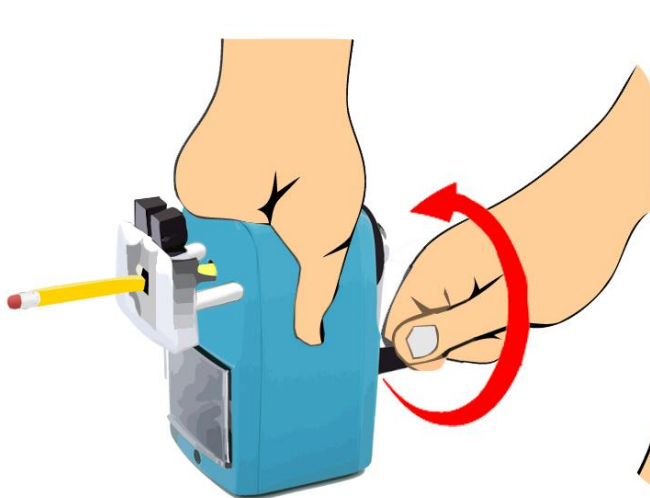

3. Place one hand on top of the sharpener to hold it secure. Do not hold onto the pencil while sharpening. Turn the handle clockwise to sharpen. The face will pull the pencil in automatically. The handle will spin freely once the pencil is fully sharpened.

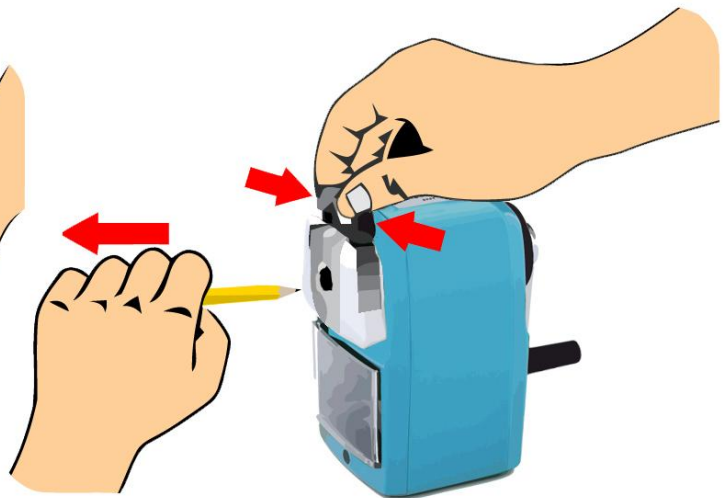

4. Pinch the 2 black knobs to release the pencil once sharpened.

A perfect sharpen every time!

For tips on how to use and repair your sharpener please visit
www.classroomfriendlysupplies.com/pages/help-portal



1. Pull the silver face forward until it locks in place.

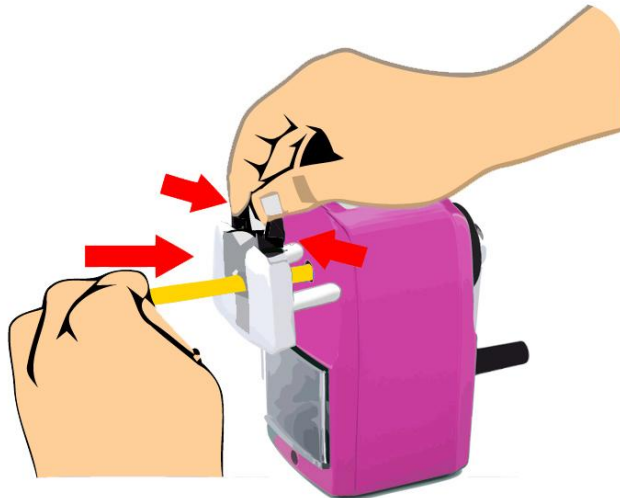

2. Pinch the 2 black knobs together and insert your pencil completely into the sharpener. When you release the knobs they will hold the pencil securely in place.



3. Place one hand on top of the sharpener to hold it secure. Do not hold onto the pencil while sharpening. Turn the handle clockwise to sharpen. The face will pull the pencil in automatically. The handle will spin freely once the pencil is fully sharpened.

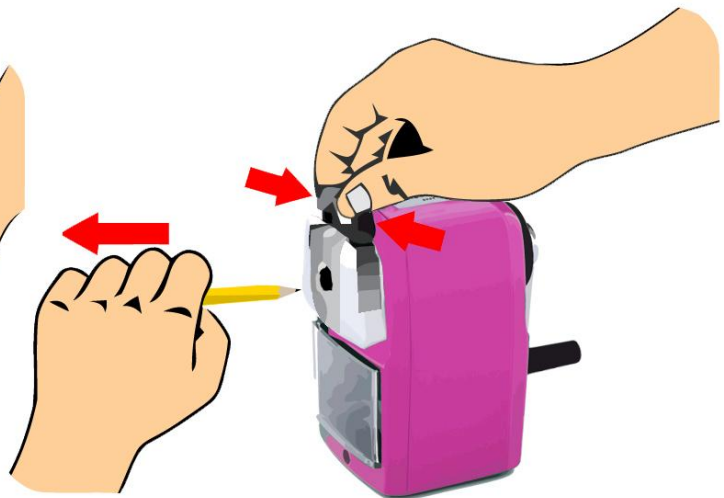

4. Pinch the 2 black knobs to release the pencil once sharpened.

A perfect sharpen every time!

For tips on how to use and repair your sharpener please visit
www.classroomfriendlysupplies.com/pages/help-portal



1. Pull the silver face forward until it locks in place.

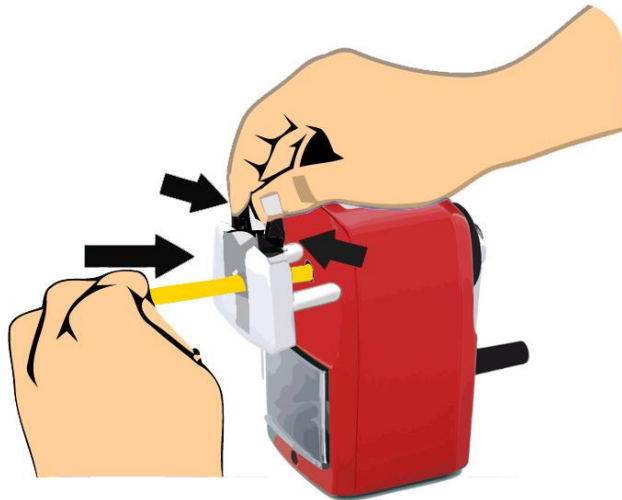

2. Pinch the 2 black knobs together and insert your pencil completely into the sharpener. When you release the knobs they will hold the pencil securely in place.

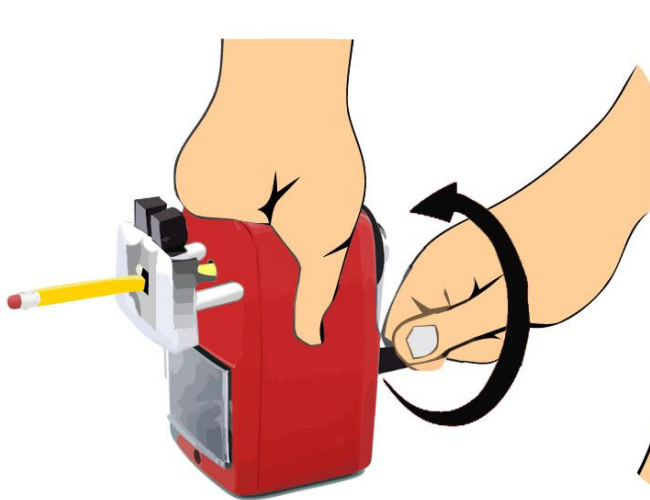

3. Place one hand on top of the sharpener to hold it secure. Do not hold onto the pencil while sharpening. Turn the handle clockwise to sharpen. The face will pull the pencil in automatically. The handle will spin freely once the pencil is fully sharpened.



4. Pinch the 2 black knobs to release the pencil once sharpened.

A perfect sharpen every time!

For tips on how to use and repair your sharpener please visit
www.classroomfriendlysupplies.com/pages/help-portal



1. Pull the silver face forward until it locks in place.

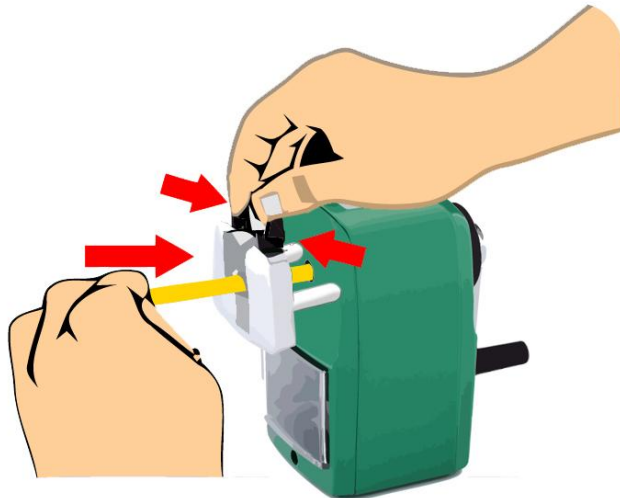

2. Pinch the 2 black knobs together and insert your pencil completely into the sharpener. When you release the knobs they will hold the pencil securely in place.



3. Place one hand on top of the sharpener to hold it secure. Do not hold onto the pencil while sharpening. Turn the handle clockwise to sharpen. The face will pull the pencil in automatically. The handle will spin freely once the pencil is fully sharpened.

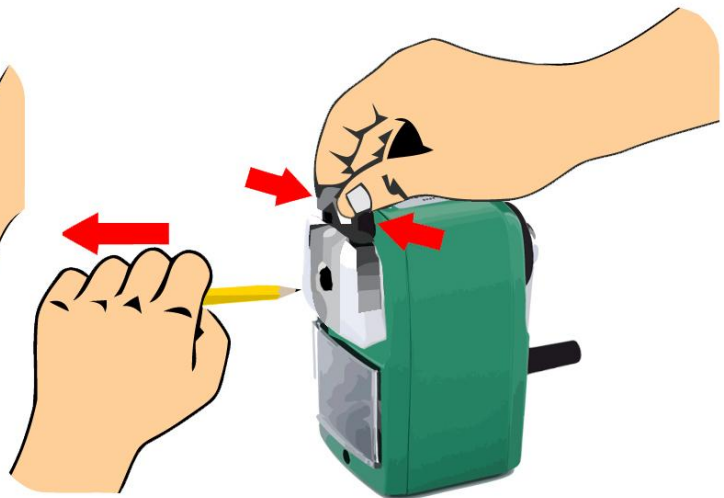

4. Pinch the 2 black knobs to release the pencil once sharpened.

A perfect sharpen every time!

For tips on how to use and repair your sharpener please visit
www.classroomfriendlysupplies.com/pages/help-portal

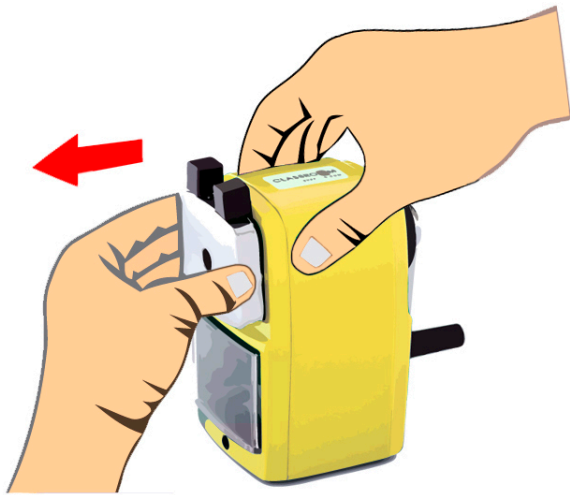

1. Pull the silver face forward until it locks in place.

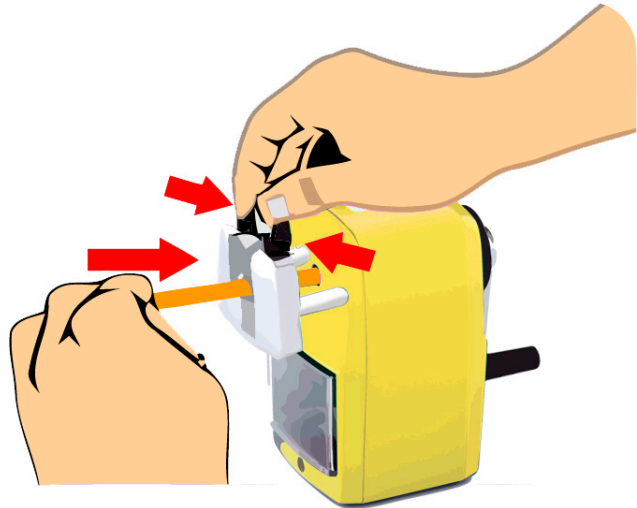

2. Pinch the 2 black knobs together and insert your pencil completely into the sharpener. When you release the knobs they will hold the pencil securely in place.

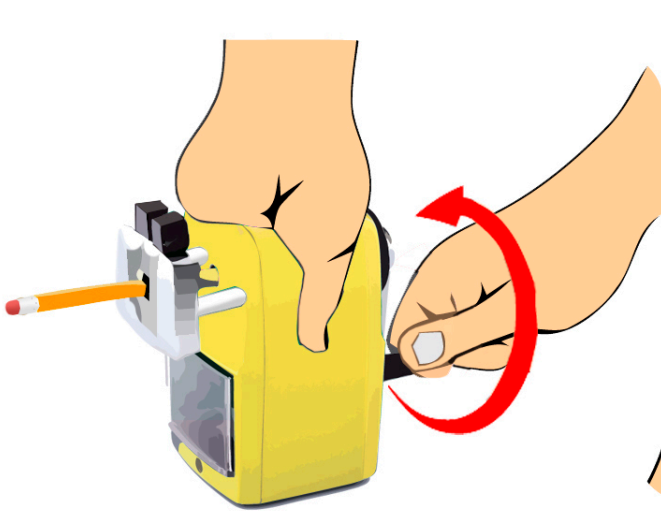

3. Place one hand on top of the sharpener to hold it secure. Do not hold onto the pencil while sharpening. Turn the handle clockwise to sharpen. The face will pull the pencil in automatically. The handle will spin freely once the pencil is fully sharpened.



4. Pinch the 2 black knobs to release the pencil once sharpened.

A perfect sharpen every time!

For tips on how to use and repair your sharpener please visit
www.classroomfriendlysupplies.com/pages/help-portal



1. Pull the silver face forward until it locks in place.

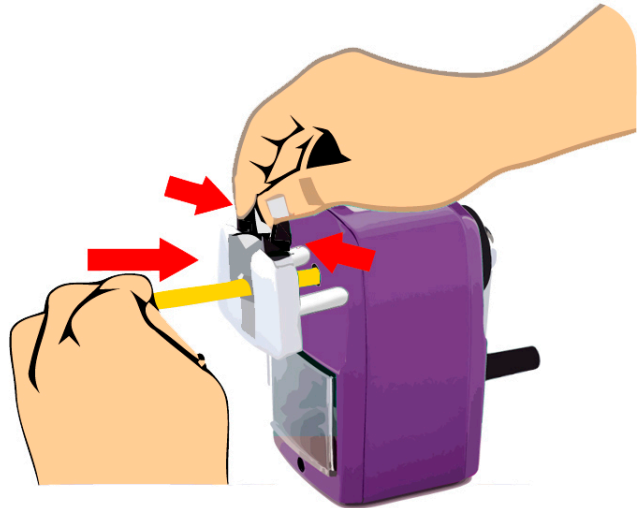

2. Pinch the 2 black knobs together and insert your pencil completely into the sharpener. When you release the knobs they will hold the pencil securely in place.

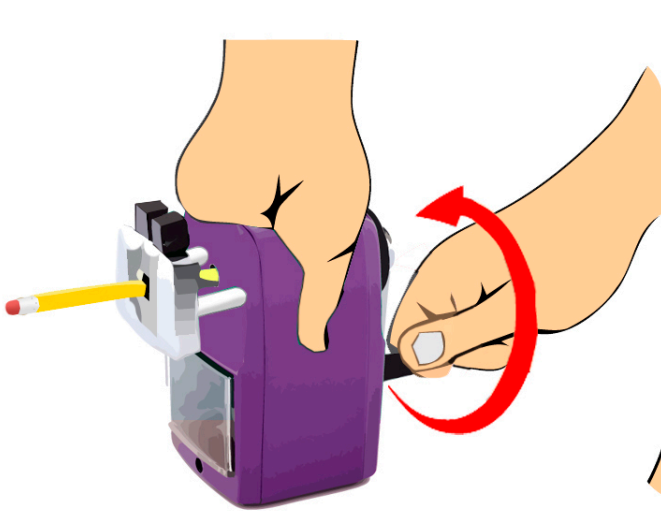

3. Place one hand on top of the sharpener to hold it secure. Do not hold onto the pencil while sharpening. Turn the handle clockwise to sharpen. The face will pull the pencil in automatically. The handle will spin freely once the pencil is fully sharpened.

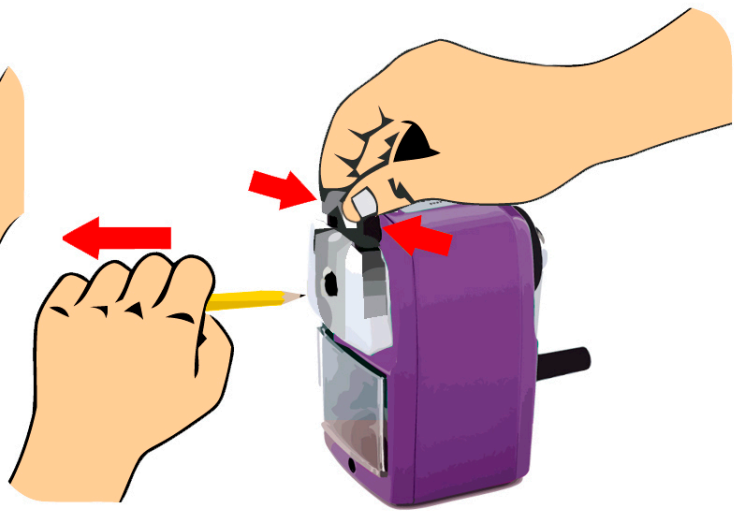

4. Pinch the 2 black knobs to release the pencil once sharpened.

A perfect sharpen every time!

For tips on how to use and repair your sharpener please visit
www.classroomfriendlysupplies.com/pages/help-portal