

• ABOUT US •

Driven by the passion for innovation, we at Dr Trust endeavour to provide our customers with the latest medical inventions with an objective to promote good health and wellness all around the world. All the medical devices and health monitors provided by Dr Trust are supported by accurate, latest and ground breaking technologies, innovated at our headquarter in NY, USA. All our products adhere to the most stringent CE and FDA guidelines and are strongly recommended by doctors and health practitioners. Our products are designed in the utmost exemplary ways to ensure that their accuracy and convenience are unrivalled. The ease of their use and operation makes them even more suitable for users of all age groups.

Dr Trust strives to enhance the quality of lifestyle by providing with the most trusted and innovative health care and wellness products. Being a renowned global leader in health care products, Dr Trust ensures that our technically efficient team works dynamically and tirelessly to provide the best of the medical devices to our clients. The products that we have to offer are suitably designed for use at homes, laboratories and hospitals.

Our ground breaking solutions allow you to monitor your health in the easiest ways possible. In today's era when all of our lives are too hassled to handle, it becomes a bit difficult to pay attention to our health. But it has now become easier with the coming of the monitoring devices which can be conveniently used at homes and even on the go.

We bring to you a variety of best self medical devices, trusted and used by Doctors, medical professionals and home users all over the world.

Dr Trust Manual Breast Pump - 6001

• QUICK STARTUP GUIDE •

Step 1

Before use, wash your hands and all components of the breast pump.

Step 2

Assemble all the components correctly.

Step 3

Sit comfortably and let the suction cup with the breast to express milk efficiently.

Step 4

Adjust the suction level to your comfort level and start extracting milk manually.

• INTRODUCTION •

Congratulations on your decision to give your baby the best possible start in life by opting breastfeeding. Breastmilk is always best because it benefits both - mother and baby. Providing breastmilk for your baby is not easy especially when you are a working or cannot be at home with your baby for any other reason. Dr Trust manual breast pump is a useful option as it offers a great amount of comfort and ease for those mothers who pump occasionally. To extract milk, squeeze the lever by hand repeatedly to create the needed suction. It does not have a motor so works silently. It is portable as it does not require a power source for operations.



6001

• KEY FEATURES •

- Ergonomic handle design
- Powerful suction
- Quiet & compact
- Easy to install & clean
- Adjustable
- PPSU bottle
- Temperature-resistance
- Non-toxic odorless
- Can connect wide-neck bottles after suction

• BENEFITS OF PUMPING •

The benefits of pumping milk include the following:

1. It makes easier for people to split caregiving duties.
2. Sharing the feeding time offers some convenience to mothers and they feel more rested.
3. It helps to promote a positive balance of childcare duties.
4. This ability to share feedings can be beneficial in the immediate postpartum period.
5. Helps in controlling the timing of feedings which means you have more free time.

• INSTALLATION WARNINGS & USAGE METHOD •

! Danger

If you do not take appropriate preventive measures, it will result in serious personal injury. So please perform operation carefully to avoid big mistakes.

! Attention

Please stay away from heat. Do not use it directly into sunlight.

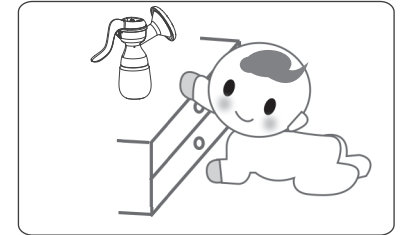

The product is not a toy. Please keep it out of reach of children.

Warning

The breast pump helps Moms to prevent unnecessary discomfort of a swelling breast because of prolonged breast-feeding time. The idea of usage of a breast pump helps in collecting adequate breast milk to let somebody else feed your baby when you are away from home. Blocked breast (some is caused by dent mamilla) or milk shortage is often existed among some new Moms. They are advised to have a professional examination for unimpeded breast before buying breast pump rather than making breast pump as milk opening device blindly. Babies who feed exclusively on pumped milk do gain access to a well-designed food that is rich in healthful fats and antibodies.



Attention

Before use, please wash, disinfect fittings. After using, wash and maintain component dry immediately.

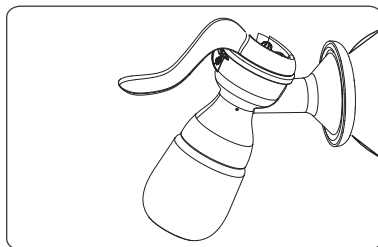
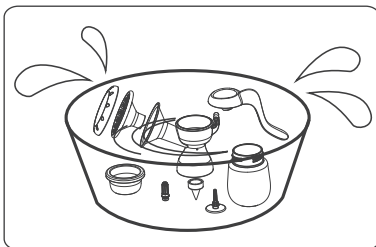

Please do not pump breast excessively in case any injuries.

- When assembling and dismantling the breast pump, please make sure all the components are assembled properly.
- When washing the breast pump, please take care of the small components, so as to avoid abnormal working status due to components loss.
- Please consult to the physician if you have any problem with your pump or when not able to extract milk successfully through using the product.
- Adjust the suction level to your comfort level.
- Please stop sucking immediately and consult doctor when you feel unusual of pump or breast.
- This product is only for extracting milk manually.

Reminder

- There is S shape nipple in gift box, used for 0-3M babies.
- Please change the nipple every two months.
- If the nipple is damaged, please replace it immediately in order to avoid the risks.
- You can use the nipple pin to prick the nipple hole to keep it unblocked.

LIST OF COMPONENTS

Check the accessories before use, if there is lack of components, please contact the seller.

No.	Name	Material	Heat	Cold	Quantity
A	Soft breast shield	silica gel	200°C	-20°C	1
B	Suction cup	PP	120°C	-20°C	1
C	Suction silicone	silica gel	200°C	-20°C	1
D	Suction bar	POM	110°C	-20°C	1
E	Suction adjustable knob	PP	120°C	-20°C	1
F	Handle	PP	120°C	-20°C	1
G	Beast shield cover	PP	120°C	-20°C	1
H	Valve	silica gel	200°C	-20°C	1
I	Bottle(160ml)	PPSU	180°C	-20°C	1
J	Bottle cap	PP	120°C	-20°C	1
K	Screw cap	PP	120°C	-20°C	1
L	Nipple	silicone	120°C	-20°C	1
M	Nipple pin	PP	120°C	-20°C	1
N	Instruction manual	/			



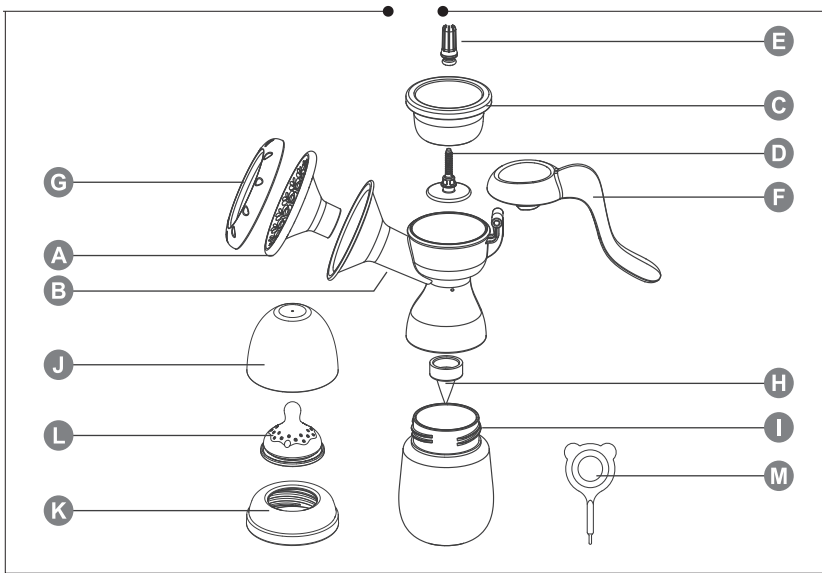

• INSTALLATION METHOD •

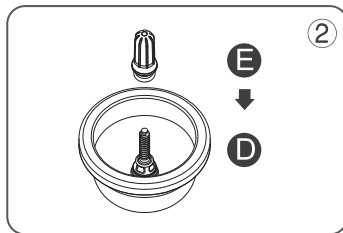
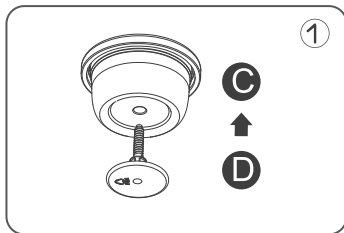

Twist suction adjustable knob.



Put it in the pump body and make sure the edge of suction silica gel is fastened to the pump body.

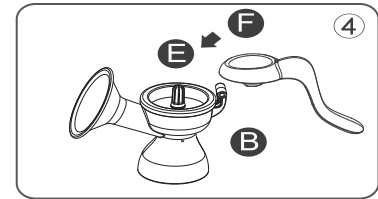

Fasten the handle to the suction adjustable knob and the breast pump.

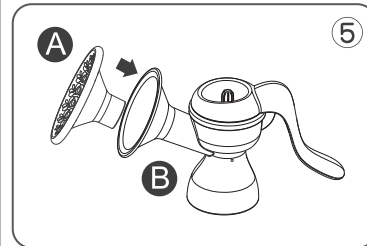

Assemble soft Breast Shield into pump body to make sure the edge of sucking silica is fastened to the pump body.

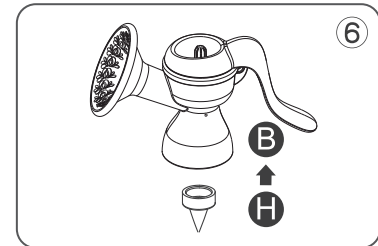

Assemble the valve into the column inside the pump body.



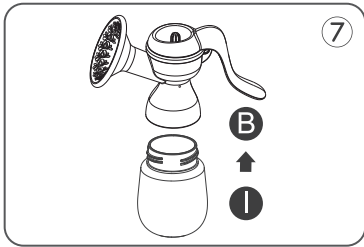

Put the suction Cup into bottle. Keep them closely.

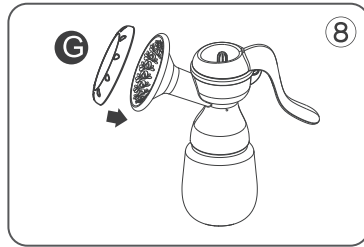

Cover with the breast Shield Cover.

RIGHT USAGE

1. Moms should have a comfortable sitting posture.
2. Ensure that all parts are correctly assembled.
3. Let the suction cup with the breast and hold the breast pump in upright position.

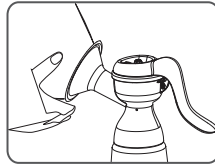

- Please grip the handle to make suction comfortably.
- Wash and sterilize all parts of the breast pump after using.
- Allow all parts of pump to dry completely before keeping in dry and cool place.

CLEANING & MAINTENANCE

- After using, please wipe the motor with a clean wet cloth.
- You can put the other components into sterilizer for sterilizing.

- When assembling and dismantling the breast pump, please make sure all the components are assembled properly
- When washing the breast pump, please take care of the small components, so as to avoid abnormal working status due to components loss.
- Do not immerse the pedestal in water when cleaning; suggest wiping with a clean cloth only.

ELIMINATING METHODS OF LACKING SUCTION

Confirm the breast cover is surrounding the breast properly.

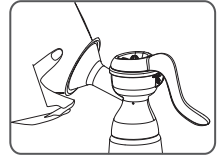

Check the soft breast shield, suction cup, suction silicone, suction bar, suction adjustable knob, handle and valve, all are installed correctly.

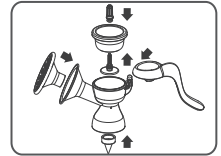

HOW TO STORE AND WARM THE BREAST MILK

	Room temperature	Refrigerator	Freezer	independent freezer
Freshly expresses into close container	No	3-5days(4°C or lower)	6months(-6°C)	12months(-18°C)
Previously frozen-thawed in	No	0hours	No refrigerator but not warmed or used	



1. Sterilize and clean the feeding bottles before storing the breast milk. Use 4oz (app 120 ml) or 5oz (app 150 ml) bottle for easy thawing and warming.
2. Write the date and time of milk expression and label it on the feeding bottles to ensure that the bottle of the earlier extracted milk will be consumed first.
3. Breast milk stored in freezer should be taken out and placed in refrigerator to thaw, the night before you use it.
4. When it is time for feeding, remove the milk from refrigerator. Shaking the contents gently to blend the fats that may have separated.
5. Do not thaw breast milk at room temperature
6. Do not refreeze milk once thawed.

! IMPORTANT

Microwaving breast milk is not recommended.

TECHNICAL SPECIFICATIONS

Product Name	Dr Trust Manual Breast Pump - 6001
Suction Strength	350 mmHg
Material	PP, Silicon
Features	Large & adjustable suction power, Ergonomic handle, labor-saving, BPA-free
Pump Size	20x8.5x17.5 cm
Unit Weight	220g

CUSTOMER SUPPORT

CONTACT ADDRESS

USA

Nureca INC.USA
276 5th Avenue, Suite 704-397,
New York (NY) - 10001, USA

INDIA

Corporate Office (Mumbai)

Nureca Limited
128 Gala Number Udyog Bhavan,
1st Floor Sonawala Lane, Goregaon East
Mumbai City Maharashtra 400063

Contact us

India: +91-7527013265 /+91-9356658436

Website: www.drtrust.in

Corp Website: www.nureca.com

Email: customercare@nureca.com

Connect with us on social networks

Facebook: @drtrust

Instagram: @drtrustisin

Youtube: NurecaUSA

COPYRIGHT©2021 NURECA LTD ALL RIGHTS RESERVED



Scan to View
Product Demo Video
www.drtrustusa.com/6001