

• ABOUT US •

Here at Dr Physio USA, we make the most imaginative, unwinding, and restorative, well-being and individual care Products.

In the hubbub of today's lifestyle, it becomes impossible to nurture yourself at times. In the chaos of maintaining every aspect of life efficiently, we forget that our bodies are not machines. they need absolute care and tenderness. Pain in neck, shoulder, back or foot should never be taken for granted. They can lead to serious ailments in the long run. To help you ease the situations of painfulness, Dr Physio USA brings to you excellent ways of relaxation and pain relief through our premium gadgets. We offer a non-intrusive answer to help renew and reestablish your muscles and relieve throbbing pain with our various products

The variety of items and massagers we offer are intended to target particular areas of the body viz neck, shoulder, back, foot and so on. the adaptable capabilities of our gadgets are meant for utmost body relaxation after a long day at work.

Sit Back, Relax and enjoy the amazing Dr Physio experience by Dr Trust!!

Dr Physio from Dr Trust
www.drphys.io | www.drtrust.in

Dr Physio

FOOT SPA MASSAGER WITH MANUAL ROLLER - 1004

• Quick Start Guide •

Step 1

Keep the Dr Physio Foot Spa Massager in a comfortable place near to the power source.

Step 2

Fill the bathtub with warm water and plug into the power source.

Step 3

Soak your feet in the tub and press the power button to generate bubbles and heating.

Step 4

Place your feet on the massage rollers and start rolling them back and forth.

Step 5

For customized experience, press bubbles, red light, and heating buttons on control panel.

Step 6

Press the power button again to shut off all functions.

Note :

You can add rose petals to enhance your sensory experience. Avoid adding essential oils in the tub as this could damage it.



• INTRODUCTION •

Dr Physio Foot Spa Massager with Manual Roller is designed to get a professional level spa massage from the comfort of your home couch. With quick and effective heating, its functionality can be controlled using the digital panel in the front of the machine. It is fully enclosed to reduce heat emission and improving heat speed. Foot Spa massager has IPX4 waterproof rating which ensure protection against water spray.

- 4 mechanical rollers
- The digital display controls functions
- Lightweight and portable unit with handle
- Infrared Heating heat the water quickly

• IMPORTANT SAFEGUARDS •

- When using electrical appliance, in order to reduce the risk of fire, electric shock, and injury to persons, basic safety precautions should always be followed.
- This appliance is not intended for use by children or disabled persons without supervision. Never leave appliance unattended when in use.
- Young children should be supervised to ensure they do not play with this appliance.
- Switch off and remove the plug from the power outlet before cleaning, filling, moving, or when not in use. To unplug, grasp the plug and remove from the power outlet.
- Never pull from the cord itself; Never carry the appliance by the cord.

- Do not operate the appliance if it has a damaged cord or begins to malfunction in any manner.
- Do not attempt to repair or disassemble the appliance. There are no user serviceable parts.
- Do not use it outdoors.
- Do not use while bathing or showering.
- Do not place or store the appliance where it can fall or be pulled into a sink or tub.

• PRODUCT STRUCTURE •

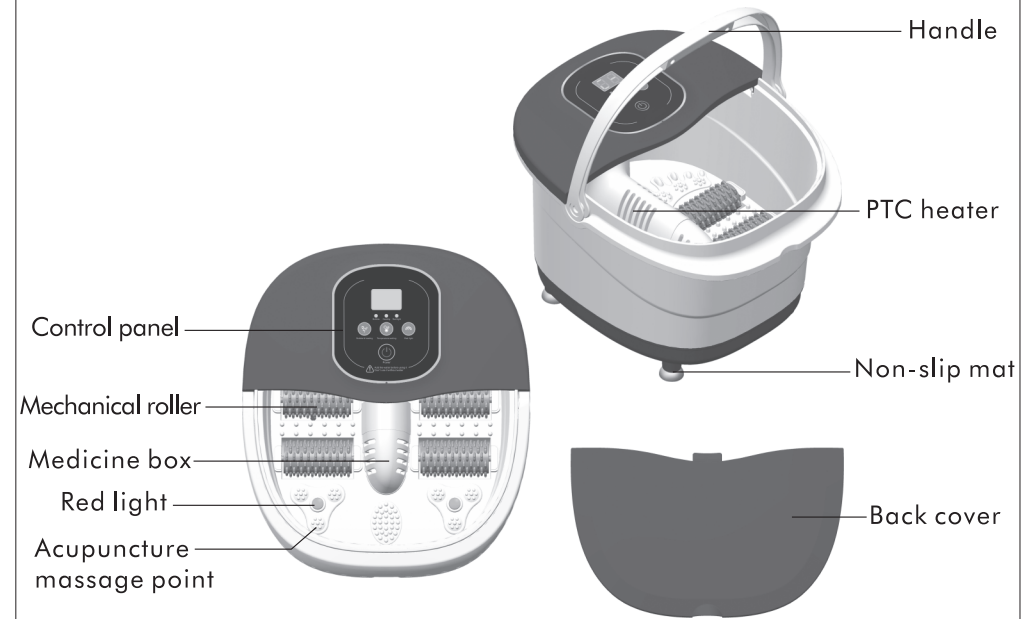

CONTROL PANEL

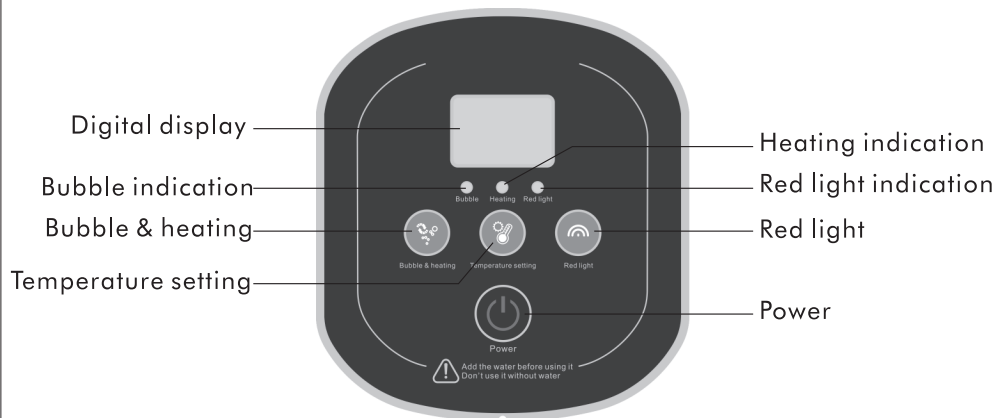

OPERATION

Power

Press the power button to generate bubbles with heating function (the default setting of this machine for 60 minutes, the default set temperature is 42° C). If you press the power button again, all functions shut off.

Note:

While the power is connected, the switch light of product will flash, the digital display screen will show "OF".

Bubble & Heating

While working, press this button for bubbles & heating function. Bubble and heating indicator light ON or OFF with pressing.

Temperature Setting

By pressing this button, you can increase temperature by 1° C. The temperature range is 35° C to 48° C, while setting temperature, the display shows the set temperature and after 3 seconds automatically return to display the current temperature. When the water reaches temperature you set, the heating function will be off automatically.

Red Light

While working, press this button to open or close red light function.

WARNING

- Never immerse the Foot Spa in water or other liquids.
- Always check the temperature of the water before placing your feet into the tub.
- Do not stand in the unit.
- To use it safely, please sit down and place your feet in the appliance.
- Ensure that your hands are dry when operating the switch or removing the plug.



- Keep cord away from heated surfaces.
- Do not sleep while using or operating the device.
- Never drop or insert objects into the appliance.
- Do not operate under a blanket or pillow to prevent excessive heating. Excessive heating could cause a fire, electrical shock, or injury.
- If you have any concern regarding your health, consult with a doctor prior to using the appliance.
- Individuals with a pacemaker should consult a physician before using the appliance.
- In case of pregnancy, diabetes, or illness, consult your doctor before using the appliance.
- Never use the appliance if open wounds, sever bruising, swelling, burns, inflammation or open lesions are present.
- Discontinue using it if you experience pain or discomfort. You can also consult your doctor.
- Do not use bath oils, gels, or other substances. The device should only be filled with water.
- Do not attempt to plug or unplug the appliance while feet are in the water.
- Do not use attachments not recommended in the user manual.

• **TROUBLESHOOT** •

| Symptom | Cause | Treatment |
|----------|-----------------------------------|---|
| No power | Power plug is not plugged in | Connect the power plug in the correct way |
| | Power button not pressed properly | Press the power button |

| | | |
|-----------------|------------------------------------|--|
| Unable to heat | Current water temperature too high | Increase temperature setting |
| Stopped working | Preset time is up | Reset time |
| | Current water temperature too high | Wait for water to cool or add cool water |

• **MAINTENANCE** •

To Clean

- Never allow water on any other liquid to meet the control panel of the device.
- After cleaning, wipe the surface with a dry cloth.
- Never use abrasives, detergents, or cleaning agents.
- Periodically straighten the cord if it becomes twisted.

To Store

- Unplug the appliance from the outlet and allow it to cool.
- Store it in its box or in a clean and dry place.
- To avoid breakage, do not wrap the power cord around the unit.
- Do not hang the appliance by the power cord.



• TECHNICAL SPECIFICATIONS •

| | |
|---------------------|----------|
| Power | 500W |
| Waterproof Rating | IPX4 |
| Highest Temperature | 48 ± 2°C |

• CUSTOMER SUPPORT •

CONTACT ADDRESS

USA

Nureca INC.USA
276 5th Avenue, Suite 704-397,
New York (NY) - 10001, USA

INDIA

Corporate Office (Mumbai)

Nureca Limited
128 Gala Number Udyog Bhavan,
1st Floor Sonawala Lane, Goregaon East
Mumbai City Maharashtra 400063

Contact us

India: +91-7527013265 /+91-9356658436

Website: www.drtrust.in

Corp Website: www.nureca.com

Email: customercare@nureca.com

Connect with us on social networks

Facebook: @drtrust

Instagram: @drtrustisin

Youtube: NurecaUsa

COPYRIGHT©2021 NURECA LTD ALL RIGHTS RESERVED



Scan to View
Product Demo Video
www.drtrustusa.com/1004