

• ABOUT US •

Driven by the passion for innovation, we at Dr Trust endeavour to provide our customers with the latest medical inventions with an objective to promote good health and wellness all around the world. All the medical devices and health monitors provided by Dr Trust are supported by accurate, latest and ground breaking technologies, innovated at our headquarter in NY, USA. All our products adhere to the most stringent CE and FDA guidelines and are strongly recommended by doctors and health practitioners. Our products are designed in the utmost exemplary ways to ensure that their accuracy and convenience are unrivalled. The ease of their use and operation makes them even more suitable for users of all age groups.

Dr Trust strives to enhance the quality of lifestyle by providing with the most trusted and innovative health care and wellness products. Being a renowned global leader in health care products, Dr Trust ensures that our technically efficient team works dynamically and tirelessly to provide the best of the medical devices to our clients. The products that we have to offer are suitably designed for use at homes, laboratories and hospitals.

Our ground breaking solutions allow you to monitor your health in the easiest ways possible. In today's era when all of our lives are too hassled to handle, it becomes a bit difficult to pay attention to our health. But it has now become easier with the coming of the monitoring devices which can be conveniently used at homes and even on the go.

We bring to you a variety of best self medical devices, trusted and used by Doctors, medical professionals and home users all over the world.

Dr Trust Electric Breast Pump – 6002

• QUICK STARTUP GUIDE •

Step 1

Wash your hands thoroughly and clean your breast.

Step 2

Assemble the breast shield, milk bottle, tubing, breast pump, and AC/DC adaptor (or battery) properly.

Step 3

Press the assembled pump body against your breast and make sure that your nipple is centered in the breast shield.

Step 4

Press the power button to start pumping with massage mode.

Step 5

Depending on your personal choice and comfort, you can set the level of suction by pressing the buttons on the control panel.

Step 6

When the milk starts flowing, adapt the suction rhythm to continue comfortable pumping.

NOTE:

Do not need to use all suction modes, only choose the modes that are comfortable for you.

When pumping becomes uncomfortable or painful, stop using the pump.

Always turn off the breast pump before you remove the pump body from your breast.



• IMPORTANT! •

- *The appliance is only to be used with the right power supply.*
- *Children shall not play with the appliance.*
- *It can be used by children aged from 8 years and above under supervision.*
- *Persons with reduced physical, sensory, or mental capabilities or lack of experience and knowledge can use if they have been given supervision or instructions concerning use of the appliance in a safe way.*

• INTRODUCTION •

Dr Trust Electric Breast Pump – 6002 is a single electric breast pump designed for nursing moms to pump breast milk in order to allow the baby to enjoy the benefits of breastfeeding even when they are not around. It has 9 adjustable pumping speed, 2-Phase Expression Technology, portable feature through volume and a power design. The pump can imitate baby's sucking rhythm through a microcomputer and can help nursing moms complete breast milk collection under a most comfortable and efficient way. It gives mothers independence to select their preferred speed and suction level. There are two options for powering the instrument. It starts working when plugged into a wall outlet or powered by batteries.

• MAIN FEATURES •

2-Phase expression

2-phase expression is a "2 speed" pumping process which emulates 30 minutes automatic scientific lactation cycle. When the pump start, it will do 2 minutes massage firstly, then automatically transferred to the 28 minutes milking. You can use 1 button to control 2-Phase switching while massage setting help to make fast frequency simulation of breast milk secretion by imitating baby sucking rhythm. All this lets moms feel more comfortable.



430 mmhg suction, 9 suction levels

The pump provides gentle and comfortable pumping. Motor provides 430 mmhg suction and produces less sound during usage. 9 suction levels let mothers collect milk for baby more easily as they give freedom to choose the most comfortable level as per their need.



Back flow preventer

Back flow preventer prevents milk backflow. Even if the milk is too much or over bottle. It will also not damage the motor.



Dual-ring silica gel cup

Unique dual-ring silica gel cup is designed according to human body engineering. It fits perfectly to the breast to let suck more smoothly. It follows rhythm and make the pumping process more comfortable.



Compatible with various power supplies

Mother can collect milk anywhere. AC/DC applied; DC mode necessitates 4 AA batteries whereas there is also an AC 100V-240V adapter for connection to infrastructural electricity.



Mini Design

Silicon Keypad and coating on the bottom side to prevent slippage.



• LIST OF COMPONENTS •

No.	Name	Material	Heat	Cold	Quantity
A	Soft Breast Shield	Silica Rubber	200°C	-20°C	1
B	Funnel Unit	PP	120°C	-20°C	1
C	Diaphragm	Silica Rubber	200°C	-20°C	1
D	UP Shell	PP	120°C	-20°C	1
E	UP Bottle Adapter	PP	120°C	-20°C	1
F	Valve	Silica Rubber	200°C	-20°C	1
G	Bottle (120ml)	PP	120°C	-20°C	1
H	Bottle Stand	PP	120°C	-20°C	1
I	Breast Shield Cover	PP	120°C	-20°C	1
J	Hose set	Silica Rubber	200°C	-20°C	1
K	Motor	ABS	80°C	-20°C	1
L	AC/DC Adapter				1

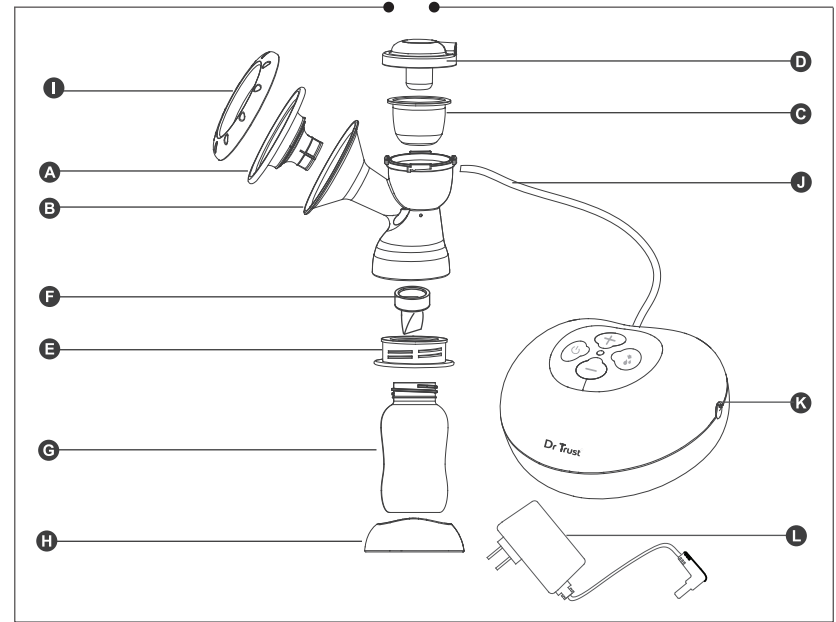

• CAUTION •

- For optimum performance, please use AC adapter.
- When breast pump is not in use for long periods, remove all batteries and unplug AC/DC adapter from the outlet.
- Do not use while sleeping and drowsy.
- Do not use AC/DC adapters that are Non-compatible with the product.
- Do not immerse pump into water.



- When assembling and dismantling the breast pump, please make sure all the components are assembled properly. When washing the breast pump, please take care of the small components, to avoid abnormal working status due to components loss.
- This is not a toy, please keep out of reach of children.
- Adjust the suction level as per your comfort level.
- Suitability of suction power varies from user to user. The maximum suction settings have been optimized to prevent injuries to users when expressing breast milk. If the maximum suction level does not provide you with an adequate suction pressure, please consult your physician.
- Please do not pump breast excessively in case any injuries.
- Please consult to the physician if you have any ache during using the product.
- Please consult to the physician if you have any problems with your mamilla and cannot extract milk successfully through using the product.
- Before use, please ensure the components are cleaned and sterilized
- After use, please clean and dry the components immediately, do not clean and sterilize the motor and AC adapter by water.
- Never operate this product if it has a damaged cord and plug, any missing component, is not working properly, or it has been dropped into water.

• CLEANING •

- After use, please wipe the motor with a clean wet cloth.

- Do not clean the motor and AC/DC adapter in water.
- Except motor, AC/DC adaptor and battery shell, you can put the other components into sterilizer for sterilizing.
- When assembling and dismantling the breast pump, please make sure all the components are assembled properly.
- When washing the breast pump, please take care of the small components, to avoid abnormal working status due to components loss.
- Before cleaning, please disconnect the power cord and wait till it will cool down.
- Do not immerse the pedestal in water when cleaning; suggest wiping with a clean cloth only.
- Small Bowl, top lid can clean by detergent.

Attention!

- It is better to use the adapter.
- Overflow protection device avoid milk flowing back to motor when the bottle is tilted.
- Do not let the hose set be knobbed and knotted. Read instructions before use to understand how to handle the product with care.
- Always store in a dry place.
- When the room temperature is below 15°C, please let the motor work 30 minutes before use.



ASSEMBLY

- ① Insert breast shield into funnel unit. Make sure it is securely fitted.

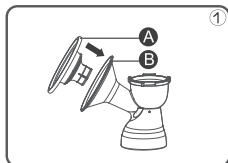

- ② Fit the diaphragm into the funnel unit under the close cover.

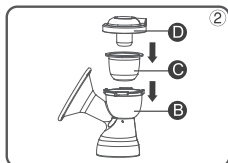

- ③ Insert the valve into the bottom of funnel unit.

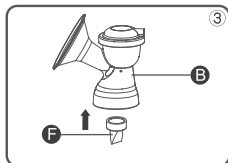

- ④ To pump milk into standard bottle, fit the small adapter into the funnel unit, followed by the bottle into the adapter as shown.

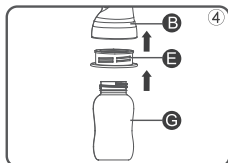

- ⑤ Plug in one end of the hose to cover and the other to the motor.

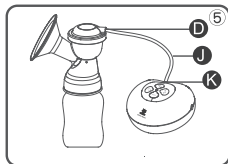

- ⑥ Place the bottle onto bottle stand.

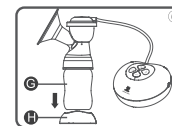

Note

Ensure that all the attachments are assembled correctly before use.

- ⑦ Connect the adapter to the motor.

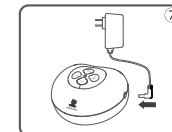

- ⑧ Power cord connect to electrical socket outlet.

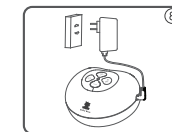

Assemble AC/DC Adapter to Pump Module

It is better to use adapter

When DC voltage is greater than 7V or less than 4V, the red-light indicator will start blinking.

INSTALL BATTERIES

- ⑨ Open the battery cover.

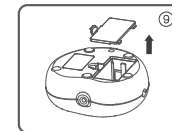

- ⑩ Insert 4 X AA high capacity Non-rechargeable batteries according to the polarities.

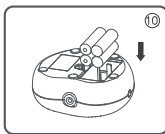

When breast pump is not in use for long period, remove batteries from motor. The motor can work nearly 3 hours under battery power condition, the sucking pressure will decrease if the residual battery power is lessened.

- ⑪ 2-Phase expression

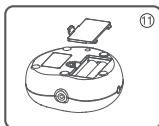

- ⑫ Finish.

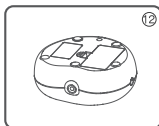

• OPERATING INSTRUCTION •

- ① Power: ON/OFF

- ② Dual mode: Massage (red light) / Pumping (green light)

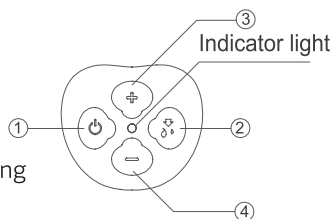

Panel of Pump Module

- ③ Press "+" to increase the suction pressure, there are 9 levels of suction level, when the red/green light indicator starts blinking, you have reached the highest suction pressure level.

- ④ Press "-" to reduce the suction pressure, when the red/green light indicator starts blinking, you have reached the lowest suction pressure level.

- ⑤ Press ON/OFF button, pump module always starts with massage mode, Red light indicator will light up.

- ⑥ Press Dual Code button, the message code will switch to pumping mode, light indicator will turn green.

The product is 2-phase expression designed, 1 button to control two phase switching, massage setting help to make fast frequency simulation of breast milk secretion, imitating baby sucking rhythm, let moms feel more comfortable.

• RIGHT USAGE •

1. Ensure parts are correctly assembled.
2. Ensure batteries or AC/DC adapter are properly assembled to pump module.
3. Mother to have comfortable sitting posture.
4. Hold breast pump in upright position, align one breast to the silicon breast shield for a proper and complete fit such that there is no space in between. (figured as pic.)

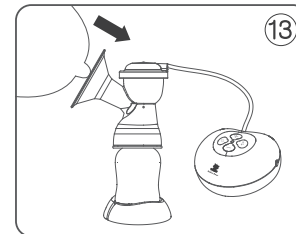

5. Press power button, light indicator turns red, pump is operating in massage mode.
6. Press "+" or "-" to increase and decrease the suction pressure as desired, there are 9 levels of suction pressure, when red/green light indicator start blinking, you have reached the highest or lowest suction pressure level. The default setting for suction pressure of pumping mode is set at level 5.
7. 30 minutes automatic cycle to provide scientific lactation cycle, 2 minutes massage, then automatically transferred to the 28 minutes milking.
8. How to find your most comfortable suction pressure level: please increase the suction pressure level until you feel little ache, then decrease the suction pressure level.
9. After use, press ON/OFF button, the light indicator will go out, turn off the power and disconnect the plug.
10. Wash and sterilize all breast pump part (except pump module and adapter) after use.
11. Allow parts to dry completely before keeping in dry and cool place.

• TROUBLESHOOTING •

Pump Module

- When inserting batteries, make sure that the polarities are correct.
- Remove batteries with low charge.
- Ensure that the ends of the hose are fitted properly to breast pump and motor unit.

Insufficient Suction Pressure

- Make sure all parts are assembled correctly.
- Batteries are on low or no charge.
- Check if the valve is correctly inserted.
- Ensure breast is aligned to the breast shield with no gaps in between.

• HOW TO STORE AND WARM THE BREAST MILK •

	Room temperature	Refrigerator	Freezer	Independent freezer
Freshly expressed into closed container	No	3-5days(4°C or lower)	6months(-6°C)	12months(-18°C)
Previously frozen-thawed in	No	0hours	No refrigerator but not warmed or used	

Source : *Breastfeeding : A guide for the medical professional*

- Sterilize and clean feeding bottles before storing the breast milk. Use 4oz/5oz bottle for easy thawing and warming.
- Write the date/milk of time expression and label it on the feeding bottles, so as to ensure that the bottle of the earlier date/milk will be consumed first.
- Breast milk stored in freezer should be taken out and placed in the refrigerator to thaw, the night before you need it.
- Do not thaw breast milk at room temperature. Do not refreeze milk once thawed.
- When it is time for feeding, remove the milk from refrigerator. Shaking the contents gently to blend the fats that may have separated.
- Microwaving breast milk is not recommended.



• **PRODUCT INFORMATION** •

Name:	Electric Breast Pump
Suction Strength	stimulation appx. -40~-160mmHg
Expression Appx.	-160~-300mmHg
Suction Level:	stimulation 9, expression 9
Output Voltage	6VDC
Power Supply	100V~240V
Power Source:	AC adapter or AA battery
Rate of Power	3.6W
Working Environment	Indoor Use Working Temperature: 15~30°C Working Humidity: 50~80%
Highest suction	Motor: 430mmhg+5%
Pump Unit Weight:	242g
Pump Size:	12x11.6.2cm
Unit Weight:	495g
Material:	PP, silicone

• **CUSTOMER SUPPORT** •

CONTACT ADDRESS

USA

Nureca INC.USA
276 5th Avenue, Suite 704-397,
New York (NY) - 10001, USA

INDIA

Corporate Office (Mumbai)

Nureca Limited
128 Gala Number Udyog Bhavan,
1st Floor Sonawala Lane, Goregaon East
Mumbai City Maharashtra 400063

Contact us

India: +91-7527013265 /+91-9356658436

Website: www.drtrust.in

Corp Website: www.nureca.com

Email: customercare@nureca.com

Connect with us on social networks

Facebook: @drtrust

Instagram: @drtrustisin

Youtube: NurecaUsa

COPYRIGHT©2021 NURECA LTD ALL RIGHTS RESERVED



Scan to View
Product Demo Video
www.drtrustusa.com/6002