

• ABOUT US •

Driven by the passion for innovation, we at Dr Trust endeavour to provide our customers with the latest medical inventions with an objective to promote good health and wellness all around the world. All the medical devices and health monitors provided by Dr Trust are supported by accurate, latest and ground breaking technologies, innovated at our headquarter in NY, USA. All our products adhere to the most stringent CE and FDA guidelines and are strongly recommended by doctors and health practitioners. Our products are designed in the utmost exemplary ways to ensure that their accuracy and convenience are unrivalled. The ease of their use and operation makes them even more suitable for users of all age groups.

Dr Trust strives to enhance the quality of lifestyle by providing with the most trusted and innovative health care and wellness products. Being a renowned global leader in health care products, Dr Trust ensures that our technically efficient team works dynamically and tirelessly to provide the best of the medical devices to our clients. The products that we have to offer are suitably designed for use at homes, laboratories and hospitals.

Our ground breaking solutions allow you to monitor your health in the easiest ways possible. In today's era when all of our lives are too hassled to handle, it becomes a bit difficult to pay attention to our health. But it has now become easier with the coming of the monitoring devices which can be conveniently used at homes and even on the go.

We bring to you a variety of best self medical devices, trusted and used by Doctors, medical professionals and home users all over the world.

Dr Trust

Compressor Nebulizer with Flow Adjuster - 407

• QUICK STARTUP GUIDE •

Step 1

Place the compressor nebulizer on a flat surface.

Step 2

Gently twist the top part of it counterclockwise to disassemble the nebulizer.

Step 3

Fill the prescribed medication in the chamber and reassemble the nebulizer.

Step 4

Attach the nebulizer and compressor through the air tube.

Step 5

Attach mouthpiece or mask to the top section of the nebulizer.

Step 6

Plug-in and press the power button to begin your treatment.



• PRODUCT OVERVIEW •

Dr Trust Compressor Nebulizer with Flow Adjuster -407 is intended for use in the treatment of asthma, COPD, and other respiratory ailments in which an aerosolized medication is required during therapy. It is a 220 V AC-powered air compressor system intended for delivery of prescribed medications in aerosol form to the bronchial lung passages. Users can have many years of reliable treatment with proper care and use of this product. It helps in the treatment of asthma, allergies, and other respiratory disorders. It creates a stream of air that travels through clear tube to the nebulizer. When air enters the nebulizer, it will convert the prescribed medication into aerosol mist for easy inhalation. The system is compact and suitable for use with both children and adults in the home, hospital, and clinic settings, etc.

- **Note:**
- Consult with your physician or pharmacist to determine if your prescription medication is approved for use with this Nebulizer.
- The nebulizer is intended for single patient use in one time.
- Any use of this product other than its intended use should always be avoided.

• PRODUCT IDENTIFICATION •

Dr Trust Compressor Nebulizer with Flow Adjuster -407 comes with a complete nebulization kit and the following components.

- Compressor (Main Unit)
- Medicine Chamber
- Mouthpiece
- Adult Mask (PVC)
- Child Mask (PVC)
- Air Tube (PVC)
- Nose Piece
- Air Filters (Package of 5)

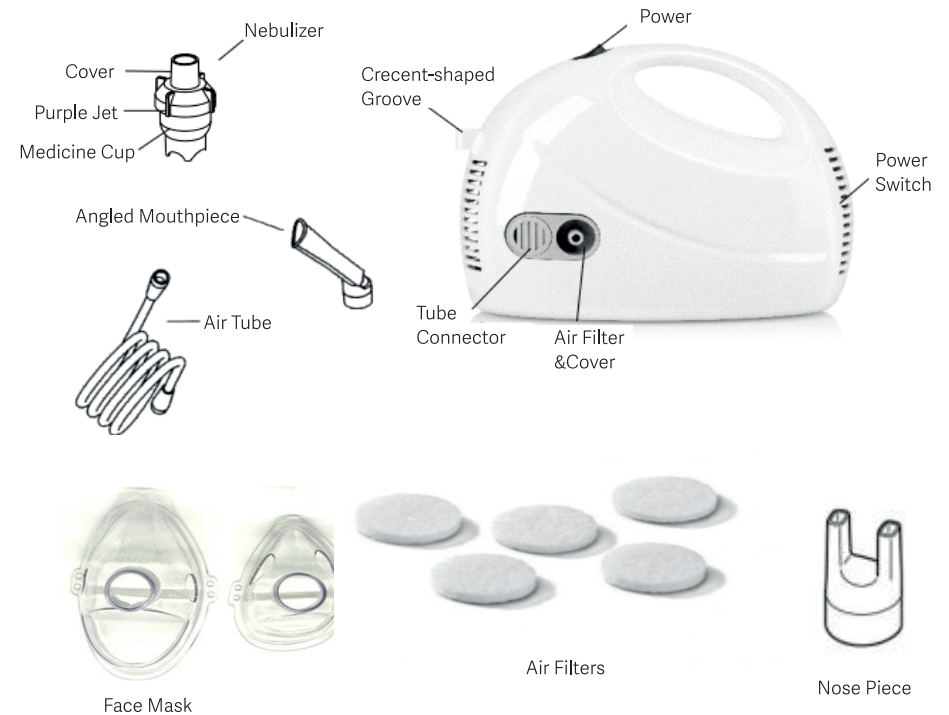

• **CAUTION** •

1. Never operate the unit if it has any damaged parts or power cord.
2. If it has been dropped or submerged in water Promptly send it to a service center for examination and repair.
3. The unit should not be used where flammable gas, oxygen or aerosol spray products are being used.
4. Keep the air vents open. Do not place the unit on a soft surface where the openings can be blocked.
5. Always connect this product to an appropriate voltage outlet for your model.
6. Do not run this product unattended.
7. If any abnormality occurs, discontinue use immediately until the unit has been examined and repaired.
8. Always unplug the product immediately after use.
9. If the medicine cup is empty, do not attempt to operate the unit.
10. The unit should not be left unattended while plugged in.
11. Do not tilt or shake the unit when in operation.
12. Disconnect the unit from the electrical outlet before cleaning, filling, and after each use.
13. Do not store the unit under direct sunlight, high temperature, or humidity.
14. Keep the unit out of reach of small children.

15. Always keep the unit unplugged while not in use.
16. To avoid electrical shock;

- Do not immerse the power cord or the unit in liquid Keep the unit away from water
- Do not use while bathing
- Do not reach for a unit that has fallen into water – immediately unplug the unit.

• **OPERATING YOUR COMPRESSOR NEBULIZER** •

1. Place your Compressor Nebulizer on a flat and stable surface. Be sure that you can easily reach the controls when you are seated.
2. Gently twist the top part of the nebulizer counterclockwise to disassemble the nebulizer.
3. Fill the bottom section of the nebulizer with the medication prescribed by your physician. Be sure that the cone is put inside the bottom section.
4. Gently twist the top part clockwise to reassemble the nebulizer. Be sure the two sections fit well.
5. Attach one end of the air tube to the base of the nebulizer.
6. Attach the other end of the air tube to the tube connector located on the front of the compressor.
7. Attach mouthpiece or mask per your choice to the top section of the nebulizer.



8. Plug the power cord into an appropriate electrical outlet. Make sure at this stage, the power switch is at "Off" status.
9. Press the power switch to begin your prescribed treatment.



Place to fill Medication

Note:

The compressor motor has a thermal protector, which will shut off the unit before the unit is overheated. When the thermal protector shuts the unit off, please:

- Switch off the unit.
- Unplug the unit from the electrical outlet.
- Wait 30 minutes for the motor to cool down before another treatment. Make sure the air openings are not obstructed.

• **CLEANING** •

It is recommended that the nebulizer, mouthpiece, and mask be thoroughly cleaned with hot water after each use and cleaned with a mild detergent after the last treatment of the day.

1. Disconnect the air tube, nebulizer, mouthpiece, and mask.
2. Gently twist the nebulizer to open it.
3. Wash nebulizer, mouthpiece, and mask in warm water and a mild detergent. Then wash them in hot tap water.
4. Dry them with clean, soft towel or let it air dry.
5. Reassemble the nebulizer when completely dry and put these parts in a dry and sealed container.
6. Use one-part white vinegar with three parts distilled water. Make sure a mixed solution is enough to submerge the nebulizer, mouthpiece, and mask.
7. Submerge these parts in the vinegar and water solution for thirty minutes.
8. Wipe daily with a damp cloth.
9. Do not use any powdered cleaners or soap pads, which may damage the finish.
10. Do not wash or clean the filter. Only use filters supplied by your distributor. And do not operate without a filter.
11. Change the filter every 30 days or when the filter turns gray.
12. Filter changing procedure:
 - Remove the filter cover.
 - Replace the used filter with a new one.
 - Replace the filter cover.



• **SPECIFICATIONS** •

Power	AC 220V; 50Hz;
Current	0.8A
Medication Capacity	8ml
Particle Size	≤0.5-10µm
Sound Level	≤ 65 dB (A) (1 meter away)
Average Nebulization Rate	≥0.25mL/min (0.9% saline water)
Compressor Pressure Range	23-58 Psi (150-400KPa)
Operating Pressure Range	9.5-19Psi (65-130KPa)
Liter Flow Range	6-8lmp
Operating Temperature Range	10°C to 40°C
Operating Humidity Range	10 to 95 % RH
Storage Temperature Range	-25°C to 70°C
Dimension	185x169x107mm
Weight	1.2 kg
Weight with packing	1.5 kg
Standard Accessories	Nebulizer, Air Tube, Adult Mask, Child Mask, Mouthpiece, Filters (5), Nose piece

• **CUSTOMER SUPPORT** •

CONTACT ADDRESS

USA

Nureca INC.USA
276 5th Avenue, Suite 704-397,
New York (NY) - 10001, USA

INDIA

Corporate Office (Mumbai)

Nureca Limited
128 Gala Number Udyog Bhavan,
1st Floor Sonawala Lane, Goregaon East
Mumbai City Maharashtra 400063

Contact us

India: +91-7527013265 /+91-9356658436

Website: www.drtrust.in

Corp Website: www.nureca.com

Email: customercare@nureca.com

Connect with us on social networks

Facebook: @drtrust

Instagram: @drtrustisin

Youtube: NurecaUsa

COPYRIGHT©2021 NURECA LTD ALL RIGHTS RESERVED



Scan to View
Product Demo Video
www.drtrustusa.com/407