

# ACCESSORY FITMENT

**Product**

Toyota Landcruiser 70 Series Pickup Triple Styling bar

**Tracking no.**

90021T /306



60  
Minutes

Models : DC and SC

Page 1 of 5

Date : 14 November 2014

DIAGRAM



Kit content:

	Qty	Description		Qty	Description
	6	Rubber feet	D	18	M8 x 22 x 1.6 Flat washers
	4	Full round straps	E	6	M10 Nuts
	4	Half round straps	F	6	M10 Spring washers
	8	Strap rubbers	G	6	M10 x 40 x3 Flat washers
	2	Mount plates LH/RH	H	4	M6 x 25 Set screws (SS)
	2	Spacers	I	4	M6 Nylok Nuts (SS)
A	10	M8 x 25 Hex Set sc	J	8	M6 x 16 x 1.5 (SS)
B	8	M8 Nuts	K	2	Spreader plate and welded nut.
C	10	M8 Spring washers			

Additional equipment/Material needed for fitment :

Qty	Description	Qty	Description
1	Centre punch	1	13 spanner and ratchet
1	9mm Drill Bit	1	17 Socket and ratchet
1	Drilling Machine	1	10 spanner and ratchet

Precautions during fitment:

Take care not to damage or scratch parts when removing from the packaging.

Directions for use:

NOTE: The Roll bar can be fitted with or without the OE cab guard.

## Fitment Instruction: Top mount LC triple roll bar

Visual / Graphic Illustration

Fig 1

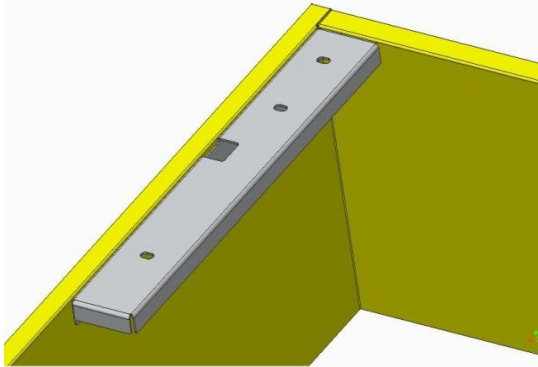
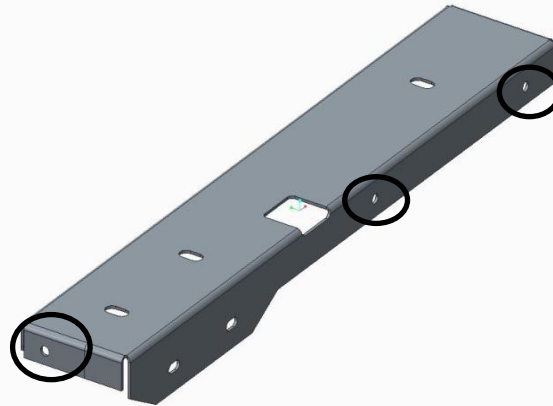

Fig 2



Step #

Description/Method

1

Remove the 2 corner bolts that hold the cab Guard in place on each side. Then hold the Roll bar mounting plates in place to mark the drilling positions of the holes (Fig 1). NOTE: It is only necessary to mark the 2 back holes and the front hole, the 2 corner holes that hold the cab guard will be used to bolt the base in place as well.(Fig 2)

2

Now use the centre punch to punch the position of the marked holes and drill using the 9mm drill bit. Treat the holes with tectyl to prevent rust.

### Fitment Instruction: Top mount LC triple roll bar

Visual / Graphic Illustration

Fig 3

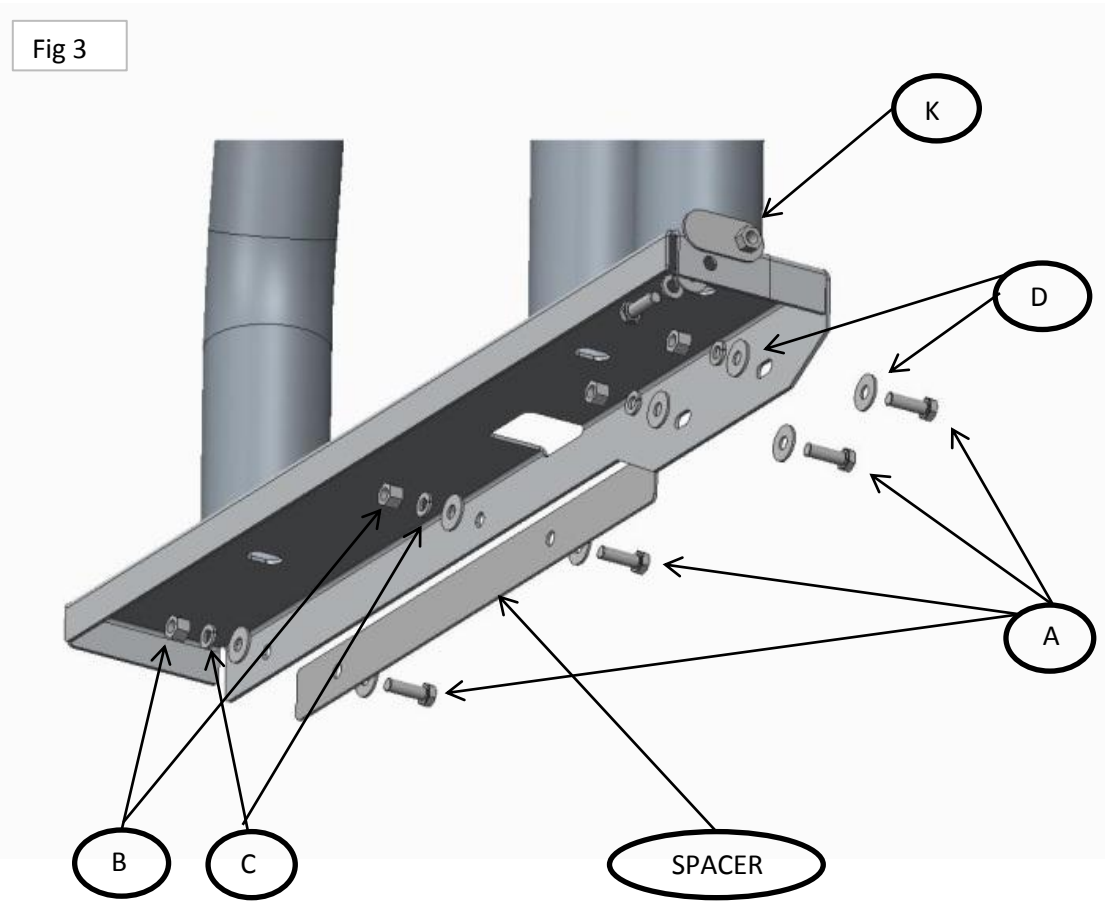

Step #

Description/Method

3

Bolt the mounting bases on as shown in Fig 3 ensuring they are flush with the top of the bin. NOTE: If the cab guard is left on the vehicle then use the spacer as shown in Fig 3.(Spacer goes between bin and mounting base)

Repeat the above steps on the opposite side mounting base.

## Fitment Instruction: Top mount LC triple roll bar

Visual / Graphic Illustration

Step #

Description/Method

Fig 4

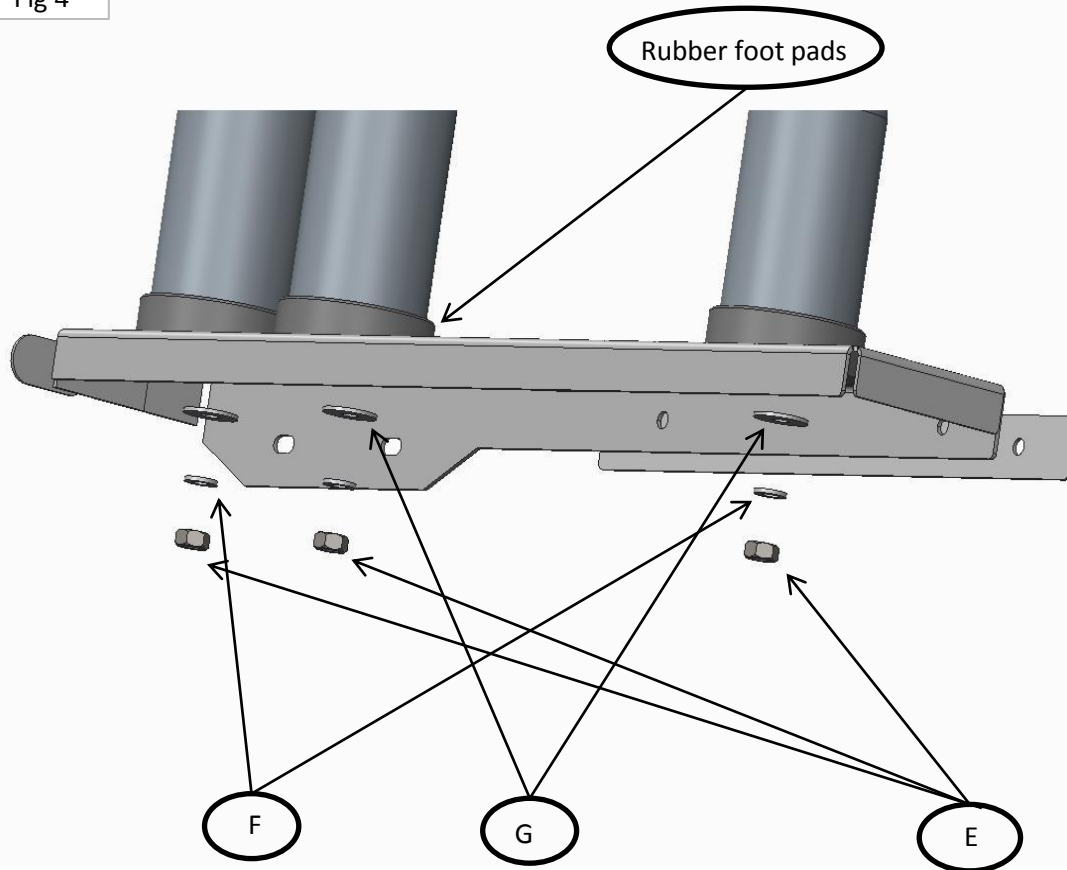

4

Start placing the roll bar in position (Don't forget to put the rubber foot caps on the bars). Start with the front bars and hand tighten until all 3 bars are in position. Fig 4

5

With all the bars in place attach the top clamps using the M6 SS hardware as shown in Fig 5. Set clamps an equal distance from the centre of the bar. The half clamp pieces are for the middle position.

Fig 5



Make sure bar is centralised and tighten all fasteners to specified torque. M8= 22Nm , M10= 42Nm , M6= 9Nm.

