

# ACCESSORY FITMENT INSTRUCTION

**Product**

GWM P Series Towbar

**Part no.**

72059T



60  
Minutes

Models : All

Page 1 of 4

26-01-2022

## DIAGRAM

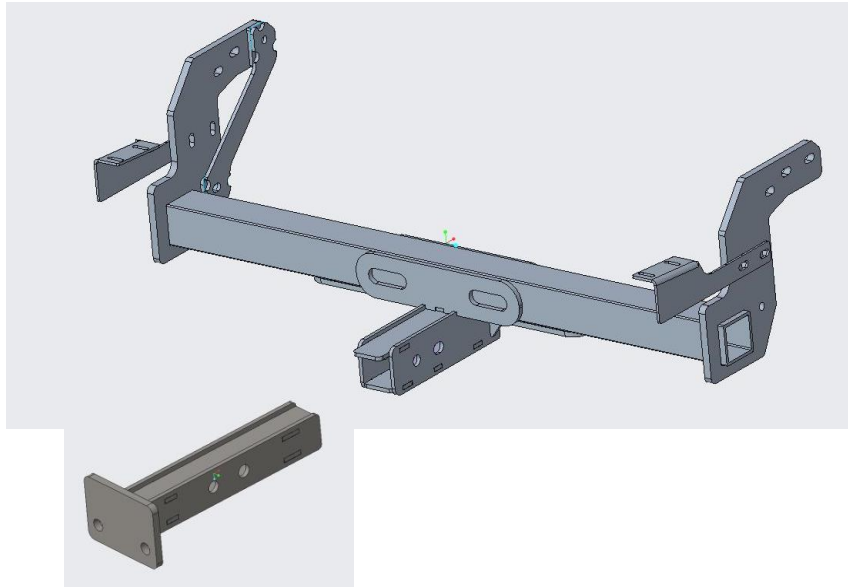

## Kit content:



	Qty	Description		Qty	Description
A	6	M12 x 1.25 x 40	K	1	M12 Nylok Nut
B	8	M12 x 2 x 25 Flat washers	L	2	M16 x 50 bolts
C	6	M12 spring washers	M	2	M16 Nylok Nuts
D	1	M12 x 50 set screws	N	2	M16 x 2 x 30 Washers
E	4	M10 x 35 set screws	O	1	16mm Hitch Pin
F	8	M10 x 1.6 x 25 flat washers	P	1	Towball and cover
G	4	M10 Nylok Nuts	Q	1	Removable gooseneck
H	4	M8 x 25 set screws	R		
I	8	M8 x 1.6 x 22 flat washers	S		
J	4	M8 Nylok Nuts	T		

## Additional equipment/Material needed for fitment :

Qty		Qty	
	Socket and ratchet set		
	Spanner set		

## Precautions during fitment:

## Fitment Instruction: GWM P-Series towbar

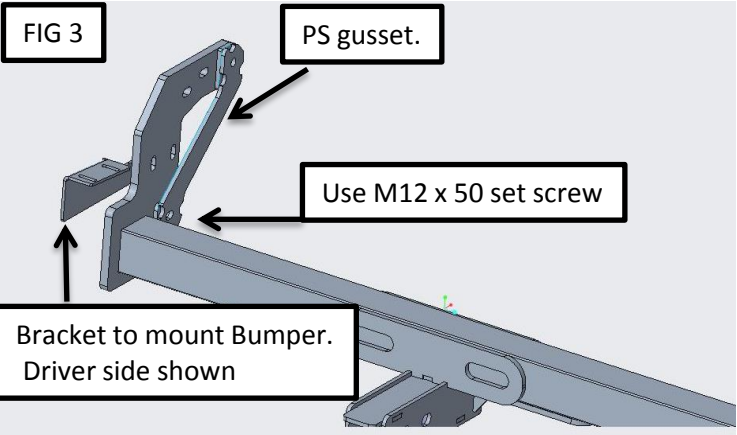
Visual / Graphic Illustration	Step #	Description/Method
 <p>FIG 1</p>	<b>1</b>	Remove bumper from vehicle as shown in Fig 1.
 <p>FIG 2</p>	<b>2</b>	Now fit the towbar using the fine thread M12 x 40 set screws , flat washers and spring washers , Fig 2. Towbar fits to inside of Chassis and uses the existing weld nuts in the chassis. Also fit the gusset on the Passenger side shown in Fig 3. Use the 1 x M12 x 50 set screw with washers and Nylok nut to tightn bottom bolt.
 <p>FIG 3</p> <p>PS gusset.</p> <p>Use M12 x 50 set screw</p> <p>Bracket to mount Bumper. Driver side shown</p>	<b>3</b>	Mount the supplied Brackets that will be used to mount to bumper shown in FIG 3. Use M10 hardware supplied.

## Fitment Instruction: GWM P-Series towbar

Visual / Graphic Illustration

Step #

Description/Method

FIG 4

**4**

To remove the original bumper mounting brackets you need to disassemble the bumper as shown in FIG 4. Once done you can remove the original brackets.

**5**

Place the steel skeleton of the bumper onto the brackets you mounted in step 3. FIG 5.

FIG 5

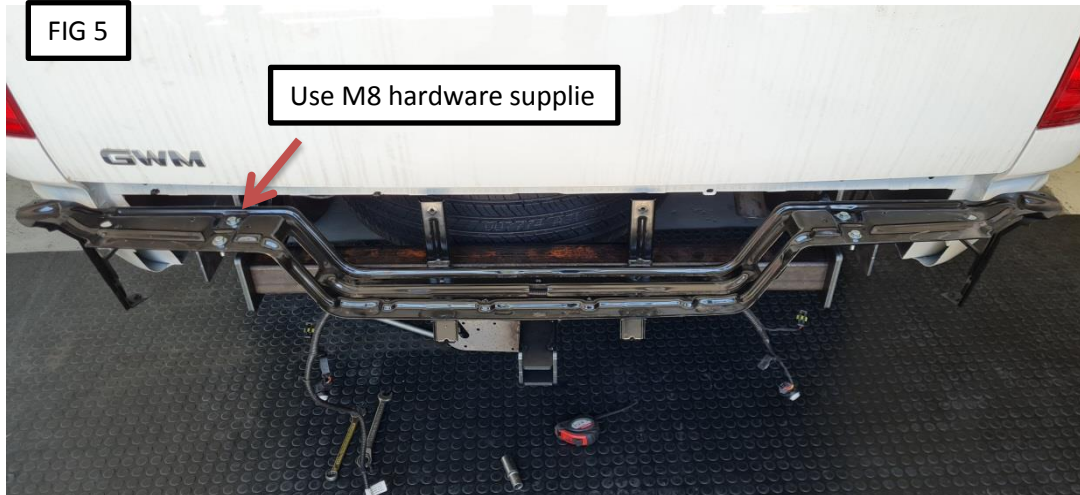
**6**

Centralise the frame and tighten it to the towbar as shown in FIG 5.

**7**

Now remove the frame with the brackets still attached where you tightened them in step 6 and reassemble the rear bumper

## Fitment Instruction: GWM P-Series towbar

Visual / Graphic Illustration



Step #

Description/Method

**8**

Once bumper is assembled with the new brackets , then mount bumper back on towbar , centralise and tighten. Torque: M12=73Nm ; M10 =42Nm ; M8 =22Nm

**9**

once towbar and bumper are tightened you can install the wiring.