

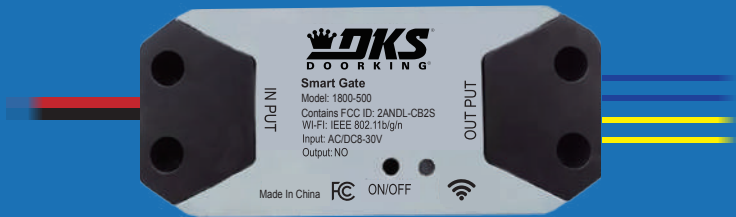

# Smart Gate Controller

Monitor and control your gate from anywhere.

## User's Manual



# WARNING

## TO PREVENT SERIOUS INJURY OR DEATH FROM YOUR MOVING GATE:

- ✓ DO NOT let children use or play with the Smart Gate device or app.
  - ✓ ONLY operate your Smart Gate device when you are in clear view of your gate, and you have verified that there are no objects obstructing the operation of the gate.
  - ✓ ALWAYS wait for the gate to complete its cycle before leaving the area.
  - ✓ This device complies with Part 15 of the FCC Rules. Operation is subject to the following two conditions:
    - (1) this device may not cause harmful interference, and
    - (2) this device must accept any interference received, including
- 1 interference that may cause undesired operation.

# WHAT'S IN THE BOX

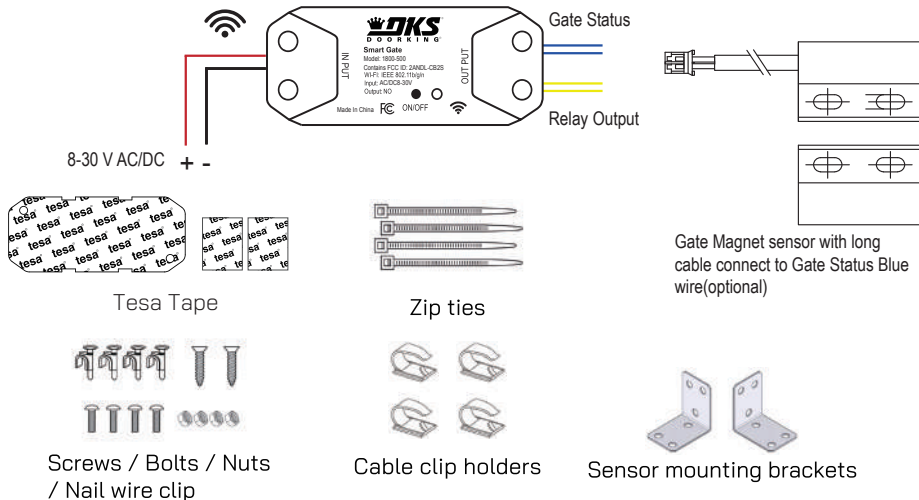

# Set up your DKS Smart Connect account

1. First, download DKS Smart Connect app for your iOS or Android device.

- Make sure you have the latest version of DKS Smart Connect from the app store



2. Next, create your account.

- If you're new to DKS Smart Connect , tap **Sign up** to create account. Enter your email address, then tap **Get Verification Code**, enter the code you receive in your email to set up the password.
- If you already have DKS Smart Connect account used for other devices, tap **Log in with Existing Account**.

# Installation Overview

Please refer to gate operator manual for proper input/output connections  
Relay contact set for N.C., relay output set to activate when gate is fully open

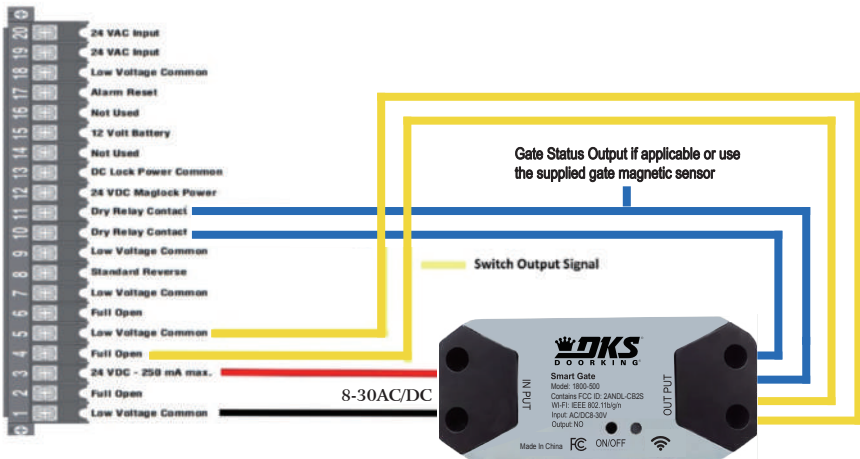

# Preparation before installation

## 1. Check your Wi-Fi (“Only supports 2.4 Ghz WiFi”)

under Check the Wi-Fi signal at the gate, where the Smart Gate Controller will be mounted.



## 2. Power up your device

Find a convenient location and power the Smart Gate Controller by connecting it to an 8-30V power source (AC/DC).

The LED indicator will start blinking.

# Add Smart gate device to DKS Smart Connect app

**\*\*\* Turn on smart phones bluetooth and Connect smartphone to your home WiFi network before the following steps. Have your SSID WiFi name ready, with WiFi password if asked.**

1. Launch the app and tap the Plus ( + ) in the top right corner to add a Controller device.

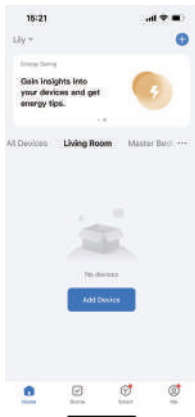

2. Press Smart Switch Button until LED flashes. Tap Go to add.



3. Enter your home Wi-Fi name and password, then tap **Confirm**.



4. Now your DoorKing Smart Gate is successfully added to DKS Smart Connect app. Tap **Done**.

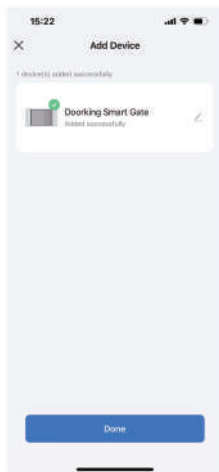



# POWER OFF your existing gate operator

- Connect the two Yellow wires to the gate operator open input terminals
- Connect the Red wire to 8-30 VAC/VDC positive
- Connect the Black wire to common
- Connect the two Blue wires to the gate operator status output relay if applicable or the gate magnetic sensor.

# DoorKing Smart Gate Controller

## Function Description of the Operation Interface

### DKS Smart Connect App

#### ✓ Main Screen:

- Select your added device to control your gate or to edit:
- Main control screen.

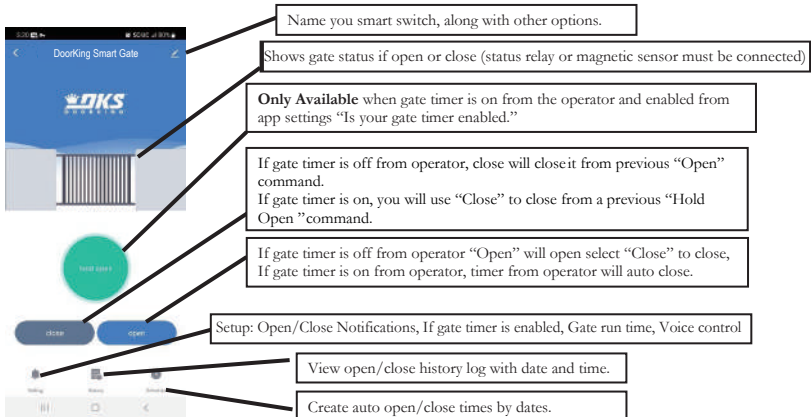

## Edit name and other options:



- Select  to make adjustment as described below.
- NOTE: These options are only available when logged as the primary user:
- Rename Device, Device Info, Share Device, Add to home screen, Check device network, Device Update

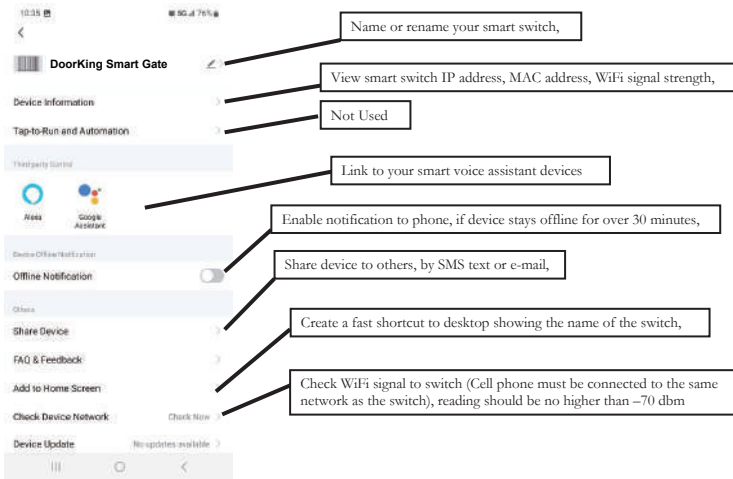

- Device can be removed from here.

✓ **Settings:**



Setting

➤ Select  to make adjustments as described below

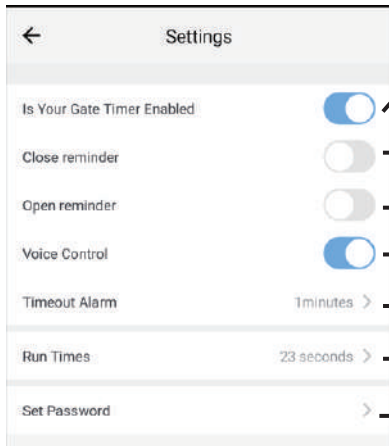

Select your gate operating closing settings:

- If gate operator is set to time out and close- Move slider to the right enable (Yes)
- If gate operator timer to close is off – Move slider to – left disable (No)

Enable/Disable notifications to cell phone,

Enable voice assistant devices (Alexa, Google)

Not Used

Set gate open/close limit timing so if not reached after the set time, a warning message will pop up

Set for Google Assistant if used.



## History:



History

- Select **History** to view log history of Open/Close/Hold Open events with date and time.

23:55		📶 📶 🔋
<	History	
Today		
23:54:59		Open
23:54:54		Close
23:54:38		Hold Open
23:54:25		Close
23:54:23		Open



## Schedule:



- Select **Schedule** to set an auto open / close time.
  - ⏪ Create a beginning time with days the gate should go open
  - ⏪ Create an end time with days the gate should go back to close

# Common Voice Commands (US)

Alexa, Google Home, Siri can't support control "Hold Open"

## Alexa

- Alexa, open the DoorKing Smart Gate.
- Alexa, close the DoorKing Smart Gate.



Google HOME

## Google Home

- Hey Google, open the DoorKing Smart Gate.
- Hey Google, close the DoorKing Smart Gate.

## Siri

- Hey Siri, open the DoorKing Smart Gate.
- Hey Siri, close the DoorKing Smart Gate.



# Link DKS Smart Connect account to Alexa

Before link DKS Smart Connect to **Alexa**:

- Launch DKS Smart Connect app, tap “**Doorking Smart Gate**”.
- Tap the ring bell on the bottom left corner.
- Tap “**Set password**”, enter a password then tap “**Confirm**”.

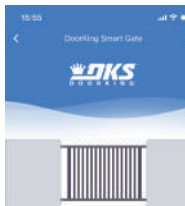

close open

Home History Settings

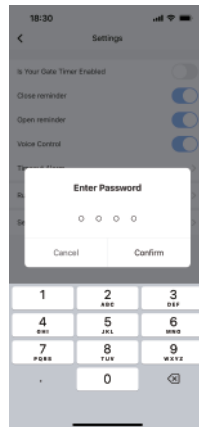
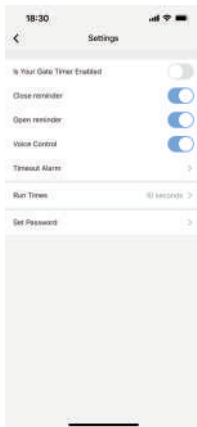

1. Launch Amazon Alexa app. Tap **More**, from the list of choices select **Skills & Games**. In search type **Smart Life**, select the skill than **Enable To Use** and “Agree and Link”.





2. Enter the e-mail used when installing DKS Smart Connect, select **Next Step**. From the option of apps, select **DKS Smart**, then select **Link Devices for this App Account**. You will be prompted to enter the password you setup originally when installing DKS Smart Connect select **Next Step**, then select **Authorize**. Select **Close**, Alexa will start looking for devices to connect. This will take from seconds to minutes, once complete select close.

The image displays three sequential screenshots of the Alexa mobile application interface during the account linking process.

- First Screenshot:** Shows the 'Add Account' screen. At the top is a blue house icon with a Wi-Fi symbol. Below it is a dropdown menu set to 'United States of America'. Underneath is a text input field for 'Phone Number/Email Address'. At the bottom, there is a checkbox for 'I have read and accept User Agreement Privacy Policy Children's Privacy Statement' and a red 'Next Step' button.
- Second Screenshot:** Titled 'Choose App'. It features a message: 'This account is registered with many apps, please select the account that belongs to the device you want to associate this time.' Below the message are two options: 'Smart Life' with an unselected radio button and 'DKS Smart' with a selected radio button and a green checkmark. A red 'Link devices for this App account' button is at the bottom.
- Third Screenshot:** Shows the password entry screen. It has a dropdown menu for 'United States of America', a dropdown for 'DKS Smart', a masked password field 'XXXXXXXXXXXXXXXXXX', and a text input field 'Type your password here'. At the bottom, there is a checkbox for 'I have read and accept User Agreement Privacy Policy Children's Privacy Statement' and a red 'Next Step' button.

3. You will be asked to create a 4-digit code, enter the same 4 digit-code you created from DKS Smart Connect select **Next**. You will now need to enter your Amazon account password. Select **Next** to complete “open by voice setup”. At this point will have the option to organize your device to a group, or select **Skip**, then **DONE**

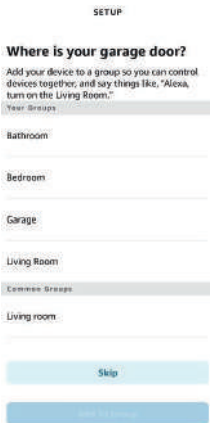
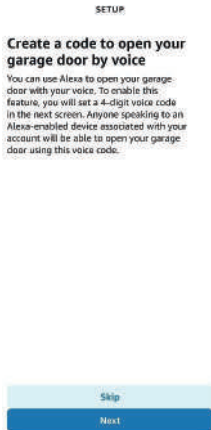

17

**NOTE:** If Alexa responds that it cannot open multiple devices, delete one of the multiple devices.

# Link DKS Smart Connect account to Google Home

Before link DKS Smart Connect to **Google Home**:

- Launch DKS Smart Connect app, tap “**DoorKing Smart Gate**”.
- Tap the ring bell on the bottom left corner.
- Tap “**Set password**”, enter a password then tap “**Confirm**”.

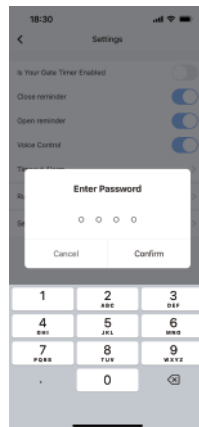
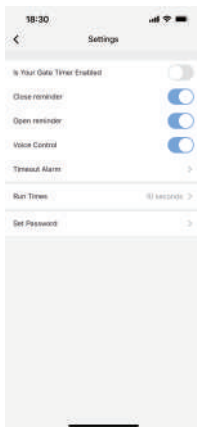

## 1. Launch **Google Home App**. **Devices -Add Device** tap on **Works with Google**

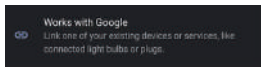

2. Type **Smart Life** to search than continue. Enter the email you set up or used from the Doorking Smart Connect app. A list of apps will be listed select **DKS Smart** then tap **Link devices for this App account**. After you will be prompt for the e-mail passwords select **Next Step** once entered.

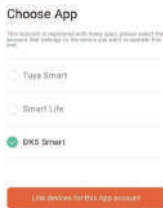
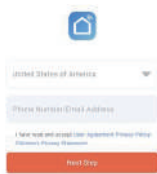
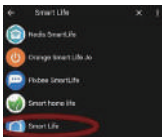

3. Tap on **Authorize**, to allow linking permissions. Select Doorking Smart Gate or the name you setup for the device, then select **Add to room**. You can then select any room from the list or add one, select **Next**. You are now finish, select **DONE**, close Google home.

By signing in, you are authorizing Google to control your devices.

Authorize

You can revoke permission at any time.

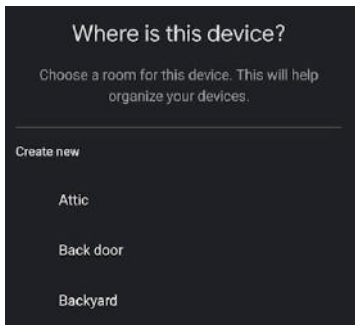
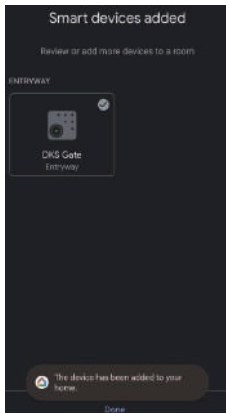

# Set up Siri to control the DoorKing Smart Gate

## Siri can only be used when logged as primary user

1. Log in the "DKS Smart Connect" app, select "Scene" at the bottom.
2. Tap "+", Select "Launch Tap To Run", Select "Add Task", Select "Run the device".
3. Select "DoorKing Smart Gate (Default device name)", then select "Action", then select "Open" or "close", click "Save", click "Next", and click "Save" again (please note Siri can't support control "Hold Open")

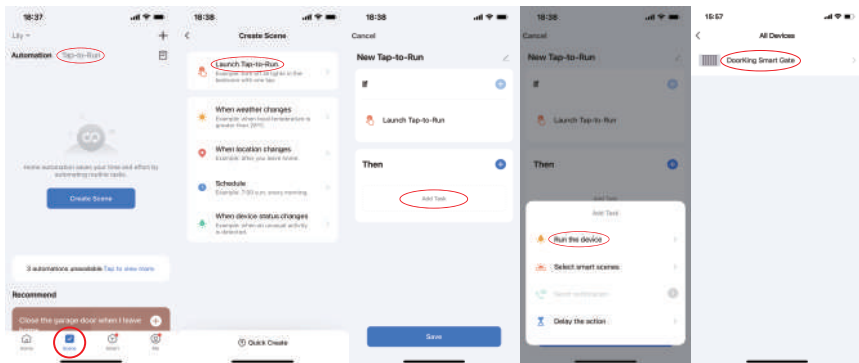

4. Back to the **"Scene"** page, tap the **"Add to Siri"** icon at the right bottom. Select the tab **"Doorking Smart Gate" Action: Open or Close**.
5. Select **"Done"**. Now you can say **"the magic word"** control the Doorking Smart Gate.

