

Proximity Reader

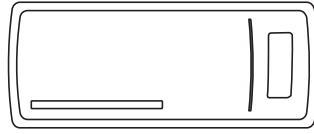

DOLCMWHIDEM

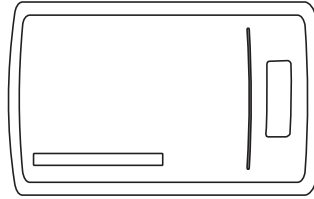

DOLCSWHIDEM

User Manual

Introduction

The DOLCMWHIDEM/DOLCSWHIDEM are Wiegand Output Proximity Readers. 125KHz EM and 125KHz HID formats are compatible with these readers. These readers have the ability to read a HID format between Wiegand ranges of 26 bits - 37 bits. The default EM bit range is set to Wiegand 26 bits.

These indoor and outdoor readers are waterproof and functions at extreme temperatures (-40F - 140F). The readers also have a built-in light sensor to signal when the keypad is being tampered.

Wiring

Color	Function	Notes
Red	Power +	9~18V DC Power Input
Black	GND	Ground
Green	D0	Wiegand D0
White	D1	Wiegand D1
Brown	LED	Green LED light control
Yellow	Buzzer	Buzzer control

Installation

- Drill 2 holes (A,C) on the wall for the screws and one hole for the cable between holes A and C.
- Knock the wall fixing plugs to holes A and C.
- Screw the back cover to the wall
- Thread the cable through hole B
- Attach the unit to the back cover

- 1 -

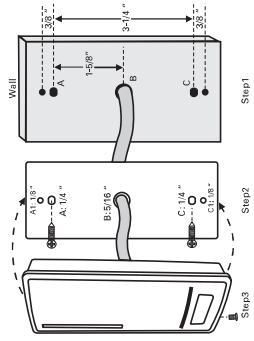

Parameters

Model	DOLCMWHIDEM/ DOLCSWHIDEM
Operating Voltage	9~18V DC
Frequency	125KHz
Card Type	EM card & HID card
Reading Distance	1 ^{1/8} to 3 ^{1/8} "
Output Format	HID Wiegand 26 - 37, EM Wiegand 26
Working Temperature	-40 F - 140 F
Standby Current	≤25 mA
Operating Humidity	10%~98% RH
Index of Protection	IP 66
Dimension	L4 ^{3/4} x W 1 ^{7/8} x H 7/8 " L4 ^{3/4} x W 3 x H 7/8 "

- 2 -

Packing List

Name	Quantity
Reader	1
Manual	1
Screw Driver	1
Wall Fixing Plugs	2
Self Tapping Screws	2



7380 S. Eastern Avenue, Suite 124-320 • Las Vegas, NV 89123
(866) 975-0101 • (866) 975-0404 Fax
www.transmittersolutions.com

- 3 -