

DURALIFE LOCKER BASIC INSTALLATION GUIDE

***IMPORTANT:** Before you begin installing your Duralife Lockers, a **complete inspection** of the job site should be done. Be sure to check for any variations in the wall and floor surfaces and sweep away any debris. Any variations in the walls that the lockers will be attaching to should be leveled and plum **prior** to beginning your installation.

STEP 1: LOCKER BASE SET UP (If base is not provided Scranton Products recommends using a leveling panel*. Set leveling panel on existing location. Shim and secure after lockers are installed.)

- 1** Locate 72" front and back base supports.
Locate base spreaders and span from front to back.
- 2** Assemble base spreaders from 24" on center.
Use 1 1/2" Brad nails to face nail spreader to front and back support using 3 nails per side.
See illustrations A
- 3** Set base in place.
Level front to back and left to right.
Secure base to the wall at a minimum of 24" on center using 2-3/4" TAPCONS (at a minimum).

A. Locker

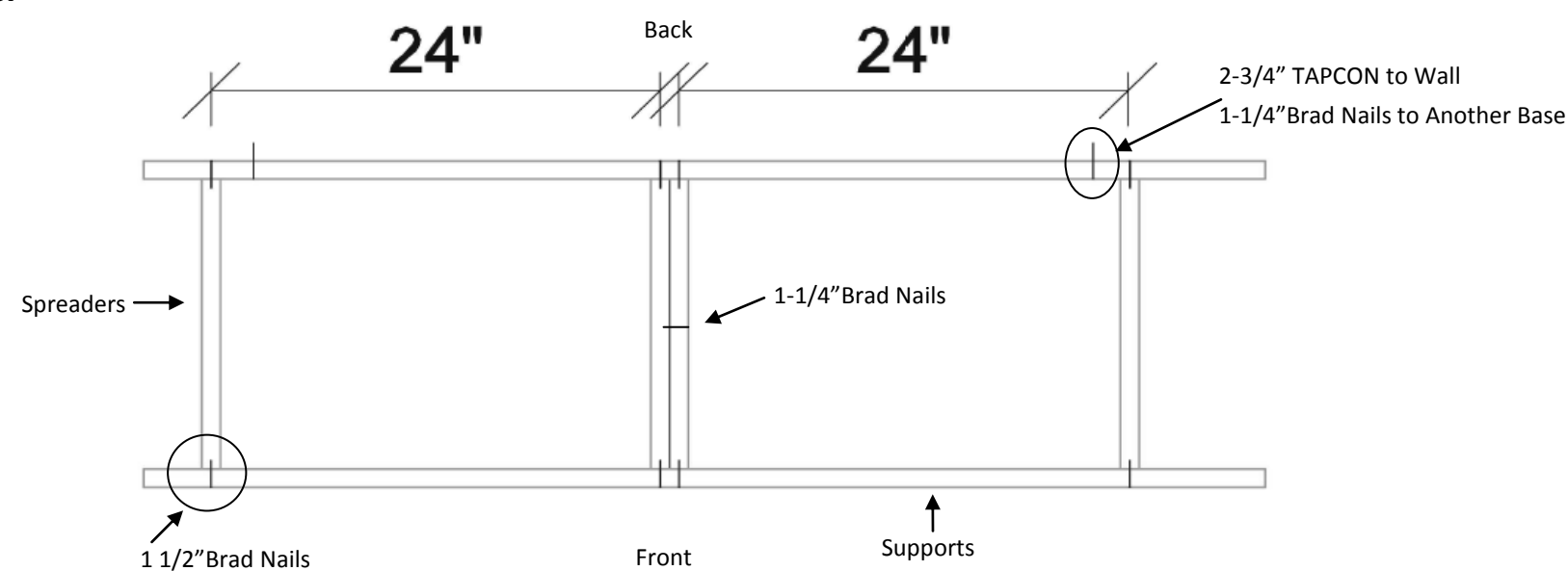

STEP 2A: Setting & Attaching Lockers

- 1** Place the first 2 banks of lockers on the leveled base and join them together using thru bolts.
See illustration A
Continue joining banks until run is complete.
Maximum of 4 (3 banks)
Ensure you do not overtighten thru bolts.
Stretching and compressing lockers is a sign of overtightening thru bolts which will prevent proper functioning of lockers.
- 2** Ensure door reveal is consistent.
Shim lockers to obtain correct door alignment.
See illustrations B, C & D
- 3** Attach lockers to the wall using a minimum of 1 screw every 24" at the top and at the base.
Ensure you do not overtighten screws.
Stretching and compressing lockers is a sign of overtightening screws which will prevent proper functioning of lockers.
- 4** Once the lockers are attached to the wall, check functionality to ensure doors are operating correctly.

A. Joining Lockers

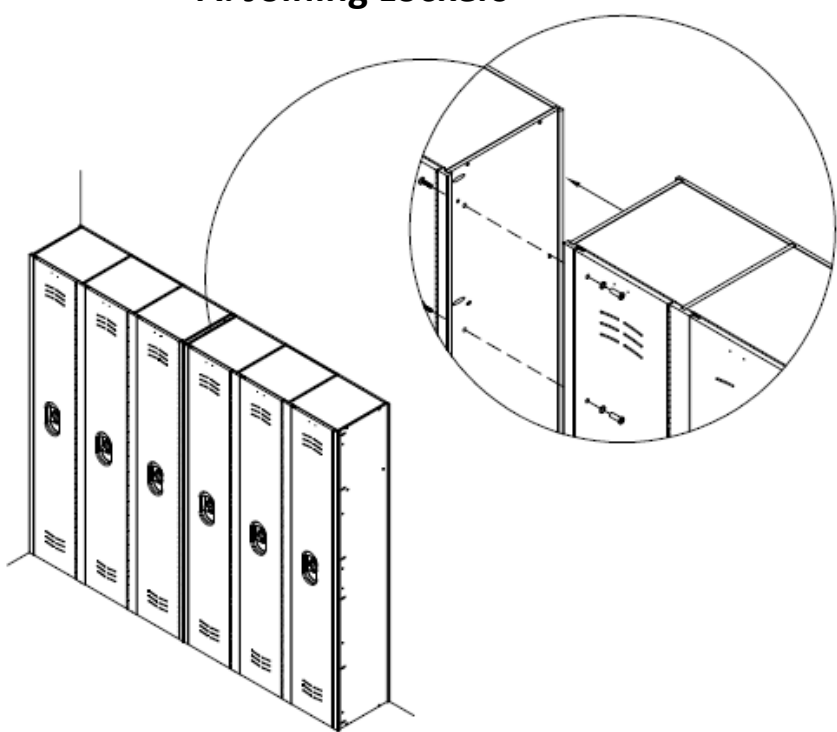

B. Correct Door Alignment

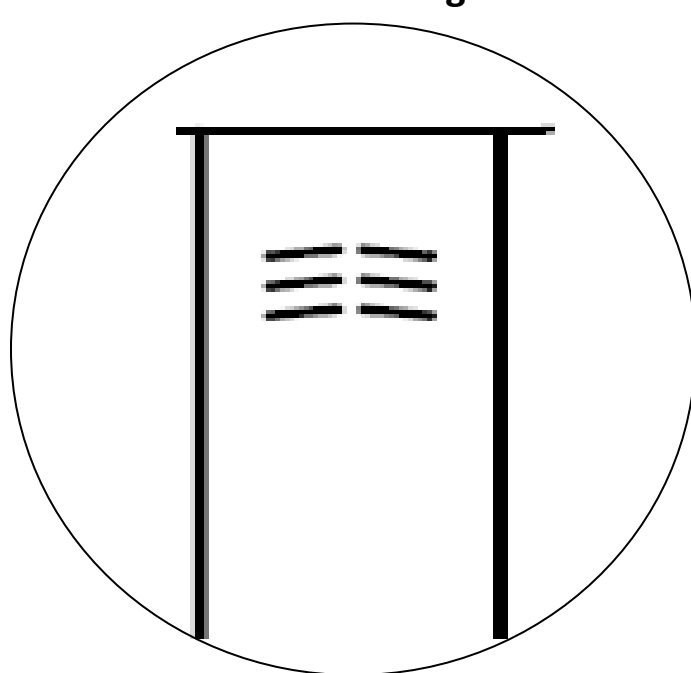

C. Doors Unaligned Left

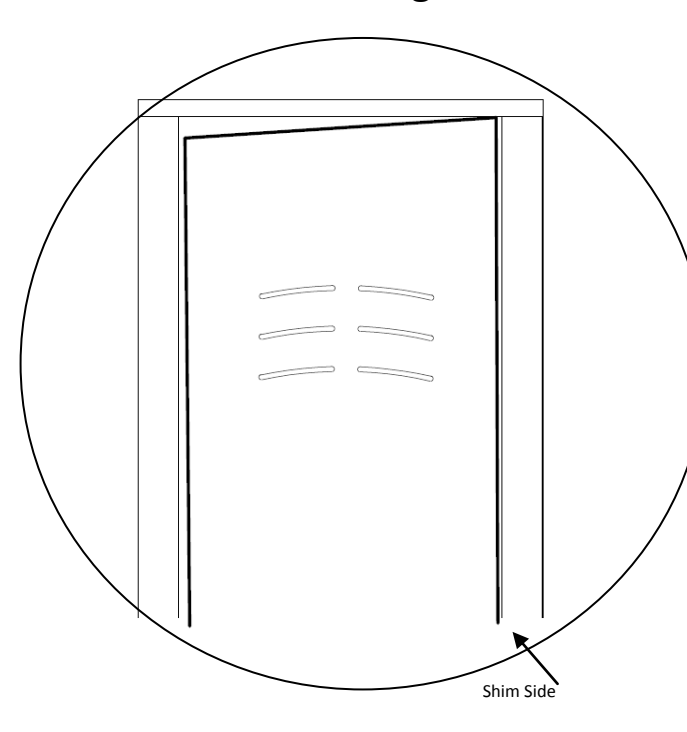

To correct doors that are out of alignment on the left, shim on the right side of the locker.

D. Doors Unaligned Right

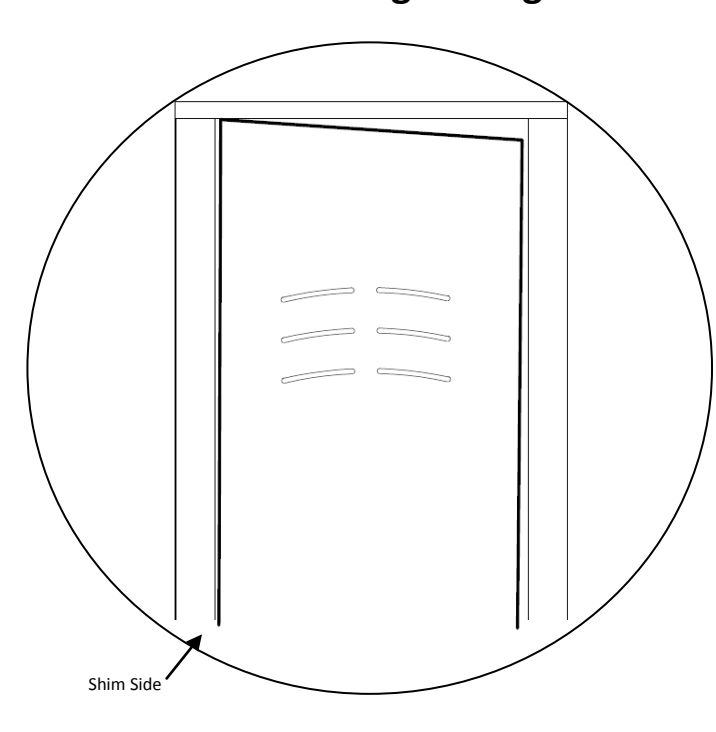

To correct doors that are out of alignment on the right, shim on the left side of the locker.

STEP 2B: Setting & Attaching Lockers in an Island

- 1** Set the first bank of lockers back to back with the second bank of lockers.
See illustration A
- 2** Predrill 1/8" holes approximately 3" down and 3" over in the 4 corners.
Secure using 5/8" pan head screws.
- 3** Ensure door reveal is consistent.
Shim lockers to obtain correct door alignment.
See illustrations above in Step2A– B,C, & D

A. Attaching Lockers

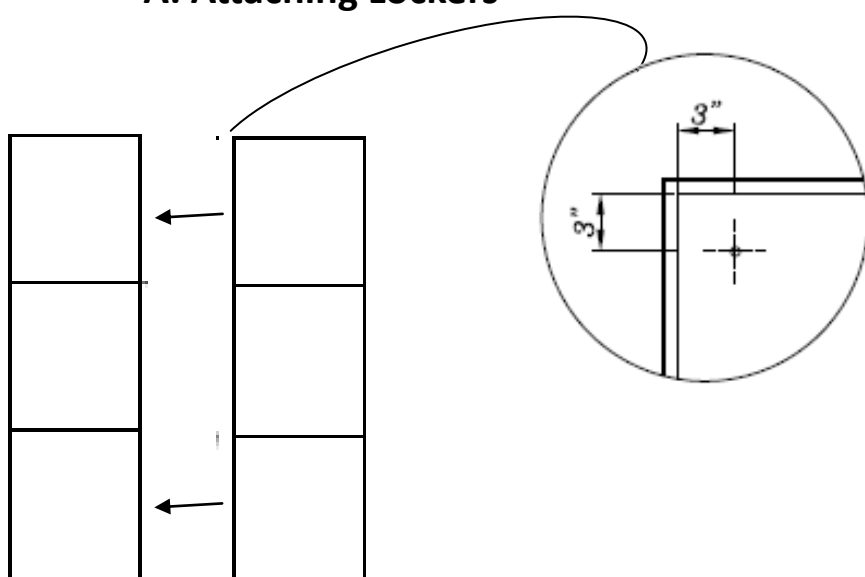

DURALIFE LOCKER ACCESSORIES INSTALLATION GUIDE

STEP 3: Installing Fillers (*Ensure you have blocking available as Scranton Products does not provide it.)

- 1 Refer to layouts for filler location and sizes. The fillers may need to be trimmed to meet field conditions.

*Fillers are supplied in set sizes and will need to be cut in field.

- 2 Attach blocking to the wall and the locker.
When installing blocking to the locker pre-drill from the inside using a 1/8" drill bit and countersink before fastening.
Preset your fillers into place.

See illustration B

- 3 Align the two fillers and attach.

See illustration C

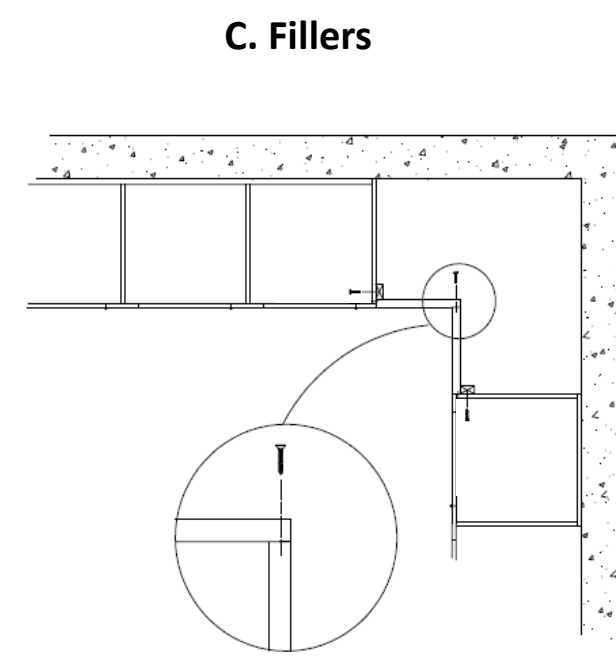
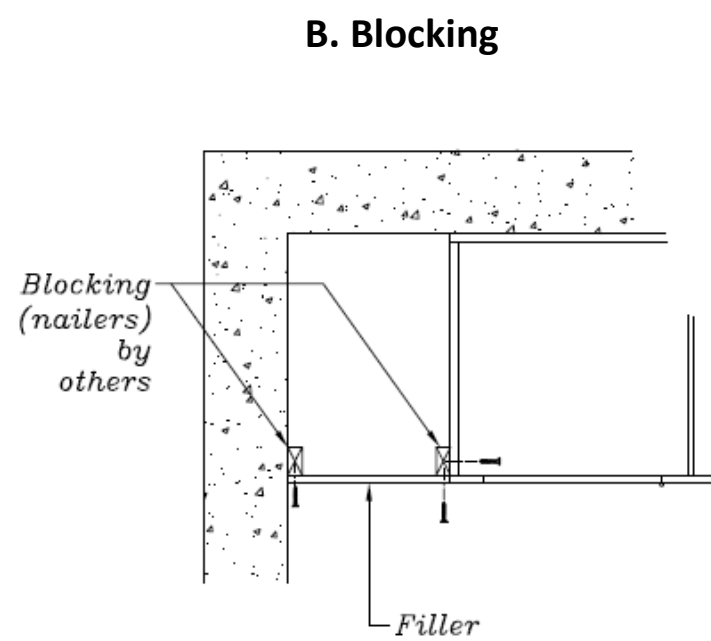
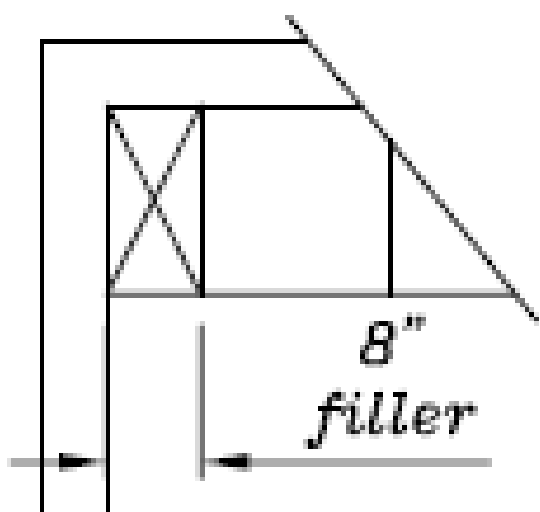

STEP 4A: Installing a Flat Top (*Scranton Products recommends cutting the tops only at the end of locker runs)

- 1 Flat tops are provided in 72" section with an overhang on the front of the lockers.

- 2 Fasten 5/8" pan screw from inside of locker. Pre-drill holes 24" on center.

See illustration B

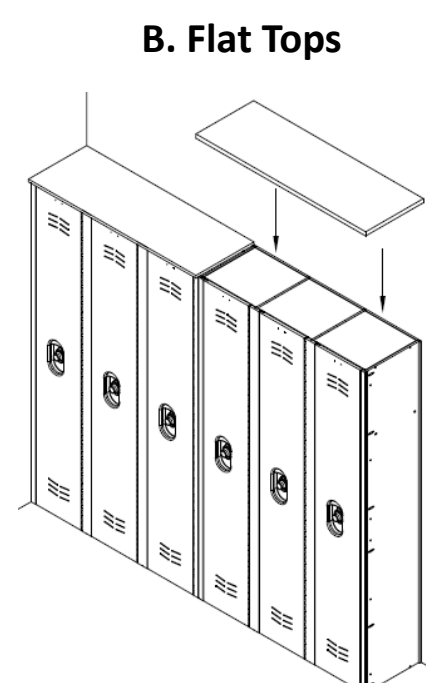

- 3 When installing flat tops above filler panels place blocking appropriately to support the top.

See illustration C

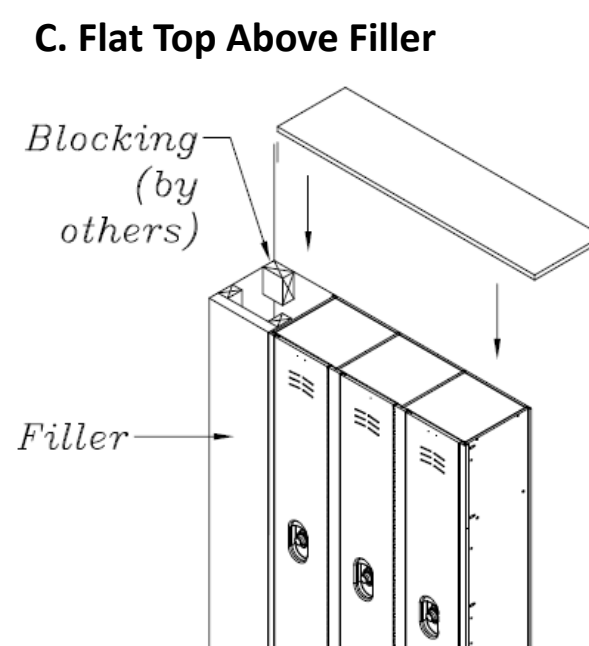

STEP 4B: Installing a Slope Top (*Scranton Products recommends cutting the tops only at the end of locker runs)

- 1 Install 1" rear support ensuring the rear support is aligned to the back of the locker.

Pre-drill holes and fasten the rear support from the inside of the locker using 1" screws every 24" on center.

See illustration A

- 2 Set the slope top into place so the front edge is aligned to the front of the locker to minimize the gap between the peak of the slope top and locker.

- 3 Pre-drill hole and install 1" screw 3/4" from each joint and then every 24" on center.

Ensure you do not overtighten screws.

See illustration B

A. Slope Top

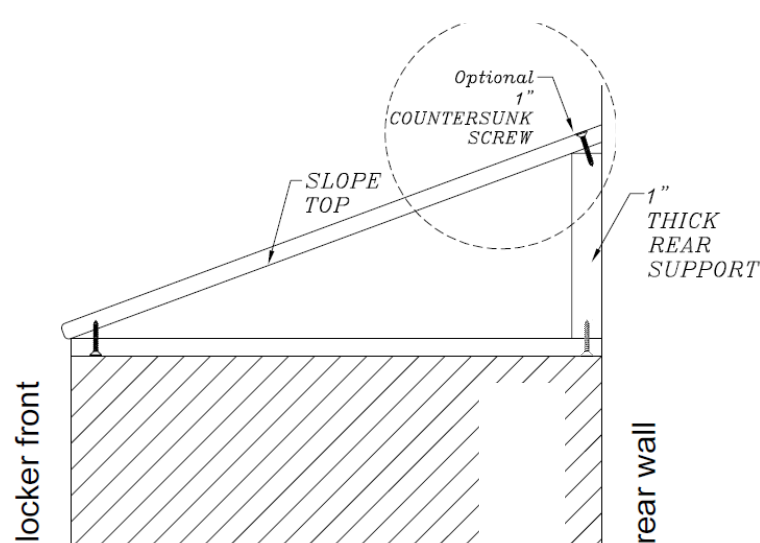

B. Fasten Slope Top

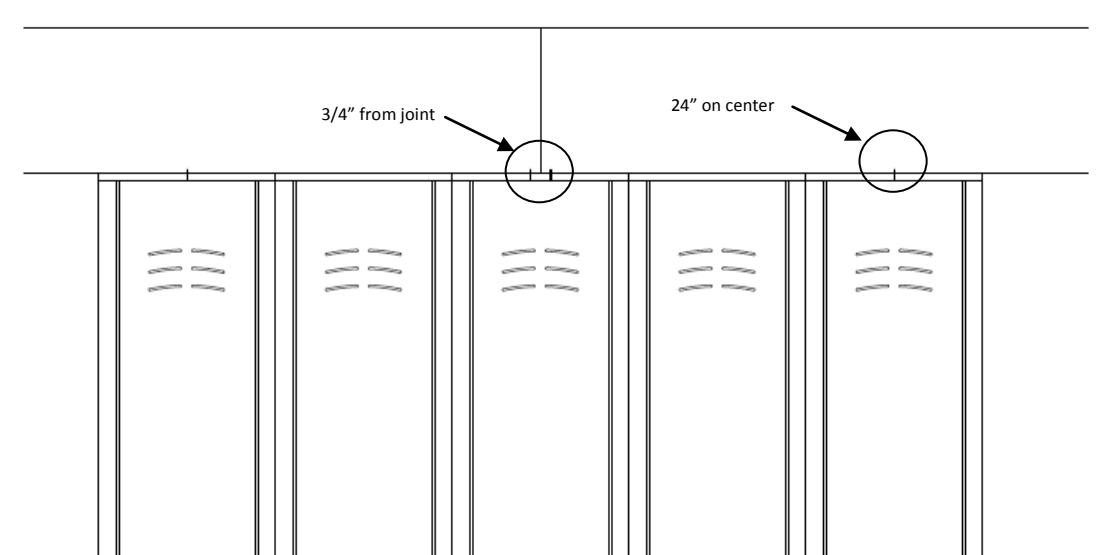

STEP 5: End Panels (*End panels are 1/4" shorter than depth of locker to allow for adjustment)

- 1 Set end panel into place flush with the back of the locker.

- 2 Pre-drill hole from inside of locker with a 1/8" drill bit utilizing a hard-stop to prevent drilling all the way through the end panel. Attach using 1" screws provided.

See illustration A

