

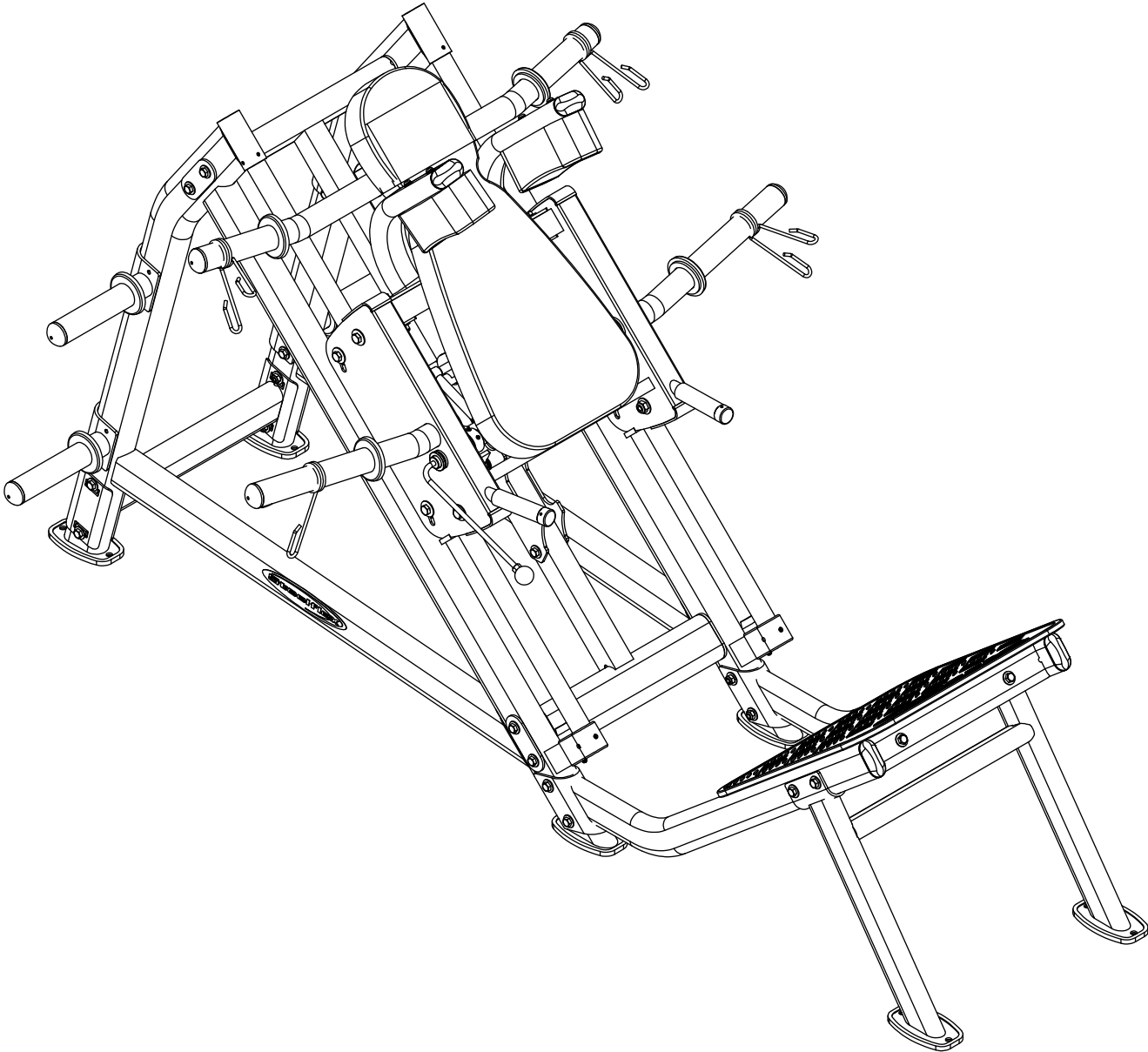

PLHP.5



Assembly & Instructions
OWNER'S & MANUAL

PLHP.5 HARDWARE
(shown in actual size)

A1.M10X70 Hex Head Bolt Qty.12

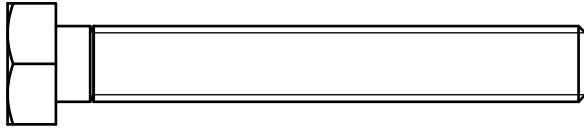

A2.M10X75 Hex Head Bolt Qty.7

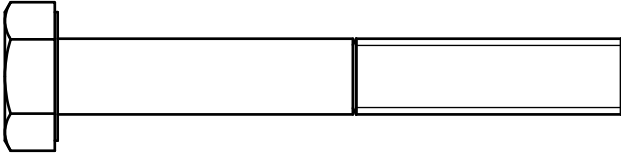

A3.M10X60 Hex Head Bolt Qty.4

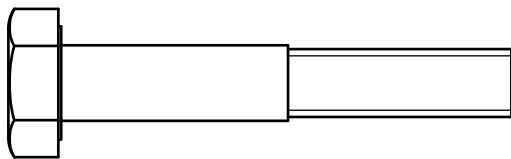

A5.M5X10 Round Cross Tapping Screw Qty.2



A6.M5X5 Grub Screw pre-installed Qty.8



A7.M8X16 Allen Screw (Full Thread) pre-installed Qty.2

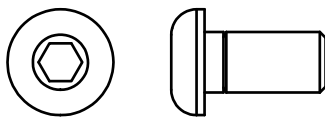

A8.M8X60 Allen Screw Qty.4

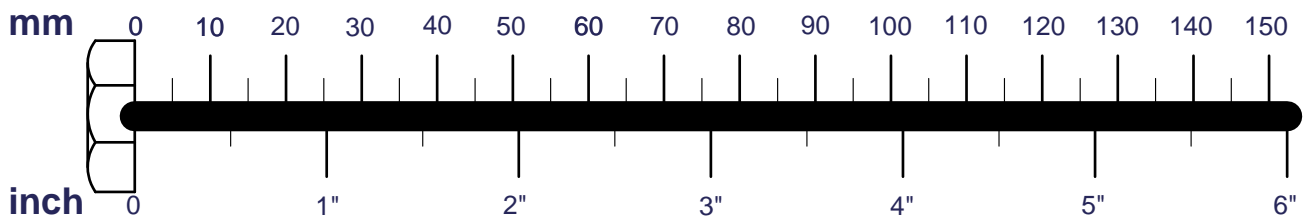
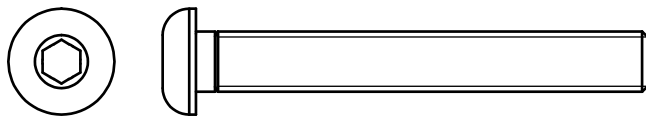

PLHP.5 HARDWARE
(shown in actual size)

A9.M8X25 Allen Screw Qty.4

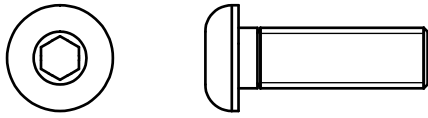

A10.M10X65 Hex Head Bolt Qty.12

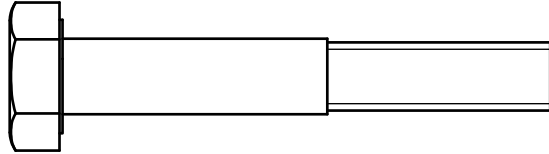

A11.M12X70 Hex Head Bolt Qty.8 (pre-installed)

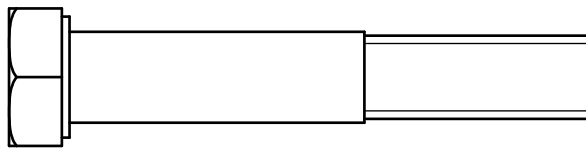

A12.M5X10 Taper Cross Tapping Screw Qty.1 (pre-installed)



A13.M12X75 Hex Head Bolt Qty.3

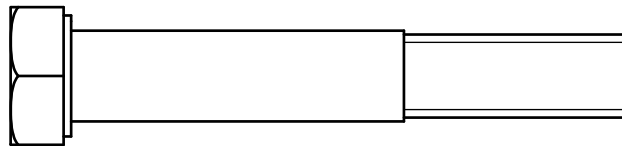

A14.M8X6 Grub Screw pre-installed Qty.10



A15.M8X95 Hex Head Bolt Qty.1

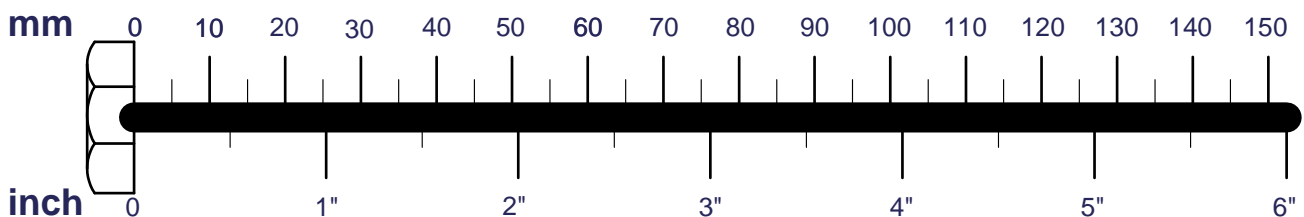
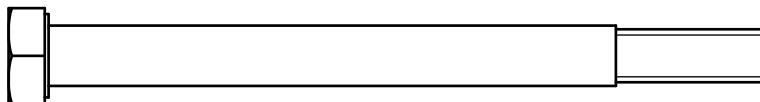

PLHP.5 HARDWARE

(shown in actual size)

B1.M10 Nylon Lock Nut Qty.19

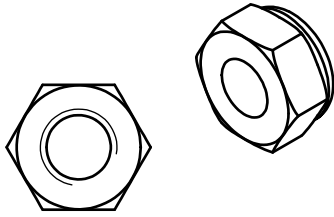

B2.M12 Nylon Lock Nut Qty.8
(pre-installed 6PCS)



B3.3/8" Lock Nut Qty.1
(pre-installed)

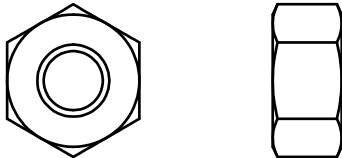

C2.M10 Washer (Ø28) Qty.54

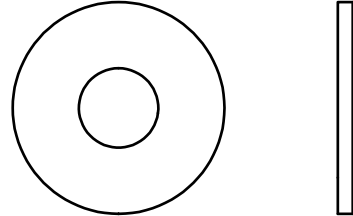

C3.M8 Washer (Ø18) Qty.11
(pre-installed 2PCS)

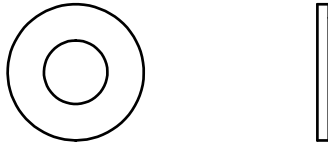

C4.M8 Spring Washer Qty.11
(pre-installed 2PCS)



C5.Tach (Ø25) Qty.1
(pre-installed)

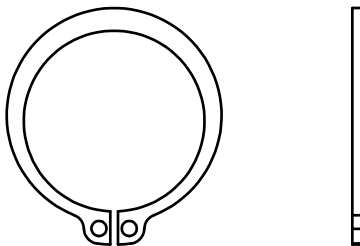

C7.M12 Washer (Ø25) Qty.19
(pre-installed 14PCS)

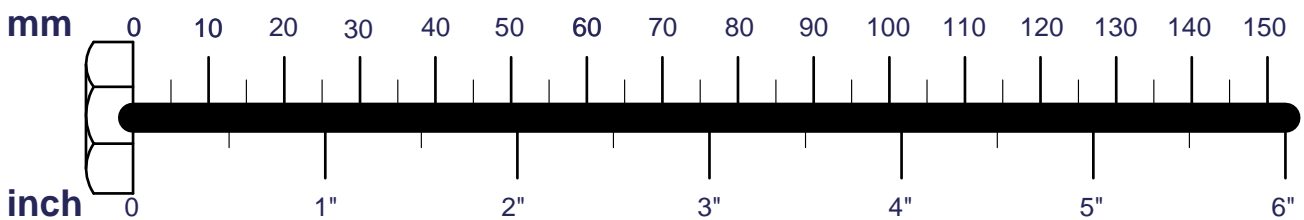
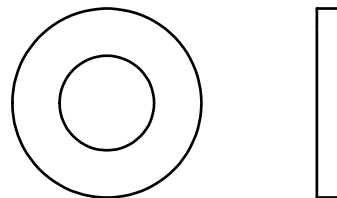

PLHP.5 HARDWARE
(shown in actual size)

A[1PCS]

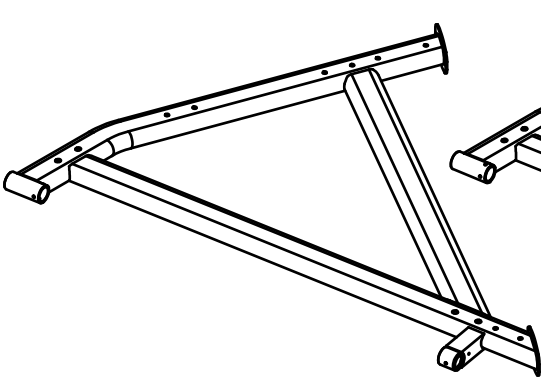

B[1PCS]

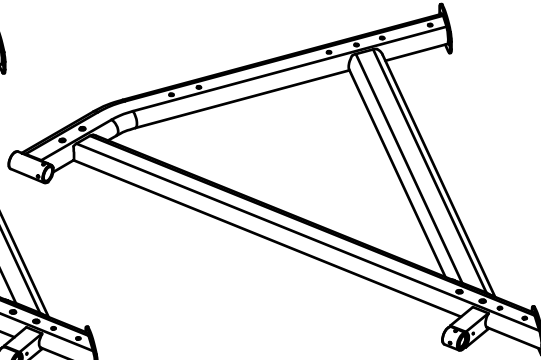

C[1PCS]

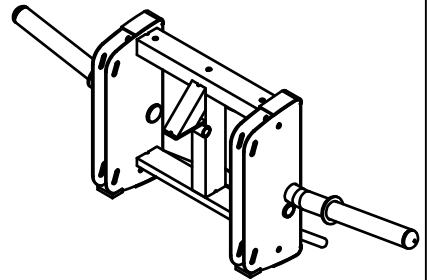

D[1PCS]

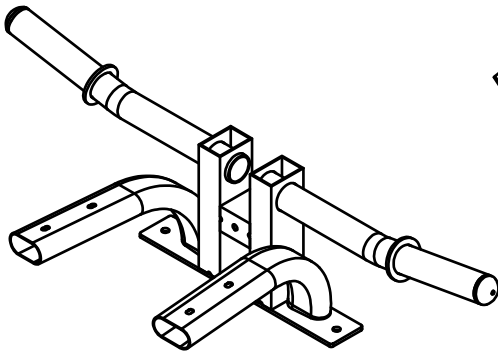

FA[1PCS]

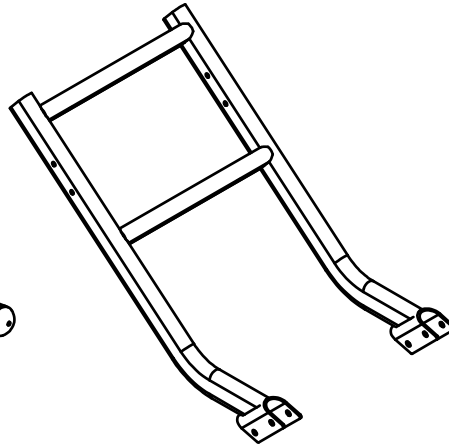

FB[1PCS]

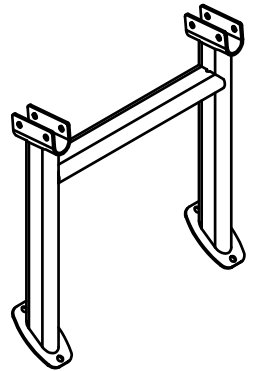

G[1PCS]



H[1PCS]

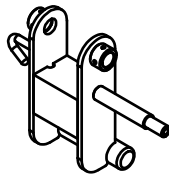

K[1PCS]

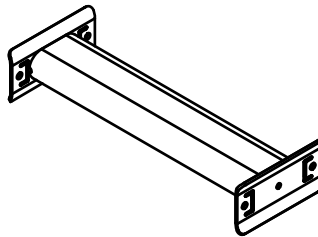

L[1PCS]

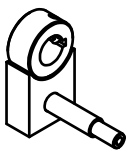

M[1PCS]

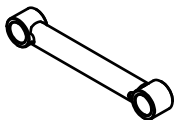

O[1PCS]

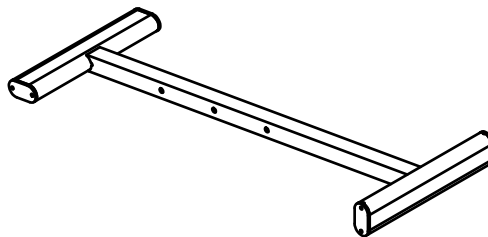

Z[1PCS]

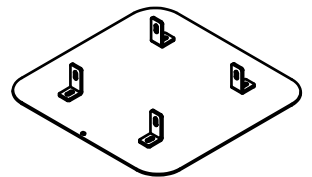

PLHP.5 HARDWARE
(shown in actual size)

S[2PCS]
8280-030

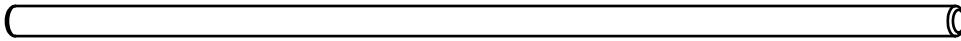

J[4PCS]
6730005

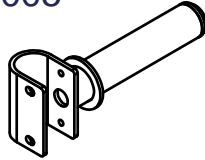

P[2PCS]
8323-234

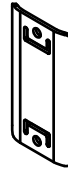

W[4PCS]
8342-048

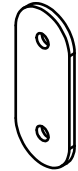

N[2PCS]
9131-054

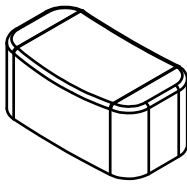

Q[1PCS]
9111-092

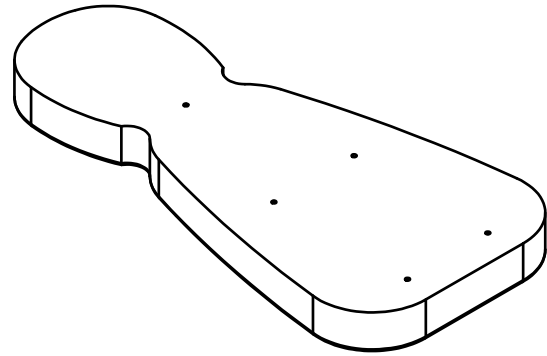

X[2PCS]
8343-305

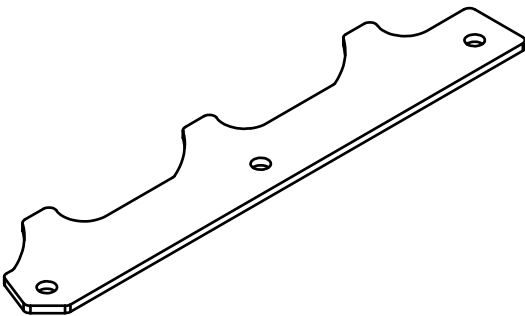

Y[2PCS]
8312-013

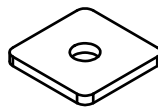

Z1[1PCS]
9310-095

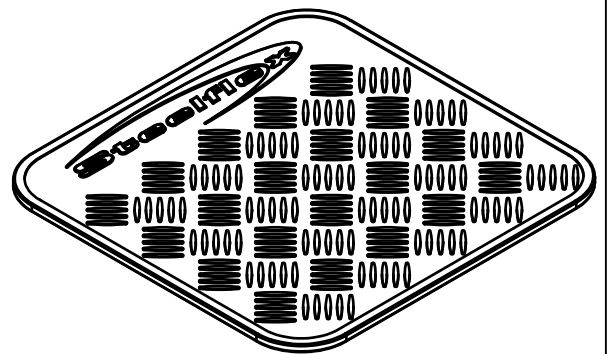

PLHP.5 HARDWARE
(shown in actual size)

D2.Rubber Insert (9310-076).....	[6PCS]
D3.Bushing (9212-069).....	[2PCS]
D4.40X80 End Cap (9211-191)	[2PCS]
D5.Rubber Dount (9310-016).....	[8PCS]
D6.Ø50 End Cap (9211-020).....	[4PCS]
D7.25X50 End Cap (9211-086).....	[1PCS]
D8.Compression Spring (8840-018).....	[1PCS]
D9.Shaft (8210-185) pre-installed.....	[1PCS]
D10.Key 6x6x30 pre-installed.....	[1PCS]
D11.Impregnated with handle (9162-155) pre-installed.	[2PCS]
D12.Pinch Cock (OC-06).....	[4PCS]
D13.Chrome Collar (8890-061) pre-installed.....	[2PCS]
D14.Oilite Bushing (8520-005) pre-insralled.....	[2PCS]
D15.Oilite Bushing (8520-002) pre-insralled.....	[2PCS]
D16.Oilite Bushing (8520-001) pre-insralled.....	[4PCS]
D17.Pulley (9266-025) pre-installed.....	[8PCS]
D18.Magnet (9546-104) pre-installed.....	[1PCS]
D19.Rubber Stopper (9310-018) pre-installed.....	[2PCS]
D20.Railing (9215-008) pre-installed.....	[1PCS]
D21.75X50 End Cap (9211-084).....	[2PCS]
D22.Copper sheath (8530-024) pre-installed.....	[16PCS]
D23.Bearing (8510-012) pre-installed.....	[16PCS]
D24.End Cap (9211-192)	[2PCS]

D2

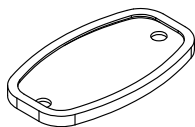

D3



D4

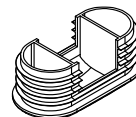

D5



D6



D7



D8



D9

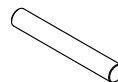

D10



D11

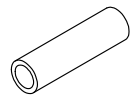

D12

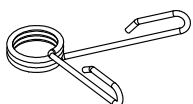

D13



D14



D15



D16



D17

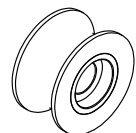

D18



D19



D20



D21



D22



D23



D24

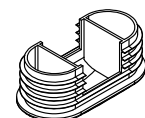

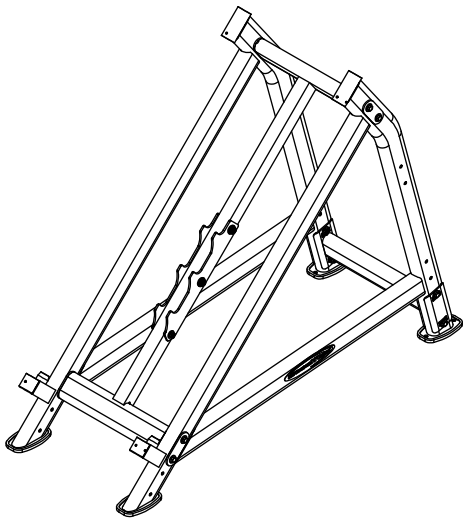

Above shows STEP 1 assembled and completed

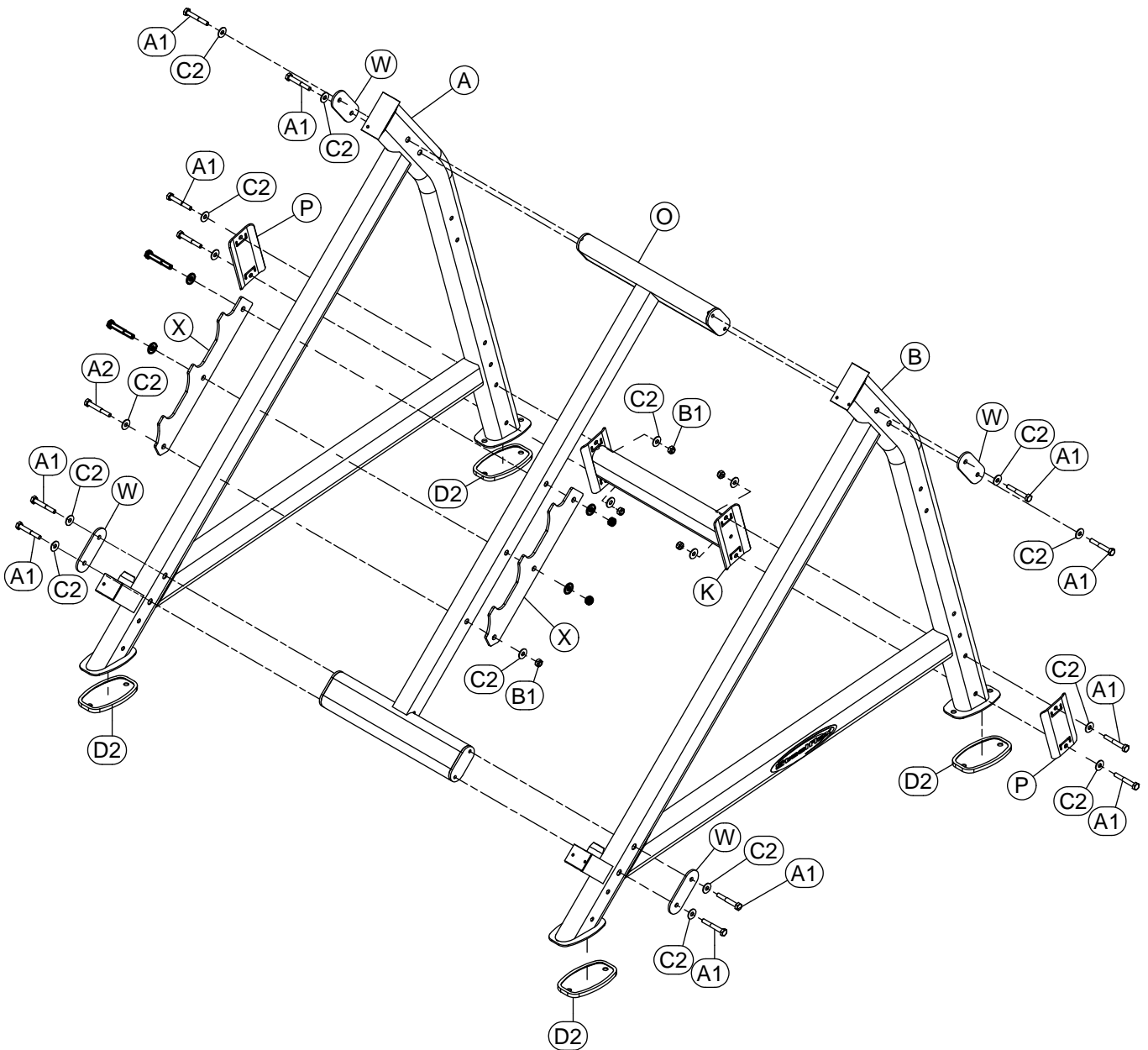

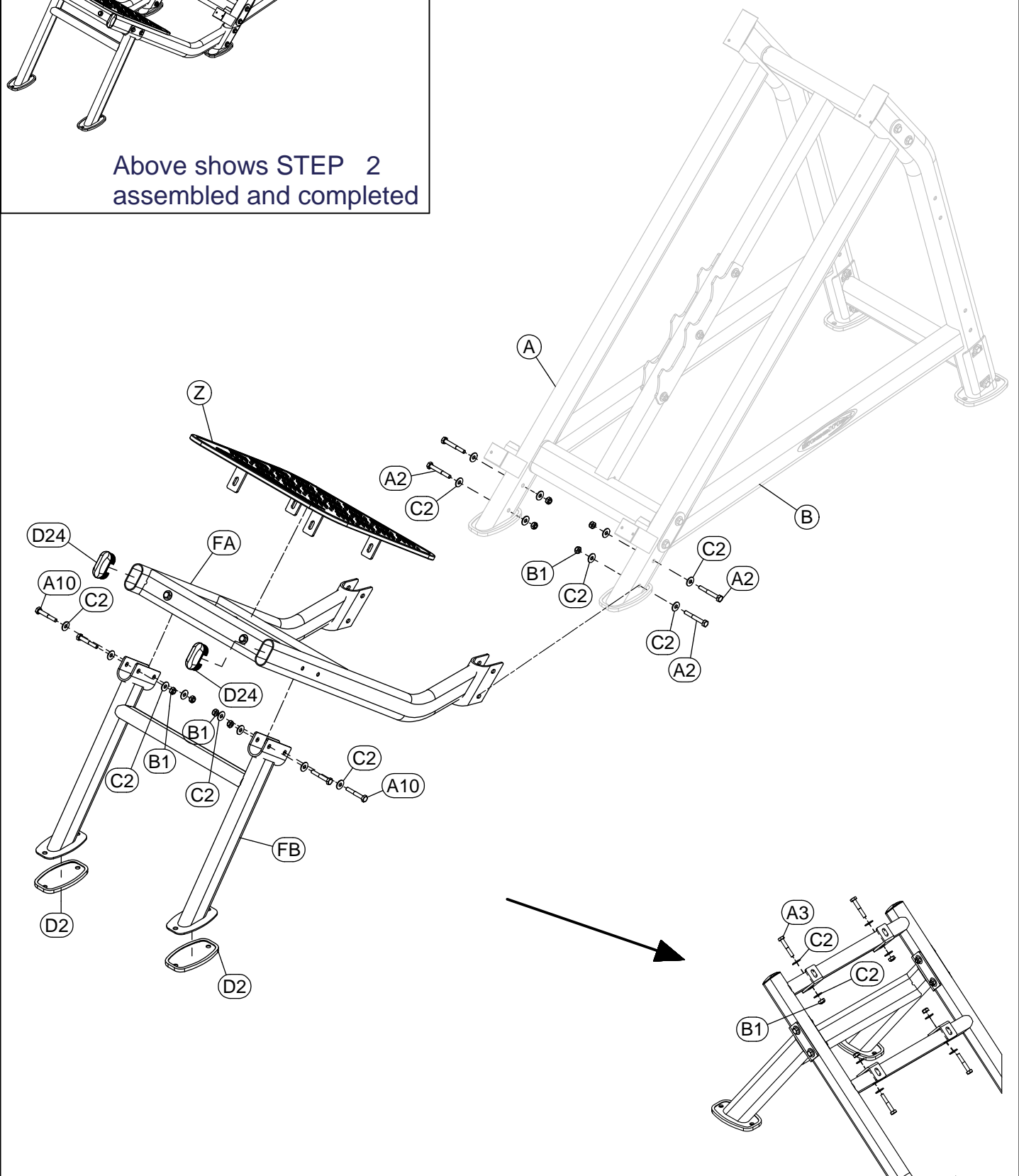

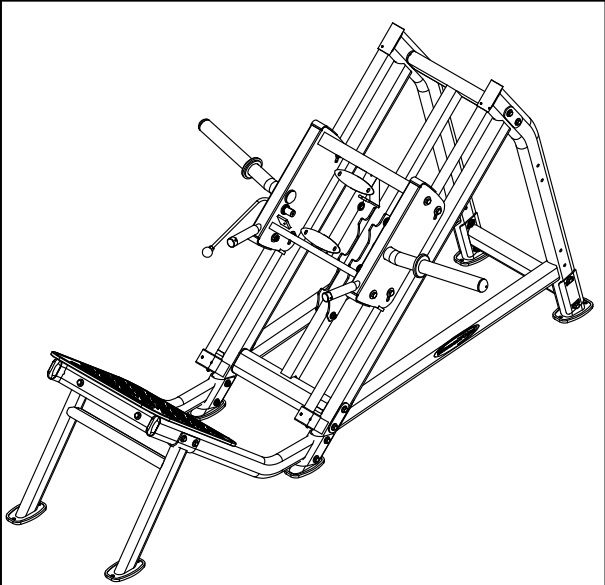

Above shows STEP 3 assembled and completed

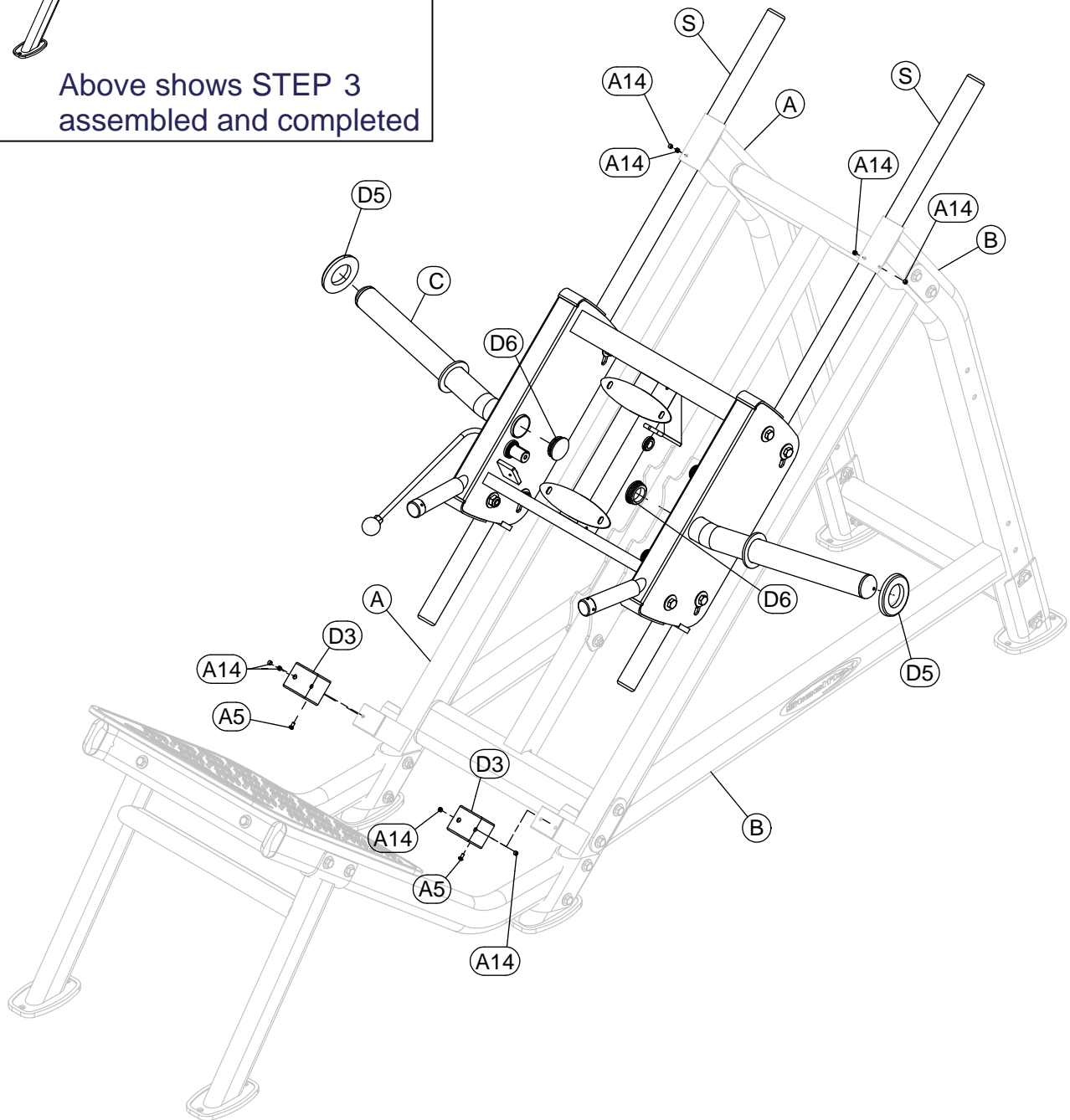

STEP
4

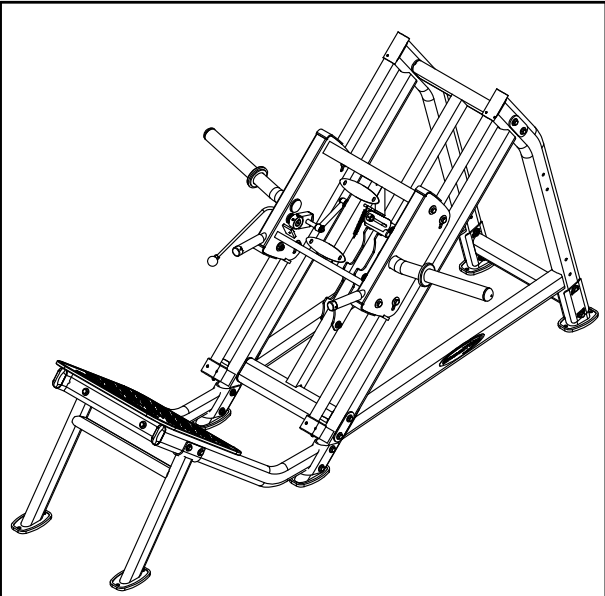

Above shows STEP 4 assembled and completed

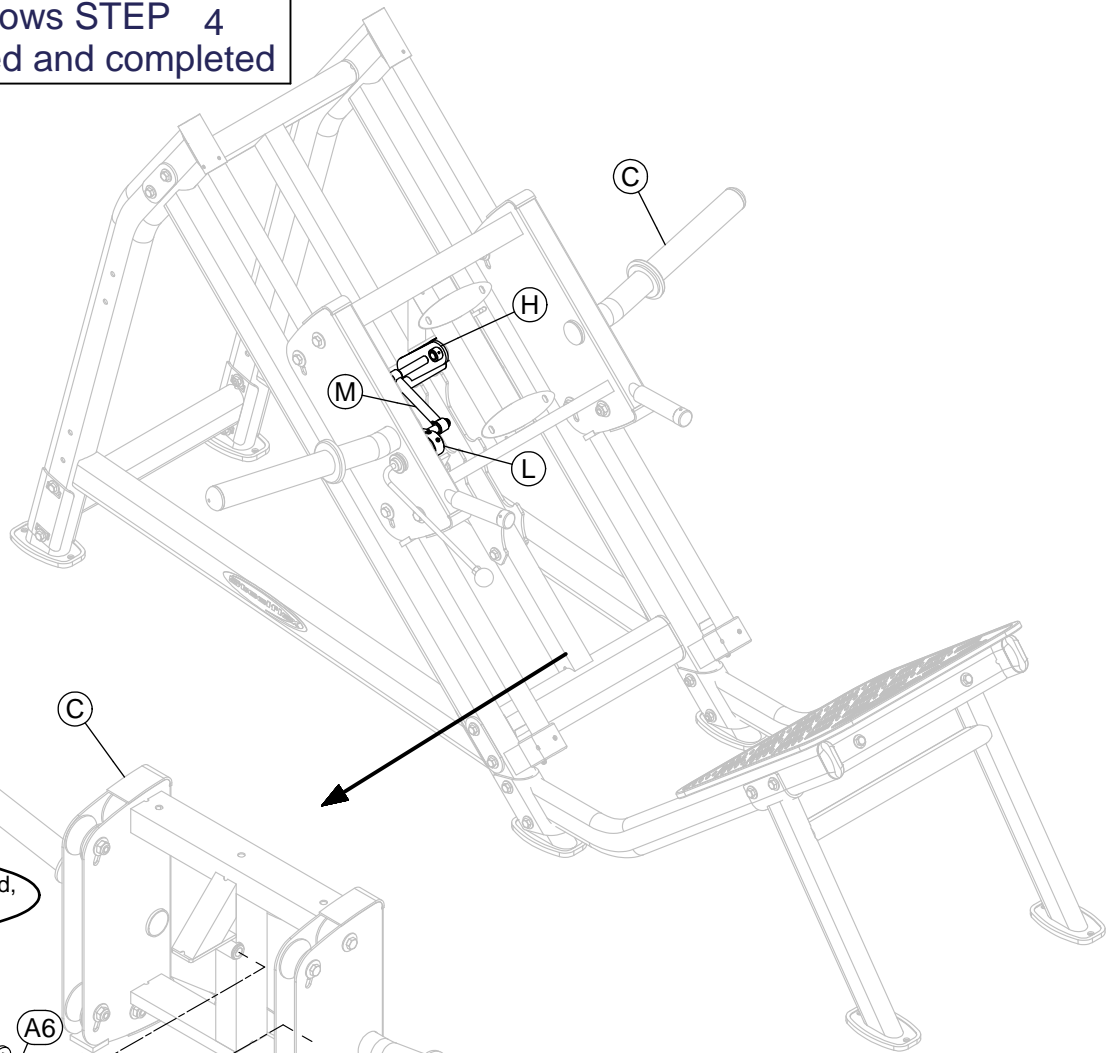

The other part is first installed, the installation "D9"

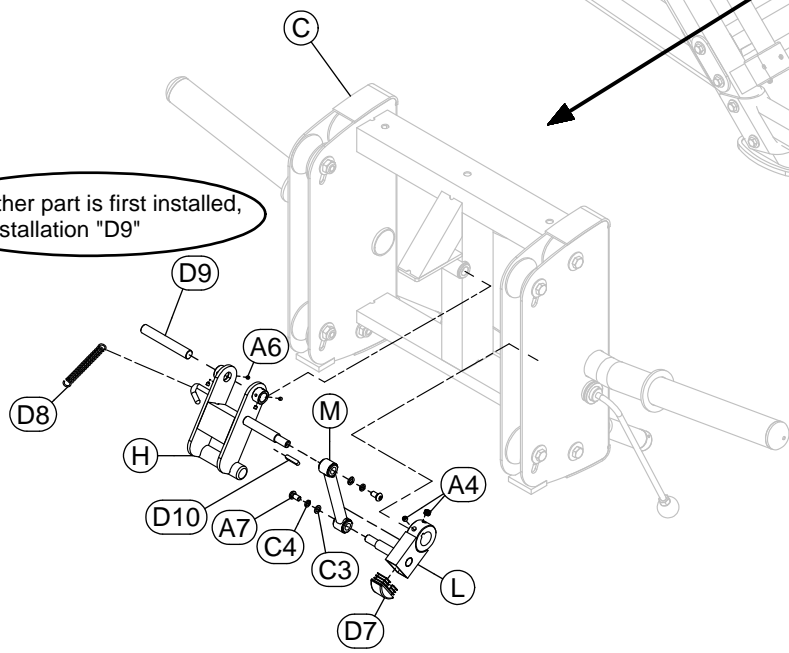

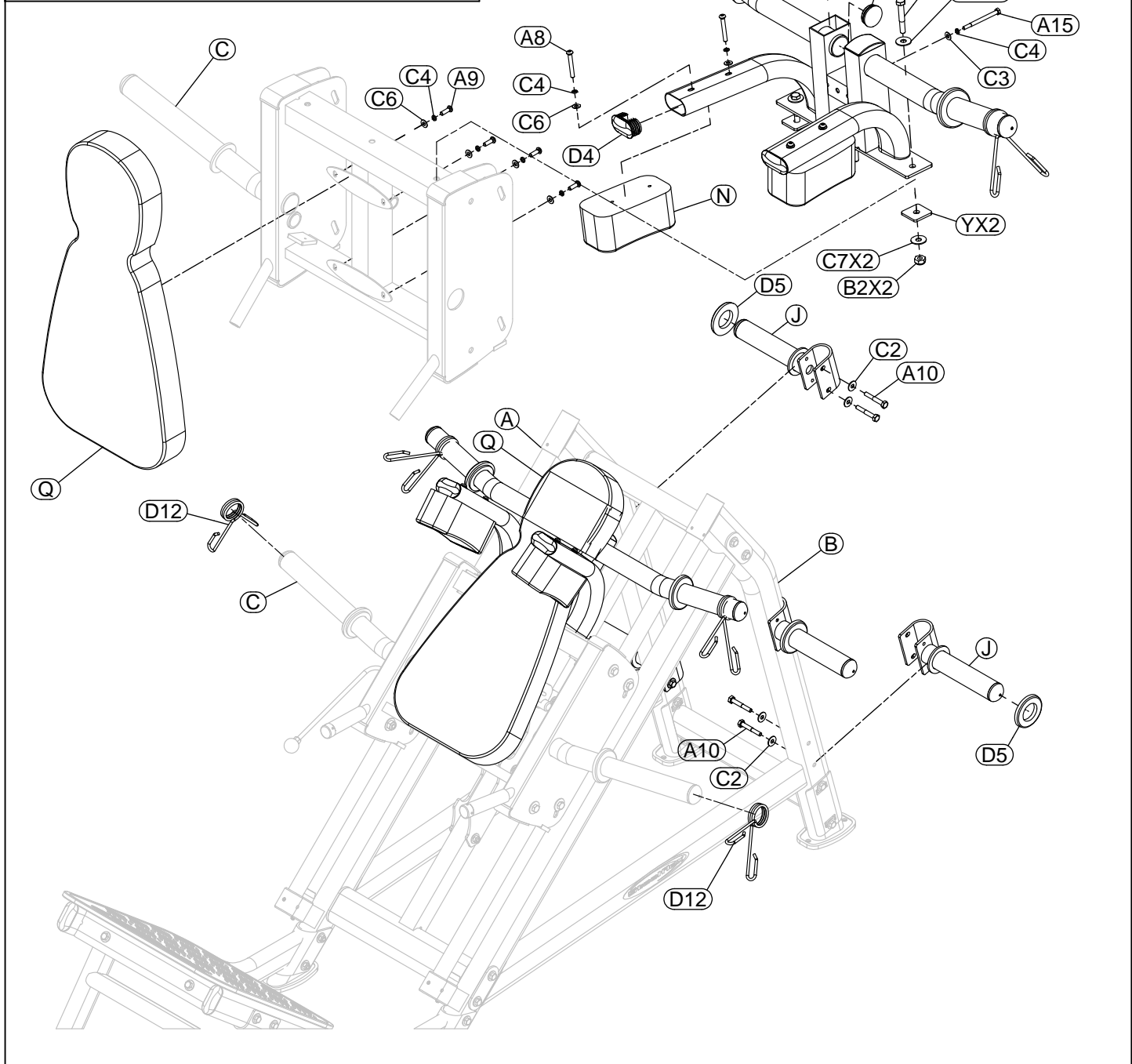
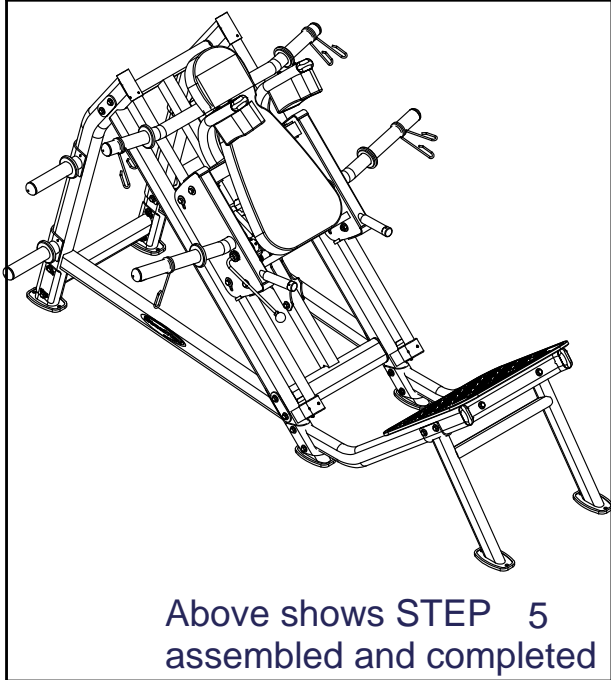

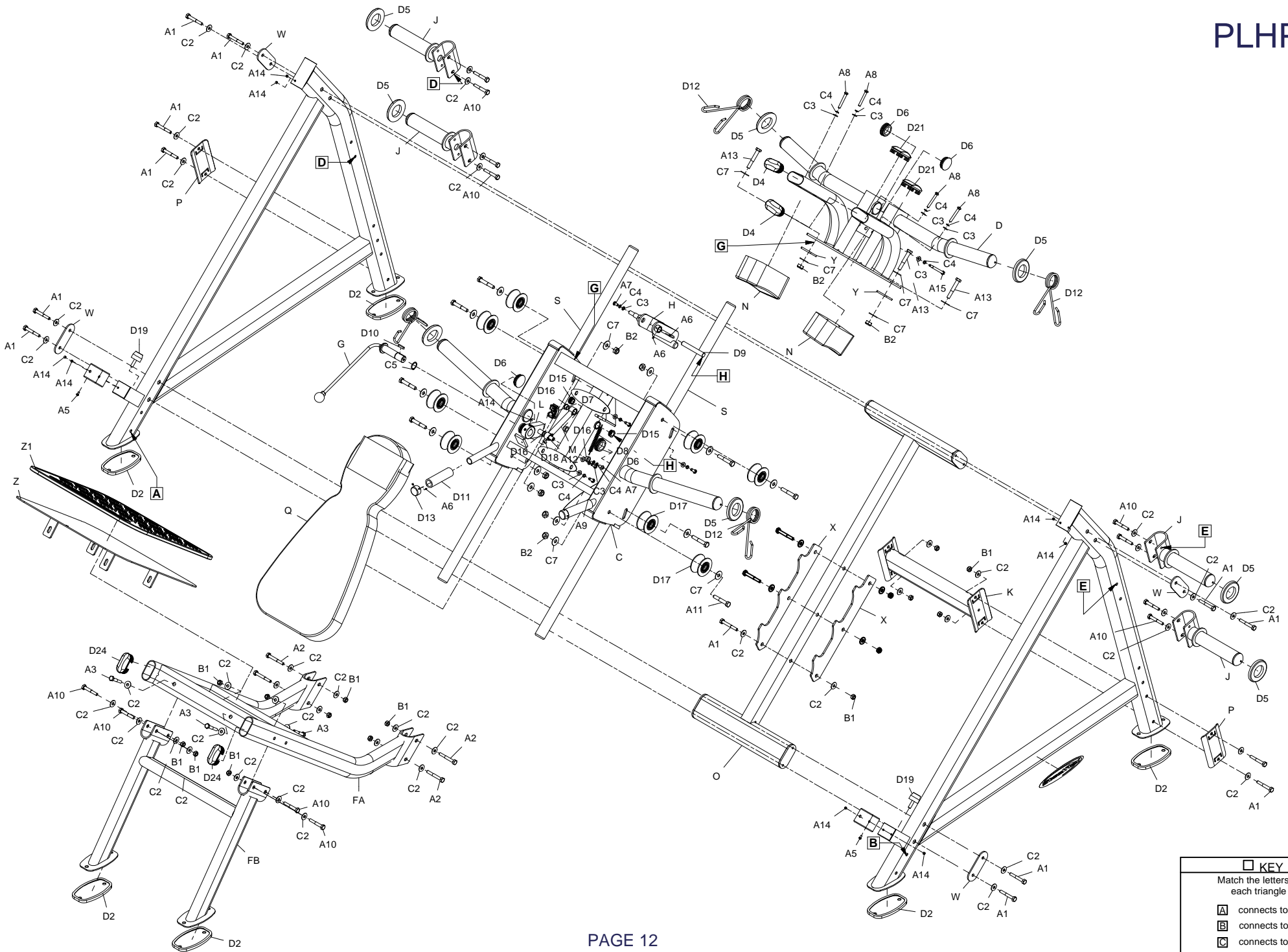

KEY			
Match the letters inside each triangle			
A	connects to	A	
B	connects to	B	
C	connects to	C	