

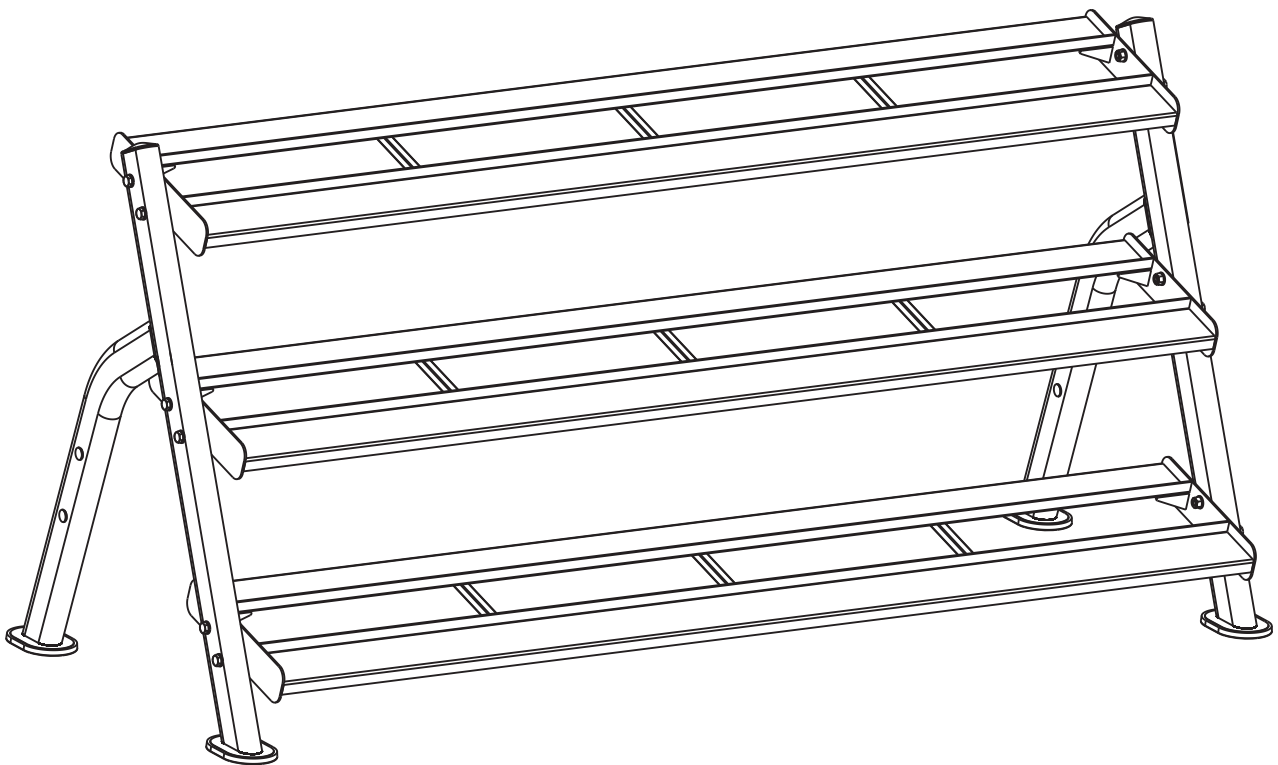

3-Tier Long Rail Dumbbell Rack

Model 6250



+ Owner's Manual

V 1.0 - 10.2020

+ Exploded Diagram

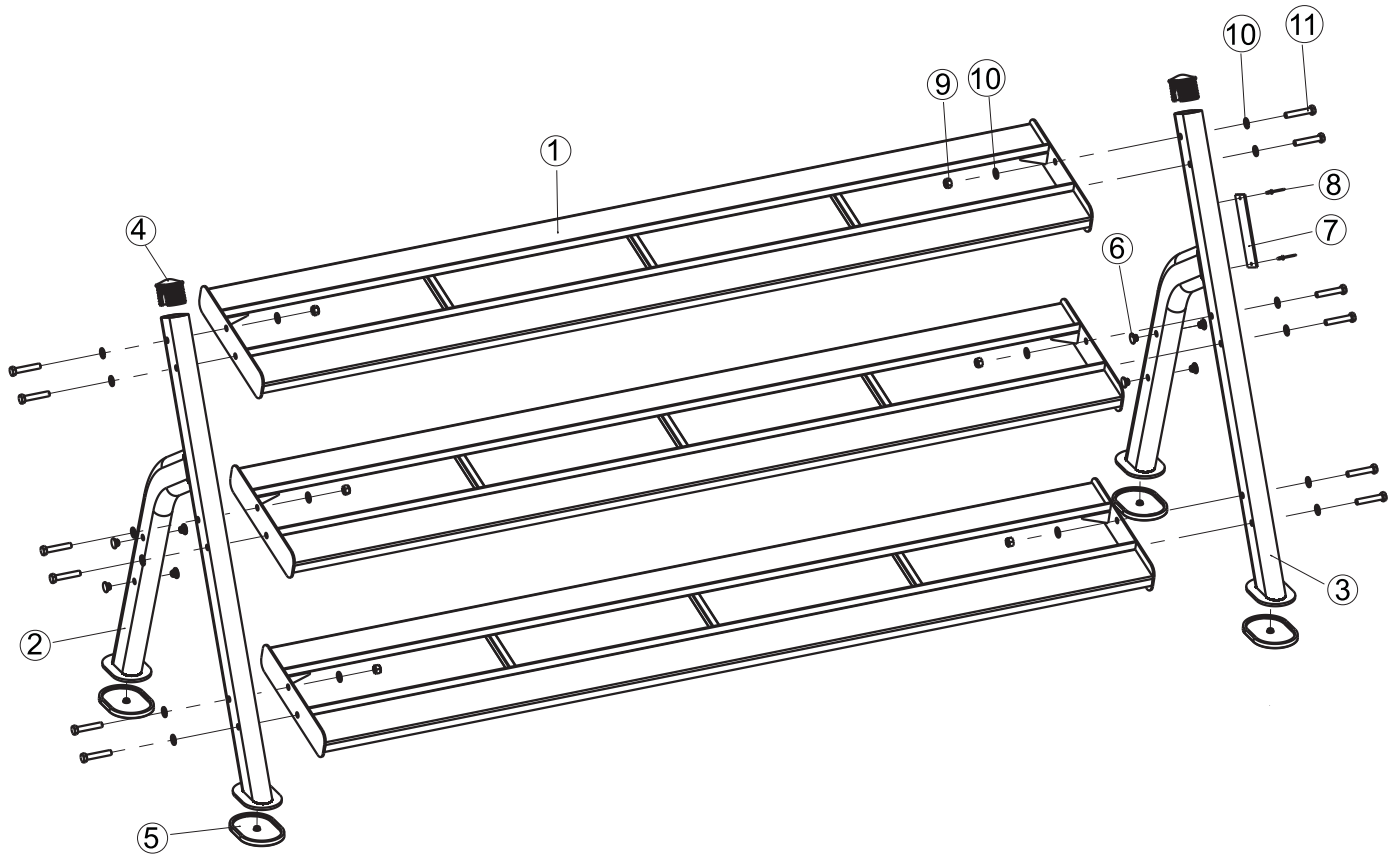

+ Parts List

NOTE: SOME OF THESE PARTS MAY COME PRE-INSTALLED

ITEM NO.	DESCRIPTION	QTY
1	Long Dumbbell Support Frame	3
2	Support Frame	1
3	Support Frame	1
4	Pipe Plug	2
5	Rubber foot	4
6	Pipe Plug	8
7	Aluminum Plate	1
8	Rivet $\phi 4$	2
9	Nylon Lock Nut M10	12
10	Flat Washer $\phi 11 * \phi 20 * 1.5$	24
11	Hexagon Bolt M10*55	12

+ Assembly

Step 1

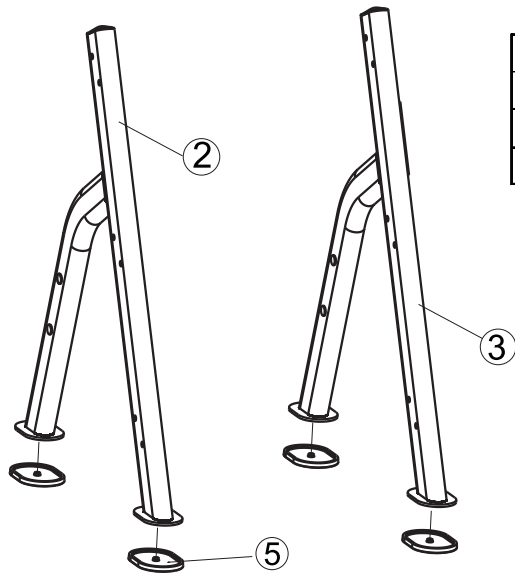

ITEM NO.	DESCRIPTION	QTY
2	Support Frame	1
3	Support Frame	1
5	Rubber foot	4

Step 2

ITEM NO.	DESCRIPTION	QTY	ITEM NO.	DESCRIPTION	QTY
1	Long Dumbbell Support Frame	3	9	Nylon Lock Nut M10	12
2	Support Frame	1	10	Flat Washer $\phi 11 * \phi 20 * 1.5$	24
3	Support Frame	1	11	Hexagon Bolt M10*55	12

