

ODDICT

TWIG

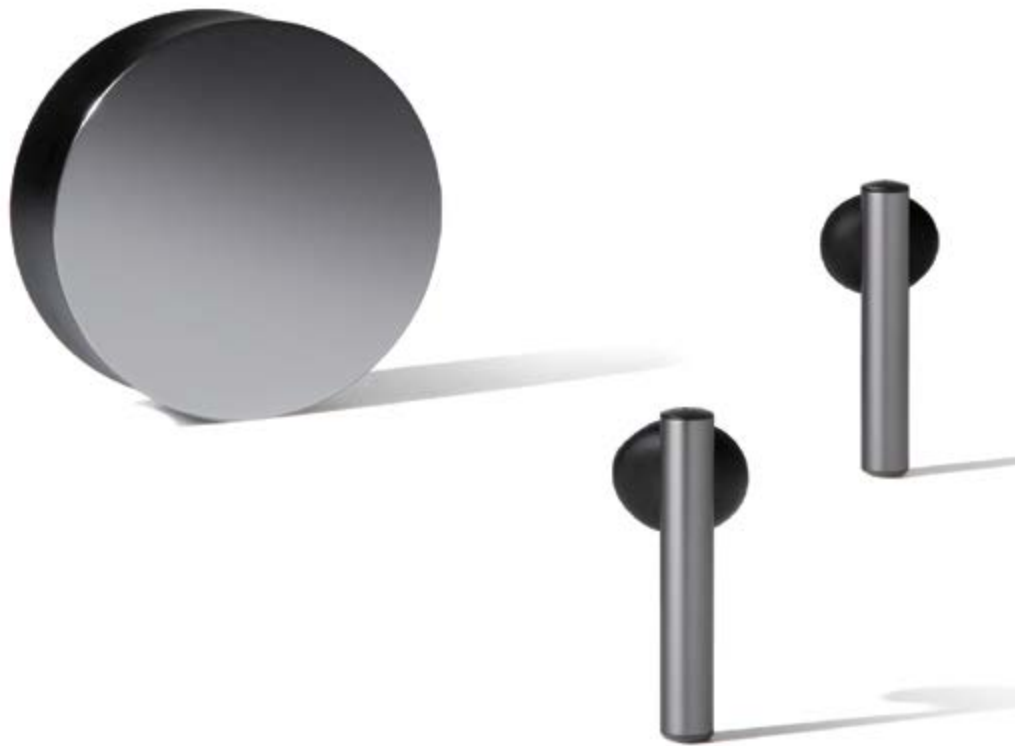

TWIG

Thank you for purchasing the ODDICT TWIG
Please follow the directions and read the guidelines carefully before use.
Keep the owner's guide for future reference.
Some functions of the TWIG may not be available
when paired with certain devices.
The specifications are subject to change
without prior notice for quality improvement.

1. Safety and general information
2. Package Contents
3. Pairing
4. How to use the Silicon eartips
5. Charging
6. Power ON/OFF and Standby mode
7. Pairing with another Bluetooth device
8. Managing Music (play & control)
9. Call Function
10. Using Voice command
11. Resetting the device
12. ODDICT APP
13. Specifications
14. Troubleshooting
15. Certification

1. Safety and General Information

- 1) Use a standard USB charging cable (included), with or without a charging adapter. (5V, over 1 A)
※Adapter not included.
 - 2) Lower the volume prior to listening to audio to prevent potential damage to eardrums caused by sudden loud sound.
 - 3) Listening to loud music for extended periods of time may cause hearing damage.
 - 4) Do not store the device in places with a temperature higher than 113 °F / 45 °C.
 - 5) This device is IPX4 sweat and water resistant. It is not waterproof. Please use caution not to oversaturate with moisture or leave excessive moisture on the device as this can damage to the internal components. In case the device gets wet, please contact our customer service for support. Visit our FAQ page for more information.
 - 6) Do not attempt to disassemble, modify, or repair the device.
 - 7) Do not cause shock to the device.
 - 8) Keep out of the reach of children and pets.
 - 9) Do not tug on cords or touch power plugs with wet hands.
 - 10) Do not use the device near microwave ovens or wireless LAN adaptors.
 - 11) When the product is not being used, please keep it in the Cradle.
 - 12) When cleaning the device, use a clean dry cloth to wipe the device clean. Do not use solvents.
 - 13) To clean the silicone eartips, remove from earphones, wash with warm water, dry completely and check for debris before reattaching.
 - 14) Replacement ear tips can be purchased from ODDICT Customer Service.
 - 15) Using the device while walking or driving may prevent the user from hearing important sounds such as signals or alarms and may impose hazardous conditions on yourself and/or others. Heed caution during use.
 - 16) The radio waves on this device may affect electronic medical devices. If you use any electronic medical devices, consult your doctor or the medical device company before using.
- ※Use TWIG only for its intended purposes.
- ※This device cannot be used for purposes related to human safety as it may cause radio interference during operation.

2. Package Contents

1) Package Contents

- TWIG Charging Case
- TWIG Earbuds Left / Right
- Silicon Tips Left /Right (Silicone tips come pre-attached.)
- USB - C Type Cable
- Quick Guide
- Warranty Card

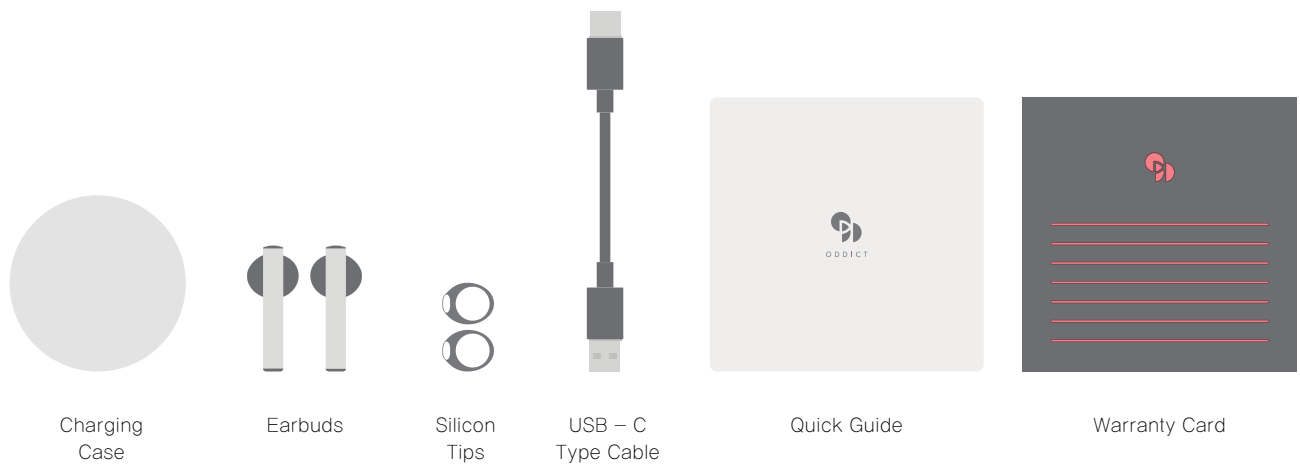

2) Components & Features

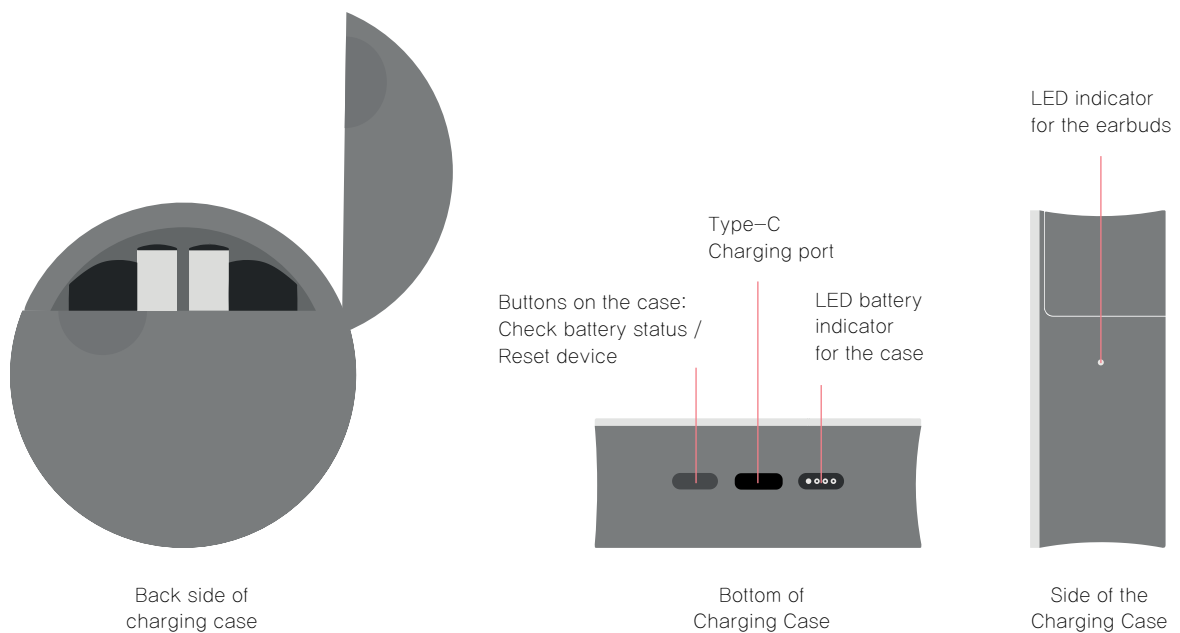

3. Pairing

★ Remove the film on the earbuds and charge for at least 10 minutes before first time use.

TWIG will automatically go into pairing mode when the case is open.

- ① Turn the Bluetooth on of your device.
 - ② Open the case to automatically go into pairing mode.
 - ③ Select TWIG in the Bluetooth settings of your device.
 - ④ When the earbuds connect to your device via Bluetooth, you will hear a high-pitched tone (marimba).
Once you place the earbuds in your ears, you will hear a low-pitched tone (synth), indicating your device and earbuds are connected and ready to use. (The earbuds must be worn to activate the touch sensor features.)
- ※ Once the pairing is complete, TWIG will pair with the last device it was connected to.

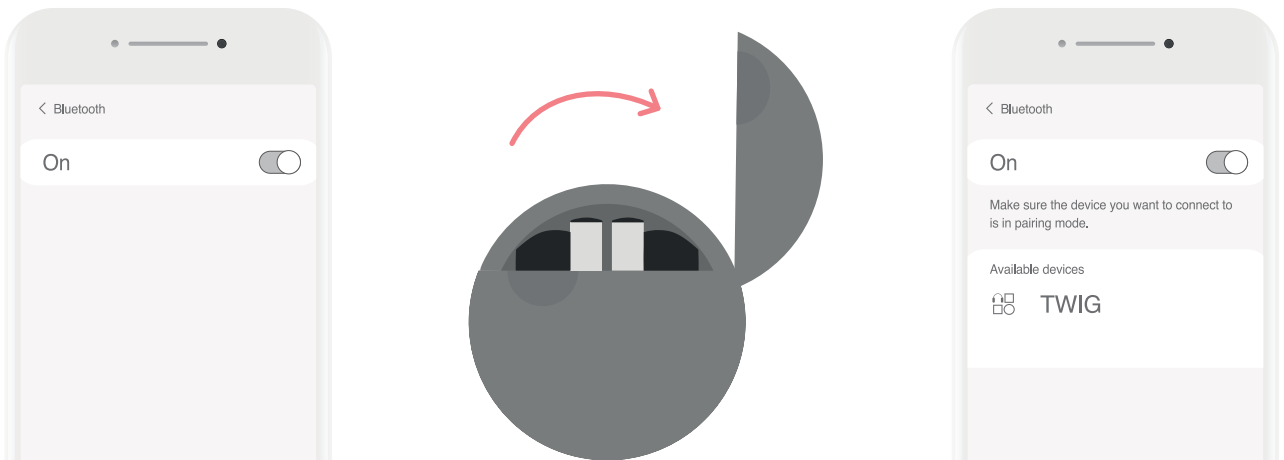

4. How to use Silicon eartips

TWIG earbuds can be worn in two sizes via the silicone eartips.

Depending on the user's preference or the size of the ear canal, a silicone eartip can be used to increase sound insulation, or can be removed for added comfort and lightness.

- ① Earbuds and silicone eartips both contain L/R indicators
 - ② The L/R markings on the silicone eartips will cover the L/R markings on the earbuds
- ※ Silicone eartips come preinstalled with the earbuds.
※ To deliver a secure fit, the silicone eartips come perfectly molded to the earbuds

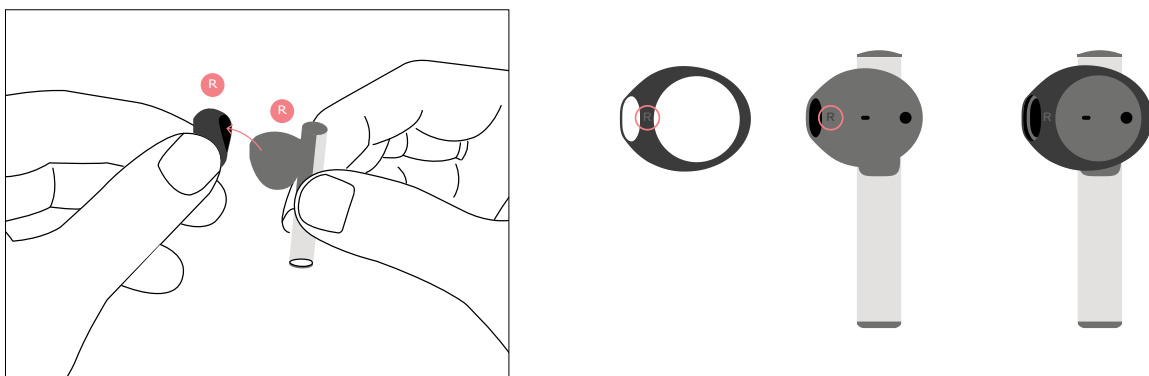

5.Charging

The earbuds begin charging from the moment they are stored in the case.
Case supports both USB Type C charging or wireless charging.

5.1 Charging the Earbuds

- ① Place the earbuds (L/R) in the case and close the case.
 - ② The status LED on the side of the case will turn on for approximately 3 seconds and will start blinking, indicating that the earbuds are being charged.
- ※ When the earbuds are fully charged, the charging status LED light on the side of the case will turn off.

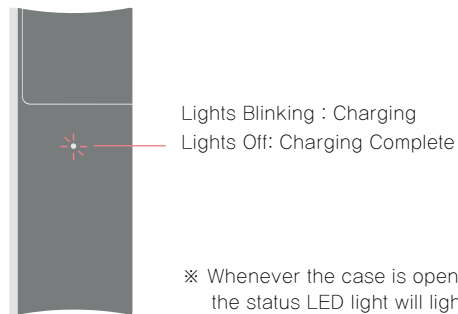
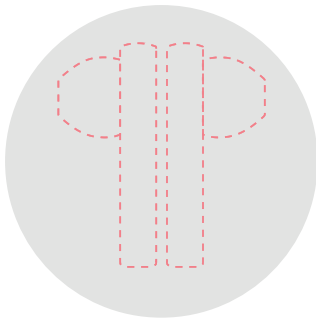

※ Whenever the case is opened or closed the status LED light will light up for 3 seconds.

5.2 Charging the Case

1) Using the Charging cable

- ① Connect the Type-C charging cable to the port at the bottom of the TWIG case.
- ② Lights indicating charging status are on the bottom of the case.
Gradually dimming lights indicate that charging is in process.

2) Wireless Charging

- ① Place the aluminum side up for wireless charging.
- ② Case charging status is show by the LED light on the bottom of the case.

5.3 Checking the remaining battery level

1) Checking the battery level of the earbuds

Battery level can be checked via the ODDICT app

2) Checking the battery level of the case

If you press the button on the bottom of the case, you can check the remaining battery levels with the 4 LED status lights.

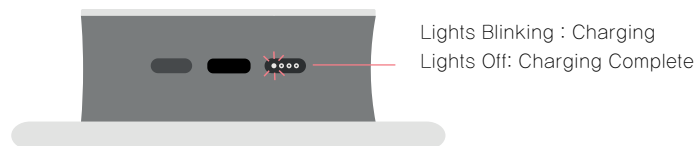
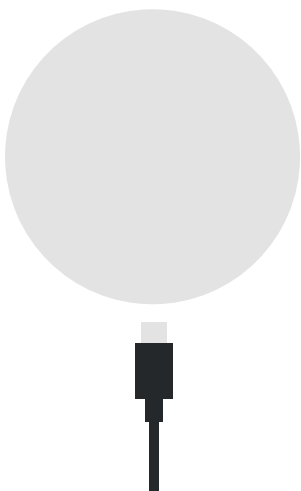

6. Power ON/OFF and Standby mode

TWIG earbuds are turned on/off automatically depending on whether the case is connected without any separate operation.

(Power ON when the case is opened / Power OFF when the earbuds are in the case and the case is closed.)

1) Turning on the earbuds

When the case is opened, the earbuds will turn on automatically and connect to a device with a connection history. If there is no device with a previous connection history nearby, the earbuds will automatically enter pairing mode.

※ When in pairing mode, the earbuds will turn off after 5 minutes if the Bluetooth has not been connected to.

2) Turning off the earbuds

Insert the earbuds into the case and close it to turn off the earbuds.

※ You can turn on/off the earbuds only when there is remaining battery power in the case.

7. Connecting/pairing with other Bluetooth devices

7.1 Connecting to other devices (maintaining the existing connection history)

① Disconnect the Bluetooth connection from the current device.

② In the Bluetooth settings of the device you want to connect, search for the device and select 'TWIG'.

※ When the case is open, the earbuds will automatically enter pairing mode if there is no device nearby with a connection history.

7.2 Manual Pairing (Delete all pairing history)

① Place both earbuds in the case and with the case still open press the button on the bottom of the case for 8 seconds.

② The lights will blink 4 times then will go into manual pairing mode and delete all previous pairing history.

※ If you use this Forced Pairing Mode, you must reconnect devices with an existing connection history.

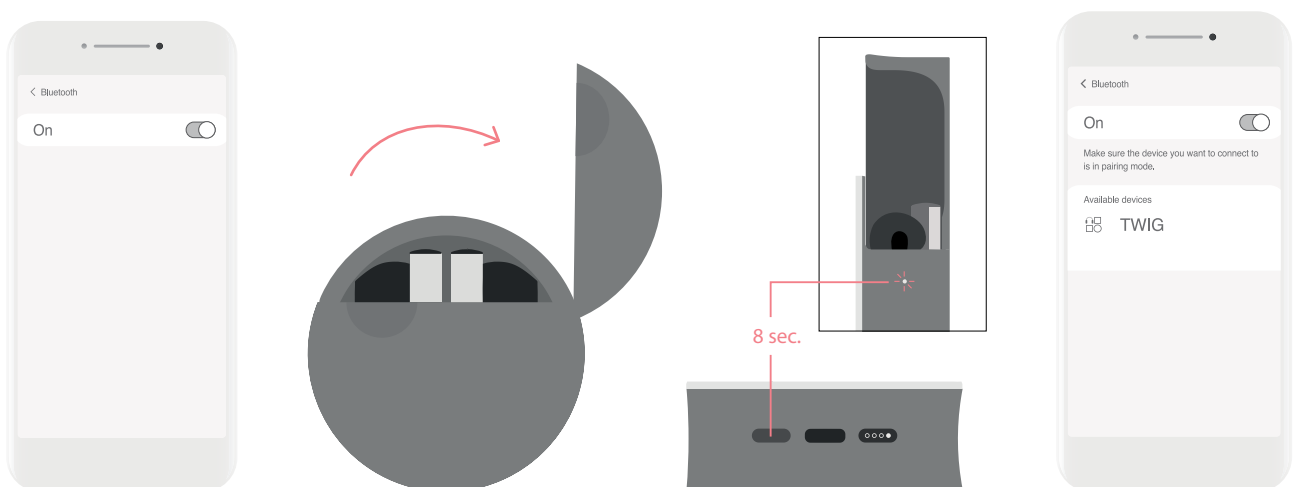

8. Managing music (play & control)

Tap the TWIG earbuds to manage the music of the connected Bluetooth device. Please check the recommended tap position (top of earbuds) as shown in the picture below.

1) Play/stop music

- ① Double-tap the right (R) earbuds ●● to play music from the Bluetooth device.
- ② Double-tap the right (R) earbuds ●● to stop the song if it's playing.

2) How to use the change song function

- ① Double-tap the left (L) earbuds ●● to skip to the next song.
- ② Triple-tap the left (L) earbuds ●●● to go back to the previous song.

- ※ You can also control the music directly from the 'Bluetooth Device'
- ※ Functions may vary depending on the paired Bluetooth device.
- ※ Tap more firmly if controls do not operate properly.

9. Call Functions

If you receive a call while using TWIG, tap the earbuds to answer and end the call.

1) Answering a call

Tap earbud twice ●● to accept / end a call.

2) Ending a call

When the call is over, double-tap the earbuds ●● to end the call.

(In the case of a call received while listening to music, the music will automatically pause and will play again when the call ends.)

- ※ When connecting to a call, the audio will come out of the earbuds.
- ※ Functions may vary depending on the paired Bluetooth device.
- ※ May need to press firmly on buttons.
- ※ When you click/touch on the connected device to answer a call, the call will connect to the device.

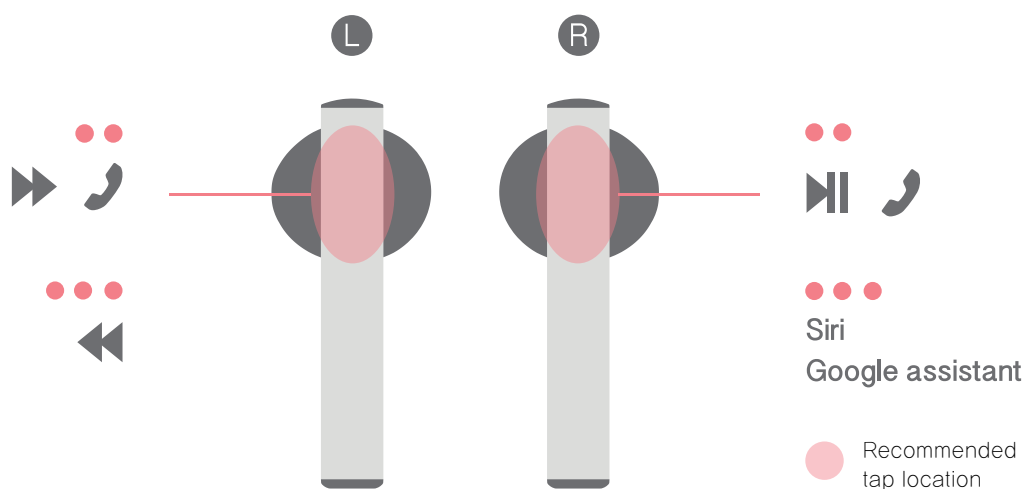

10. Activate the voice command function

Activate the voice command function of the connected Bluetooth device by tapping the TWIG Earbuds. Tap the right (R) earbud 3 times ●●● to activate Siri or Google Assistant.
※ Functions may vary depending on the paired Bluetooth device.

11. Product Reset

If an unknown problem occurs with the TWIG, most issues can be resolved by simply resetting the device.

- ① Use USB Type-C cable for charging.
 - ② While the cable is plugged in and charging, open the case and press the button on the bottom of the case for 15 seconds. The earbud charging status LED light will blink 8 times and the resetting process will begin.
 - ③ After 15 seconds, close and open the case to enter the pairing mode.
- ※ All existing connection history will be reset.

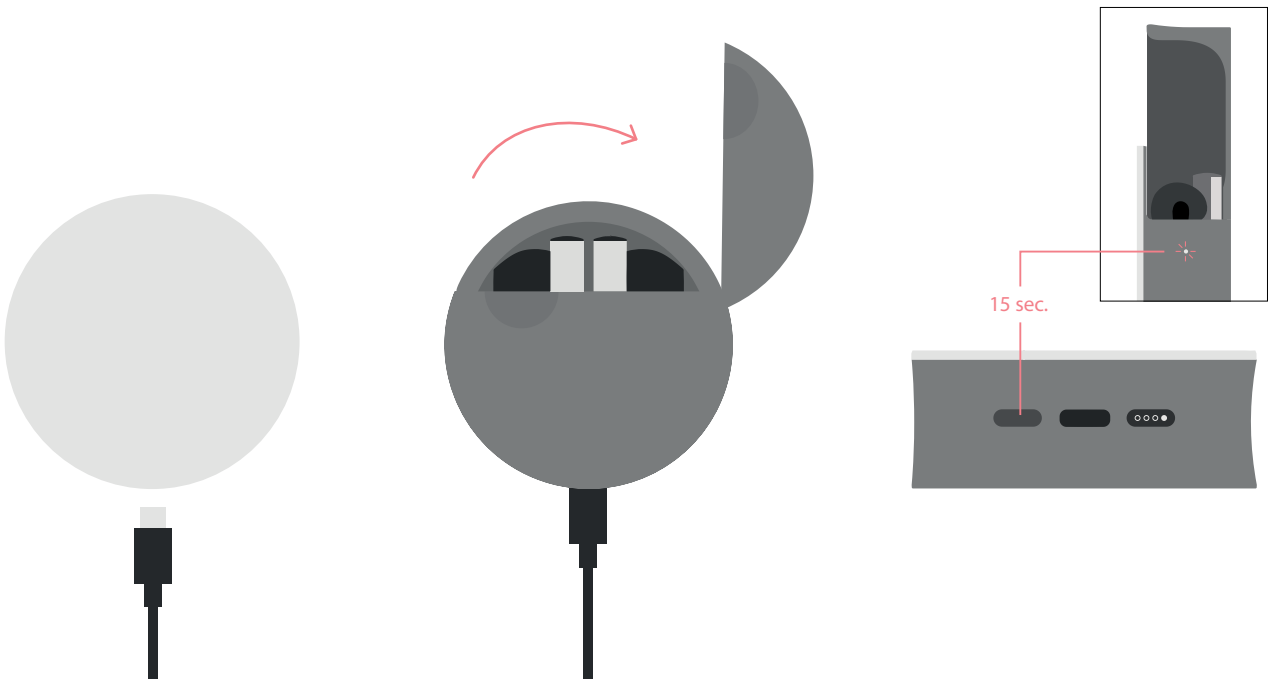

12. ODDICT APP

This is the dedicated app for TWIG which provides a variety of control functions including equalizer, changing device name for personalization.



12.1 Download the ODDICT APP

- ① Search for ODDICT in the Google Play or Apple App Store and download/run the app.
- ② Create an account and log in.



12.2 Register your TWIG

- ① To connect your TWIG to the app, place both earbuds in the case.
Leave the case open and add the device through the app.
- ※ If there is a TWIG already registered, swipe left to see a new registration page.
- ② Follow the guide to open the case and touch 'START' at the bottom of the screen.
 - ③ If your TWIG appears in the search device list, select it to continue the pairing process
 - ④ Go to the Bluetooth settings of the connected device and complete the device connection.
- ※ If TWIG_LE and TWIG are shown at the same time in the Bluetooth connection settings, connect to 'TWIG'.

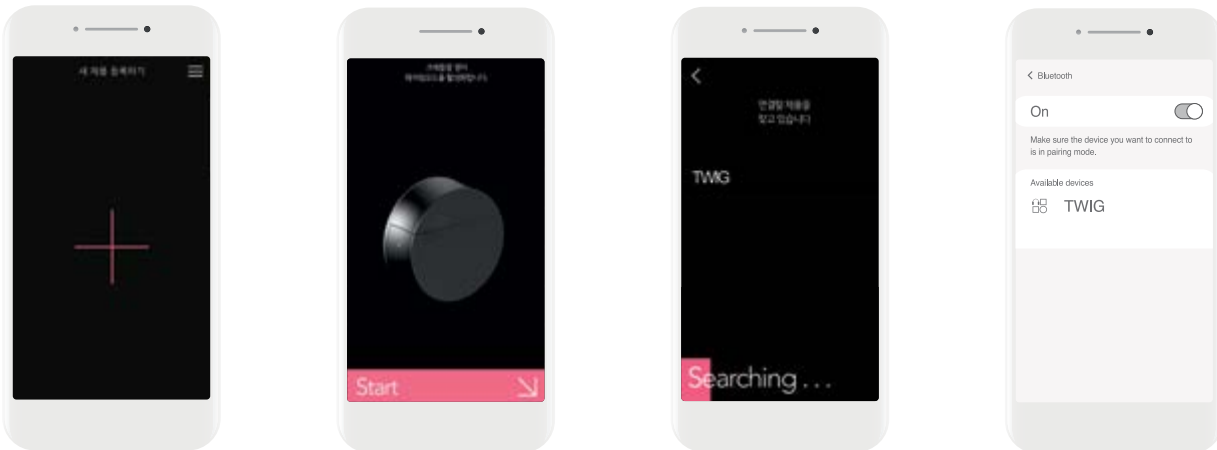

12.3 How to use the ODDICT APP

- A The name of the connected TWIG device will be displayed.
When registering for the first time, it will be marked as 'TWIG' and can be later modified in the ODDICT app.
- B If you tap the TWIG image, you will be taken to the TWIG menu screen.
- C C Moves to the APP settings screen.

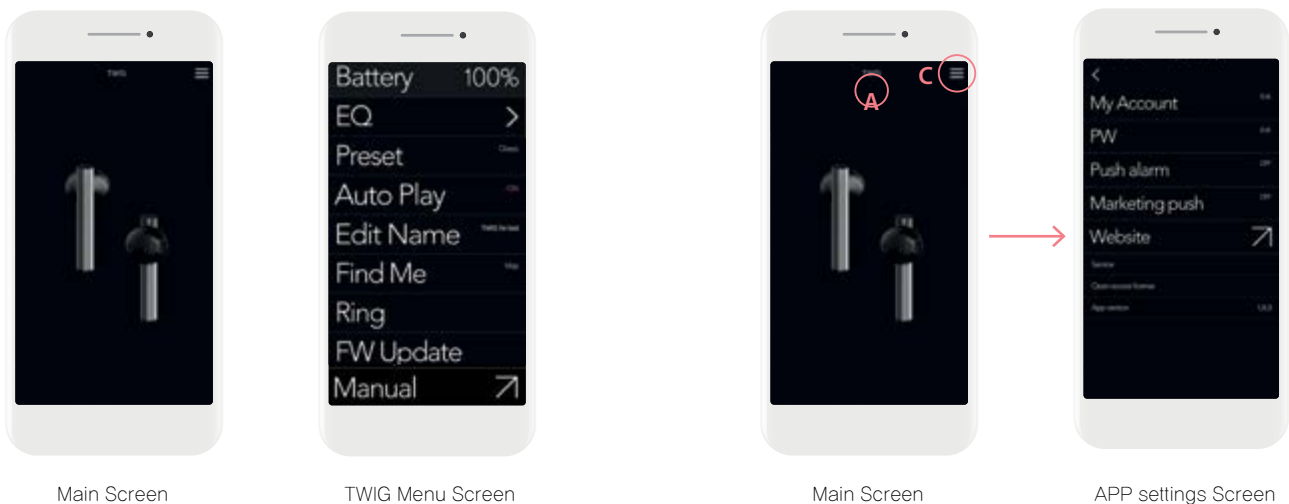

B) TWIG Menu Screen

Once TWIG is added on the app, go to the Bluetooth settings to complete the pairing process. You can set additional functions for the TWIG through the app.

Menu Items	Explanations
Battery	The remaining battery level of the earbuds is displayed.
EQ	Set the desired sound profile and save it as a preset.
Preset	EQ profiles can be selected based on the music genre or sound profile presets (Up to 6 can be created).
Auto Play	Turn on/off the auto play function that automatically plays music while wearing the earbuds.
Edit Name	Set the name of the registered device.
Find Me	Find the location where the registered product was last connected to the device.
Ring	A 2 kHz high-pitched tone will sound to indicate the location of the earbuds.
FW Update	Check the version of the app and update the firmware. ※ When a firmware update is required, it will be indicated by pink color. ※ Please wait until the update is complete ※ After the update is completed, the device name will automatically be changed to TWIG.
Manual	Check the manual of the registered device.
Delete	Delete registered device.

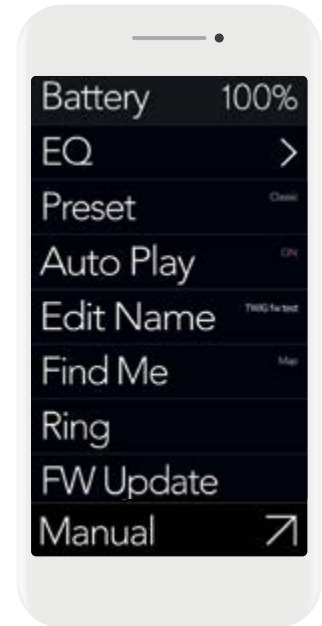

C) APP setting Screen

Menu Items	Explanations
My Account	Check the login account information connected with the app.
Push alarm	Receive or block notifications provided by ODDICT.
Marketing push	Receive or block marketing notifications provided by ODDICT.
Website	Link to the ODDICT official website. (www.oddict.co.kr)
Service Open-Source license App Version	Check the version of the app, license information, terms of use, and privacy policy.

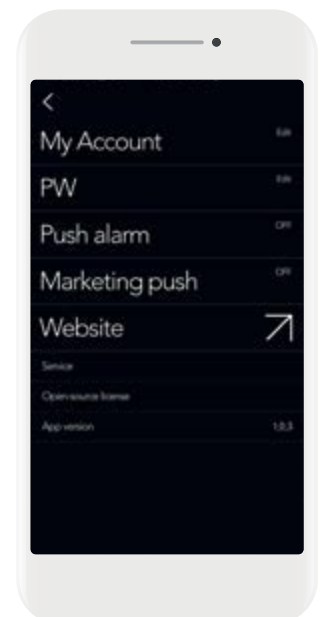

13. Specifications

1) TWIG earbuds

- Communication Network : Bluetooth Version 5.0
- Output Power: Power Class 1
- Max. Communication Range: Discoverable within 10 m / 33 ft.
- Full Charging Time: 1 hr
- Quick Charge: Support 10 min. Charging = 1 hr Playing
- Call Time: 2.5 hrs
- Music Play Time: 3 hrs
- Standby Time: 30 hrs
- Operating Frequency: 2.4 GHz (2,402 GHz ~ 2,480 GHz)
- Audio Codec: SBC, AAC
- Battery: Lithium Polymer DC 3.8 V / 30 mAh
- Microphone Frequency Range: 100 ~ 8,000 Hz
- Microphone Sensitivity: 42 dB
- Driver Unit: 12 mm / Dual Layered Carbon Paper
- Driver Unit Sensitivity: 103 dB/mW
- Driver Unit Impedance: 32 ohms
- Driver Unit Frequency Response: 20 Hz – 20 KHz
- Earbuds Weight: 9.4 g (Each 4.7 g)

2) TWIG case

- Input Power: DC 5 V / over 1 A
- Full Charging Time including Earphones: 2.5 hrs
- Number of 'TWIG' charging with 'Charging Case': 3 Times
- Standby Time: 3,200 hrs Max.
- Size: 58.6(H)X 58.6(W) X 22.5(D) mm / 2.30(H) X 2.30(W) X 0.88(D) in
- Weight: 38.7 g (Charging case)
- Operating Temperature: 0 ~ 45 ° C / 30 ~ 113 ° F

※ The specifications are subject to change without prior notice for quality improvement.

14. Troubleshooting

1) The power does not turn on:

- Make sure the earbud protection film has been removed.
- Charge the device for at least 30 minutes.
- If the power does not turn on even after charging, contact ODDICT Customer Service.

2) The device does not charge:

- Make sure the earbud protection film has been removed.
- Check whether the USB charging cable has been properly connected with the device.
- [Wireless charging] Check if the aluminum cover of the TWIG case is facing up.
- [Wireless Charging] Check if the TWIG case is correctly positioned at the charging location of the wireless charging pad.

3) The device does not pair:

- Check whether the power of the Bluetooth device you want to connect is on.
- Check whether the Bluetooth feature within the Bluetooth device you want to connect is enabled
- Check whether the Bluetooth device you want to connect is within the supported range.
(Pairing is supported only within 3 feet)
- Check whether the Bluetooth profile within the Bluetooth device is compatible.

4) When there is no sound or music:

- Check whether the power of the device and the Bluetooth device is on
- Check whether music is being played within the connected Bluetooth device.
- Check whether the volume within the connected Bluetooth device is low.

5) When there is static noise or the sound cuts off:

- Check whether there is another electronic device nearby using the 2.4 GHz frequency band that is connected to the Bluetooth device
- Check whether the connected Bluetooth device is within the proper communication distance to the device.
(Maximum communication range: 33 feet)

6) The other party cannot be heard while on a call:

- Check if the power of the Bluetooth device you want to connect is on.
- Check whether the volume within the connected Bluetooth device is low

7) Product does not operate or operation has stopped:

- Place the earbuds in the case, check the status indicator on the side of the case when it is closed, and then open the case again to pair.
- If any of the above methods do not work, please reset the earbuds.

8) The device is paired with a PC/Laptop but does not work:

- PC/Laptops are equipped with various Bluetooth drivers depending on the manufacturer.
It is possible that the PC/Laptop you are trying to connect is not compatible with TWIG

15. Certification

FCC Compliance Information

FCC ID: V2R-TWIG

This device complies with part 15 of FCC Rules.

Operation is subject to the following two conditions:

(1) This device may not cause harmful interference, and (2) this device must accept any interference received, including interference that may cause undesired operation.

Information to the user:

NOTE: This equipment has been tested and found to comply with limits for a Class B digital device, pursuant to part 15 of the FCC Rules. These limits are designed to provide reasonable protection against harmful interference in a residential installation. This equipment generates, use and can radiate radio frequency energy and, if not installed and used in accordance with the instructions, may cause harmful interference to radio communications. However there is no guarantee Ainterference will not occur in a particular installation. If this equipment does cause harmful interference to radio or television reception, which can be determined by turning the equipment off and on, the user is encouraged to try the correct interference by one or more of the following measures:

- Reorient or relocate the receiving antenna.
- Increase the separation between the equipment and receiver.
- Connect the equipment into an outlet on a circuit different from that to which the receiver is connected.
- Consult the dealer or an experienced radio/TV technician for help.

USER CAUTION :

Changes or modifications not expressly approved by the party reasonable for compliance could void the user's authority to operate the equipment.

IC Compliance Information

IC : 10488A-TWIG

This device complies with Industry Canada's licence-exempt RSSs.

Operation is subject to the following two conditions:

- (1) This device may not cause interference; and
- (2) This device must accept any interference, including interference that may cause undesired operation of the device.

This equipment complies with IC radiation exposure limits set forth for an uncontrolled environment and meets RSS-102 of the IC radio frequency (RF) Exposure rules. This equipment complies with FCC radiation exposure limits set forth for an uncontrolled environment and meets the FCC radio frequency (RF) Exposure Guidelines. This equipment has very low levels of RF energy that is deemed to comply without testing of specific absorption rate (SAR).

Pour la clientèle au Canada

L'émetteur/récepteur exempt de licence contenu dans le présent appareil est conforme aux CNR d'Innovation, Sciences et Développement économique Canada applicables aux deux conditions suivantes :

- 1) l'appareil ne doit pas produire de brouillage;
- 2) l'utilisateur de l'appareil doit accepter tout brouillage adioélectrique subi, même si le brouillage est susceptible d'en compromettre le fonctionnement

TWIG a été testé et jugé conforme aux limites d'exposition aux rayonnements ISDE énoncées pour un environnement non contrôlé et respecte les règles d'exposition aux fréquences radioélectriques (RF) CNR-102 de l'ISDE.

CE Compliance Information

ODDICT, hereby declares that this TWIG is in compliance with the essential requirements and other relevant provisions of directive 2014/53/EU. The full text of the EU declaration of conformity is available at the following internet address: <https://www.oddictofficial.com/uploads/manual/twig.pdf>