

ODDICT

TWIG PRO



TWIG PRO

Digital Hybrid Active Noise Cancelling Earbuds

Thank you for purchasing the ODDICT TWIG PRO

– Please follow the directions and read the guidelines carefully before use.

We recommend keeping the owner's guide for future reference.

– Some functions of the TWIG Pro may not be available when paired with certain devices.

– The specifications are subject to change without prior notice for quality improvement.

Carefully check all components before use.

To ensure quality of this product, specifications are subject to change without prior notice.

Features of TWIG PRO may also be limited, depending on the operating system and functions of the connected 'Bluetooth device'.



1. Safety and General Information
2. Package Contents
3. First time pairing with Bluetooth device
4. Charging
5. Power ON/OFF and Standby mode
6. Connecting/Pairing with other Bluetooth devices
7. Listening to music (play & control)
8. Call Function
9. Noise cancelling function
10. Ambient Mode
11. Activate Voice Assistant
12. Factory Reset
13. ODDICT APP
14. Specifications
15. Troubleshooting
16. Compliance Information

1. Safety and General Information

- 1) Use a standard USB charging cable (included), with or without a charging adapter. (5V, over 0.5 A)
* Adapter Not Included.
 - 2) Lower the volume prior to listening to audio to prevent potential damage to eardrums caused by sudden loud sound.
 - 3) Warning: Listening to loud music for extended periods of time may cause hearing damage.
 - 4) Do not store the device in places with a temperature higher than 113 °F / 45 °C.
 - 5) This device is IPX4 sweat and water resistant. Please note that it is not waterproof. Please use caution not to oversaturate with moisture or leave excessive moisture on the device as this can damage the internal components. In case you get the device wet, please contact our customer service for support. (Visit our FAQ page for more info)
 - 6) Do not attempt to disassemble, modify or repair the device.
 - 7) Do not cause shock to the device.
 - 8) Keep out of the reach of children and pets.
 - 9) Do not tug on cords or touch power plugs with wet hands.
 - 10) Do not use the device near microwave ovens or wireless LAN adaptors.
 - 11) When the product is not being used, please keep it in the Cradle.
 - 12) When cleaning the device, use a clean dry cloth to wipe the device clean. (Do not use solvents.)
 - 13) To clean the silicone ear tips, remove from earphones, wash with warm water, dry completely and check for debris before reattaching.
 - 14) Replacement ear tips can be purchased from ODDICT Customer Service.
 - 15) Using the device while walking or driving may prevent the user from hearing important sounds such as signals or alarms and may impose hazardous conditions on yourself or others. Heed caution during use.
 - 16) The radio waves on this device may affect electronic medical devices. If you use any electronic medical device, consult your doctor or the medical device company before using it.
- ※ Use the TWIG only for its intended purposes.
- ※ This device cannot be used for purposes related to human safety as it may cause radio interference during operation.

2. Package Contents

1) Contents

- TWIG PRO Earbuds
- TWIG PRO Charging Case
- 3 sizes of silicone ear tips (M size comes already attached)
- USB– C Type Cable
- Quick Guide
- Warranty Card

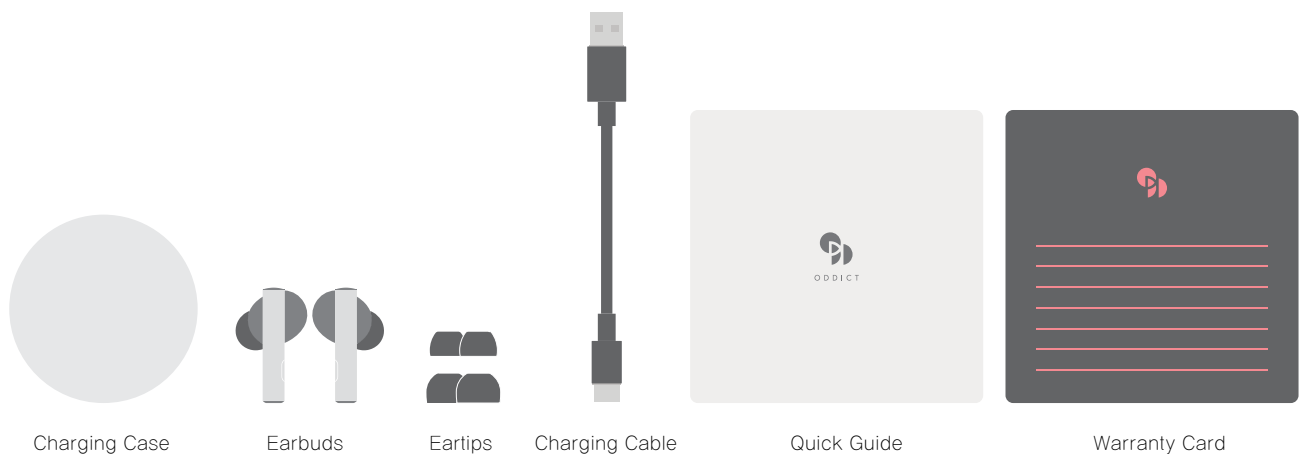

2) Components & Features

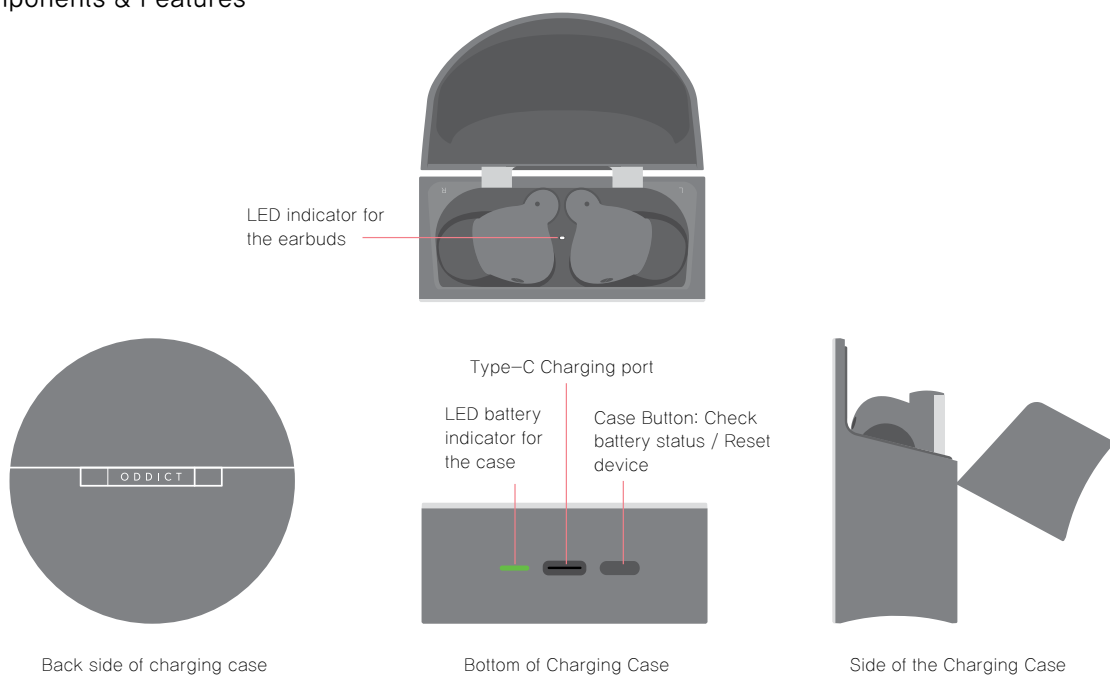

3. First time pairing with Bluetooth device

★ Remove the film on the earbuds and charge for at least 10 minutes.

- ① Turn on the Bluetooth in your device.
- ② Open the case lid and pairing mode will be automatically activated.
- ③ Select TWIG PRO within the Bluetooth setting of your device.
- ④ When the earbuds connect to your device via Bluetooth, you will hear a high-pitched tone (marimba).
Once you place the earbuds in your ears, you will hear a low-pitched tone (synth), indicating your device and earbuds are connected and ready to use. (The earbuds must be worn to activate the sensor features.)

※ Once the pairing is complete, TWIG PRO will pair with the last device it was connected to.

※ Repeat this procedure every time you pair TWIG PRO with a new device.

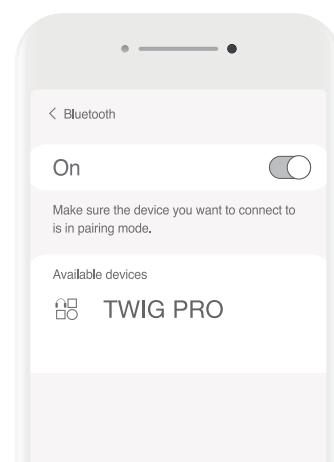
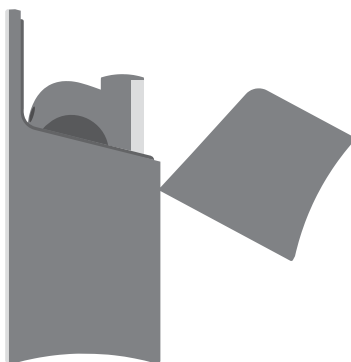
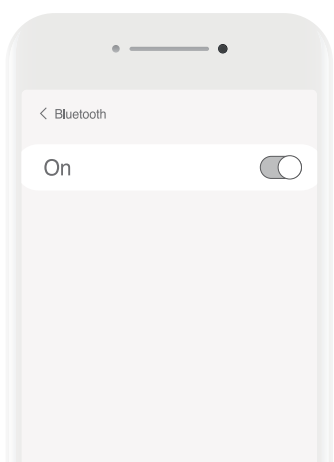

4. Charging

The earbuds will begin charging from the moment they are stored in the case. Case supports both USB Type C charging or wireless charging.

4.1 Charging the Earbuds

- ① Placing the earbuds inside the case automatically charges them.
 - ② The LED inside the case turns on to indicate earbuds are charging.
- ※ When the earbuds are fully charged, the charging status LED on the side of the case will turn off.

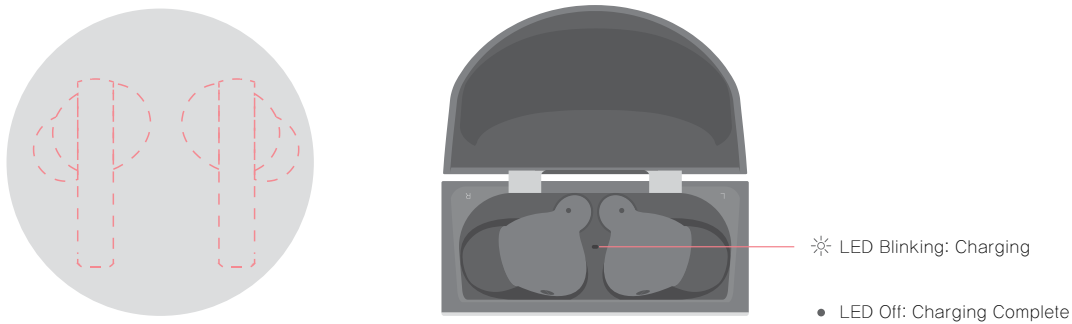

4.2 Charging the Case

1) Using the Charging cable

- ① Connect the Type-C charging cable to the port at the bottom of the TWIG PRO case.
- ② Check the bottom of the case to see if the lights are slowly dimming which indicates the case is being charged.

2) Wireless Charging

- ① Place the case with the aluminum side up for wireless charging.
- ② Case charging status can be checked with LED light on the bottom of the case.

- ※ The wireless charging coil is located slightly lower in the back of the case.
Please use this part so that it is centered on the wireless charging pad.

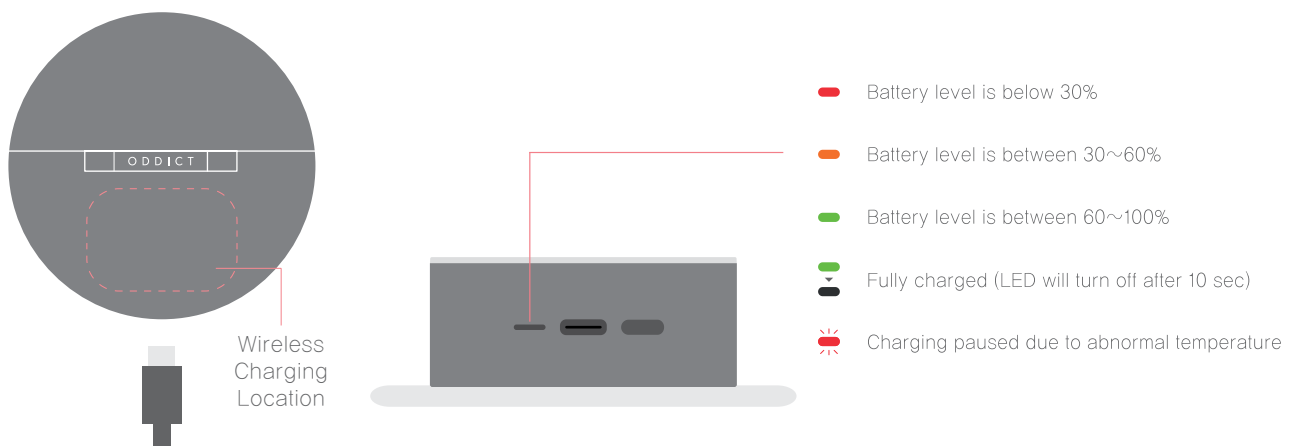

4.3 Checking the remaining battery level

1) Check battery level of the earbuds

Battery level can be checked via the ODDICT App.

2) Check the battery level of the case

If you press the button on the bottom of the case, you can check the remaining battery levels with the LED status lights.

5. Power ON/OFF and Standby mode

TWIG earbuds are turned on/off automatically depending on whether the case is connected without any separate operation, (Power ON when the case is opened / Power OFF when the earbuds are in the case and the case is closed)

1) Turning on the earbuds

① When the case is opened, the earbuds will turn on automatically.

② If there is no previously paired device nearby, it will automatically enter 'pairing mode' 5 seconds after opening the case cover.

③ If a previously paired device is nearby, the earbuds will be connected immediately when taken out of the charging case.

※ When in pairing mode, the earbuds will turn off after 5 minutes if the Bluetooth has not been connected to.

2) Turning off the earbuds

Insert the earbuds into the case and close it to turn off the earbuds.

※ You can turn on/off the earbuds only when there is remaining battery power in the case.

6. Connecting/Pairing with other Bluetooth devices

① Place the earbuds back in the case. Close and open case lid, TWIG PRO will enter pairing mode after 5 seconds.

② Search for the device in the Bluetooth settings of the device you want to connect and select TWIG PRO.

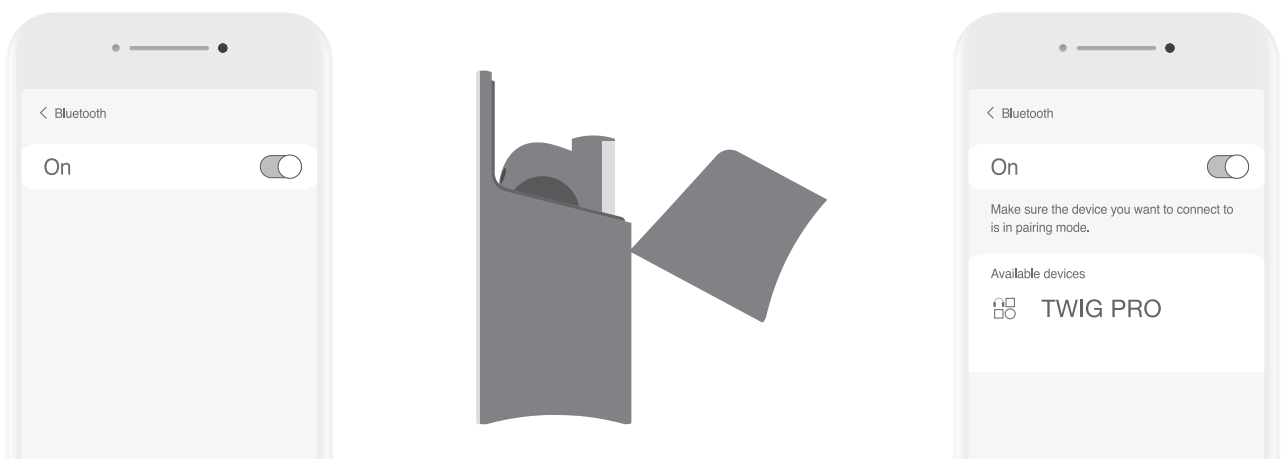

7. Listening to music (play & control)

Control the music function of the connected Bluetooth device by pressing the button.

1) Play/stop music

- ① Briefly press the earbuds button to play the song.
- ② While music is playing, briefly press the earbuds button pause the music.

2) How to use the change song function

- ① Double press the earbuds button to play the next song.
- ② Triple press the earbuds button to play the previous song.

8. Call Function

When you receive a call while using TWIG PRO, you can answer and end the call by briefly pressing the button on the earbuds.

1) Answer a call

When you hear an incoming tone through the earbuds, briefly press the button on the earbuds once to answer the call.

2) End a call

To end the call, briefly press the button on the earbuds once to end the call.

(In case the call came while listening to music, the music will automatically start playing again when the call ends.)

- ※ When connecting to a call, the audio will come out of the earbuds.
- ※ Functions may vary depending on the paired Bluetooth device.
- ※ May need to press firmly on the buttons.
- ※ When you click/touch on the connected device to answer a call, the call will connect to the device.

9. Noise cancelling function

1) What is noise cancelling?

It refers to noise reduction technology that reduces mid bass noise below 1 kHz.

2) Using the noise cancelling function

- ① When both L/R earbuds are worn, noise cancelling function is automatically activated.
 - ※ The sensor of the earbud that is worn first (left or right) will activate with a low synth notification sound and the noise cancelling function will turn on immediately when the other earbud is put on.
- ② Press and hold the earbuds button for 1 second to stop noise cancelling mode and switch to ambient mode.

10. Ambient Mode

- ① Ambient Mode allows you to hear the sounds around you without having to remove the earbuds.
- ② Press and hold the earbuds button for 1 second to activate ambient mode.

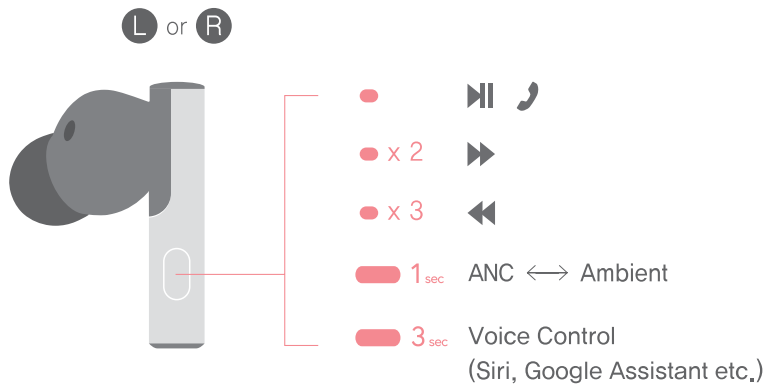

11. Activate Voice Assistant

Activate the voice command function of the connected Bluetooth device by pressing button on the TWIG Earbuds.

Activate voice assistant (Siri, Google Assistant etc.)

Press and hold the button on the earbuds button for 3 seconds. When you hear a beep, voice assistant will activate.

※ Functions may vary depending on the paired Bluetooth device.

12. Factory Reset

Many issues can be resolved by factory resetting your TWIG PRO.

- ① Press and hold the button on each earbud for 30 seconds.
 - ② A notification tone is emitted from each earbud and a red LED turns on in the middle of the earbuds.
 - ③ Once each earbud lights up red, place them together and the red LED will turn off indicating they've been paired with one another.
 - ④ Place the earbuds back in the case. Close and open cover again, TWIG PRO will automatically enter pairing mode.
- ※ All existing connection histories are reset.

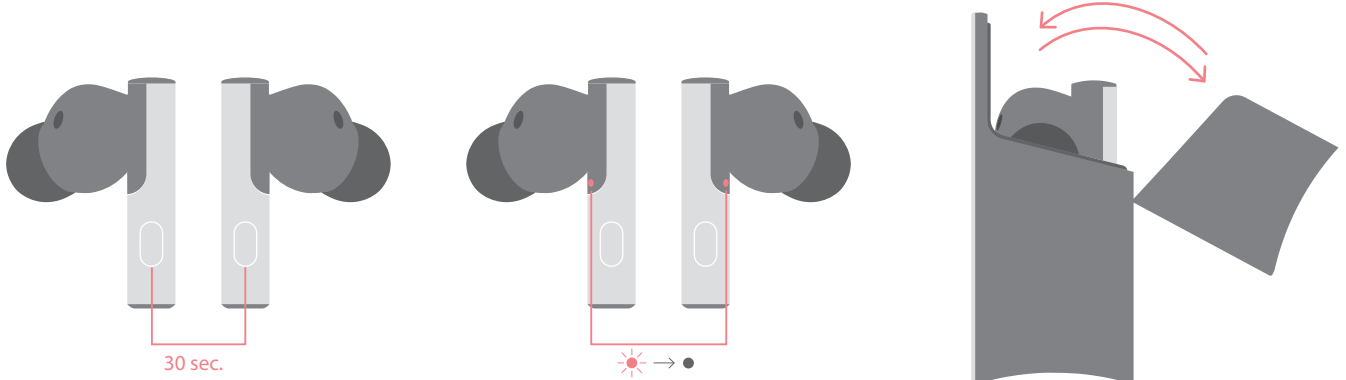

13. ODDICT APP

The dedicated ODDICT APP allows you to customize your TWIG PRO by providing control over various functions such as saving presets, equalizer adjustments, device name and earbud tracking.



13.1 Download the ODDICT APP

- ① Search for ODDICT in the Google Play or Apple App Store and download/run the app.
- ② Create an account and log in.



13.2 Register your TWIG

- ① To connect your TWIG PRO to the APP, place both earbuds in the case. Leave the case open and add the device through the app.
 - ※ If there is a already registered TWIG product, swipe left to see a new registration page.
- ② Follow the guide to open the case and touch 'START' at the bottom of the screen.
- ③ If your TWIG PRO appears in the search device list, select it to continue the pairing process.
- ④ Go to the Bluetooth settings of the connected device and complete the device connection.

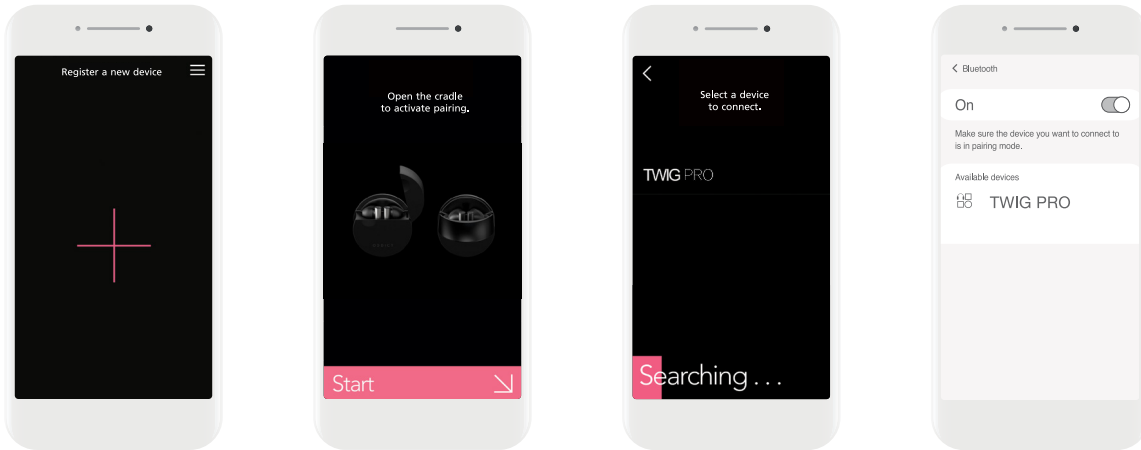

13.3 How to use the ODDICT APP

- A The name of the connected TWIG PRO device will be displayed. When registering for the first time, it will be marked as 'TWIG' and can be later modified in the ODDICT APP.
- B If you tap the TWIG PRO image, you will be taken to the TWIG PRO menu screen.
- C Moves to the APP settings screen.

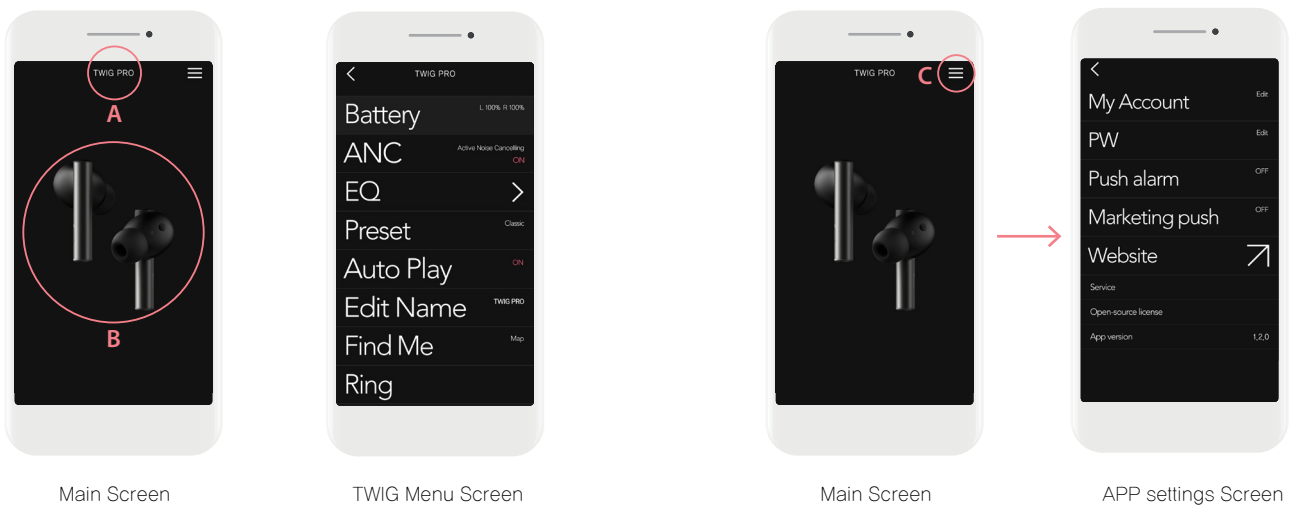

Main Screen

TWIG Menu Screen

Main Screen

APP settings Screen

B) TWIG PRO Menu Screen

You can set/change additional functions of the registered 'TWIG PRO'.

Menu Items	Explanations
Battery	The remaining battery level of the earbuds is displayed.
ANC	You can turn on/off the noise cancelling function, adjust noise cancelling levels, or choose ambient mode.
EQ	Set the desired sound profile and save it as a preset.
Preset	EQ profiles can be selected based on the music genre or sound profile presets (Up to 5 can be created).
Auto Play	Turn on/off the auto play function that automatically plays music while wearing the earbuds.
Edit Name	Set the name of the registered device.
Find Me	Find the location where the registered product was last connected to the ODDICT App.
Ring	A 2 kHz high-pitched tone will sound to indicate the location of the earbuds.
FW Update	Check the version of the app and update the firmware. ※ When firmware update is available, a pink dot will appear next to firmware update in settings. ※ Please wait until the firmware update is complete. ※ After the update is completed, the device name will automatically be changed to TWIG PRO.
Manual	Check the manual of the registered device.
Delete	Remove registered device.

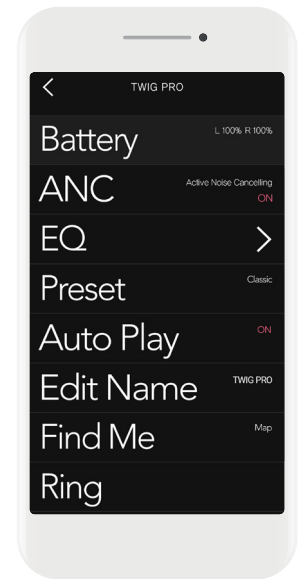

C) APP setting screen

Menu Items	Explanations
My Account	Check the login account information connected with the app.
Push alarm	Receive or block notifications provided by ODDICT.
Marketing push	Receive or block marketing notifications provided by ODDICT.
Website	Link to the ODDICT official website. (www.oddictofficial.com/).
Service Open-Source license App Version	Check the version of the app, license information, terms of use, and privacy policy.

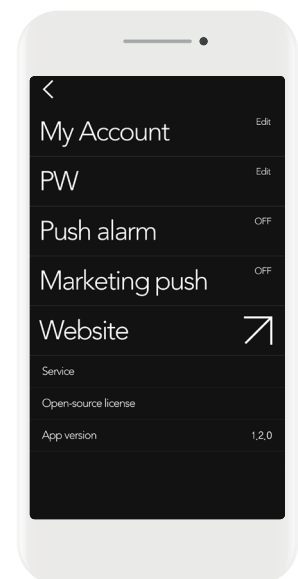

14. Specifications

1) TWIG PRO Earbuds

- Communication Network : Bluetooth Version 5.2
- Output Power: Power Class 1
- Max. Communication Range: Discoverable within 10 m / 33 ft.
- Full charge time: Earbuds – 1,3 hours , Case – 1,5 hours
- Quick Charge: Support 10 min. Charging = 40 Min. Playing
- Talk time: 5,5 hours (NC On) / 6 hours (NC Off)
- Music playback time: 5,5 hours (NC On) / 6 hours (NC Off)
- Standby Time: 34 hrs.
- Operating Frequency: 2.4 GHz (2,402 GHz ~ 2,480 GHz)
- Compatible Bluetooth Profiles: HFP v 1,8 / A2DP v 1,3 / AVRCP v 1,6
- Audio Codec: SBC, AAC, aptX™ Adaptive
- Battery: Lithium Polymer DC 3,8 V / 55 mAh
- Microphone Frequency Range: 100 ~ 8,000 Hz
- Call Mic, Sensitivity: –26 dB
- Driver Unit: 12 mm / Dual Layer Carbon Paper
- Driver Unit Sensitivity: 108 dB/mW
- Driver Unit Impedance: 32 ohms
- Driver Unit Frequency Response: 20 Hz – 20 KHz
- Earbud Weight: 9,8 g (Each 4,9 g)
- Noise cancelling type: Digital Hybrid (Feedforward + Feedback)

2) TWIG PRO Case

- Input Power: DC 5 V / over 0,5 A
 - Full Charging Time including Earphones: 1,5 hrs.
 - Number of 'TWIG' charging with 'Charging Case': 1,5 Times
 - Standby Time: 3,400 hrs. Max.
 - Wireless Charger Operating Frequency: 110 KHz ~ 150 KHz
 - Size: 56,9(H) * 56,9(W) * 25,1(D) mm / 2,24(H) * 2,24(W) * 0,99(D) in
 - Weight: 46,5 g (Charging case)
 - Operating Temperature: 0 ~ 45 ° C / 30 ~ 113 ° F
- ※ The specifications are subject to change without prior notice for quality improvement.

15. Troubleshooting

1) The power does not turn on:

- Make sure earbud protection film has been removed.
- Charge the device at least 30 min.
- If the power does not turn on even after charging, contact ODDICT Customer Service.

2) The device does not charge:

- Make sure the earbud protection film has been removed.
- Check whether the USB charging cable has been properly connected with the device.
- [Wireless charging] Check if the aluminum cover of the TWIG PRO case is facing up.
- [Wireless Charging] Check if the TWIG PRO case is correctly positioned at the charging location of the wireless charging pad.

3) The device does not pair:

- Check whether the power of the "Bluetooth" device is on and that the protective films are removed from the earbuds.
- Check whether the Bluetooth feature within the 'Bluetooth Device' you want to connect is enabled.
- Check whether the 'Bluetooth Device' you want to connect is within the supported range.
(Pairing is supported only when within 3 feet)
- Check whether the Bluetooth profile within the 'Bluetooth Device' is compatible.

4) When there is no sound or music:

- Check whether the power of the device and 'Bluetooth Device' is on.
- Check whether music is being played within the connected 'Bluetooth Device'.
- Check whether the volume within the connected 'Bluetooth Device' is low.

5) When there is static noise or the sound cuts off:

- Check whether there is another electronic device nearby using the 2.4 GHz frequency band that is connected to the Bluetooth device.
- Check whether the connected Bluetooth device is within the proper communication distance to the device.
(Maximum communication range: 33 feet)

6) The other party cannot be heard while on a call:

- Check if the power of the Bluetooth device you want to connect is on.
- Check whether the volume within the connected Bluetooth device is low.

7) When noise cancelling or ambient mode does not work.

- Make sure both earbuds are being properly worn.

8) If the product stops working or does not respond:

- Place the earbuds back in the case. Close and open case lid again. TWIG PRO will automatically enter pairing mode.
- If any of the above methods do not work, please reset the earbuds.

9) The device is paired with a PC/Laptop but does not work:

- PC/Laptops are equipped with various Bluetooth drivers depending on the manufacturer. It is possible that the PC/Laptop you are trying to connect is not compatible with TWIG PRO.

16. Compliance Information

FCC Compliance Information

FCC ID: V2R-TWIGPRO

This device complies with Part 15 of FCC Rules.

Operation is subject to the following two conditions:

(1) This device may not cause harmful interference, and (2) this device must accept any interference received, including interference that may cause undesired operation.

Information to the user:

NOTE: This equipment has been tested and found to comply with limits for a Class B digital device, pursuant to Part 15 of the FCC Rules. These limits are designed to provide reasonable protection against harmful interference in a residential installation. This equipment generates, uses and can radiate radio frequency energy and, if not installed and used in accordance with the instructions, may cause harmful interference to radio communications. However, there is no guarantee that interference will not occur in a particular installation. If this equipment does cause harmful interference to radio or television reception, which can be determined by turning the equipment off and on, the user is encouraged to try the correct the interference by one or more of the following measures:

- Reorient or relocate the receiving antenna.
- Increase the separation between the equipment and receiver.
- Connect the equipment into an outlet on a circuit different from that to which the receiver is connected.
- Consult the dealer or an experienced radio/TV technician for help.

USER CAUTION :

Changes or modifications not expressly approved by the party reasonable for compliance could void the user's authority to operate the equipment.

IC Compliance Information

IC : 10488A-TWIGPRO

Model: TWIG PRO

This device complies with Industry Canada's licence-exempt RSSs.

Operation is subject to the following two conditions:

- (1) This device may not cause interference; and
- (2) This device must accept any interference, including interference that may cause undesired operation of the device.

This equipment complies with IC radiation exposure limits set forth for an uncontrolled environment and meets RSS-102 of the IC radio frequency (RF) Exposure rules. This equipment complies with FCC radiation exposure limits set forth for an uncontrolled environment and meets the FCC radio frequency (RF) Exposure Guidelines. This equipment has very low levels of RF energy that is deemed to comply without testing of specific absorption rate (SAR).

Pour la clientèle au Canada

L'émetteur/récepteur exempt de licence contenu dans le présent appareil est conforme aux CNR d'Innovation, Sciences et Développement économique Canada applicables aux deux conditions suivantes :

- 1) l'appareil ne doit pas produire de brouillage;
- 2) l'utilisateur de l'appareil doit accepter tout brouillage adioélectrique subi, même si le brouillage est susceptible d'en compromettre le fonctionnement

TWIG PRO a été testé et jugé conforme aux limites d'exposition aux rayonnements ISDE énoncées pour un environnement non contrôlé et respecte les règles d'exposition aux fréquences radioélectriques (RF) CNR-102 de l'ISDE.

Charging Case

CAN RSS-261 / CRN-216