

OWNER'S GUIDE

BT 110



 **PHIATON**



WIRELESS EARPHONES

Thank you for purchasing PHIATON BT 110.

- Please follow the directions, and read the guidelines carefully before use. Please keep the owner's guide for future reference.
- Some functions of the BT 110 may not be available when it is paired with certain devices.
- The specifications are subject to change without prior notice for quality improvement.

CONTENTS

1. SAFETY AND GENERAL INFORMATION
2. COMPONENTS & FEATURES
3. HOW TO WEAR EARPHONES
4. CHARGING
5. POWER ON/OFF AND EARPHONE CONNECTION WAITING MODE
6. PAIRING WITH A 'BLUETOOTH DEVICE'
7. MULTIPOINT CONNECTION
8. LISTENING TO MUSIC (PLAY & CONTROL)
9. ACCEPTING A CALL WHILE PLAYING MUSIC
10. USING THE CALL FUNCTION
11. MISCELLANEOUS FEATURES
12. SPECIFICATIONS
13. PRODUCT SYMPTOMS AND TROUBLESHOOTING
14. FCC COMPLIANCE INFORMATION
15. IC COMPLIANCE INFORMATION
16. CE COMPLIANCE INFORMATION

English

한국어

Deutsch

Français

Español

русский

中國語

1. SAFETY AND GENERAL INFORMATION

- 1) Use a standard USB charging cable (included), with or without a charging adapter.
(5V, over 500mA) * Adapter Not Included
- 2) Lower the volume prior to listening to audio to prevent potential damage to eardrums caused by sudden loud sound.
- 3) Listening to loud music for extended periods of time may cause hearing damage.
- 4) Do not store the device in places with a temperature higher than 113 °F / 45 °C.
- 5) This product is sweat and water resistant. Do not get the product completely wet. If the device becomes wet, turn the power off, dry the device with a dry towel and contact Phiaton Customer Service for an inspection.
(For more information, refer to the contact us page within our website – phiaton.com)
- 6) Do not attempt to disassemble, modify or repair the device.
- 7) Do not cause shock to the device.
- 8) Keep out of the reach of children and pets.
- 9) Do not tug on cords or touch power plugs with wet hands.
- 10) Do not use the device nearby microwave ovens or wireless LAN adapters.
- 11) When the product is not being used, set the device power switch to 'OFF'.
- 12) When storing the device, place the device within the provided carrying case.
- 13) When cleaning the device, use a clean dry cloth to wipe the device clean. (Do not use solvents)
- 14) Remove the eartips from the earphones, wash them with warm water, dry completely and check for any debris before reattaching.
- 15) Replacement eartips can be purchased from Phiaton Customer Service.
- 16) Use while driving or walking will prevent outside noise, such as signals or alarms, from being heard and may be dangerous to yourself and others. Heed caution during use.
- 17) The radio waves of this device may affect electronic medical devices.
If you use any electronic medical device, consult your doctor or the medical device company before you use it.

※ Use the earphones only for its intended purposes.

※ This device cannot be used for purposes related to human safety as it may cause radio interference during operation.

2. COMPONENTS & FEATURES

1) COMPONENTS

- BT 110
- USB Charging Cable
- 4 sizes of Eartips
- 3 sizes of RightFit+ Ear Wings
- Carrying Case
- Quick Guide
- Warranty Card

2) FEATURES

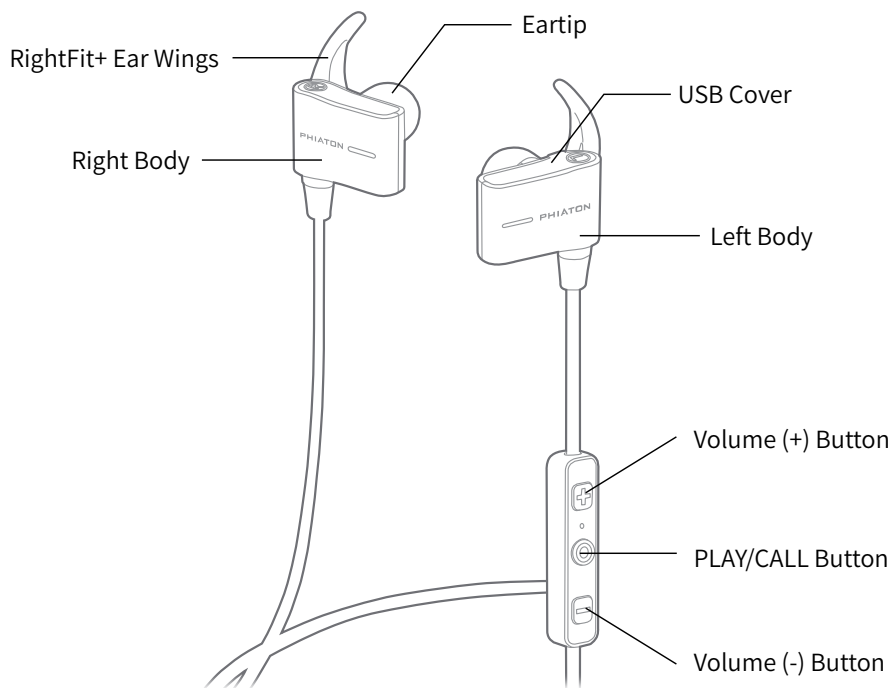

3. HOW TO WEAR EARPHONES

- 1) Hold the earphone body with wire dropping down.
- 2) Gently insert the ear tip into the ear canal.
- 3) Let the ear wing set comfortably in cymba conchae (the upper, smaller part of the external ear).

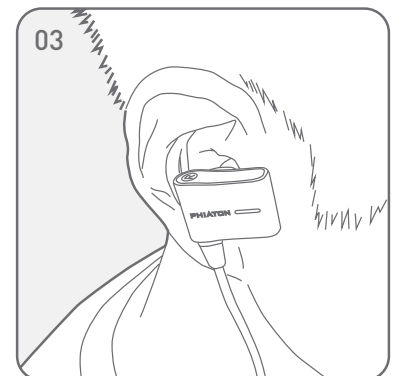
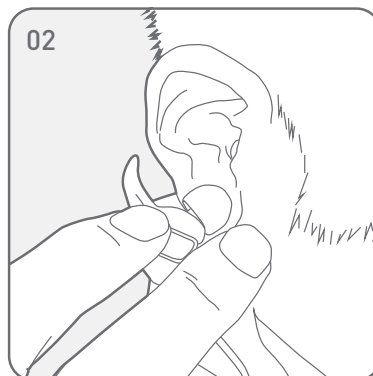
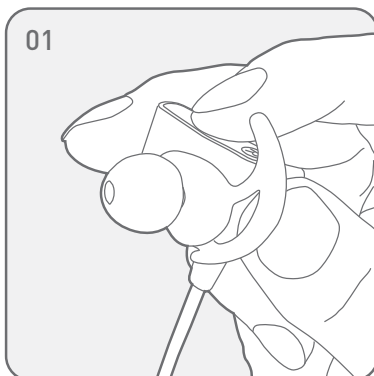

4. CHARGING

The device may not be charged upon purchase and must first be charged before use.

- 1) Connect the provided USB charging cable (micro USB 5pin connector) to BT 110.
- 2) Connect the provided USB charging cable with a computer (laptop) or you may also use a separately purchased USB adapter (rating: 5V/over 500mA) to begin charging.

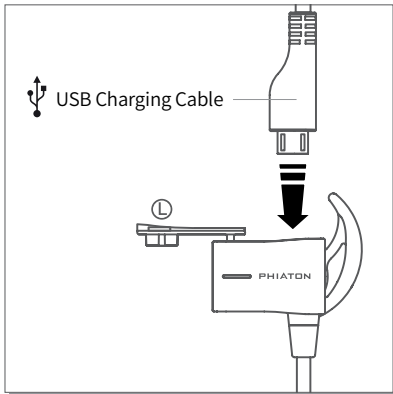

Status	LED Indicator
Charging	Red light
Charging complete	Blue light

- This device has a built-in battery, so it will begin charging automatically when you connect the charging cable.

※ Battery use time

Classification		Use Time
Continuous Talk Time		Max. 4.5 hours
Continuous Music Play Time	aptX High Quality Sound Mode	Max. 4 hours
	AAC High Quality Sound Mode	Max. 5 hours
	SBC Mode	Max. 4.5 hours
Stand by Time		Max. 125 hours
Full Charge Time		About 2 hours

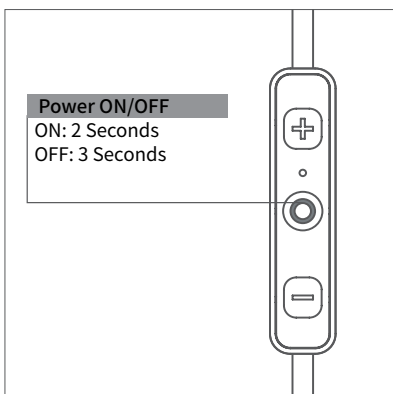

* The above times may differ depending on the environment in which it is used.

5. POWER ON/OFF AND EARPHONE CONNECTION WAITING MODE



1) Power ON/OFF

- Press and hold the PLAY/CALL Ⓞ Button for 2 seconds to turn the power on.
- When turning the power off, press and hold the PLAY/CALL Ⓞ Button for 3 seconds to turn off.

Status	Operation	LED Indicator	Voice Guidance
ON	Press and hold the PLAY/CALL  Button for 2 seconds	Purple light turns on for 1 second	Power on
OFF	Press and hold the PLAY/CALL  Button for 3 seconds	Red light blinks 5 times	Power off

※ Pairing mode will start once the power is turned on for the first time after purchase.

2) Connection Waiting Mode

- When power is turned on, 'Connection Waiting Mode' will start if 'Pairing Mode' cannot be entered or the earphones cannot connect with 'Bluetooth Device'.
- If the 'Bluetooth Device' is not connected within 5 minutes in 'Connection Waiting Mode', the earphones will automatically turn off.

Status	LED Indicator
Connection Waiting Mode	Blue light blinks twice in 6 second intervals

6. PAIRING WITH A 'BLUETOOTH DEVICE'

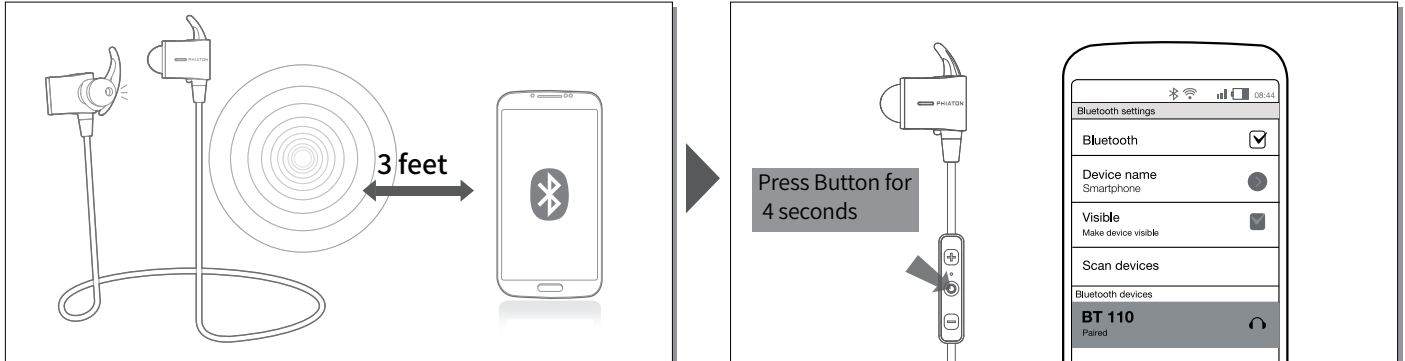

1) Pairing

- Turn on the Bluetooth feature with the 'Bluetooth Device' you want to connect with the BT 110.
- Place the BT 110 within 3 feet of the 'Bluetooth Device' you want to connect.
- Press and hold the PLAY/CALL  Button for over 4 seconds with the BT 110 power off to enter Pairing Mode.

Status	LED Indicator	Voice Guidance
Pairing Mode	Blue and Red light alternately blinks	Pairing Mode activated

- Within the 'Bluetooth Device' you want to connect, search/select 'BT 110'.
 - ※ If the 'Bluetooth Device' requires a PIN CODE or password, enter '0000'.
- Use the earphones to play music or connect a call.

Status	LED Indicator	Voice Guidance
Connection success	After Purple light blinks twice, Blue light blinks once in 6 second intervals	Device connected

2) Re-connecting a Disconnected Device

① Auto Connection

- Once the device has been paired with a 'Bluetooth Device' it will automatically be connected to a previously connected device once the BT 110 power is turned on.
- If Bluetooth becomes disconnected as the discover range between the 'Bluetooth Device' and the BT 110 is exceeded, then Bluetooth will not be automatically re-connected.
When you are back within the discover range (33 feet), you must then connect manually.

② Manual Connection - When having entered 'Connection Waiting Mode' during connection.

- Press the PLAY/CALL Ⓞ Button to connect.
- The BT 110 will also be connected if you select 'BT 110' from the device search list within your 'Bluetooth Device'.

3) Checkpoints Upon Pairing

- Check to see whether the Bluetooth feature is activated within the 'Bluetooth Device' you want to connect.
- When selecting the connection device, connect by selecting stereo headset device.
Music cannot be played when connected through mono headset.

※ In order to properly use the Bluetooth feature of this device, the profile (A2DP, HSP, HFP and AVRCP) of the 'Bluetooth Device' you are trying to connect must support the profile of this device.

* A2DP—"Advanced Audio Distribution Profile", HSP—"Headset Profile", HFP—"Hands Free Profile".
AVRCP—"Audio/Video Remote Control Profile"

※ The device will not operate properly if the profiles are not supported equally. Even when the profiles are supported equally, Some features may not properly operate depending on the 'Bluetooth Device' specifications. To check the detail specifications of this earphone's profile, refer to '12. SPECIFICATIONS.' For more information, please visit phiaton.com or contact Phiaton customer service.

7. MULTIPOINT CONNECTION

1) What is 'Multipoint Connection'?

- This is a feature where BT 110's user can simultaneously connect two Bluetooth devices.

2) Multipoint Connecting

- Turn on the Bluetooth feature within the two 'Bluetooth Devices' you want to connect with BT 110.
- Refer to 6. PAIRING WITH A 'BLUETOOTH DEVICE' to pair the first device with the BT 110.
- Press and hold the PLAY/CALL Ⓞ Button for 3 seconds for power off, then press and hold the PLAY/CALL Ⓞ Button again for over 4 seconds with the BT 110 power off to enter 'Pairing Mode'.
(Here, the first device becomes disconnected.)
- Once 'Pairing Mode' has been entered, pair the second device.
- Within the first 'Bluetooth Device' you want to connect, select 'BT 110' again.

- Now, both of the 'Bluetooth Devices' will be connected simultaneously, and now the 'BT 110' will control the secondly paired device.

- ※ Sleep Mode will be entered when devices are not connected within two minutes. When trying to connect a device while in Sleep Mode, pressing any button will re-enter 'Connection Waiting Mode' where connection is possible.
- ※ When the BT 110 power is turned off and back on, only the second paired device will automatically be connected. When the first paired device is reconnected, then both of the devices will remain connected.

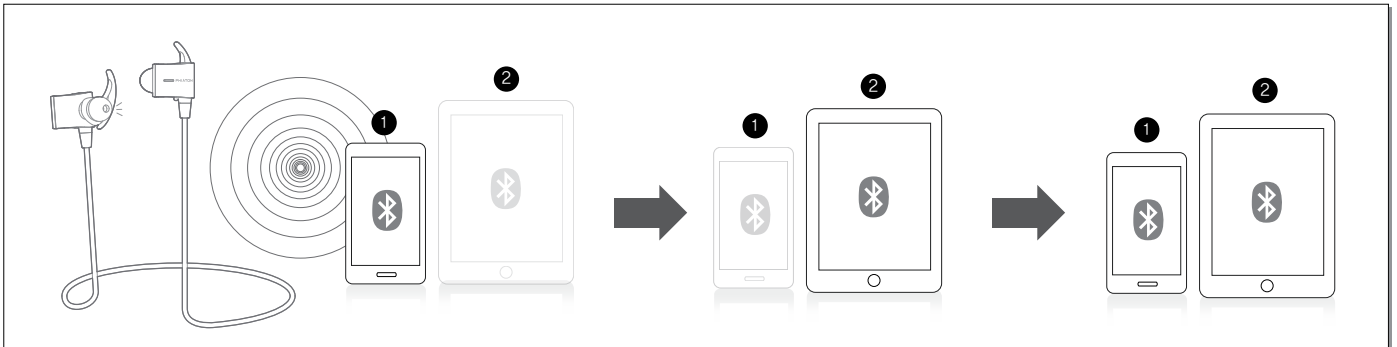

- ※ Upon Multipoint Connection, the features operated within BT 110 usually operate within the second paired device. (When using the first paired device, it is possible to operate the device from BT 110.)
- ※ When using Multipoint Connection, the order of the paired devices may change. To change the order, re-connect the device you usually use.

8. LISTENING TO MUSIC (PLAY & CONTROL)

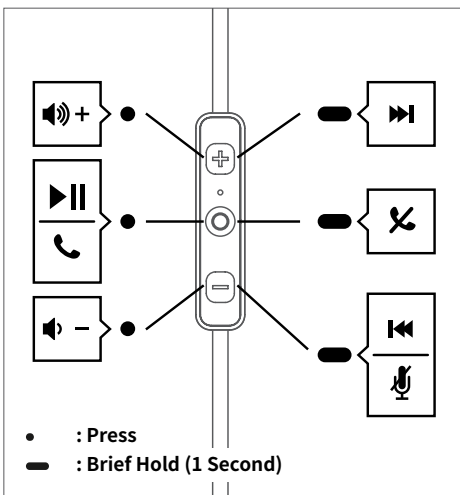

1) Playing Music

- Shortly press the PLAY/CALL (●) Button once to play music from the 'Bluetooth Device'.
- While music is playing, shortly press the PLAY (●) Button to pause the playing music. The music will be played from the paused point when playing music again.

Status	LED Indicator
While music is playing (Connection with aptX or AAC)	Purple Light slowly blinks every 6 seconds
While music is playing (Connection with SBC)	Blue Light slowly blinks every 6 seconds

* SBC(Sub Band Codec) is default audio codec installed for any 'Bluetooth Device'.

* aptX and AAC are high quality audio codec.

2) Controlling Volume and Using Seek

- Press the Volume (⊕)/(⊖) Button to control the volume.
- Press and hold the Volume (⊕)/(⊖) Button for about 1 second to go to the next / previous song. After 1 second, the 'beep' signal tone is provided.

* Music can be listened to through BT 110 by directly operating your 'Bluetooth Device'.

9. ACCEPTING A CALL WHILE PLAYING MUSIC

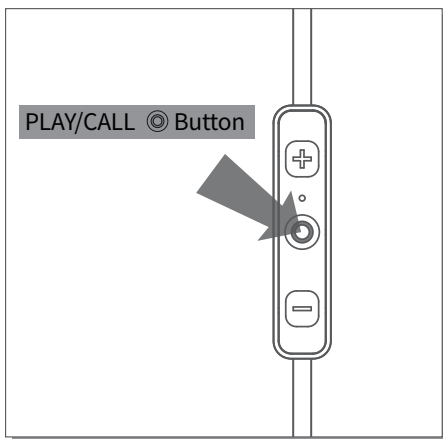

1) Accepting a Call while Playing Music

- When the incoming call tone is heard through the earphones, press the PLAY/CALL © Button.
The music will be paused and the call is connected.
 - Once the call has ended, press the PLAY/CALL © Button to terminate the call.
Once the call is terminated, the paused music will play again.
- * This feature may slightly differ depending on your 'Bluetooth Device'.

10. USING THE CALL FUNCTION

1) Accepting a Call

- When the incoming call tone is heard through the earphones, press the PLAY/CALL © Button.
(Adjusting Call Volume: to control the call volume, press the Volume ⊕/⊖ Button)

2) Ending a Call

- While on a call, shortly pressing the PLAY/CALL © Button to end the call.

3) Rejecting a Call

- When the incoming call tone is heard through the earphones, press and holds the PLAY/CALL © Button for about 1 second. (After hearing the 'beep' signal tone, the incoming call is rejected and the voice guidance "Call Ignored" is heard.)

4) Turning Mute On/Off

- While on a call, press the Volume ⊖ Button for about 1 second to mute microphone.
To turn back on, press the Volume ⊖ Button again for about 1 second.

5) Call Waiting - When there is another incoming call while on a call.

(Supported only when having applied for this service with your telecom provider.)

- Press and hold the PLAY/CALL © Button for about 1 second to place the current call on call waiting and connect the second call. (Press the PLAY/CALL © Button again for about 1 second to switch between the waiting call and connected call.)
- Shortly press the PLAY/CALL © Button to end the current call and connect the second call.

6) Calling by Voice (Supported within mobile phones that support the voice command feature).

- While waiting, press the PLAY/CALL © Button for 1 second.

7) Switching between the Device and Mobile Phone

- To switch the call from mobile phone to the earphone, press the PLAY/CALL © Button for 1 second.

Status	LED Indicator
Incoming Bell/Outgoing Bell	Purple light blinks in 1.5 second intervals
During Call	Blue light slowly blinks every 6 seconds
When there are two calls connected	Purple light slowly blinks every 6 seconds

11. MISCELLANEOUS FEATURES

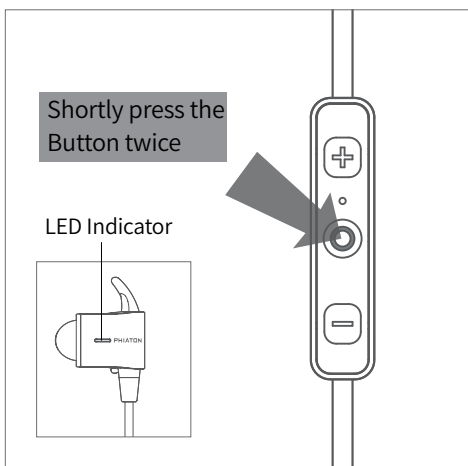

1) Checking Remaining Battery

- With the power on, shortly press the PLAY/CALL (Ⓢ) Button twice to display the remaining battery indicator (LED).
- For Apple iOS version 5 or above, the remaining battery is displayed at the top right side of the screen.

Remaining Battery	LED Indicator	Voice Guidance
Over 80%	Blue light lights up for 1 second	Battery is full
80% ~ 30%	Purple light lights up for 1 second	Battery is moderate
Under 30%	Red light lights up for 1 second	Battery is low
Under 5%	Red light lights up for 1 second and the alarm will sound	Please recharge

* The Battery Check feature will not operate while the battery is being charged.

* When the battery charge is under 5%, the alarm will sound.

If use is continued for several minutes the battery will be completely drained, the 'Power Off' voice guidance is provided and the power will automatically turn off.

2) Resetting the Device

- To reset to factory settings, press the PLAY/CALL (Ⓢ) Button and Volume (⊕) Button simultaneously for 4 seconds simultaneously while in 'Pairing Mode'.

Operation	LED Indicator	Voice Guidance
Factory Settings	Purple light lights up twice	After 'beep' signal tone twice, "POWER ON, Pairing Mode activated"

12. SPECIFICATIONS

- Type: Φ 6 mm Driver Unit
- Sensitivity: 90 dB/mW
- Frequency Response: 20 ~ 27 kHz
- Impedance: 16 ohms
- Weight: 16 g / 0.035 lb
- Communication Network: Bluetooth 4.0
- Output Power: Power Class 2
- Discover Range: Discoverable within 10 m / 33 ft.
- Full Charging Time: 2 hours
- Calling Time: 4.5 hours
- Music Play Time: 4.5 hours
- Stand-by Time: 125 hours
- Operating Frequency: 2.4GHz (2.402GHz ~ 2.480GHz)
- Bluetooth Profile Support: HFP v1.6 / HSP v1.2 / A2DP v1.3 / AVRCP v1.5
- Audio Codec: SBC, aptX, AAC
- Battery: Lithium Polymer DC3.7V / 75mAh
- Microphone Frequency Range: 10 ~ 4,000Hz
- Microphone Sensitivity: -42 dB
- Support Echo Cancellation and Talk Noise Reduction with CVC solution
- Operating Temperature: -20 ~ 40 °C / -4 ~ 104 °F
- Dimensions: 27 (H) x 25 (W) x 27 (D) mm / 1.1 (H) x 1.0 (W) x 1.1 (D) inch

* The Specifications are subject to change without prior notice for quality improvement.

13. PRODUCT SYMPTOMS AND TROUBLESHOOTING

1) The power does not turn on:

- Charge the device. If the power does not turn on even after charging, contact Phiaton Customer Service.

2) The device does not charge:

- Check whether the USB charging cable has been properly connected with the device.
- Check whether the PC power is on and that it has been properly connected.
- When using a separately purchased USB AC adapter, check to see that it has been properly connected.

3) The device does not pair:

- Check whether the power of the 'Bluetooth Device' you want to connect is on.
- Check whether the Bluetooth feature within the 'Bluetooth Device' you want to connect is enabled.
- Check whether the 'Bluetooth Device' you want to connect is within the supported range.
(Pairing is supported only when within 3 feet.)
- Check whether the Bluetooth profile within the 'Bluetooth Device' is compatible.

4) Music cannot be played:

- Check whether the power of the device and 'Bluetooth Device' is on.
- Check whether music is being played within the connected 'Bluetooth Device'.
- Check whether the volume within the connected 'Bluetooth Device' is low.

5) Noise is heard or the sound lags:

- Check whether there is an electronic device using the 2.4 GHz frequency band nearby the device and connected 'Bluetooth Device'.
- Check whether the connected 'Bluetooth Device' is far away from this device.
(Maximum communication range: within 33 feet.)
- Check whether the Radio interference object (metal, wall, etc.) or user's body is located between BT 110 and 'Bluetooth device'. (If the Radio interference object (metal, wall, etc.) or user's body is located between BT 110 and 'Bluetooth device', it could have an influence to BT 110's radio performance.)

6) The music sound quality is low:

- If the 'Bluetooth Device' you are trying to connect with this device is accessed to HSP, change the access to A2DP.

7) The other party cannot be heard while on a call:

- Check whether the power of the 'Bluetooth Device' you want to connect is on.
- Access Bluetooth through HFP or HSP.
- Check whether the volume within the connected 'Bluetooth Device' is low.

8) Product does not operate or operation has stopped:

- Connect the USB charging cable to reset.
- Power will turn off once the USB charging cable is connected.
- Pairing information is not deleted even when the device is reset.

9) The device is paired with PC/Laptop but does not work:

- PC/Laptop is equipped with various Bluetooth drivers depending on the manufacturer and it is possible it does not support BT 110.
- Please contact the PC/Laptop manufacturer to download the latest software driver or for further assistance in connecting to a 'Bluetooth Device'.

14. FCC COMPLIANCE INFORMATION

FCC ID : V2R-BT110

This device complies with part 15 of FCC Rules. Operation is subject to the following two conditions: (1) This device may not cause harmful interference, and (2) this device must accept any interference received, including interference that may cause undesired operation.

Information to the user:

NOTE: This equipment has been tested and found to comply with limits for a Class B digital device, pursuant to part 15 of the FCC Rules. These limits are designed to provide reasonable protection against harmful interference in a residential installation. This equipment generates, use and can radiate radio frequency energy and, if not installed and used in accordance with the instructions, may cause harmful interference to radio communications. However there is no guarantee that interference will not occur in a particular installation, if this equipment does cause harmful interference to radio or television reception, which can be determined by turning the equipment off and on, the user is encouraged to try the correct interference by one or more of the following measures:

- Reorient or relocate the receiving antenna.
- Increase the separation between the equipment and receiver.
- Connect the equipment into an outlet on a circuit different from that to which the receiver is connected.
- Consult the dealer or an experienced radio/TV technician for help.

CAUTION TO USER: Changes or modifications not expressly approved by the party reasonable for compliance could void the user's authority to operate the equipment.

15. IC Compliance Information

This device complies with Industry Canada license-except RSS standard(s). Operation is subject to the following two conditions:

(1) This device may not cause interference, and (2) this device must accept any interference, including interference that may cause undesired operation of the device.

This equipment complies with IC radiation exposure limits set forth for an uncontrolled environment and meets RSS-102 of the IC Radio Frequency (RF) Exposure rules. This equipment has very low levels of RF energy that are deemed to comply without testing of specific absorption ratio (SAR).

16. CE Compliance Information

Phiaton, hereby declares that this BT 110 is in compliance with the essential requirements and other relevant provisions of Directive 1999/5/EC.



© 2015 PHIATON Corporation
18662 MacArthur Blvd., STE 405
Irvine, California 92612 USA

www.phiaton.com
www.phiaton.co.kr