

OWNER'S GUIDE



BonoBeats Lite

Hybrid Active Noise Cancelling
Bluetooth® Noise Cancelling Headphone





WIRELESS DIGITAL HYBRID NOISE CANCELLING HEADPHONES

- Please follow the directions and read the guidelines carefully before use.
- Please keep the owner's guide for future reference.
- Some functions of the BonoBeats Lite may not be available when it is paired with certain devices.
- The specifications are subject to change without prior notice for quality improvement.

CONTENTS

1. SAFETY AND GENERAL INFORMATION
2. COMPONENTS & FEATURES
3. CHARGING
4. POWER ON/OFF AND HEADPHONE CONNECTION WAITING MODE
5. PAIRING WITH A 'BLUETOOTH DEVICE'
6. MULTIPOINT CONNECTION
7. NOISE CANCELLING FUNCTION
8. MONITORING (AUDIO TRANSPARENCY)
9. LISTENING TO MUSIC (PLAY & CONTROL)
10. ACCEPTING / MAKING A CALL WHILE PLAYING MUSIC
11. USING THE CALL FUNCTION
12. MISCELLANEOUS FEATURES
13. SPECIFICATIONS
14. PRODUCT ISSUES AND TROUBLESHOOTING
15. CERTIFICATION

1. SAFETY AND GENERAL INFORMATION

- 1) Use a standard USB charging cable (included) with or without a charging adaptor. (5V, over 1 A)
 - * Adaptor Not Included.
 - * Use products that satisfy IEC/EN 62368-1, LPS
- 2) Sudden, loud music can potentially cause hearing damage. Lower the volume before placing headphones on your ears and gradually increase the volume until a comfortable level has been reached.
- 3) Listening to loud music for extended periods of time may cause hearing damage.
- 4) Do not store the device in places with a temperature higher than 122 °F / 50 °C
- 5) Do not attempt to disassemble, modify or repair the device.
- 6) Do not cause shock to the device.
- 7) Keep out of reach of children and pets.
- 8) Do not tug on cords or touch power plugs with wet hands.
- 9) Do not use the device near microwave ovens or wireless LAN adaptors.
- 10) When cleaning the device, use a clean dry cloth to wipe the device clean. (Do not use solvents.)
- 11) Keep the device in the protective case when the product is not being used.
- 12) Replacement ear pads can be purchased from Phiaton Customer Service.
Email us at SUPPORT@PHIATON.COM
- 13) Using the device while walking or driving may prevent user from hearing important sounds such as signals or alarms and may impose hazardous conditions on yourself or others. Heed caution during use.
- 14) The radio waves of this device may affect electronic medical devices. If you use any electronic medical device, consult your doctor or the medical device company before using.

※ Use the BonoBeats Lite only for its intended purposes.

※ This device cannot be used for purposes related to human safety as it may cause radio interference during operation.



- Risk of fire or explosion if the battery is disposed of into a fire or hot oven, mechanical crushing or cutting machine.
- Risk of explosion or leakage of flammable liquid or gas if the battery is left in an extremely high temperature environment.
- Risk of explosion or leakage of flammable liquid or gas if the battery is subjected to extremely low air pressure.

- Extreme temperatures that a battery can be subjected to during use, storage or transportation; and
- Low air pressure at high altitude.
- Disposing the battery in a fire or hot oven, or mechanical crushing or cutting machine can result in an explosion.
- Leaving battery in an extremely high temperature environment can result in an explosion or cause leakage of flammable liquid or gas.
- Battery subjected to extremely low air pressure that may result in an explosion or the leakage of flammable liquid or gas.

2. COMPONENTS & FEATURES

1) Contents

- BonoBeats Lite
- USB–C TO USB–C Charging Cable
- Quick Guide
- Warranty Card

2) Features

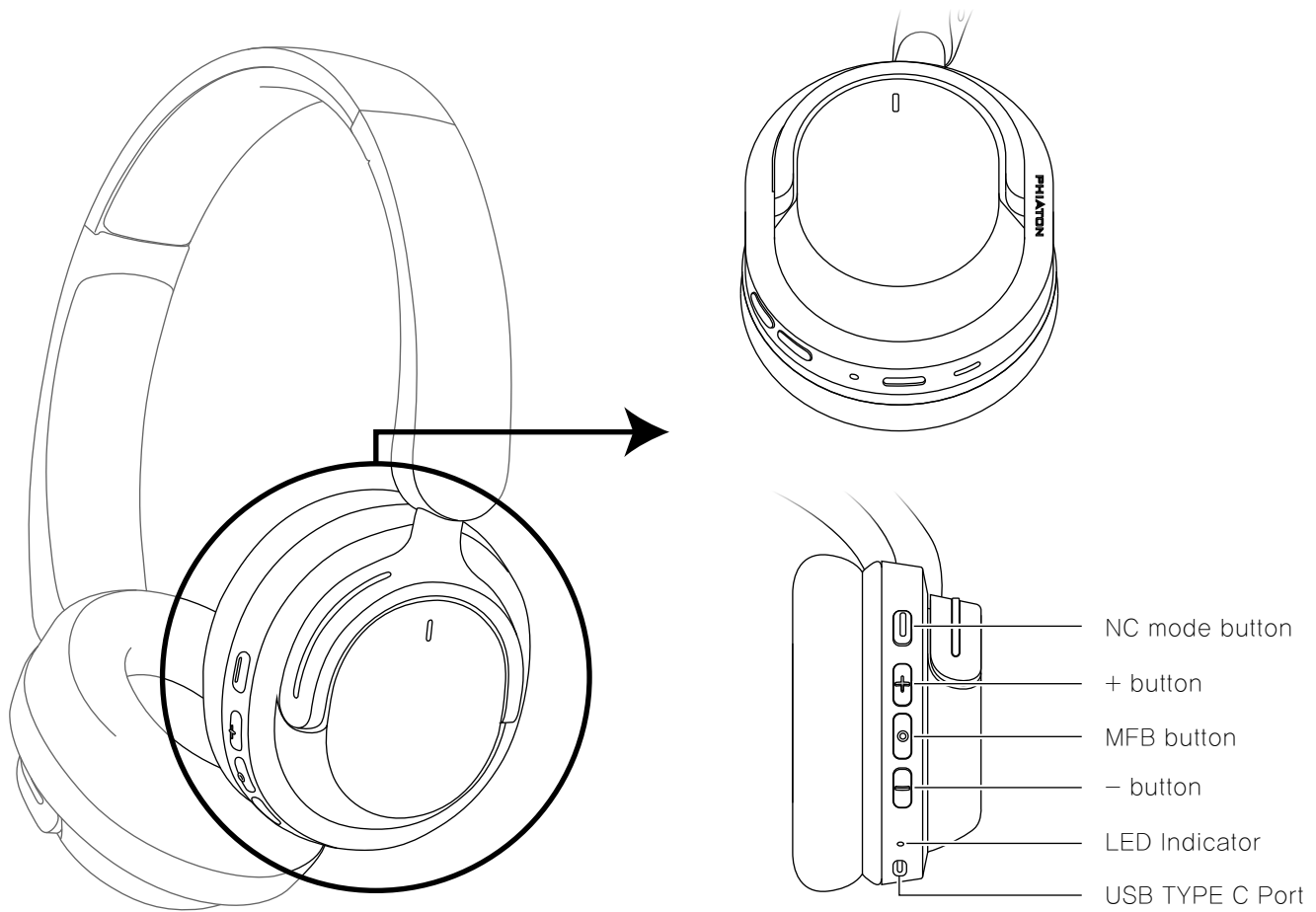

3. CHARGING

The device may have low battery and should be charged before first the use.

- 1) Connect the provided USB charging cable to BonoBeats Lite.
- 2) Connect the provided USB charging cable with a computer (laptop) or you may also use an USB adaptor (purchased separately) with a minimum rating of 5V (over 500mA).

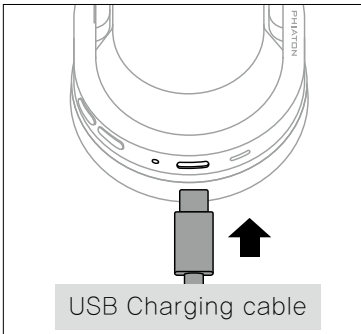

Operation	LED indicator
Charging	Red Light
Charging Complete	Blue Light

- This device has a built-in battery, and will begin charging automatically when connected to the charging cable.

4. POWER ON/OFF AND HEADPHONE CONNECTION WAITING MODE

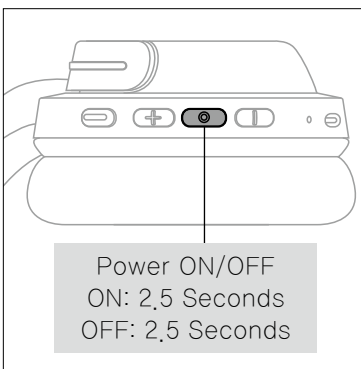

- 1) Power ON/OFF
 - Press and hold the 'Power' button for 2,5 seconds to turn the power on.
 - Press and hold the 'Power' button for 2,5 seconds to turn off.

Status	Operation	LED Indicator	Notice
ON	Press and hold the POWER button for 2,5 seconds	Purple light then, Blue light blinks 2 times	Sound effect
OFF	Press and hold the POWER button for 2,5 seconds	Blue light blinks 5 times	Sound effect

※ When powering on for the first time after purchase, pairing mode is automatically activated.

2) Connection Waiting Mode

- When power is turned on, 'Connection Waiting Mode' will start if 'Pairing Mode' cannot be entered or the headphones cannot connect with 'Bluetooth Device'.
- If the 'Bluetooth Device' is not connected within 5 minutes in 'Connection Waiting Mode', the headphones will automatically turn off.
- ※ In connection Waiting Mode, the headphone should be entered to 'Pairing Mode' for connection to 'Bluetooth device' again after power off. If not, BonoBeats Lite will turn off within 5 minutes after starting 'Connection Waiting Mode'.

Status	LED Indicator
Connection Waiting Mode	Blue light blinks twice in 6 second intervals

5. PAIRING WITH A BLUETOOTH DEVICE

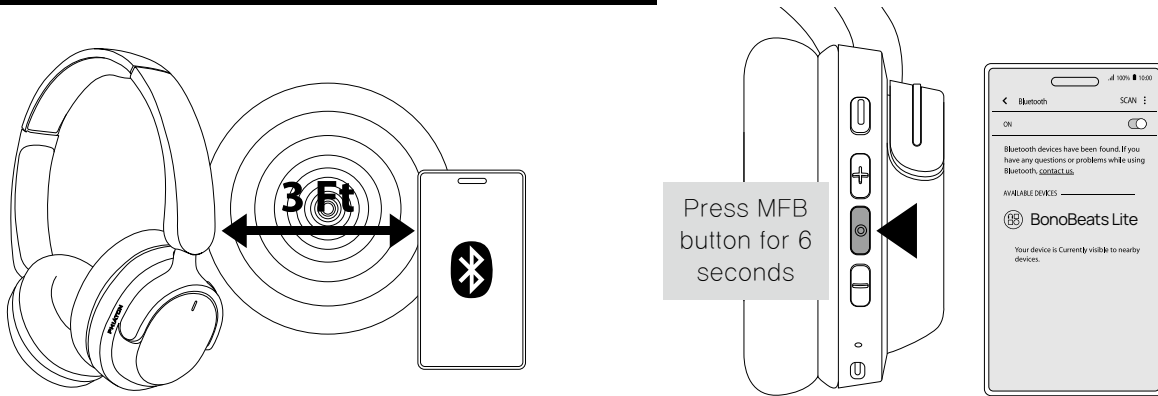

1) Pairing

- Turn on the Bluetooth feature with the 'Bluetooth Device' you want to connect with the BonoBeats Lite.
- Place the BonoBeats Lite within 3 feet of the 'Bluetooth Device' you want to connect.
- Press and hold the MFB button for over 6 seconds with the BonoBeats Lite power on to enter Pairing Mode. Pairing mode will automatically start the first time the BonoBeats Lite are turned on after purchase.

Status	LED Indicator	Voice Guidance
Pairing Mode	Blue and Red light alternately blinks	Pairing Mode activated

- Within the 'Bluetooth device' you want to connect, search/select 'BonoBeats Lite'.

※ If the 'Bluetooth device' requires a PIN code or password, enter '0000'.

- Use the headphones to play music or connect a call.

Operation	LED Indicator	Voice Guidance
Connection Success	Blue light blinks once in 6 second intervals	Device connected

2) Re-connecting a Disconnected Device

① Auto Connection

- Once the device has been paired with a 'Bluetooth Device' it will automatically be connected to a previously connected device once the BonoBeats Lite power is turned on.
- If Bluetooth becomes disconnected and the range between the BonoBeats Lite and the 'Bluetooth Device' is exceeded, then Bluetooth will not be automatically reconnected when back in range. When you are back within the discover range (33 feet), you must then connect manually.

② Manual Connection

- When having entered 'Connection Waiting Mode' during connection.
- Press the POWER Button on the headphone to connect.
- The BonoBeats Lite will also be connected if you select 'BonoBeats Lite' from the device search list within your 'Bluetooth Device'.

3) Checkpoints Upon Pairing

- Check to see whether the Bluetooth mode is activated within the 'Bluetooth Device' you want to connect.
- When selecting the connection device, connect by selecting stereo headset device. Music cannot be played when connected through mono headset.

※ In order to properly use the Bluetooth feature of this device, the profile (A2DP, HFP and AVRCP) of the 'Bluetooth Device' you are trying to connect must support the profile of this device.

- ※ A2DP—"Advanced Audio Distribution Profile", HFP—"Hands Free Profile", AVRCP—"Audio/Video Remote Control Profile"
- ※ The device will not operate properly if the profiles are not supported equally. Even when the profiles are supported equally, some features may not properly operate depending on the 'Bluetooth Device' specifications. To check the detail specifications of this headphone's profile, refer to '15. SPECIFICATIONS'. For more information, please visit phiaton.com or contact Phiaton customer service.

6. MULTIPOINT CONNECTION

1) What is 'Multipoint Connection'?

- This is a feature where BonoBeats Lite's user can simultaneously connect two Bluetooth devices.

2) Multipoint Connecting

- Turn on the Bluetooth feature within the two 'Bluetooth Devices' you want to connect with BonoBeats Lite.
- Refer to 5. PAIRING WITH A 'BLUETOOTH DEVICE' to pair the first device with the BonoBeats Lite.
- Press and hold the POWER Button again for 5 seconds to enter 'Pairing Mode'.
It is normal that the first device will disconnect here.
- Once 'Pairing Mode' has been entered, pair the second device. – Within the first 'Bluetooth Device' you want to connect, select 'BonoBeats Lite' again.
- Now, both of the 'Bluetooth Devices' will now be connected simultaneously, and the 'BonoBeats Lite' will control the second paired device.

- ※ If the second 'Bluetooth Device' is not connected during the process of connecting 'Multipoint Connection', the BonoBeats Lite will be turned off after 5 minutes.
- ※ When the BonoBeats Lite is turned off and back on, the first and second paired devices will automatically be connected.

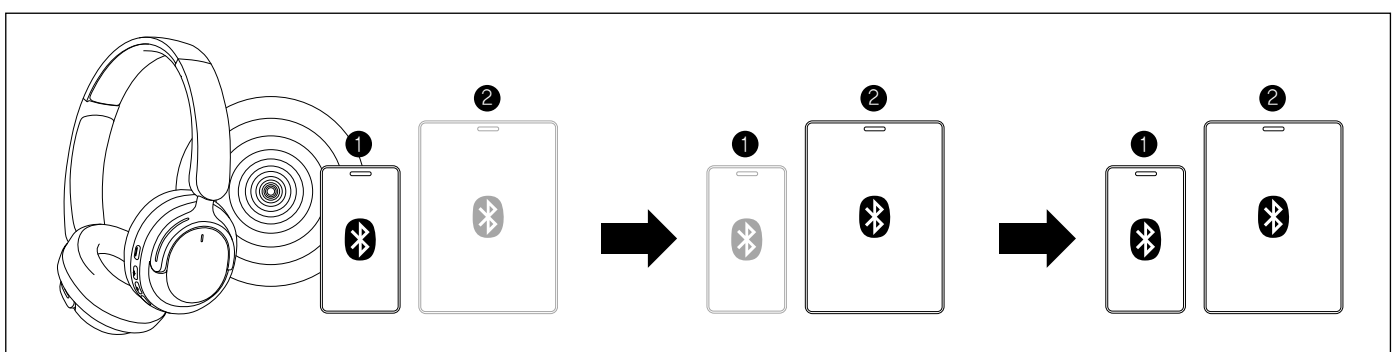

- ※ When Multipoint Connection is being used, the features operated within BonoBeats Lite usually operate within the first paired device. (When using the second paired device, it is possible to operate the device from BonoBeats Lite.)
- ※ When using Multipoint Connection, the order of the paired devices may change. To change the order, re-connect the device you usually use.

7. NOISE CANCELLING FUNCTION

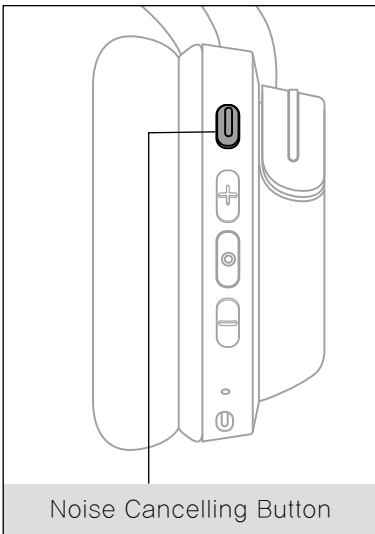

- 1) What is 'Noise Cancelling'?
 - Noise Cancelling refers to a technology that reduces noise from mid/low pitched sounds under 1kHz.
- 2) Turn On Noise Cancelling
 - The Noise Cancellation function is automatically activated when the device is powered on or when the audio cable is plugged in. When pressing the Noise Cancellation button you will activate the Audio Transparency feature which will allow you to hear the sounds around you better. Press the NC button again and Noise Cancellation is activated again.
- 3) Cautions regarding the Noise Cancelling function
 - The Noise Cancelling function cannot be used when the battery is completely discharged or completely empty.
 - Using this function while driving or walking could prevent outside noise, such as signals or alarms, from being heard and may present a hazard to yourself and others. Proceed with caution when in use.
 - Noise Cancelling is optimized for mechanical noises from airplanes, buses, and subway trains and is not necessary within quiet indoor environments.

8. MONITORING (AUDIO TRANSPARENCY)

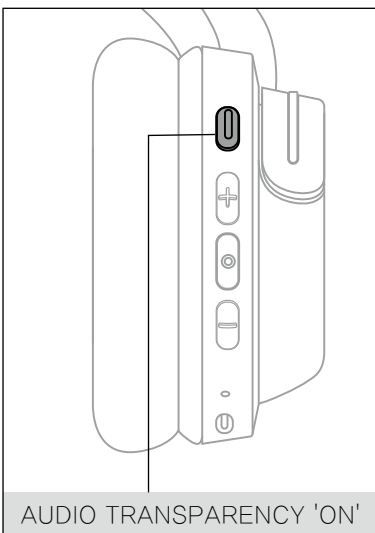

- 1) The AUDIO TRANSPARENCY feature allows you to stop noise cancelling temporarily so you can hear the surrounding sounds without removing the headphone.
- 2) When AUDIO TRANSPARENCY is activated, the noise cancelling function is stopped and external sounds can be heard.
- 3) When the NC button is pressed while the noise cancelling function is on, AUDIO TRANSPARENCY is activated. Press again to stop the AUDIO TRANSPARENCY.

9. LISTENING TO MUSIC (PLAY & CONTROL)

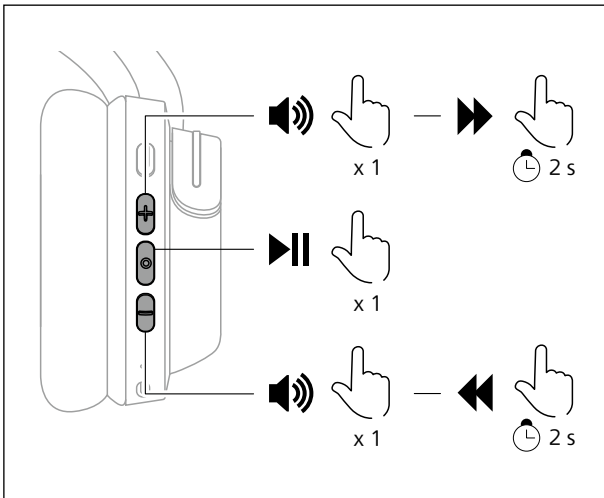

1) Playing Music

- Short press the MFB Button once to play music from the 'Bluetooth Device'.
- While music is playing, short press the MFB Button to pause the playing music.
The music will resume from the paused point when playing again.

※ SBC (Sub Band Codec) is default audio codec installed for any 'Bluetooth Device'.

※ aptX™ , aptX™ HD and AAC are high quality audio codec.

2) Controlling Volume and Using Seek

- Press the (+)/(-) Button to control the volume.
- Press and hold the (+)/(-) Button for about 2 second to go to the next / previous song.
- Press and hold the (+)/(-) Button continuously to fast-forward / rewind the current song.
- ※ Music can also be controlled directly through your connected Bluetooth device.

10. ACCEPTING / MAKING A CALL WHILE PLAYING MUSIC

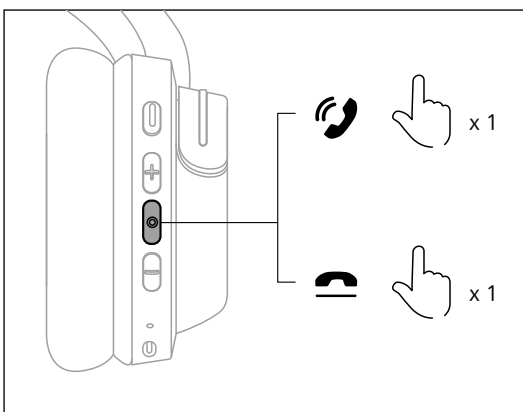

1) Accepting a Call while Playing Music

- When an incoming call tone is heard through the headphones, press the MFB button. The music will pause and the call will be connected.
- Once the call has ended, press the MFB button to terminate the call. Once the call is terminated, music will then resume.

11. USING THE CALL FUNCTION

1) Accepting a Call

- When an incoming call tone is heard through the headphones, press the MFB button.
(Volume control: While on a call, use the + / – button to control volume.)

2) Ending a Call

- While on a call, press the MFB button

3) Rejecting a Call

- When an incoming call tone is heard through the headphones, press and hold the MFB button for about 1 second.
(After hearing the 'beep' signal tone, the incoming call is rejected and the voice guidance "Call Ignored" is heard.)

4) Call Waiting

- When receiving another incoming call while on a call.
(Supported only when having applied for this service with your telecom provider.)
- Shortly Press the MFB button to place the current call on call waiting and connect the second call.
(Quickly double press the MFB button again to switch between the waiting call and connected call.)
- Press and hold the MFB button for about 1 second to end the current call and connect the second call.

5) Switching between Mobile Phone to BonoBeats Lite

- To switch the call from mobile phone to the headphone, press the MFB button for 1 second.

Status	LED Indicator
Incoming Bell/Outgoing Bell	Purple light blinks in 1,5 second intervals
During Call	Blue light slowly blinks every 6 seconds
When two calls are connected	Purple light slowly blinks every 6 seconds

Battery use time

Status	Noise Cancelling 'ON'
Call Time	Max. 34 hours
Music Play Time	Max. 30 hours
Standby Time	Max. 40 hours
10 min. Charging	Max. 5 hours
Full Charging Time	About 2 hours

※ The above times may differ depending on the environment in which it is used.

12. MISCELLANEOUS FEATURES

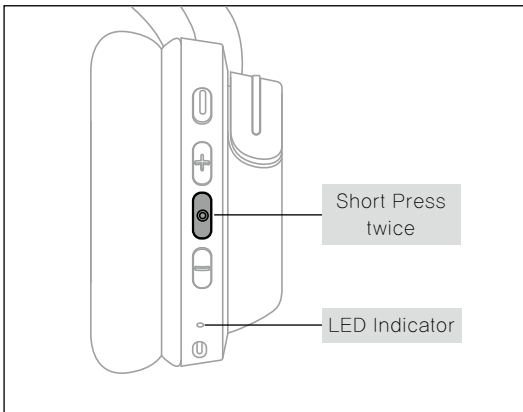

1) Checking Remaining Battery

- With the power on, short press the MFB button twice to announce the remaining battery level by voice guidance.
- For Apple iOS version 5 or above, the remaining battery is displayed at the top right side of the screen.

Remaining Battery	Voice Guidance
Over 80%	Battery is full
80% ~ 20%	Battery is moderate
Under 20%	Battery is low
Under 10% Red light	Please recharge

※ The Battery Check feature will not operate while the battery is being charged.

※ When the battery charge is under 10%, The voice guidance 'Please recharge' will be announced periodically. If the battery is completely drained, the 'Power Off' voice guidance will be provided and the power will automatically turn off.

2) Resetting the Device

- To reset to factory settings, when power on, continue to press and hold the MFB button and Vol – for over 6 seconds and device will reset itself.

Operation	LED Indicator
Factory Settings	Purple light blinks 5 times

13. SPECIFICATIONS

Communication Network	Bluetooth® 5.2
Bluetooth Profiles	HFP v1.8 / A2DP v1.3.2 / AVRCP v1.6.2
Audio Codec	SBC, Qualcomm® aptX™ ,aptX™ HD, AAC
Operating Frequencies	2.4 GHz (2.402 GHz ~ 2.480 GHz)
Operating Range	Within 10 m / 33 ft.
Music Play	NC ON 30 hrs
Standby Time	40 hrs
Full Charge Time	2 hrs
Headphone Dimensions	182.4 X 185.4 X 53.4 mm
Weight	148 g (0.32 lb)
Driver Unit	Ø30 mm
Sensitivity	105 dB/mW

※ The specifications are subject to change without prior notice for quality improvement.

14. PRODUCT ISSUES AND TROUBLESHOOTING

1) The power does not turn on:

- Charge the device. If the power does not turn on even after charging, contact Phiaton Customer Service.

2) The device does not charge:

- Check whether the USB charging cable has been properly connected with the device.
- Check whether the PC power is on and that it has been properly connected.
- When using an USB AC adapter, check to see that it is properly connected.
- Check by plugging into a different port or outlet to ensure it isn't an issue with outlet or port.

3) The device does not pair:

- Check whether the power of the 'Bluetooth Device' you want to connect is on.
- Check whether the Bluetooth feature within the 'Bluetooth Device' you want to connect is enabled.
- Check whether the 'Bluetooth Device' you want to connect is within the supported range.
(Pairing is supported only when within 3 feet.)
- Check whether the Bluetooth profile within the 'Bluetooth Device' is compatible.
- Check whether the BonoBeats Lite is in 'Pairing Mode'.
- Power OFF, then try repairing again by following direction from 5. PAIRING WITH A 'BLUETOOTH DEVICE'.
- Make sure the BonoBeats Lite is fully charged.

4) Music cannot be played:

- Check whether the power of the device and 'Bluetooth Device' is on.
- Check whether music is being played within the connected 'Bluetooth Device'.
- Check whether the volume within the connected 'Bluetooth Device' is low.
- When using an audio cord, check to see that the plug is properly connected.

5) Noise is heard or the sound lags:

- Check whether there is an electronic device nearby using the 2.4 GHz frequency band and it's also Connected to the 'Bluetooth Device'. (i.e. Wi-Fi routers, smart devices, baby monitors, and etc.)
- Check whether the connected 'Bluetooth Device' is far away from this device.
(Maximum communication range: within 33 feet.)
- Make sure there isn't an issue with Wi-Fi if streaming.

6) The other party cannot be heard while on a call:

- Check whether the power of the 'Bluetooth Device' you want to connect is on.
- Access Bluetooth through HFP.
- Check whether the volume within the connected 'Bluetooth Device' is low.

7) Outside noise is too high or not reduced:

- Check whether Noise Cancelling is turned ON.
- Check if AUDIO TRANSPARENCY has been activated

8) Product does not work or operation has stopped:

- Reset the device by simultaneously pressing the power button and connecting the USB charging cable.
- This will power off the device but will not delete previously paired devices.
- This performs a hardware reset. Headphone power will be forced to quit but pairing history will remain.
- This method is recommended when headphone or function keys do not work.

9) The device is paired with PC/Laptop but does not work:

- PC/Laptop is equipped with various Bluetooth drivers depending on the manufacturer and it is possible it does not support BonoBeats Lite.
- Please contact to PC/Laptop manufacturer to download the latest software driver or for further assistance in connecting to a 'Bluetooth Device'.

15. CERTIFICATION

FCC Compliance Information

FCC ID: V2R-BN0300

This device complies with Part 15 of the FCC Rules.

Operation is subject to the following two conditions:

- (1) this device may not cause harmful interference, and
- (2) this device must accept any interference received, including interference that may cause undesired operation.

Warning: Changes or modifications not expressly approved by the party responsible for compliance could void the user's authority to operate the equipment

NOTE :

This equipment has been tested and found to comply with the limits for a Class B Digital Device, pursuant to Part 15 of the FCC Rules. These limits are designed to provide reasonable protection against harmful interference in a residential installation. This equipment generates, uses and can radiate radio frequency energy and, if not installed and used in accordance with the instruction, may cause harmful interference to radio communication. However, there is no guarantee that interference will not occur in a particular installation. If this equipment does cause harmful interference to radio or television reception. Which can be determined by turning the equipment off and on, the user is encouraged to try to correct the interference by one or more of the following

measures :

- Reorient or relocate the receiving antenna.
- Increase the separation between the equipment and receiver
- Connect the equipment into an outlet on a circuit different from that to which the receiver is connected.
- Consult the dealer or an experienced radio/TV technician for help.

This equipment complies with FCC radiation exposure limits set forth for an uncontrolled environment and meets the FCC radio frequency (RF) Exposure Guidelines.

This equipment has very low levels of RF energy that is deemed to comply without testing of specific absorption rate (SAR).

Caution:

Changes or modifications not expressly approved by the party responsible for compliance could void the user's authority to operate the equipment.

IC Compliance Information

IC ID: 10488A-BN0300

This device complies with Industry Canada's license-exempt RSS(s).

Operation is subject to the following two conditions:

- (1) This device may not cause interference.
- (2) This device must accept any interference, including interference that may cause undesired operation of the device.

This equipment complies with IC radiation exposure limits set forth for an uncontrolled environment and meets RSS-102 of the IC radio frequency (RF) Exposure rules.

Pour la clientèle au Canada

L'émetteur/récepteur exempt de licence contenu dans le présent appareil est conforme aux CNR d'Innovation, Sciences et Développement économique Canada applicables aux appareils radio exempts de licence. L'exploitation est autorisée aux deux conditions suivantes :

- (1) L'appareil ne doit pas produire de brouillage;
- (2) L'appareil doit accepter tout brouillage radioélectrique subi, même si le brouillage est susceptible d'en compromettre le fonctionnement.

TN0620 a été testé et jugé conforme aux limites d'exposition aux rayonnements énoncées pour un environnement non contrôlé et respecte les règles d'exposition aux fréquences radioélectriques (RF) CNR-102 de l'ISDE.

CE Compliance Information

Hereby, PHIATON declares that this product is in compliance with the essential requirements and other relevant provisions of RE Directive 2014/53/EU 2011/65/EU.

We hereby declare under our sole responsibility that the electrical product above is in compliance with the essential requirements of the Radio Equipment Directive (2014/53/EU) by application of

- | | |
|------------|---|
| Art.3.1.a) | EN 62368-1:2020 + A11:2020
EN 50663:2017 |
| Art.3.1.b) | EN 301 489-1 V2.2.3 (2019-11)
EN 301 489-17 V3.2.4 (2020-09) |
| Art.3.2) | EN 300 328 V2.2.2 (2019-07) |

UKCA Compliance Information

We hereby declare under our sole responsibility that the electrical product above is in compliance with the essential requirements of the Radio Equipment Regulations 2017 by application of

- | | |
|--------------------|---|
| Regulation 6(1)(a) | EN 62368-1:2020 + A11:2020
EN 50663:2017 |
| Regulation 6(1)(b) | EN 301 489-1 V2.2.3 (2019-11)
EN 301 489-17 V3.2.4 (2020-09) |
| Regulation 6(2) | EN 300 328 V2.2.2 (2019-07) |

Responsible Party-U.S. Contact Information

PHIATON Corporation

9550 Warner Ave #360 Fountain Valley CA 92708

To learn more, visit our website, www.phiaton.com

Phiaton is a trademark of Phiaton Corporation

