

OWNER'S GUIDE

BT 150 NC



 **PHIATON**



WIRELESS EARPHONES with ACTIVE NOISE CANCELLING and TOUCH INTERFACE

Thank you for purchasing PHIATON BT 150 NC.

- Please follow the directions, and read the guidelines carefully before use. Please keep the owner's guide for future reference.
- Some functions of the BT 150 NC may not be available when it is paired with certain devices.
- The specifications are subject to change without prior notice for quality improvement.

Contents

1. SAFETY AND GENERAL INFORMATION
2. COMPONENTS & FEATURES
3. RETRACTABLE WIRE EARPHONES
4. CHARGING
5. BLUETOOTH POWER ON/OFF AND EARPHONE CONNECTION WAITING MODE
6. PAIRING WITH A 'BLUETOOTH DEVICE'
7. MULTIPOINT CONNECTION
8. USING NOISE CANCELLING FEATURE
9. MONITOR FEATURE
10. LISTENING TO MUSIC (PLAY & CONTROL)
11. USING THE CALL FUNCTION
12. CHANGING SOUND MODE
13. OUT OF COMMUNICATION RANGE
14. MISCELLANEOUS FEATURES
15. CONNECTING AND USING THE AUDIO CABLE
16. SPECIFICATIONS
17. PRODUCT SYMPTOMS AND TROUBLESHOOTING
18. FCC COMPLIANCE INFORMATION
19. CE COMPLIANCE INFORMATION

English

한국어

Deutsch

Français

Español

русский

中國語

1. SAFETY AND GENERAL INFORMATION

- 1) Use a standard USB charging cable (included), with or without a charging adapter.
(5V, over 500mA) * Adapter Not Included
- 2) Lower the volume prior to listening to audio to prevent potential damage to eardrums caused by sudden loud sound.
- 3) Listening to loud music for extended periods of time may cause hearing damage.
- 4) Do not store the device in places with a temperature higher than 113 °F/ 45 °C.
- 5) This device is IPX4 sweat and water resistant. Please note that it is not water proof. Please use caution to not oversaturate with moisture or leave excessive moisture on the device as this can damage the internal components. (For more information, refer to the contact us page within our website –phiaton.com.)
- 6) Do not attempt to disassemble, modify or repair the device.
- 7) Do not cause shock to the device.
- 8) Keep out of the reach of children and pets.
- 9) Do not tug on cords or touch power plugs with wet hands.
- 10) Do not use the device nearby microwave ovens or wireless LAN adapters.
- 11) When the product is not being used, set the device power switch to 'OFF' and the NC power switch to 'OFF'.
- 12) When cleaning the device, use a clean dry cloth to wipe the device clean.
(Do not use solvents.)
- 13) Remove the ear tips from the earphones, wash them with warm water, dry completely and check for any debris before reattaching.
- 14) Replacement ear tips can be purchased from Phiaton Customer Service.
- 15) Use while driving or walking will prevent outside noise, such as signals or alarms, from being heard and may be dangerous to yourself and others. Heed caution during use.
- 16) The radio waves of this device may affect electronic medical devices. If you use any electronic medical device, consult your doctor or the medical device company before you use it.

※ Use the BT 150 NC only for its intended purposes.

※ This device cannot be used for purposes related to human safety as it may cause radio interference during operation.

2. COMPONENTS & FEATURES

1) COMPONENTS

- BT 150 NC
- USB Charging Cable
- Audio Cable (1.0 m, micro USB Plug to 3.5 mm Plug)
- 4 Sizes of Silicon Ear Tips (S, M, L, XL)
- Quick Guide
- Warranty Card

2) FEATURES

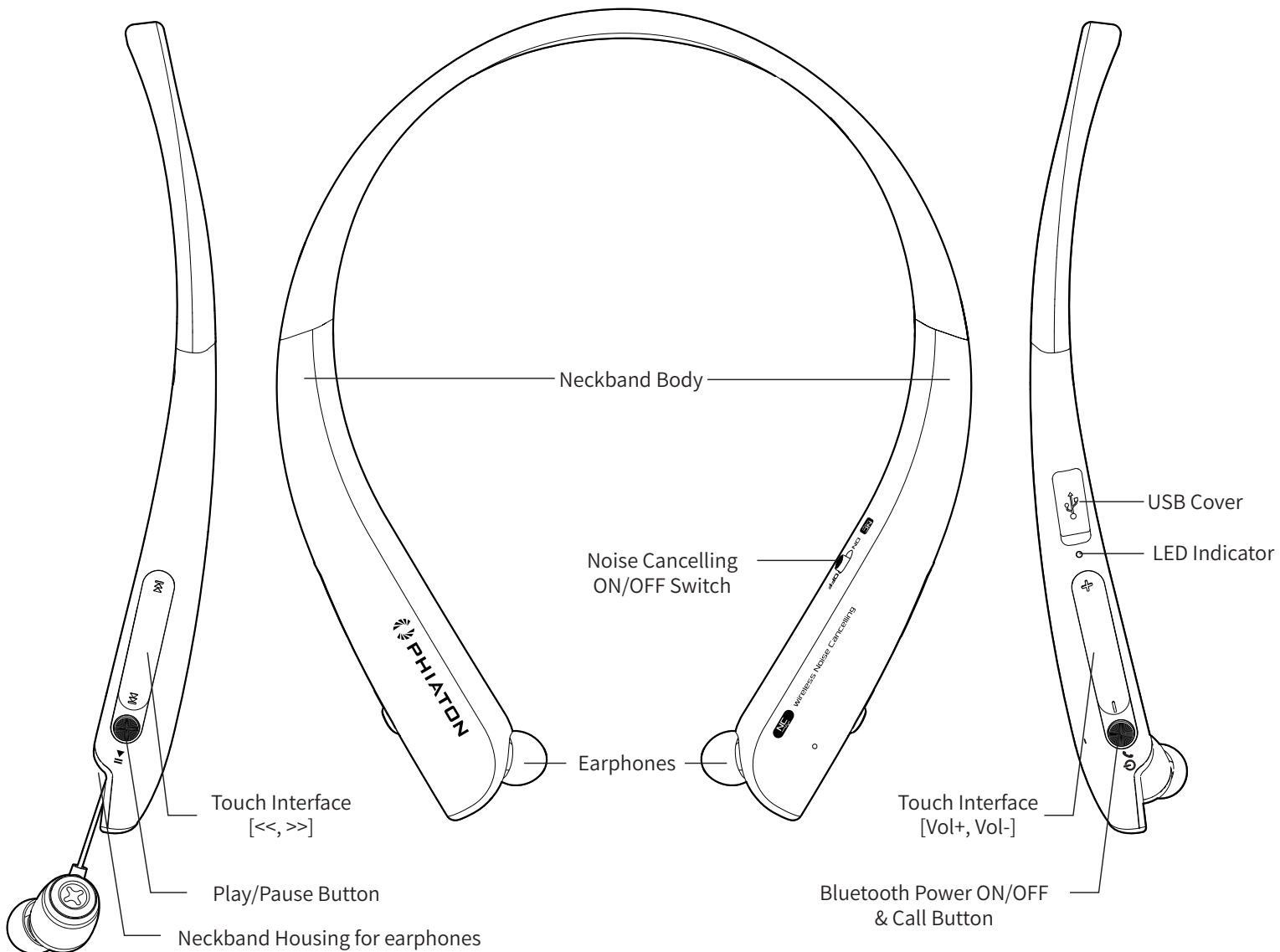

3. RETRACTABLE WIRE EARPHONES

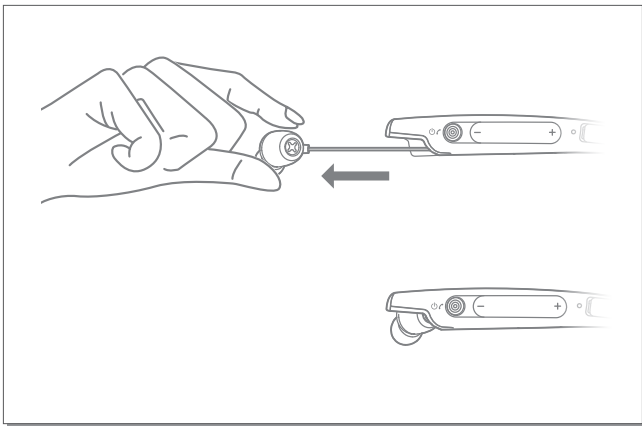

- 1) The earphones are connected to the neckband with a retractable wire. To use, gently pull the earphones from the neckband to a comfortable corded length to place in your ears.
- 2) There are stop latches in the reel so when you reach the desired length for a comfortable fit, simply allow the wire to stop at one of the stop latches. You can either further extend or retract with another slight pull of the earphone.
- 3) When you are finished listening, remove the earphones from your ears.
- 4) Then simply retract the earphones back into the neckband housing by gently pulling the earphones slightly out to engage the retractable wire, until it is wound completely back into the neckband.

- ※ Use with care as there is risk of damage to the retractable wire if you pull with too much force or extend too far from the neckband body.
- ※ When pulling the retractable wire earphone for storage into the neckband housing, pulling too far will cause the wire to latch again and not be wound.

4. CHARGING

The device may not be charged upon purchase and must first be charged before use.

- 1) Open the USB cover on BT 150 NC and connect the provided USB charging cable.
- 2) Connect the provided USB charging cable with a computer (laptop) or you may also use a separately purchased USB adapter (rating: 5V/over 500mA) to begin charging.

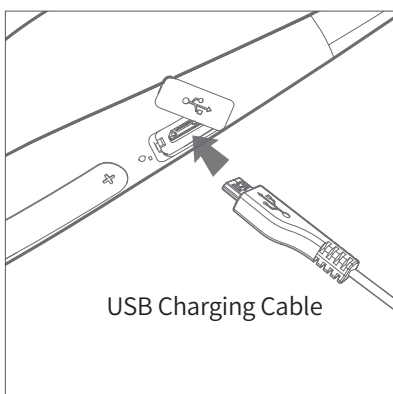

Operation	LED Indicator
Charging	Red light
Charging complete	Blue light

- This device has a built-in battery, so it will begin charging automatically when you connect the charging cable.

5. BLUETOOTH POWER ON/OFF AND EARPHONE CONNECTION WAITING MODE

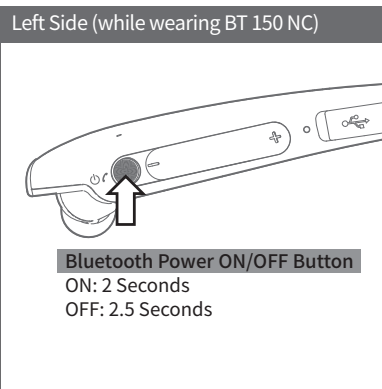

1) Bluetooth Power ON/OFF

- Press and hold the [CALL/POWER] Button for 2 seconds to turn the power on.
- When turning the power off, press and hold the [CALL/POWER] Button for 2.5 seconds to turn off.
(While on an incoming call, you cannot power off the device.)
- When turning power on/off, there is a vibration notification that rings.

Status	Operation	LED Indicator	Vibration Notification
ON	Press and hold the CALL/POWER button for 2 seconds	Purple light turns on for 1 second	Vibrates once for 0.3 second
OFF	Press and hold the CALL/POWER button for 2.5 seconds	Red light blinks 5 times	Vibrates twice for 0.3 second

※ Pairing mode will start once the power is turned on for the first time after purchase.

※ When the BT 150 NC is not in use, ensure the NC function is switched OFF. If left in the ON position, this will cause the battery to run out.

2) Connection Waiting Mode

- When power is turned on, 'Connection Waiting Mode' will start if 'Pairing Mode' cannot be entered or the earphones cannot connect with 'Bluetooth Device'.
- If the 'Bluetooth Device' is not connected within 5 minutes in 'Connection Waiting Mode', the earphones will automatically turn off.

Status	LED Indicator
Connection Waiting Mode	Blue light blinks twice in 6 second intervals

6. PAIRING WITH A 'BLUETOOTH DEVICE'

1) Pairing

- Turn on the Bluetooth feature with the 'Bluetooth Device' you want to connect with the BT 150 NC.
- Place the BT 150 NC within 3 feet of the 'Bluetooth Device' you want to connect.
- Press and hold the PLAY Button for over 2.5 seconds with the BT 150 NC power on to enter Pairing Mode.

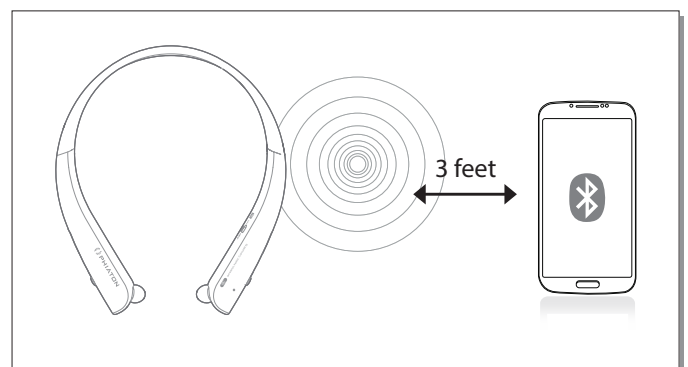

Status	LED Indicator	Voice Guidance
Pairing Mode	Blue and Red light alternately blinks	Pairing Mode activated

- Within the 'Bluetooth Device' you want to connect, search/select 'BT 150 NC'.
- ※ If the 'Bluetooth Device' requires a PIN CODE or password, enter '0000'. Bouton de lecture pendant 2,5 secondes.
- Use the earphones to play music or connect a call.

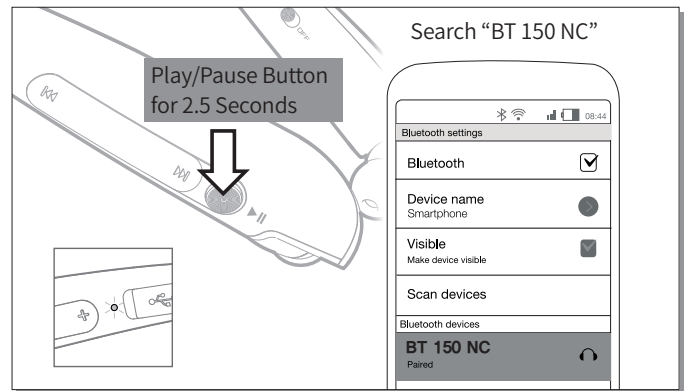

Operation	LED Indicator	Voice Guidance
Connection success	After Purple light blinks twice, blue light blinks once in 6 second intervals.	Device connected

2) Re-connecting a Disconnected Device

① Auto Connection

- Once the device has been paired with a 'Bluetooth Device', it will automatically be connected to a previously connected device once the BT 150 NC power is turned on.
- If Bluetooth becomes disconnected as the discover range between the 'Bluetooth Device' and the BT 150 NC is exceeded, then Bluetooth will not be automatically re-connected. When you are back within the discover range (33 feet), you must then connect manually.

② Manual Connection

- When having entered 'Connection Waiting Mode' during connection.
- Press the CALL/POWER Button or the PLAY Button on the earphone to connect.
- The BT 150 NC will also be connected if you select 'BT 150 NC' from the device search list within your 'Bluetooth Device'.

3) Checkpoints Upon Pairing

- Check to see whether the Bluetooth feature is activated within the 'Bluetooth Device' you want to connect.
- When selecting the connection device, connect by selecting stereo headset device. Music cannot be played when connected through mono headset.

※ In order to properly use the Bluetooth feature of this device, the profile (A2DP, HSP, HFP and AVRCP) of the 'Bluetooth Device' you are trying to connect must support the profile of this device.

* A2DP—"Advanced Audio Distribution Profile", HSP—"Headset Profile", HFP—"Hands Free Profile". AVRCP—"Audio/Video Remote Control Profile"

※ The device will not operate properly if the profiles are not supported equally. Even when the profiles are supported equally, some features may not properly operate depending on the 'Bluetooth Device' specifications.

To check the detail specifications of this earphone's profile, refer to '16. SPECIFICATIONS'.

For more information, please visit phiaton.com or contact Phiaton customer service.

7. MULTIPOINT CONNECTION

1) What is 'Multipoint Connection'?

- This is a feature where BT 150 NC's user can simultaneously connect two Bluetooth devices.

2) Multipoint Connecting

- Turn on the Bluetooth feature within the two 'Bluetooth Devices' you want to connect with BT 150 NC.
- Refer to '6. PAIRING WITH A 'BLUETOOTH DEVICE' to pair the first device with the BT 150 NC.
- Press and hold the PLAY Button again for 2.5 seconds to enter 'Pairing Mode'
(Here, the first device becomes disconnected.)
- Once 'Pairing Mode' has been entered, pair the second device.
- Within the first 'Bluetooth Device' you want to connect, select 'BT 150 NC' again.
- Now, both of the 'Bluetooth Devices' will be connected simultaneously, and now the 'BT 150 NC' will control the secondly paired device.

- ※ Sleep Mode will be entered when devices are not connected within two minutes. When trying to connect a device while in Sleep Mode, pressing any button will re-enter 'Connection Waiting Mode' where connection is possible.
- ※ When the BT 150 NC power is turned off and back on, only the second paired device will automatically be connected. When the first paired device is reconnected, then both of the devices will remain connected.

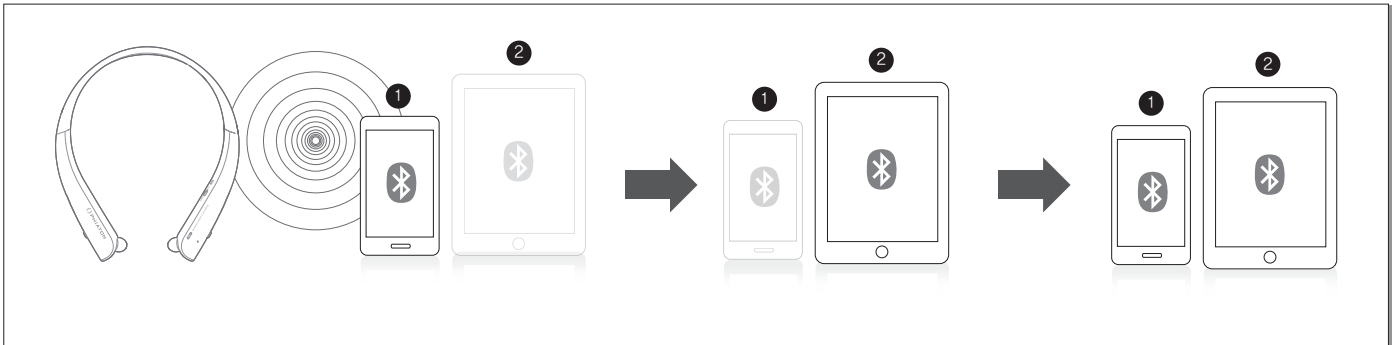

- ※ Upon Multipoint Connection, the features operated within BT 150 NC usually operate within the second paired device.
(When using the first paired device, it is possible to operate the device from BT 150 NC.)
- ※ When using Multipoint Connection, the order of the paired devices may change. To change the order, re-connect the device you usually use.

8. USING NOISE CANCELLING FEATURE

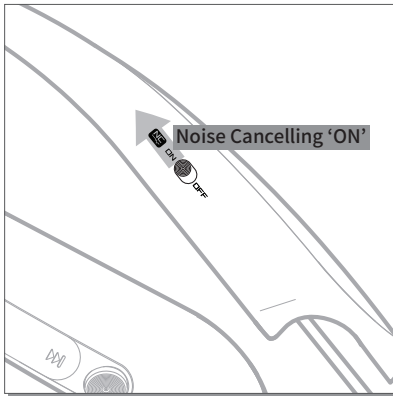

1) What is 'Noise Cancelling'?

Noise Cancelling refers to a technology that reduces noise from mid/low pitched sounds under 1 kHz.

2) Turning Noise Cancelling Feature ON/OFF

- Sliding the NC Button towards ON direction will turn Noise Cancelling ON and sliding the Button towards OFF will discontinue Noise Cancelling. (NC function will stop when either L or R earphone is stored.)

3) Noise Cancelling Function Auto ON/OFF (When Using Noise Cancelling Feature)

- If the earphone is retracted back in the neckband, while the NC switch is still 'ON', the Noise Cancelling feature will automatically disable to save the battery life.
- If you pull the earphones back out from the neckband housing, and the NC switch is still 'ON,' the Noise Cancelling function will resume.

4) Cautions upon using Noise Cancelling Feature

- Noise Cancelling cannot be used when the battery is completely drained.
- Use while driving or walking will prevent outside noise, such as signals or alarms, from being heard and may be dangerous to yourself and others. Heed caution during use.
- Noise Cancelling is optimized for mechanical noises from airplanes, buses, and subway trains and is not required for use within quiet interior environments.
- Always switch the NC button to "OFF" when the Noise Cancelling feature is not needed to save the battery life.

9. MONITOR FEATURE

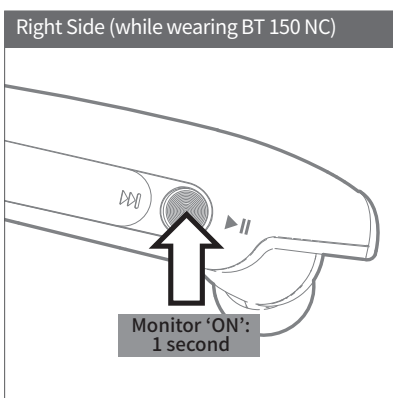

1) The monitor feature allows you to mute your music and noise cancelling temporarily, so you can hear the surrounding sounds without removing the ear buds.

2) Press the PLAY/PAUSE Button for about 1 second when you want to hear the sounds around you. (When the Noise Cancelling feature is ON and or you are listening to music.)

3) Monitor is continued for 30 seconds unless you press any key to stop the monitor feature quicker.

10. LISTENING TO MUSIC (PLAY & CONTROL)

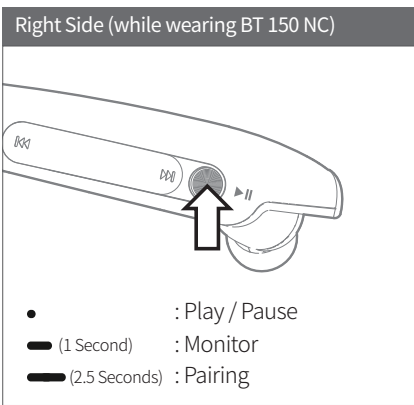

• : Press — : Brief Hold — : Press & Hold

1) Playing Music

- Shortly press the PLAY/PAUSE Button once to play music from the 'Bluetooth Device'.
- While music is playing, shortly press the PLAY/PAUSE Button to pause the playing music. The music will be played from the paused point when playing music again.

Status	LED Indicator
While music is playing (Connection with 'Qualcomm® aptX™ audio')	Purple Light slowly blinks every 6 seconds
While music is playing (Connection with SBC)	Blue Light slowly blinks every 6 seconds

* SBC (Sub Band Codec) is default audio codec installed for any 'Bluetooth Device'.

* 'Qualcomm® aptX™ audio' is high quality audio codec supported by Qualcomm® CSR.

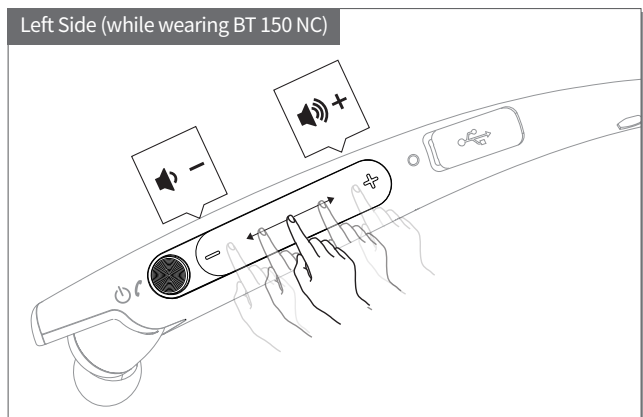
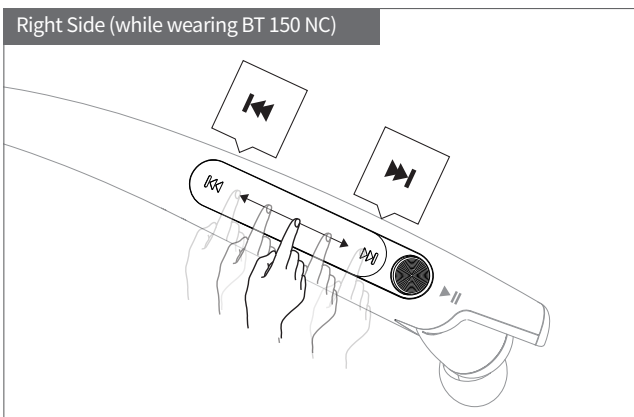

2) Controlling Volume and Using Seek

- Both sides of the neckband feature a touch panel to control the volume and music tracks.
- Sweep the touch panel to control the volume of the Left side (while wearing BT 150 NC) to top (+) / bottom (-) to control the volume.
- Sweep the touch panel of the Right side (while wearing BT 150 NC) to go to the previous / next song. (You will hear the 'beep' signal when operating the touch panel.)

* When listening to music on the BT 150 NC via Bluetooth, you can also control your music and calls directly from your 'Bluetooth Device'.

* When the battery is completely drained, you can connect the provided audio cable to hard wire to your device and continue listening. (The buttons and touch panel will not function when using the optional audio cable so you will have to use your 'Bluetooth Device' for music and call control.)

11. USING THE CALL FUNCTION

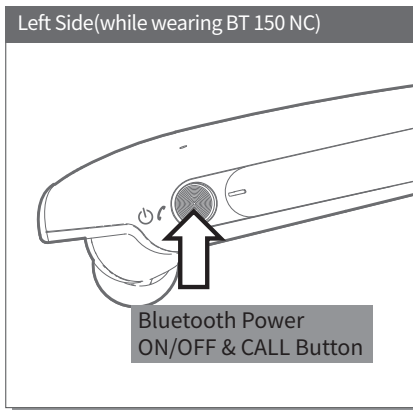

1) Accepting a Call

- When the incoming call tone is heard through the earphones or the incoming call vibration is ringing, press the CALL/POWER Button. (If you are listening to music when the call comes in, your music will be paused when you press the CALL/POWER BUTTON.)
- Adjusting Call Volume: to control the call volume, sweep the touch panel of the left side (while wearing BT 150 NC) to top (+) / bottom (-) ward.

2) Ending a Call

- While on a call, shortly pressing the CALL/POWER Button to end the call. (If you were listening to music when the call came in, your music will resume playing when you end the call.)

3) Rejecting a Call

- When the incoming call tone is heard through the earphones or the incoming call vibration is ringing, press and holds the CALL/POWER Button for about 1 second. (After providing the 'beep' signal tone, the incoming call is rejected and the 'Call Ignored' voice guidance is heard.)

4) Call Waiting (Supported only when having applied for this service with your telecom provider.)

- When there is another incoming call while on a call.
- Press and hold the CALL/POWER Button for about 1 second to place the current call on call waiting and connect the second call. (Press the CALL/POWER Button again for about 1 second to switch between the waiting call and connected call.)
- Shortly press the CALL/POWER Button to end the current call and connect the second call.

5) Calling by Voice

- To place a call by voice, shortly press the CALL/POWER Button and request 'call contact' while connected to the phone.
- This will begin voice command function. (Supported within mobile phones that support the voice command feature.)

6) Switching between the Device and Mobile Phone

- To switch the call from mobile phone to the headphone, press the CALL Button for 1 second.

Status	LED Indicator
Incoming Bell/Outgoing Bell	Purple light blinks in 1.5 second intervals
During Call	Blue light slowly blinks every 6 seconds
When there are two calls connected	Purple light slowly blinks every 6 seconds

7) Stopping Incoming Call Vibration

- During on incoming call, shortly press the PLAY/PAUSE Button to stop vibration feature. You will then only hear the incoming call tone.

12. CHANGING SOUND MODE

1) When the BT 150 NC connects with a 'Qualcomm® aptX™ audio' high quality sound compatible 'Bluetooth Device', it connects in 'Qualcomm® aptX™ audio' mode automatically. (If the 'Bluetooth Device' cannot support 'Qualcomm® aptX™ audio' mode, it will be connected with SBC mode.)

Status	Operation	LED Indicator
'Qualcomm® aptX™ audio'	Connect automatically	Purple light turns on for 1 second
SBC mode	Connect automatically	Blue light turns on for 1 second

* SBC (Sub Band Codec) is default audio codec installed for any 'Bluetooth Device'.

* 'Qualcomm® aptX™ audio' is high quality audio codec supported by Qualcomm® CSR.

※ Battery use time

Classification	Noise Cancelling OFF	Noise Cancelling ON
Continuous Talk Time	Max 10.5 hours	Max 6 hours
Continuous Music Play Time	Max 10.5 hours	Max 6 hours
Stand by Time	Max 350 hours	Max 16 hours
Full Charge Time	About 2 hours	

* The above times may differ depending on the environment in which it is used.

13. OUT OF COMMUNICATION RANGE

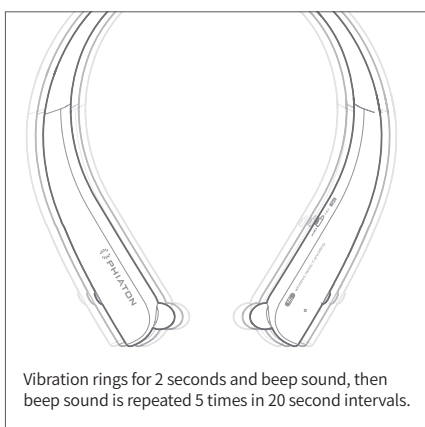

- 1) The BT 150 NC vibrates when you are out of communication range (about 10 m/33 ft.) from the 'Bluetooth Device'.
- 2) The alarm function first notifies you with a vibration for 2 seconds and beep sound, then beep sound is repeated 5 times in 20 second intervals.
- 3) If you continue to be out of range for more than 20 seconds, the BT 150 NC will enter 'Connection Waiting Mode' after notifying you with vibration and beep sounds, along with a voice prompt of 'Device Disconnected'.
- 4) If you move back into communication range before the notification completes the fifth interval, you will stay connected to your 'Bluetooth Device'.
- 5) If you do not move back into communication range until after the notification has ended, you will need to manually reconnect to Bluetooth.

14. MISCELLANEOUS FEATURES

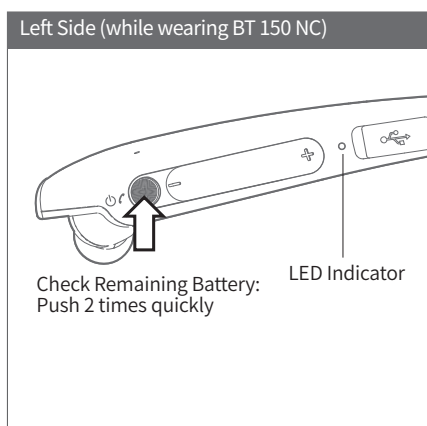

1) Checking Remaining Battery

- With the power on, shortly press the CALL/POWER Button twice to display the remaining battery indicator (LED).
- For Apple iOS version 5 or above, the remaining battery is displayed at the top right side of the screen.

Remaining Battery	LED Indicator	Voice Guidance
Over 80%	Blue light lights up for 1 second	Battery is full
80% ~ 30%	Purple light lights up for 1 second	Battery is moderate
Under 30%	Red light lights up for 1 second	Battery is low
Under 3%	Red light lights up for 1 second and the alarm will sound	Please recharge

* The Battery Check feature will not operate while the battery is being charged.

* When the battery charge is under 3%, the alarm will sound.

If use is continued for several minutes the battery will be completely drained, the 'Power Off' voice guidance is provided and the power will automatically turn off.

2) Resetting the Device

- To reset to factory settings, shortly press the PLAY/PAUSE Button twice while in the 'Pairing Mode.'
- This is Software reset. This will delete all of the previously paired device history.
- This method is recommended when there's issue on pairing with devices.

Operation	LED Indicator	Voice Guidance
Factory Settings	Purple light lights up twice	After 'beep' signal tone twice, "POWER ON, Pairing Mode Activated"

15. CONNECTING AND USING THE AUDIO CABLE

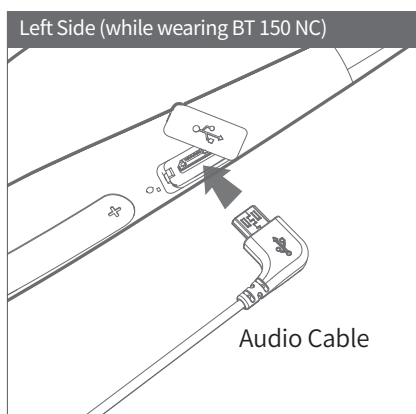

1) BT 150 NC can also be used with the audio cable connected as shown in the figure.

- * When connected to a device with the provided audio cable, the Bluetooth remote features are disabled and you must use the device you are connected to answer calls and play music.

16. SPECIFICATIONS

1) Main Body

- Communication Network: Bluetooth 4.2
- Output Power: Power Class 2
- Max. Communication Range: Discoverable within 10 m / 33 ft.
- Full Charging Time: 2 Hours
- Call Time (NC ON / OFF): 6 Hours / 10.5 Hours
- Music Play Time (NC ON / OFF): 6 Hours / 10.5 Hours
- Standby Time (NC ON / OFF): 16 Hours / 350 Hours
- Bluetooth Profile Support: HFP v1.6 / HSP v1.2 / A2DP v1.3 / AVRCP v1.5
- Audio Codec: SBC, Qualcomm® aptX™ audio
- Battery: Lithium Polymer DC 3.7 V / 195 mAh
- Microphone Frequency Range: 50 ~ 4,000 Hz
- Microphone Sensitivity: -42 dB
- Support Echo Cancellation and Talk Noise: CVC Solution
- Operating Temperature: -20 ~ 45 °C
- Size: 180 (H) x 162(W) x 23(D) mm / 7.09(H) x 6.38(W) x 0.91(D) inch
- Weight: 63 g (0.14 lbs.)

2) Earphones

- Type: Φ 12 mm Driver Units
- Sensitivity: 105 dB/mW
- Frequency Response: 10 Hz ~ 27 kHz
- Impedance: 16 Ω
- Mic. for Noise Cancelling

※ The Specifications are subject to change without prior notice for quality improvement.

17. PRODUCT SYMPTOMS AND TROUBLESHOOTING

1) The power does not turn on:

- Charge the device. If the power does not turn on even after charging, contact Phiaton Customer Service.

2) The device does not charge:

- Check whether the USB charging cable has been properly connected with the device.
- Check whether the PC power is on and that it has been properly connected.
- When using a separately purchased USB AC adapter, check to see that it has been properly connected.

3) The device does not pair:

- Check whether the power of the 'Bluetooth Device' you want to connect is on.
- Check whether the Bluetooth feature within the 'Bluetooth Device' you want to connect is enabled.
- Check whether the 'Bluetooth Device' you want to connect is within the supported range.
(Pairing is supported only when within 3 feet.)
- Check whether the Bluetooth profile within the 'Bluetooth Device' is compatible.
- Check whether the BT 150 NC is in 'Pairing Mode'.
- Power OFF, then try again repairing by following direction from **6. PAIRING WITH A 'BLUETOOTH DEVICE'**.

4) Music cannot be played:

- Check whether the power of the device and 'Bluetooth Device' is on.
- Check whether music is being played within the connected 'Bluetooth Device'.
- Check whether the volume within the connected 'Bluetooth Device' is low.
- When using an extension cord, check to see that the plug is properly connected.

5) Noise is heard or the sound lags:

- Check whether there is an electronic device using the 2.4 GHz frequency band nearby the device and connected 'Bluetooth Device'.
- Check whether the connected 'Bluetooth Device' is far away from this device.
(Maximum communication range: within 33 feet.)

6) The music sound quality is low:

- If the 'Bluetooth Device' you are trying to connect with this device is accessed to HSP, change the access to A2DP.

7) The other party cannot be heard while on a call:

- Check whether the power of the 'Bluetooth Device' you want to connect is on.
- Access Bluetooth through HFP or HSP.
- Check whether the volume within the connected 'Bluetooth Device' is low.

8) Outside noise is too high or not reduced:

- Check whether Noise Cancelling is turned ON.
- Check whether the right size ear tips are chosen.
(Noise will not be properly reduced if the ear tips are not properly inserted or the right size ear tips are not chosen.)

9) Product does not operate or operation has stopped:

- Press the 'Bluetooth Power ON/OFF & Call Button' and connect the USB charging cable with power to reset the BT 150 NC.
- This is Hardware reset. Earphone power will be forced to quit but pairing history will remain.
- This method is recommended when earphone or function keys do not work.

10) The device is paired with PC/Laptop but does not work:

- PC/Laptop is equipped with various Bluetooth drivers depending on the manufacturer and it is possible it does not support BT 150 NC.
- Please contact to PC/Laptop manufacturer to download the latest software driver or for further assistance in connecting to a 'Bluetooth Device'.

18. FCC COMPLIANCE INFORMATION

FCC ID: V2R-BT150NC

This device complies with part 15 of FCC Rules. Operation is subject to the following two conditions:

(1) This device may not cause harmful interference, and (2) this device must accept any interference received, including interference that may cause undesired operation.

Information to the user:

NOTE: This equipment has been tested and found to comply with limits for a Class B digital device, pursuant to part 15 of the FCC Rules. These limits are designed to provide reasonable protection against harmful interference in a residential installation. This equipment generates, use and can radiate radio frequency energy and, if not installed and used in accordance with the instructions, may cause harmful interference to radio communications. However there is no guarantee that interference will not occur in a particular installation. If this equipment does cause harmful interference to radio or television reception, which can be determined by turning the equipment off and on, the user is encouraged to try the correct interference by one or more of the following measures:

- Reorient or relocate the receiving antenna.
- Increase the separation between the equipment and receiver.
- Connect the equipment into an outlet on a circuit different from that to which the receiver is connected.
- Consult the dealer or an experienced radio/TV technician for help.

CAUTION TO USER: Changes or modifications not expressly approved by the party responsible for compliance could void the user's authority to operate the equipment.

19. CE COMPLIANCE INFORMATION

Phiaton, hereby declares that this BT 150 NC is in compliance with the essential requirements and other relevant provisions of directive 1999/5/EC.