

Direct restorations using light-curing composite resin

Follow the standard procedures for isolation, moisture control, cavity preparation and pulp protection

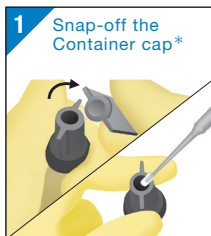

*Do not tilt the container to avoid spilling the liquid.



*Before applying PRIMER, selective enamel etch by phosphoric acid is an option.



*Refer to the table for light-curing time.

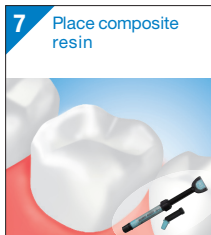

Table : Dental curing unit and curing time

Light source	Light Intensity	Light-curing time
Halogen lamp	More than 400 mW/cm ²	10 seconds
Blue LED*	800-1400 mW/cm ²	10 seconds
	More than 1500 mW/cm ²	5 seconds

The effective wavelength range of each dental curing unit must be 400-515nm.
*Peak of emission spectrum:450-480nm

