

Instructions For Use

FirstPlug® is a screw channel barrier for implant-supported restorations. It is intended to facilitate the removal of the retaining screw by excluding the overlying restorative filling from the screw head recess and screw channel. The material is supplied non-sterile. A desired amount of material is cut into individual pieces. It can be placed directly into the screw channel or sterilized in the dental autoclave prior to use.

FirstPlug®

is made of PTFE (expanded polytetrafluoroethylene). The shape and mechanical properties have been optimized to allow for efficient placement and removal. When properly placed and condensed, the material has sufficient stiffness to support the overlying restorative filling material (composite resin, amalgam, or ceramic). It is also indicated as a screw channel barrier for the implant-supported hybrid restorations and implant-supported bar type substructures.

Contraindications

Do not use if there is a known allergy or sensitivity to PTFE.*

1 Guide To Parts

Thumb latch to open



Finger recess to grab material

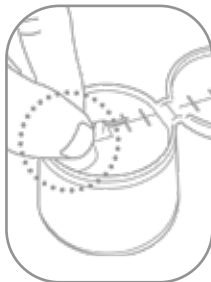

Top measuring strip (cm)

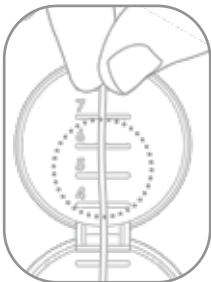

Pull to side to use cutting blade



Containers can be cleaned with standard surface disinfectant

2 Preparation

- A** Cut pieces of material to the desired length. Use directly in the screw channel or if preferred, sterilize following instructions in B and C.

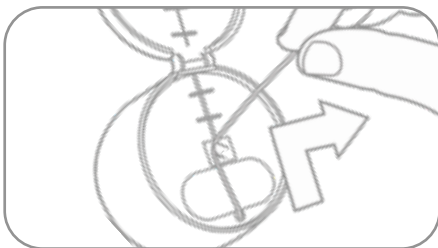

- Use cutting blade and length markings.

- a** Recommended Material Length Table

Channel Depth	FirstPlug Length
< 5 mm	1 cm
5 - 10 mm	4 cm
> 10 mm	6 cm

- PTFE Qty. 210 cm

- B** Place cut material into autoclave sterilization pouches.



- One or more pieces can be inserted per pouch.

- C** Sterilize sealed pouches in steam autoclave.

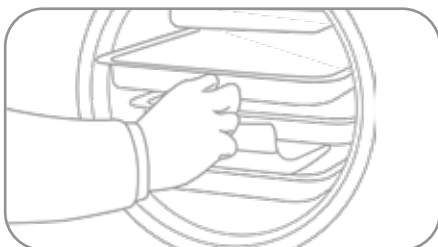

- Material will shrink during sterilization.
- Store sealed sterilized pouches until needed.



35 NEWTONS®
Tacoma, WA



2021-12-01



P000028-001



PTFE material
assembled in China
Pat. US201190151206A1

Not compatible with a chemiclave sterilization

3 Placement of FirstPlug®

A After restoration is seated and secured, clean channel and dry with air syringe

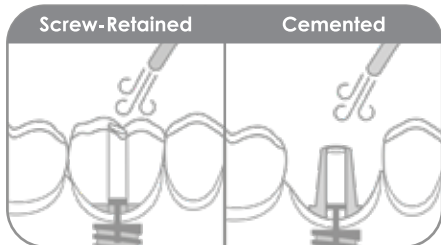

B Hold one end using cotton pliers. Using the Barrier Plugger™ or condenser, push into channel.

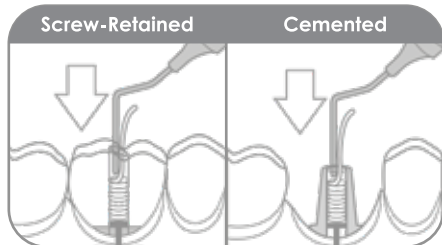

- Allow 2-3 mm space for filling material.
- Fill channel.
- One or more pieces can be used.

C Trim excess material using scissors. Dry cavity with air syringe.

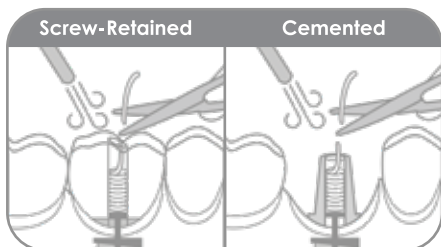

D Complete restorative filling process using standard protocols.

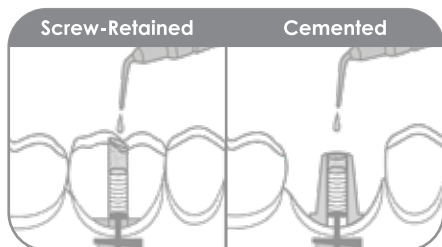

4 Removal of FirstPlug®

A Expose the screw access channel using standard protocols.

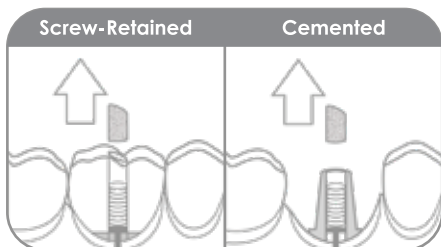

- Remove restorative filling material.
- Remove crown or drill through restoration.

B Using the Barrier Excavator™ or curette, pull out FirstPlug® material from channel.

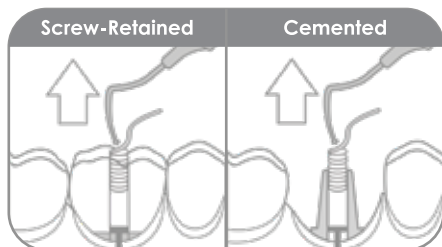

5 Instruments



A Barrier Plugger™



B Barrier Excavator™

Purchase at: www.35Newtons.com

6 Symbol Guide



Manufactured For:



Date of Manufacture



Catalogue Number



Batch Code



Consult Instructions for Use



Do Not Re-Use



Keep Away From Sunlight



Keep Dry



Temperature Limit



Non-Sterile



Use by Date

Federal law restricts this device to sale by or on order of a dentist.