

Complex HD Quick Start Guide

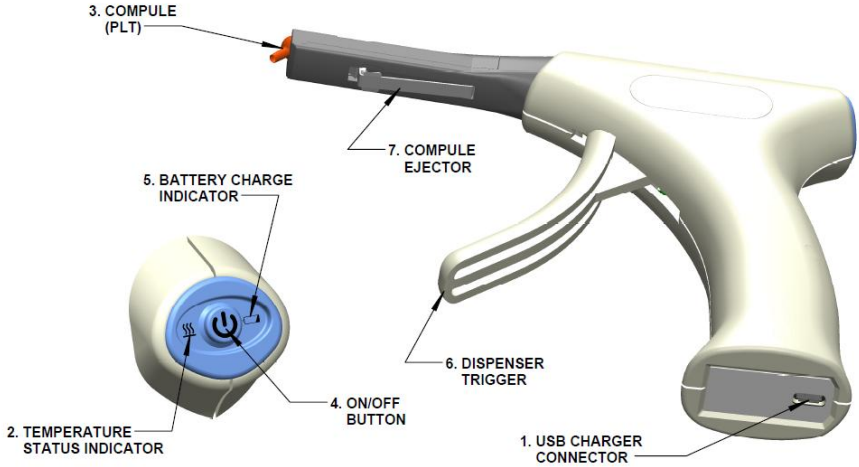

1. Connect the USB charger and fully charge the Complex prior to using the unit.
2. The Battery Charge Indicator will turn from blinking red to solid green. Disconnect the charger.
3. Insert a compule (PLT) into the opening in the barrel.
4. Start the heating cycle by pressing the ON/OFF button once.
5. Wait for the Temperature Status Indicator to turn from blinking yellow to solid green.
6. Dispense the composite by squeezing the trigger.
7. Remove the compule by pressing down on the raised portion of the compule ejector.
 - To heat additional compules insert a new compule (PLT) and press the ON/OFF button once.
 - To turn the unit off, press and hold the ON/OFF button for 1.5 seconds.
 - Refer to Instructions for Use for additional information and cleaning/disinfection/sterilizing instructions.