

# T8 SERIES

COMMERCIAL INDOOR LIGHTING

**WESTGATE**  
THE FUTURE IS HERE...AND IT'S QUITE BRIGHT!

- T8-EZ6-GS-4FT-15W-30K-C
- T8-EZ6-GS-4FT-15W-35K-C
- T8-EZ6-GS-4FT-15W-40K-C
- T8-EZ6-GS-4FT-15W-50K-C

Customer Name: \_\_\_\_\_  
Project Name: \_\_\_\_\_  
Note: \_\_\_\_\_ | Type: \_\_\_\_\_

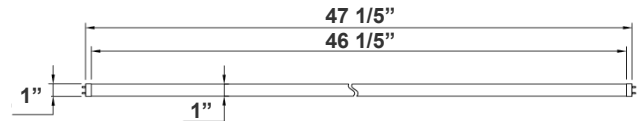

Crystal Glass T8 Tube switches from fluorescent tubes to LED, giving more cost efficiency by providing the same amount of lumen output with less energy consumption. Type B single end and Type A+B are designed for different retrofit projects. 350° beam angle glass The LED tube offers a soft and bright light distribution. Stable quality out of mass automated production.

47 1/5"(L) X 1" (D)

## Features

- Type A + B (Dual UL)
- Type A: With Existing Ballast - UL No. E366061
- Type B: Ballast Override (AC Direct), Connect One End or Both Ends (Dual Function) - UL No. E342884
- 5-Year Warranty
- Glass Lens

## Technical Specifications

### Electrical:

- Voltage: 120-277V; 50/60Hz AC
- Power Factor: >0.90
- THD: <20%
- Wattage: 15W
- Efficacy: 120 LPW

### Lighting:

- Dimming: Non Dimmable
- Total Lumens: 1800LM
- Color Temperatures: 3000K/3500K/4000K/5000K
- Color Rendering Index: CRI ≥ 80
- Beam Angle: 120°
- Rated life: 50,000 hrs

### Mechanical:

- Base Type: G13
- Glass tube: Better Transparency and Thermal Conductivity than Plastic
- Clear Glass
- Ambient Operating Temperature: -13°F to 113°F
- IP Rating: IP20 (Indoor)

### Applications:

- Direct Fit 4 T8 LED tubes do not burn out easily and provide bright and even lighting to schools, office spaces, retail stores and storage rooms.

### Other Models:

- 15W | 1800LM | T8-EZ6-GS-4FT-15W-30K-F
- 15W | 1800LM | T8-EZ6-GS-4FT-15W-35K-F
- 15W | 1800LM | T8-EZ6-GS-4FT-15W-40K-F
- 15W | 1800LM | T8-EZ6-GS-4FT-15W-50K-F



Phone: (877) 805-2252 | Fax: (877) 805-2252  
www.westgatemfg.com | www.westgatecontrols.co



## Photometrics: T8-EZ6-GS-4FT-15W

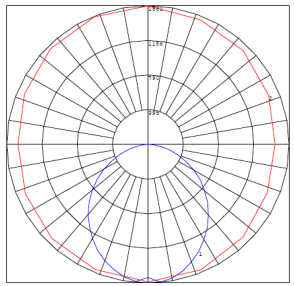
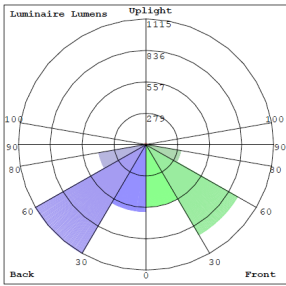

BUG Rating: B2-U2-G1

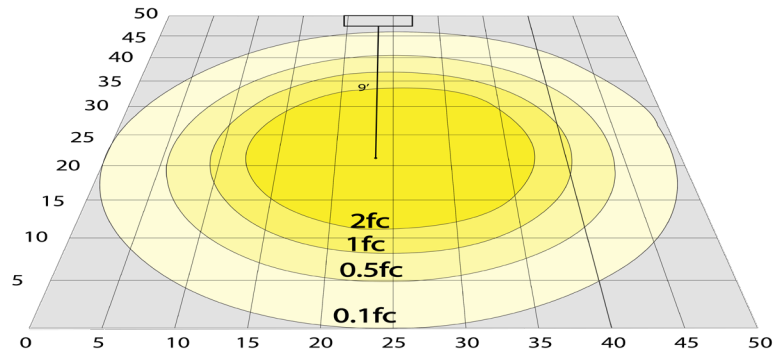

Area 50'x 50' Mounting Height: 9'

## Other Views:



Close-up View



Front View



Socket View

## Performance Table: T8-EZ6-GS-4FT-15W

MODEL NO.	Wattage	Voltage	Lumens	Color Temp.	BUG Rating	LPW
T8-EZ6-GS-4FT-15W-30K-C	15W	120-277V	1800LM	3000K	B2-U2-G1	120
T8-EZ6-GS-4FT-15W-35K-C	15W	120-277V	1800LM	3500K	B2-U2-G1	120
T8-EZ6-GS-4FT-15W-40K-C	15W	120-277V	1800LM	4000K	B2-U2-G1	120
T8-EZ6-GS-4FT-15W-50K-C	15W	120-277V	1800LM	5000K	B2-U2-G1	120

## Sample Ordering

**Model**      **Material**      **Size**      **Watt**      **Color Temp.**      **Lens Type**  
 T8   -   EZ6   -   GS   -   4FT   -   15W   -      -   C

30K = 3000K  
 35K = 3500K  
 40K = 4000K  
 50K = 5000K

## Example:

1. T8-EZ6-GS-4FT-15W-30K-C (FOR 15W 3000K T8 4FT TUBE LAMP 120-277V)

## WIRING DIAGRAM:

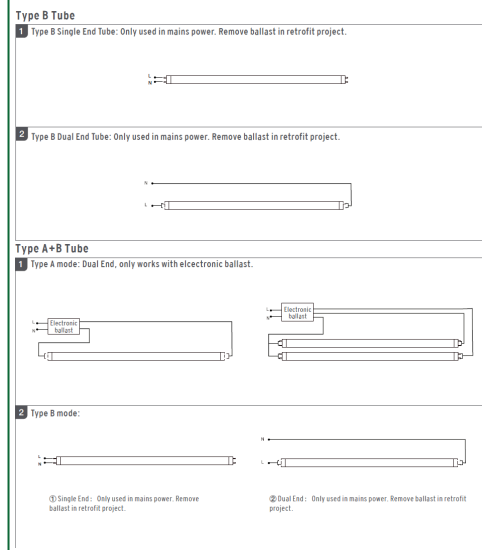

## Other Models: T8-EZ6-GS-4FT-15W-F (Frosted Model)



Close-up View

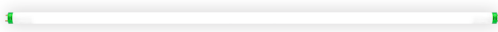

Front View



Socket View