

## Installation Instruction

WLWP Series

### IMPORTANT SAFETY PRECAUTIONS

**READ CAREFULLY AND UNDERSTAND COMPLETELY BEFORE INSTALLING OR OPERATING THE FIXTURE. Retain this instruction for future reference.**

To reduce the risk of death, personal injury or property damage from fire, electric shock, falling parts, cuts/abrasions, and other hazards please read all warnings and instructions included with and on the fixture box and all fixture labels. Installation of the fixture should be performed by a qualified licensed electrician.

Maintenance of the fixture should be performed by person(s) familiar with the fixture's construction and operation and any hazards involved. Regular maintenance programs are recommended.

DO NOT install damaged product! The fixture has been properly packed so that no parts should have been damaged during transit. Thoroughly inspect the fixture for any freight damage; freight damage should be reported to the delivery carrier.

#### WARNING: RISK OF ELECTRIC SHOCK

- The fixture must be wired in accordance with the National Electrical Code and all applicable local codes. Proper grounding is required for safety.
- All wiring connections should be capped with UL approved recognized wire connectors.
- Make sure power supply is OFF before installing or maintaining fixture.

#### WARNING: RISK OF FIRE

- DO NOT exceed maximum supply voltage or wattage marked on fixture label.
- DO NOT exceed fixture maximum ambient temperature or RH.
- DO NOT operate in close proximity to persons, combustible materials or substances affected by heat or drying.
- DO NOT place operating fixtures face down on a flush surface to avoid the risk of overheating or fire.

#### CAUTION: RISK OF INJURY

- ALWAYS wear gloves and safety glasses when removing luminaire from carton, installing, servicing or performing maintenance.
- AVOID direct eye exposure to the light source while it is on.

#### CAUTION: RISK OF PRODUCT DAMAGE

- HANDLE WITH CARE! Improper installing, operating and servicing might damage the product and void the warranty.
- DO NOT mount or support this fixture in a manner that can cut the outer jacket or damage wire insulation.
- DO NOT touch or clean individual LEDs or other electrical components as this can cause Electrostatic Discharge (ESD), damage the fixture, shorten fixture's life, or alter performance. Personal grounding equipment must be worn during all installation or servicing of the unit.
- CHECK for compatibility before wiring any control system for dimming, auto-sensing, or remote control that are not factory-wired.
- DO NOT restrict fixture ventilation and allow some volume of airspace around fixture.
- DO NOT cover fixture with insulation, foam or other material that will prevent convection or conduction cooling.
- NEVER perform maintenance or cleaning while fixture is energized; allow fixture to cool before handling.

### INTENDED APPLICATION

Input voltage: 120-277VAC, 50/60Hz; consult factory for 347VAC/480VAC option, CHECK PRODUCT LABEL RATINGS BEFORE ATTEMPTING TO INSTALL

Min. 90°C supply conductors

Operating temperature: -40°C to 40°C

Suitable for wet location

Mounting height: above 4 feet (1.2 meter)

### MOUNTING

This wall pack fixture is available in WALL MOUNT, and CONDUIT MOUNT installations.

- WALL MOUNT

1. Loosen screws on the right side of the fixture to open the fixture; disconnect the quick connector (between LED module and LED driver) inside the fixture and take off the front housing, see FIG.1.
2. Drill the stand-offs, see FIG. 2, on the back housing, route wires from junction box through knockout into back housing and secure back housing onto wall; make sure knockout matches junction box in the wall, see FIG. 3. For more secure installation, drill holes through the knockout template and mount back housing onto junction box in the wall, see FIG. 4.

CAUTION: Junction box gasket should create seal against wall surface. On uneven surfaces, you may use silicon sealant (not provided) to ensure tight seal against surface.

## Installation Instruction

### WLWP Series

3. Make wiring connection according to wiring selection. Refer to “WIRING” for more details.
4. Assemble front housing back onto back housing, reconnect quick connector and close the fixture, see FIG. 5. Use silicone sealant (not provided) all along the bottom of the fixture to ensure tight seal against surface.  
CAUTION: The front housing can only be reassembled at half open angle.  
CAUTION: Make sure all gaskets seated properly and all bolts and screws inserted and tightened firmly.

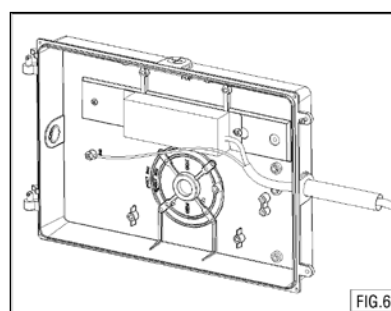
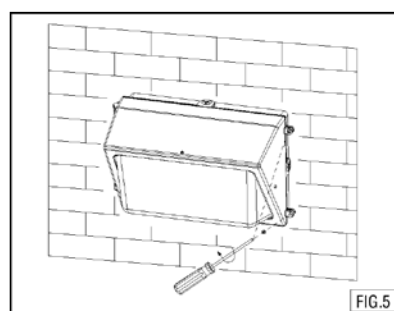
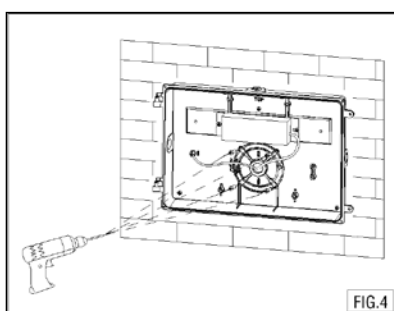
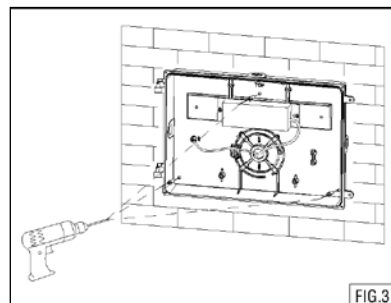
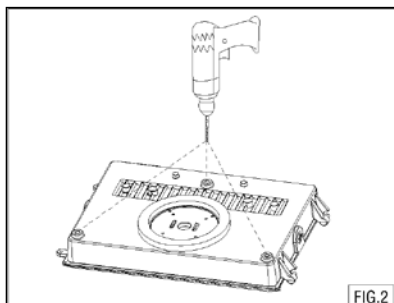
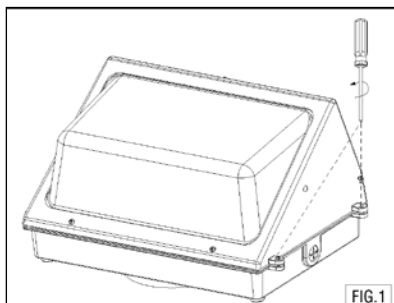

#### - CONDUIT MOUNT

1. Loosen screws on the right side of the fixture to open the fixture; disconnect the quick connector (between LED module and LED driver) inside the fixture and take off the front housing, see FIG.1;
2. Drill the stand-offs, see FIG. 2, on the back housing, remove the 1/2” plug from side of back housing and feed the conduit into back housing through knockout, see FIG. 6.  
For more secure installation, drill holes through the knockout template and mount back housing onto junction box in the wall, see FIG. 4.  
CAUTION: Junction box gasket should create seal against wall surface. On uneven surfaces, you may use silicon sealant (not provided) to ensure tight seal against surface.
3. Make wiring connection according to wiring selection. Refer to “WIRING” for more details.
4. Assemble front housing back onto back housing, reconnect quick connector and close the fixture, see FIG. 5. Use silicone sealant (not provided) all along the bottom of the fixture to ensure tight seal against surface.  
CAUTION: The front housing can only be reassembled at half open angle.  
CAUTION: Make sure all gaskets seated properly and all bolts and screws inserted and tightened firmly.

## WIRING

Wire input end of the LED driver to supply wires using appropriate wire nut according to wiring section.

CAUTION: Wire connections MUST be insulated and waterproof.

1. Connect the BLACK/BROWN lead to LINE (+) supply lead.
2. Connect the WHITE/BLUE lead to NEUTRAL/COMMON (-) supply lead.
3. Connect the GREEN leads of front housing and back housing to GROUND supply lead.
4. If any, connect PURPLE to 0-10V SIGNAL supply lead and PINK to 0-10V NEUTRAL/REFERENCE supply lead.

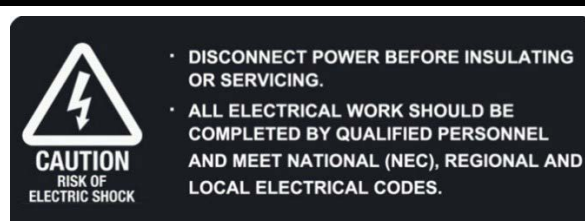

#### WIRING DIAGRAM

