

CIRCLE-Line: Semi-Circle Up/Down Wall Pack

3-CCT + 3-Power Selectable

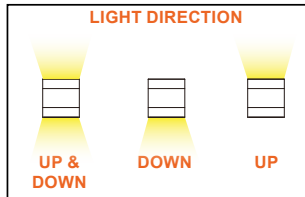

WATT	LUMENS
60	7,800
80	10,400
100	13,000

Detail Specifications

- Finish: Bronze, Custom finishes available
- IP Rating: Wet Location
- Impact Rating: IK08
- Beam Angle: Type III (Standard)
- Chip: SMD 2835, R9 >50, CRI >80
- Wattage:
 - Up Light: 20W
 - Downlight: 80W
- BUG: B3-U2-G2
- Operating Temperature: -40° - 122° F
- Lens: Clear acrylic with optics
- Average life (L70) of 70,000 hours

Applications:

- Walkways & Pathways
- Parking Lots
- Hospitality, Multi-Family
- Outdoor Corridors
- Residential, Commercial and Industrial

Product Information:

- Sturdy die-cast aluminum housing finished with corrosion free powder coat
- Uplight can be turned off
- Full Cut-Off Dark Sky Compliant With Uplight Off
- Photocell is included with an on/off switch
- Instant-On to full brightness
- Select-n-Switch Technology: 3-CCT + 3-Power Selectable

Driver Options:

- UNV: 120-277V 0-10V Dimmable
- Built in 6Kv Surge Protector
- THD: <20% (+/-5% tolerance), PF >0.9, 50/60Hz

Mounting & Installation:

- Five 1/2" knockouts: 1 one each side for convenient installation

Certifications:

- UL Listed for USA and CA
- DLC Listed
- ROHS Compliant
- Approved for CA T24
- 5 Year Limited Warranty
- FCC CFR 47, GCC Part 15, Subpart B:2017

Series	Finish ¹	Voltage	Photocell	Optic	Sensor ²	Emergency	Surge Protector
LED-WPUD-SC-3P100-TRI- 100/80/60W	BZ Bronze (Standard)	(blank) 120-277V	-PC Photocell is included. Easy quick disconnect. (PC-3/4-3PIN-LV)	(blank) Type III T2 Type II T4 Type IV	(blank) No Sensor BMS Bi-Level Motion + Daylight Sensor (S-BMS-EXT-1) BMSBT Bi-Level Motion + Daylight Sensor -Blue- tooth Control- (S-BMS-EXT-1-BT)	(blank) No Emergency EMB Emergency Backup	(blank) 6KV Built in 20KV 20KV Surge Protector

1. Standard quickship is bronze. Other colors are made to order

2. Sensors require remote for programming

Optional Accessories (Order Separately)

Remote for Sensors

S-LINE-R
S-Line
Remote

Specs and model numbers are subject to change with or without notice.

FEATURES

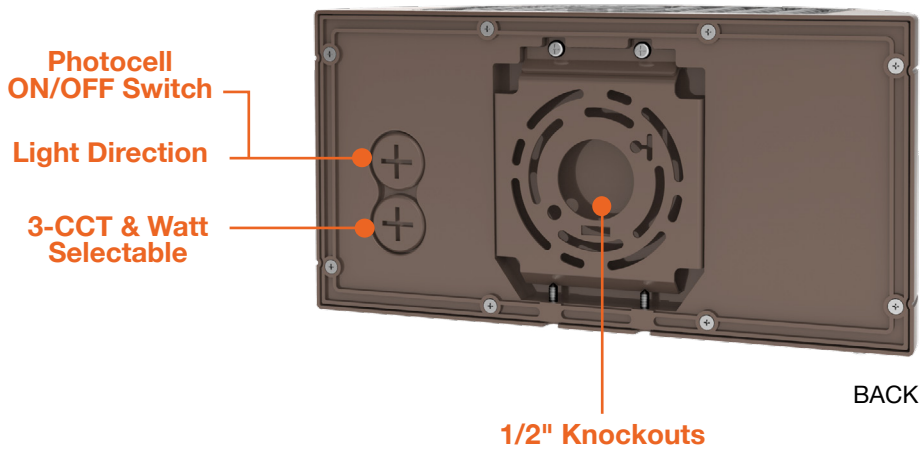
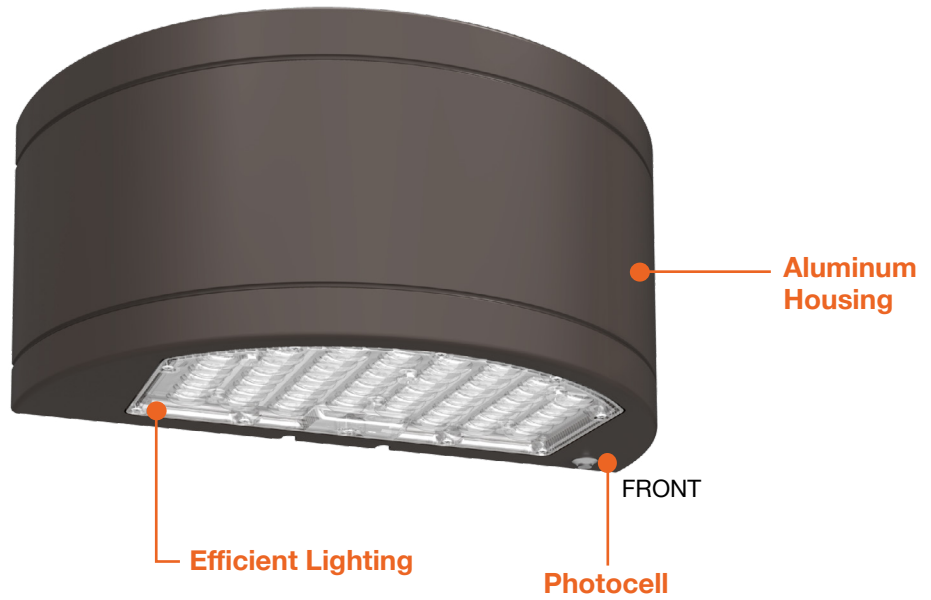
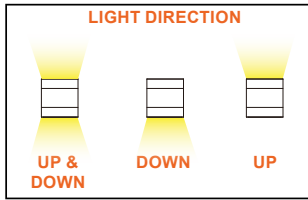

DIMENSIONS

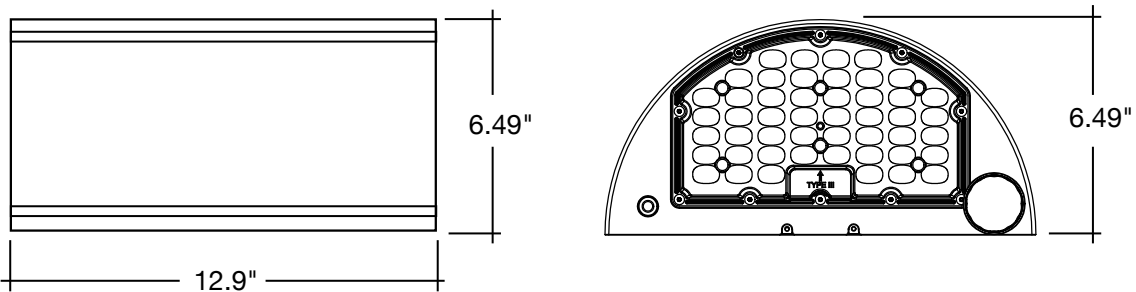

Specs and model numbers are subject to change with or without notice.



S-LINE-R



S-BMS-EXT-1
S-BMS-EXT-1-BT

WALL PACK

Model	Voltage	Watts	Lumens	Color	CRI
LED-WPUD-SC-3P100-TRI-BZ-PC	120-347V	100/80/60w	13,000/10,400/7,800	50/40/30k	>80

REMOTE CONTROL

Accessory Model	Description
S-LINE-R	Remote for S-LINE Series Sensors

HB-LINE-SENSORS

Model	Item Description	Voltage	Watts
S-BMS-EXT-1	S-Line: Bi Level Motion Sensor w/ Daylight Harvesting, Ideal for use with LED WALLPACKS. 12V Aux REQD. (Remote Required)	12V	<1w
S-BMS-EXT-1-BT	S-Line: Bi Level Motion Sensor w/ Daylight Harvesting, Ideal for use with Wallpacks. 12V Aux REQD. (Remote Required)	12V	<1w

Specs and model numbers are subject to change with or without notice.