

CIRCLE-Line: Semi-Circle Wall Pack

3-CCT + 3-Power Selectable



Detail Specifications

- Finish: Bronze, Custom finishes available
- IP Rating: Wet Location
- Impact Rating: IK08
- Beam Angle: Type III (Standard)
- Chip: SMD 2835, R9 >50, CRI >80
- BUG: B3-U2-G2
- Operating Temperature: -40° - 122° F
- Lens: Clear acrylic with optics
- Average life (L70) of 70,000 hours

Applications:

- Walkways & Pathways
- Parking Lots
- Hospitality, Multi-Family
- Outdoor Corridors
- Residential, Commercial and Industrial

Product Information:

- Sturdy die-cast aluminum housing finished with corrosion free powder coat
- Full Cut-Off Dark Sky Compliant
- Photocell is included with an on/off switch
- Instant-On to full brightness
- Select-n-Switch Technology: 3-CCT + 3-Power Selectable

Driver Options:

- UNV: 120-277V 0-10V Dimmable
- Built in 6Kv Surge Protector
- THD: <20% (+/-5% tolerance), PF >0.9, 50/60Hz

Mounting & Installation:

- Five 1/2" knockouts: 1 one each side for convenient installation

Certifications:

- UL Listed for USA and CA
- DLC Listed
- ROHS Compliant
- Approved for CA T24
- 5 Year Limited Warranty
- FCC CFR 47, GCC Part 15, Subpart B:2017

WATT	LUMENS
48	6,480
64	8,640
80	10,800

Series

LED-WPFC-SC-3P80-TRI
80/64/48w

Finish¹

BZ Bronze (Standard)
BL¹ Black
WH¹ White
GRY¹ Gray
CS¹ Custom Color

Voltage

(blank)
120-277V

Photocell

-PC
Photocell is included. Easy quick disconnect. (PC-3/4-3PIN-LV)

Sensor²

(blank) No Sensor
BMS Bi-Level Motion + Daylight Sensor (S-BMS-EXT-1)
BMSBT Bi-Level Motion + Daylight Sensor -Blue-tooth Control- (S-BMS-EXT-1-BT)

Emergency

(blank) No Emergency
EMB Emergency Backup

Surge Protector

(blank) 6KV Built in
20KV 20KV Surge Protector

Optional Accessories (Order Separately)

Remote for Sensors

S-LINE-R
S-Line Remote

1. Standard quickship is bronze & black. Other colors are custom finishes

2. Sensors require remote for programming

Specs and model numbers are subject to change with or without notice.

FEATURES



DIMENSIONS

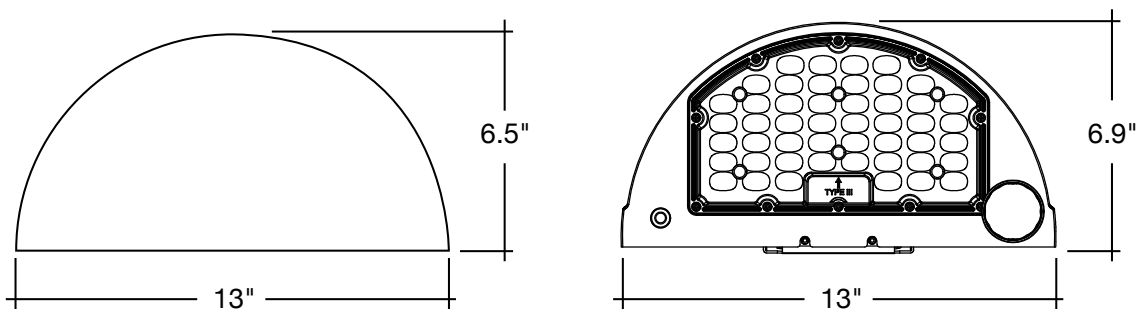

Specs and model numbers are subject to change with or without notice.

CIRCLE-Line: Semi-Circle Wall Pack

3-CCT + 3-Power Selectable



S-LINE-R



S-BMS-EXT-1
S-BMS-EXT-1-BT

WALL PACK

Model	Voltage	Watts	Lumens	Color	CRI
LED-WPFC-SC-3P80-TRI-BZ-PC	120-347V	80/64/48w	10,800/8,640/6,480	50/40/30k	>80

REMOTE CONTROL

Accessory Model	Description
S-LINE-R	Remote for S-LINE Series Sensors

HB-LINE-SENSORS

Model	Item Description	Voltage	Watts
S-BMS-EXT-1	S-Line: Bi Level Motion Sensor w/ Daylight Harvesting, Ideal for use with LED WALLPACKS. 12V Aux REQD. (Remote Required)	12V	<1w
S-BMS-EXT-1-BT	S-Line: Bi Level Motion Sensor w/ Daylight Harvesting, Ideal for use with Wallpacks. 12V Aux REQD. (Remote Required)	12V	<1w

Specs and model numbers are subject to change with or without notice.