

WARRIOR STRENGTH

OWNER'S MANUAL

Warrior 801

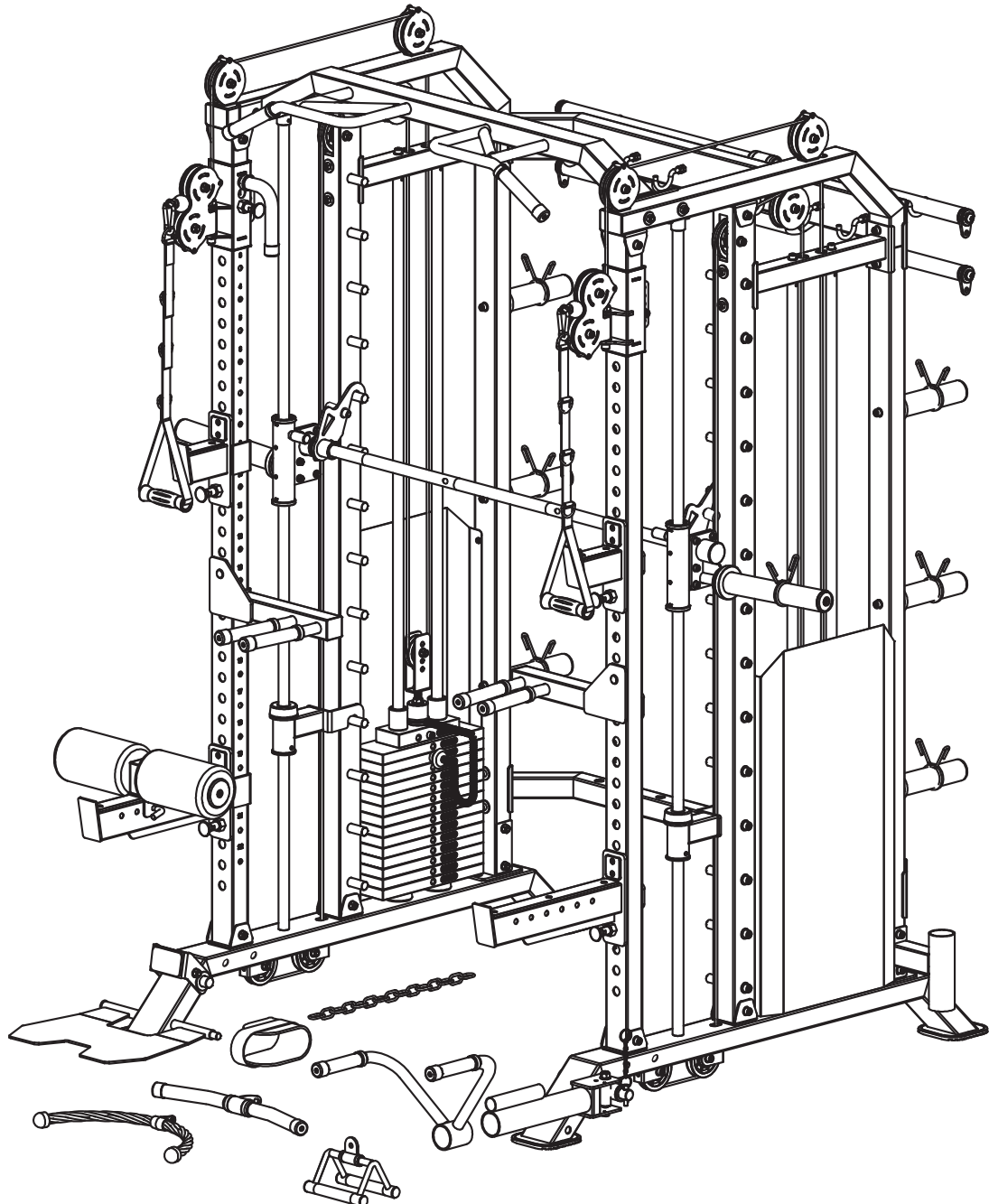

CAUTION!

Read all precautions and instructions in this manual before using this equipment.

20230424-V1.0

TABLE OF CONTENTS

BEFORE YOU BEGIN.....	1
IMPORTANT SAFETY NOTICES.....	2
ASSEMBLED DIMENSION.....	3
HARDWARE PACK.....	4
ASSEMBLY INSTRUCTIONS.....	8
EXPLODED DIAGRAM.....	24
PARTS LIST.....	25

BEFORE YOU BEGIN

Thank you for selecting the Warrior 801. For your safety and benefit, read this manual carefully before using the machine. As a manufacturer, we are committed to provide you complete customer satisfaction.

IMPORTANT SAFETY NOTICE

PRECAUTIONS

This exercise machine is built for optimum safety. However, certain precautions apply whenever you operate a piece of exercise equipment. Be sure to read the entire manual before you assemble or operate your machine. In particular, note the following safety precautions:

1. **Keep children and pets away from the machine at all times. DO NOT leave children unattended in the same room with the machine.**
2. Only one person at a time should use the machine.
3. If the user experiences dizziness, nausea, chest pain, or any other abnormal symptoms, STOP the workout at once. CONSULT A PHYSICIAN IMMEDIATELY.
4. Position the machine on a clear, leveled surface. DO NOT use the machine near water or outdoors.
5. Keep hands away from all moving parts.
6. Always wear appropriate workout clothing when exercising. DO NOT wear robes or other clothing that could become caught in the machine. Running or aerobic shoes are also required when using the machine.
7. Use the machine only for its intended use as described in this manual. DO NOT use attachments not recommended by the manufacturer.
8. Do not place any sharp object around the machine.
9. Disabled person should not use the machine without a qualified person or physician in attendance.
10. Before using the machine to exercise, always do stretching exercises to properly warm up.
11. Never operate the machine if the machine is not functioning properly.

WARNING: BEFORE BEGINNING ANY EXERCISE PROGRAM, CONSULT YOUR PHYSICIAN. THIS IS ESPECIALLY IMPORTANT FOR INDIVIDUALS OVER THE AGE OF 35 OR PERSONS WITH PRE-EXISTING HEALTH PROBLEMS. READ ALL INSTRUCTIONS BEFORE USING ANY FITNESS EQUIPMENT. WE ASSUME NO RESPONSIBILITY FOR PERSONAL INJURY OR PROPERTY DAMAGE SUSTAINED BY OR THROUGH THE USE OF THIS PRODUCT.

SAVE THESE INSTRUCTIONS.

Assembled Dimension: 1990mm x 1700mm x2300mm

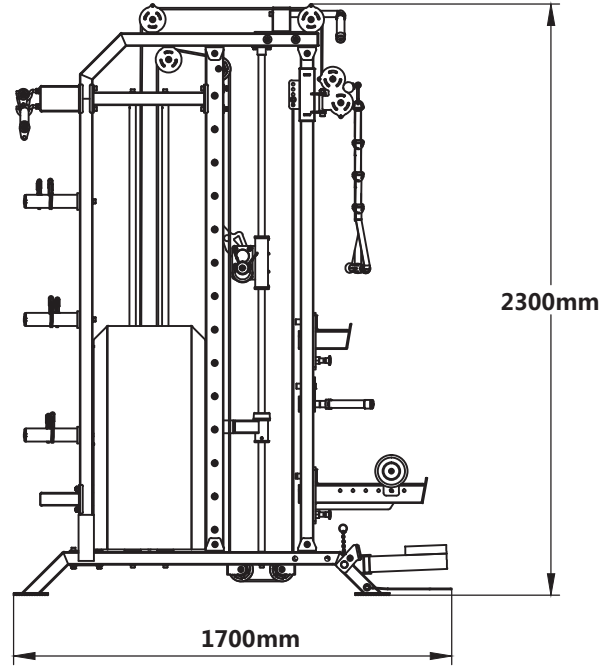
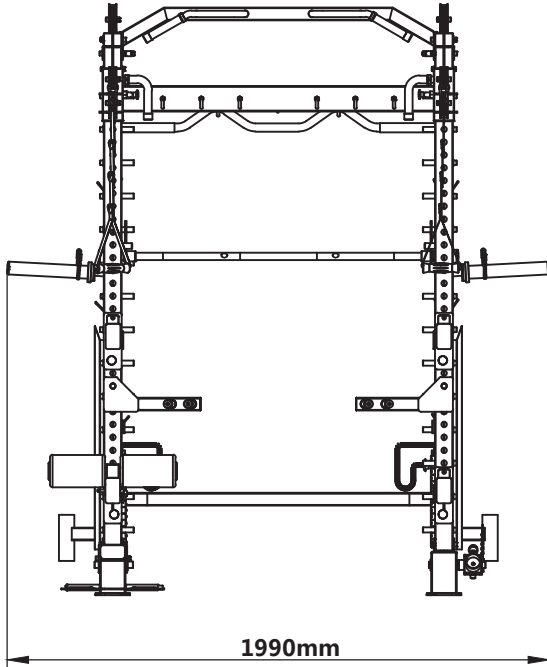

MACHINE

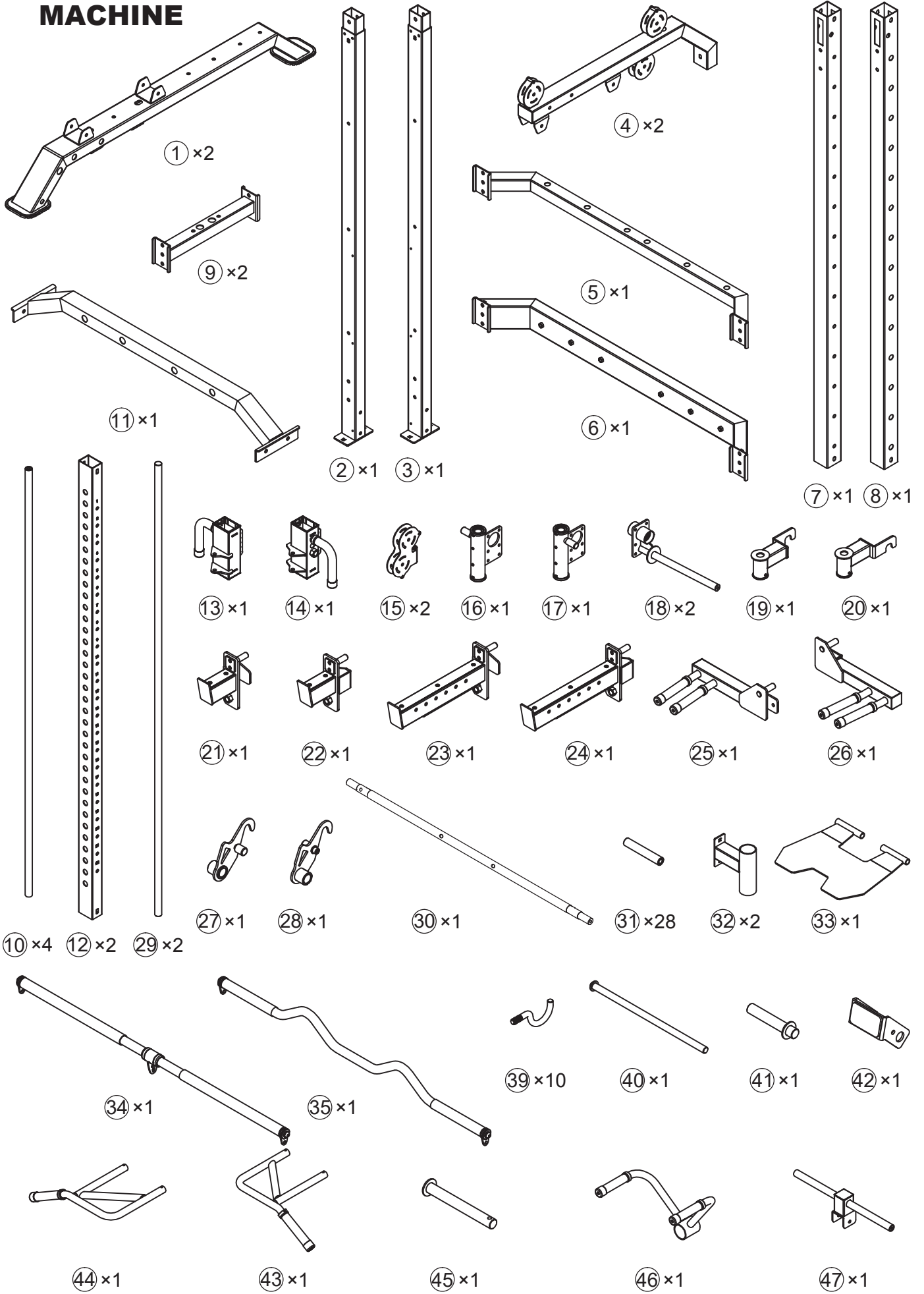

MACHINE

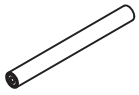

④⑧ × 6

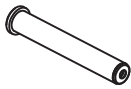

⑤⑦ × 2



⑤⑩ × 6

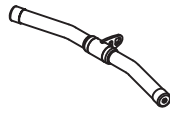

⑤⑨ × 1



⑤③ × 1



⑤④ × 1

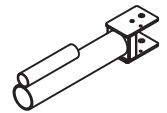

⑤⑤ × 1



⑤⑥ × 2



⑤⑦ × 1



⑥② × 2



⑥③ × 2



⑥⑥ × 1



⑥⑨ × 1



⑦⑦ × 2



⑦⑩ × 2



⑦⑨ × 1



⑦⑤ × 6



⑦⑥ × 2



⑦⑦ × 2



⑦⑧ × 6



⑧③ × 2



⑧⑤ × 16



⑧⑥ × 2

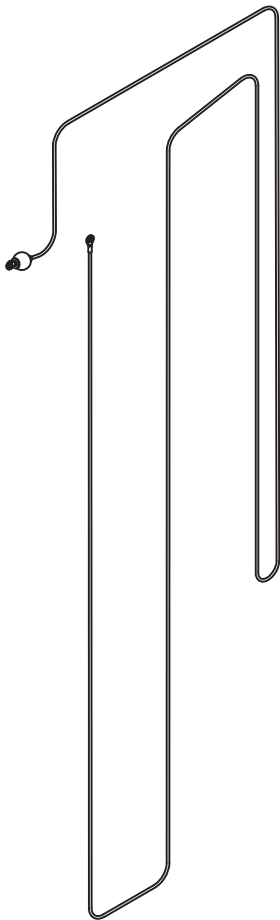

⑧④ × 2

MACHINE

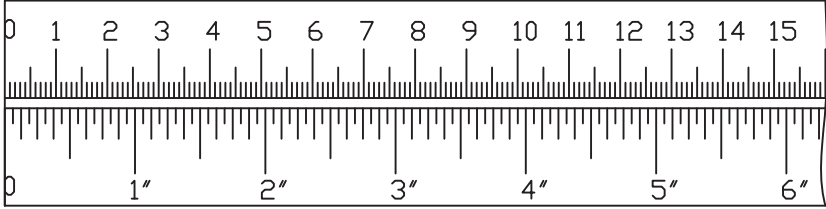
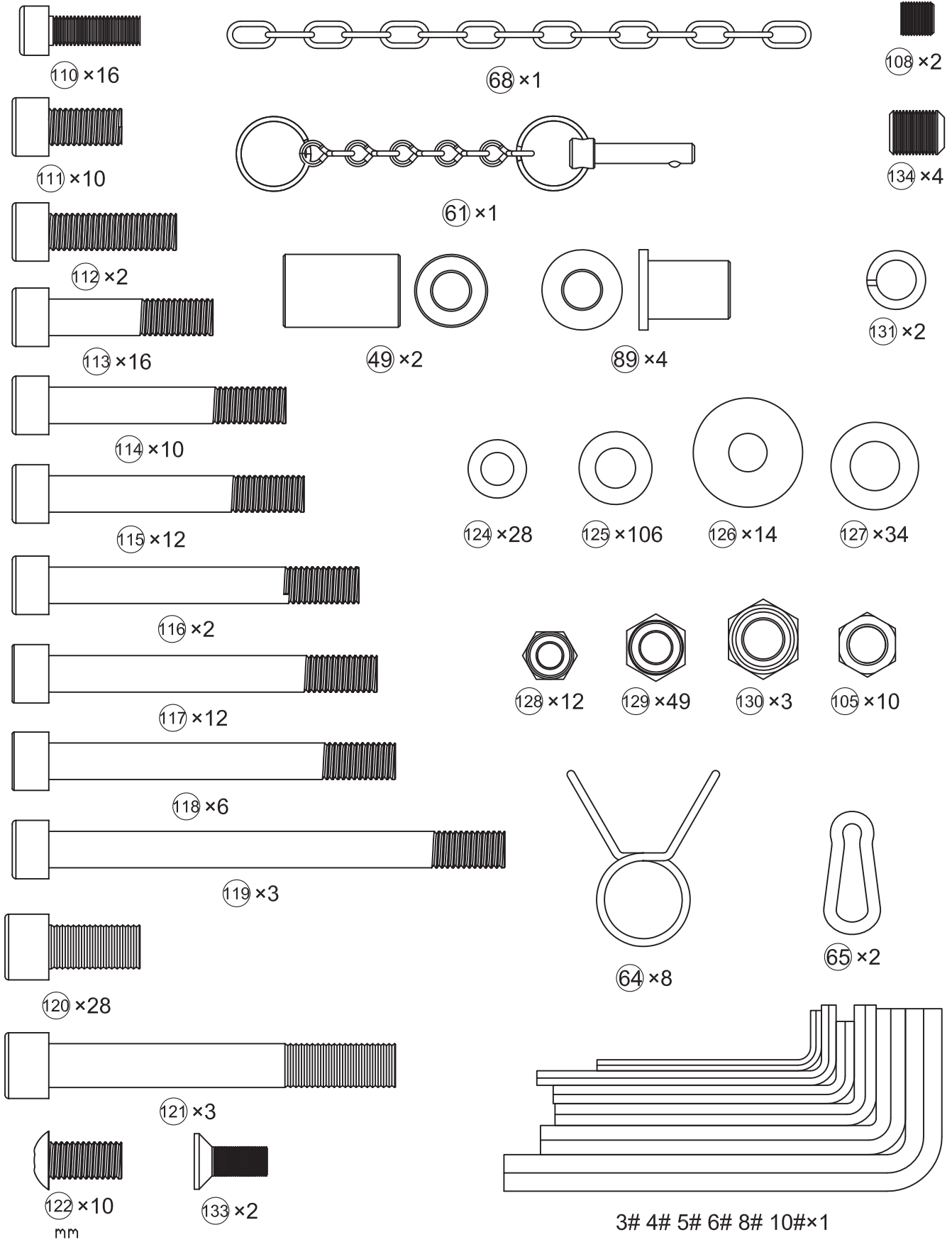

WEIGHT STACK

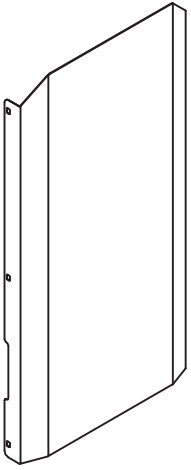

135 x 2

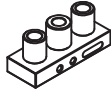

136 x 2

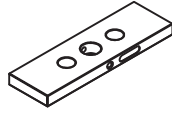

137 x 28



138 x 2



139 x 2



140 x 2



144 x 2

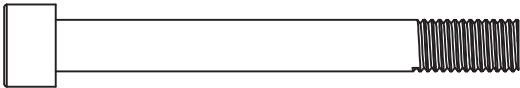

117 x 2



129 x 2



141 x 2



142 x 12



143 x 12

mm

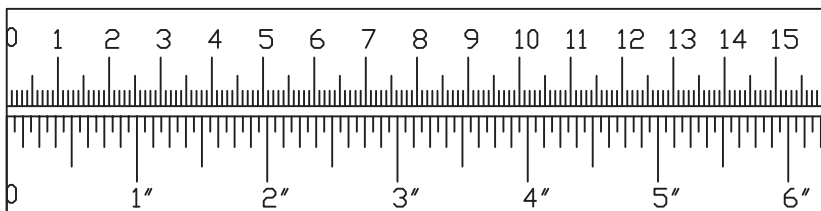

①15		x8	M10x70	①26		x4	Φ30xΦ10.5
①25		x12	Φ10				
①29		x8	M10				

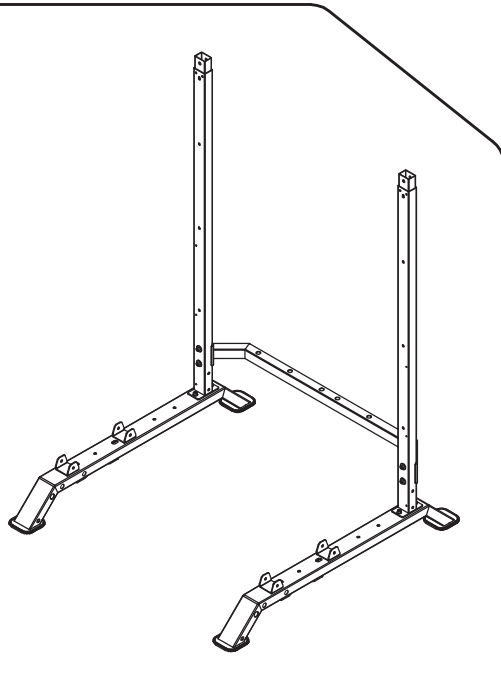
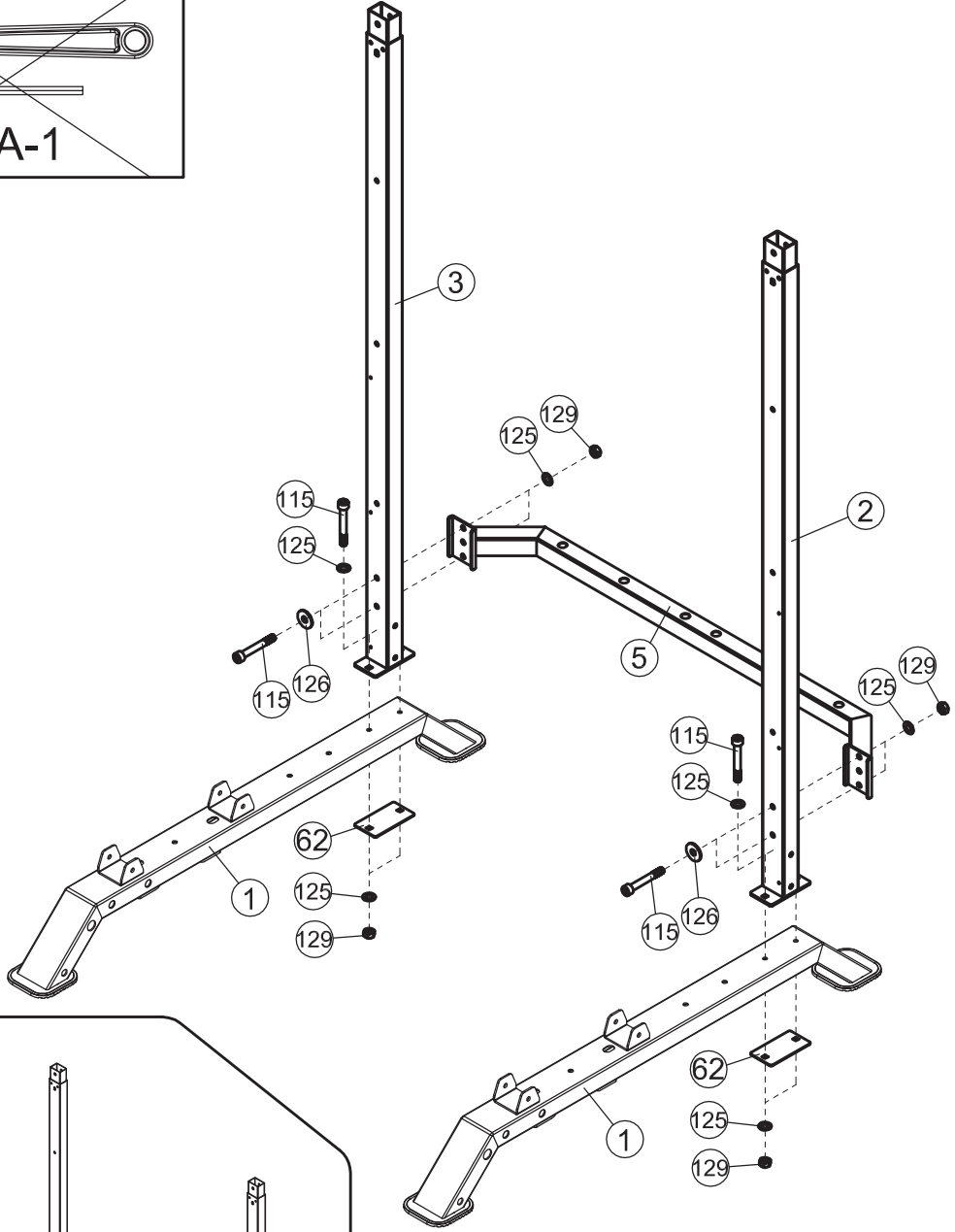
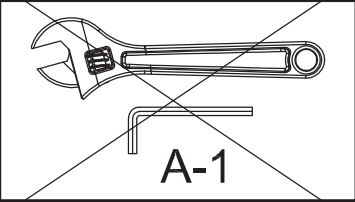

118

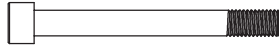

x4 M10x95

125







x8 Φ10

129

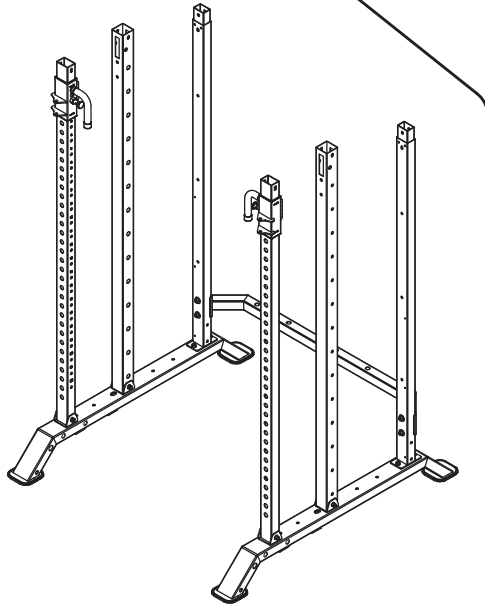
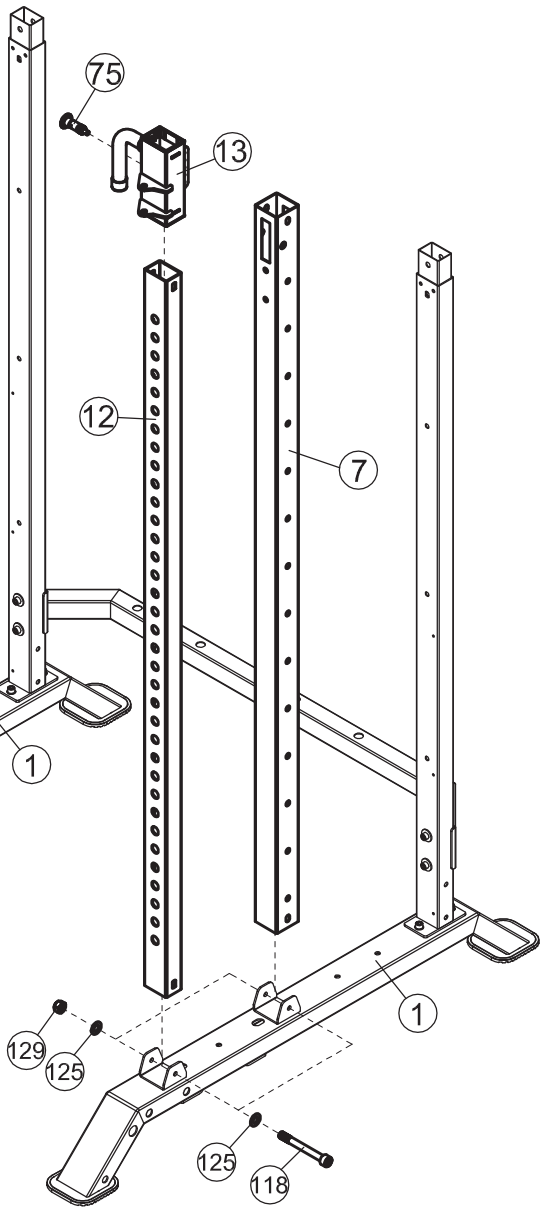
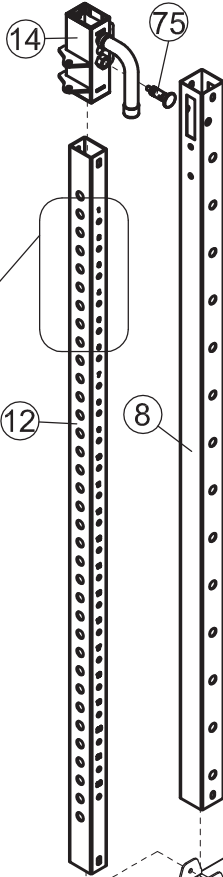
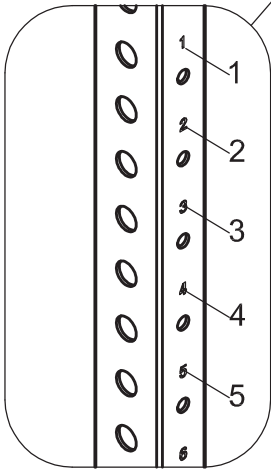
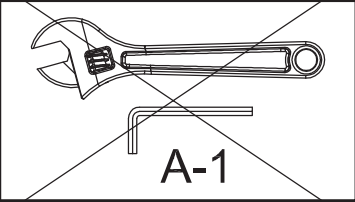

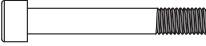



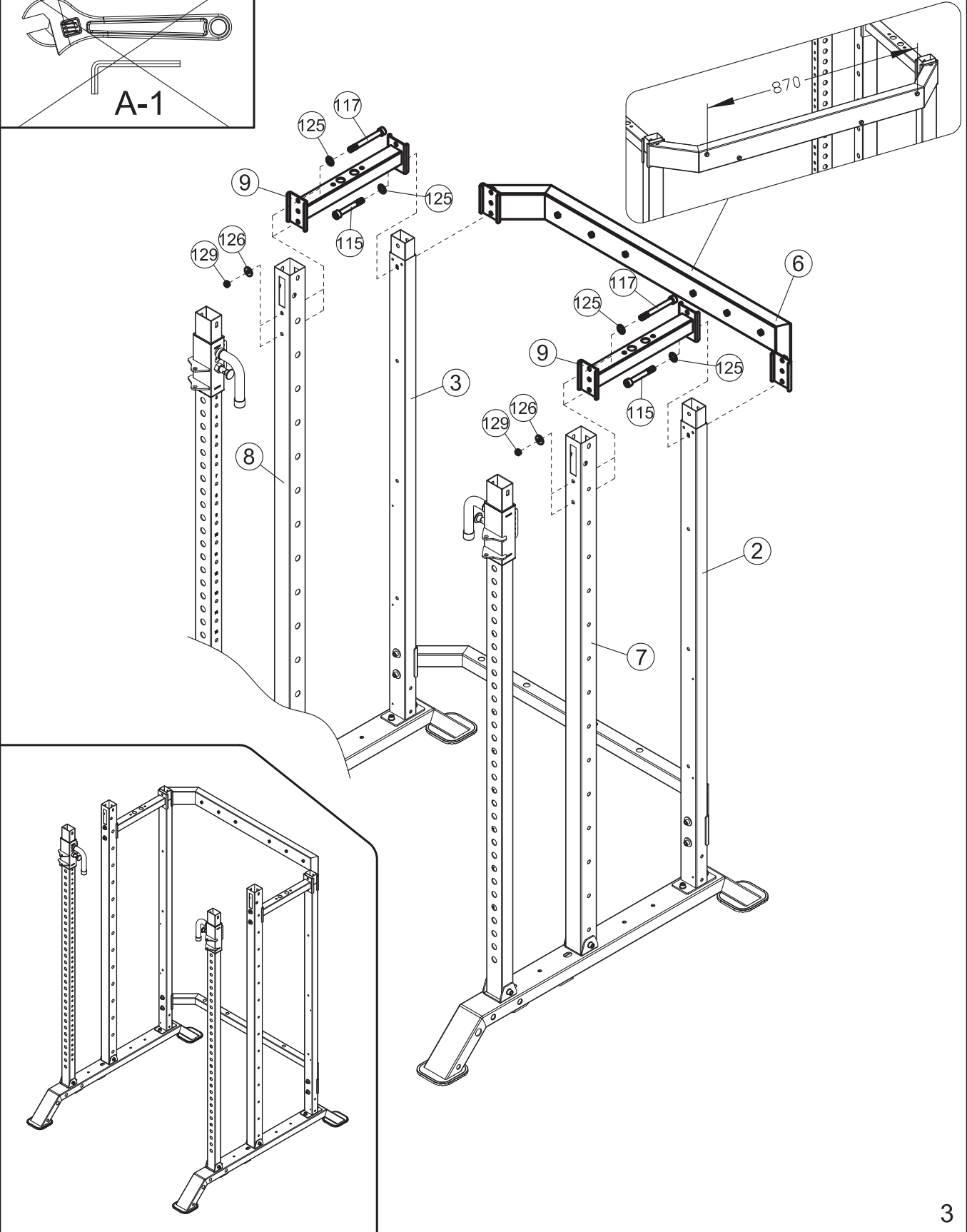
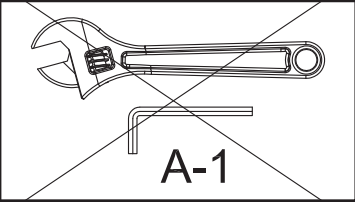

x4 M10

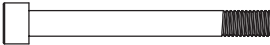

- | | | | | | | | |
|-----|---|----|--------|-----|--|----|-----------|
| ①15 |  | x2 | M10x70 | ①26 |  | x4 | Φ30xΦ10.5 |
| ①17 |  | x4 | M10x90 | ①25 |  | x6 | Φ10 |
| ①29 |  | x4 | M10 | | | | |

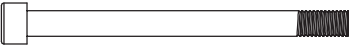

- | | | | | | | | |
|------|---|----|---------|------|--|-----|--------------|
| ①115 |  | x2 | M10x70 | ①125 |  | x10 | Φ10 |
| ①118 |  | x2 | M10x95 | ①129 |  | x4 | M10 |
| ①119 |  | x2 | M10x125 | ④49 |  | x2 | Φ20xΦ10.2x32 |

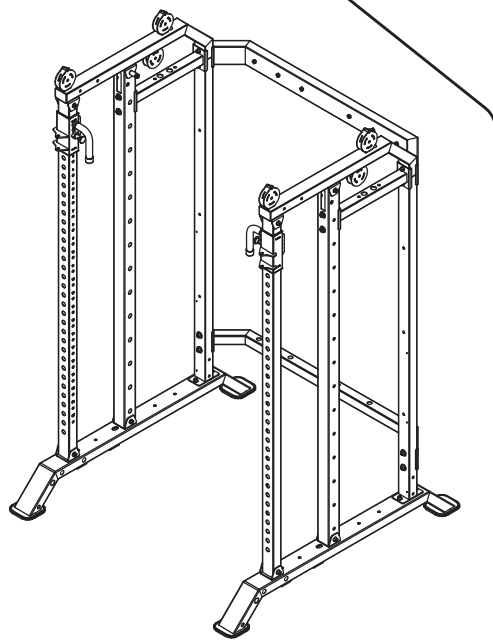
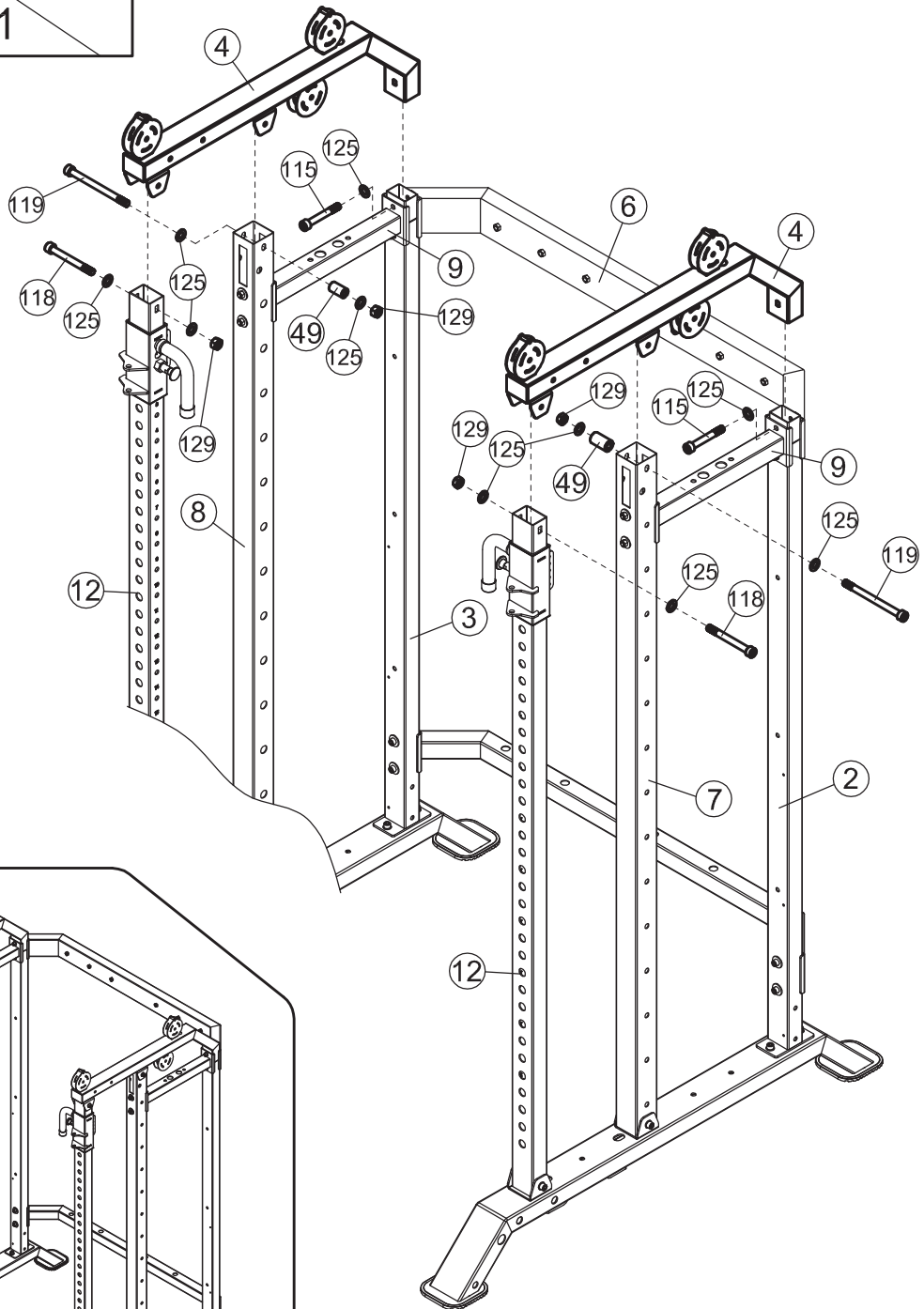
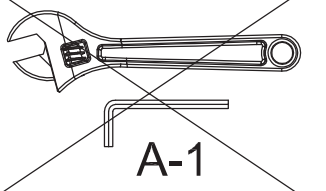

120

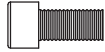

x28 M12x25

127



x28 Φ12

105





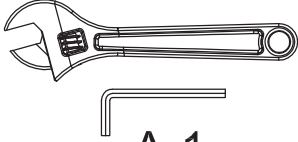

x10 M10

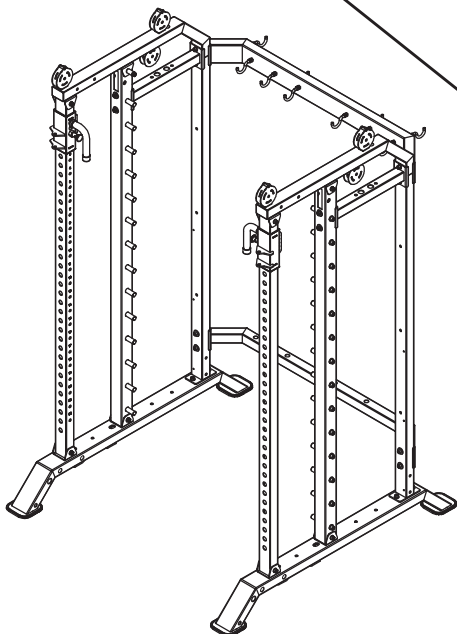
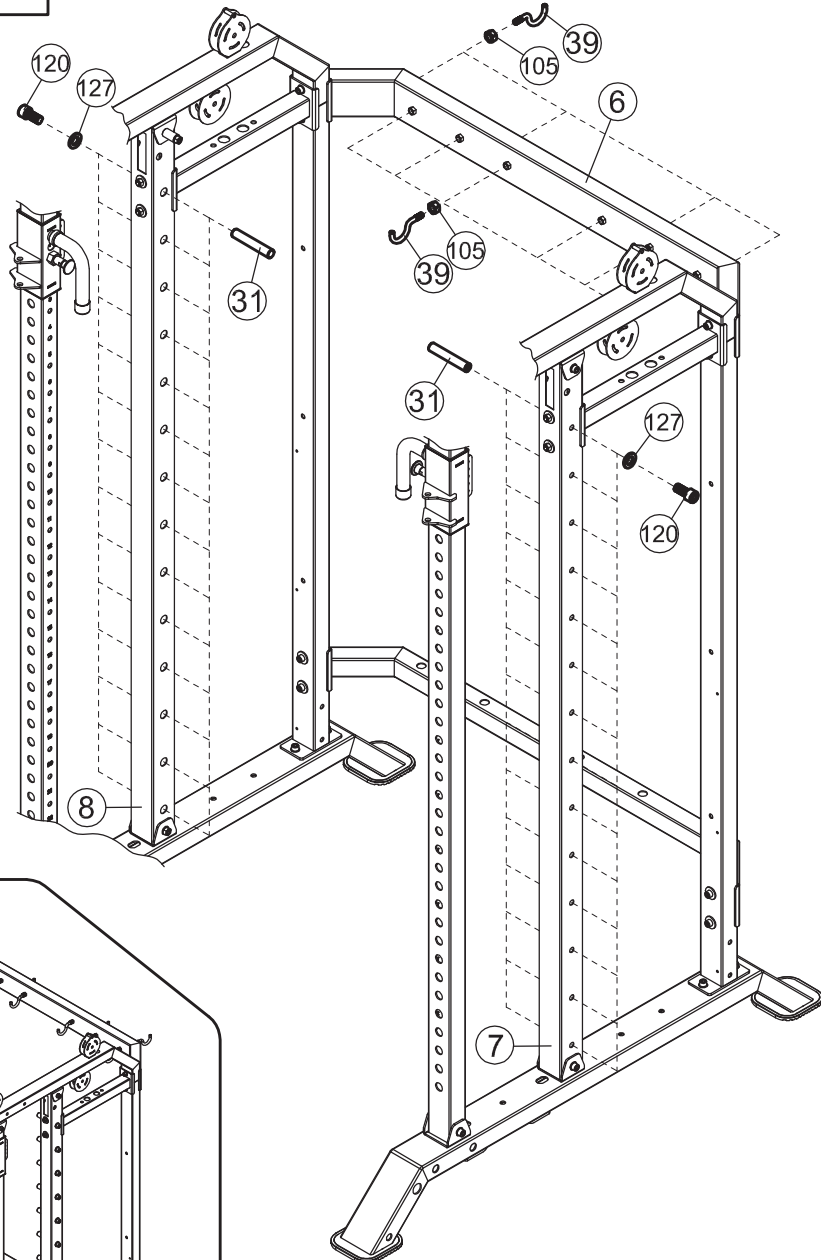

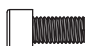
A-1

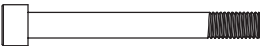



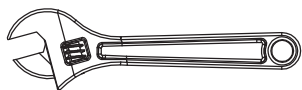

- | | | | | | | | |
|-------|---|----|--------|-------|--|----|-----------|
| (111) |  | x4 | M10x20 | (126) |  | x4 | Φ30xΦ10.5 |
| (125) |  | x8 | Φ10 | (117) |  | x4 | M10x90 |
| (129) |  | x4 | M10 | | | | |

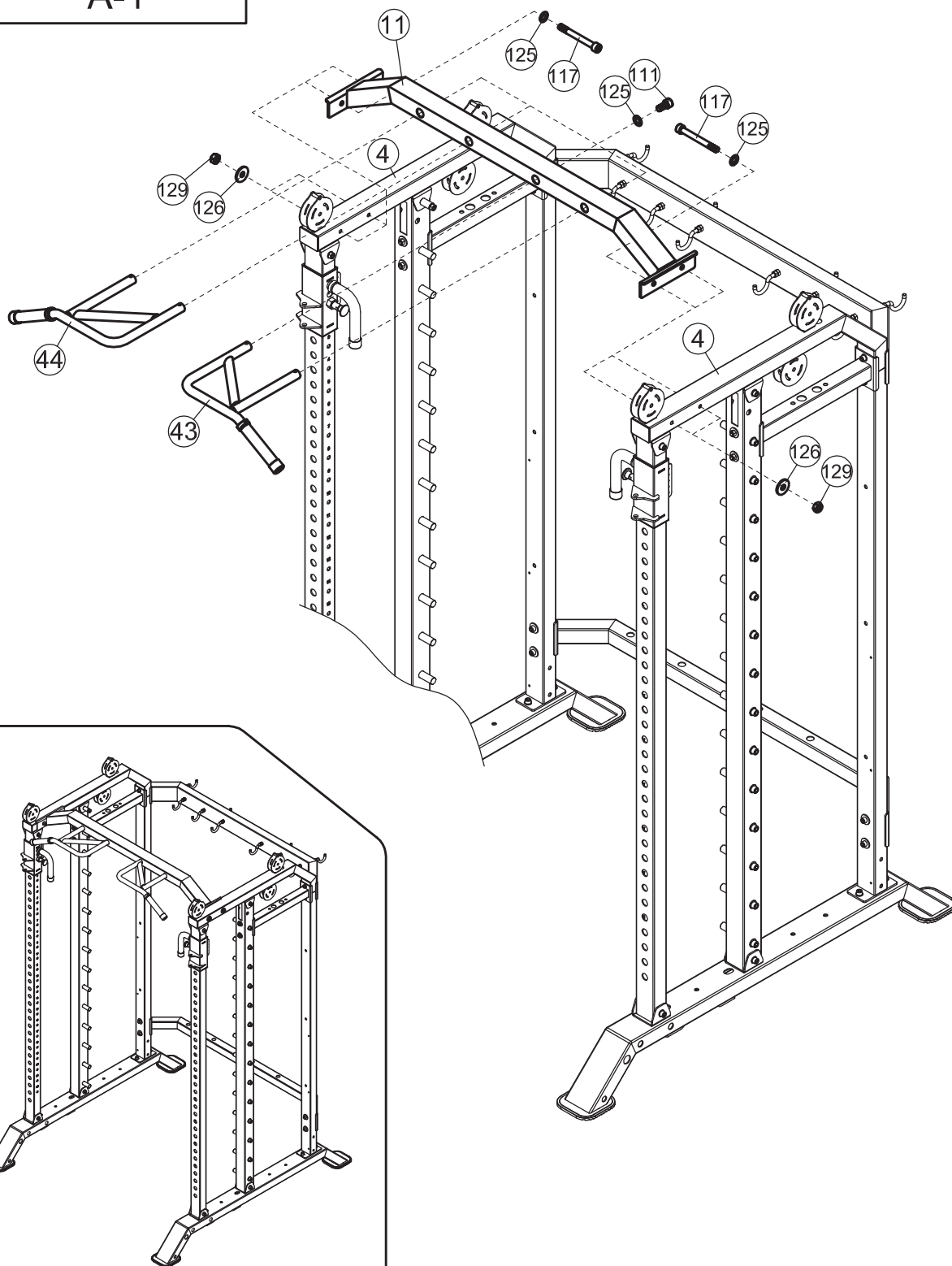

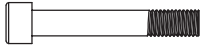
A-1





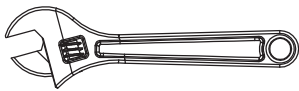

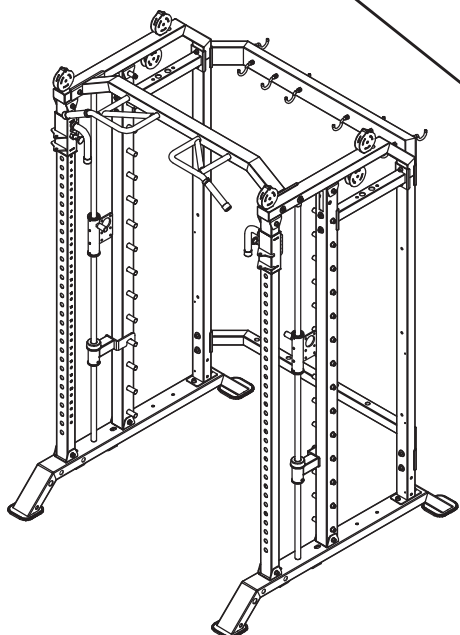
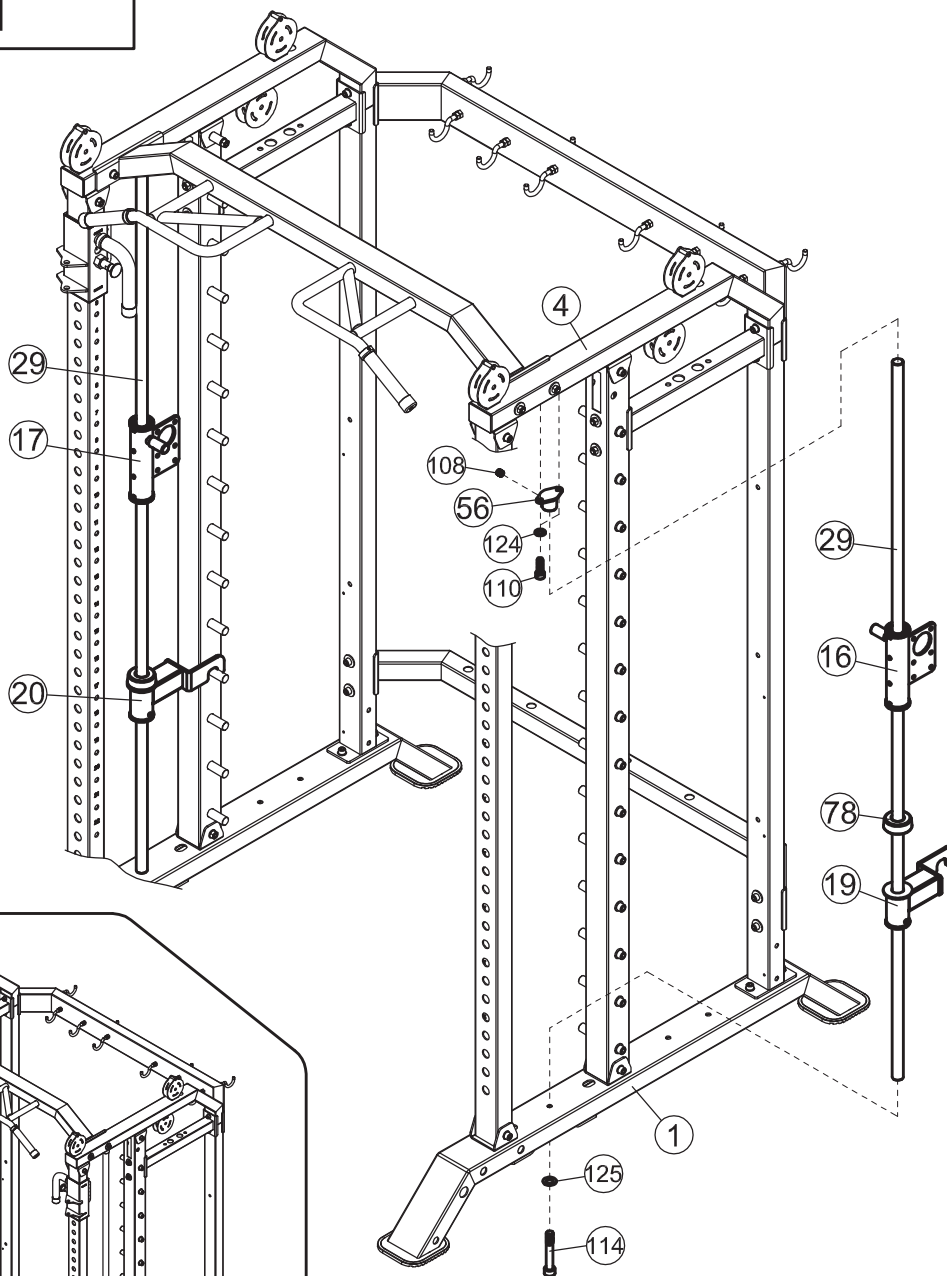

- | | | | | | | | |
|------|---|----|--------|-----|--|----|------|
| ①114 |  | x2 | M10x65 | ①24 |  | x4 | Φ8 |
| ①25 |  | x2 | Φ10 | ①08 |  | x2 | M6x6 |
| ①10 |  | x4 | M8x25 | | | | |



A-1







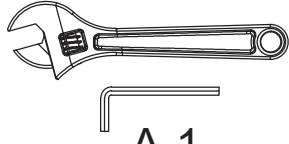

- (122)  ×4 M10×20
- (131)  ×2 Φ10
- (110)  ×12 M8×25
- (124)  | ×24 Φ8

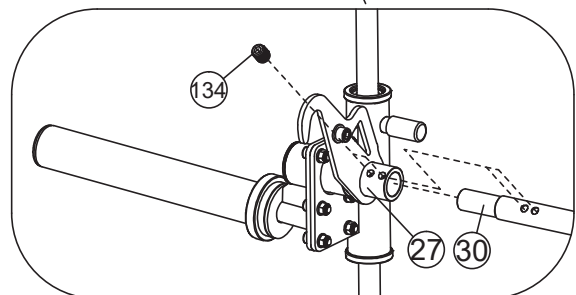
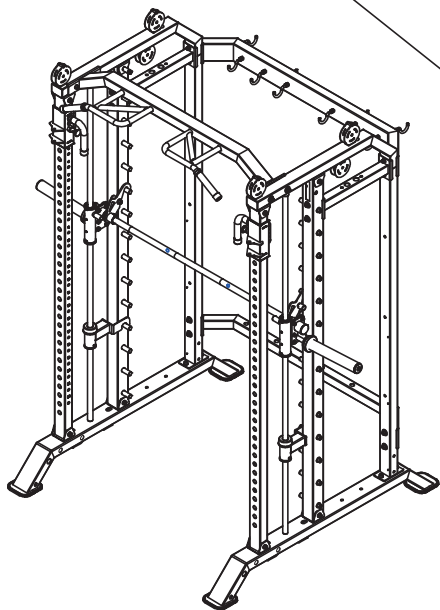
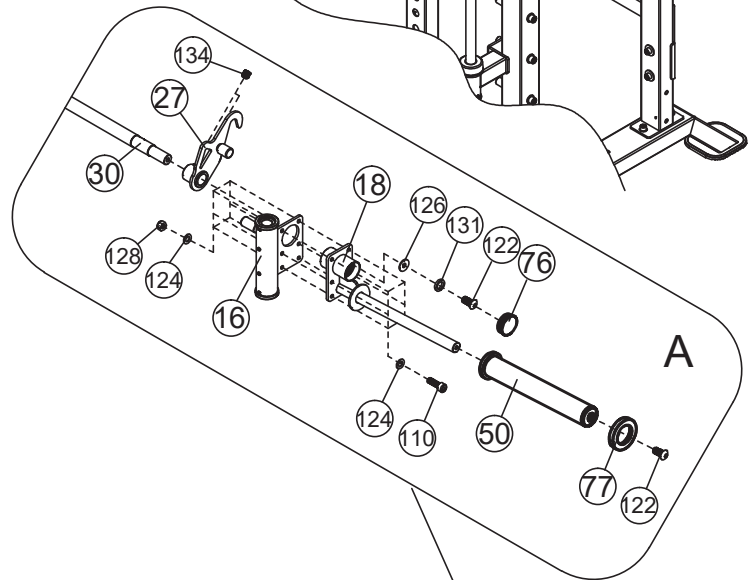
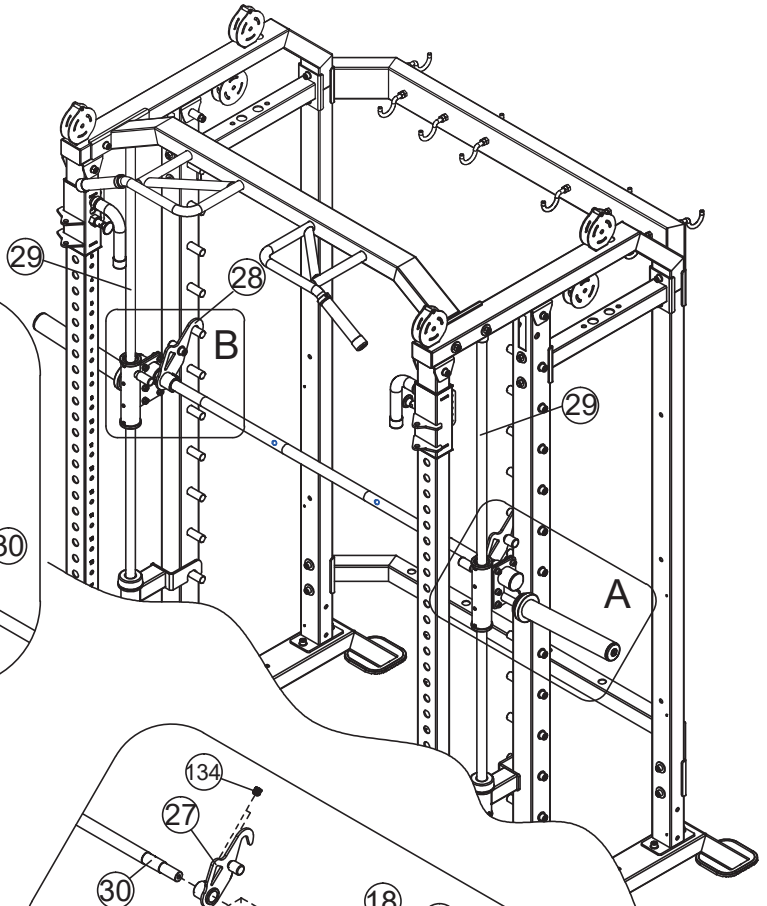
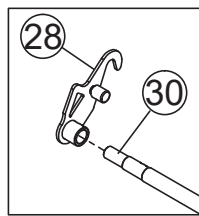
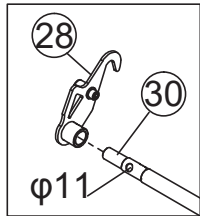
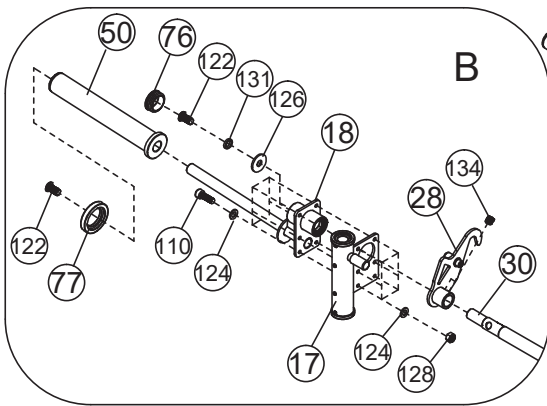
- (134)  ×4 M8×10
- (128)  | ×12 M8
- (126)  | ×2 Φ30×Φ10.5

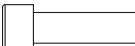
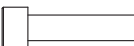

A-1

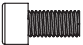

121		x2	M12x95	117		x4	M10x90
127		x4	Φ12	129		x4	M10
130		x2	M12	125		x14	Φ10
111		x6	M10x20	122		x6	M10x20

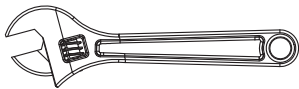

A-1

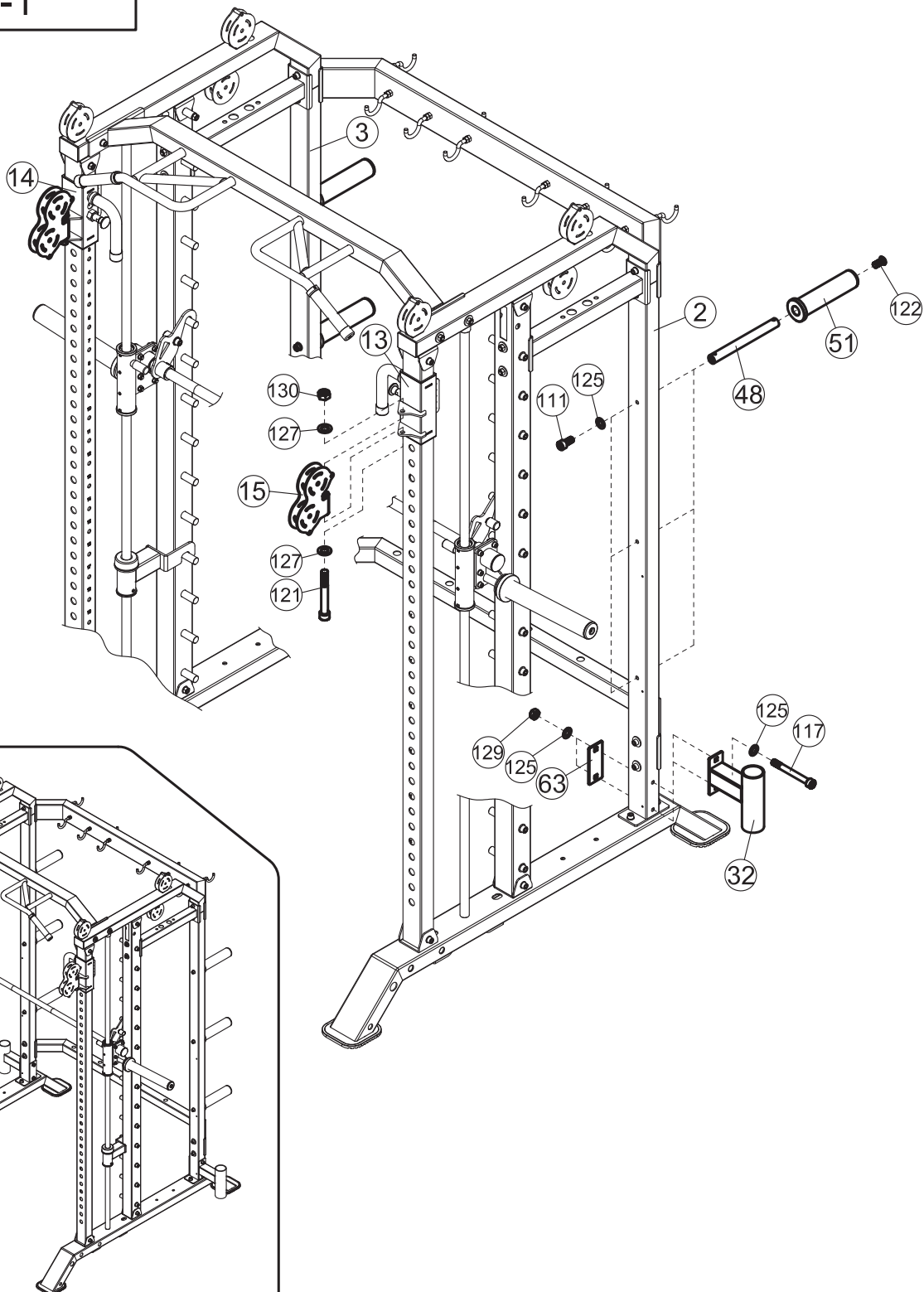

119

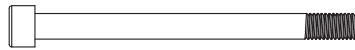

x1 M10x125

125



x2 Φ10

129



x1 M10

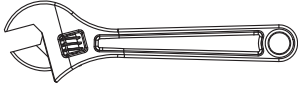

A-1

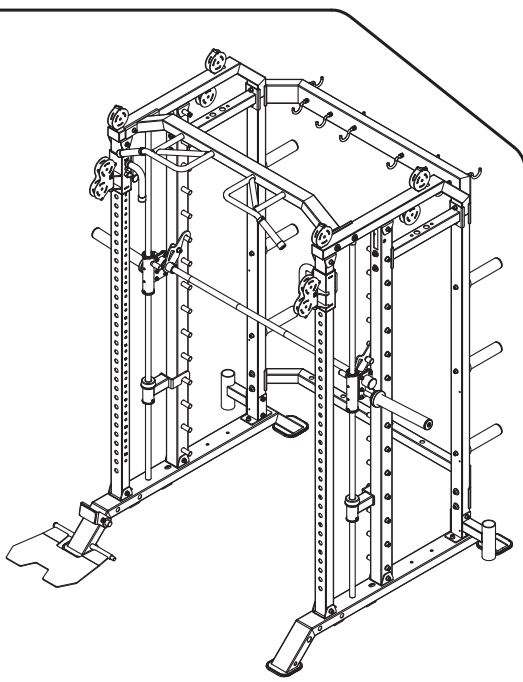
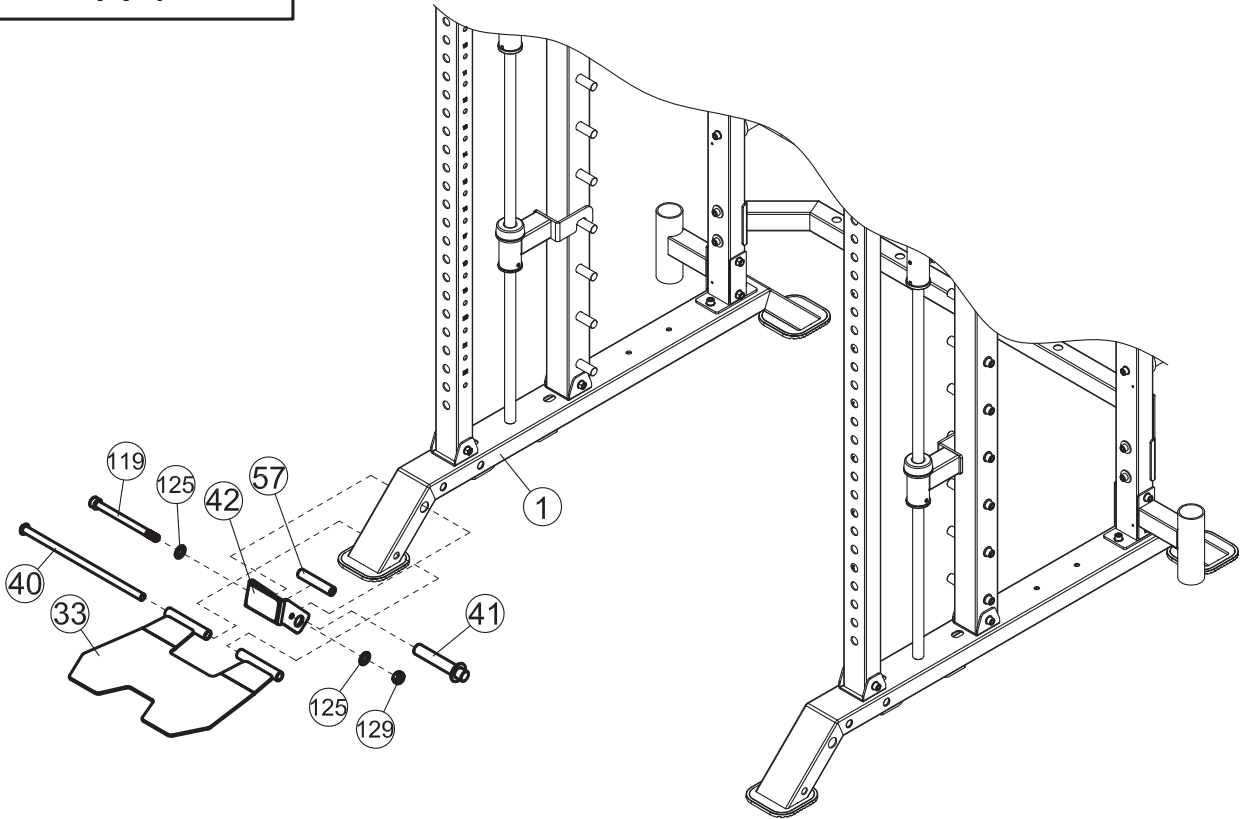

121



×1 M12×95

127



×2 Φ12

130



×1 M12

61



×1 Φ12×Φ8×50

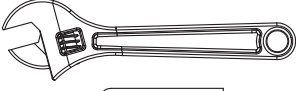

A-1

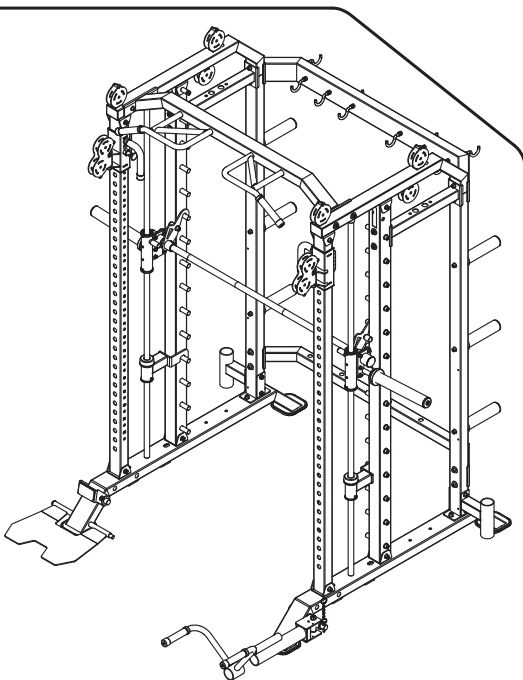
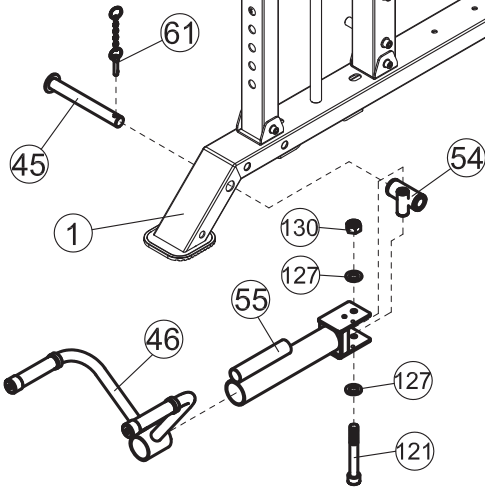
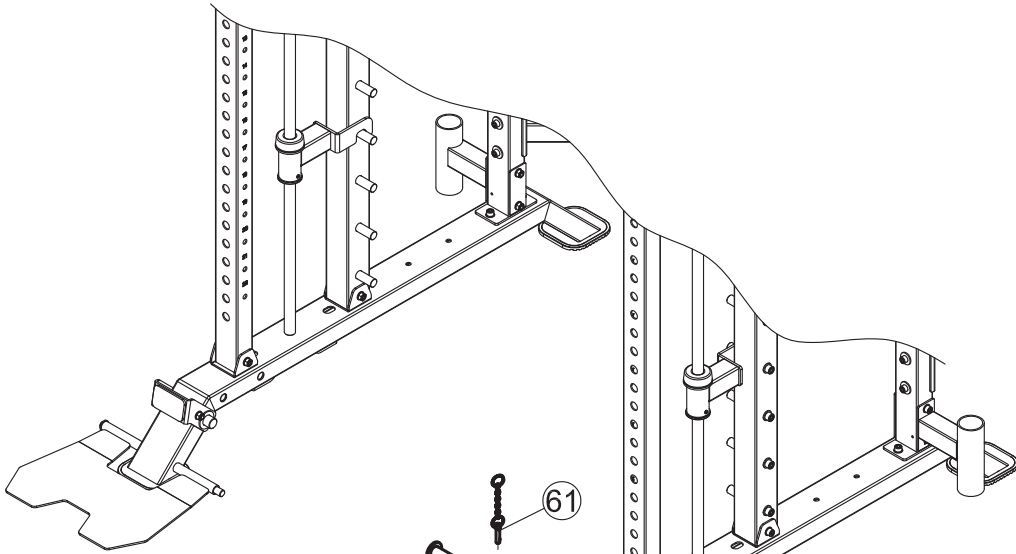

133



×2 M8×20

64

×8 Φ49

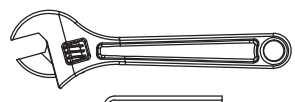

A-1

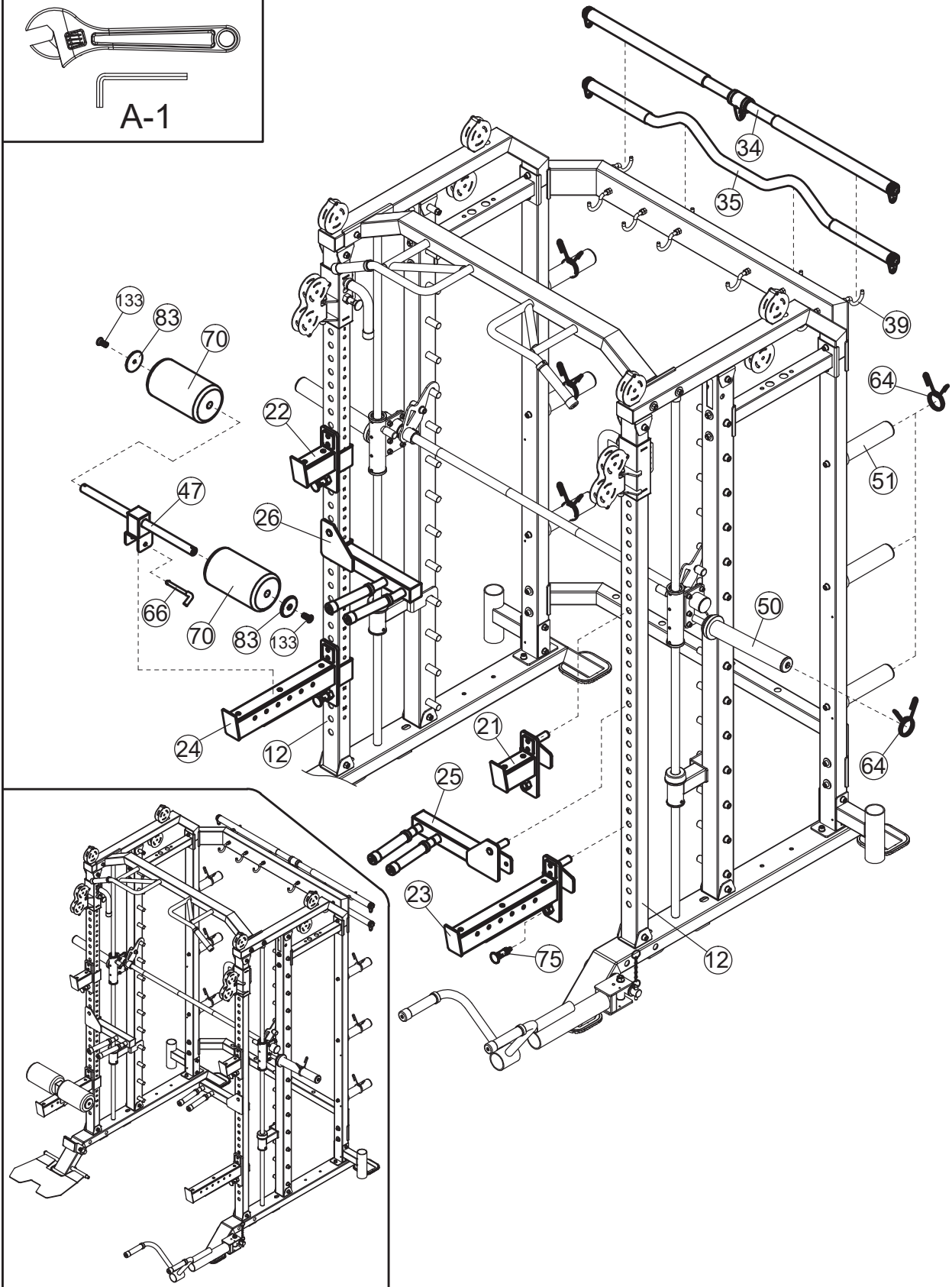

143

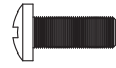

×12

M6×16

142







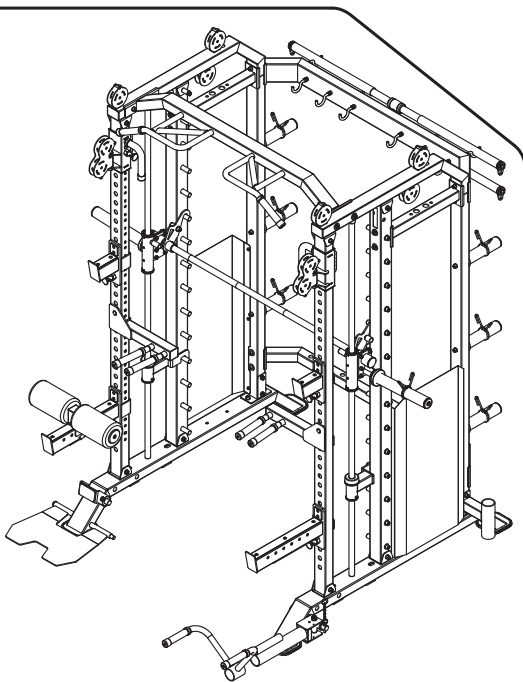
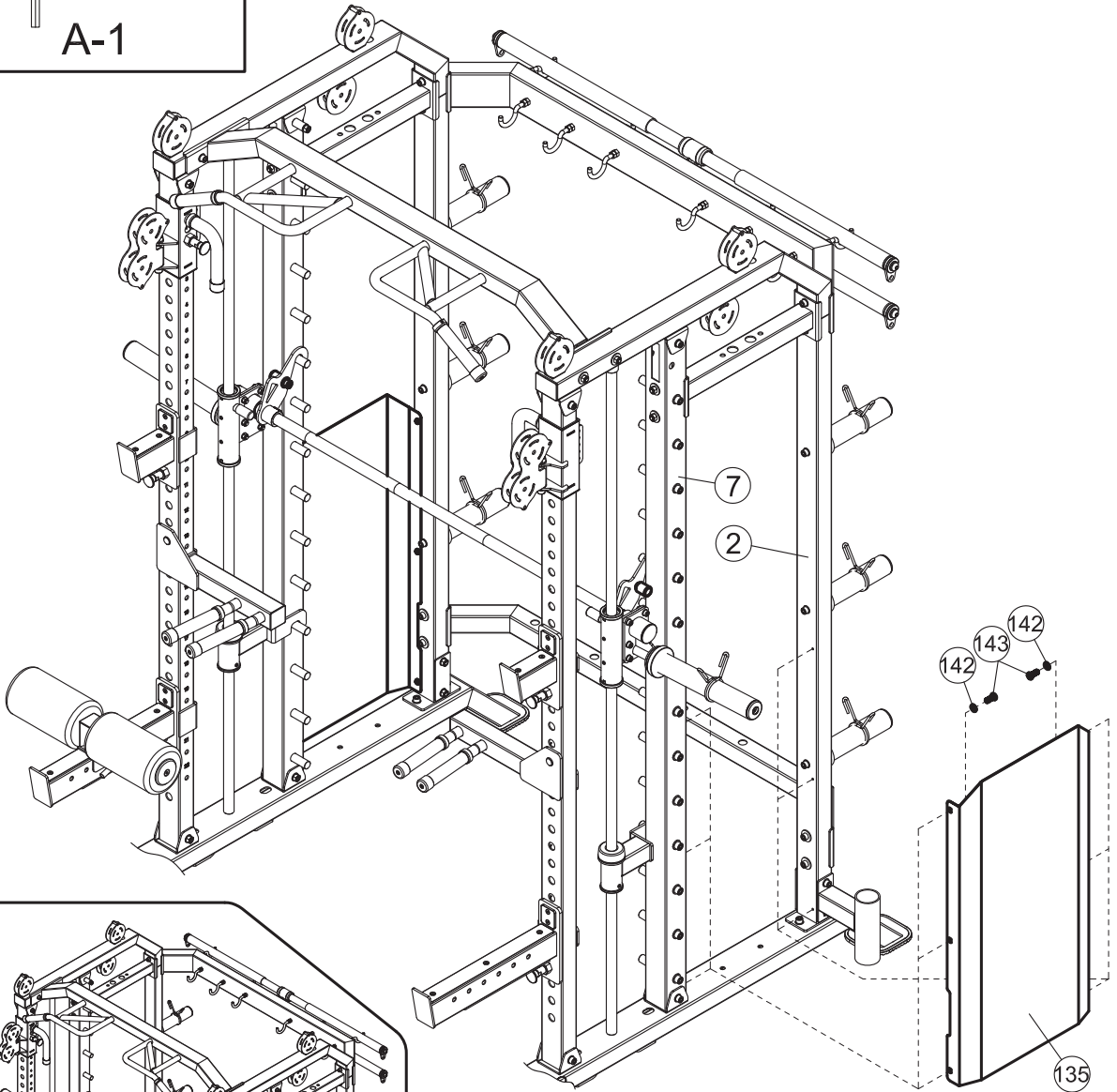

×12

Φ6

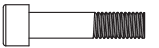
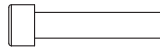

A-1



113		×16	M10×45	116		×2	M10×85
125		×36	Φ10	89		×4	Φ22×Φ10.2×25
129		×20	M10	65		×2	Φ8
112		×2	M10×35				



A-1

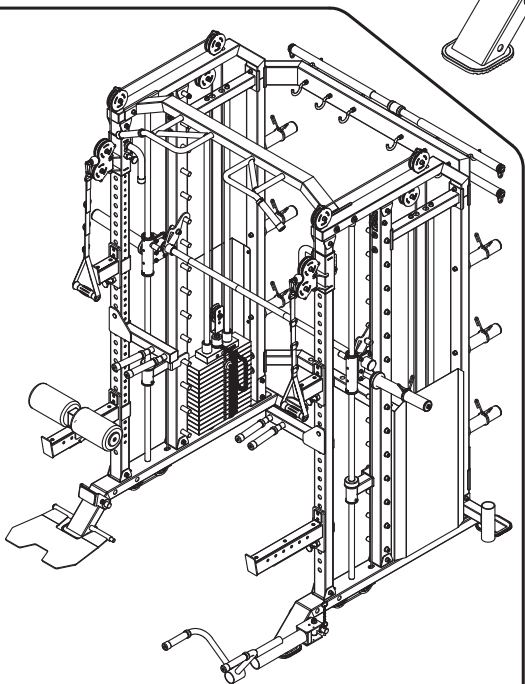
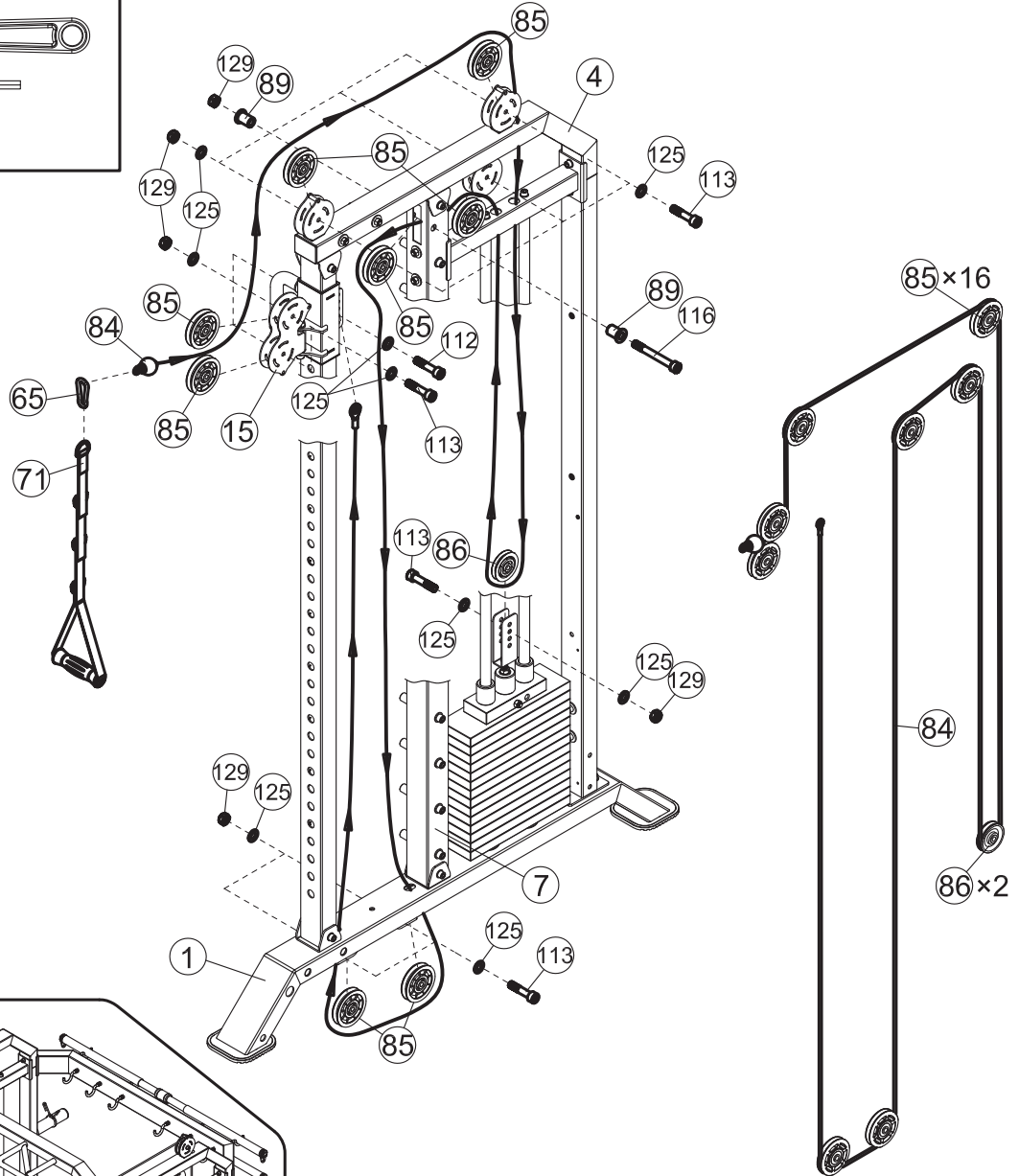

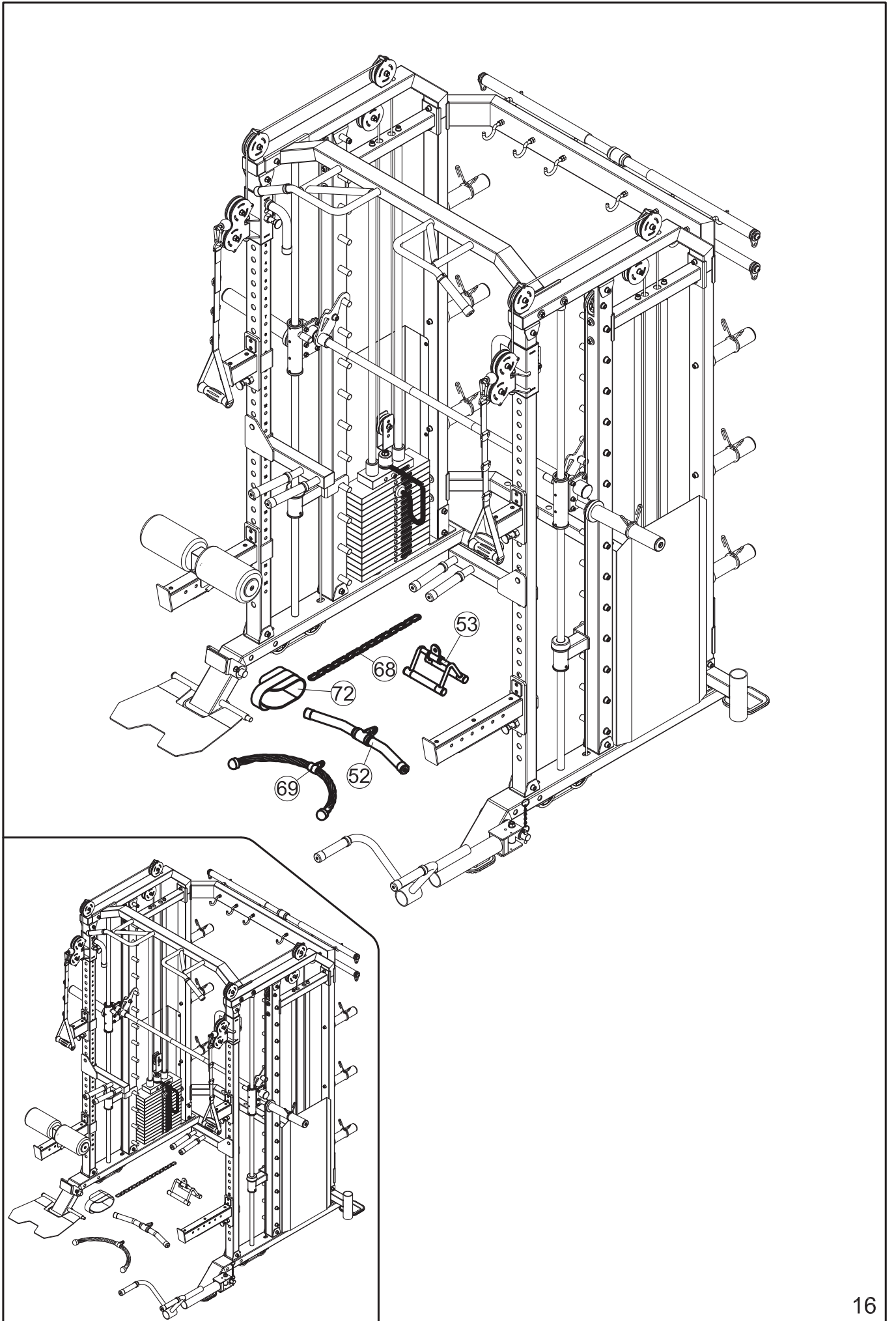

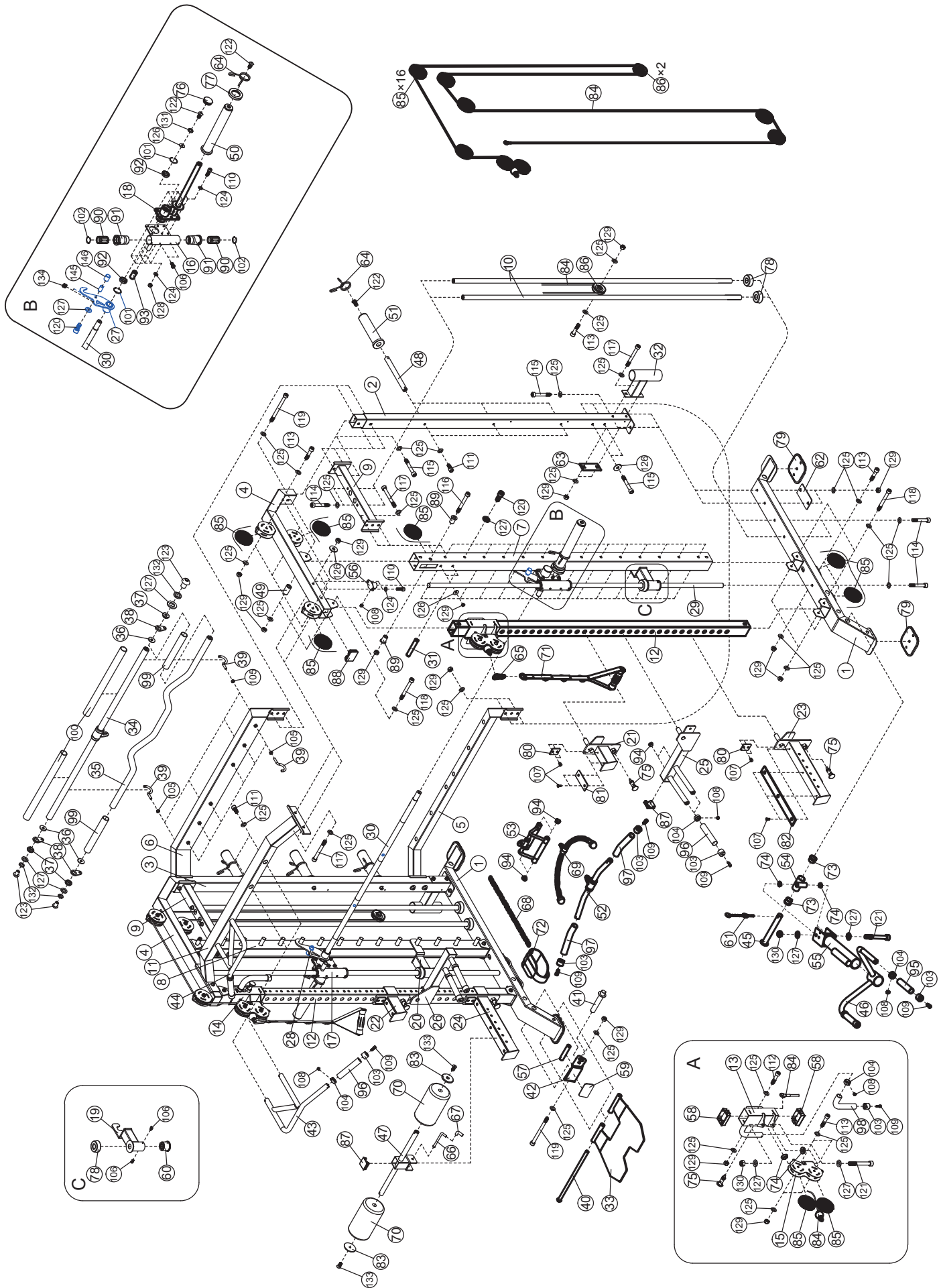

MACHINE PARTS LIST

KEY NO.	PART DESCRIPTION	SPEC	QTY
1	Base Frame		2
2	Rear Post L		1
3	Rear Post R		1
4	Top Frame		2
5	Connecting Frame Rear		1
6	Connecting Frame Rear		1
7	Intermediate Stand L	□70×2×1960	1
8	Intermediate Stand R	□70×2×1960	1
9	Upper connecting frame		2
10	Guide Rod Rear	Φ25×1738	4
11	Horizontal bar		1
12	Guide Shaft	□50×70×3×1960	2
13	Sliding frame L		1
14	Sliding frame R		1
15	Pulley Case		2
16	Mobile rack R		1
17	Mobile rack L		1
18	Weights Stow Rod		2
19	Safety hook Bracket L		1
20	Safety hook Bracket R		1
21	Short Safety Rack L		1
22	Short Safety Rack R		1
23	Long Safety Rack L		1
24	Long Safety Rack R		1
25	Dip Bar L		1
26	Dip Bar R		1
27	Hanging Bar L		1
28	Hanging Bar R		1
29	Guide rod	Φ25×1965	2
30	Weight Rod	Φ30×1215×M10	1
31	Hanging post	Φ20×115	28
32	Barbell Socket		2
33	Foot Pedal Set		1
34	Straight Bar (attachment)		1
35	Cambered Bar (attachment)		1
36	Washer	Φ38×Φ13×4	4
37	Bushing	Φ38×Φ13×12	4

MACHINE PARTS LIST

38	Rotating plate	$\Phi 26 \times \Phi 12 \times 38 \times 6$	4
39	Safety Hook	$\Phi 10 \times R20 \times M10$	10
40	Long latch		1
41	Fixed pedestal		1
42	Limit bracket	$101 \times 95 \times 50 \times 5$	1
43	Left Chin-up Bar		1
44	Right Chin-up Bar		1
45	Rotating Shaft		1
46	Handle		1
47	FOAM Frame		1
48	Weights Stow Rod		6
49	Spacer	$\Phi 20 \times \Phi 10.2 \times 32$	2
50	Long Spacer		2
51	Short Spacer		6
52	Small grip frame		1
53	V-type handle		1
54	Spacer		1
55	Rotating Frame		1
56	Fixing frame		2
57	Spacer	$\Phi 20 \times \Phi 10.2 \times 101$	1
58	Slide Guide	$\square 60 \times 80 \times 2.0 \times \square 50 \times 70$	4
59	Rubber Stopper	$95 \times 55 \times 5$	1
60	Safety hook Bracket Guides	$\Phi 55 \times \Phi 46 \times \Phi 27 \times 41$	2
61	Pop pin		1
62	Bracket	$130 \times 70 \times 3$	2
63	Bracket	$120 \times 50 \times 3$	2
64	Spring Clip	$\Phi 49$	8
65	Hook	$\Phi 8$	2
66	L spring pins	$\Phi 10 \times 115$	1
67	Rubber sleeve	$\Phi 13 \times \Phi 9.5 \times 58$	1
68	15-Joint Chain	15	1
69	Rope	$\Phi 29 \times 695$	1
70	FOAM	$\Phi 125 \times \Phi 22 \times 215$	2
71	Nylon Strap Iso-Handle		2
72	Ankle Strap		1
73	Bushing	$\Phi 38 \times \Phi 34 \times \Phi 25 \times 22$	2
74	Bushing	$\Phi 25 \times \Phi 21.8 \times \Phi 12.2 \times 8$	6
75	Moving Lock Pin		6

MACHINE PARTS LIST

76	Rectangular End Cap	Φ50	2
77	Rubber Stopper	Φ78xΦ47.5x13	2
78	Rubber Stopper	Φ62×Φ24.5×25	6
79	Floor End Cap	□135×135×8	4
80	Rack Liner	52×45×5	4
81	Rack Liner	120×45×5	2
82	Rack Liner	415×45×5	2
83	plate	Φ68×5.7	2
84	Double pull cable	Φ5	2
85	Pulley with Bearings	Φ96	16
86	Small Pulley with Bearing	Φ75×25	2
87	Rectangular End Cap	□50	3
88	Rectangular End Cap	□70×50	2
89	Bushing	Φ22×Φ10.2×25	4
90	Linear Motion Bearing	LB254058	4
91	Sliding Rod Guide	Φ55×Φ46×Φ40×73	4
92	Deep groove ball bearing	61905	4
93	Tube End Cap	Φ19×42	2
94	Rectangular End Cap	Φ25	8
95	Dips Handle	Φ23×130	2
96	Dips Handle	Φ23×150	6
97	Dips Handle	Φ23×180	2
98	Dips Handle	Φ23×200	2
99	Dips Handle	Φ30×3×200	2
100	Dips Handle	Φ30×3×500	2
101	Hole circlip	42	4
102	Hole circlip	d0=40	4
103	Decorative cover	Φ33.5×Φ6.6×25	12
104	Retaining ring	Φ34.5×Φ26.5×14×M6	10
105	Hex nuts	M10	10
106	Screw	ST4.0×9	8
107	Allenlen BoltBolt	M6×12(8.8)	18
108	Set screw	M6×6	12
109	Hexagon socket button head screws	M6×15	12
110	Hexagon socket button head screws	M8×25/8.8	16
111	Hexagon socket button head screws	M10×20	10
112	Hexagon socket button head screws	M10×35	2
113	Hexagon socket button head screws	M10×45	16

MACHINE PARTS LIST

114	Hexagon socket button head screws	M10×65	10
115	Hexagon socket button head screws	M10×70/8.8	12
116	Hexagon socket button head screws	M10×85	2
117	Hexagon socket button head screws	M10×90	12
118	Hexagon socket button head screws	M10×95	6
119	Hexagon socket button head screws	M10×125	3
120	Hexagon socket button head screws	M12×25	30
121	Hexagon socket button head screws	M12×95	3
122	Allen Bolt	M10×20	10
123	Allen Bolt	M12×40	4
124	Washer	8	28
125	Washer	10	106
126	Washer	Φ30×Φ10.5×2.5	14
127	Washer	12	40
128	Nut	M8	12
129	Nut	M10	49
130	Nut	M12	3
131	Washer	10	2
132	Washer	12	4
133	Allen Bolt Bolt	M8×20	2
134	Set screw	M8×10	4
145	Limit post	Φ18×32×M12	2
146	Tube End Cap	Φ18×Φ25×30	2
	Allen wrench	3#	1
	Allen wrench	4#	1
	Allen wrench	5#	1
	Allen wrench	6#	1
	Allen wrench	8#	1
	Allen wrench	10#	1

WEIGHT STACK PARTS LIST

KEY NO.	PART DESCRIPTION	SPEC	QTY
135	Weight Stack Cover	870×438×60×1.0	2
136	Top Weight Plate	198×76×33	2
137	Weight Plate	330×102×25 (6KG)	28
138	Selector Rod	Φ25×450 (14+1)	2
139	Weight Selector Pin		2
140	Pulley Case		2
117	Hexagon socket button head screws	M10×90	2
129	Nut	M10	2
141	Hex nuts	M12	2
142	Washer	6	12
143	Cross slot head screw	M6×16	12
144	Weight Plate Sticker (90kg)	51×13	2