

# Wireless TENS with Remote

Model ACRL-9000



The purpose of this reference guide is to assist you in correctly operating your AccuRelief™ Wireless TENS with Remote ACRL-9000 unit. This guide is not intended to replace or substitute the AccuRelief™ Dual Channel TENS User Manual. **PLEASE READ THE INSTRUCTION MANUAL COMPLETELY BEFORE USING THIS DEVICE.** Read, understand and practice the IMPORTANT SAFETY PRECAUTIONS AND WARNINGS found on pages 6 – 12 of your user manual.

For more information about your AccuRelief™ Dual Channel TENS unit, visit us online at [www.accurelief.com](http://www.accurelief.com) or call 1-800-328-2935.

### AccuRelief™ Wireless TENS with Remote Unit

- 1 Gel pad
- 2 Power ON / increase intensity button
- 3 LED indicator
- 4 Power OFF / decrease intensity button
- 5 Battery cover
- 6 Snap-fastener
- 7 Unit A intensity decrease button
- 8 Unit B intensity decrease button
- 9 Unit A & B intensity decrease button
- 10 Power off button
- 11 LED indicator
- 12 Remote control
- 13 Unit A intensity increase button
- 14 Unit B intensity increase button
- 15 Unit A & B intensity increase button
- 16 Battery cover
- 17 Unit A
- 18 Unit B

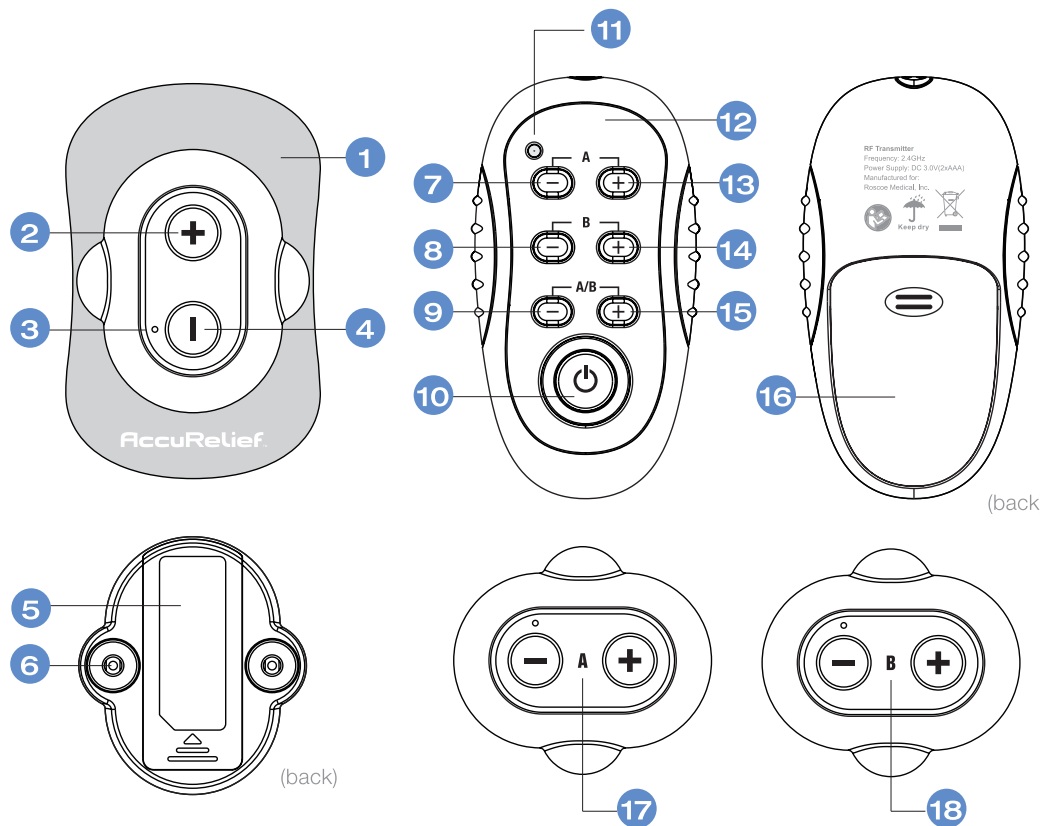

### 1 INSERT BATTERIES

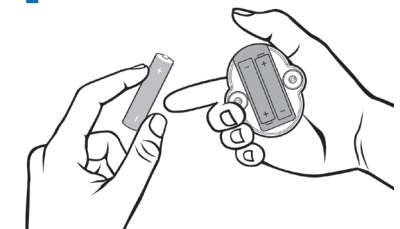

AAA batteries are included. Remove the back cover of each unit by pressing and sliding the cover in the direction of the arrow. Insert batteries, + and - ends to those in unit. Slide cover back into position.

### 2 CONNECT GEL PADS TO EACH DEVICE

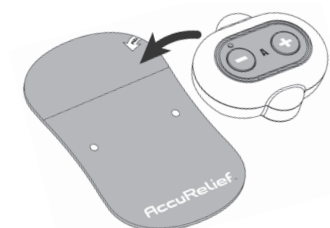

Each gel pad is pre-fixed with a stud to connect to the back of the device, and is protected by a transparent film. Attach the gel pads to the back of the device, pressing them in place.

# Wireless TENS with Remote



Apply pads to normal, healthy, clean and dry skin of adult patients because it may otherwise disrupt the healing process.

If you experience any skin irritation or redness after a session, do not continue stimulation in that area of the skin.

### REPLACEMENT PARTS:

AccuRelief™ Wireless TENS Supply Kit - ACRL-0003 includes 8 electrode pads

## 3

Clip excess hair from the area to be treated. Wash with soap and water, and dry completely. Remove the protective film layer and apply the gel pad to the skin. Press firmly to ensure adhesion.



See the **Electrode Placement Guide** for more information.

## 4 TURN ON TENS UNIT



**NOTE: You cannot turn the gel pad units on by pressing the remote control.** Press the **+** button on the gel pad unit to turn the device on.

## 5 OPERATING THE TENS UNIT

Using either the remote control or the gel pad units, press the **+** button to increase or the **-** button to decrease the intensity.

LED indicator explanation of the gel pads units:

- Steady solid light** – the unit is on
- Flashing** – the unit is ready for use
- Rapid flashing** – the unit is receiving information from the remote
- Light off** – the unit is switched off.

## 6 TURN OFF TENS UNIT



Turn off device in one of the following ways:

- The device will turn off automatically after 30 minutes treatment time.
- Press the **-** button continuously until the LED light turns off.
- Turn the device off by pressing the **⏻** button on the remote control.

## Recommended Gel Pad Positions

