

⚠ WARNINGS

- Only use the charging cable provided and a good quality USB power source.
- Charge the product in a well-ventilated area and avoid charging under pillows, blankets, or on flammable surfaces. Do not leave unattended while charging.
- Although this speaker is IPX6 water-resistant, it is not waterproof. To avoid damaging the speaker, please keep it away from direct streams of water and do not submerge it in water.
- Do not expose this product to sources of heat. Do not expose to temperatures above 40°C, such as in a car on a hot day, or in direct sunlight.
- Prevent objects and debris from entering the device ports.
- To protect your hearing, keep the volume at a safe level and take regular breaks.
- Refer all servicing to qualified service personnel, which is required if this product is damaged in any way, is exposed to liquid, or does not operate normally.
- Children must be supervised when using or handling this product.

SPECIFICATIONS

Bluetooth version:	V5.2
Waterproof rating:	IPX6
Driver:	5W
Built-in Battery:	3.7V/1200mAh lithium polymer
Input USB-C:	DC 5V 1A Max
Play time:	Approx 5hr
Charge time:	Approx 2.5hr

fuse

ONE S PORTABLE SPEAKER



AFS-BT-1S-GRY

fuse

QUICK START GUIDE

WHAT'S INCLUDED:

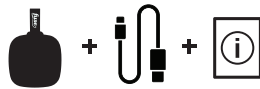

1. CHARGE YOUR ONE S SPEAKER

Fully charge before using the first time using the supplied cable. The LED indicator will turn red when the speaker is charging and will switch OFF when the speaker is fully charged.

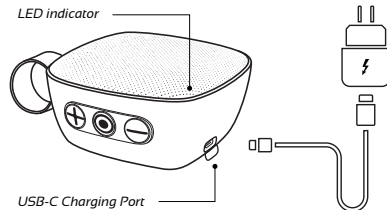

2. CONNECT YOUR ONE S SPEAKER

When the speaker is fully charged, press the power ON button for 2 seconds, the speaker will emit a short sound and the LED indicator light will flash blue to indicate it is ON and ready to pair.

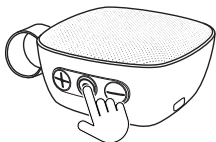

Turn Bluetooth ON in your phone settings and select Fuse One S from the available Bluetooth devices. The speaker will emit a sound and the LED indicator light will remain blue to indicate it has successfully paired.

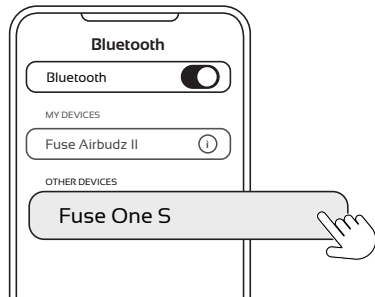

3. USE YOUR ONE S SPEAKER

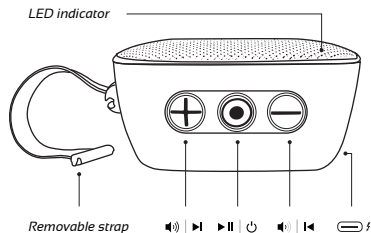

Switch speaker ON/OFF	Press	○	for 2 seconds
Play/pause song	Press	○	
Previous track	Press	-	for 2 seconds
Next track	Press	+	for 2 seconds
Volume down	Press	-	
Volume up	Press	+	

4. PRODUCT SUPPORT

For the most up-to-date assistance, please scan this QR Code for product support.



CHECK OUT OUR WHOLE RANGE AT
FUSEAUDIO.COM.AU

fuse