

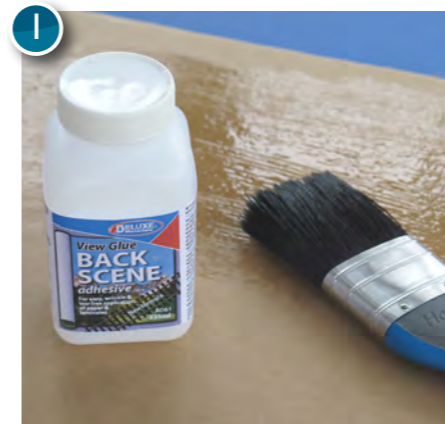

HOW TO DO IT: USE BACKSCENE ADHESIVE

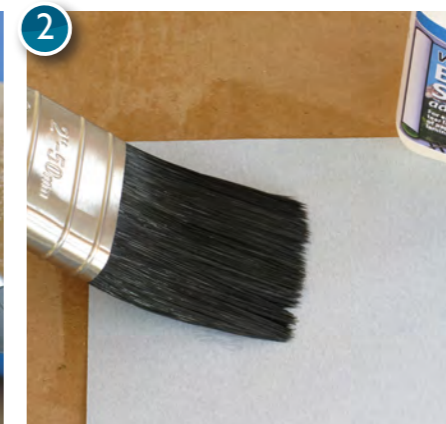

1 I brushed the adhesive all over the board to which I was fixing the backscene, checking that I had not missed any areas.



2 After fully covering the backing board, I painted the adhesive over the reverse side of the backscene, ensuring that it was completely covered with a thin, even layer.



3 Roll a wallpaper seam roller over the edges to prevent them from curling. Clean its surface as you go with a damp cloth, otherwise it will spread streaks of adhesive over the backscene.

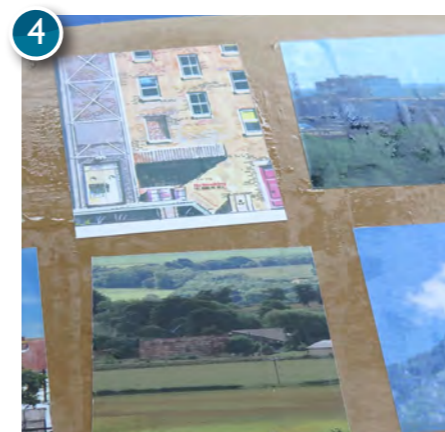

4 The six backscenes ten minutes after they had been glued to the piece of cardboard. You'll see that most of them have bubbles in them...

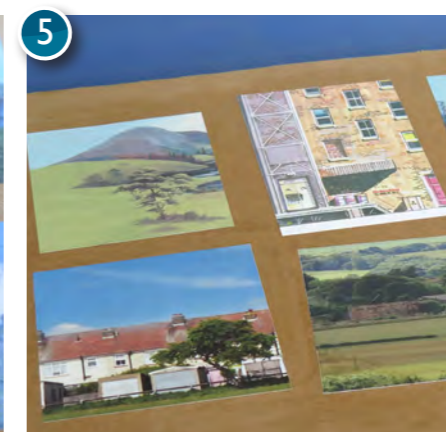

5 ...but leave the backscenes overnight and the adhesive will dry with no bubbles, creases or ripples.

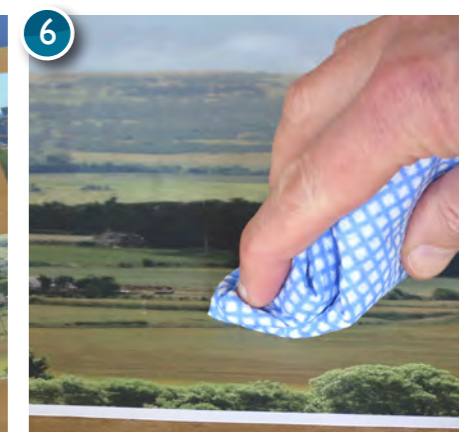

6 Wipe away excess adhesive with a damp cloth. This can be done soon after the backscene has been fixed to the backing board. Alternatively, you can leave it until the adhesive has dried.

HOW TO... AFFIX A BACKSCENE



Surely any old glue will do for sticking a backscene image down? **PETER MARRIOTT** knows which product he'll stick with in future...

Always on the lookout for gaps in the market, Deluxe Materials launched View Glue a few years ago, specifically formulated to fix backscenes to backing boards. However, the firm says that it's gone back to the drawing board and created Backscene Adhesive, which supposedly offers improved performance.

I felt that I had to put this re-formulated glue to the test, because I thought

that the old View Glue worked perfectly well enough as it was. I also wanted to see if Deluxe's claim that "this unique adhesive allows papers to be slithered into position and finely adjusted before drying without creases or wrinkles" was true.

To give Backscene Adhesive a thorough workout, I took backscenes from Falter, Gaugemaster, ID Backscenes, Peco, Walther's and Vollmer and fixed them to a large piece of strong, corrugated cardboard, the

type used to package white goods such as washing machines.

I brushed adhesive on to the cardboard and the reverse of the backscenes and brought the two together. I ran a wallpaper roller over the edges to ensure that they didn't curl up, then left them to dry.

After an hour, I went to check on them and my heart sank: bubbles! With a heavy sigh, I decided to leave them overnight to dry fully.

Next morning, all of the backscenes were flat on the backing board. No wrinkles and, more importantly, no bubbles. There were a few shiny



MODEL
Deluxe Materials
Backscene
Adhesive (AD61),
225ml (covers 7 sq m)
• Price: £8.50

AVAILABILITY
Deluxe Materials
stockists or www.gaugemaster.com



ESTIMATED TIME
One hour to cover and position a 2 sq m backscene, plus overnight drying time



- Self-healing cutting mat
- Sharp craft knife
- Paintbrushes
- Wallpaper seam roller
- Damp cloth

patches on the backscenes, but they were easily removed with a damp cloth.

I then tried Backscene Adhesive on mounting card and foamboard and it worked superbly on both. I didn't get to try it out on wood, but Deluxe Materials says it works well on MDF and plywood. The only suggestion I'd make about working on wood is to give it a coat of adhesive first and let it dry, then give it a second coat when you come to apply the backscene. This would let me slide the backscene into place without damaging it.

In the past, I've used diluted PVA or wallpaper paste to fix backscenes to the backing board with varying degrees of success. Sometimes, I've been really disappointed with the results. But now I've discovered Backscene Adhesive, I'm never going to use anything else. **MR**

+
Easy to work with, gives excellent results. Why use anything else?
PETER'S VERDICT
Costs more than wallpaper adhesive.
-

