

Gregson-Clark Three-point Hitch Spraying System

Operator's Manual

55, 85 or 100 Gallon



Do not hesitate to call your dealer or Gregson-Clark directly with any questions or concerns. We also welcome your comments and suggestions on how we can continue to improve this product.

Toll free: 800 . 706 . 9530
Phone: 585 . 538 . 9570

Fax: 585 . 538 . 9577
E-mail: Sales@GregsonClark.com



3213 Lehigh Street
Caledonia, NY 14423
www.GregsonClark.com

OPERATING GUIDELINES

This sprayer is equipped with either a roller or diaphragm pump with PTO adapter and torque arm. When attaching the pump to the 540 rpm PTO shaft, be sure that the collar locks securely onto the shaft. Refer to the included data sheet concerning your pump.

The torque arm supports the pump and carries the PTO torque load. Refer to the included torque arm instruction sheet for directions concerning proper mounting of the pump.

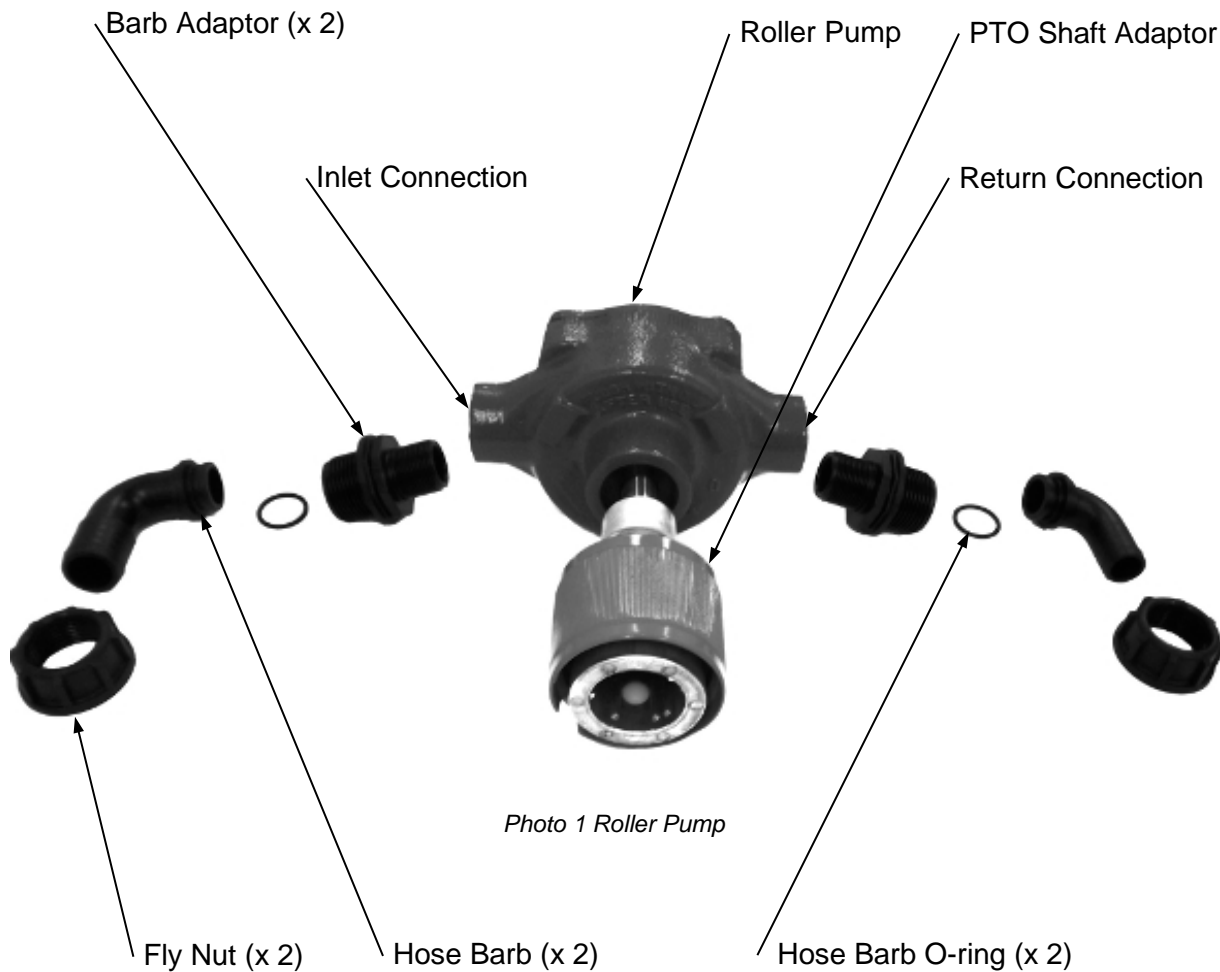
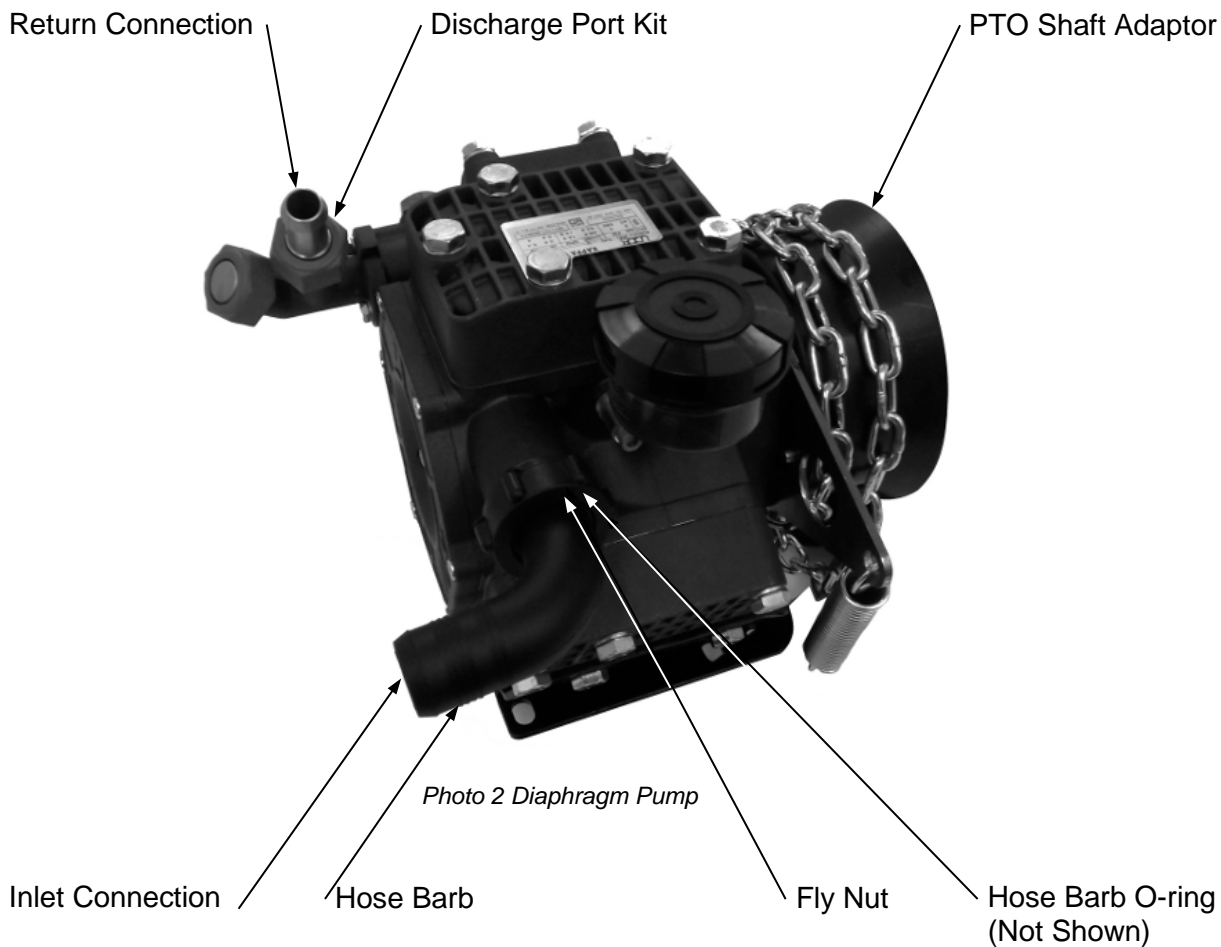

Photo 1 Roller Pump

Part Numbers

Roller Pump	PTO Adapter	Barb Adapter	Fly Nut	Inlet Barb	Outlet Barb	Barb O-Ring
1700C	1321-0013	2002060	2402060	116633	116625	G10061
6500C	1321-0012	2002040	2402040	116425	116420	G10041
7560C	1321-0013	2002040	2402040	116425	116420	G10041
7700C	1321-0013	2002040	2402040	116425	116420	G10041



Part Numbers

Discharge Port Kit	PTO Shaft Adaptor	Hose Barb	Fly Nut	Hose Barb O-ring
8704.07	7752.A2	0202.52	0604.18	1101.41



Part Numbers

Photo 3 Relief Valve for Diaphragm Pump

Relief Valve	Hose Barb	Fly Nut	Hose Barb O-ring	Ball Valve
6047.06	0254.04	0604.26	1101.12	0608.46

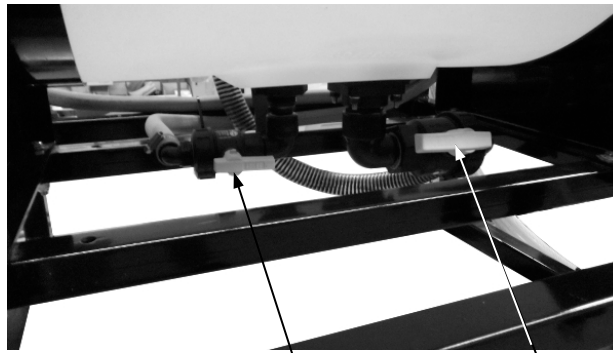

Photo 4 Tank Valves

Return Valve

Suction Valve

Be sure that both the suction and return valves on the bottom of the tank are open whenever the pump is running. The system pressure is adjusted by the regulator located on the boom control valve. Turning the knob clockwise will increase the pressure and counterclockwise will decrease the pressure.

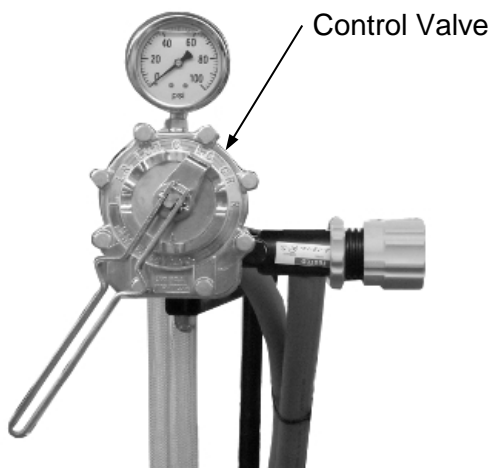

Photo 5 Boom Control Valve with Regulator

Pulling the lever out opens the valve for spraying. The valve can be opened or closed without changing the indexed position.

The 3-section boom selector valve allows for spraying out of individual boom sections. Note the **L**, **C**, and **R** marks, which are for the Left, Center, and Right boom sections. The **LCR** position is used to spray with the complete boom. Rotate the lever to the desired position to select which boom sections you want to use.

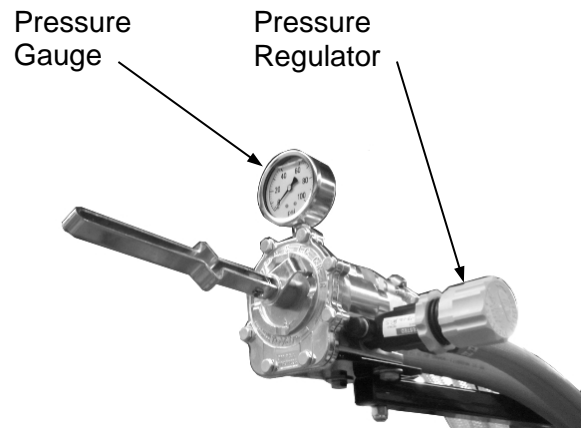

Photo 6 Boom Control Valve shown open

Part Numbers

Control Valve	Pressure Gauge	Pressure Regulator
AA17L	2141GXB100	23120-3/4-PP

STRAINER PARTS

Strainer Assembly with Barbs - P/N 3142561-A
Strainer Assembly without Barbs - P/N 3142561

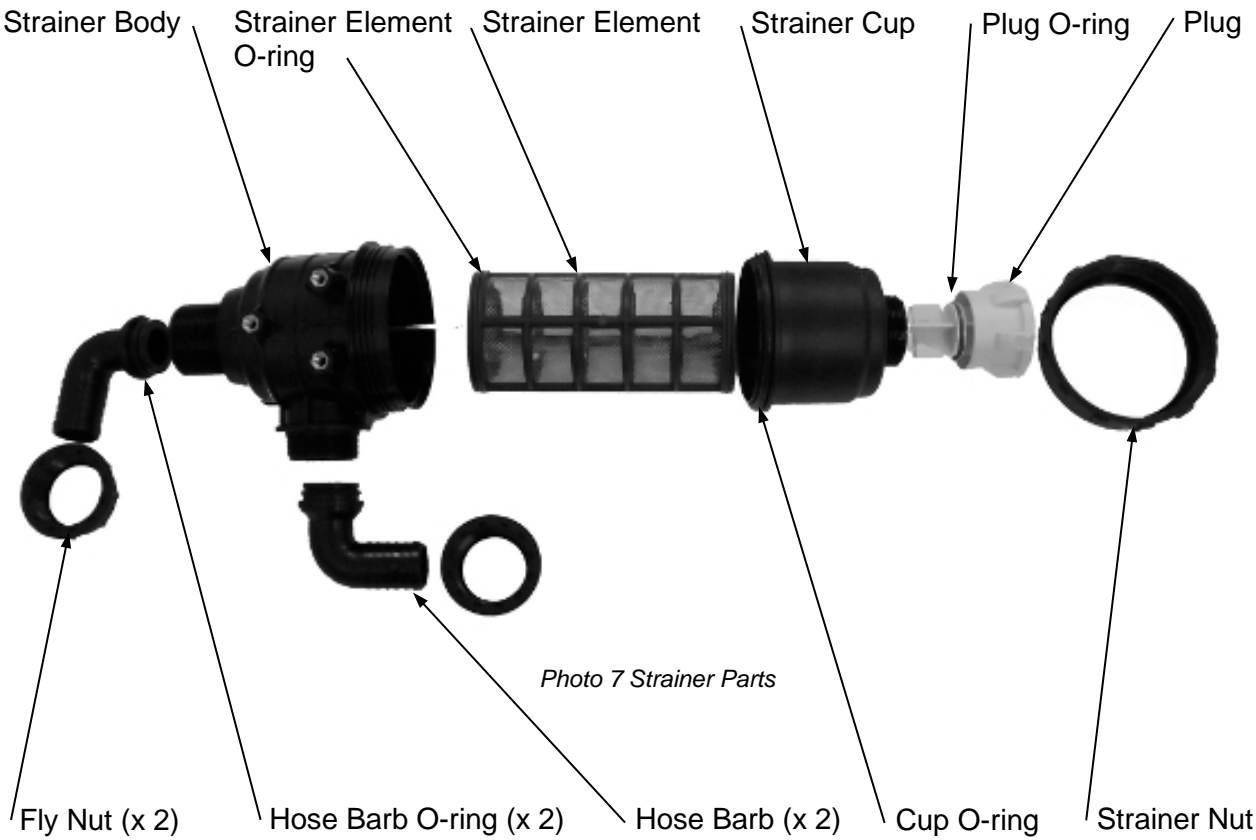

Part Numbers

Strainer Body	Strainer Element O-ring	Strainer Element	Strainer Cup	Plug O-ring	Strainer Plug
3142060.010	314300.060	314001.030	3142400.020	462300.230	314200.060

Fly Nut (x 2)	Hose Barb O-ring (x 2)	Hose Barb (x 2)	Cup O-ring	Strainer Nut	
2002060	910061	116633	314000.050	314000.040	

OPTIONAL SOLENOID VALVES

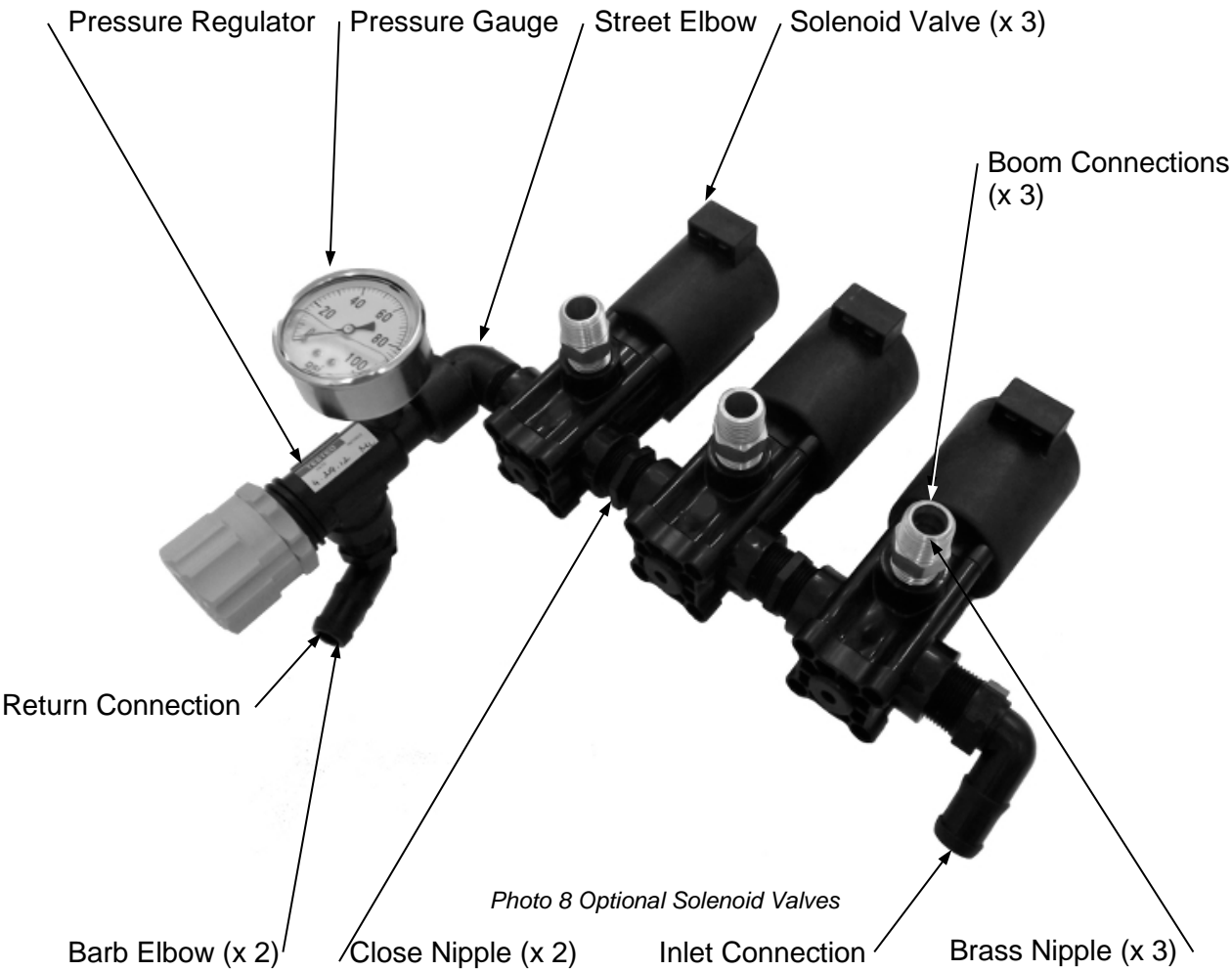

Part Numbers

Pressure Regulator	Street Elbow	Solenoid Valve	Barb Elbow	Close Nipple	Brass Nipple
23120-3/4-PP	SL075-90	AA144P-1	HB075-90	NIP075-SH	122-D

	Top Mount	Back Mount (Shown above)
Pressure Gauge	2141GXB100	2241GXB100

BOOM CONFIGURATION

The nozzles on the boom are spaced on 20" centers.

All spraying should be done with a boom height of 22 inches or more to ensure proper overlap of the nozzle spray pattern.

Refer to the TeeJet application guideline chart for the application rate of the Turbo TeeJet nozzles, if provided. See Figure 1. If TeeJet nozzles are not included, contact the nozzle manufacturer for application rate guidelines.

MAINTENANCE

Clean the pump strainer and the tip screens with each use

LONG TERM STORAGE

Protect from freezing! Completely rinse the sprayer of chemicals with clean water and flush with RV antifreeze. Drain the tank and hoses, and blow out with air if necessary. Damage to the system will occur if liquids are left exposed to freezing conditions.



Photo 9 Add Anti-Freeze through Suction Strainer

When not using the roller pump, drain it of spray solution, rinse with clean water, and circulate oil through the pump. If the pump is left for extended periods without oil in it, rust will occur inside the pump and it will be difficult to get it to turn again and it may be permanently damaged.

NOTE: This step is not necessary when using a diaphragm pump.

For more information on winterizing your sprayer, refer to our Web site.
www.GregsonClark.com/resource_info.html

Turbo TeeJet® Wide Angle Flat Spray Tips



Typical Applications:

See selection guide on page 2 for recommended typical applications for Turbo TeeJet tips.

Features:

- Tapered edge wide angle flat spray pattern for uniform coverage in broadcast spraying.
- Large, rounded internal passage to minimize clogging.
- Excellent resistance to corrosive solutions.
- Superior wear characteristics.
- Larger droplets for less drift—15–90 PSI (1–6 bar).
- Automatic spray alignment with 25612-[®]-NYP Quick TeeJet[®] cap and gasket. Reference page 57 for more information.
- Blockage-free passage means less clogging.
- Unique internal configuration means substantially longer wear life.



CONTACT PRODUCT	SYSTEMIC PRODUCT	DRIFT MANAGEMENT
VERY GOOD	VERY GOOD	VERY GOOD
GOOD*	EXCELLENT*	VERY GOOD*

*At pressures below 30 PSI (2.0 bar)

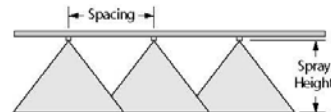

Optimum Spray Height

110°	20°
1.0	1.0
1.1	1.1
1.2	1.2
1.3	1.3
1.4	1.4
1.5	1.5
1.6	1.6
1.7	1.7
1.8	1.8
1.9	1.9
2.0	2.0
2.1	2.1
2.2	2.2
2.3	2.3
2.4	2.4
2.5	2.5
2.6	2.6
2.7	2.7
2.8	2.8
2.9	2.9
3.0	3.0
3.1	3.1
3.2	3.2
3.3	3.3
3.4	3.4
3.5	3.5
3.6	3.6
3.7	3.7
3.8	3.8
3.9	3.9
4.0	4.0
4.1	4.1
4.2	4.2
4.3	4.3
4.4	4.4
4.5	4.5
4.6	4.6
4.7	4.7
4.8	4.8
4.9	4.9
5.0	5.0
5.1	5.1
5.2	5.2
5.3	5.3
5.4	5.4
5.5	5.5
5.6	5.6
5.7	5.7
5.8	5.8
5.9	5.9
6.0	6.0
6.1	6.1
6.2	6.2
6.3	6.3
6.4	6.4
6.5	6.5
6.6	6.6
6.7	6.7
6.8	6.8
6.9	6.9
7.0	7.0
7.1	7.1
7.2	7.2
7.3	7.3
7.4	7.4
7.5	7.5
7.6	7.6
7.7	7.7
7.8	7.8
7.9	7.9
8.0	8.0
8.1	8.1
8.2	8.2
8.3	8.3
8.4	8.4
8.5	8.5
8.6	8.6
8.7	8.7
8.8	8.8
8.9	8.9
9.0	9.0
9.1	9.1
9.2	9.2
9.3	9.3
9.4	9.4
9.5	9.5
9.6	9.6
9.7	9.7
9.8	9.8
9.9	9.9
10.0	10.0
10.1	10.1
10.2	10.2
10.3	10.3
10.4	10.4
10.5	10.5
10.6	10.6
10.7	10.7
10.8	10.8
10.9	10.9
11.0	11.0
11.1	11.1
11.2	11.2
11.3	11.3
11.4	11.4
11.5	11.5
11.6	11.6
11.7	11.7
11.8	11.8
11.9	11.9
12.0	12.0
12.1	12.1
12.2	12.2
12.3	12.3
12.4	12.4
12.5	12.5
12.6	12.6
12.7	12.7
12.8	12.8
12.9	12.9
13.0	13.0
13.1	13.1
13.2	13.2
13.3	13.3
13.4	13.4
13.5	13.5
13.6	13.6
13.7	13.7
13.8	13.8
13.9	13.9
14.0	14.0
14.1	14.1
14.2	14.2
14.3	14.3
14.4	14.4
14.5	14.5
14.6	14.6
14.7	14.7
14.8	14.8
14.9	14.9
15.0	15.0
15.1	15.1
15.2	15.2
15.3	15.3
15.4	15.4
15.5	15.5
15.6	15.6
15.7	15.7
15.8	15.8
15.9	15.9
16.0	16.0
16.1	16.1
16.2	16.2
16.3	16.3
16.4	16.4
16.5	16.5
16.6	16.6
16.7	16.7
16.8	16.8
16.9	16.9
17.0	17.0
17.1	17.1
17.2	17.2
17.3	17.3
17.4	17.4
17.5	17.5
17.6	17.6
17.7	17.7
17.8	17.8
17.9	17.9
18.0	18.0
18.1	18.1
18.2	18.2
18.3	18.3
18.4	18.4
18.5	18.5
18.6	18.6
18.7	18.7
18.8	18.8
18.9	18.9
19.0	19.0
19.1	19.1
19.2	19.2
19.3	19.3
19.4	19.4
19.5	19.5
19.6	19.6
19.7	19.7
19.8	19.8
19.9	19.9
20.0	20.0
20.1	20.1
20.2	20.2
20.3	20.3
20.4	20.4
20.5	20.5
20.6	20.6
20.7	20.7
20.8	20.8
20.9	20.9
21.0	21.0
21.1	21.1
21.2	21.2
21.3	21.3
21.4	21.4
21.5	21.5
21.6	21.6
21.7	21.7
21.8	21.8
21.9	21.9
22.0	22.0
22.1	22.1
22.2	22.2
22.3	22.3
22.4	22.4
22.5	22.5
22.6	22.6
22.7	22.7
22.8	22.8
22.9	22.9
23.0	23.0
23.1	23.1
23.2	23.2
23.3	23.3
23.4	23.4
23.5	23.5
23.6	23.6
23.7	23.7
23.8	23.8
23.9	23.9
24.0	24.0
24.1	24.1
24.2	24.2
24.3	24.3
24.4	24.4
24.5	24.5
24.6	24.6
24.7	24.7
24.8	24.8
24.9	24.9
25.0	25.0
25.1	25.1
25.2	25.2
25.3	25.3
25.4	25.4
25.5	25.5
25.6	25.6
25.7	25.7
25.8	25.8
25.9	25.9
26.0	26.0
26.1	26.1
26.2	26.2
26.3	26.3
26.4	26.4
26.5	26.5
26.6	26.6
26.7	26.7
26.8	26.8
26.9	26.9
27.0	27.0
27.1	27.1
27.2	27.2
27.3	27.3
27.4	27.4
27.5	27.5
27.6	27.6
27.7	27.7
27.8	27.8
27.9	27.9
28.0	28.0
28.1	28.1
28.2	28.2
28.3	28.3
28.4	28.4
28.5	28.5
28.6	28.6
28.7	28.7
28.8	28.8
28.9	28.9
29.0	29.0
29.1	29.1
29.2	29.2
29.3	29.3
29.4	29.4
29.5	29.5
29.6	29.6
29.7	29.7
29.8	29.8
29.9	29.9
30.0	30.0
30.1	30.1
30.2	30.2
30.3	30.3
30.4	30.4
30.5	30.5
30.6	30.6
30.7	30.7
30.8	30.8
30.9	30.9
31.0	31.0
31.1	31.1
31.2	31.2
31.3	31.3
31.4	31.4
31.5	31.5
31.6	31.6
31.7	31.7
31.8	31.8
31.9	31.9
32.0	32.0
32.1	32.1
32.2	32.2
32.3	32.3
32.4	32.4
32.5	32.5
32.6	32.6
32.7	32.7
32.8	32.8
32.9	32.9
33.0	33.0
33.1	33.1
33.2	33.2
33.3	33.3
33.4	33.4
33.5	33.5
33.6	33.6
33.7	33.7
33.8	33.8
33.9	33.9
34.0	34.0
34.1	34.1
34.2	34.2
34.3	34.3
34.4	34.4
34.5	34.5
34.6	34.6
34.7	34.7
34.8	34.8
34.9	34.9
35.0	35.0
35.1	35.1
35.2	35.2
35.3	35.3
35.4	35.4
35.5	35.5
35.6	35.6
35.7	35.7
35.8	35.8
35.9	35.9
36.0	36.0
36.1	36.1
36.2	36.2
36.3	36.3
36.4	36.4
36.5	36.5
36.6	36.6
36.7	36.7
36.8	36.8
36.9	36.9
37.0	37.0
37.1	37.1
37.2	37.2
37.3	37.3
37.4	37.4
37.5	37.5
37.6	37.6
37.7	37.7
37.8	37.8
37.9	37.9
38.0	38.0
38.1	38.1
38.2	38.2
38.3	38.3
38.4	38.4
38.5	38.5
38.6	38.6
38.7	38.7
38.8	38.8
38.9	38.9
39.0	39.0
39.1	39.1
39.2	39.2
39.3	39.3
39.4	39.4
39.5	39.5
39.6	39.6
39.7	39.7
39.8	39.8
39.9	39.9
40.0	40.0
40.1	40.1
40.2	40.2
40.3	40.3
40.4	40.4
40.5	40.5
40.6	40.6
40.7	40.7
40.8	40.8
40.9	40.9
41.0	41.0
41.1	41.1
41.2	41.2
41.3	41.3
41.4	41.4
41.5	41.5
41.6	41.6
41.7	41.7
41.8	41.8
41.9	41.9
42.0	42.0
42.1	42.1
42.2	42.2
42.3	42.3
42.4	42.4
42.5	42.5
42.6	42.6
42.7	42.7
42.8	42.8
42.9	42.9
43.0	43.0
43.1	43.1
43.2	43.2
43.3	43.3
43.4	43.4
43.5	43.5
43.6	43.6
43.7	43.7
43.8	43.8
43.9	43.9
44.0	44.0
44.1	44.1
44.2	44.2
44.3	44.3
44.4	44.4
44.5	44.5
44.6	44.6
44.7	44.7
44.8	44.8
44.9	44.9
45.0	45.0
45.1	45.1
45.2	45.2
45.3	45.3
45.4	45.4
45.5	45.5
45.6	45.6
45.7	45.7
45.8	45.8
45.9	45.9
46.0	46.0
46.1	46.1
46.2	46.2
46.3	46.3
46.4	46.4
46.5	46.5
46.6	46.6
46.7	46.7
46.8	46.8
46.9	46.9
47.0	47.0
47.1	47.1
47.2	47.2
47.3	47.3
47.4	47.4
47.5	47.5
47.6	47.6
47.7	47.7
47.8	47.8
47.9	47.9
48.0	48.0
48.1	48.1
48.2	48.2
48.3	48.3
48.4	48.4
48.5	48.5
48.6	48.6
48.7	48.7
48.8	48.8
48.9	48.9
49.0	49.0
49.1	49.1
49.2	49.2
49.3	49.3
49.4	49.4
49.5	49.5</