

## Cordless Cellular Shades

---

# INSTALLATION INSTRUCTIONS

## NOTICE

Thank you for purchasing our products.

Please read the installation instructions carefully to familiarize yourself with safe and effective usage before use. In addition, keep the installation instructions handy when using the product.

The brackets and screws apply to the wooden window frames, plasterboard walls and concrete walls, but they cannot be installed onto the window frames or ceiling which are not made up of wood, plasterboard and concrete.

Please check the materials and hardness of the window frames or ceiling before installation.

Ensure to comply with the number of brackets and installation location required in the installation instructions when installing the products. Improper installation could cause the shades to drop and bring damage to health or property.

Please do not hang any items on the product or pull the product roughly or fiercely.

The product is only suitable for indoor use and not for outdoor use.

Please do not use the product in a high-heat or humid environment (such as saunas or furnaces), or near an open flame.

Please close the window or push the shades up during high winds, otherwise the strong winds could cause the damage to the product or an accident.

Please do not place any items which can interfere with operating the shades within a range of moving up and down.

Please feel free to email us if you have any question : [hello@grandekorshop.com](mailto:hello@grandekorshop.com)



## Details of Parts Included in Package

A

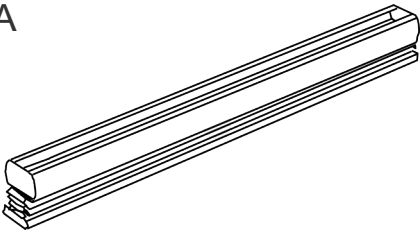

1 x Cellular Shade

B

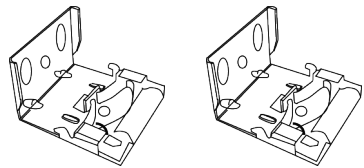

2 x Brackets

C



4 x Screws

D



1 x Handle



## How to install

1. Decide on and mark the position of the two brackets with a pencil, using pencil marks as a guide, start the screw hole by drilling (wood and plasterboard and concrete surfaces only). Holding the brackets (B) in place, secure with screws.

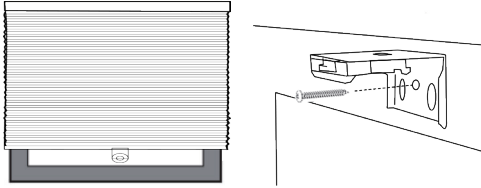

Outside Mount

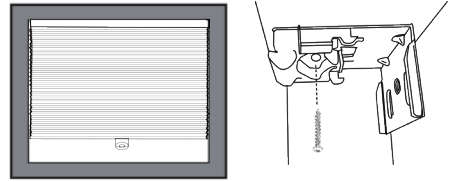

Inside Mount

2. Mount the shade into the brackets

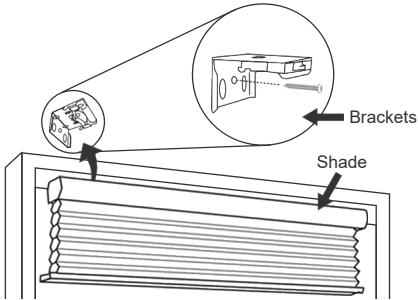

- ① Hang the frontside of the headrail on front lip of the white plastic part.

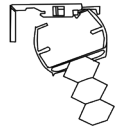

- ② Rotate headrail backward toward window until you hear "Click".

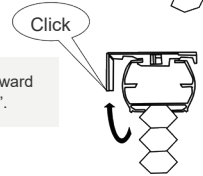

## How to Operate the Shade

Down: Lower the shade by pulling the handle of the bottom rail down gently.

Up: Raise the shade by pushing the handle of the bottom rail up gen.

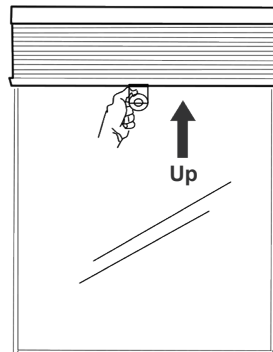
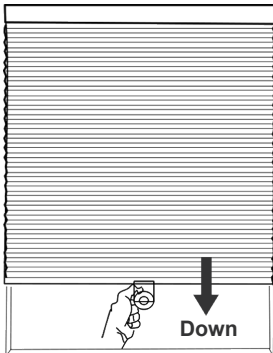



## How to Remove the Headrail from the Brackets

Raise the whole shade to the top, then grab both rails and push the front of the headrail forward, rotate the backward of the headrail down.

