

## Mechanical Blind Assembly

**Table: Bill of Materials**

ITEM NO.	DESCRIPTION	QTY
1	IDLER END BRACKET	1
2	GEAR BOX & BRACKET	1
3	R-CLIP	1
4	PIVOT PIN	1
5	BLIND ASSEMBLY	1
6	SHOOT BOLT LEFT	1
7	SHOOT BOLT RIGHT	1
8	CRANK HANDLE	1
9	HEAVY DUTY CHANNEL	2

### Heavy Duty Channel

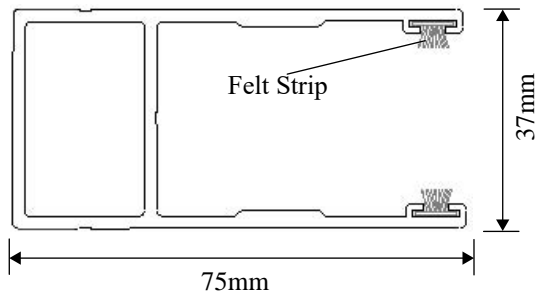

### Mounting Bracket

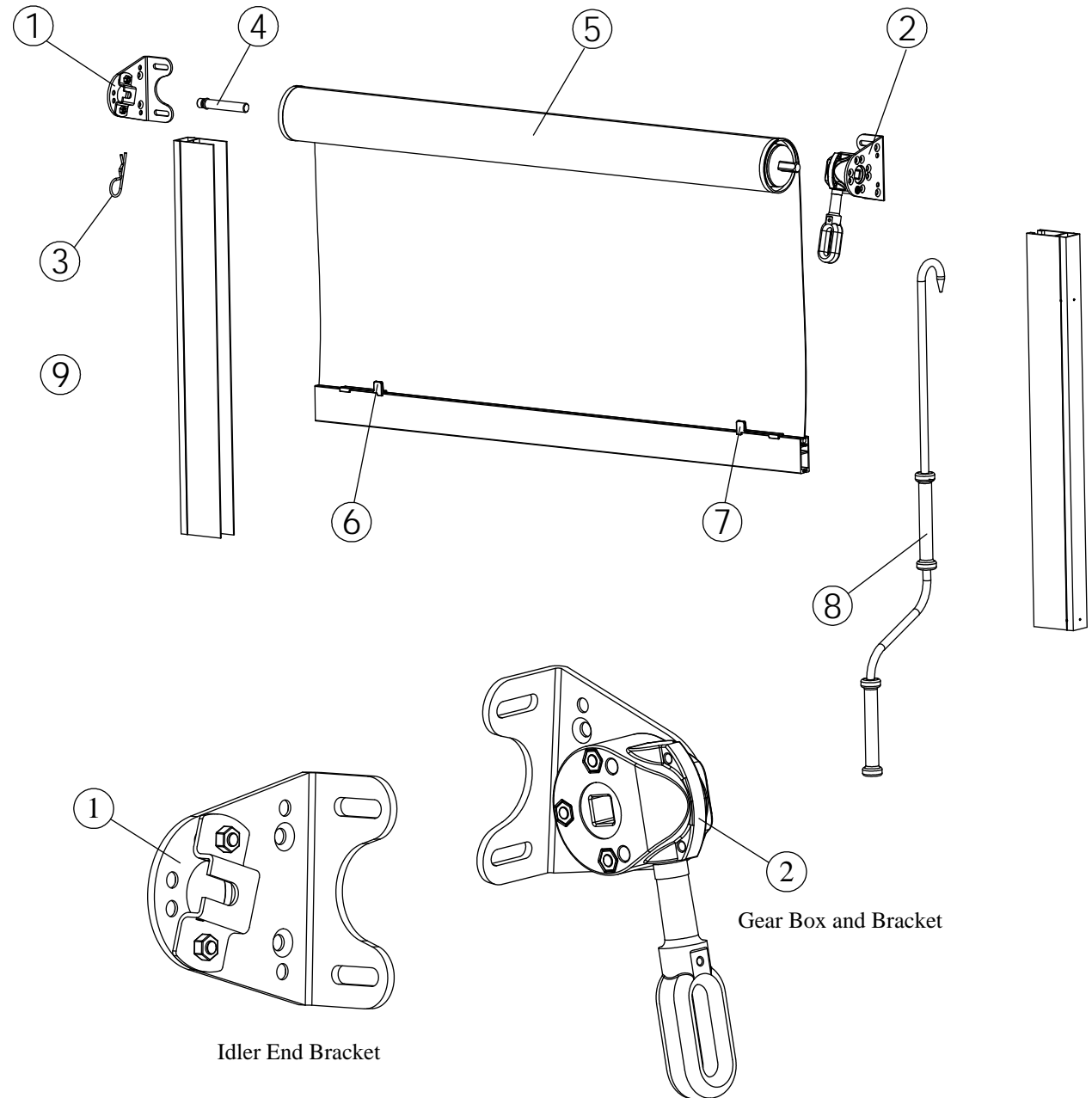
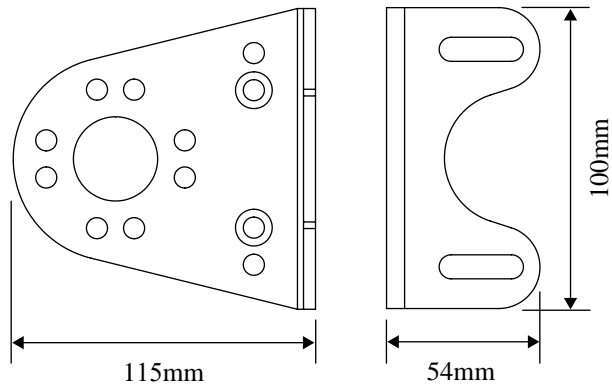

Assemble top brackets - reveal mount or face mount.

Idler End

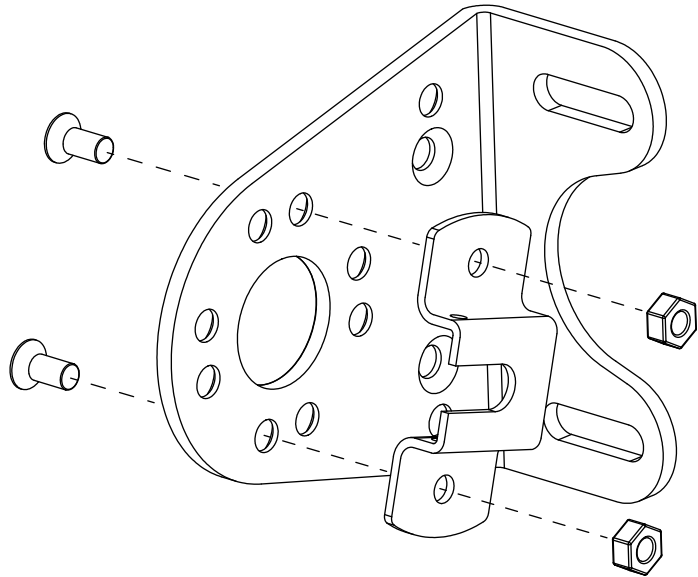

Drive End

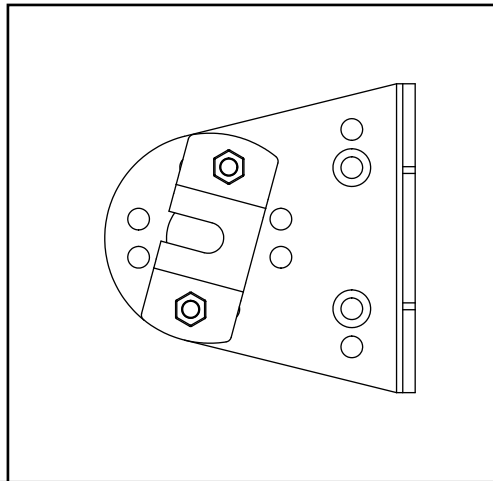
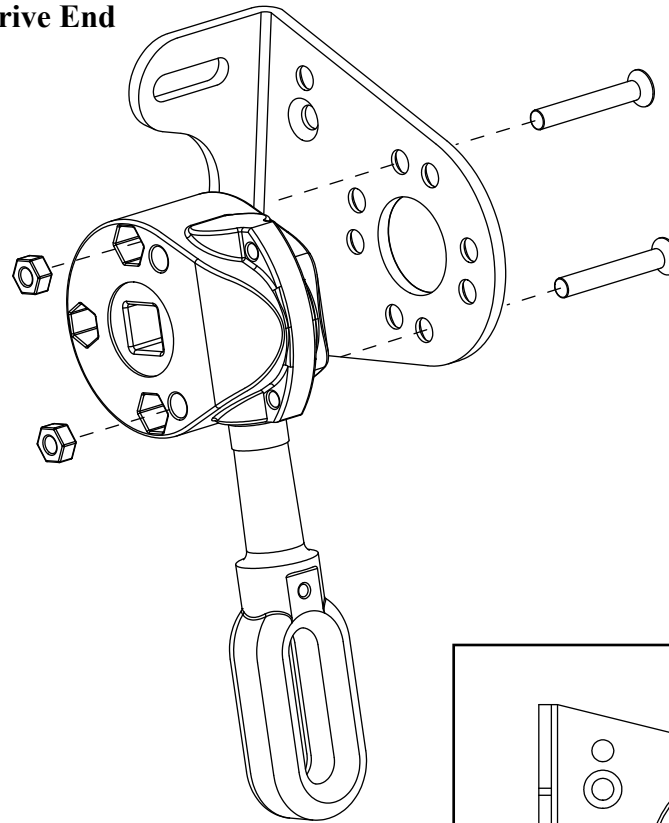

Secure idler end to bracket as shown.

 The control side is the side with the Gearbox attached.  
Right Hand Control Shown.

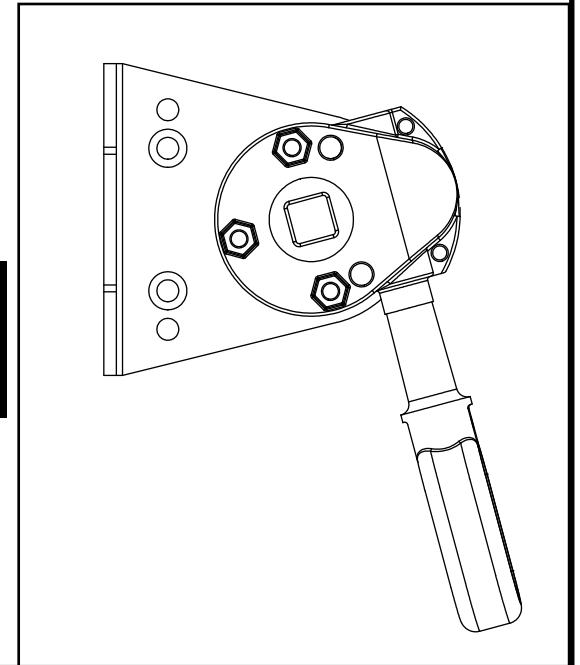

Secure gearbox to bracket as shown.

## Install top brackets - reveal mount or face mount.

**Important Note:**  
 Brackets come as a pair.  
 The control is the side with the gearbox or motor adaptor attached.  
 Gearboxes are only available in black or white.

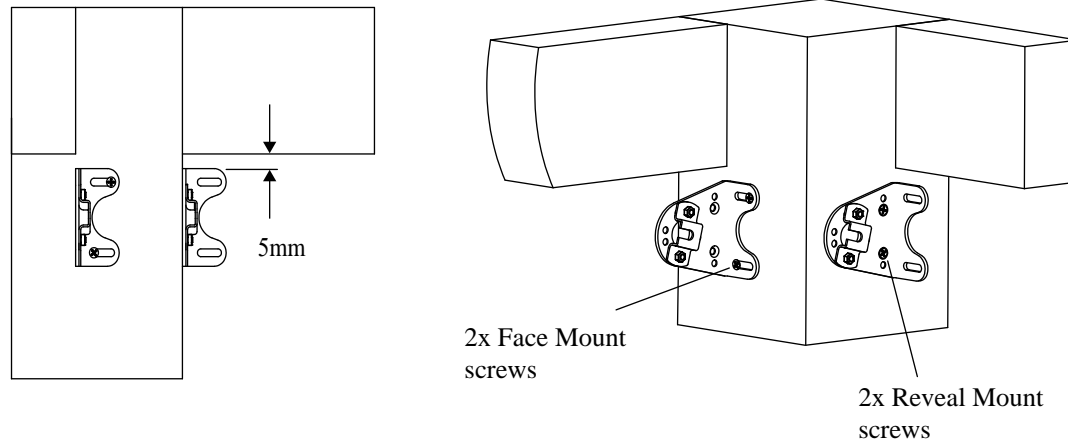

**1** Fix brackets either *Face Mount* or *Reveal Mount* 5mm below the bottom face of structure.

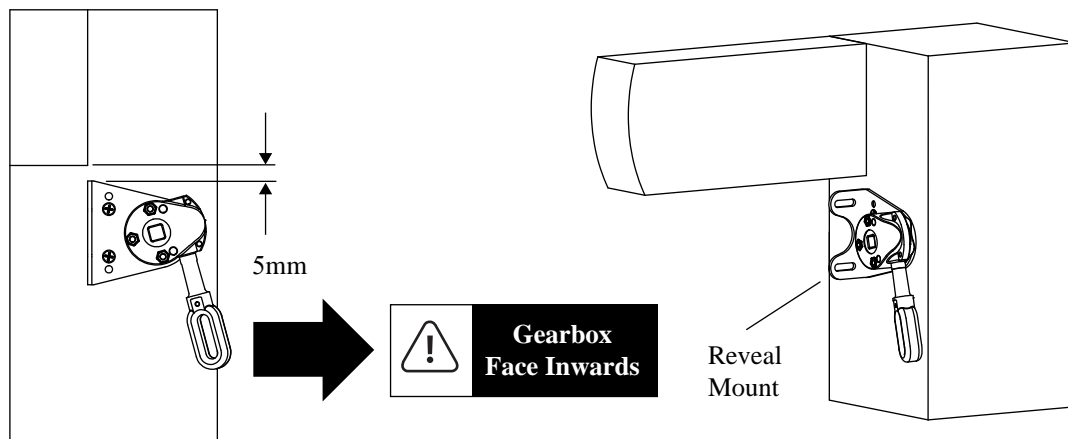

Fix bracket with gearbox either *Face Mount* or *Reveal Mount* 5mm below the bottom face of the structure.

**2** **!** Install gearbox facing inwards.

## Install channels - reveal mount or face mount.

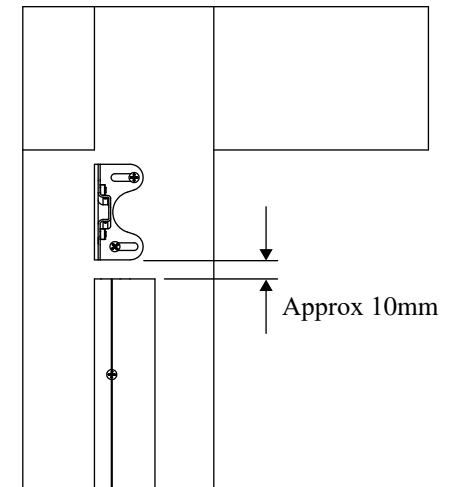

**Face Mount**

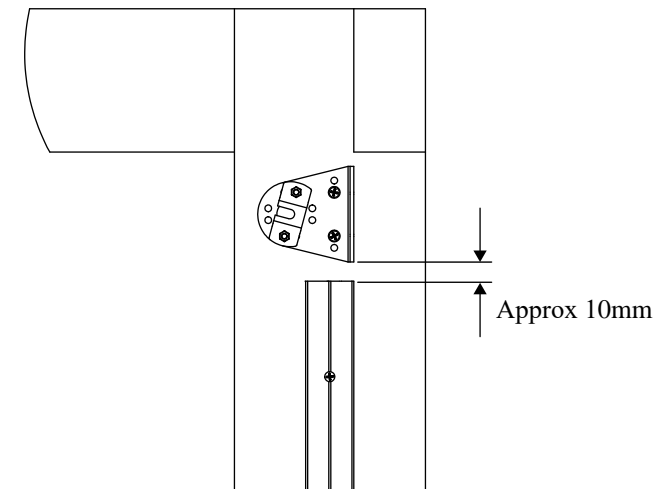

**Reveal Mount**

Cut Channels to size (115mm less than opening size to allow for brackets and clearances).

**3** Align back edge of the channel with the back edge of the brackets and 10mm below the bottom edge.

## Install channels - reveal mount or face mount (continued).

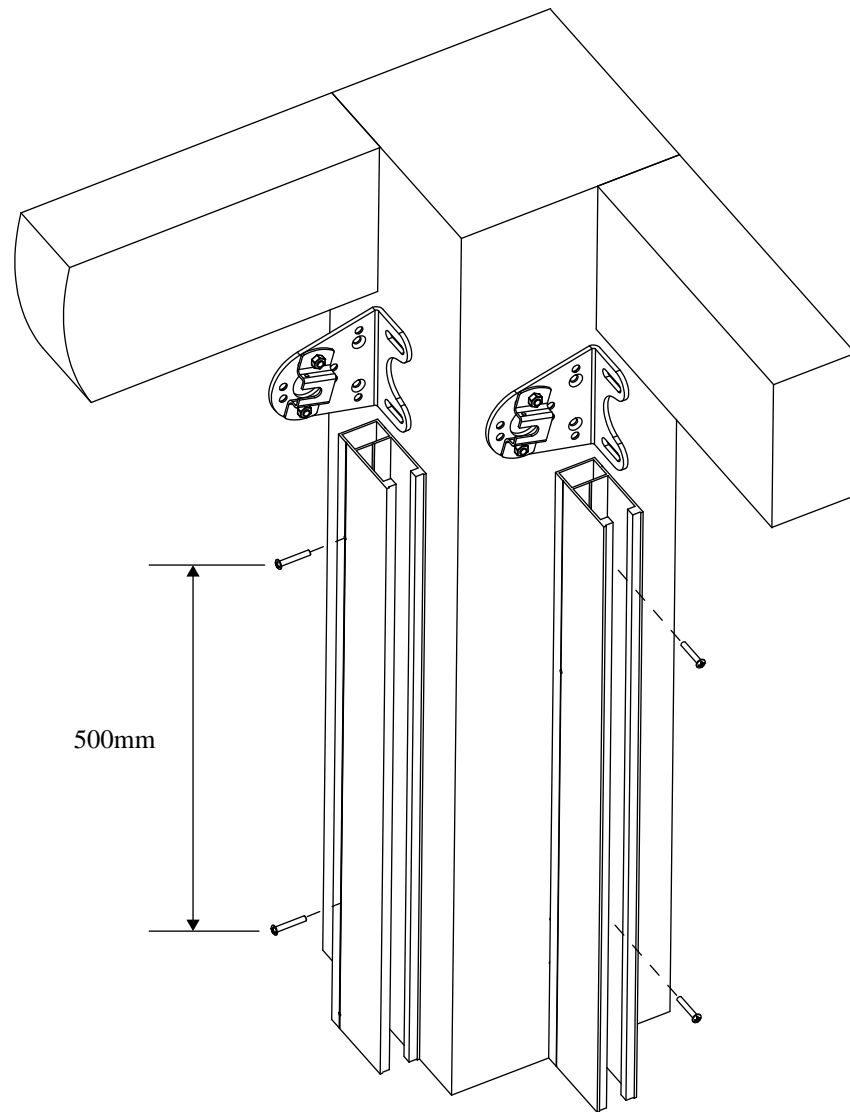

1) Attach channel with a minimum of five screws evenly spaced, maximum of 500mm spacing between screw fixings.

⚠ Depending on the structure (metal/timber/masonry), pilot holes may be required and longer screws necessary for thicker structures.

4

Align screws  
with groove

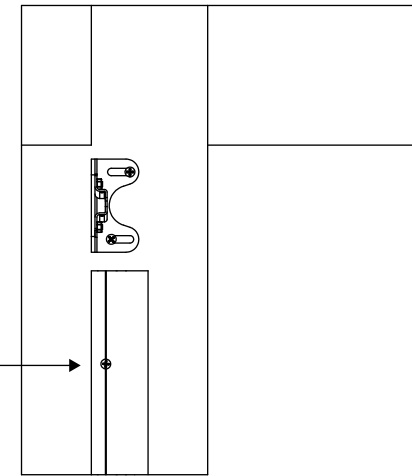

Face Mount

Fix screws to the front face along the groove of the channel.

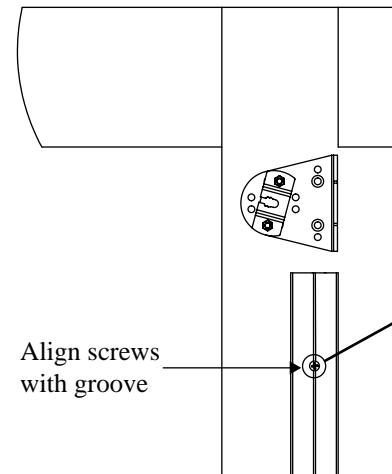

Align screws  
with groove

Reveal Mount

Fix screws to the inside face along the groove center of the channel.

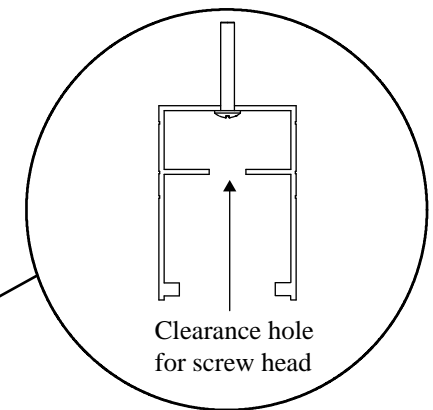

Clearance hole  
for screw head



**Reveal Mount - Drill a  
clearance hole into the section.**

- 5
- 1) Align screws with groove on channel for *Face Mount* or *Reveal Mount*.
  - 2) Drill a clearance hole for the screw head to pass through into the rear cavity of the section for a *Reveal Mount*.

## Mounting the blind - Mechanical or Motorised.

**Important Note:**  
Unwind the blind two turns before fitting it to the brackets.

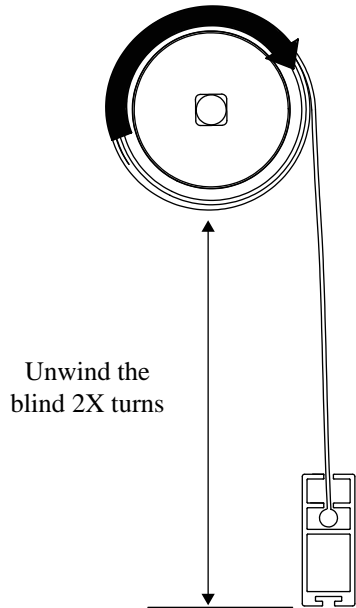

Unwind the blind 2X turns

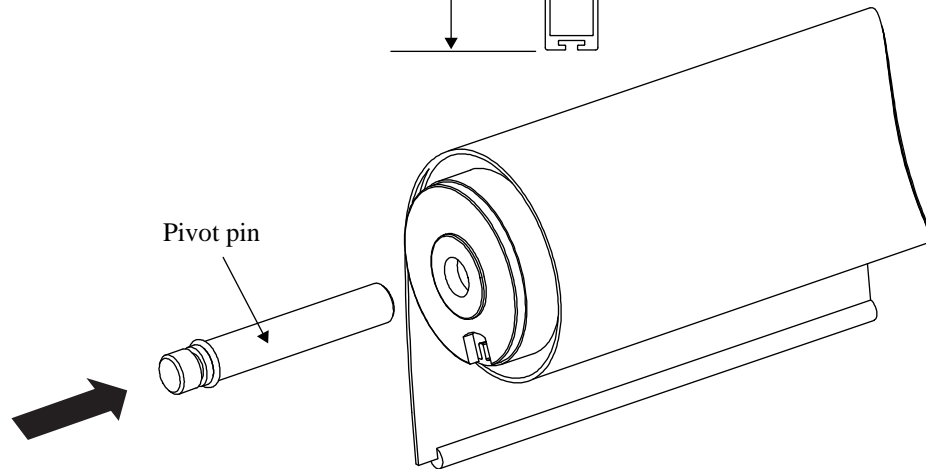

Pivot pin

6

Insert the pivot pin into the hole in the end of the idler.

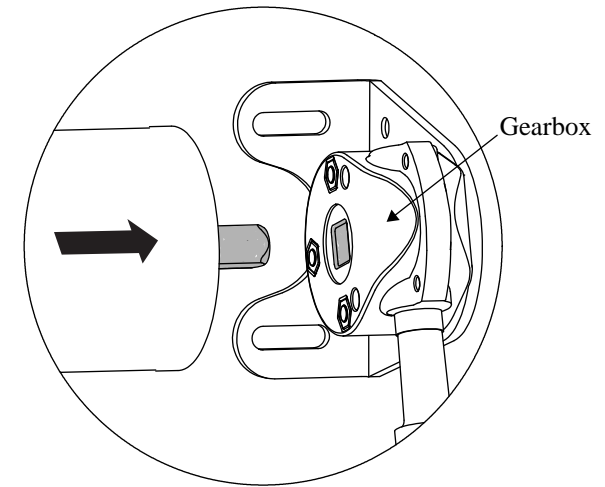

Gearbox

7

**MECHANICAL BLIND** - Align and insert the square pin of the drive end into the gearbox.

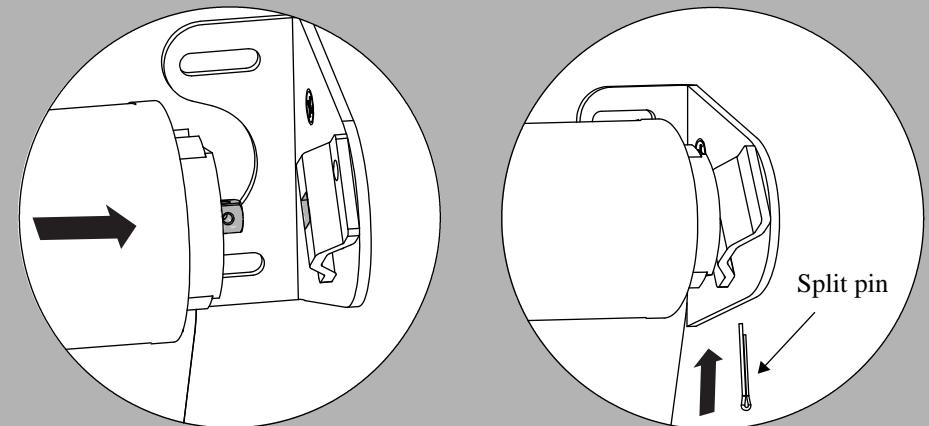

Split pin

**MOTORISED BLIND** - Align and insert the square pin of the drive end into the square hole in the bracket. Then insert split pin into hole in drive end to secure.

Refer to the *Motor Program Quick Guide* to connect power to the blind.

8

**Important Note:** Motor must be set up in step-mode.

## Mounting the blind - Mechanical or Motorised (continued).

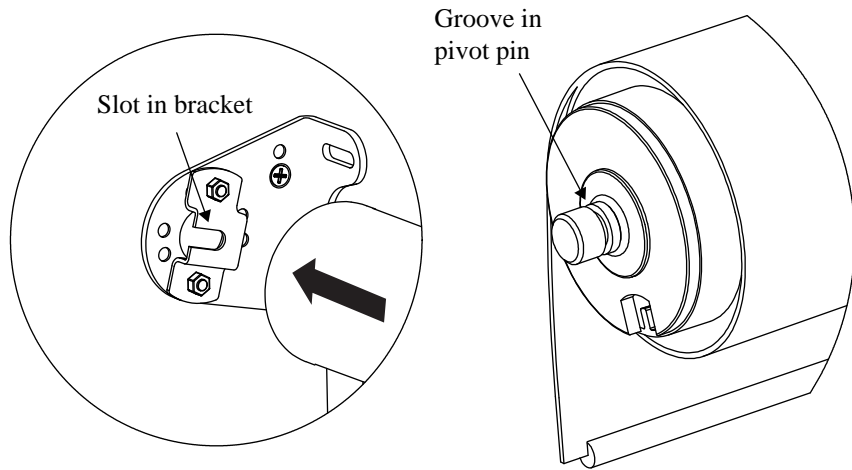

**9** Align and locate the groove on the pivot pin into slot in the idler bracket.

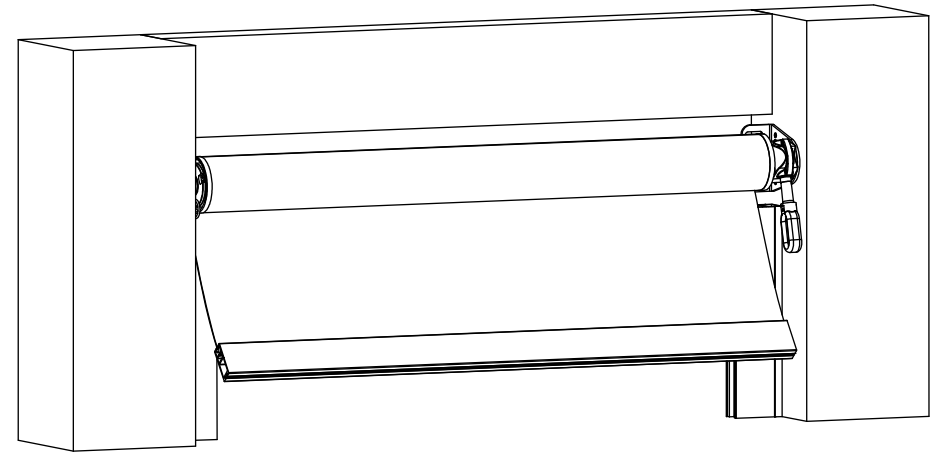

**11** The blind is in position for both Mechanical and Motorised versions.

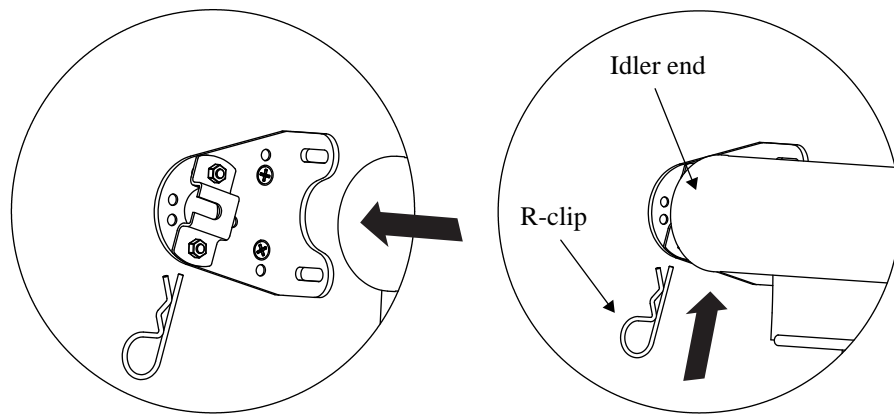

**10** Align R-clip with the two holes in the bracket and secure idler end.

## Install left and right shoot bolts.

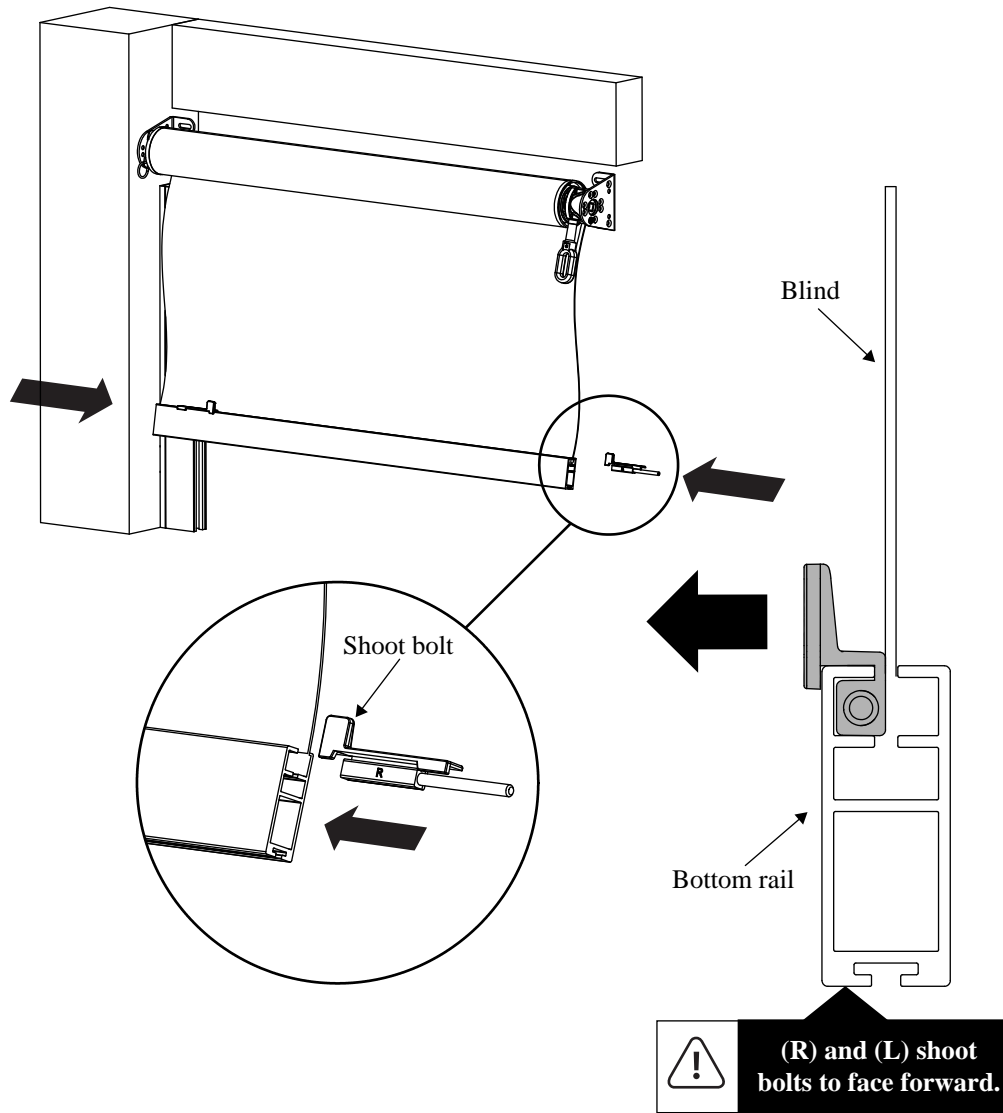

12 Insert the right side (R) shoot bolt into the right side of the bottom rail and the left side (L) shoot bolt from the left side.

**!** The shoot bolts slide inside the bottom rail section and forward of the blind.

## Mounting the bottom rail into the channel.

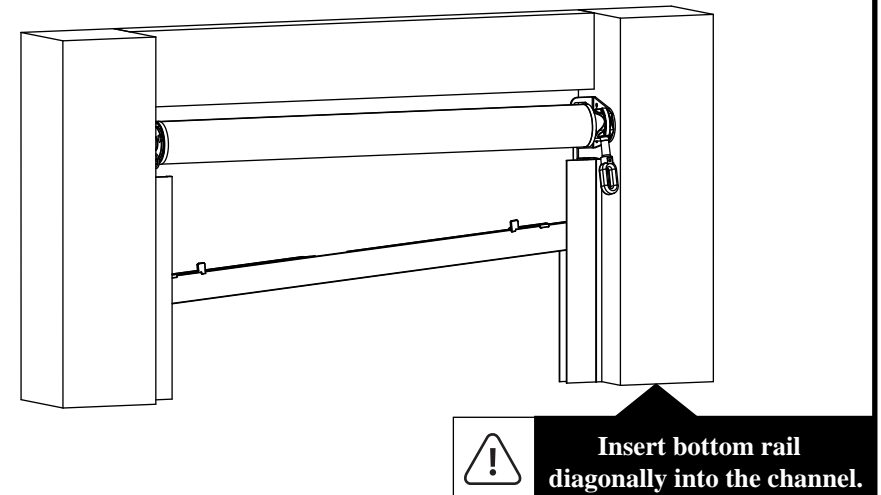

13

Carefully align and insert the bottom rail diagonally into the channels, fitting one side first before the other.

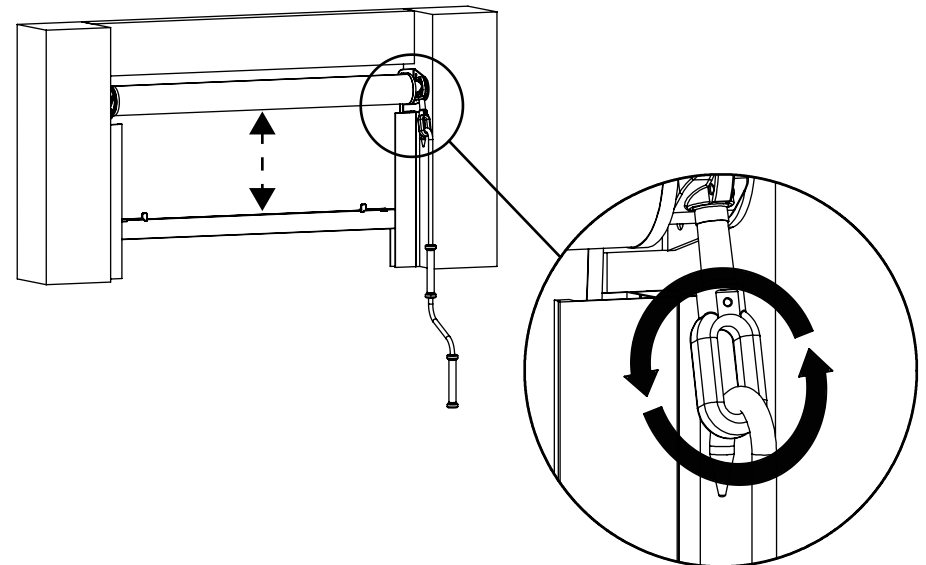

14

With the blind in position, use the crank handle or remote control to raise and lower the blind to the desired position.

## Secure the blind and set the shoot bolt position.

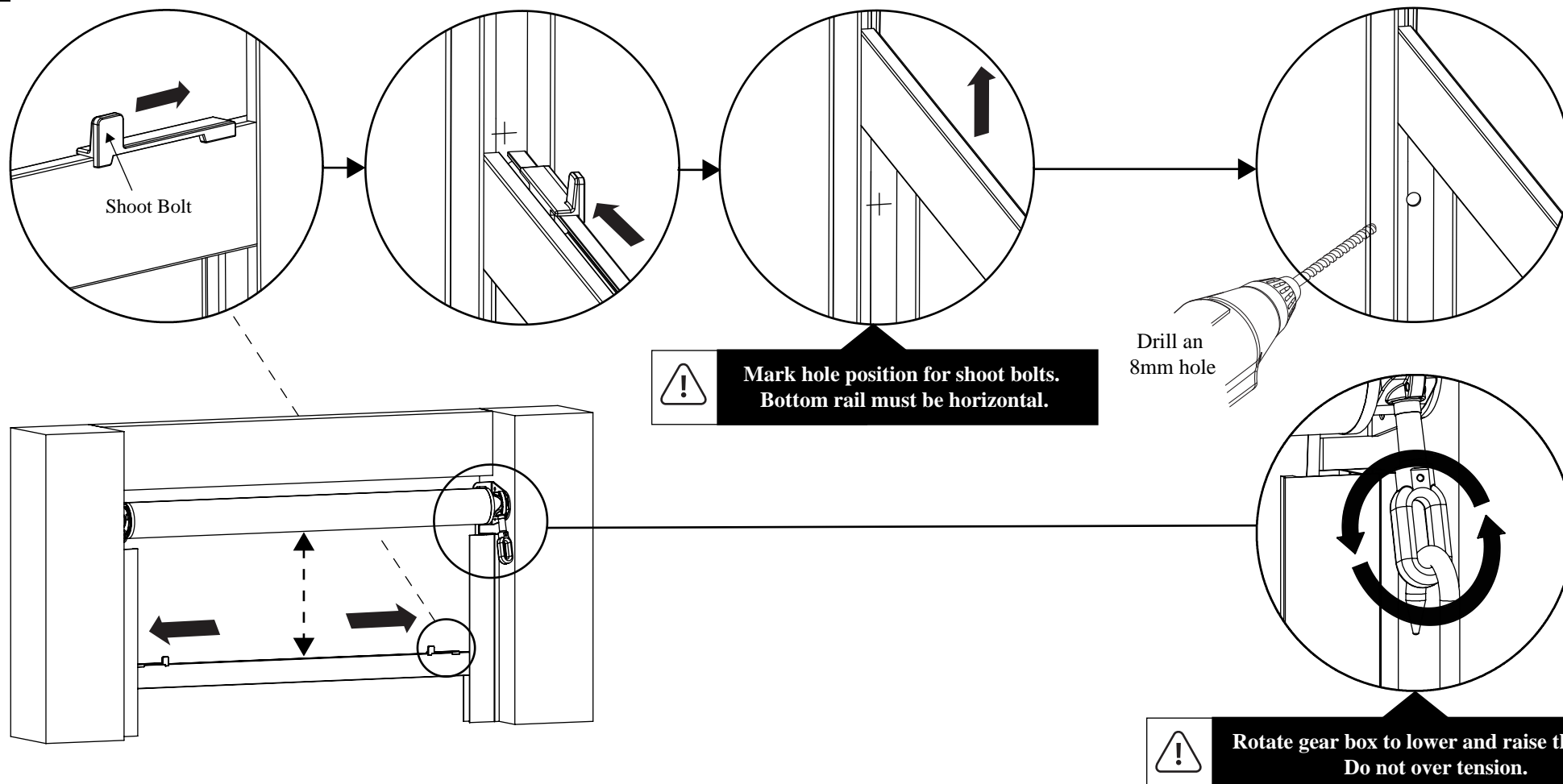

- 1) Push the shoot bolts into both channels to determine where to drill the bolt hole.
- 2) Mark the hole position on the inside of the channel.
- 3) Raise the blind and drill an 8mm hole into the channel, repeat for the other side.
- 4) Slide the shoot bolts into the holes to secure the blind.
- 5) Rotate gear box to raise and lower the blind.

⚠ Do not over tension blind.

### DISCLAIMER

We guarantee that all our products will be free from defects in components and manufacture for a period of **twelve months** from the date of purchase.

All goods supplied are guaranteed against mechanical default in normal domestic use and the supplier will repair or replace at its discretion such components that prove faulty in operation. Damage caused by accidents, alterations, misuse, abuse or wear and tear are not covered by this warranty.

Under the guarantee, the supplier shall not be liable or responsible for incidental or consequential damages or for any other direct or indirect damage, loss, cost, expense or fee. The benefits conferred by this Guarantee are in addition to all other rights and services which the purchaser has under the Trade Practices Act 1974 and similar state and territory laws.

All warranties are conditional. For the warranty to be valid, customers must strictly adhere to both the installation and care instructions provided. The warranty does not cover variances in colours and textures from batch to batch. In addition, a receipt providing proof of purchase is required for any warranty claims.