

LiftMate TXL Range Manual Scissor Lift Table

Our TXL range of scissor lift tables consist of medium to heavy duty single and double manual lift tables which are easy to operate. The tables are used for a variety of work functions and are therefore versatile lifting aids within industrial, workshop, warehouse and other environments. We can offer galvanized and stainless steel versions. Different table tops (e.g. rotating, with rollers, ball bearings) can be fitted to most tables and we can also design and build completely bespoke versions to match your requirements.



FEATURES & BENEFITS

- Capacity range from 150 kg to 1500kg
- Heavy duty design
- Great stability & manoeuvrability
- Foot pump to lift platform
- Hand lever to release/lower platform
- Can be used safely at any height
- Special bespoke designs available
- Both swivel wheels are fitted with a total stop brakes as standard

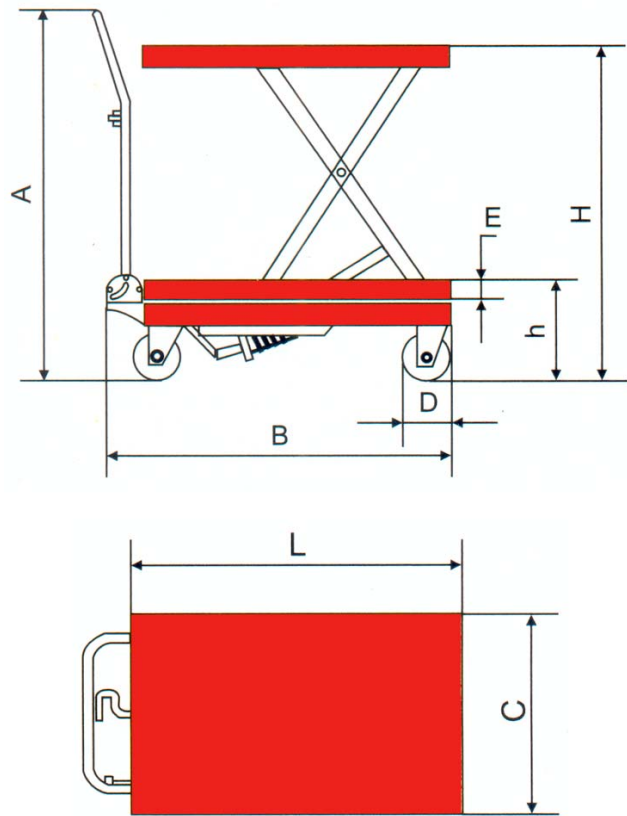

Technical Specifications

Model		TXL150	TXL200	TXL300	TXL500	TXL500L	TXL800	TXL1000	TXL1500
Lift		Manual	Manual	Manual	Manual	Manual	Manual	Manual	Manual
Capacity	kg	150	200	300	500	500	800	1000	1500
Platform size (C x L)	mm	450 x 700	500 x 1000	500 x 855	500 x 855	800 x 1600	510 x 1000	515 x 1015	610 x 1220
Lift height (h - H)	mm	225 - 740	340 - 1000	340 - 915	280 - 910	310 - 910	420 - 1000	380 - 1010	420 - 1010
Pump strokes to max.height	#	23	18	25	48	42	48	50	52
Handle height (A)	mm	935	1055	970	970	970	970	970	970
Wheel diameter (D)	mm	100	200	125	125	125	150	150	150
Overall length incl. pedal (B)	mm	930	1120	1080	1100	1820	1320	1320	1570
Weight	kg	43	70	75	79	134	115	121	142

Note: 720mm
O/A width

Model		TXL150D	TXL350D	TXL680D	TXL800D
Lift		Manual	Manual	Manual	Manual
Capacity	kg	150	350	680	800
Platform size (C x L)	mm	450x700	500 x 910	610x1210	610 x 1220
Lift height (h - H)	mm	310-1120	350 - 1300	475 - 1510	485 - 1500
Pump strokes to max.height	#	16/30	46	25 / 70	90
Handle height (A)	mm	920	970	1020	970
Wheel diameter (D)	mm	100	125	150	150
Overall length incl. pedal (B)	mm	930	1130	1490	1590
Weight	kg	47	103	176	181

All tables conform to:

BS-EN1570 (Safety Requirements for Lifting Tables)

BS EN 292 (Safety of Machinery – Basic Concepts Parts 1 and 2)