

Submersible UTILITY PUMPS

Specifications

ITEM#	660021	660022	660024	660025
MAX. FLOW RATE (GPH)	423	568	873	976
MAX. FLOW RATE (LPH)	1,600	2,150	3,300	3,700
Dimensions (in.)	6.88 x 3.18 x 4.52	6.88 x 3.18 x 4.52	7.55 x 3.54 x 5.11	7.55 x 3.54 x 5.11
Discharge	1/2" MPT	1/2" MPT	3/4" MPT	3/4" MPT
Power Cord (ft.)	6.5	6.5	6.5	6.5
Voltage	120V, 60Hz	120V, 60Hz	120V, 60Hz	120V, 60Hz
Amps	0.25	0.46	0.55	0.72
Power Factor	0.73	0.87	0.98	0.98
Watts	21	46	61	82
Max. Pumping Head (ft.)	9.5	9.5	12.3	12.3
Max. Pumping Head (m)	2.9	2.9	3.75	3.75

Flow Rate At Height

ITEM#	660021		660022		660024		660025	
	Gallons	Liters	Gallons	Liters	Gallons	Liters	Gallons	Liters
0 ft.	423	1,600	568	2,150	873	3,306	976	3,696
1.6 ft.	373	1,413	506	1,915	753	2,850	867	3,283
3.3 ft.	331	1,254	446	1,687	632	2,394	761	2,880
4.9 ft.	277	1,048	307	1,162	572	2,166	729	2,760
6.5 ft.	138	524	187	706	542	2,052	710	2,688
8.2 ft.	54	205	273	72	434	1,641	634	2,400
9.8 ft.	0	0	0	0	187	706	596	2,256
11.4 ft.	0	0	0	0	85	320	146	552



423 GPH
1600 LPH

568 GPH
2150 LPH

873 GPH
3300 LPH

976 GPH
3700 LPH

Customer Support
Call 1-888-548-3480
customersupport@aquaticlife.com

For more information on this product and for a complete list of other quality Aquatic Life products visit www.AquaticLife.com

Submersible UTILITY PUMPS

Item#	Description
660021	423 GPH 1600 LPH
660022	568 GPH 2150 LPH
660024	873 GPH 3300 LPH
660025	976 GPH 3700 LPH

Aquatic Life submersible pumps are designed with gardening applications in mind.

Each cUL approved high head pump features a special intake shield that allows operation in low water levels.

- Heavy-duty utility pump with thermal protection built for hydroponic applications
- Pump intake design promotes efficient operation in low water installations
- Top power cord configuration allows for easy routing of cord out of reservoirs

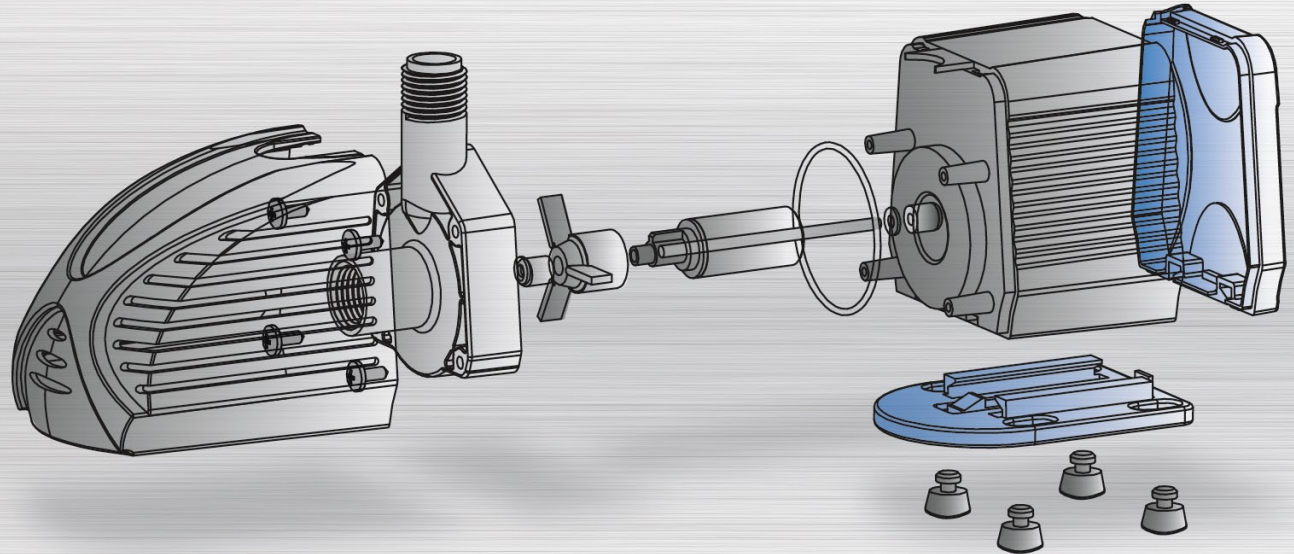

Standard pipe threads for easy installation



Power cord exits top of the pump for easier reservoir placement



Intake cover design allows for pump operation in low-water level conditions



Removable base with rubber feet to minimize noise from pump operation