

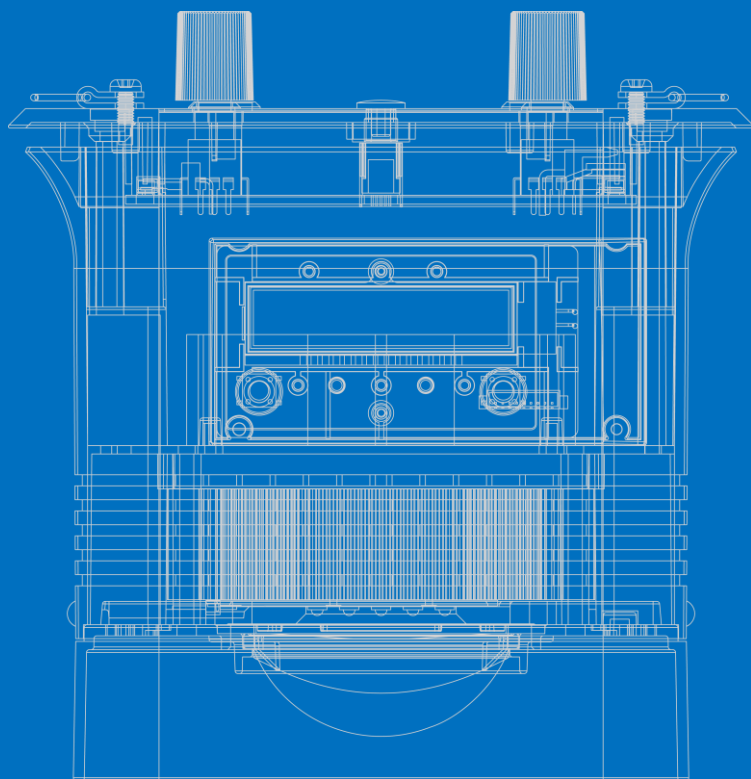

Halo Programmable LED Aquarium Light

Quick Start Guide



LIGHTING
FOR LIFE

**TIAO
JIYOU**

www.tiaojiou.com

1. FEATURES

- **25 LED array delivering rich color spectrum**
- **Two groups (channels) of LEDs to optimize the light**
- **Embedded Timers and Dimming Control**
- **Stylish design**

2. SAFETY INSTRUCTIONS

A) READ AND FOLLOW ALL SAFETY INSTRUCTIONS.

B) DANGER – To avoid possible electric shock, special care should be taken since water is employed in the use of aquarium equipment. For each of the following situations, do not attempt repairs by yourself; return the appliance to an authorized service facility for service or discard the appliance:

- 1. If the appliance falls into the water, DON'T reach for it! First unplug it and then retrieve it. If electrical components of the appliance get wet, unplug the appliance immediately. (Non-immersible equipment only)
- 2. If the appliance shows any sign of abnormal water leakage, immediately unplug it from the power source. (Immersible equipment only)
- 3. Carefully examine the appliance after installation. It should not be plugged in if there is water on parts not intended to be wet.
- 4. Do not operate any appliance if it has a damaged cord or plug, or if it is malfunctioning or has been dropped or damaged in any manner.
- 5. To avoid the possibility of the appliance plug or receptacle getting wet, position aquarium stand and tank to one side of a wall-mounted receptacle to prevent water from dripping onto the receptacle or

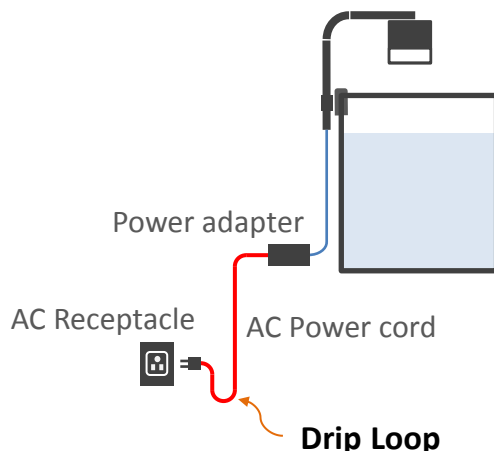

plug. A "drip loop," shown in the figure on the left, should be arranged by the user for each cord connecting an aquarium appliance to a receptacle. The "drip loop" is that part of the cord below the level of the receptacle, or the connector if an extension cord is used, to prevent water traveling along the cord and coming in contact with the receptacle. If the plug or receptacle does get wet, DON'T unplug the cord. Disconnect the fuse or circuit breaker that supplies power to the appliance. Then, unplug and examine for presence of water in the receptacle.

C) Close supervision is necessary when any appliance is used by or near children.

D) To avoid injury, do not contact moving parts or hot parts such as heaters, reflectors, lamp bulbs, and the like.

E) Always unplug an appliance from an outlet when not in use, before putting on or taking off parts, and before cleaning. Never yank the cord to pull the plug from outlet. Grasp the plug and pull to disconnect.

F) Do not use an appliance for other than intended use. The use of attachments not recommended or sold by the appliance manufacturer may cause an unsafe condition.

G) Do not install or store the appliance where it will be exposed to the weather or to temperatures below freezing.

H) Make sure an appliance mounted on a tank is securely installed before operating it.

I) Read and observe all the important notices on the appliance.

J) If an extension cord is necessary, a cord with a proper rating should be used. A cord rated for less amperes or watts than the appliance rating may overheat. Care should be taken to arrange the cord so that it will not be tripped over or pulled.

K) For added safety, the appliance must be plugged into a receptacle controlled by a GFCI (ground fault interrupter) circuit breaker. The device must be properly connected to a grounded three-prong receptacle.

L) This appliance is intended FOR HOUSEHOLD USE ONLY.

M) This Light unit is required to be used over a covered aquarium. A glass top or protective barrier is required to minimize the unit's exposure to water.

N) SAVE THESE INSTRUCTIONS

3. SPECIFICATIONS

	Marine Deluxe MX80	Marine Deluxe MX110	Marine Basic M80	Marine Basic M110
Lens Emission Angle	80 degrees	110 degrees	80 degrees	110 degrees
LED Array Structure	25 LED (UV + Cool White + Blue + Royal Blue)			
LED Light Characteristic	<p>■ channel 1: full spectrum of ocean blue light 400-480nm LED included: UV 400nm x1, UV 420nm x1, Royal Blue x2, Blue 465nm x2, Blue 470nm x5, Blue 475nm x2, Blue 480nm x4</p> <p>■ channel 2: high Kelvin white light simulating neritic zone LED included: Blue 470nm x4, Cool White x4.</p>			
Dimensions (Light Unit)	L13.4 x W13.4 x H13.8 cm L5.3 x W5.3 x 5.5 in		L13.4 x W13.4 x H12.5 cm L5.3 x W5.3 x 4.9 in	
Weight (Light Unit)	730g / 1.61lbs	720g / 1.59lbs	690g / 1.52lbs	680g / 1.50lbs
Power Consumption	85W at maximum intensity (DC 33V)		85W at maximum intensity (DC 33V)	

	Fresh Deluxe FX80	Fresh Deluxe FX110	Fresh Basic F80	Fresh Basic F110
Lens Emission Angle	80 degrees	110 degrees	80 degrees	110 degrees
LED Array Structure	25 LED (UV + Cool White + Warm White + Blue + Royal Blue + Red)			
LED Light Characteristic	<p>■ channel 1: full spectrum of grow light 400-680nm for anthocyanin stimulations LED included: UV 400nm x1, UV 420nm x1, Royal Blue x2, Cool White x4, Red 625nm x1, Cool White x8.</p> <p>■ channel 2: warm white light for flowering and harvest LED included: Warm White x8.</p>			
Dimensions (Light Unit)	L13.4 x W13.4 x H13.8 cm L5.3 x W5.3 x 5.5 in		L13.4 x W13.4 x H12.5 cm L5.3 x W5.3 x 4.9 in	
Weight (Light Unit)	730g / 1.61lbs	720g / 1.59lbs	690g / 1.52lbs	680g / 1.50lbs
Power Consumption	85W at maximum intensity (DC 33V)		85W at maximum intensity (DC 33V)	



Halo Basic

Halo Deluxe

4. PARTS DIAGRAM

a) Basic Unit (M80, M110, F80, F110)

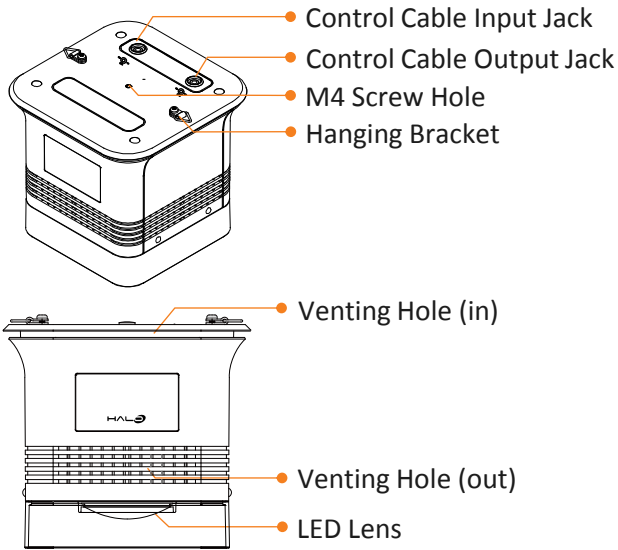

b) Deluxe Unit (MX80, MX110, FX80, FX110)

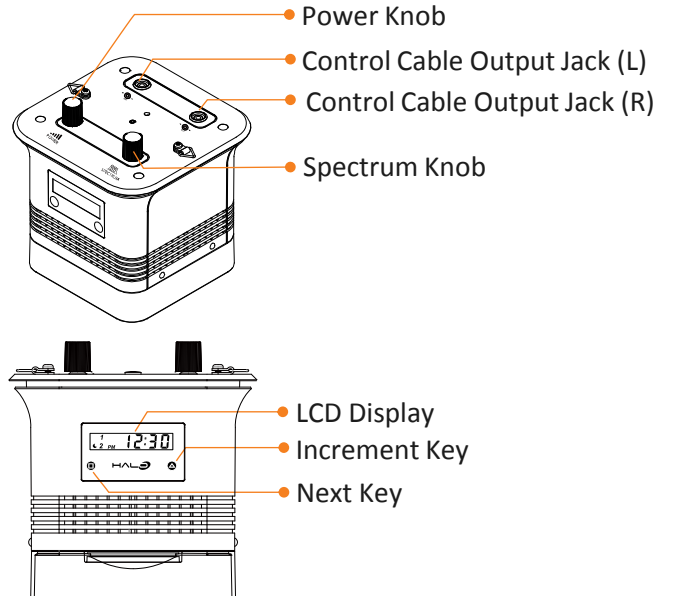

5. POWER ADAPTER CONNECTION

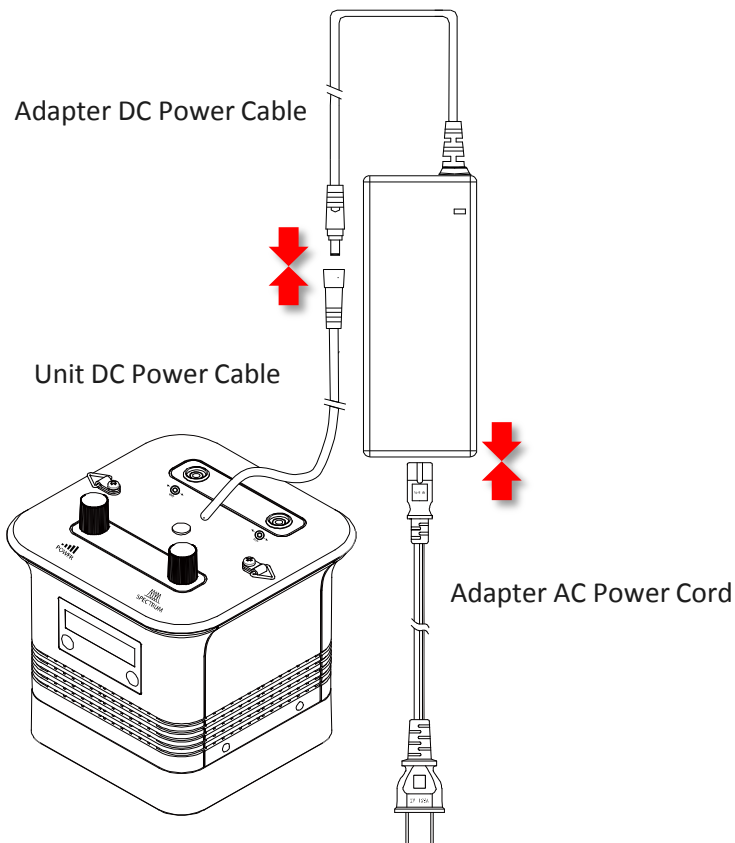

6. MULTIPLE UNITS LINKAGE

a) Minimum System

The simplest architecture of your aquarium light will comprise a single HALO Deluxe unit. The Deluxe HALO plays both roles as the LED light and the programmable controller.

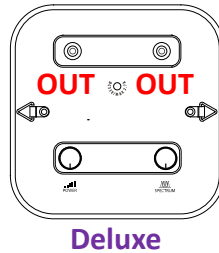

b) Expanded System

If more than one light is required for your aquarium, you can link HALO Basic lights to the HALO Deluxe unit simply by plugging in the control cable. All of the HALO Basic lights will synchronize with the HALO Deluxe unit automatically.

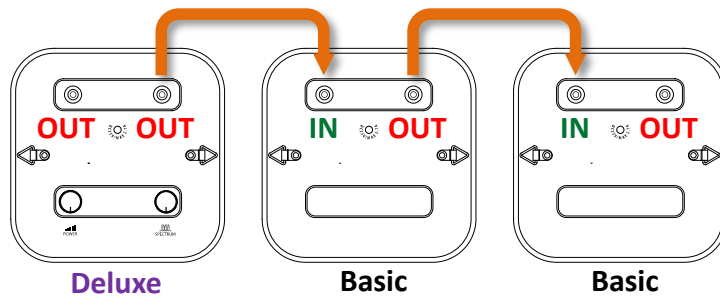

c) Large (two-side Linkage) System

HALO Basic units can be linked to the HALO Deluxe unit from both sides to allow great flexibility in the arrangement of the aquarium light system.

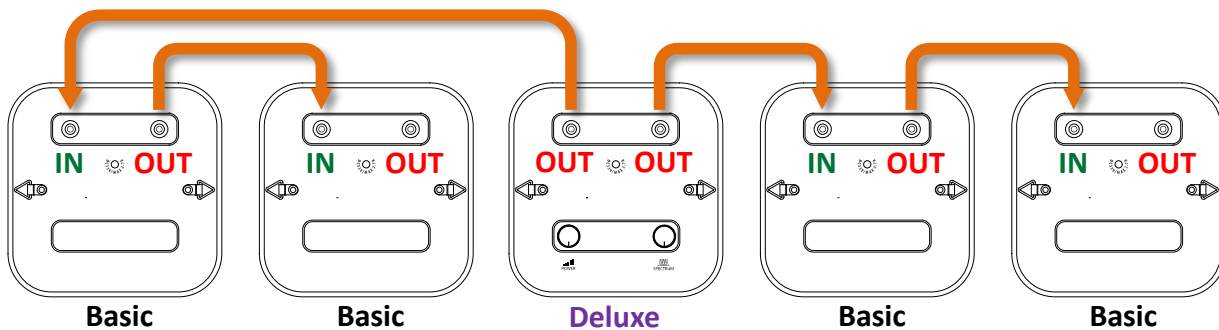

*Please note that synchronization may slow as the quantity of linked unit increases.

7. CLOCK AND TIMER SETTING



Next Key

Increment Key

a) General Guide

Things to consider before setting the clock and timer:

- Flashing backlight means clock adjustment is needed, and the timer is reset to factory settings.
- Channel 1 controls the ocean blue light for Marine unit, and grow light for Fresh unit.
- Channel 2 controls the high Kelvin white light for Maine unit, and warm white light for Fresh unit.
- Moonlight activates Channel 1 at 10% power.
- All channels can be run simultaneously or consecutively.
- The Sunrise/Sunset applies to Channel 1 & Channel 2.
- The same steps used to program Channel 1 are used to program Channel 2 and Moonlight.
- The Sunrise begins at the START time.
(8:00 START with 2 hr. ramp = FULLY UP at 10:00)
- The Sunset begins at the END time.
(8:00 END with 2 hr. ramp = FULLY DOWN at 10:00)
- When programming the button advances to the next setting.
- When programming the button advances the time.
- Before programming, ensure that power is supplied to the unit.
- If left idle for 30 seconds the timer will exit "program" mode.
- Once programmed each channel must manually be turned on.
- If left idle for 7 seconds the timer will exit "channel on/off" mode.

The timer comes pre-programmed.

- o Channel 1: Start 8:00 am / End 8:00 pm
- o Channel 2: Start 10:00 am / End 5:00 pm
- o Moonlight: Start 8:00 pm / End 12:00 am
- o Sunrise/Sunset: Duration 0:10

Mapping out your start and end times before set up is advised.

- o Channel 1: Start ___:___ / End ___:___
- o Channel 2: Start ___:___ / End ___:___
- o Moonlight: Start ___:___ / End ___:___
- o Sunrise/Sunset: Duration ___:___

b) Setting the Clock and Timer

1. To enter program mode hold down for 1 second and then press the . Release both when the hour on the clock begins to flash.
2. Use to increase the hours to the desired time.
3. Press to move to the minutes.
Use to increase the minutes on the clock.
4. Press to move to the Start Hour for Channel 1.
Use to increase the hour.
5. Press to move to Start Minutes for Channel 1.
Use to increase the minutes.
6. Press to move to the End Hour for Channel 1.
Use to increase the hour.
7. Press to move to the End Minutes for Channel 1.
Use to increase the minutes.
8. Repeat steps 4-7 for Channel 2 and Moonlights
9. Press to move to the Sunrise/Sunset duration.
Use to increase in 10 min increments up to 2 hours.
10. Press to exit "program" mode.

c) Turning Channels ON/OFF

1. Press to enter "On/Off" mode.
Use to turn CH 1 on or off.
2. Press to move to Channel 2.
Use to turn CH2 on or off.
3. Press to move to Moonlight.
Use to turn CH on or off.

8. MAINTENANCE

The following maintenances can be carried out by the owner as needed:

1) If foreign material or heavy dust is found in the venting holes, unplug the power of the light unit and clean the venting holes with the compressed air can, same as you would for a computer.

2) If the LED lens is contaminated with water or dust, unplug the power of the light unit , wait for the lens to cool down, and then swab the lens gently with a clean and soft cloth or wet lens tissue. Alcohol should NOT be used.

9. TROUBLE SHOOTING

When the light unit flickers or fails to turn on:

1) Check and ensure the light unit is firmly connected to the power adapter, and the power adapter is plugged to the AC receptacle.

2) Check if venting holes are blocked by foreign material or dust. Clean it with compressed air can if they are. (the protection circuitry will force the LEDs to shut down when overheated)

3) Ensure the Clock and Timer are set correctly. Also make sure the Power Knob is not tuned to the minimum.

Tiaojiou Limited.

3F., No.76, Baozhong Rd.,
Xindian Dist., New Taipei City 23144,
Taiwan