

## INSTALLATION & MAINTENANCE GUIDE

# REVERSE OSMOSIS/ DEIONIZATION UNITS

Item #	Product Description
540085	60 GPD Deluxe
540086	100 GPD Deluxe
540087	100 GPD Power
540239	200 GPD Power



# TABLE OF CONTENTS



This symbol indicates “**WARNINGS**” that are essential in order to protect against injury to people or damage to equipment.



This symbol indicates “**NOTES**” that are specific instructions on how to operate, control, adjust or maintain the units.



This symbol indicates “**TIPS**” that are intended to offer helpful advice for a better user experience.

## DELUXE MODELS

#540085 & #540086

<b>Parts &amp; Specifications</b> .....	<b>3</b>
Parts Diagram .....	3
Product Specifications .....	3
<b>Installation</b> .....	<b>4</b>
Cartridge Placement .....	4
Mounting .....	4
Membrane Placement .....	5
Tubing Attachment .....	6
<b>Operation</b> .....	<b>7</b>
Water Supply .....	7
Flush Valve .....	7
Water Storage .....	7
<b>Maintenance</b> .....	<b>8</b>
Cartridge Replacement .....	8
Membrane Flushing .....	8
Service Record .....	8

## POWER MODELS

#540087 & #540239

<b>Safety Instructions</b> .....	<b>9</b>
Warnings .....	9
Grounding .....	9
<b>Parts &amp; Specifications</b> .....	<b>10</b>
Parts Diagram .....	10
Product Specifications .....	11
<b>Installation</b> .....	<b>12</b>
Cartridge Placement .....	12
Mounting .....	12
Membrane Placement .....	12
Tubing Attachment .....	12
<b>Operation</b> .....	<b>13</b>
Water Supply .....	13
Flush Valve (Automatic) .....	13
Low Pressure Switch .....	13
High Pressure Switch .....	13
Pressure Pump .....	13
Automatic Shut-off .....	13
Computer Controller .....	13
Water Storage .....	13

<b>Glossary of Terms</b> .....	<b>15</b>
<b>Registration &amp; Warranty</b> .....	<b>16</b>

<b>Maintenance</b> .....	<b>14</b>
Cartridge Replacement .....	14
Power Unit Wiring .....	14

## Thank you for purchasing an AquaticLife™ RO/DI System for use with your aquarium!

We know you value quality and innovation and will be pleased with this product's performance.

We encourage you to take a few minutes to become familiar with this manual and note items that apply to your particular model. For additional information, please visit [www.aquaticlife.com](http://www.aquaticlife.com).

Your purchase includes a coupon on the side of the box. Save Life Rewards™ point coupons from Aquatic Life products and redeem them for free merchandise at [www.aquaticlife.com](http://www.aquaticlife.com). This is our way of saying thank you for your loyalty.



Copyright © Aquatic Life, LLC  
All rights reserved.

No part of this document may be reproduced, stored in a retrieval system, or transmitted in any form or by any means without the prior written consent of Aquatic Life, LLC.

**Aquatic Life, LLC**  
Commerce, CA 90040  
Toll-Free US only: (888) 548-3480  
Outside the US: 1-818-768-6943  
[customersupport@aquaticlife.com](mailto:customersupport@aquaticlife.com)

Check us out on...



## PARTS DIAGRAM

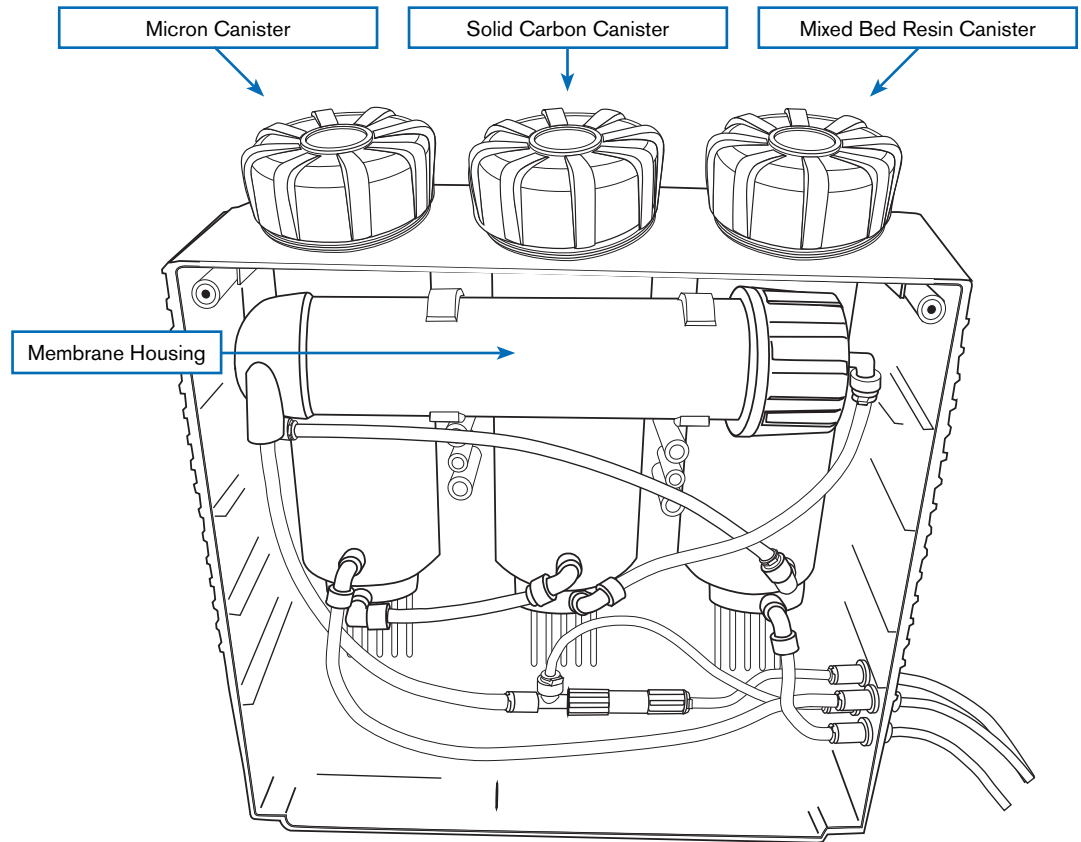

### PARTS LIST: For Reverse Osmosis Deluxe Unit (Models 540085 / 540086)

Mounting Hardware	✓
Canister Caps (blue)	3
Micron Cartridge	330088
Solid Carbon Block Cartridge	330090
Resin Cartridge (mixed bed)	330091
Reverse Osmosis Membrane	330092 / 330093
Flush Valve (manual)	✓
Canister Cap Wrench	✓
Membrane Wrench	✓
Tubing Blue 6.4 mm / 1/4"	3 m / 10 ft
Tubing Red 6.4 mm / 1/4"	2.7 m / 8.85 ft
Tubing Red 6.4 mm / 1/4"	2 x 10 cm & 1 x 20cm
Tubing Yellow 6.4 mm / 1/4"	3 m / 10 ft
Shut-off Valve	✓
Faucet Connection	✓
Installation & Maintenance Guide	✓
Mounting Template	✓

### PRODUCT SPECIFICATIONS: For Reverse Osmosis Deluxe Unit (Models 540085 / 540086)

Optimal water pressure:	60 psi
Maximum water pressure:	100 psi
Optimal water temperature:	77°F (25°C)
Maximum water temperature:	105°F (40.5°C)
Typical Rejection rate:	1:5.6
Dimensions: (L x W x H)	41 x 22 x 44 cm 16.2 x 8.7 x 17.4 in

## Tools required for installation:

- 1) Scissors & Adhesive Tape    2) Phillips #2 Screwdriver (5" or longer)    3) Drill – optional if mounting    4) Pencil

## CARTRIDGE PLACEMENT



**WARNING:** Unlike traditional RO units, the easy access top-loading design of this Aquatic Life RO unit positions the plumbing below the cartridges. For this reason, the Mixed Bed Resin cartridge must be placed with the gasket side down. Water will flow through the cartridge from the top to bottom.



**TIP:** Using the Canister Cap Wrench will ensure a tight seal and prevent leaks.

The reverse osmosis filter incorporates three top-loading canisters into the housing. The cartridges are to be installed and replaced by removing the blue canister caps on the top of the RO unit. The canister lids should be removed by hand or with the supplied Canister Lid Wrench.

- The first canister from the left houses the Micron Cartridge which removes particulate materials from the source water. It is recommended that this pre-filter cartridge be at least a 5 micron rating to remove the most amount of particulate in the water prior to the carbon filtration.
- The second canister, or center canister, houses the Solid Carbon cartridge. The Solid Carbon cartridge removes chlorines and other impurities from the water supply prior to passing through the membrane.
- The final canister, or right canister, houses a Mixed Bed Resin cartridge. This cartridge will help eliminate any remaining impurities found in the membrane-filtered water.

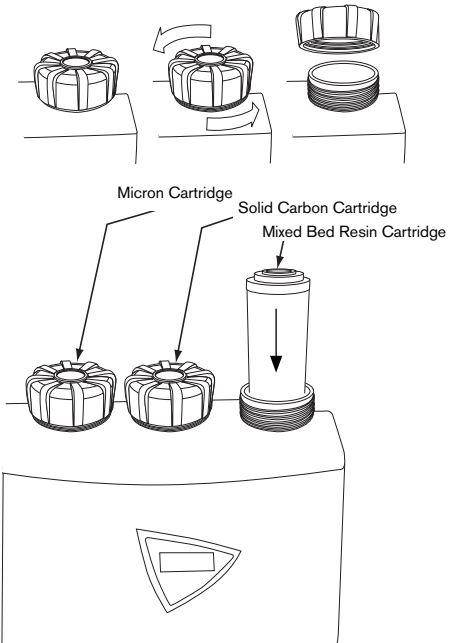

## MOUNTING

### Wall Mount – (suggested)

Using the supplied bracket and hardware, the RO unit can be mounted to a wall or flat surface.

- 1) Affix the included template to the surface to be mounted with non-marring tape.
- 2) Drive the screws through the template and into the surface to be mounted.
- 3) Remove the screws and the template from the surface.
- 4) Align the Mounting Plate with the two holes and drive the screws until tight.
- 5) Align the RO Housing with the Mounting Bracket and slide into place.



**TIP:** Use wall anchors when mounting the RO Unit to drywall. The RO Unit can weigh as much as 30 pounds when operating.

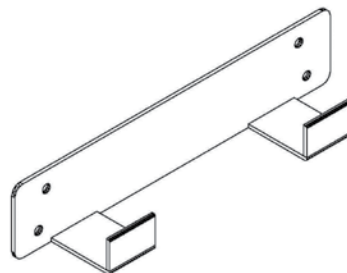

### Free Standing

The RO unit can also be used as a free standing portable unit. In this application, it is not necessary to mount the RO unit to the wall. The RO unit is equipped with white, non-marring plastic feet to allow placement on flat, level surfaces.

## MEMBRANE PLACEMENT

- 1) Detach the Front Cover by removing the four screws on the back side of the RO unit.



**TIP:** A minimum 5" length #2 Phillips screwdriver is recommended.

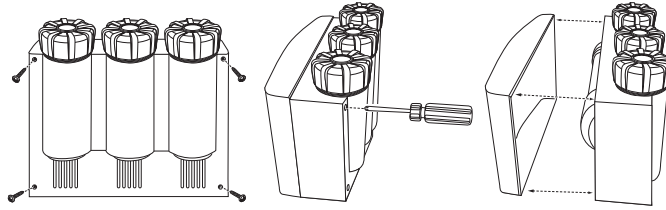

- 2) After removing the Front Cover, remove the yellow supply water line attached to the Membrane Housing. Remove the blue clip that secures the tubing to the connecting elbow.

- 3) After the clip is removed, push the protruding connection from the elbow toward the elbow to release the yellow tubing from the connection.

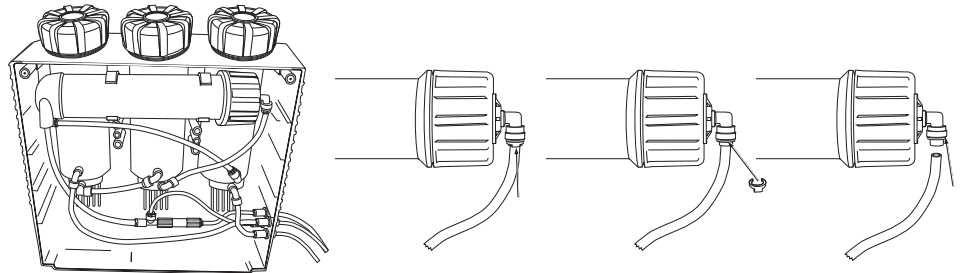

- 4) After the yellow tubing is detached, remove the Membrane Housing Lid.



**TIP:** Use the supplied wrench to remove the Membrane Housing Lid.



- 5) Remove the Membrane from the packaging before inserting the Membrane into the Housing.

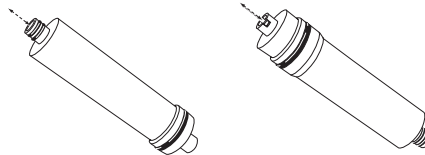

- 6) Insert the Membrane into the Membrane Housing.



**NOTE:** The Membrane MUST be placed into the Membrane Housing with the double o-ring end first. The black ring around the other end will be inserted into the Membrane Housing last.

- 7) After inserting the Membrane into the Membrane Housing, verify that the Membrane is properly installed. The top plug of the Membrane should be flush or even with the top of the Membrane Housing.

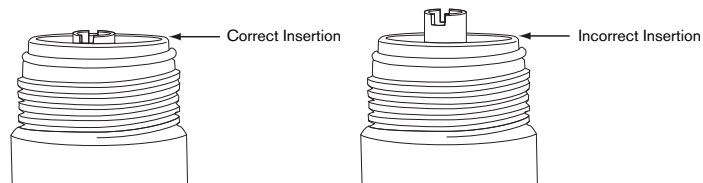

- 8) Replace the Membrane Lid and tighten with the supplied wrench. Reattach the yellow tubing and replace the blue clip to secure the tubing to the Membrane Housing. Proceed to the tubing installation process prior to replacing the Front Cover.

## TUBING ATTACHMENT

The right side of the RO unit will have four connections as depicted below:

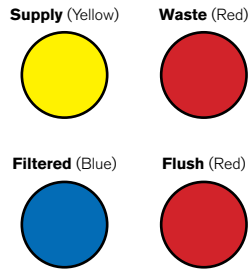

**NOTE:** Before attaching the tubing, remove the blue clips and protective plugs from the housing attachments.

### Flush Connection:

This RO unit includes a manual Flush Valve for cleaning the Membrane. There are three small pieces of red tubing included with the RO.

- 1) Insert one piece of red 10 cm tubing into the FLUSH connection on the RO unit.
- 2) Attach the supplied Flush Valve to the other end of the red tubing.
- 3) Attach the remaining piece of 10 cm red tubing into the other end of the valve.

### Waste Connection:

- 1) Insert the red 20 cm tubing into the WASTE connection on the RO unit.
- 2) There are now two sections of red tubing attached to the side of the RO unit—one with a valve in the middle. Next attach both red tubing ends to the supplied T.
- 3) Attach the piece of red 2.7 m tubing to the open end of the T. This single red tube will discharge the waste water from the unit.

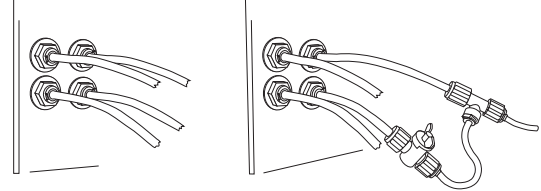

### Supply Connection:

- 1) Insert the yellow 3 m tubing into the SUPPLY connection on the RO unit.
- 2) The RO unit includes an attachment to adapt to a standard threaded utility sink or garden hose. With the faucet connection installed, insert the other end of the yellow 3 m tubing into the adaptor.



### Filtered Connection:

- 1) Insert the blue 3 m tubing into the blue FILTERED connection on the RO unit.
- 2) Attach the supply shut-off valve to the other end of the blue tubing.



**WARNING:** When using a new Membrane for the first time, DO NOT use the first 30 gallons of filtered water produced from the RO unit for aquariums. The Membrane includes a preservative that is removed during initial water contact.

## WATER SUPPLY

With all tubing connections in place, turn on the supply water to the RO unit. Check to ensure that all connections are secure and there are no leaks. If all connections are secure and water tight, replace the RO unit's Front Cover and replace the four screws that were removed.

## FLUSH VALVE

Flushing the Membrane is critical to obtaining peak performance from the RO unit. Flushing clears debris build-up on the Membrane. The Deluxe RO unit includes a valve that is attached to the outside (see Tubing Attachment) and is labeled, FLUSH (red). To flush the Membrane, open the valve for 30 seconds when the RO unit is first supplied with water. This valve allows the water to bypass the flow restrictor located inside the RO unit housing. After 30 seconds turn the valve off. Water is now forced to pass through the flow restrictor and pressure will build against the Membrane and filtered water production will resume.



**TIP:** Store RO filtered water in a clean plastic barrel with lid for easy mixing of saltwater for marine aquaria.

## WATER STORAGE

Reverse Osmosis filtered water can be stored in covered or sealed containers for future use.

# DELUXE UNIT MAINTENANCE

## CARTRIDGE REPLACEMENT

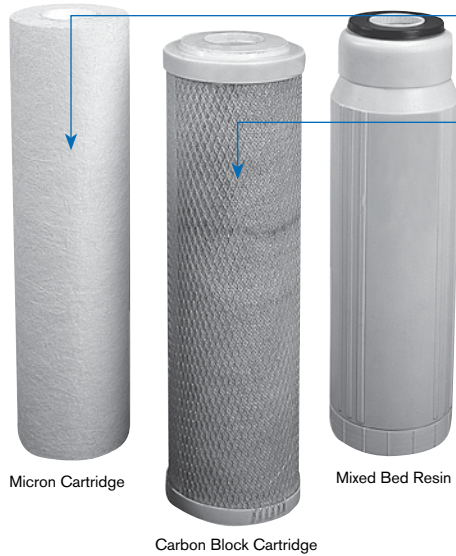

**Micron Cartridge (Item # 330088)**

Replace the Micron Cartridge every six months or 3,000 gallons, whichever comes first. As the cartridge fills with particulate material, it will restrict water flow and reduce the overall performance of the RO unit.

**Carbon Block Cartridge (Item # 330090)**

Replace the Carbon Block every six months or 3,000 gallons, whichever comes first. As the cartridge fills with particulate material, it will restrict water flow and reduce the overall performance of the RO unit.

**Mixed Bed Resin Cartridge (Item # 330091)**

The Mixed Bed Resin Cartridge should be replaced when the Total Dissolved Solids (TDS) level of the filtered water is above 3% of the incoming source water TDS level. This level can be calculated by dividing the TDS level of the filtered water, by the TDS level of the source water. This value will show the % of TDS in the filtered water.

**Membrane**

The Membrane should be replaced every two years or when an increased TDS level is found even after a new Mixed Bed Resin Cartridge is installed.

## MEMBRANE FLUSHING

Flush the Membrane before each use to prolong the life of the Membrane.

## SERVICE RECORD

Micron Cartridge (replace every 6 months)	
Date Replaced	___ / ___ / 20__
Date Replaced	___ / ___ / 20__
Date Replaced	___ / ___ / 20__
Date Replaced	___ / ___ / 20__
Date Replaced	___ / ___ / 20__
Date Replaced	___ / ___ / 20__
Date Replaced	___ / ___ / 20__
Date Replaced	___ / ___ / 20__
Date Replaced	___ / ___ / 20__
Date Replaced	___ / ___ / 20__
Date Replaced	___ / ___ / 20__
Date Replaced	___ / ___ / 20__
Date Replaced	___ / ___ / 20__
Date Replaced	___ / ___ / 20__
Date Replaced	___ / ___ / 20__
Date Replaced	___ / ___ / 20__
Date Replaced	___ / ___ / 20__
Date Replaced	___ / ___ / 20__
Date Replaced	___ / ___ / 20__
Date Replaced	___ / ___ / 20__
Date Replaced	___ / ___ / 20__
Date Replaced	___ / ___ / 20__

Carbon Block Cartridge (replace every 6 months)	
Date Replaced	___ / ___ / 20__
Date Replaced	___ / ___ / 20__
Date Replaced	___ / ___ / 20__
Date Replaced	___ / ___ / 20__
Date Replaced	___ / ___ / 20__
Date Replaced	___ / ___ / 20__
Date Replaced	___ / ___ / 20__
Date Replaced	___ / ___ / 20__
Date Replaced	___ / ___ / 20__
Date Replaced	___ / ___ / 20__
Date Replaced	___ / ___ / 20__
Date Replaced	___ / ___ / 20__
Date Replaced	___ / ___ / 20__
Date Replaced	___ / ___ / 20__
Date Replaced	___ / ___ / 20__
Date Replaced	___ / ___ / 20__
Date Replaced	___ / ___ / 20__
Date Replaced	___ / ___ / 20__
Date Replaced	___ / ___ / 20__
Date Replaced	___ / ___ / 20__
Date Replaced	___ / ___ / 20__

Mixed Bed Resin Cartridge (replace as needed)	
Date Replaced	___ / ___ / 20__
Date Replaced	___ / ___ / 20__
Date Replaced	___ / ___ / 20__
Date Replaced	___ / ___ / 20__
Date Replaced	___ / ___ / 20__
Date Replaced	___ / ___ / 20__
Date Replaced	___ / ___ / 20__
Date Replaced	___ / ___ / 20__
Date Replaced	___ / ___ / 20__
Date Replaced	___ / ___ / 20__
Date Replaced	___ / ___ / 20__
Date Replaced	___ / ___ / 20__
Date Replaced	___ / ___ / 20__
Date Replaced	___ / ___ / 20__
Date Replaced	___ / ___ / 20__
Date Replaced	___ / ___ / 20__
Date Replaced	___ / ___ / 20__
Date Replaced	___ / ___ / 20__
Date Replaced	___ / ___ / 20__
Date Replaced	___ / ___ / 20__
Date Replaced	___ / ___ / 20__



# SAFETY INSTRUCTIONS



## WARNING

TO GUARD AGAINST INJURY, BASIC PRECAUTIONS SHOULD BE OBSERVED, INCLUDING THE FOLLOWING:

- A) **READ AND FOLLOW ALL SAFETY INSTRUCTIONS.**
- B) **DANGER** – To avoid possible electric shock, special care should be taken since water is employed in the use of aquarium equipment. For each of the following situations, do not attempt repairs by yourself; return the appliance to an authorized service facility for service or discard the appliance:
  - 1) If the appliance falls into the water, DON'T reach for it! First unplug it and then retrieve it. If electrical components of the appliance get wet, unplug the appliance immediately. (Non-immersible equipment only)
  - 2) If the appliance shows any sign of abnormal water leakage, immediately unplug it from the power source. (Immersible equipment only)
  - 3) Carefully examine the appliance after installation. It should not be plugged in if there is water on parts not intended to be wet.
  - 4) Do not operate any appliance if it has a damaged cord or plug, or if it is malfunctioning or has been dropped or damaged in any manner.
  - 5) To avoid the possibility of the appliance plug or receptacle getting wet, position aquarium stand and tank to one side of a wall-mounted receptacle to prevent water from dripping onto the receptacle or plug. A "drip loop," shown in the figure below, should be arranged by the user for each cord connecting an aquarium appliance to a receptacle. The "drip loop" is that part of the cord below the level of the receptacle, or the connector if an extension cord is used, to prevent water traveling along the cord and coming in contact with the receptacle. If the plug or receptacle does get wet, DON'T unplug the cord. Disconnect the fuse or circuit breaker that supplies power to the appliance. Then, unplug and examine for presence of water in the receptacle.
- C) Close supervision is necessary when any appliance is used by or near children.
- D) To avoid injury, do not contact moving parts or hot parts such as heaters, reflectors, lamp bulbs, and the like.
- E) Always unplug an appliance from an outlet when not in use, before putting on or taking off parts, and before cleaning. Never yank cord to pull plug from outlet. Grasp the plug and pull to disconnect.
- F) Do not use an appliance for other than intended use. The use of attachments not recommended or sold by the appliance manufacturer may cause an unsafe condition.
- G) Do not install or store the appliance where it will be exposed to the weather or to temperatures below freezing.
- H) Make sure an appliance mounted on a tank is securely installed before operating it.
- I) Read and observe all the important notices on the appliance.
- J) If an extension cord is necessary, a cord with a proper rating should be used. A cord rated for less amperes or watts than the appliance rating may overheat. Care should be taken to arrange the cord so that it will not be tripped over or pulled.
- K) For added safety, the appliance must be plugged into a receptacle controlled by a GFCI (ground fault interrupter) circuit breaker. Device must be properly connected to a grounded three-prong receptacle.
- L) This appliance is intended FOR HOUSEHOLD USE ONLY.
- M) This Light Fixture is required to be used over a covered aquarium. A glass top or protective barrier is required to minimize the fixture's exposure to water.
- N) **SAVE THESE INSTRUCTIONS**



## NOTE

DO NOT POSITION HID LAMPS DIRECTLY OVER AQUARIUM FRAME BRACES

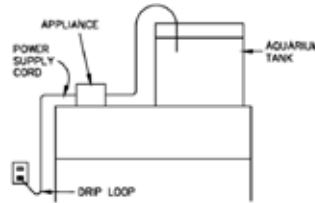

## GROUNDING SETUP

This appliance should be grounded to minimize the possibility of electric shock. This appliance is equipped with an electric cord having an equipment grounding conductor and a grounding type plug. The plug must be plugged into an outlet that is installed and grounded in accordance with all appropriate codes and ordinances.

This appliance is for use on a normal 120-volt circuit, and has a grounding plug that looks like the plug illustrated below.

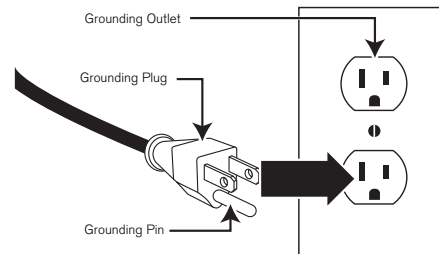

A temporary adaptor which looks like the adaptor illustrated in (A) may be used to connect this plug to a two-pole receptacle as shown in (A) if a grounded outlet is not available.

A temporary adaptor should only be used until a grounded outlet can be installed by a qualified electrician.

## GROUNDING INSTALLATION

The green-colored rigid tab extending from the adaptor must be fastened to a permanent ground such as a grounded outlet box.

1. Plug temporary adaptor into two-pole outlet. (B)
2. Insert screw through rigid tab on temporary adaptor and into grounded outlet box. (C)

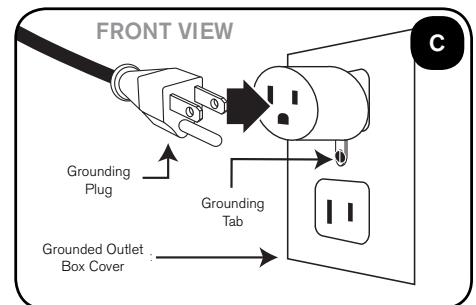
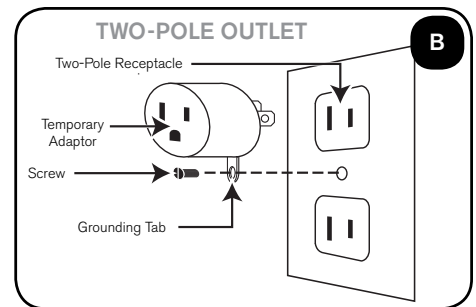
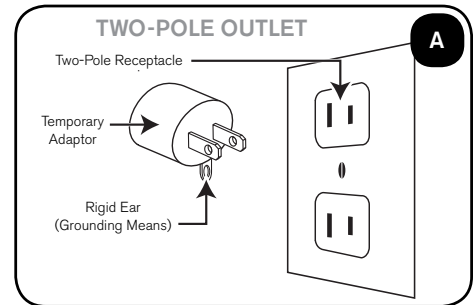

## PARTS DIAGRAM (100 GPD)

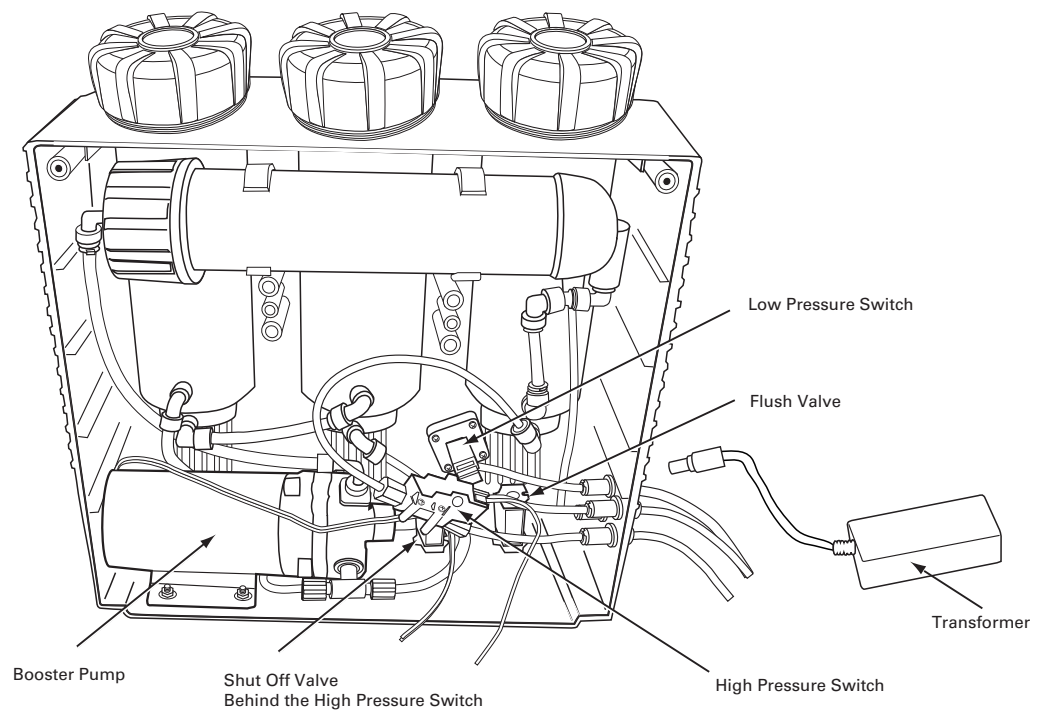

## PARTS DIAGRAM (200 GPD)

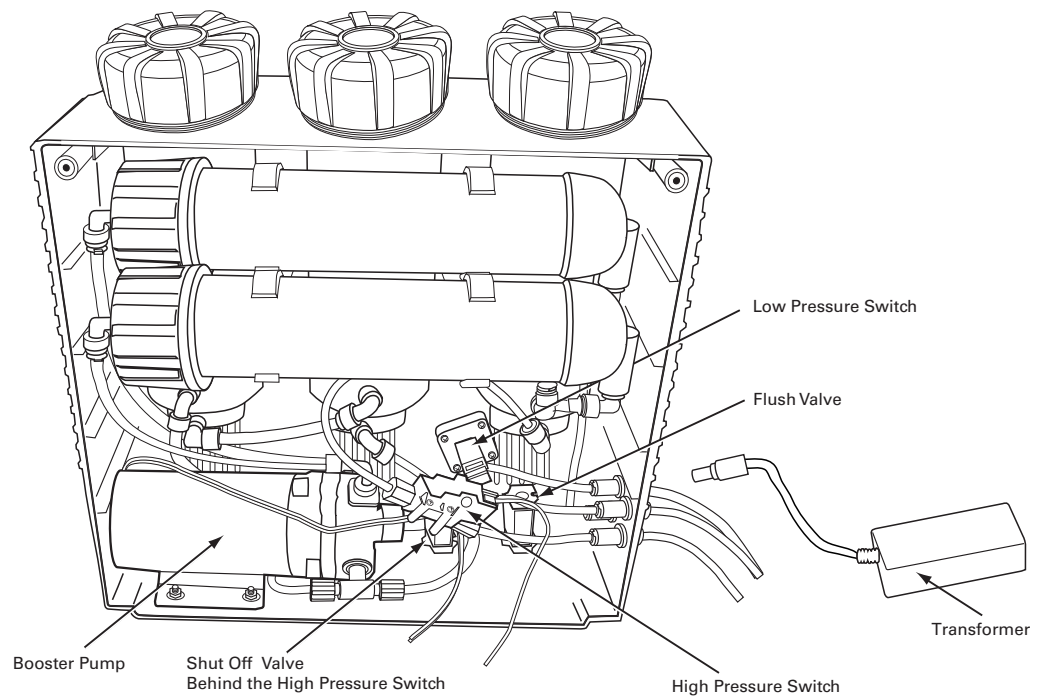

**PARTS LIST:**  
**For Reverse Osmosis Power Unit**  
 (Models 540087, 540239)

Mounting Hardware	✓
Canister Caps (blue)	3
Micron Cartridge	330088
Solid Carbon Block Cartridge	330090
Resin Cartridge (mixed bed)	330091
Reverse Osmosis Membrane (1)(2)	330093
Canister Cap Wrench	✓
Membrane Wrench	✓
Tubing Blue (meters) 6.4 mm / 1/4"	15 m / 49 ft
Tubing Red (meters) 6.4 mm / 1/4"	3 m / 10 ft
Tubing Yellow (meters) 6.4 mm / 1/4"	3 m / 10 ft
Canister Cap Wrench	✓
Computer Controller	✓
Shut-off Valve (manual)	✓
Booster Pump (low voltage)	✓
Low Voltage Transformer	✓
High Pressure Switch	✓
Low Pressure Switch	✓
Automatic Flush Valve	✓
Automatic Shut-off Valve	✓
Faucet Connection	✓
Installation & Maintenance Guide	✓
Mounting Template	✓

**PRODUCT SPECIFICATIONS:**  
**For Reverse Osmosis Power Unit**  
 (Models 540087, 540239)

Water pressure:	Minimum 30 psi
Maximum water pressure:	100 psi
Optimal water temperature:	77°F (25°C)
Maximum water temperature:	105°F (40.5°C)
Typical Rejection rate:	1:1.5
Dimensions: (L x W x H)	41 x 22 x 44 cm 16.2 x 8.7 x 17.4 in

**Tools required for installation:**

- 1) Scissors & Adhesive Tape    2) Phillips #2 Screwdriver (5" or longer)    3) Drill – optional if mounting    4) Pencil

## CARTRIDGE PLACEMENT

Refer to page 4 in the *Deluxe Unit* section for step-by-step instructions.

## MOUNTING

Refer to page 4 in the *Deluxe Unit* section for step-by-step instructions.

## MEMBRANE PLACEMENT

Refer to page 5 in the *Deluxe Unit* section for step-by-step instructions.

## TUBING ATTACHMENT

The right side of the RO unit will have three connections as depicted below:

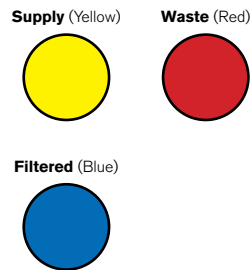
**Waste Connection:**

Insert the red 3 m tubing into the WASTE connection on the RO unit.

**Supply Connection:**

- 1) Insert the yellow 3 m tubing into the SUPPLY connection on the RO unit.
- 2) The RO unit includes an attachment to adapt to a standard threaded utility sink or garden hose. With the faucet connection installed, insert the other end of the yellow 3 m tubing into the adaptor.



**NOTE:** Before attaching the tubing, remove the blue clips and protective plugs from the housing attachments.

**Filtered Connection:**

- 1) Insert the blue 15 m tubing into the blue FILTERED connection on the RO unit.
- 2) Attach the supply shut-off valve to the other end of the blue tubing.



**WARNING:** When using a new Membrane for the first time, DO NOT use the first 30 gallons of filtered water produced from the RO unit for aquariums. The Membrane includes a preservative that is removed during initial water contact.

## WATER SUPPLY

With all tubing connections in place, turn on the supply water to the RO unit. Check to ensure that all connections are secure and there are no leaks. If all connections are secure and water tight, replace the RO unit's Front Cover and replace the four screws that were removed.

## FLUSH VALVE (AUTOMATIC)

Flushing the Membrane is critical to obtaining peak performance from the RO unit. Flushing clears debris build-up on the Membrane. The Power RO unit includes an internal automatic valve that flushes the Membrane for 30 - 45 seconds every time the unit is activated. The internal valve allows water to bypass the flow restrictor located inside the RO unit housing. After 30-45 seconds, the valve will force the water to pass through the flow restrictor and build pressure against the Membrane. Filtered water production will then resume.

## LOW PRESSURE SWITCH

The Low Pressure Switch will disconnect power from the RO unit if the source water pressure is less than 4.35 PSI. This will prolong the life of the Pressure Pump.



**NOTE:** The water pressure supplied to the High Pressure Switch must be constant. If the pressure fluctuates, the Switch may NOT shut the system down. It is recommended that a Positive Valve be used with the Powered RO unit.

## HIGH PRESSURE SWITCH

The High Pressure Switch will disconnect power from the RO unit if the FILTERED water supply line pressure is greater than 43.5 PSI.

Many RO unit installations connect to storage containers that use float valves or pressure canisters that create pressure on the FILTERED water line. When the containers are full, a back pressure on the FILTERED water line is created. The Aquatic Life Powered RO unit will disconnect power to the Pressure Pump and prevent water flow to the Membrane.

## PRESSURE PUMP

The Pressure Pump increases incoming water pressure to 100 PSI. This higher pressure increases the effectiveness of the RO unit and reduces waste water output. The Pressure Pump is low voltage and is powered by the included transformer.

## AUTOMATIC SHUT-OFF VALVE

An Automatic Shut-off Valve is included with the Power RO unit to eliminate water waste and possible leak involved problems. The Shut-off Valve will activate if the Low Pressure Switch or High Pressure Switch is activated. The computer controlled valve will stop the water supply from reaching the RO unit.

## COMPUTER CONTROLLER

The Powered RO unit includes a Computer that controls the operation of the RO unit. The display will indicate several operating modes.

- **Washing (orange)** - Indicates that the RO Membrane is being flushed by the Automatic Flush Valve. Flushing should last no more than 45 seconds.
- **Full (green)** - Indicates that the RO unit has filled the container or the Shut-off Valve has been activated.
- **Lack (orange)** - Indicates that the supply water to the RO unit is not sufficient, the water pressure is under 4.35 PSI and the unit will not operate until the supply water pressure can be increased.
- **Check (red)** - Indicates that the unit has operated over 18 hours.
- **Source (blue)** - Water production is in process and all components are functioning properly.

## WATER STORAGE

Reverse Osmosis filtered water can be stored in covered or sealed containers for future use.



**TIP:** Store RO filtered water in a clean plastic barrel with lid for easy mixing of saltwater for marine aquaria.

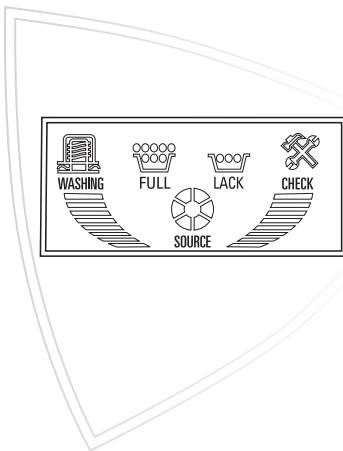

## CARTRIDGE REPLACEMENT

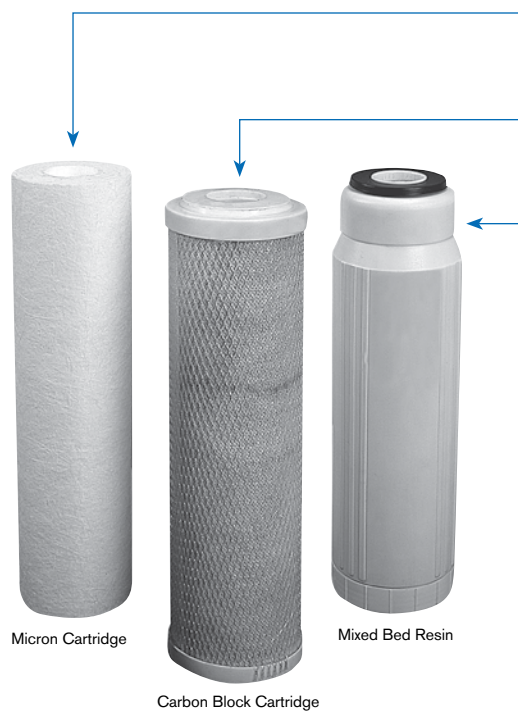

### Micron Cartridge (Item # 330088)

Replace the Micron Cartridge every six months or 3,000 gallons, whichever comes first. As the cartridge fills with particulate material, it will restrict water flow and reduce the overall performance of the RO unit.

### Carbon Block Cartridge (Item # 330090)

Replace the Carbon Block every six months or 3,000 gallons, whichever comes first. As the cartridge fills with particulate material, it will restrict water flow and reduce the overall performance of the RO unit.

### Mixed Bed Resin Cartridge (Item # 330091)

The Mixed Bed Resin Cartridge should be replaced when the TDS level of the filtered water is above 3% of the incoming source water TDS level. This level can be calculated by dividing the TDS level of the filtered water, by the TDS level of the source water. This value will show the % of TDS in the filtered water.

### Membrane

The Membrane should be replaced every two years or when an increased TDS level is found even after a new Mixed Bed Resin Cartridge is installed.

## POWER UNIT WIRING

### Wiring description for the computer controller:

- |                |   |                     |               |   |                  |
|----------------|---|---------------------|---------------|---|------------------|
| ● Yellow wires | > | Low pressure valve  | ● Green wires | > | Pump             |
| ● Blue wires   | > | High pressure valve | ○ White wire  | > | Red power line   |
| ● Red wires    | > | Flush valve         | ● Pink wire   | > | Black power line |
| ● Black wires  | > | Shut-off valve      |               |   |                  |

**Drip Loop:** To arrange an electrical cord so it hangs down well below the outlet before running back up again. Any water running down the cord will drip down from the loop, rather than running uphill to enter the outlet.

**Reverse Osmosis: (RO)** A separation process that uses pressure to force water through a membrane that retains the solute on one side and allows the pure water to pass to the other side.

**Total Dissolved Solids: (TDS)** The combined content of all inorganic and organic substances contained in a liquid which are present in a molecular, ionized or micro-granular suspended form. The principal application of TDS is in the measure of water quality.

**Mixed Bed Resin:** Media primarily used in water purification for the polishing process to achieve demineralized water quality. Mixed Bed, as the name states, consists of strong acid cation exchange and strong base anion exchange resin that removes total dissolved solids (TDS) from membrane filtered water.

**Positive Valve:** A valve that can be manual or automated that creates a solid consistent seal.

**Membrane:** A filter media that will allow certain molecules or ions to pass through it by diffusion. The rate of passage depends on the pressure, concentration, and temperature of the molecules or solutes on either side, as well as the permeability of the membrane to each solute.

**Flow Restrictor:** Reduces the water flow to a specific volume of water. The Aquatic Life RO units use a Flow Restrictor on the waste water line that only allows 300cc of water to pass.

**Pressure Canister:** A storage container that uses an internal bladder to create pressure on water that is stored inside the canister. A pressure canister is used to store filtered water from the RO unit and releases the water when a valve is opened. The canister stores water to increase the volume of water when needed.

## REGISTERING YOUR PRODUCT(S) WITH AQUATIC LIFE

When you purchase an Aquatic Life product, you will find a Warranty Registration Card accompanying the product. Please complete this Card and mail it in within 15 days from the date of purchase or register your product online at [www.aquaticlife.com](http://www.aquaticlife.com). Some Aquatic Life products will include a Serial Number. To validate your warranty, the Serial Number must be included for appropriate products.

### Product Serial Numbers

Serial Numbers DO NOT contain the letters "UL", "CUL", "CSA", "EN" or "CE". These letters refer to a US, Canadian and European Standards for that product. If you need help locating the Serial Number for your product, please visit our website at [www.aquaticlife.com](http://www.aquaticlife.com) or call Aquatic Life at 1-888-548-3480.

## LIMITED WARRANTY

Aquatic Life, LLC warrants that this Reverse Osmosis Unit (excluding cartridges and membrane) shall be free from defective electrical components and leaks or cracks due to defects in materials or workmanship for a period of twenty-four (24) months from the date of purchase. If a defect is shown, Aquatic Life, LLC will, at Aquatic Life's sole discretion, either repair or replace the product without charge. No cash refunds will be made. This warranty is provided solely to the original consumer purchaser of the product and may not be transferred or assigned.

This warranty does not apply to damage resulting from accident, misuse, abuse, lack of reasonable care, failure to follow safety and installation instructions, use of the product with non-standard electrical service, or any other defect not resulting from defects in the electrical components of the product or defects in materials or workmanship. This warranty will not be effective unless and until the Aquatic Life product is shown to have been used in accordance with the safety and installation instructions accompanying the product.

THIS CONSTITUTES AQUATIC LIFE'S ENTIRE WARRANTY AND AQUATIC LIFE MAKES NO OTHER WARRANTIES, WHETHER EXPRESS OR IMPLIED, WITH RESPECT TO THE PRODUCT. AQUATIC LIFE, LLC SPECIFICALLY DISCLAIMS ANY AND ALL IMPLIED WARRANTIES, INCLUDING, WITHOUT LIMITATION, WARRANTIES OF MERCHANTABILITY AND FITNESS FOR A PARTICULAR PURPOSE. IF AQUATIC LIFE, LLC CANNOT LAWFULLY DISCLAIM IMPLIED WARRANTIES UNDER THIS LIMITED WARRANTY, ALL SUCH WARRANTIES, INCLUDING WARRANTIES OF MERCHANTABILITY AND FITNESS FOR A PARTICULAR PURPOSE ARE LIMITED IN DURATION TO THE DURATION OF THIS WARRANTY.

AQUATIC LIFE IS NOT RESPONSIBLE FOR DIRECT, SPECIAL, INCIDENTAL OR CONSEQUENTIAL DAMAGES RESULTING FROM ANY BREACH OF WARRANTY OR CONDITION, OR UNDER ANY OTHER LEGAL THEORY. AQUATIC LIFE, LLC EXPRESSLY DISCLAIMS ALL ALLEGED DAMAGES FOR LOSS OF MARINE LIFE, PERSONAL INJURY, AND/OR PROPERTY DAMAGE.

Some states and provinces do not allow the exclusion or limitation of incidental or consequential damages or exclusions or limitations on the duration of implied warranties or conditions, so the above limitations or exclusions may not apply to you. This warranty gives you specific legal rights, and you may also have other rights that vary by state or province.

Aquatic Life, LLC shall not have any obligations under this warranty unless the owner notifies Aquatic Life, LLC in writing of any alleged defect(s) within 30 days of discovery of the defect(s). Any notice to Aquatic Life, LLC must be delivered by United States or electronic mail to the following address:

U.S. Mail

**Aquatic Life, LLC**  
**2416 W. Victory Blvd, #136**  
**Burbank, CA 91506**

Electronic Mail: [customersupport@aquaticlife.com](mailto:customersupport@aquaticlife.com)

Aquatic Life, LLC shall be allowed a reasonable period of time to investigate any warranty claim and to perform any testing Aquatic Life, LLC deems necessary to determine the cause of the defect. This warranty shall be interpreted under the laws of the State of California.





Aquatic Life, Life Rewards, and  
"Bringing the ocean to you, wherever you may be."  
are trademarks of  
Aquatic Life LLC  
Commerce, CA 90040  
[www.aquaticlife.com](http://www.aquaticlife.com)

© Copyright Aquatic Life LLC

P/N 9000040 REV 05/12