

Thank you for purchasing an Aquatic Life Barrel Buddie™ Smart Fill Controller.

When maintained properly, this unit will provide you with years of service.



## OVERVIEW

The Barrel Buddie will monitor the water level at both high and low points in your barrel or container. When the lower sensor detects the water level, the low voltage solenoid will open and allow water to flow into the container. When the water level reaches the upper sensor, the solenoid will close.

Unlike float valves or auto top-off systems, the Barrel Buddie reduces TDS creep by allowing the RO unit to only operate once to fill the container. This will improve the overall TDS in your collection container and prolong the life of your DI resin if you are using DI filtration.

There are additional features to the Barrel Buddie, so please review this entire guide to understand the benefits and requirements.

## Contents

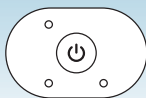

Controller

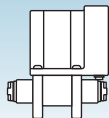

Solenoid

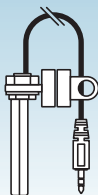

High Water Sensor

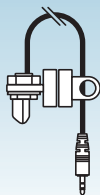

Low Water Sensor

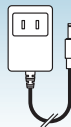

Power Supply

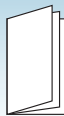

Product Manual

For technical assistance or warranty issues, contact Aquatic Life at [customersupport@aquaticlife.com](mailto:customersupport@aquaticlife.com)



**WARNING:** Please read carefully before proceeding with installation. Your failure to follow any attached instructions and operating parameters may lead to the product's failure.

## BECOMING FAMILIAR WITH YOUR BARREL BUDDIE

### CONTROLLER

The Controller has four jacks:

- ❶ High Water Sensor
- ❷ Low Water Sensor
- ❸ Transformer
- ❹ Solenoid

Each jack is different size and/or design, so there is no confusion which cord plugs into which jack.



The Controller will perform the following functions:

- ❶ Show a solid red LED when the unit is powered on
- ❷ Open solenoid when low water sensor is activated
- ❸ Close solenoid when high water sensor is activated
- ❹ Flash blue LED and sound alarm if backup high water sensor is activated
- ❺ In the event of a power outage, the unit will shut off. Pressing the on button will activate the unit again.

## BECOMING FAMILIAR WITH YOUR BARREL BUDDIE

### HIGH WATER SENSOR

The High Water Sensor is actually two sensors in one. The bottom sensor detects the water level and closes the solenoid.

There is a second back-up sensor closer to the magnet attachment. If water should continue to fill your container and reach the top sensor, the Controller will flash a blue LED and sound an audible alarm.

The strong magnet makes it easy to position the sensor in most plastic and rubber containers.

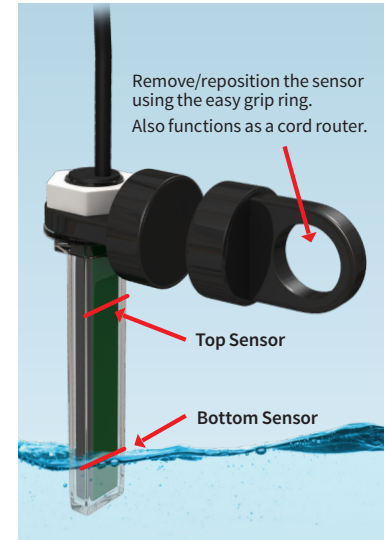

### LOW WATER SENSOR

When the Low Water Sensor detects the water fall below the sensor, the Controller will open the solenoid and allow water to fill the container.

The strong magnet makes it easy to position the sensor in most plastic and rubber containers.



## BECOMING FAMILIAR WITH YOUR BARREL BUDDIE

### SOLENOID

The Solenoid responds to the signals sent from the Controller. In the event of a power outage, the Solenoid will close to avoid overfilling the container.

To prolong the Solenoid life, it should be placed after a sediment filter to prevent becoming plugged with possible debris in a water supply line.

**Ideal operating pressure is 80 PSI OR LESS.**

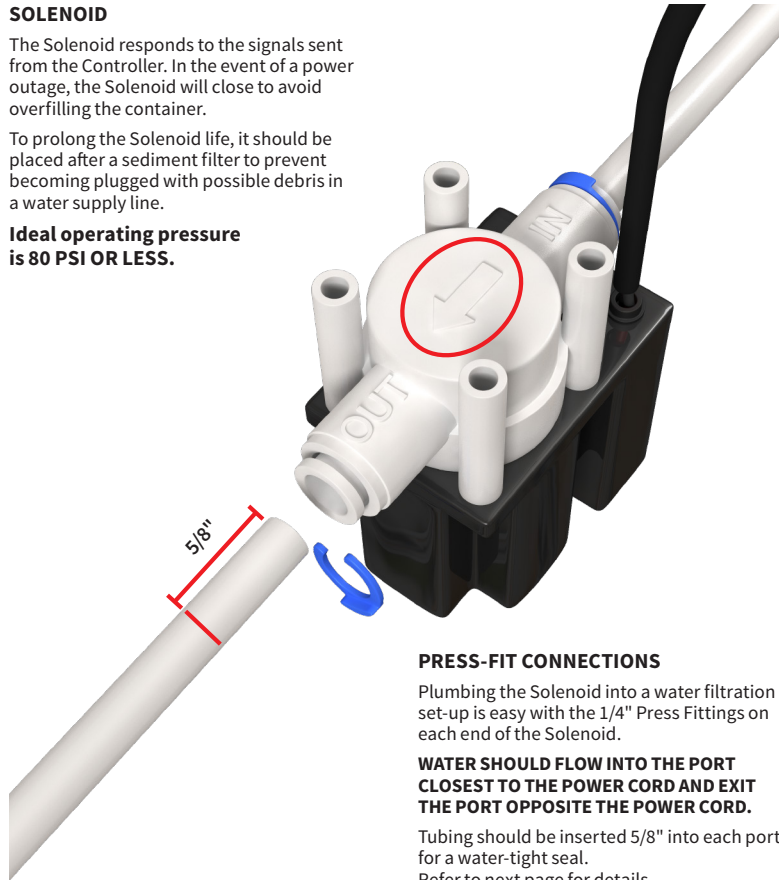

### PRESS-FIT CONNECTIONS

Plumbing the Solenoid into a water filtration set-up is easy with the 1/4" Press Fittings on each end of the Solenoid.

**WATER SHOULD FLOW INTO THE PORT CLOSEST TO THE POWER CORD AND EXIT THE PORT OPPOSITE THE POWER CORD.**

Tubing should be inserted 5/8" into each port for a water-tight seal. Refer to next page for details.

## USING THE PRESS FITTINGS

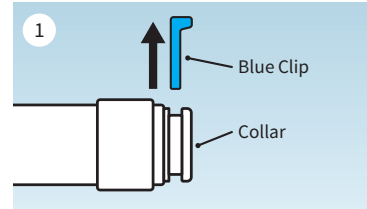

Remove the blue clip from the press fitting.

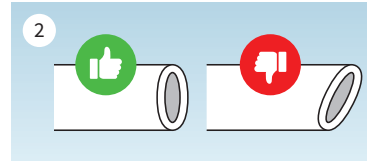

Cut tubing evenly and not at an angle.

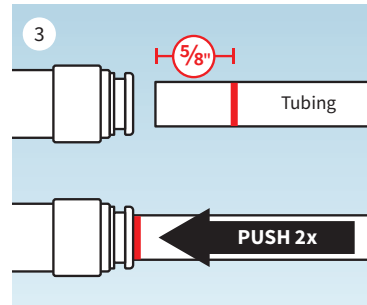

Mark the tubing 5/8" from the cut end. Push the tubing into the fitting. You will hit the first stop. The tubing is still not secured properly. Push the tubing a second time until it reaches the 5/8" mark.

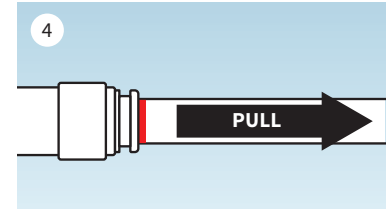

Pull back on the tubing to ensure it is secure.

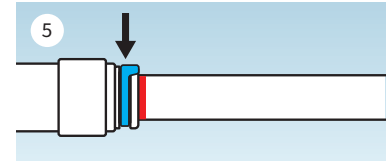

Replace the blue clip back onto the fitting.

**NOTE:** To remove a piece of tubing, remove the blue clip, then press down and hold the collar while pulling out tubing.

**NOTE:** Pinched tubing will not seal properly. Cut the tubing with the included razor blade to prevent pinching. It is important that the tubing is inserted a full 5/8" into the press fitting to avoid leaking.



**SCAN TO WATCH**  
How to use  
press fittings

## BARREL BUDDIE INSTALLATION

**Step 1** - Mount the low-water sensor in the collection container using the **MAGNET ON THE OUTSIDE** of the container and **SENSOR ON THE INSIDE**. Sensor location determines when the solenoid opens and starts filling the container.

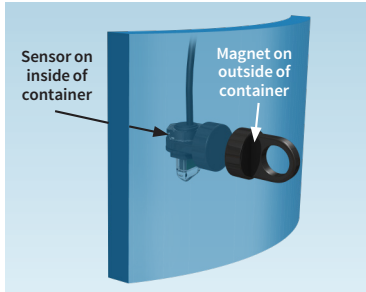

**Step 2** - Mount the high-water sensor in the collection container using the **MAGNET ON THE OUTSIDE** of the container and **SENSOR ON THE INSIDE**. The bottom of the sensor determines when the solenoid shuts off, stopping water to flow to the container.

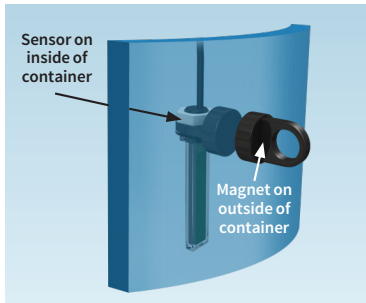

**Step 3** - Connect tubing to the Solenoid. An arrow on the bottom shows water flow direction. Refer to page 5 on **USING THE PRESS FITTINGS** to ensure a water-tight seal.

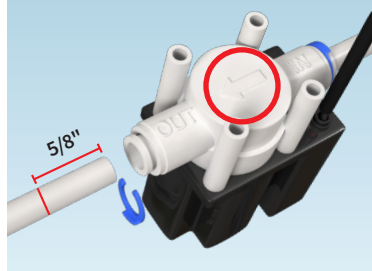

When connecting to a RO or RO/DI unit, the Solenoid should be placed after the sediment and before the carbon cartridge if possible.

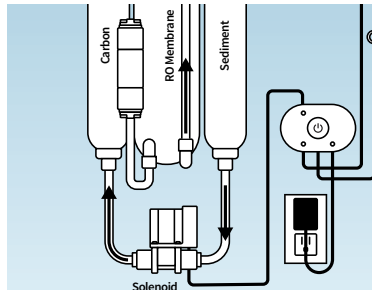

**NOTE:** If you must place the solenoid after the carbon cartridge(s), **always remove the solenoid when flushing new carbon cartridges** to prevent carbon dust from plugging the solenoid screen.

## BARREL BUDDIE INSTALLATION

**Step 4** - Locate Controller in a convenient location for easy access. Connect the sensor and solenoid cords.

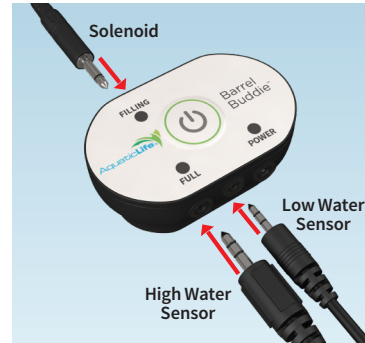

**Step 5** - Plug the low voltage transformer cord into the controller. Plug the transformer into a power outlet and create a drip loop.

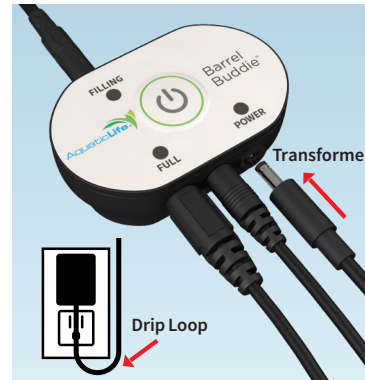

**TIP:** Install a float valve as a back-up on the filtered water line going into your collection container. The container will fill from the float, but the float should never activate unless for some reason the Barrel Buddie is not available to shut-off the water. (e.g. You remove the Barrel Buddie sensor for cleaning and forget to reinstall it).

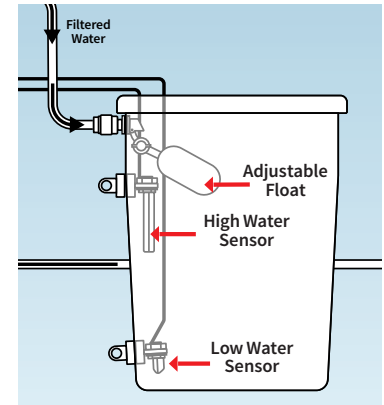

## BARREL BUDDIE OPERATION

- 1 Press the On/Off button to turn on the unit.
- 2 The Controller will sense the water level at the high and low sensors.
- 3 If the water level is below the low sensor, the controller will open the solenoid and begin filling the container.
- 4 When the water level reaches the high sensor, the controller will shut-off the solenoid.

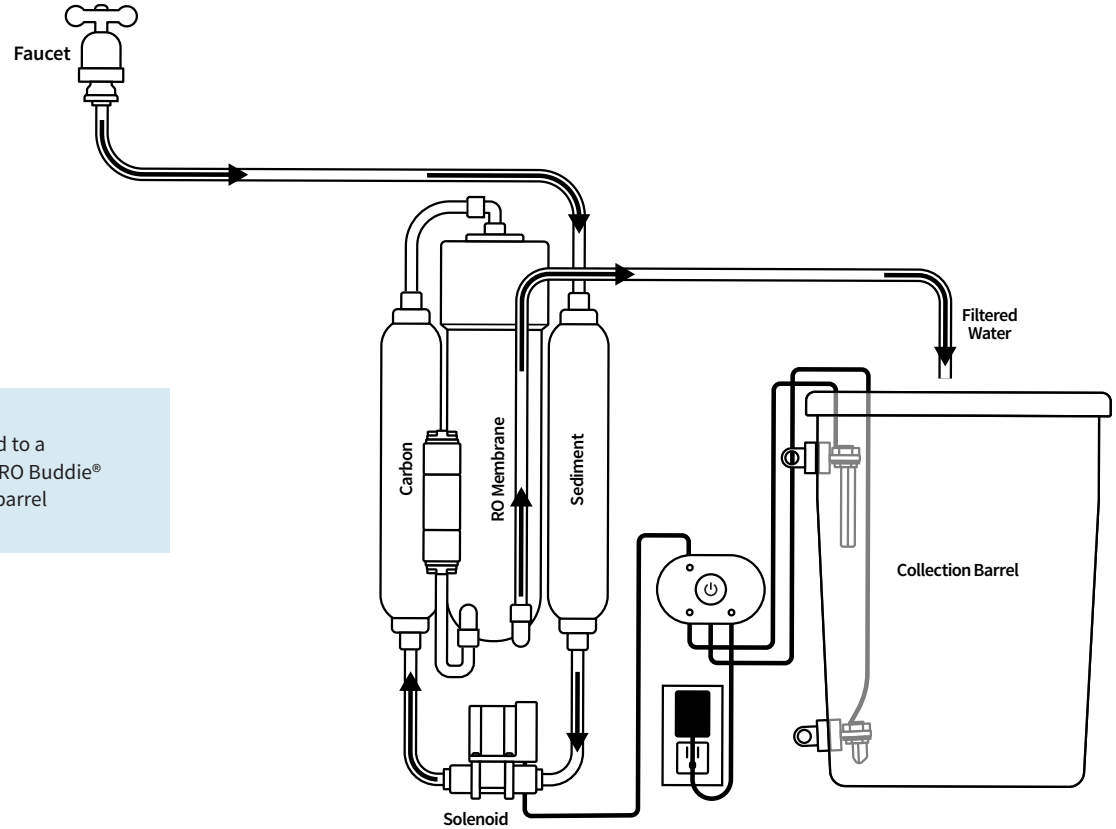

Installation

# A

Plumbed to a  
50 or 100 GPD RO Buddie®  
filling a barrel

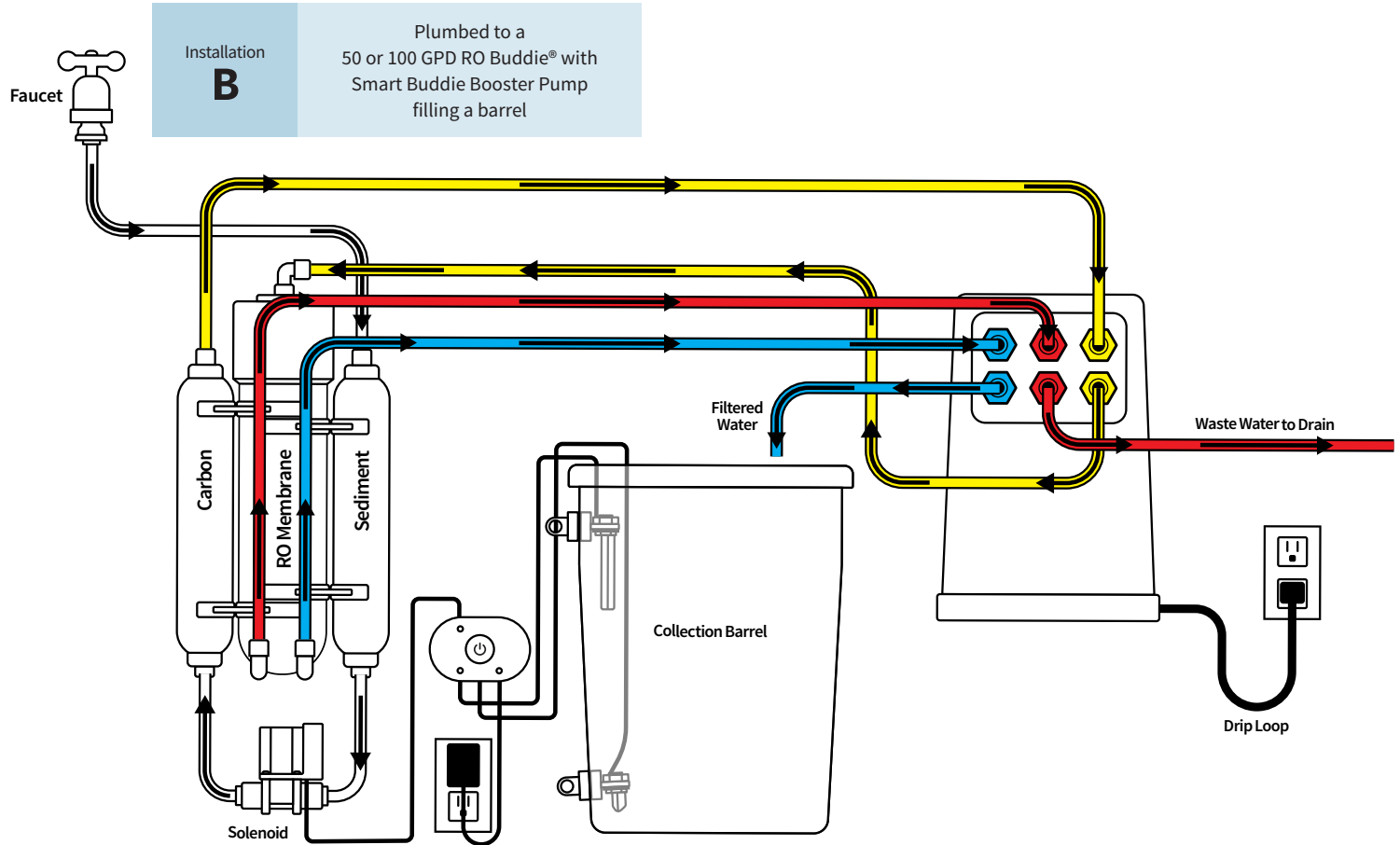

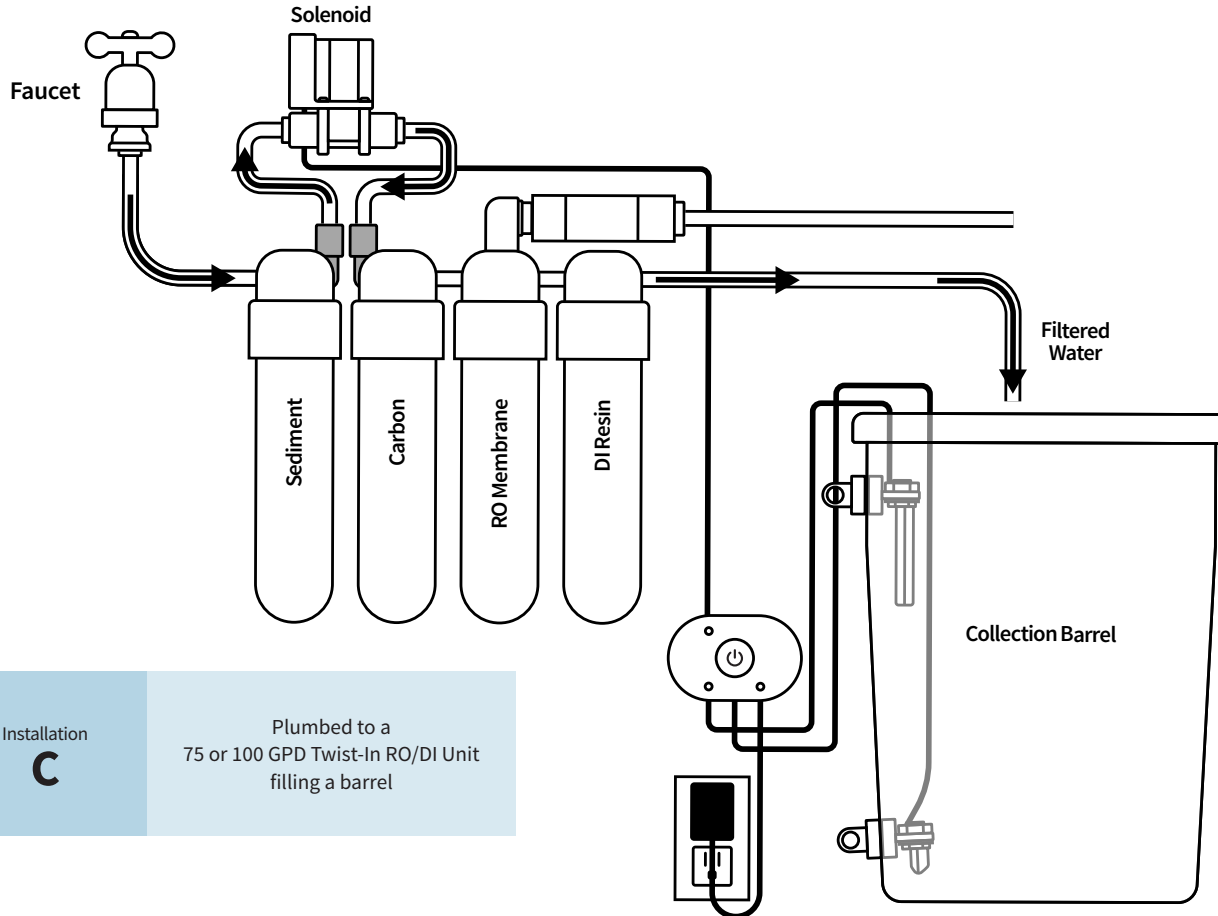

Installation

**C**

Plumbed to a 75 or 100 GPD Twist-In RO/DI Unit filling a barrel

Installation

**D**

Plumbed to a  
75 or 100 Twist-In RO/DI Unit with  
Smart Buddie Booster Pump  
filling a barrel

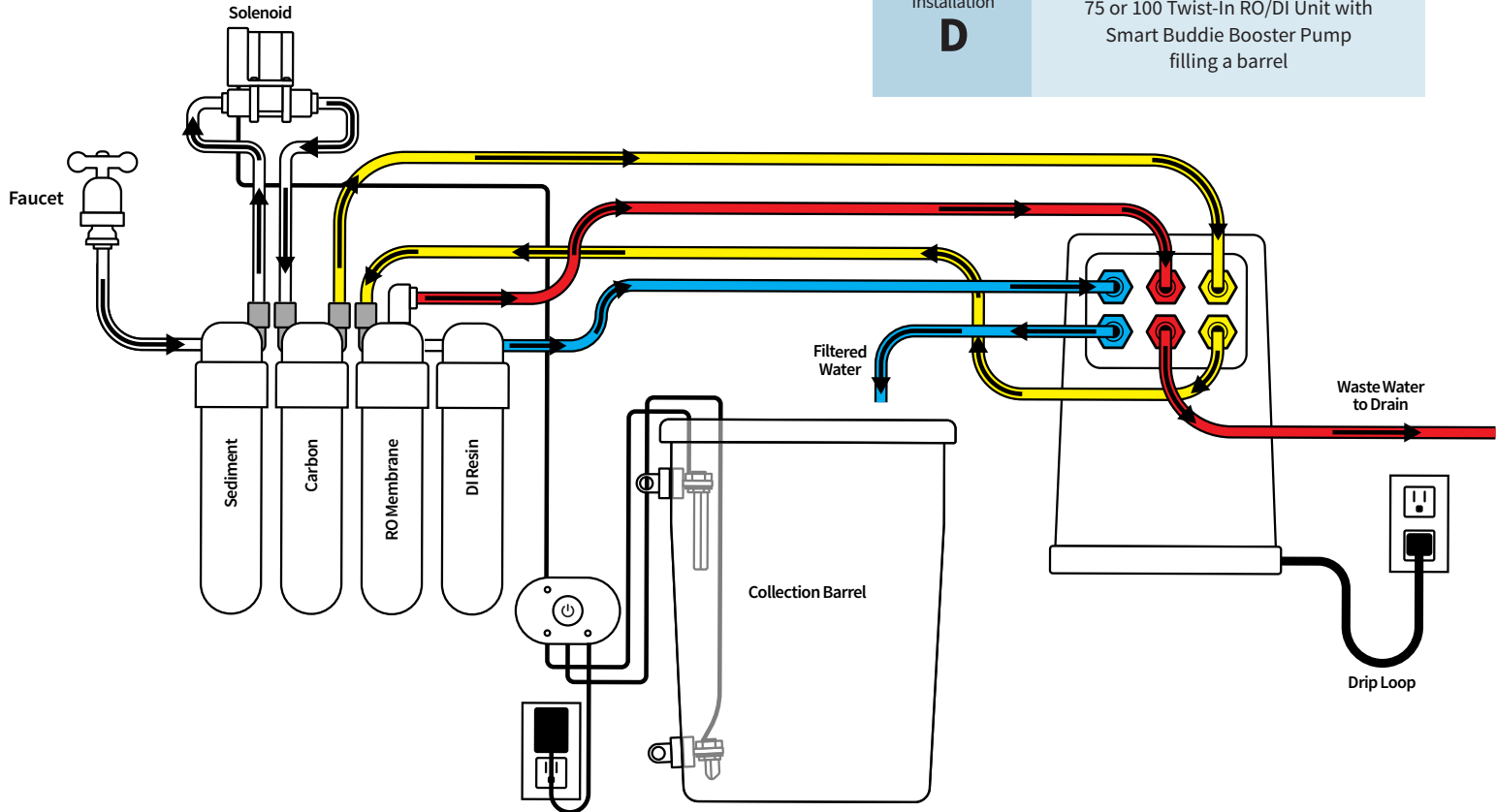



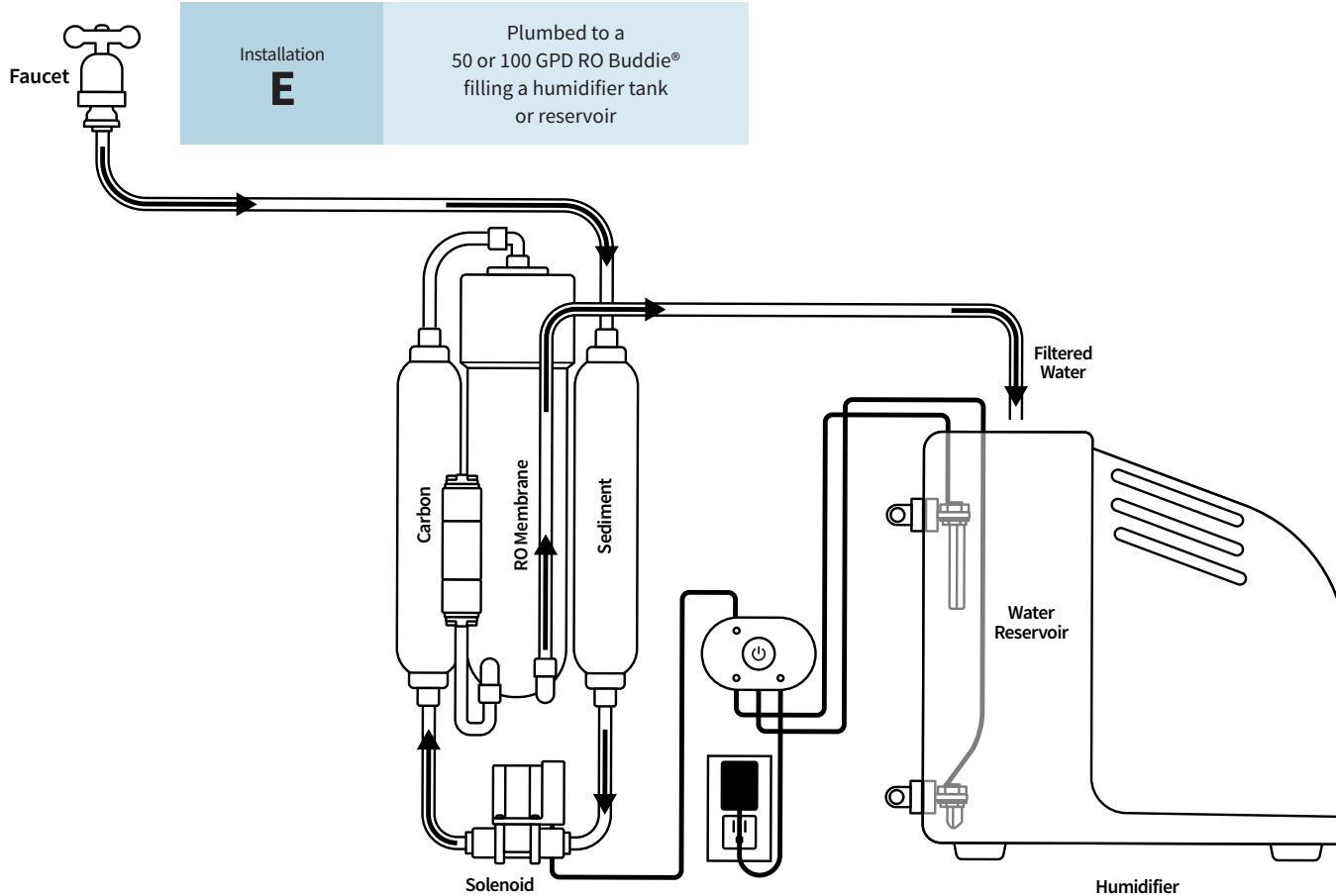

Installation  
**F**

Plumbed to a  
200 GPD RO Hydroponics Unit  
filling a barrel

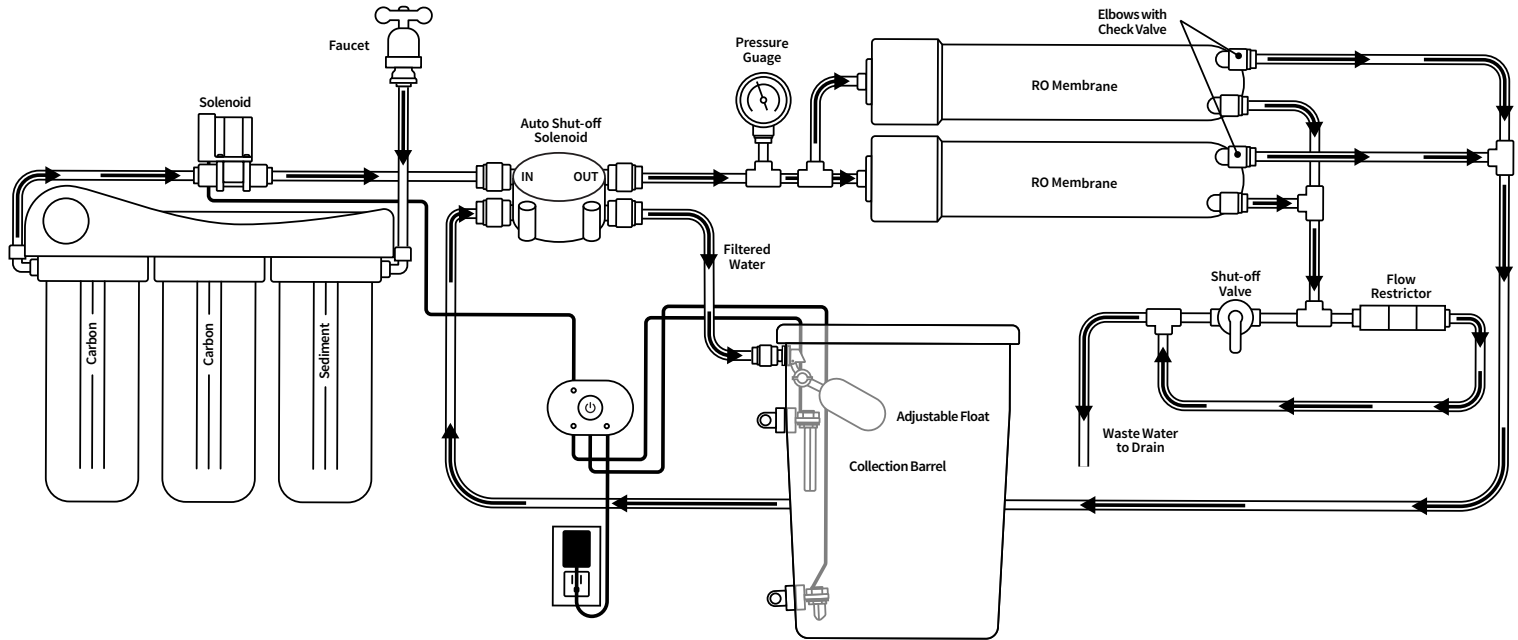

## UNIT MAINTENANCE

Monthly, or as needed, remove the sensors and wipe with a clean, damp cloth.

**Do not use abrasive cleaners on the sensors.** If calcium or minerals build-up on the sensors, soak in a 50/50 solution of vinegar and water then wipe clean.

## TROUBLESHOOTING

**The solenoid does not open when water is below the low sensor.**

- 1 Ensure the unit is powered on and the red LED light is illuminated on the controller.
- 2 Ensure the sensor cord is completely plugged into the jack on the controller

**The solenoid does not close when water reaches the high sensor.**

- 1 Ensure the unit is powered on and the red LED light is illuminated on the controller.
- 2 Ensure the sensor cord is completely plugged into the jack on the controller.
- 3 Check for debris trapped in the solenoid. Water should be pre-filtered prior to flowing through the solenoid.

## LIMITED WARRANTY

Lifetime Products LLC warrants that this Barrel Buddie shall be free from defective components due to defects in materials or workmanship for a period of one (1) year from the date of purchase. If a defect is shown, Lifetime Products LLC will, at Lifetime Product's sole discretion, either repair or replace the product without charge. No cash refunds will be made. This warranty is provided solely to the original consumer purchaser of the product and may not be transferred or assigned. If Lifetime Products chooses to replace the equipment, Lifetime Products may replace it with reconditioned equipment. Parts used in repairing or replacing the equipment will be warranted for 90 days from the date the equipment is returned to you or the remainder of the original warranty period, whichever is longer.

This warranty does not apply to damage resulting from accident, misuse, abuse, lack of reasonable care, failure to follow safety and installation instructions.

This warranty will be void if defects occur due to failure to observe the following conditions:

- Water flowing through the unit is free of particulate matter.

- Water flowing through the unit is below 40°F or above 100°F.
- Water pressure is more than 80 PSI.
- Do not use outdoors or in a location that is subjected to direct sunlight or freezing.

This warranty will not be effective unless and until the Aquatic Life product is shown to have been used in accordance with the installation and maintenance instructions accompanying the product.

THIS CONSTITUTES LIFETIME PRODUCTS ENTIRE WARRANTY AND LIFETIME PRODUCTS MAKES NO OTHER WARRANTIES, WHETHER EXPRESS OR IMPLIED, WITH RESPECT TO THE PRODUCT. LIFETIME PRODUCTS, LLC SPECIFICALLY DISCLAIMS ANY AND ALL IMPLIED WARRANTIES, INCLUDING, WITHOUT LIMITATION, WARRANTIES OF MERCHANTABILITY AND FITNESS FOR A PARTICULAR PURPOSE. IF LIFETIME PRODUCTS, LLC CANNOT LAWFULLY DISCLAIM IMPLIED WARRANTIES UNDER THIS LIMITED WARRANTY, ALL SUCH WARRANTIES, INCLUDING WARRANTIES OF MERCHANTABILITY AND FITNESS FOR A PARTICULAR PURPOSE ARE LIMITED IN DURATION TO THE DURATION OF THIS WARRANTY. LIFETIME PRODUCTS IS NOT RESPONSIBLE FOR DIRECT, SPECIAL, INCIDENTAL OR CONSEQUENTIAL DAMAGES RESULTING FROM ANY BREACH OF WARRANTY OR CONDITION, OR UNDER ANY OTHER LEGAL THEORY. LIFETIME PRODUCTS, LLC EXPRESSLY DISCLAIMS ALL ALLEGED DAMAGES FOR LOSS OF MARINE LIFE, PERSONAL INJURY, AND/OR PROPERTY DAMAGE.

Some states and provinces do not allow the exclusion or limitation of incidental or consequential damages or exclusions or limitations on the duration of implied warranties or conditions, so the above limitations or exclusions may not apply to you. This warranty gives you specific legal rights, and you may also have other rights that vary by state or province.

Lifetime Products, LLC shall not have any obligations under this warranty unless the owner notifies Lifetime Products, LLC in writing of any alleged defect(s) within 30 days of discovery of the defect(s).

Any notice to Lifetime Products, LLC must be delivered by United States or electronic mail to the following address: U.S. Mail: Lifetime Products, LLC, 9710 Klingerman St., S. El Monte, CA 91733 or electronic mail: customersupport@aquaticlife.com. Lifetime Products shall be allowed a reasonable period of time to investigate any warranty claim and to perform any testing Lifetime Products deems necessary to determine the cause of the defect. This warranty shall be interpreted under the laws of the State of California.

**Lifetime Products, LLC**  
 9710 Klingerman St. | S. El Monte, CA 91733  
 customersupport@aquaticlife.com  
 www.aquaticlife.com