

# LED SOLAR BARN LIGHT

## YAXW SERIES

### Features & Benefits

**Easy to Install:** No wire need, 0 Electricity Bill, just turn on the light and it will work automatically. Make your life safer and more convenient. (No ambient light on solar panel at night)

**Advanced 7W Monocrystalline Silicon Solar Panel:** The solar energy conversion rate is 30% faster than the old versions by using upgraded technology and material.

Solar lights outdoor detect the surrounding light condition and automatically turn on and off, a smooth panel surface keeps dirt and debris from accumulating and blocking sunlight.

Mounts directly to wooden posts or poles or can be used with existing mounting arm (not supplied).



#### Optics

Independently designed optical lens, using anti-UV material to maximize the lighting effect while reducing glare.

#### Photocel

Photocell allows for security and energy saving.

#### Motion Sensor

The PIR through the remote control can be set in a variety of working modes, long light mode, induction mode, 50% or 100% brightness optional, when the sensing motion it light 100%, when the sensing no motion it reverts to 30% brightness.

#### Versatile Mounting Arm

Mounts directly to wall surface or to pole with mounting mast arm (sold separately).



## Technical Parameters

Model	YAXW50
LED Wattage	15W
Lumens per Watt	130 - 160
Input Voltage	3.7V
Color Temperature	3000K / 4000K / 5000K / 5700K / 6500K
Operation Temperature	-40°C to + 50°C (-40°F to 122°F)
Beam Angle	120°
CRI	Ra80 (Ra90 optional)
Net Weight	0.9kg / 2.0lbs
QTY/CTN	10
GW/CTN	11.0kg / 24.3lbs
Size of box(mm/in)	225*385*95 / 8.86*15.16*3.74
SIZE of CTN(mm/in)	470*395*530 / 18.50*15.55*20.87

## Product Dimensions

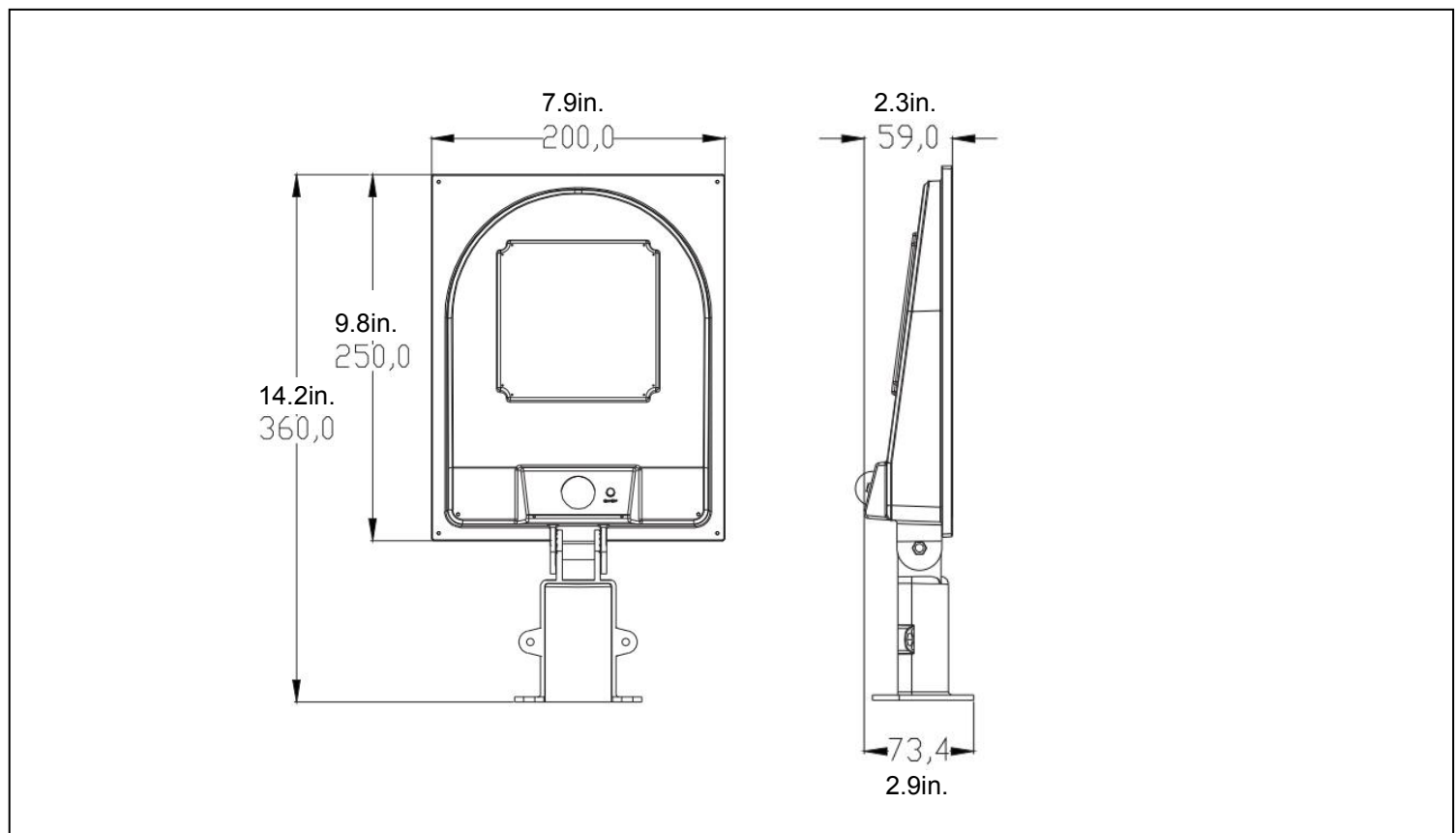

## Technical Parameters

LEISURE LIGHTING



BARN LIGHTS



YARD LIGHT



DOORWAYS



## Remote control Instruction

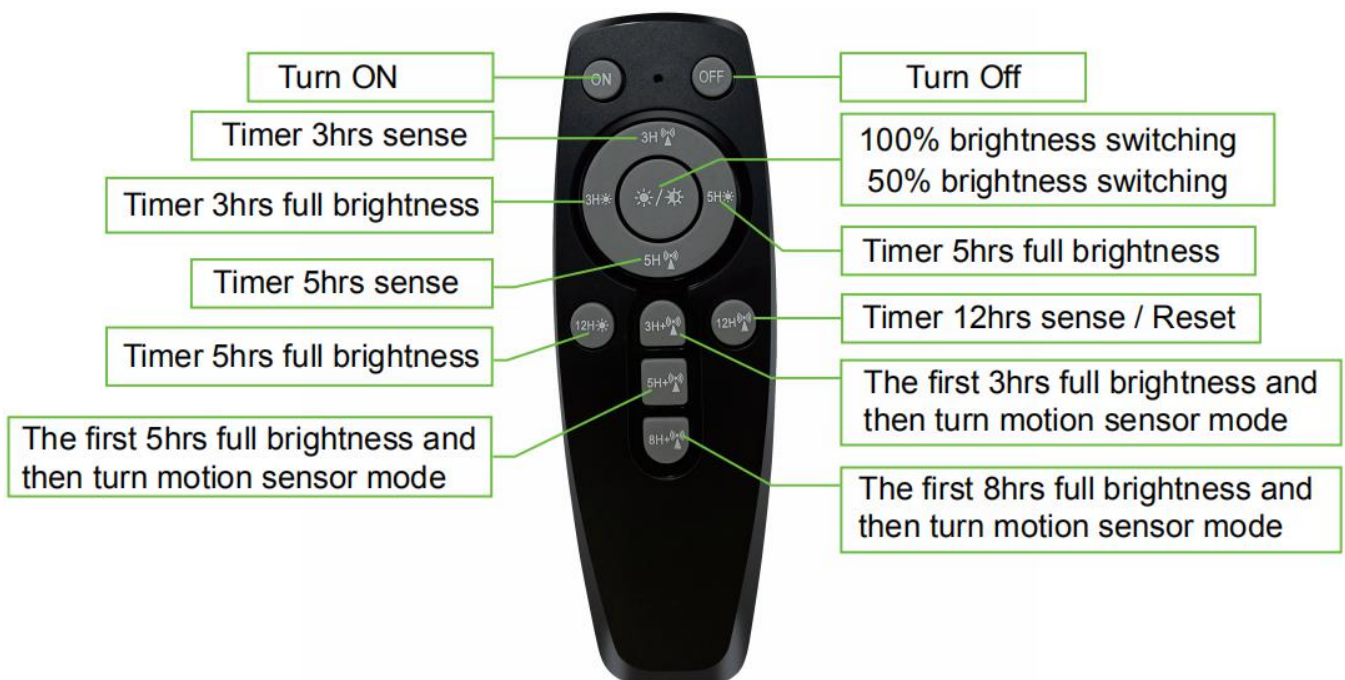

# Installation Instruction

## Direct Mounting Instructions

STEP1: Inspect components to ensure that male and female port threads and sealing surfaces are free of burrs, nicks and scratches or any foreign material.

STEP2: Drill mounting holes for fixture as shown in Fig.1.

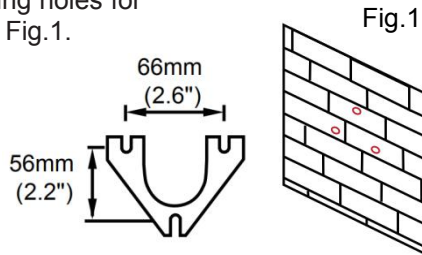

STEP3: Insert two screws (provided) into the two lower-most mounting hole locations, as shown in Fig.2. Do not tighten the screws fully.

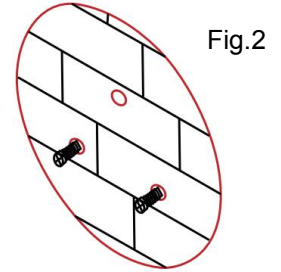

STEP4: Hook the fixture onto the two inserted screws, then insert and tighten the top screw, as shown in Fig.3. Finally, tighten the two lower-most screws.

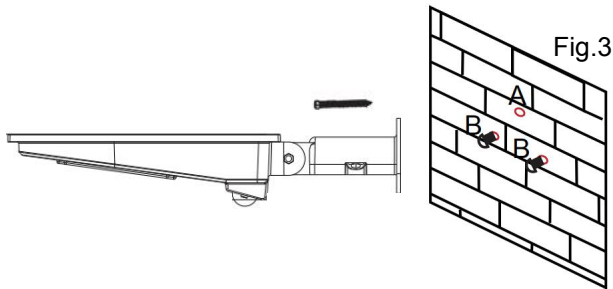

## Arm Mounting Instructions

STEP1: Inspect components to ensure that male and female port threads and sealing surfaces are free of burrs, nicks and scratches or any foreign material.

STEP2: Inspect mounting arm; if split-arm is provided, use supplied nut and bolt to assemble arm as shown in Fig.4.

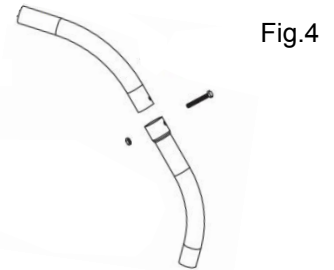

STEP3: Insert arm into the U-slot on luminaire. Use the two provided screws to secure arm, as shown in Fig.5.

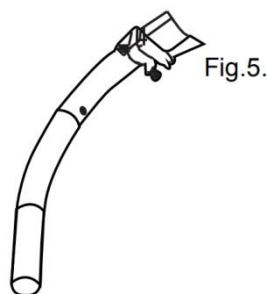

STEP4: Secure clamp onto the base of the arm, as shown in Fig.6. Ensure that the arm does not rotate.

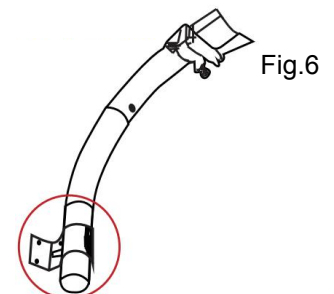

STEP5: Secure luminaire and arm to surface using four provided mounting screws, as shown in Fig.7.

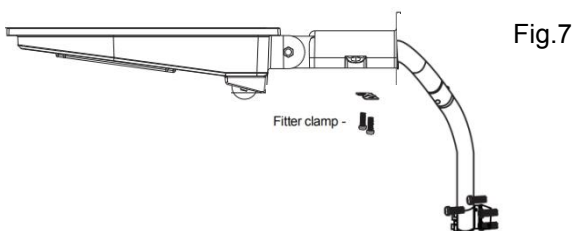

## Tip:

1. Before the first use, please short press the white button one time on the barn light and charge it for 6-8 hours under direct sunlight.
2. If you test during the daytime, must be block solar panels, otherwise it wouldn't be on, because the photocell sensor is on the solar panel.
3. When the barn light charge for 6-8 hours, if the barn light can't auto on at night, please short press the white button turn on the light again.
4. first mode :short press the white button trun on the light and then can control the light with remote control
5. second mode:short press the white button trun off the light