

PIR LED WALL LIGHTS WITH MOTION SENSOR

Product Manual

MODEL: BDB55G-3 BDI45G-2 BDC80G-3
 BDL40G-3 BDD100G-3 BDB100G-3
 BDB36G-3 BDJ55G-3

COMPONENTS AND STRUCTURE

BDB55G-3

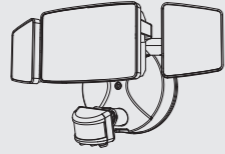

BDI45G-2

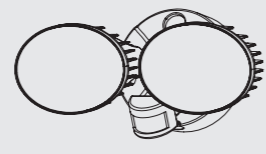

BDC80G-3

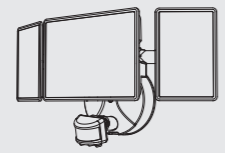

BDD100G-3

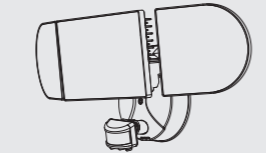

BDL40G-3

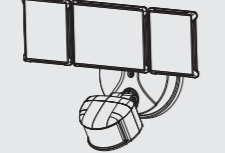

BDB100G-3

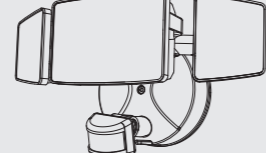

2



COMPONENTS AND STRUCTURE

BDB36G-3

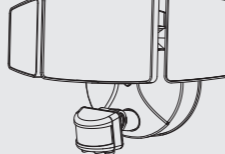

BDJ55G-3

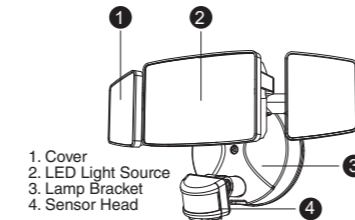
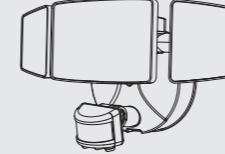

1. Cover
2. LED Light Source
3. Lamp Bracket
4. Sensor Head

PARTS LIST

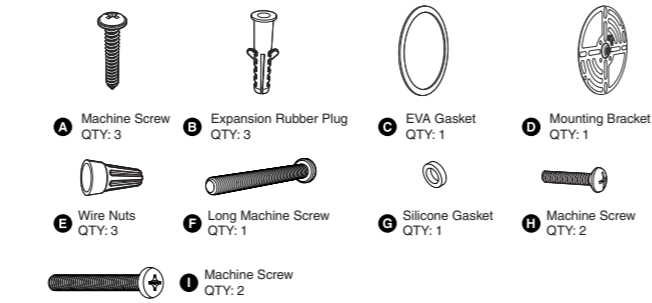

3



SPECIFICATIONS

LED WALL LAMP			
Model	BDB55G-3	BDI45G-2	BDC80G-3
Input Voltage	100-120V ~ 60Hz		
Input Current	0.5A	0.38A	0.58A
Rated Power	55W	45W	70W
Luminous Flux	5500lm	4000lm	6200lm
Model	BDD100G-3	BDL40G-3	BDB100G-3
Input Voltage	100-120V ~ 60Hz		
Input Current	0.83A	0.35A	0.83A
Rated Power	100W	40W	100W
Luminous Flux	9000lm	4000lm	9000lm
Model	BDB36G-3	BDJ55G-3	
Input Voltage	100-120V ~ 60Hz	100-120V ~ 60Hz	
Input Current	0.3A	0.5A	
Rated Power	36W	55W	
Luminous Flux	3600lm	5500lm	
CCT	6500K		
CRI	≥80		
Power Factor	≥0.9		
L70B50 lifetime	30000hours L70B50 @ 25°		
Beam Angle	120°		
ta	-20~40°C/-4°F~104°F		
Luminaire Location	SUITABLE FOR WET LOCATIONS		

4



SPECIFICATIONS

DIMENSIONS			
Model	BDB55G-3	BDI45G-2	BDC80G-3
Dimensions (LxHxW)	272x123x121mm / 10.71x4.84x4.76 in	256x140x145 mm / 10.08x5.5x5.7 in	365x195x118 mm / 14.4x7.67x4.64 in
Weight	0.7 kg / 1.54 lb	0.66 kg / 1.46 lb	0.95kg / 2.1lb
Model	BDD100G-3	BDL40G-3	BDB100G-3
Dimensions (LxHxW)	455x182x120 mm / 17.9x7.16x4.72 in	279x136x124 mm / 10.98x5.35x4.88 in	389x208x120 mm / 15.3x8.2x4.72 in
Weight	1.53kg / 3.37lb	0.7 kg / 1.54 lb	1.02 kg/2.25 lb
Model	BDB36G-3	BDJ55G-3	
Dimensions (LxHxW)	272x178x120 mm / 10.71x7.00x4.72 in	270x152x109 mm / 10.63x5.98x4.29 in	
Weight	0.53kg / 1.17lb	0.91kg / 2.00lb	

Note:

The testing standard of the product's luminous flux. Place the three/two lights on the same horizontal surface for testing, and the tested luminous flux is the accurate luminous flux.

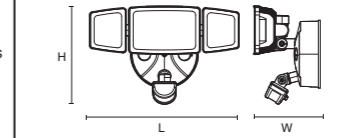

5



Operation Instructions

1. SENS adjustable: It can be adjusted according to using location; low sensitivity with 5m for detection distance; high sensitivity with 10m, it fits for large room.
2. Can identify day and night: The consumer can adjust work ambient light. It can work in the daytimes and at night when it is adjusted on the "+" position (max). It can work in the ambient light less than 10LUX when it is adjusted on the "-" position (min).
3. Time-delay adjustment: It can be set according to the consumer's desire. The minimum time is 10sec±3sec. The maximum is 7min±2min. Time-delay is added continually: When it receives the second induction signals after the first induction, it will compute time once more on the rest of the first time-delay basic (set time).

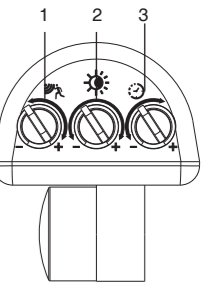

6



OPERATION INSTRUCTIONS

Detection Range: 180°

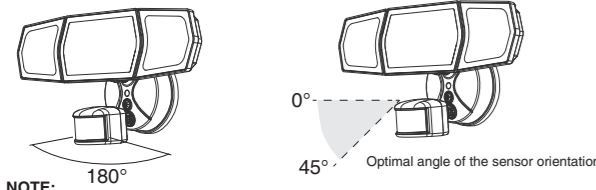

NOTE:

1. The PIR sensor shall always be tilted slightly downward.
2. The orientation angle of the sensor shall be between 0-45°.

RECOMMENDED INSTALLATION HEIGHT: 6.5-13.1 feet above the ground.

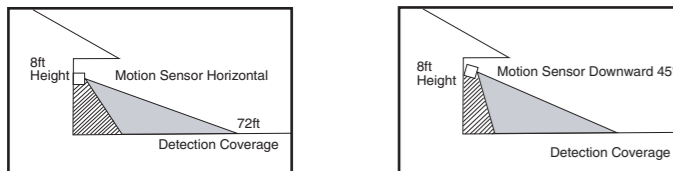

When mounted 8ft above the ground and the sensor is oriented horizontally, the maximum sensing distance is about 72ft.

When mounted 8ft above the ground and the sensor is 45° down, the minimum sensing distance is about 19ft.

Note: The detection distance of the sensor is the farthest when the ambient temperature is 25°C. Any temperature fluctuations above or below 25°C will affect the detection distance. If the light continues to detect motion while it is on, it will remain on until the motion stops.

The sensor will be more sensitive to motion across the motion towards it directly.

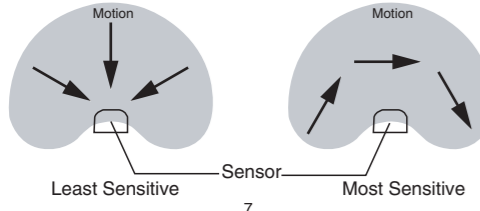

7



PREPARATION

RISK OF SHOCK:

BEFORE BEGINNING INSTALLATION, TURN OFF ELECTRICITY AT THE CIRCUIT BREAKER BOX OR THE MAIN FUSE BOX.

NOTE:

BE SURE TO USE WIRE NUTS/CONNECTORS RATED FOR THE CORRECT GAUGE AND NUMBER OF WIRES USED.

MAKE SURE THERE ARE NO EXPOSED WIRE BUNDLES OUTSIDE THE WIRE NUT/CONNECTOR (IF APPLICABLE).

BE CAREFUL NOT TO DAMAGE OR CUT THE WIRE INSULATION (COVERING) DURING INSTALLATION. DO NOT LET THE WIRES TOUCH ANY SHARP EDGES.

WARNING:

DO NOT CONNECT THIS LIGHT FIXTURE TO AN UNGROUNDED ELECTRICAL SYSTEM. ATTACH GROUND FIXTURE WIRE TO EITHER GREEN GROUND SCREW ON MOUNTING PLATE OR THE GROUND WIRE IN THE OUTLET BOX.

INSTALLING THIS LIGHT IN AN UNGROUNDED ELECTRICAL SYSTEM MAY CAUSE THE METAL PARTS OF THE LIGHT TO CARRY CURRENT IF ANY WIRES OR WIRE CONNECTIONS ARE DAMAGED OR LOOSE. IN THIS CASE, ANYONE WHO TOUCHES THE LIGHT WILL RECEIVE AN ELECTRIC SHOCK, RESULTING IN INJURY OR DEATH.

8



INSTALLATION STEPS

FOR WET LOCATION, MAKE SURE FILL FULL THE GAP OF EVA GASKET AND MOUNTING SURFACE WITH SEALING COMPOUND OR SILICONE GLUE.

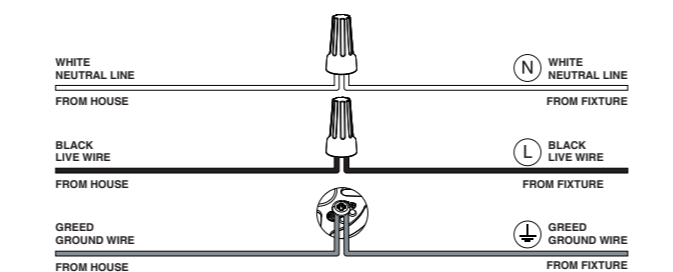
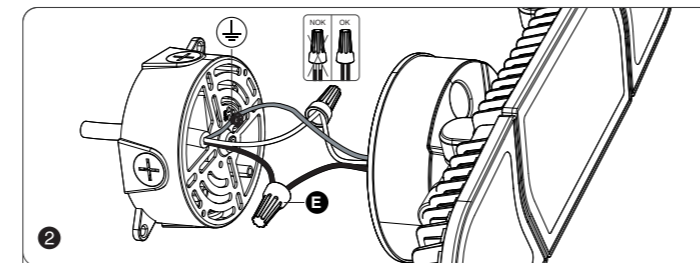
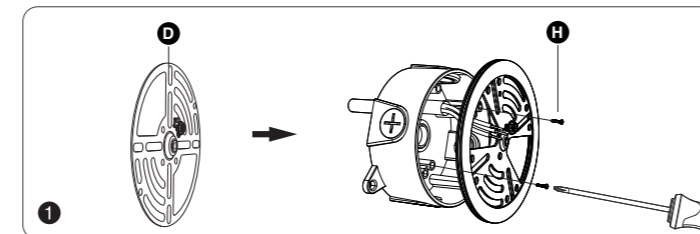

9

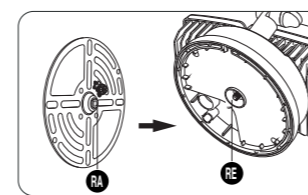
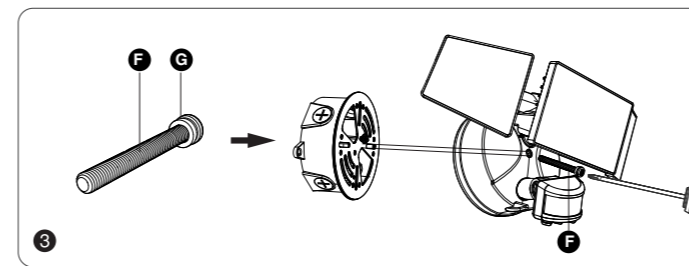

Note:

The raised part (RA) of the metal plate must be engaged with the recessed part (RE) of the base, otherwise it cannot be installed.

10



Troubleshooting

Malfunction	Cause	Remedy
LED senses a movement, the light does not light up	1. The light is not energized 2. Other surrounding light sources make the light misjudge it as daytime 3. During the day, the brightness is in night mode 4. Internal wiring is loose	1. Check power-on status 2. Turn off the nearby lights or sensor head to other directions 3. Reset 4. Rewiring after power failure
LED sensor light did not go out, continued to light up	Continuous movement within the sensing range	Check the relevant area and return or override the sensor head if necessary
LED sensor light illuminates during the day	The shadows around the sensor make it mistakenly think it's night	1. Do not cover the sensor head 2. Place the light in a place where the light is bright enough during the day
LED sensor light flashing	Surrounded by other unstable light sources shining onto the induction	Avoid being exposed to such light sources
LED lights turn on unexpectedly	1. Wind blows the branches and bushes within the sensing range 2. Sensing cars on the road 3. Sudden temperature change due to climate factors or fans, exhaust from open windows	1. Adjust its scope 2. Adjust its scope 3. Change irradiation area

11



HK Bright International Lighting Co., Limited
Unit 616, 6/F., Kam Teem Industrial Building, 135
Connaught Road West, Sai Wan Hong Kong
Manufacturer/Hersteller: MDH LIGHTING LTD
Suite 302, 292 Strovolos Avenue, 2048 Strovolos Nicosia,
Cyprus

UK Importer: MDH LIGHTING LTD
69 Aberdeen Avenue, Cambridge CB2 8DL,
United Kingdom

Made in China

support@onforuled.com www.onforuleds.com

