

### Bottom-mount Configuration for empty Garden Tower:

We recommend using pre-moistened potting soil. If you want to add fertilizer, mix it into the moistened soil before filling the Tower. If you are not using pre-moistened soil, add water where indicated in instructions.

1. Thread the long pipe into irrigation emitter ring.
2. Thread the short pipe into the 90° fitting at the bottom of the long pipe.
3. Thread the brass hose coupler onto the end of the short pipe. You can place a baggie over the end of the coupler and fasten with a rubber band to keep soil from getting in during installation.

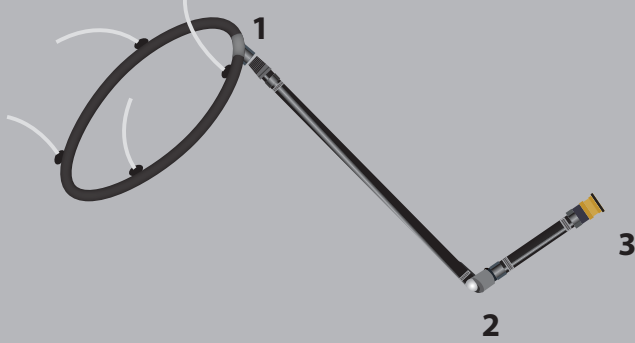

Add cap

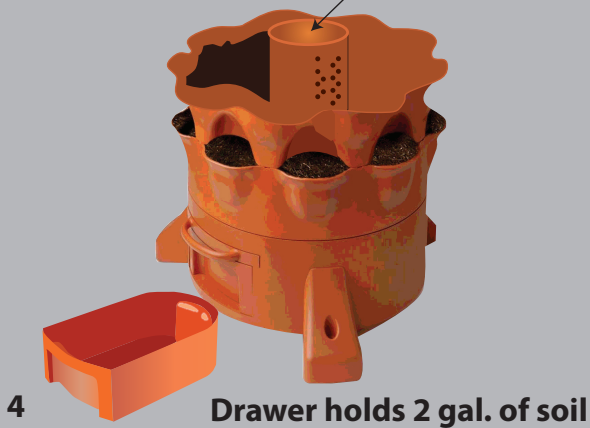

4. Set up the Garden Tower base, 1 grow ring and 2 perforated column sections. Place the cap on the perforated column section. Fill with approximately 8 gallons of potting soil. If you use the drawer to scoop the soil, use 4 drawer-fuls.

5. Mound the soil to one side so that you can place the watering system assembly inside the Tower. The coupler will extend out of one of the lowest planting pockets. Add approximately 3 gallons of water to the soil.

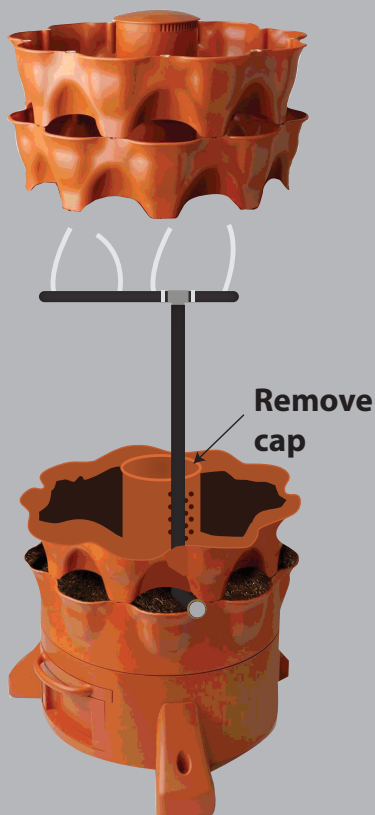

6. Remove the compost column cap and place 2 more perforated compost column sections in the center. On the side, place 2 rings together. Lift and hold the watering system assembly. Place the 2 rings over the top of the assembly and set into place. Place the compost column cap back on the top compost column section.

Add enough soil to fill the grow ring almost to the top and water with approximately 3 gallons of water. Holding the watering assembly in place, work the soil into the tower through the pockets, pressing firmly to eliminate any air pockets.

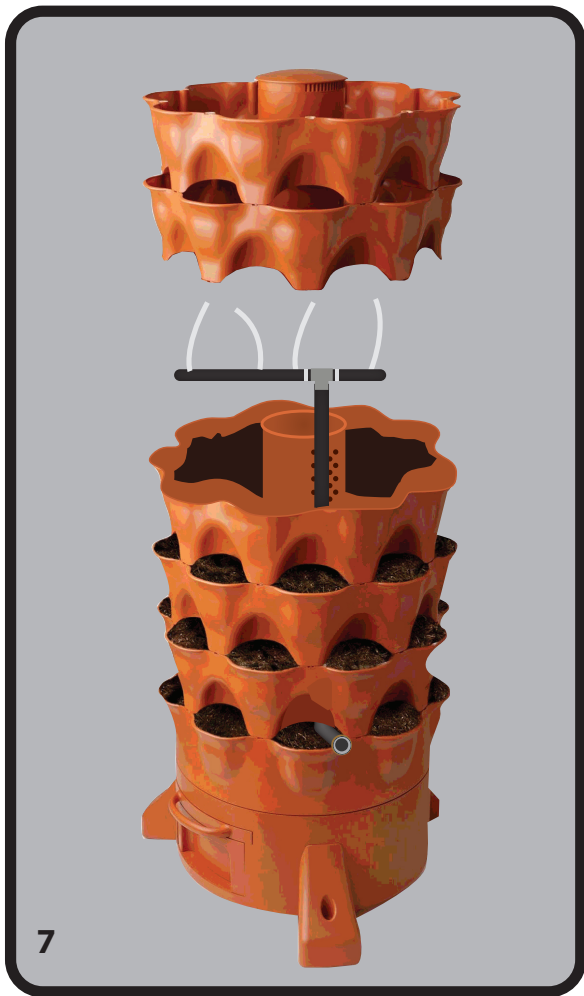

7. Place the last perforated compost column section and then the solid section. Put the cap on top. Place the last 2 grow rings on.



8. Position the watering system assembly at the bottom of the top grow ring. Turn the 4 top level watering hoses (white tubes extending from the top of the watering ring) into a spiral pattern so that when water runs through, it will water above the ring, not towards the center or outer edge.

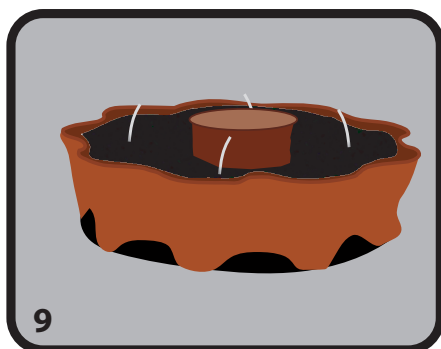

9. Add more soil, working it in from lower pockets . Fill the Tower until the soil is 1" below the top edge of the Tower. Add approximately 3 gallons of water to the soil.

Remove the plastic bag from the end of the brass couple and attach the garden hose or Irrigation Timer assembly.